



# Paint Crew<sup>®</sup>

*Superior House Painting Tool<sup>®</sup>*  
*Airless Paint Sprayer*

## MODEL 770

### Owner's Manual

Français - p. 25  
Español - p. 49

#### Contents

##### Before You Start

- 2 Important Safety Information
- 4 What's in the Box
- 5 Assemble Your Wagner Paint Crew

##### Using the Wagner Paint Crew

- 6 Proper Use and Functions
- 7 Pressure Relief Procedure
- 8 Load Material
- 9 Getting Material to Flow Prior to Spraying
- 10 Practice Spraying

##### Tips if Experiencing Spray Issues

- 12 Common Solutions to Spraying Issues
- 13 Clear the Spray Tip
- 14 Clean the Inlet Filter
- 15 Clean the Spray Gun Filter

##### Cleanup and Storage

- 16 Shut Down and Short Term Storage
- 17 Startup From Short Term Storage
- 18 Flush Material from Sprayer
- 19 Clean the Hopper
- 20 Clean Spray Gun Components
- 21 Long Term Storage

##### Troubleshooting

- 22 Fix Spraying Problems
- 24 Replacing Outlet Valve
- 24 Cleaning or Replacing Inlet Valve

##### Parts List

- 74 Parts and Accessories for Your Paint Crew

##### Warranty

- 75 Limited Warranty for Your Paint Crew

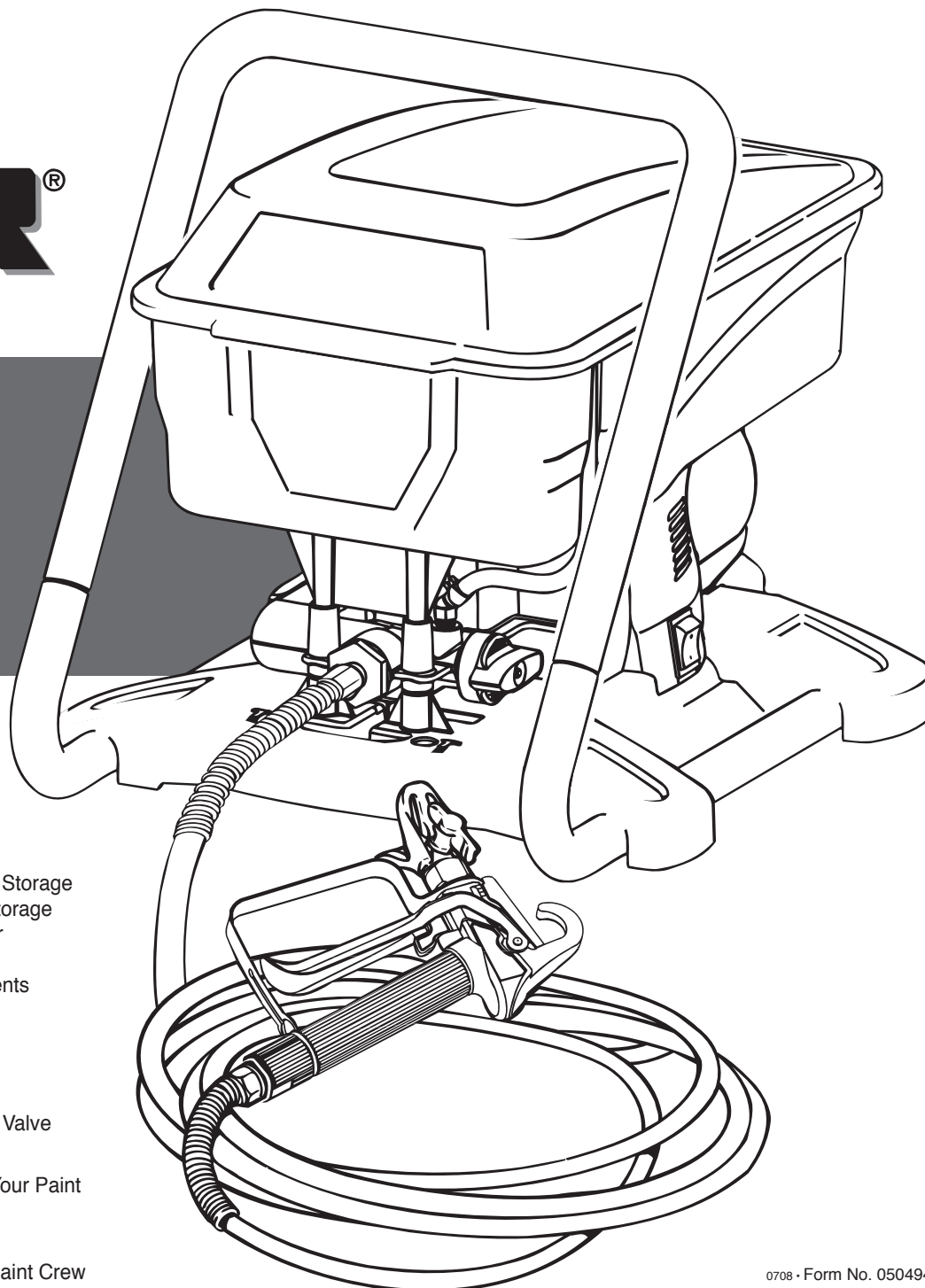

# Important Safety Information



**Read all safety information before operating the equipment. Save these instructions**

**To reduce the risks of fire or explosion, electrical shock and the injury to persons, read and understand all instructions included in this manual. Be familiar with the controls and proper usage of the equipment.**



Indicates a hazardous situation which, if not avoided, could result in death or serious injury.

### HAZARD: Injection injury

A high pressure paint stream produced by this equipment can pierce the skin and underlying tissues, leading to serious injury and possible amputation. See a physician immediately.



**DO NOT TREAT AN INJECTION INJURY AS A SIMPLE CUT! Injection can lead to amputation. See a physician immediately.**

The maximum operating range of the gun is 2800 PSI/193 BAR fluid pressure.

### PREVENTION:

- NEVER aim the gun at any part of the body.
- Do not aim the gun at, or spray any person or animal.
- NEVER allow any part of the body to touch the fluid stream. DO NOT allow body to touch a leak in the fluid hose.
- NEVER put your hand in front of the gun. Gloves will not provide protection against an injection injury.
- ALWAYS lock the gun trigger, shut the pump off, and release all pressure before servicing, cleaning the tip or guard, changing tip, or leaving unattended. Pressure will not be released by turning off the motor. The PRIME/SPRAY knob must be turned

to PRIME to relieve the pressure. Refer to the Pressure Relief Procedure (page 7) described in the pump manual.

- ALWAYS keep the tip guard in place while spraying. The tip guard provides some protection but is mainly a warning device.
- ALWAYS remove the spray tip before flushing or cleaning the system.
- Paint hose can develop leaks from wear, kinking and abuse. A leak can inject material into the skin. Inspect the hose before each use. Do not use hose to lift or pull equipment.
- NEVER use a spray gun without a working trigger lock and trigger guard in place.
- All accessories must be rated at or above 2800 PSI/193 BAR. This includes spray tips, guns, extensions, and hose.

### NOTE TO PHYSICIAN:

Injection into the skin is a traumatic injury. It is important to treat the injury as soon as possible. DO NOT delay treatment to research toxicity. Toxicity is a concern with some coatings injected directly into the blood stream. Consultation with a plastic surgeon or reconstructive hand surgeon may be advisable.

### HAZARD: HAZARDOUS VAPORS

Paints, solvents, insecticides, and other materials can be harmful if inhaled or come in contact with the body. Vapors can cause severe nausea, fainting, or poisoning.



### PREVENTION:

- Use a respirator or mask if vapors can be inhaled. Read all instructions supplied with the mask to be sure it will provide the necessary protection.
- Wear protective eye wear.
- Wear protective clothing as required by coating manufacturer.



### HAZARD: EXPLOSION OR FIRE

Solvent and paint fumes can explode or ignite. Property damage and/or severe injury can occur.



### PREVENTION:

- Provide extensive exhaust and fresh air introduction to keep the air within the spray area free from accumulation of flammable vapors. Solvent and paint fumes can explode or ignite.
- Do not spray in a confined area.
- Avoid all ignition sources such as static electric sparks, open flames, pilot lights, electrical appliances, and hot objects. Connecting or disconnecting power cords or working light switches can make sparks. Paint or solvent flowing through the equipment is able to result in static electricity.
- Do not smoke in spray area.
- Fire extinguisher must be present and in good working order.
- Place paint pump in a well-ventilated area away from the spray object. Flammable vapors are often heavier than air. Floor area must be extremely well ventilated.
- The equipment and objects in and around the spray area must be properly grounded to prevent static sparks.
- Keep area clean and free of paint or solvent containers, rags and other flammable materials.
- Use only conductive or grounded high pressure fluid hose. Gun must be grounded through hose connections.
- Power cord must be connected to a grounded circuit.
- Always flush unit into a separate metal container, at low pump pressure, with spray tip removed. Hold gun firmly against side of container to ground container and prevent static sparks.
- Follow the material and solvent manufacturer's warnings and instructions. Know the contents of the paints and solvents being sprayed. Read all Material Safety Data Sheets (MSDS) and container labels provided with the paints and solvents. Follow the paint and solvent manufacturer's safety instructions.



- This product may be used only with water-based materials or materials with a minimum flash point of 70°F (21°C) for spraying or cleaning. Do not spray or clean with materials having a flash point less than 70°F (21°C), such as solvent based lacquers, enamels, and/or stain blockers. Flash point is the temperature at which a fluid can produce enough vapors to ignite.
- Plastic can cause static sparks. Never hang plastic to enclose a spray area. Do not use plastic drop cloths when spraying flammable materials.
- Use lowest possible pressure to flush equipment.
- Do not spray onto pump assembly.

## HAZARD: EXPLOSION HAZARD DUE TO INCOMPATIBLE MATERIALS

Will cause property damage or severe injury.

### PREVENTION:

- Do not use materials containing bleach or chlorine.
- Do not use halogenated hydrocarbon solvents such as bleach, mildewcide, methylene chloride and 1,1,1 - trichloroethane. They are not compatible with aluminum.
- Contact your coating supplier about the compatibility of material with aluminum.



## HAZARD: GENERAL

Can cause severe injury or property damage.

### PREVENTION:

- Read all instructions and safety precautions before operating equipment.
- Follow all appropriate local, state, and national codes governing ventilation, fire prevention, and operation.
- The United States Government Safety Standards have been adopted under the Occupational Safety and Health Act (OSHA). These standards, particularly part 1910 of the General Standards and part 1926 of the Construction Standards should be consulted.
- Use only manufacturer authorized parts. User assumes all risks and liabilities when using parts

that do not meet the minimum specifications and safety requirements of the pump manufacturer.

- Before each use, check all hoses for cuts, leaks, abrasion or bulging of cover. Check for damage or movement of couplings. Immediately replace the hose if any of these conditions exist. Never repair a paint hose. Replace it with another grounded high-pressure hose.
- All hoses and fittings must be secured before operating spray pump. Unsecured parts can eject at great force or leak a high pressure fluid stream causing severe injury.
- All hoses, swivels, guns, and accessories must be pressure rated at or above 2800 PSI/193 BAR.
- Do not spray outdoors on windy days.
- Wear clothing to keep paint off skin and hair.
- Do not operate or spray near children. Keep children away from the equipment at all times.
- Do not overreach or stand on an unstable support. Keep effective footing and balance at all times.
- Stay alert and watch what you are doing.
- Do not operate the unit when fatigued or under the influence of drugs or alcohol.

## IMPORTANT ELECTRICAL INFORMATION NOTICE

Use only a 3-wire extension cord that has a 3-blade grounding plug and a 3-slot receptacle that will accept the plug on the product. Make sure your extension cord is in good condition. When using an extension cord, be sure to use one heavy enough to carry the current your product will draw. An undersized cord will cause a drop in line voltage resulting in loss of power and overheating. A 14 or 12 gauge cord is recommended (see chart). If an extension cord is to be used outdoors, it must be marked with the suffix W-A after the cord type designation. For example, a designation of SJTW-A would indicate that the cord would be appropriate for outdoor use.

### Wagner Spray Tech accessory extension cords recommended:

- P/N 0090241 20 foot extension cord.
- P/N 0090242 35 foot extension cord.

Cord gauge	Maximum cord length
12	150 feet
14	100 feet

**Do not use more than 50 feet of spray hose. If you need to spray further than 50 feet from your power source, use more extension cord, not more spray hose.**

### Grounding Instructions

This product must be grounded. In the event of an electrical short circuit, grounding reduces the risk of electric shock by providing an escape wire for the electric current. This product is equipped with a cord having a grounding wire with an appropriate grounding plug. The plug must be plugged into an outlet that is properly installed and grounded in accordance with all local codes and ordinances.

**WARNING - Improper installation of the grounding plug can result in a risk of electric shock.**



If repair or replacement of the cord or plug is necessary, do not connect the green grounding wire to either flat blade terminal. The wire with insulation having a green outer surface with or without yellow stripes is the grounding wire and must be connected to the grounding pin.

Check with a qualified electrician or serviceman if the grounding instructions are not completely understood, or if you are in doubt as to whether the product is properly grounded. Do not modify the plug provided. If the plug will not fit the outlet, have the proper outlet installed by a qualified electrician.

This product is for use on a nominal 120 volt circuit and has a grounding plug that looks like the plug illustrated below. Make sure that the product is connected to an outlet having the same configuration as the plug. No adapter should be used with this product.

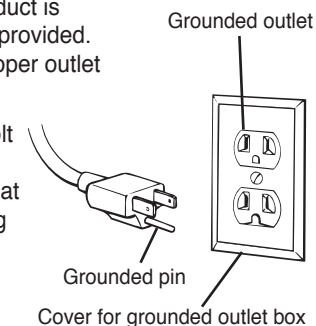

**If you experience problems with your sprayer at any time during assembly, operation, or cleanup, please refer to the Troubleshooting section of this manual (page 22), or call customer service at: 1-800-328-8251**

# What's in the Box?

## The Spray Gun

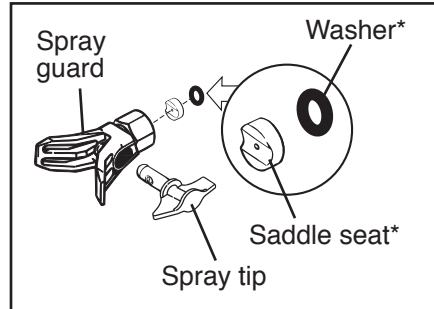

\* Saddle seat and washer come pre-assembled inside spray guard

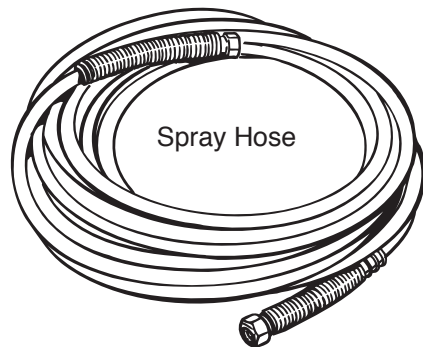
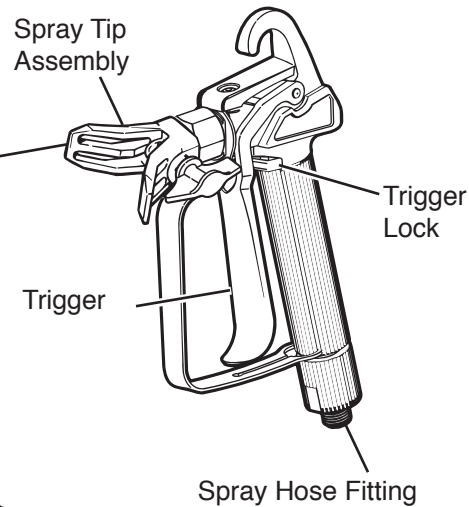

## The Paint Crew

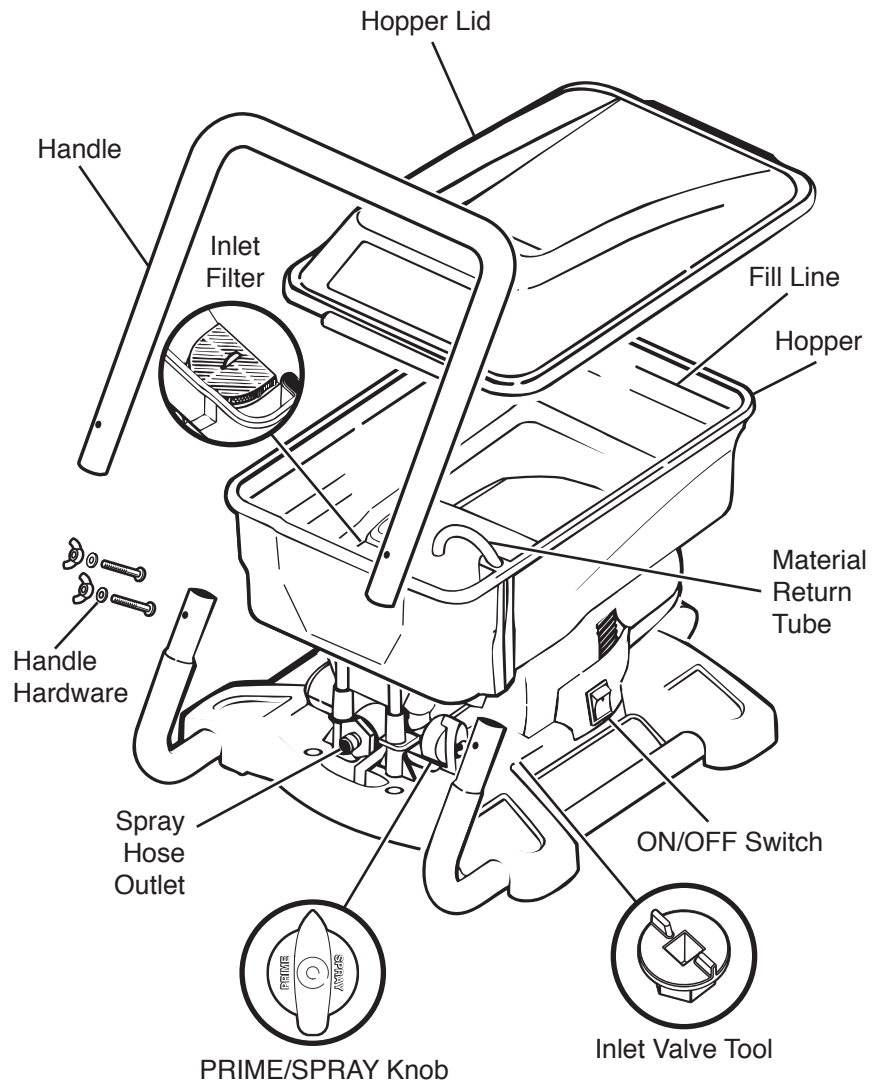

## Questions?

Call Wagner Technical Service

**1-800-328-8251**

Register your product online at:  
[www.wagnerspraytech.com](http://www.wagnerspraytech.com)

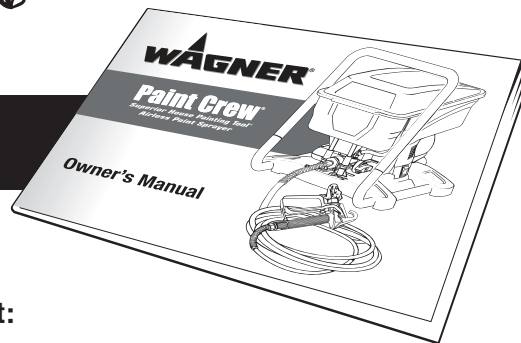



# Assemble Your Wagner Paint Crew

## Start 1 What you'll need

- Phillips screwdriver
- Wrench (2)

**Note:** Do not plug in the power cord until assembly is complete.

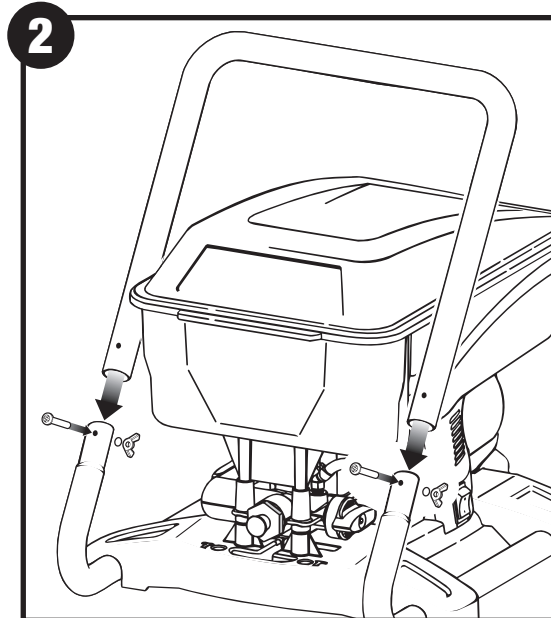
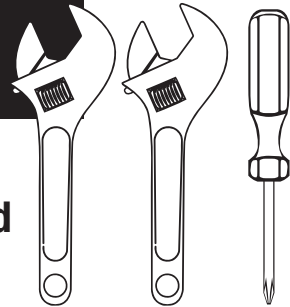

2. Insert handle

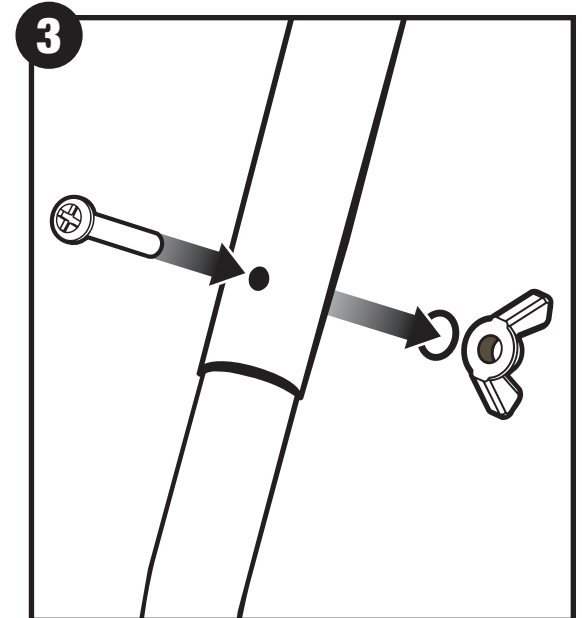

3. On each side of the handle install bolt and tighten wing nut over lock washer

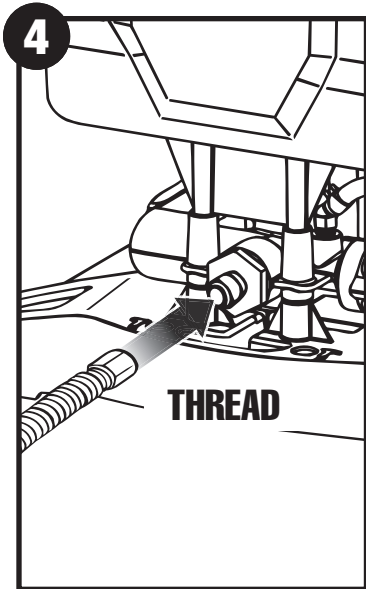

4. Thread one end of spray hose to outlet valve on sprayer

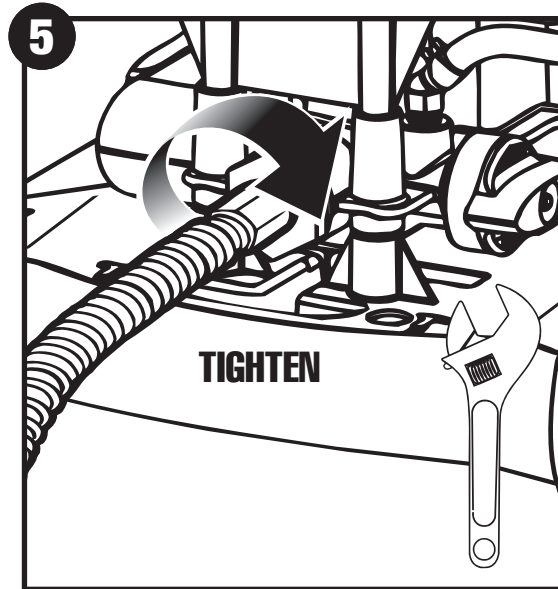

5. Tighten with wrench

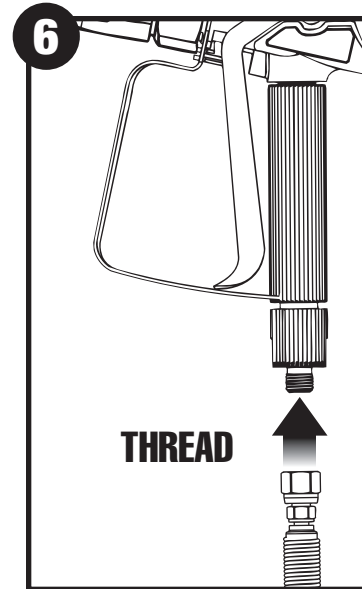

6. Thread other end of spray hose to spray gun

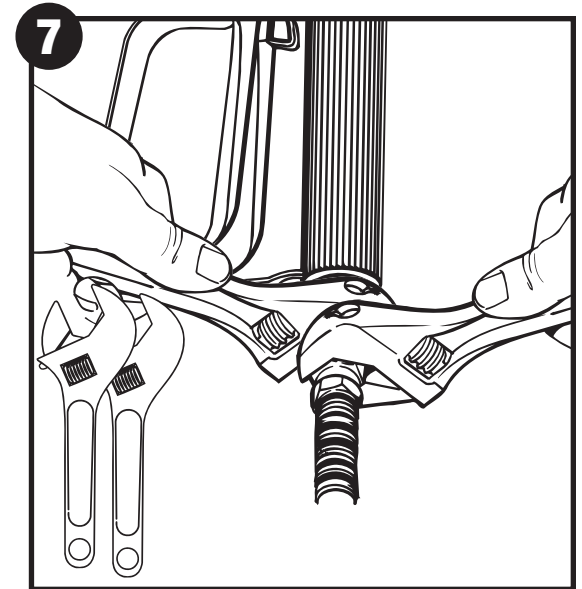

7. Hold spray gun with one wrench and tighten hose nut with other wrench

# Proper Use and Functions

## Specifications

- Weight .....25 lbs
- Capacity .....2 gallon hopper
- Power source ..... ½ Hp universal motor
- Power requirement..... 15 amp minimum circuit on 120 VAC, 60 Hz current
- Generator .....8000 Watt
- Max. spraying pressure .....2800 PSI

## Controls and Functions



**ON/OFF Switch:** The ON/OFF switch turns power to sprayer on and off (O=OFF,I=ON)

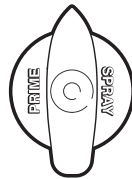

**PRIME/SPRAY Knob:** The PRIME/SPRAY knob directs material to the material return tube when set to PRIME (figure A) or to spray hose when set to SPRAY (figure B)



**Spray Hose:** The spray hose connects the spray gun to the pump



**Spray Gun:** The spray gun controls the delivery of material being pumped

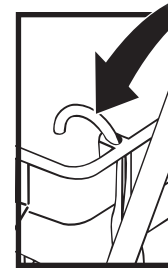
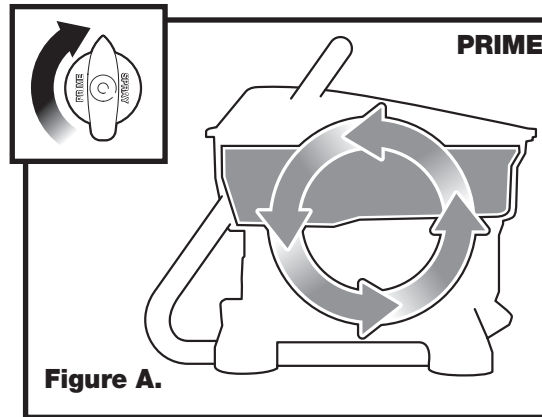

**Material Return Tube:** Fluid is sent back out through the return tube and into the hopper when the PRIME/SPRAY knob is in the PRIME position

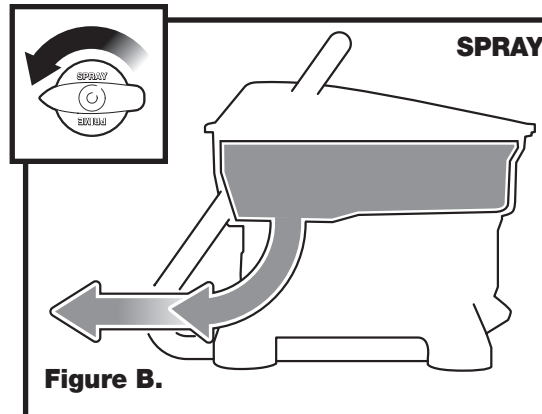

## Capability

Sprays a variety of paints (oil-based and latex), primers, stains, preservatives and other nonabrasive materials. Do not use materials with flash points below 70° F (21° C)

## Do not use!

This pump should not be used with textured materials, block filler, lacquers, industrial enamels, or asphalt sealer or materials containing HHC. See coating supplier if flash point is not listed on the container

## Safety features

Spray gun trigger lock and pressure diffuser; built-in tip safety guard; PRIME/SPRAY knob for safe pressure release. Conforms to ULSTD 1450. Certified to CAN/CSAC 22.2 NO 68-92

# Pressure Relief Procedure\*

\* Perform when instructed

## Start 1 What you'll need

- Waste bucket



Be sure to follow the Pressure Relief Procedure when shutting the unit off for any purpose. This procedure is used to relieve pressure from the spray hose. Failure to do so could result in serious injury.

## Important Safety Warning



Be careful when handling the spray gun so you don't accidentally spray yourself. The high pressure paint stream could pierce your skin causing serious injury. If an accident happens see detail procedures in the Safety Information section on pages 4-5. See physician immediately and bring this instruction manual.

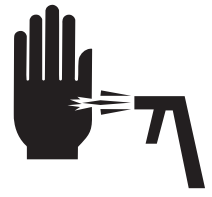

2. Lock spray gun

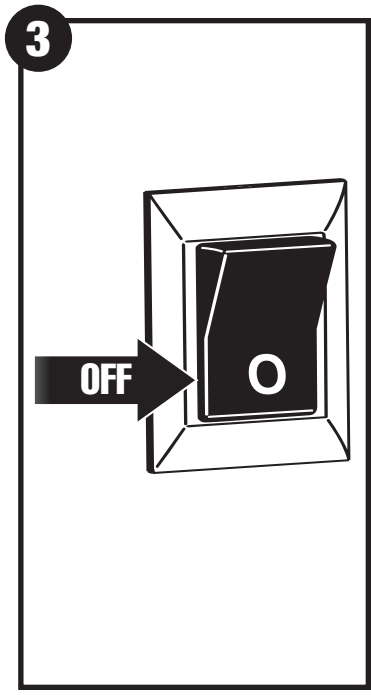

3. Turn power **OFF**

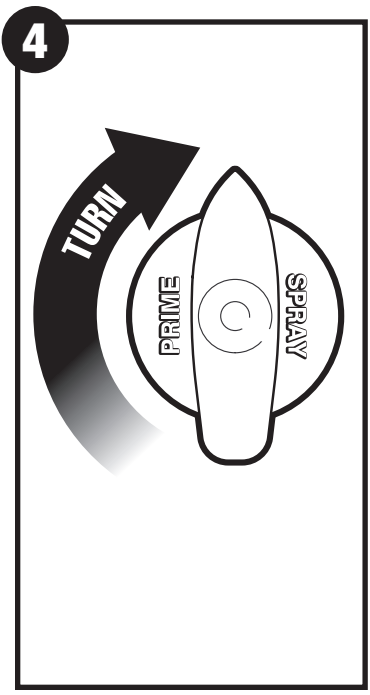

4. Turn knob to **PRIME**

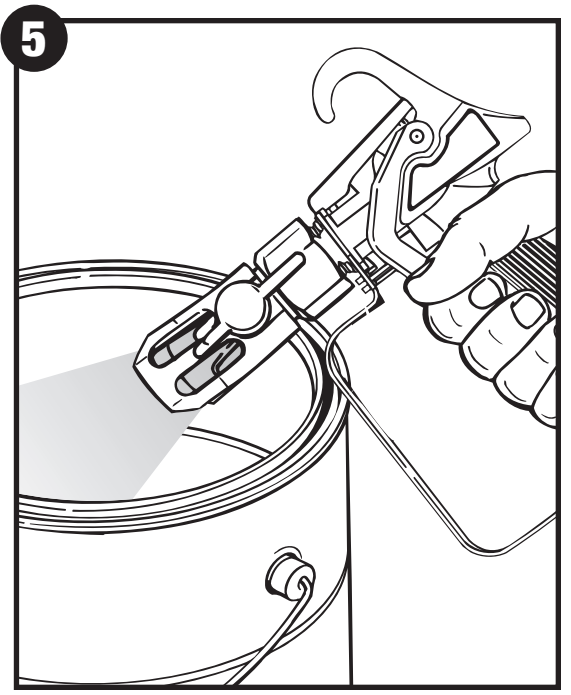

5. Unlock spray gun. Spray into a waste bucket until pressure is relieved. Lock the spray gun

# 1. Load Material



Start

## 1 What you'll need

- The material you plan to spray
- Extension cord
- Waste container

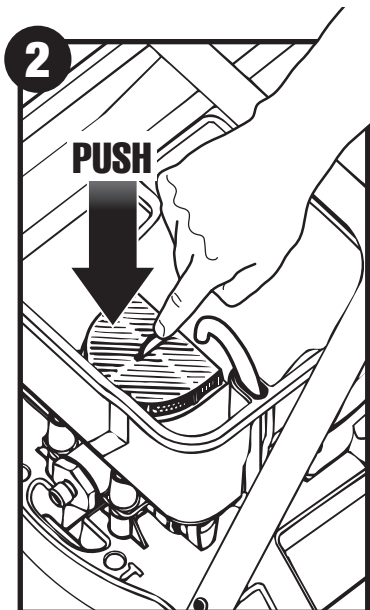

**2.** Push tab on filter twice to test inlet valve operation

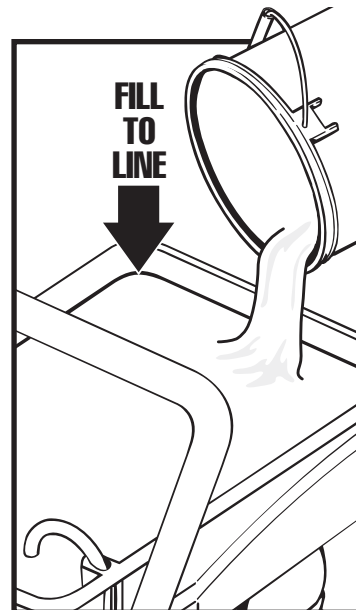

**3.** Fill hopper **TIP:** If material is old, strain when pouring into hopper to help prevent clogging when spraying

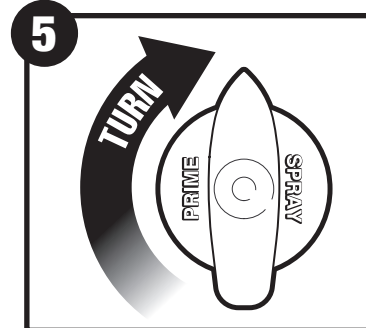
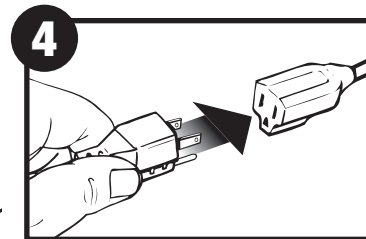

**4.** Plug in sprayer  
**5.** Turn knob to **PRIME**

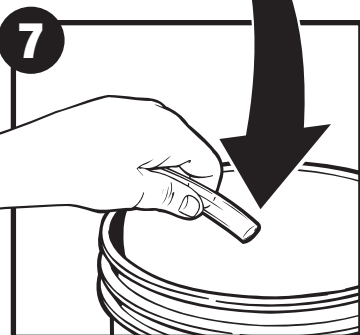
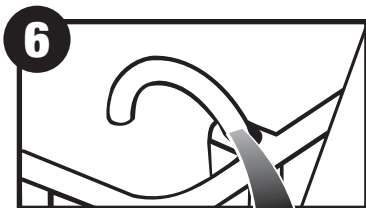

**6.** Remove material return tube from hopper  
**7.** Hold tube over waste container

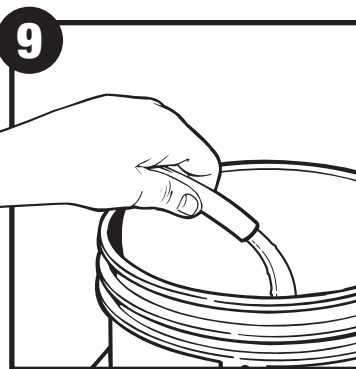
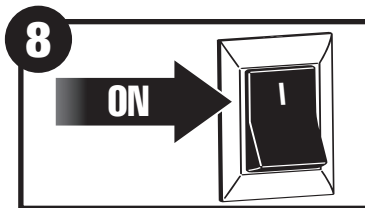

**8.** Turn power **ON**  
**9.** Steady flow for 5 seconds

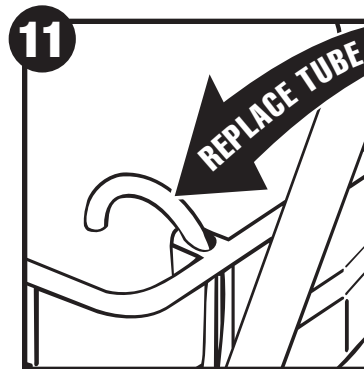
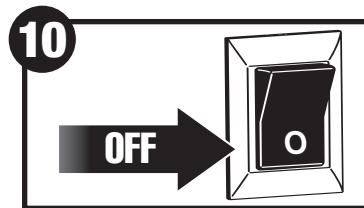

**10.** Turn power **OFF**  
**11.** Snap return tube back in place

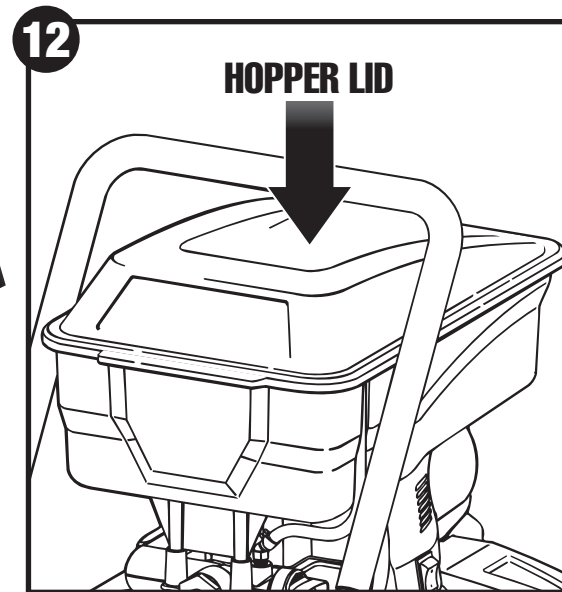

**12.** Place hopper lid on



## 2. Getting Material to Flow Prior to Spraying

Start

### 1 What you'll need

- Scrap material/cardboard
- Drop cloths to protect floors and furnishings from overspray

### Special Note

Don't let the hopper run empty. If the hopper runs empty go to page 8 "Load Material" and page 9 "Getting Material to Flow" and follow the steps as shown

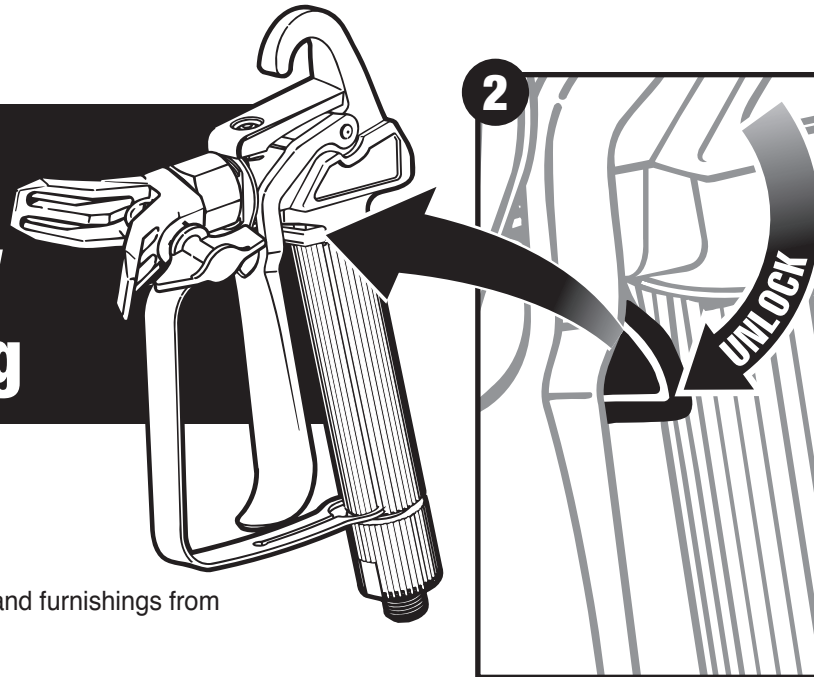

2. Unlock spray gun by turning trigger lock down

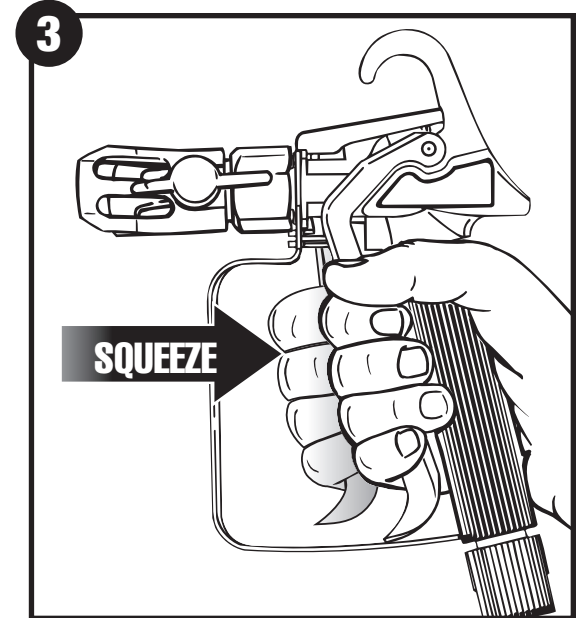

3. Point spray gun at piece of scrap material/cardboard. Squeeze and hold trigger for steps 4-6

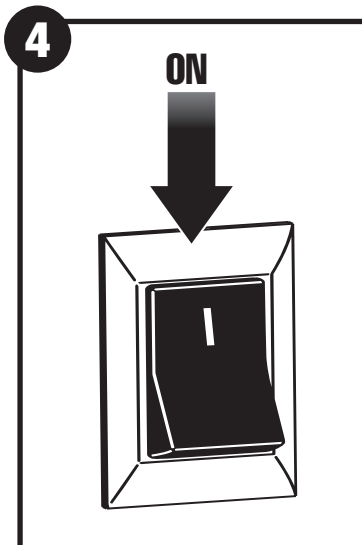

4. Turn power **ON**

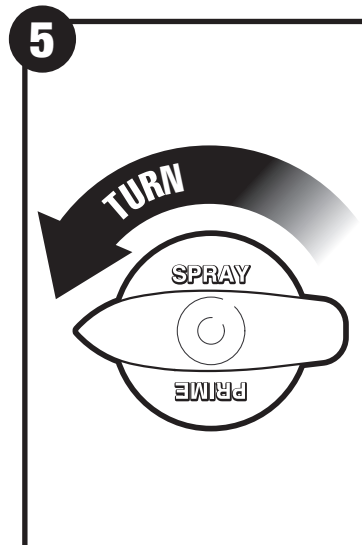

5. Turn knob to **SPRAY**

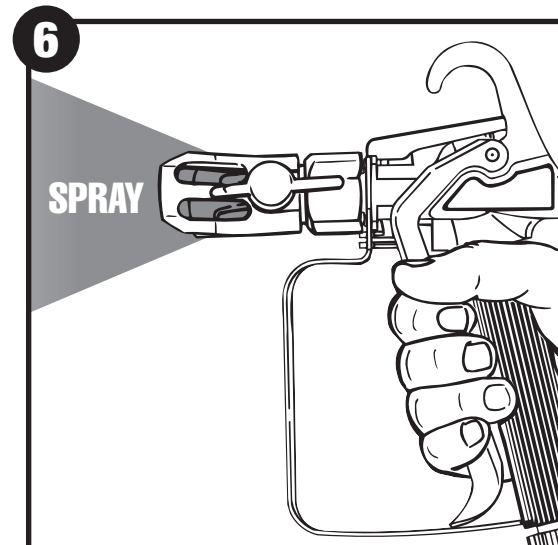

6. Continue to squeeze trigger until the material is flowing freely through spray gun

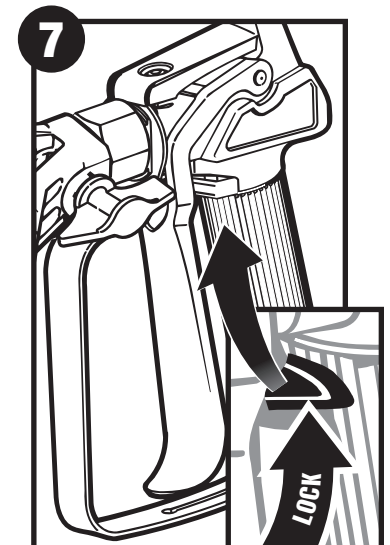

7. Release trigger and lock spray gun

# 3. Practice Spraying

Start

## 1 What you'll need

- Scrap material/cardboard

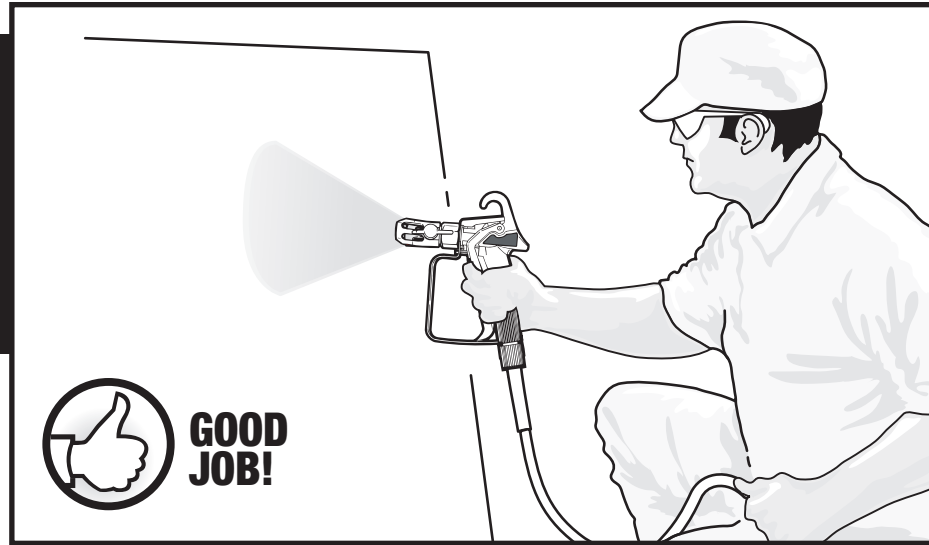

Practice on a piece of scrap material/cardboard

### Tip:

Trigger gun after starting the stroke. Release the trigger before ending the stroke. The spray gun should be moving when the trigger is pulled and released. Overlap each stroke by about 30%. This will ensure an even coating.

## Hold the Spray Gun Level

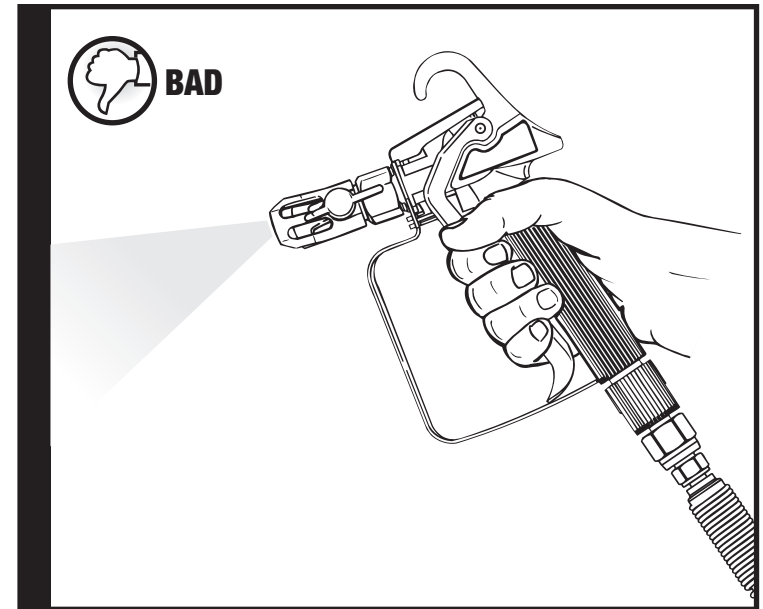
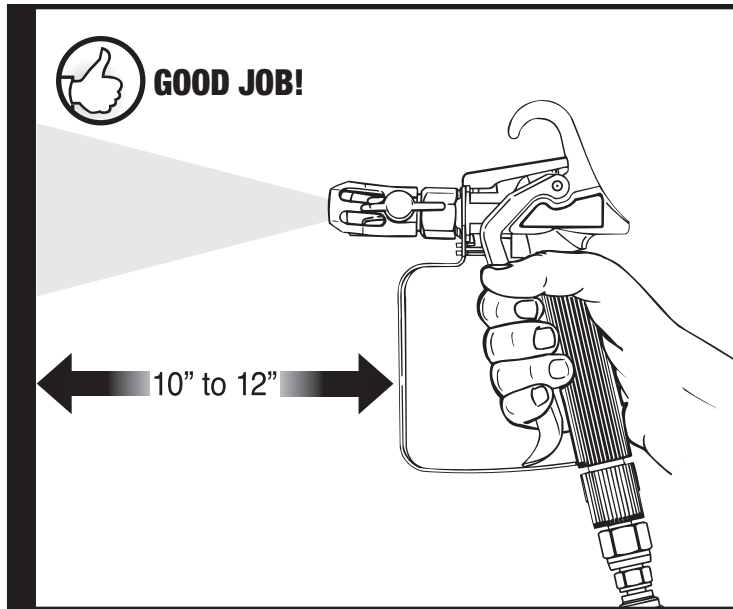

### Spray Technique

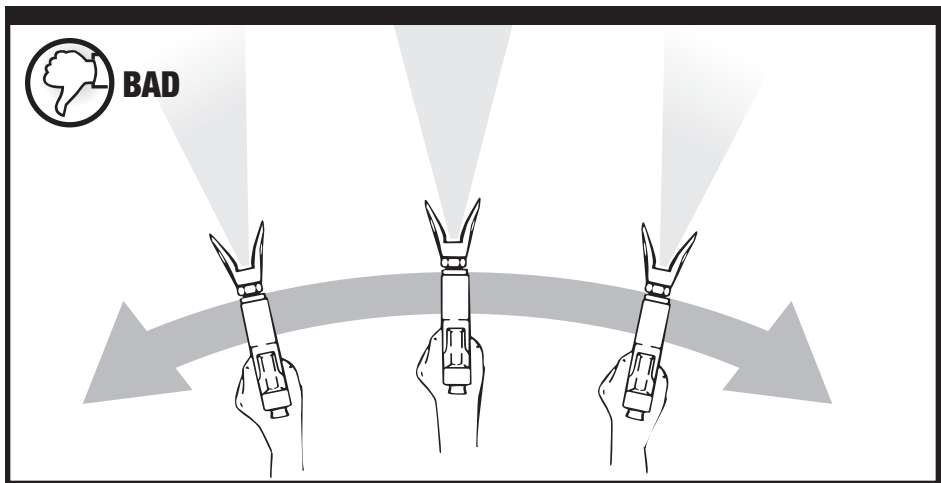
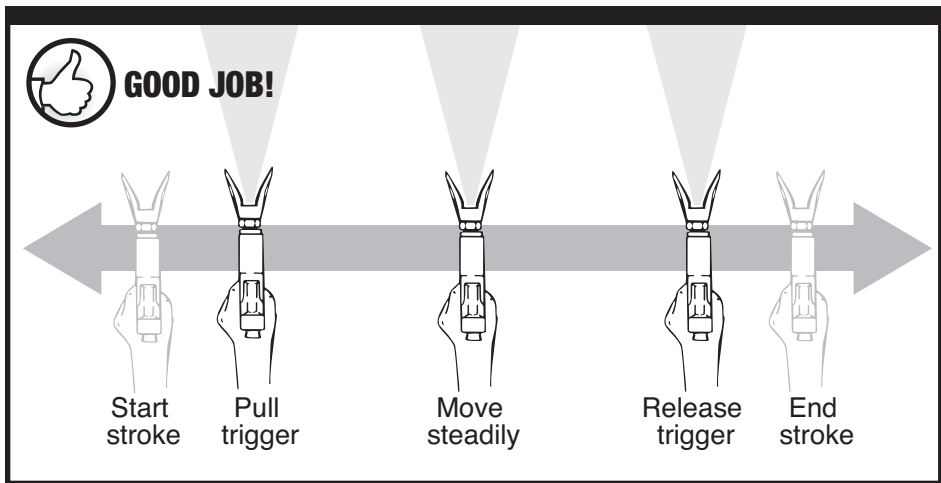

### Spray Pattern

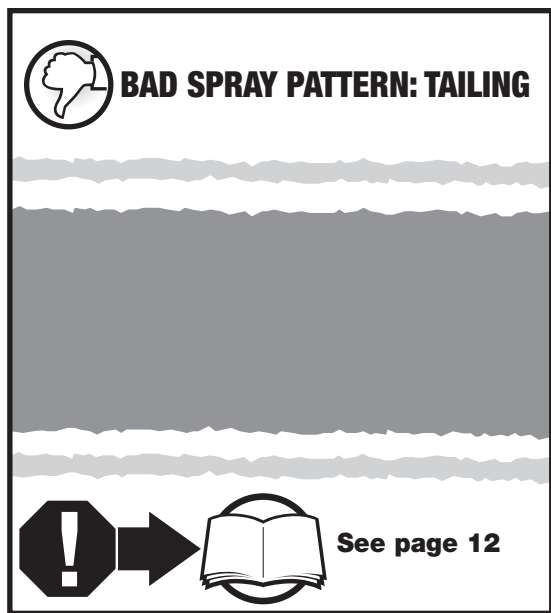
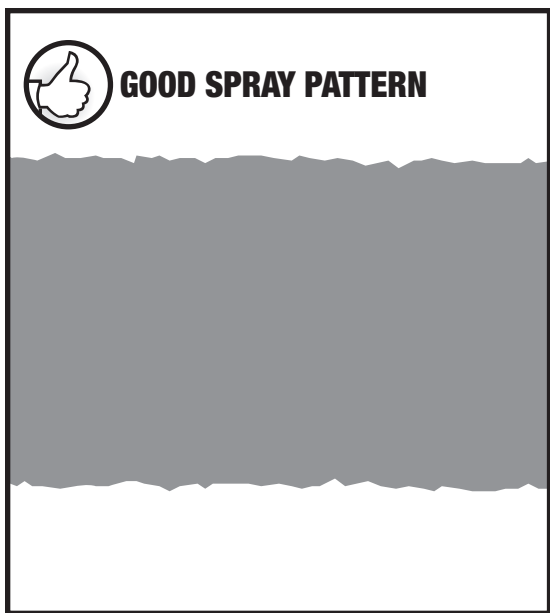

### Overlap Your Strokes

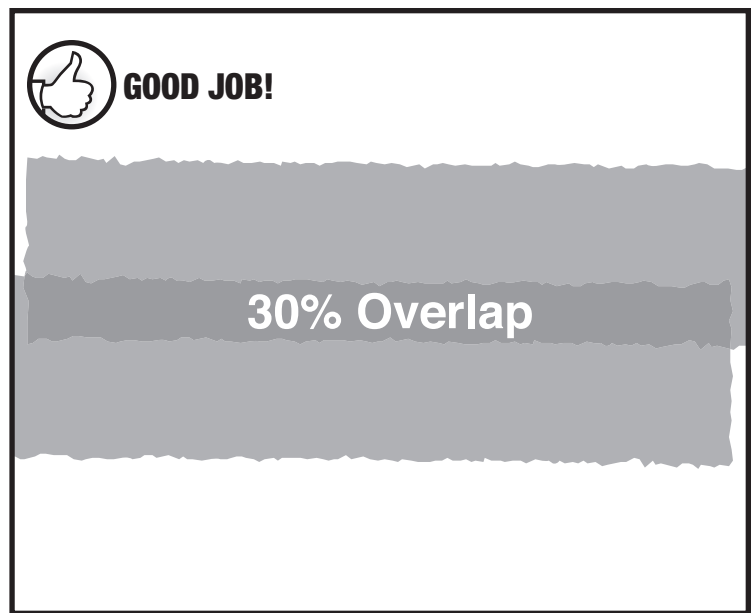

# Common Solutions to Spraying Issues

## Keep material flowing smoothly while spraying

Straining material when loading hopper helps minimize clogging

If experiencing issues with spray patterns or if material isn't flowing smoothly follow instructions to clear the following:

### Spray Tip

If using thicker material the tip may become clogged. Follow Clear the Spray Tip Instructions on page 13

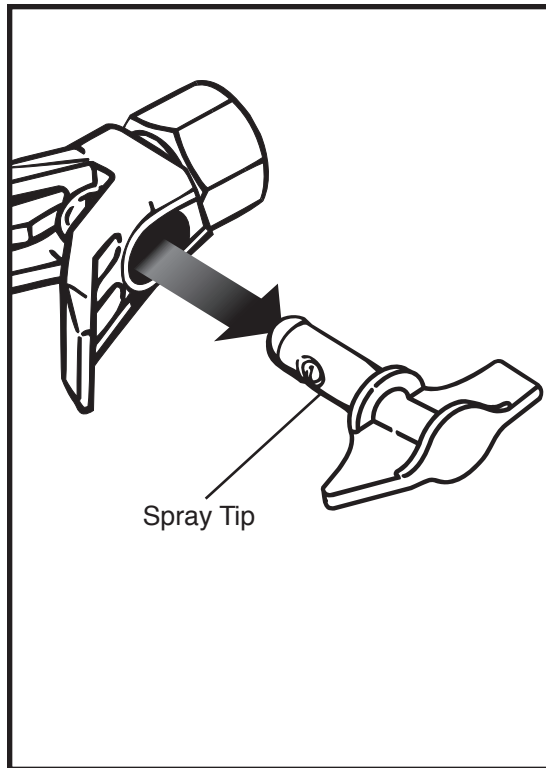

### Inlet Filter

The inlet filter located in the hopper is more likely to clog with thick material or if something like a leaf gets in the hopper, follow Clean the Inlet Filter instructions on page 14

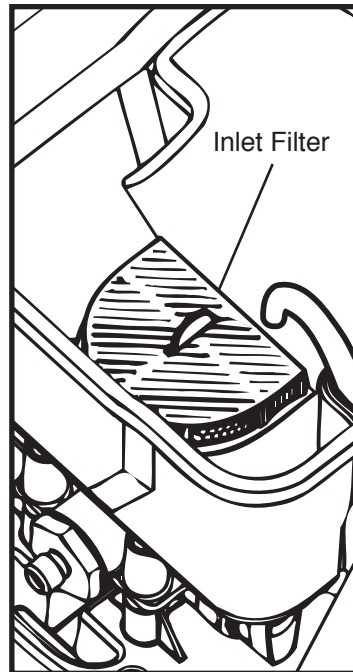

### Spray Gun Filter

When using thicker material the filter may become clogged follow Clean the Spray Gun Filter instructions on page 15

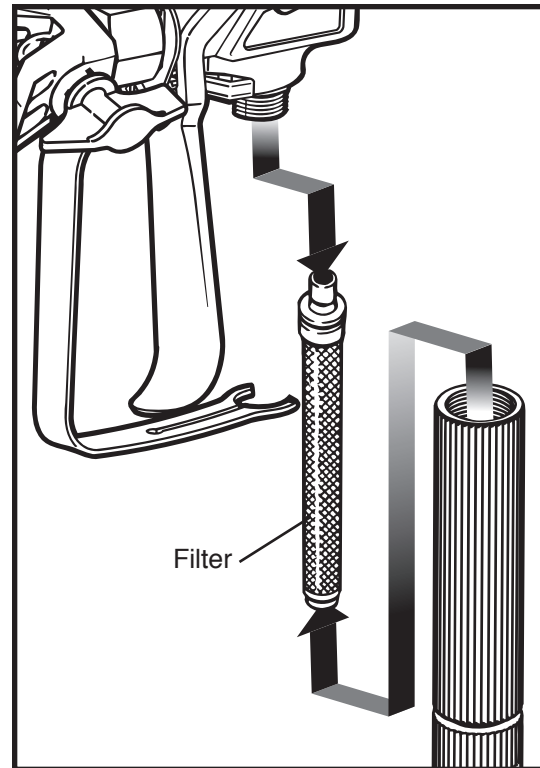

If material isn't flowing properly after clearing these things see additional instructions in the Fix Spraying Problems section

Page 22



# Clear the Spray Tip



**Start** **1** What you'll need

- Scrap material/cardboard



Do not attempt to unclog or clean the tip with your finger. High pressure fluid can cause injection injury.

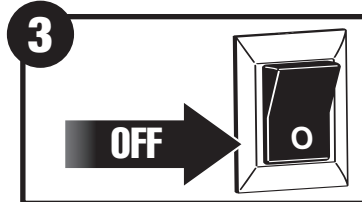
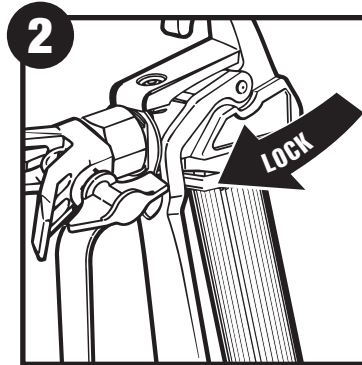

- 2.** Release trigger and lock spray gun  
**3.** Turn power **OFF**

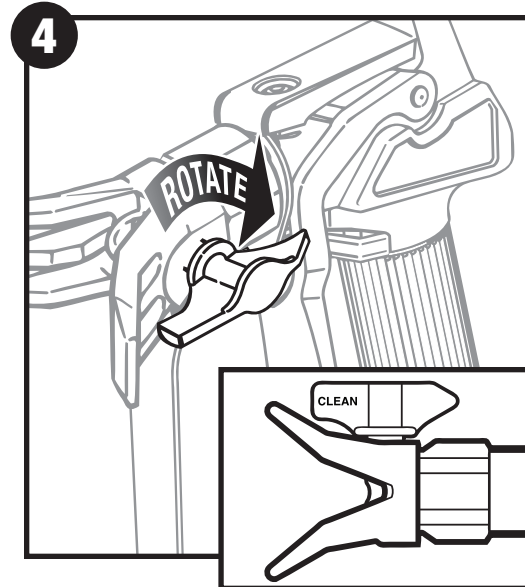

- 4.** Rotate reversible spray tip 180 degrees to **CLEAN** position (arrow pointing toward rear of spray gun)

**Note:** If spray tip is difficult to rotate relieve pressure by turning **PRIME/SPRAY** knob to **PRIME** and squeeze trigger while pointing at scrap material/cardboard. Release trigger and try rotating spray tip again

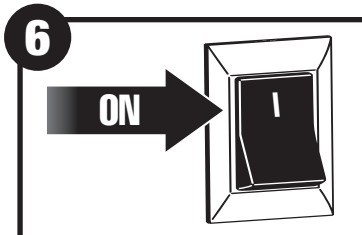
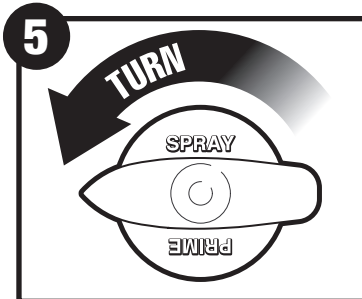

- 5.** Turn knob to **SPRAY**  
**6.** Turn power **ON**



- 7.** Unlock spray gun

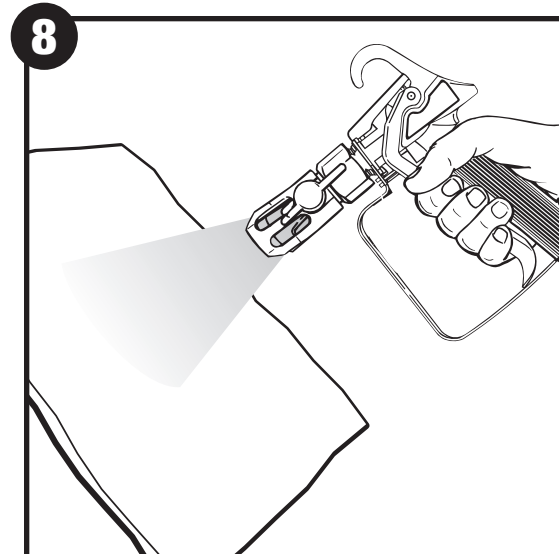

- 8.** Point at scrap material/cardboard and squeeze trigger until material comes out in a high pressure stream. Release trigger and lock spray gun

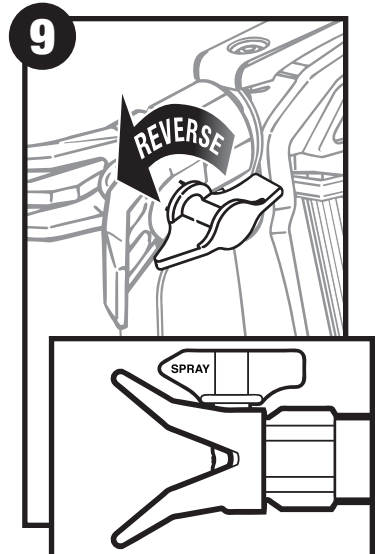

- 9.** Reverse spray tip so arrow points forward and resume spraying



## Clean the Inlet Filter



**IMPORTANT:** Never clean filter by poking with sharp object.



### Start **1** What you'll need

- Original material container
- Warm, soapy water for latex material
- Mineral spirits for oil based materials

### **2** Perform Pressure Relief Procedure

Page 7

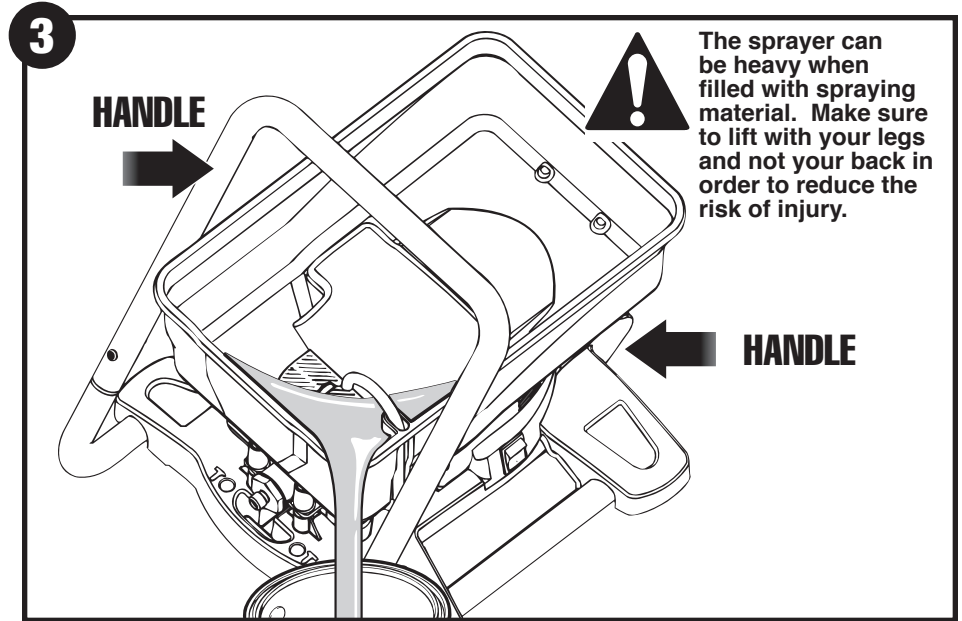

**3.** Empty material from hopper into original material container

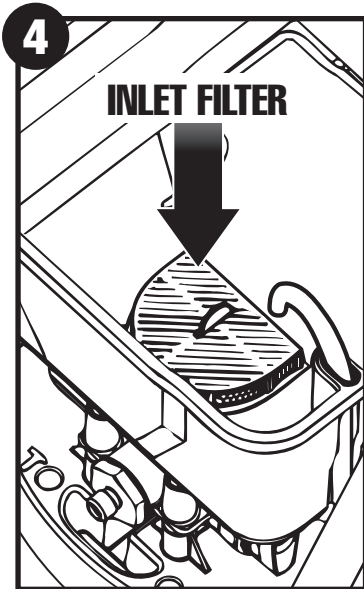

**4.** Remove inlet filter from hopper

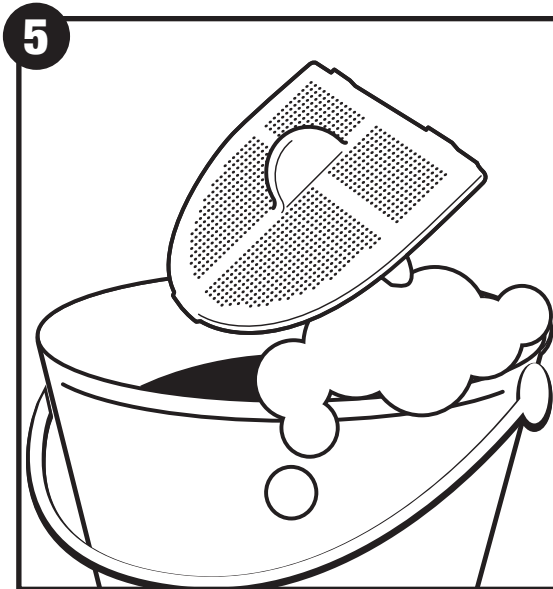

**5.** Clean inlet filter using appropriate cleaning solution; warm, soapy water for latex material and mineral spirits for oil based materials

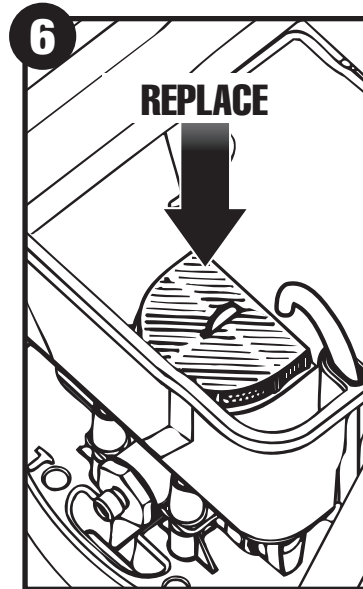

**6.** Replace inlet filter

**7.** To resume painting follow: **Load Material and Get Material to Flow instructions**

Page 8-9



# Clean the Spray Gun Filter

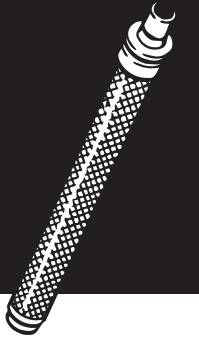

**IMPORTANT:** Never clean filter by poking with sharp object.



## Start 1 What you'll need

- Wrench
- Warm, soapy water for latex material
- Mineral spirits for oil based materials
- Replacement spray gun filter (if necessary)

## 2 Perform Pressure Relief Procedure

Page 7



## Tips if Experiencing Spray Issues

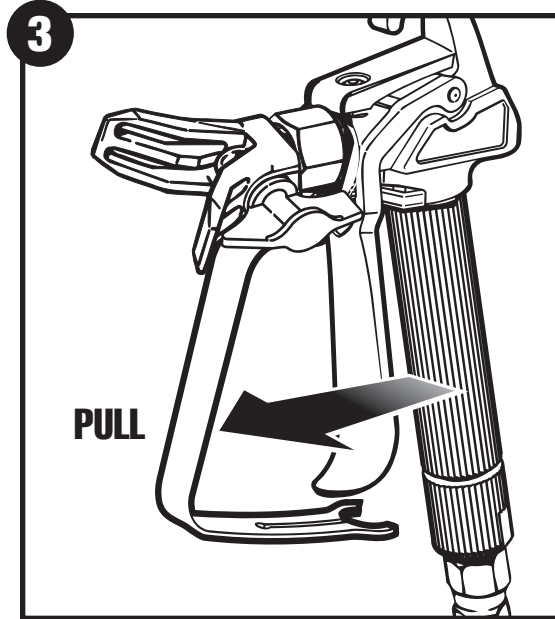

3. Pull trigger guard to separate from filter housing

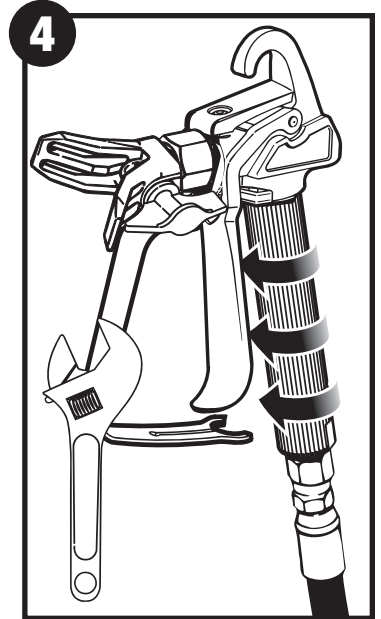

4. Unscrew filter housing using a wrench

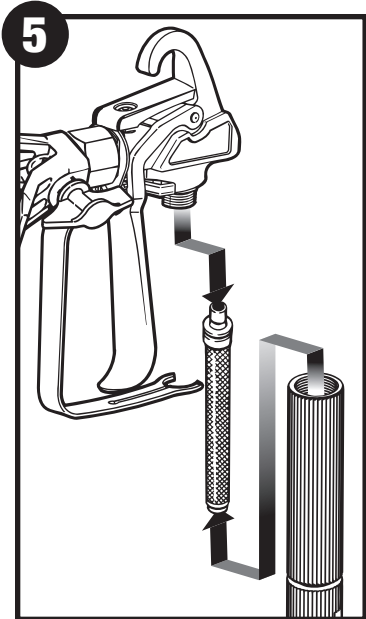

5. Remove filter from housing

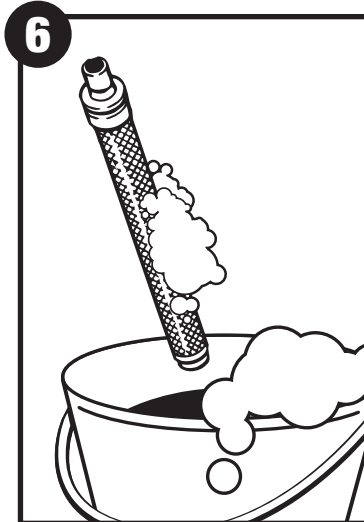

6. Clean with appropriate cleaning solution for material being used; warm, soapy water for latex material and mineral spirits for oil based material

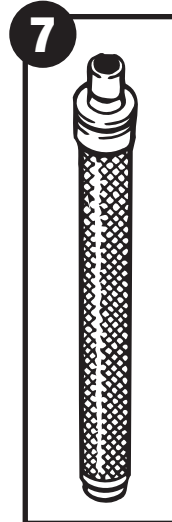

7. Inspect filter for damage and replace if rips are found

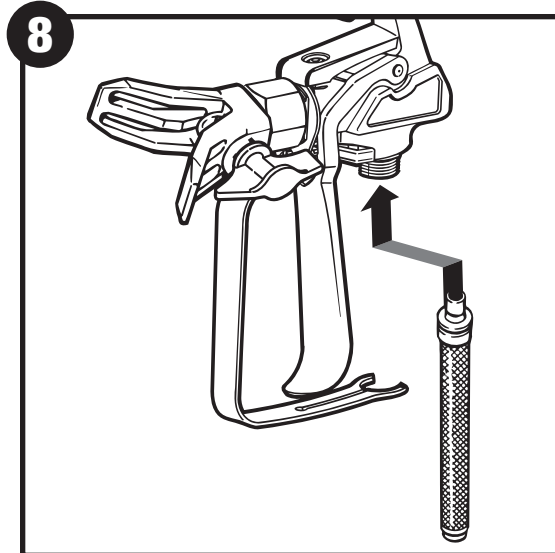

8. Replace cleaned filter, tapered end first, into gun housing. **Note:** It is important to place tapered end first to ensure proper sprayer operation

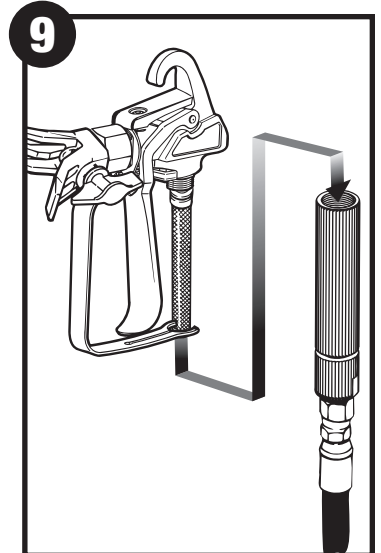

9. Reassemble spray gun

## Shut Down and Short Term Storage



or



Start

### 1 What you'll need

- Water
- Plastic bag or bucket
- Rags

### 2 Instructions are for latex material only

**Note:** If using oil based material follow instructions for Cleanup and Storage on **page 18**

This procedure should be used when taking a short term break or when ending your project for the day. If your break is longer than 16 hours follow instructions for Cleanup and Storage on **page 18**

### 3



**Perform Pressure Relief Procedure**

**Page 7**

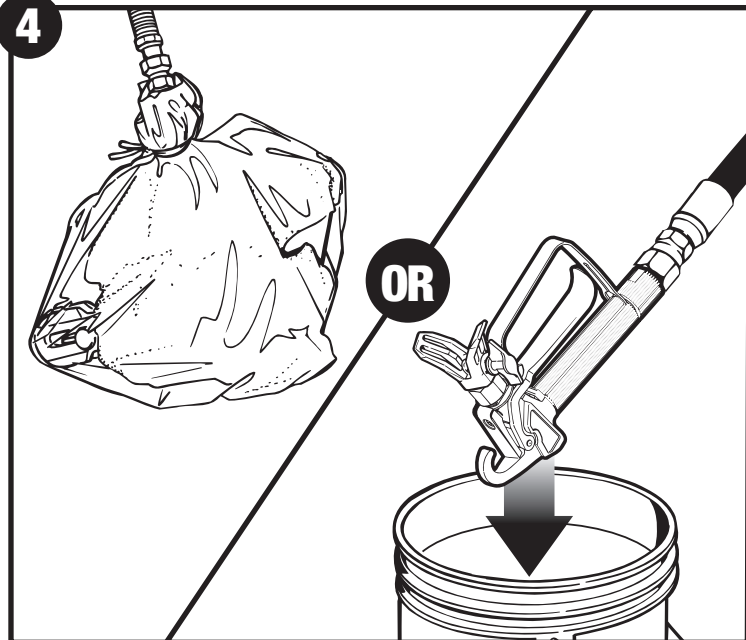

**4.** Place spray gun in plastic bag or immerse into bucket of water

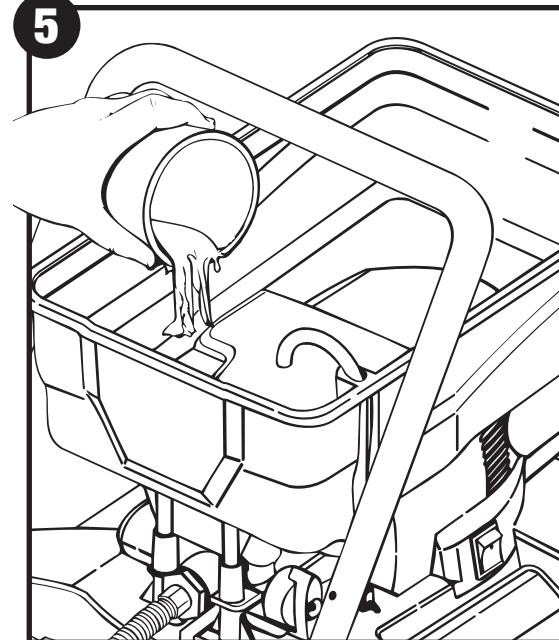

**5.** If your break is more than an hour slowly pour ½ cup of water or paint in hopper. This helps prevent paint from drying and causing possible clogs

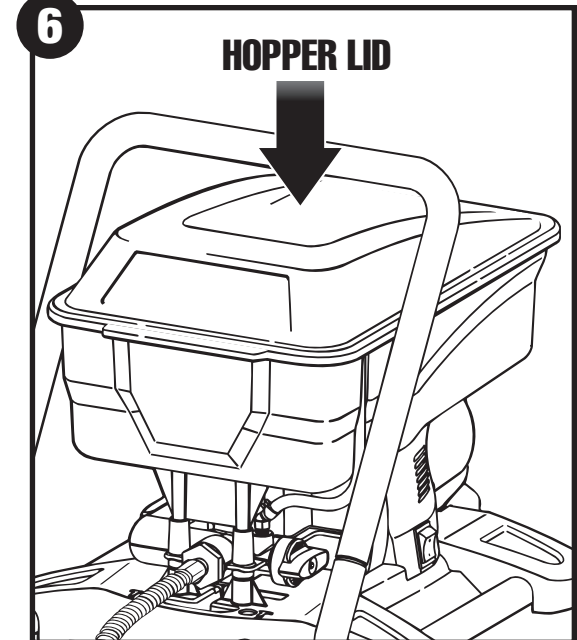

**6.** Place lid on hopper and keep sprayer out of sun

# Startup from Short Term Storage

- Start** **1** What you'll need
- Stir stick

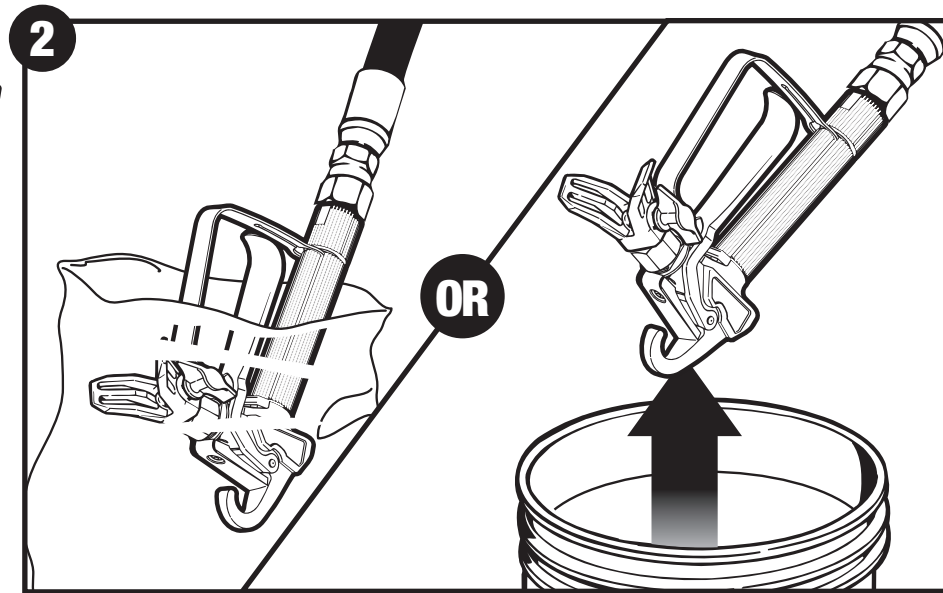

**2.** Remove spray gun from plastic bag or from bucket of water

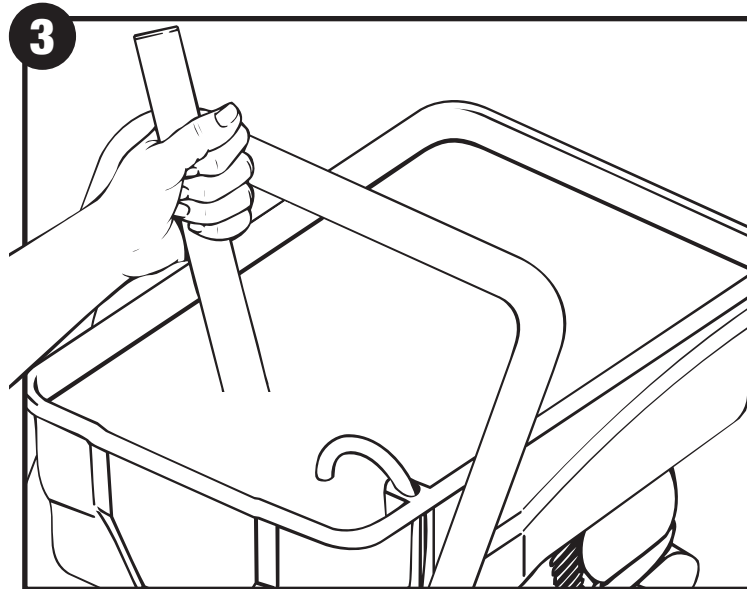

**3.** If water was added during shut down stir water into material

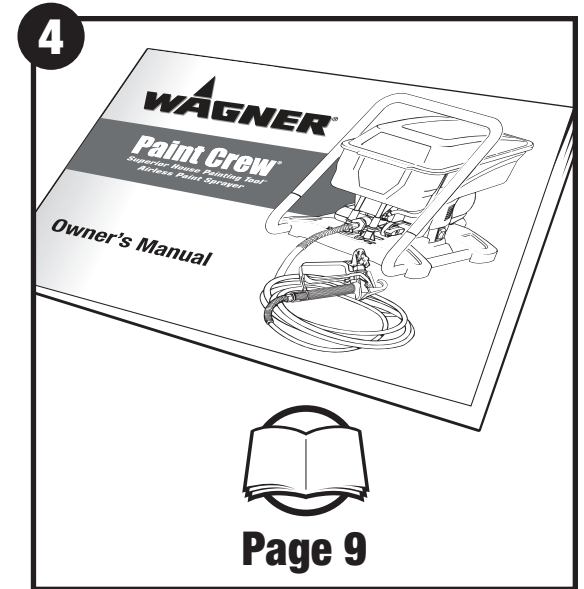

**4.** Steps for Getting Material to Flow (page 9)

## Flush Material From Sprayer



or



**Start**

### 1 What you'll need

- Warm, soapy water if using latex material
- Mineral spirits if using oil-based material
- Waste container

### 2 Cleaning Notes

- When using latex material, clean sprayer and components with warm, soapy water. For oil based material use mineral spirits. Never use mineral spirits with latex materials
- NEVER use gasoline to clean sprayer
- Dispose of used cleaning solution properly
- Thorough cleaning and lubrication of sprayer is important to ensure proper operation after storage
- If you flush your sprayer with mineral spirits, repeat Flush Material From Sprayer instructions using warm-soapy water



### 3 Perform Pressure Relief Procedure

Page 7

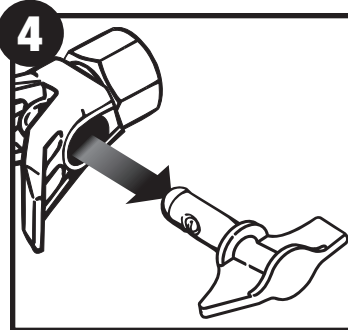

4. Remove spray tip and guard and place in cleaning solution

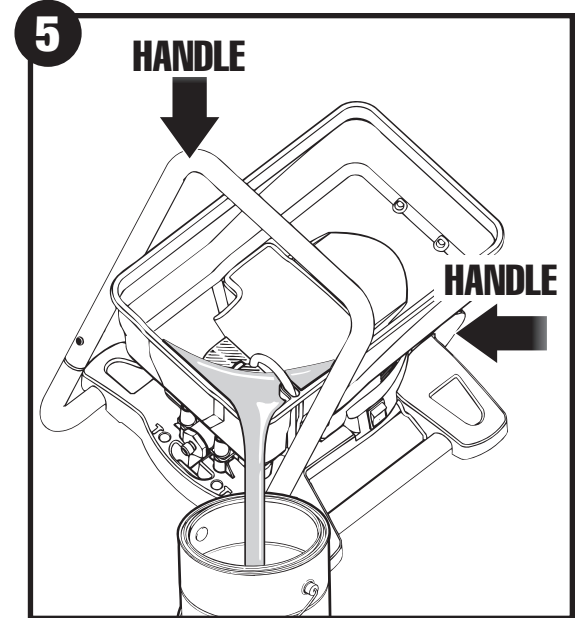

5. Empty material from hopper into original material container. **Make sure to lift with your legs and not your back to avoid injury.**



### Follow these steps whenever cleaning with mineral spirits:

- If spraying or cleaning with oil-based materials, the spray gun must be grounded while preparing the spray hose or cleaning.
- Ground the gun by holding it against the edge of a metal container while purging. Failure to do so may lead to a static electric discharge which may cause a fire
- Always flush spray gun at least one hose length from spray pump
- If collecting flushed solvent in one gallon metal container, place it into an empty five gallon container, then flush
- Area must be free from vapors
- Follow all cleanup instructions

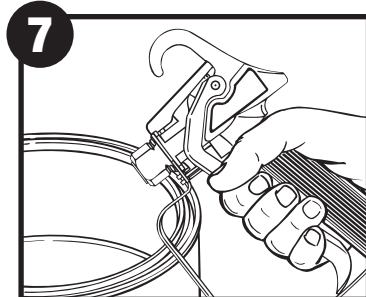
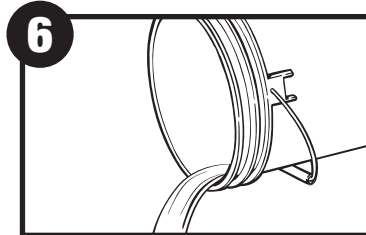

6. Fill hopper with appropriate cleaning solution  
7. Point spray gun at side of waste container

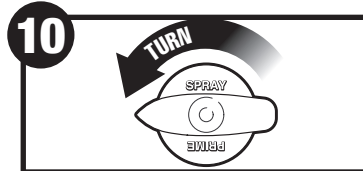
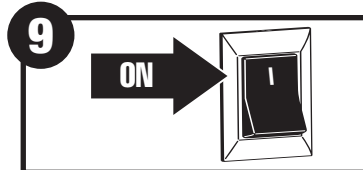
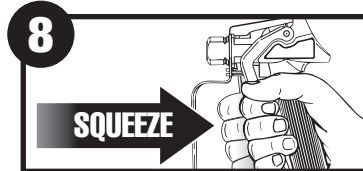

8. Squeeze trigger  
9. Turn power **ON**  
10. Turn knob to **SPRAY**

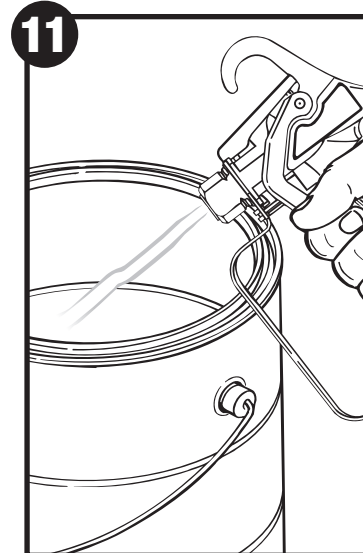

11. Continue squeezing trigger until fluid is coming out clear. Repeat as necessary

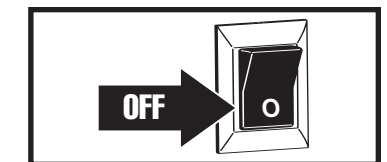
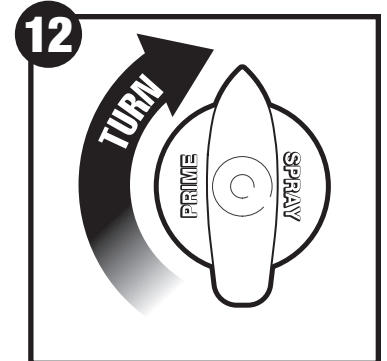

12. Turn knob to **PRIME** and squeeze trigger until pressure is relieved. Release trigger, lock spray gun, turn power **OFF**



# Clean the Hopper



or



## Start 1 What you'll need

- Warm, soapy water
- Mineral spirits if using oil-based material
- Rags



Do not allow any fluid to drip onto the motor housing.

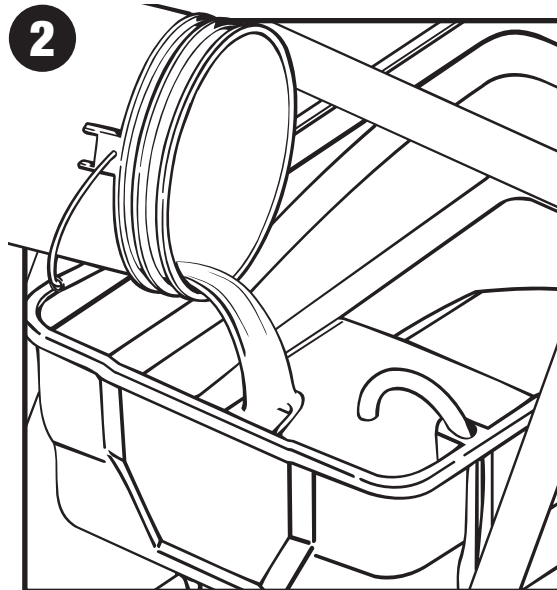

2. Rinse hopper with appropriate cleaning solution

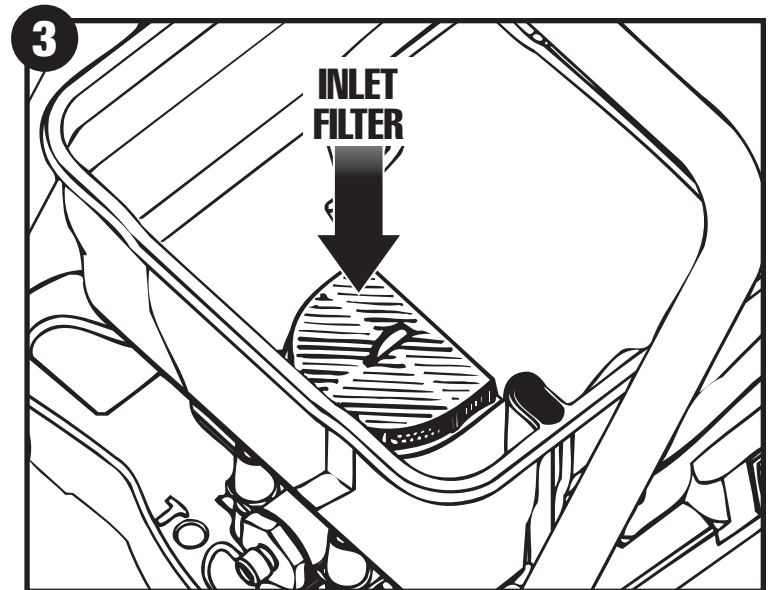

3. Remove inlet filter and clean with appropriate cleaning solution. Replace inlet filter in hopper

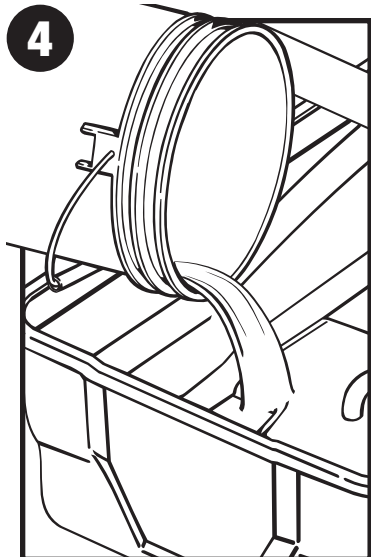

4. Partially fill hopper with NEW cleaning solution

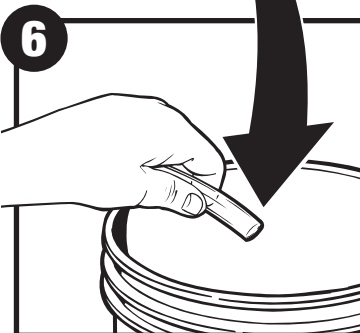
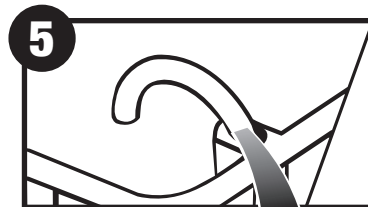

5. Remove material return tube from hopper  
6. Hold tube over waste container

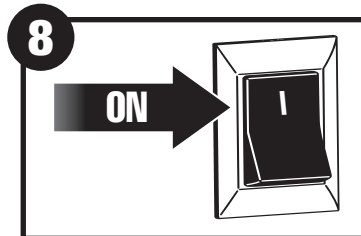
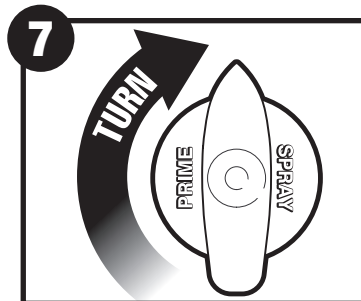

7. Turn knob to **PRIME**  
8. Turn power **ON**

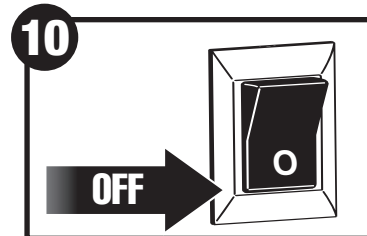

9. Hold material return tube over a waste container. Run for 2 to 3 minutes  
10. Turn power **OFF**

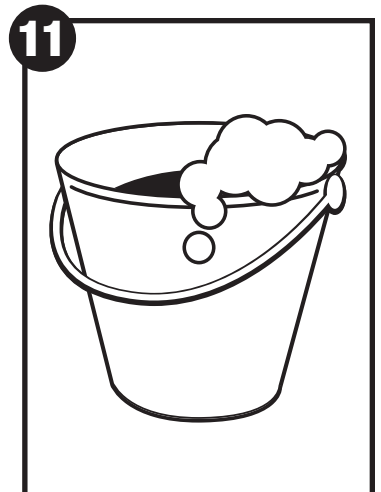

11. Properly dispose of cleaning solution in hopper  
**Note:** If mineral spirits were used to clean hopper repeat clean hopper instructions using warm, soapy water

## Clean Spray Gun Components



2



**Perform Pressure Relief Procedure**

Page 7



### Start 1 What you'll need

- Soft bristled brush
- Light household oil
- Warm, soapy water if using latex material
- Mineral spirits for oil based material
- Wrench

3

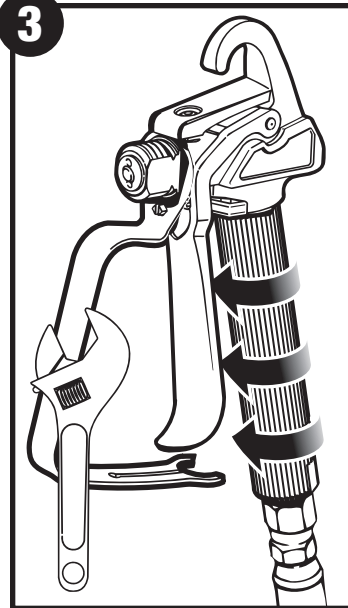

3. Pull trigger guard to separate from filter housing and unscrew housing using a wrench

4

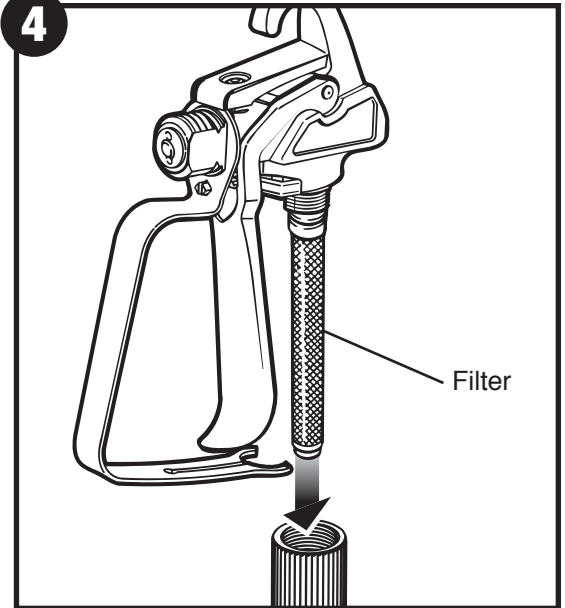

4. Remove filter from spray gun

5

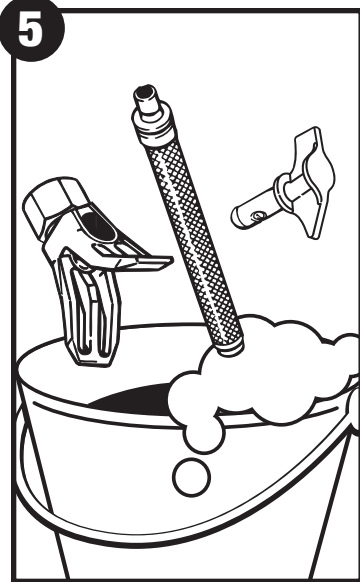

5. Clean spray tip and filter with soft bristled brush and appropriate cleaning solution

6

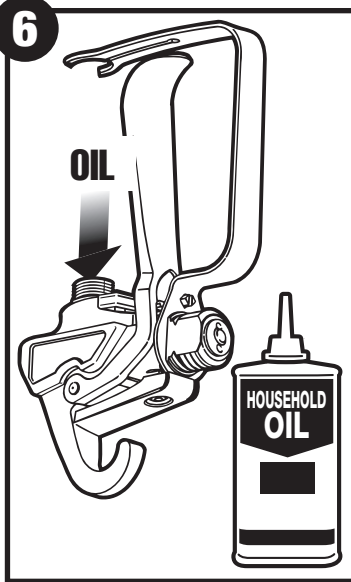

6. Pour a few drops of light household oil inside gun housing

7

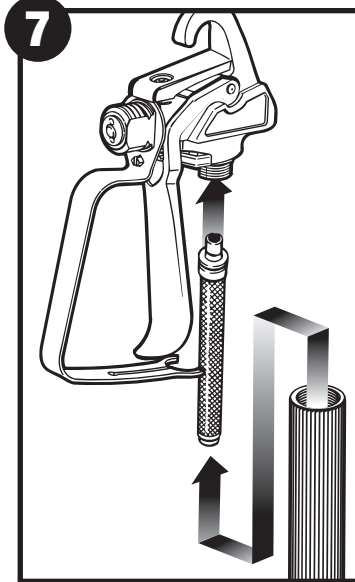

7. Install gun filter tapered-end first. Reassemble spray gun

8

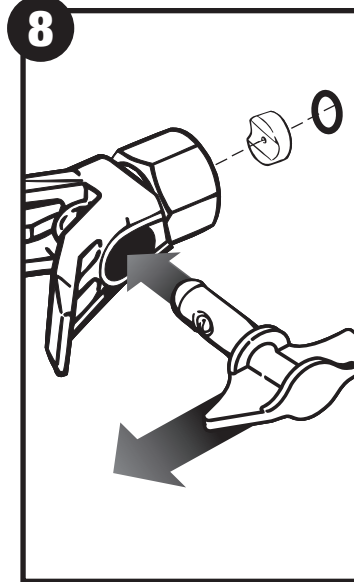

8. Install spray tip with arrow pointing towards front of spray gun tip

9

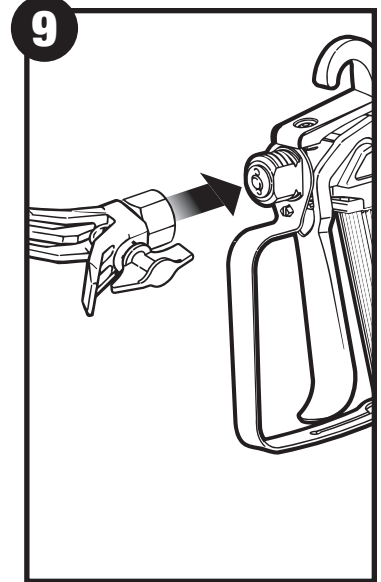

9. Install spray tip and guard assembly

# Long Term Storage



## Start 1 What you'll need

- Light household oil
- Rags

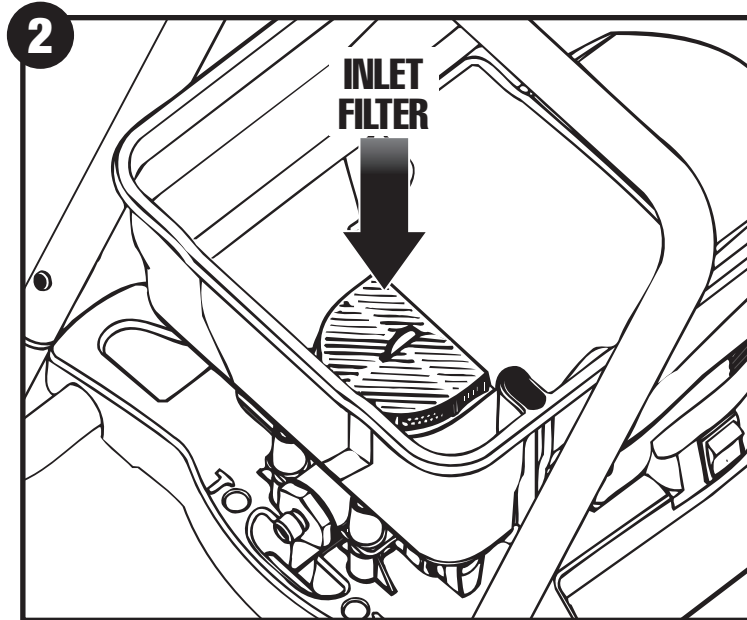

2. Remove inlet filter

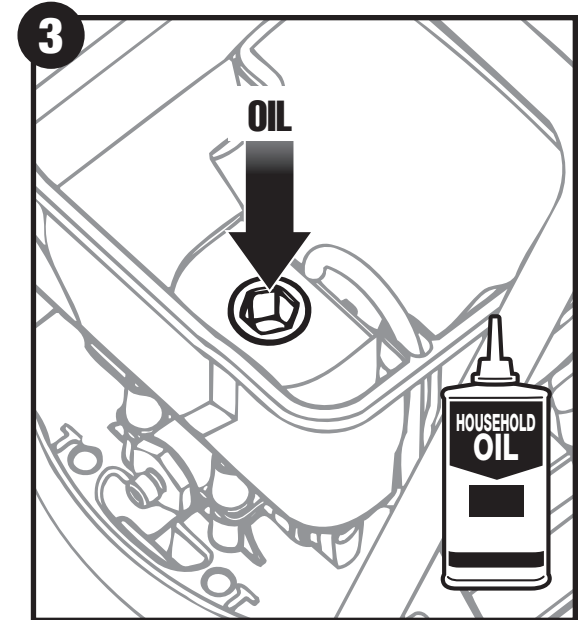

3. Pour approximately 2 ounces of light household oil into inlet valve

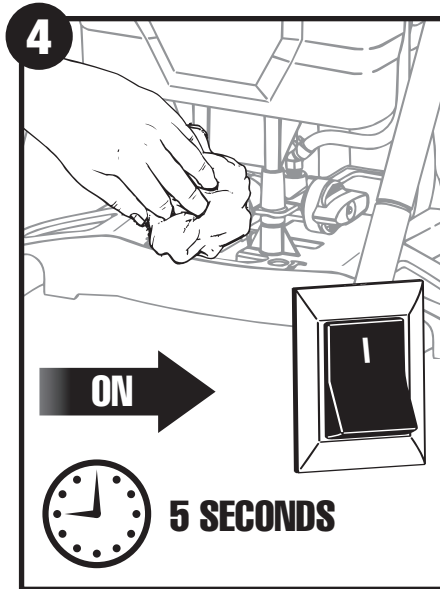

4. Cover outlet valve with a rag. Turn power **ON**. Let run for 5 seconds

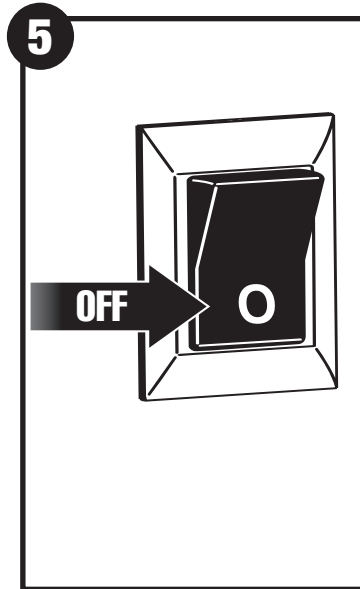

5. Turn power **OFF**

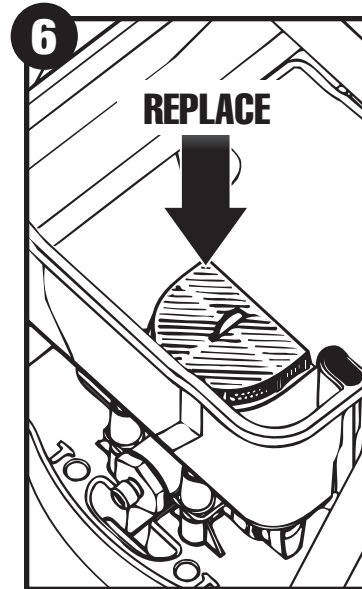

6. Replace inlet filter

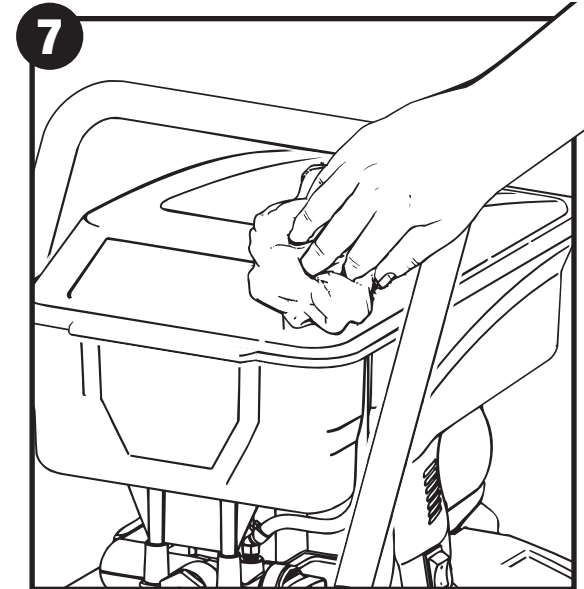

7. Wipe entire unit, hose and spray gun with damp cloth to remove accumulated material

## Fix Spraying Problems



**Before servicing, always release system pressure by following Pressure Relief Procedure (page 7).**

### Problem A: The sprayer does not start

Cause	Solution
1. Sprayer is not plugged in	Plug sprayer in
2. ON/OFF switch is set to OFF	Turn ON/OFF switch to ON
3. The sprayer shuts off while under pressure	Motor will cycle ON and OFF while spraying to regulate pressure. This is normal
4. No voltage is coming from wall plug	Test the power supply voltage
5. The extension cord is damaged or has too low a capacity	Replace extension cord
6. There is a problem with sprayer motor	Take sprayer to Wagner Authorized Service Center

### Problem B: The sprayer starts but does not draw material when the PRIME/SPRAY knob is set to PRIME

Cause	Solution
1. The sprayer will not prime properly or has lost prime	Refer to Getting Material to Flow section <b>see page 9</b>
2. The hopper is empty	Refer to Load Material and Getting Material to Flow sections <b>see pages 8-9</b>
3. The sprayer is not on level ground	Relocate sprayer to level ground
4. The inlet filter is clogged	Refer to Clean the Inlet Filter <b>see page 14</b>
5. The inlet valve is stuck	Inlet may be stuck from old material. Push filter tab to release. If still stuck refer to Clean the Inlet Filter <b>see page 14</b> or Replace the Inlet Valve <b>see page 24 *</b>
6. The outlet valve is stuck	Refer to Replacing Outlet Valve <b>see page 24</b>
7. The inlet valve is worn or damaged	Refer to Cleaning or Replacing Inlet Valve <b>see page 24 *</b>
8. The PRIME/SPRAY valve is plugged	Take sprayer to Wagner Authorized Service Center

### Problem C: The sprayer draws up material but the pressure drops when the gun is triggered

Cause	Solution
1. The spray tip is worn	Replace spray tip with a new one**
2. The inlet filter is clogged	Refer to Clean the Inlet Filter <b>see page 14</b>
3. The spray tip is plugged	Refer to Clear the Spray Tip <b>see page 13</b>
4. The spray gun filter is clogged	Refer Clean the Spray Gun Filter <b>see page 15</b> . Keep extra filters on hand
5. The material is too heavy or coarse	Thin or strain the material
6. The outlet valve assembly is dirty or worn	Refer to Replacing Outlet Valve <b>see page 24 *</b>
7. The inlet valve assembly is damaged or worn	Refer to Clean or Replace Inlet Valve <b>see page 24 *</b>

## Problem D: The PRIME/SPRAY knob is set to SPRAY and there is flow through the material return tube

Cause	Solution
1. The PRIME/SPRAY valve is dirty or worn	Take sprayer to Wagner Authorized Service Center

## Problem E: The spray gun leaks

Cause	Solution
1. Gun filter housing is loose	Tighten handle
2. Internal parts of spray gun are worn or dirty	Take sprayer to Wagner Authorized Service Center

## Problem F: The spray tip assembly leaks

Cause	Solution
1. The spray tip was assembled incorrectly	Check tip assembly and assemble properly <b>see page 20, steps 8-9</b>
2. Gun seal is worn	Replace the seal*

## Problem G: The spray gun will not spray

Cause	Solution
1. The spray tip plugged	Refer to Clear the Spray Tip <b>see page 13</b>
2. The spray gun filter is clogged	Refer to Clean the Spray Gun Filter <b>see page 15</b> . Keep extra filters on hand
3. The spray tip is in CLEAN position	Rotate spray tip to SPRAY position <b>see page 13, step 9</b>
4. PRIME/SPRAY knob not set on SPRAY	Turn PRIME/SPRAY knob to SPRAY <b>see page 9</b> Getting Material to Flow

## Problem H: The spray pattern is poor (tailing)

Cause	Solution
1. The spray tip is plugged	Refer to Clear the Spray Tip <b>see page 13</b>
2. The inlet filter is clogged	Refer to Clean the Inlet Filter <b>see page 14</b>
3. The spray gun filter is clogged	Refer to Clean the Spray Gun Filter <b>see page 15</b> . Keep extra filters on hand
4. The spray tip is worn	Replace the spray tip
5. The material is too thick	Thin material using appropriate thinning solution
6. Pressure loss	Refer to Causes and Solutions for Problem C

\* Special repair kits with instructions are available for these procedures. Refer to the Maintenance section of this manual for a list of the kits and their part numbers

\*\* Additional parts are available for this procedure. Refer to the Accessories (**page 74**) section of this manual for a list of the parts and their part numbers

### Daily Maintenance

The only daily maintenance necessary is thorough cleaning  
Follow the cleaning procedures in this manual

### Extended Maintenance

Some pump parts eventually wear out from use and must be replaced. The following is a list of available repair kits. Pump performance is the only reliable indicator of when to replace wear parts. Refer to the Troubleshooting section for more information on when to use these kits

### Kit Part # Description

0515221	Inlet valve kit
0515237	Outlet valve kit
0501014	Saddle seat/seal kit



## Replacing Outlet Valve

Replacement of the outlet valve may be necessary if spray performance remains poor after following steps in the **Fix Spraying Problems** section. Replacement valves can be ordered by calling the customer service number found on **page 2**

### Start 1 What you'll need

- Wrench
- Rag
- Warm, soapy water if using latex material
- Mineral spirits for oil based material

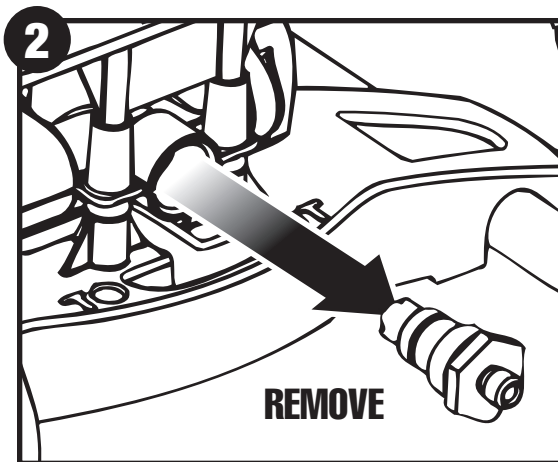

**2.** Unscrew outlet valve from outlet valve housing using wrench

**3.** Remove any accumulated material inside outlet valve housing using appropriate solution for material being used

**4.** Replace with new outlet valve and tighten with wrench

## Cleaning or Replacing Inlet Valve

Cleaning or replacing the inlet valve may be necessary if spray performance remains poor after following steps in the **Fix Spraying Problems** section. Problems with the inlet valve are usually caused by improper cleaning or storage. Replacement kits may be ordered by calling the customer service number found on **page 2**

### Start 1 What you'll need

- Inlet valve tool
- Ratchet wrench, extension
- Household oil
- Warm, soapy water if using latex material
- Mineral spirits for oil based material

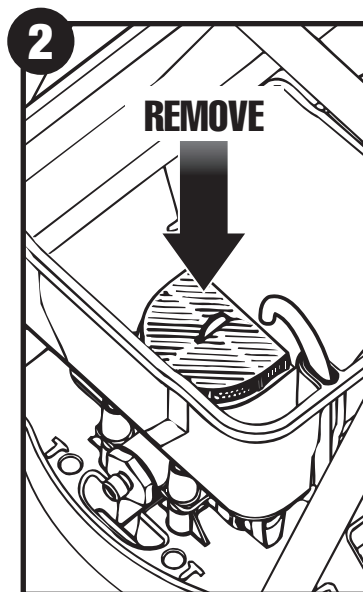

**2.** Remove inlet filter from bottom of hopper

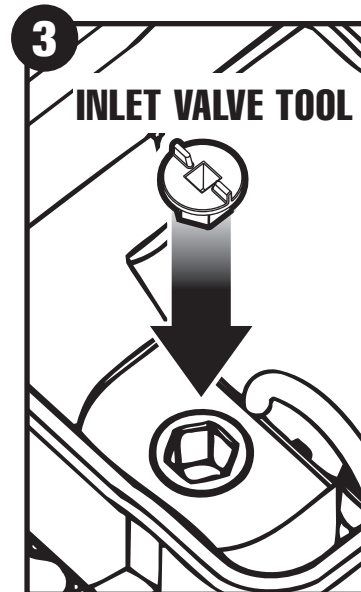

**3.** Attach inlet valve tool to ratchet wrench extension. Insert inlet valve tool into inlet fitting. Turn counter-clockwise and remove from housing

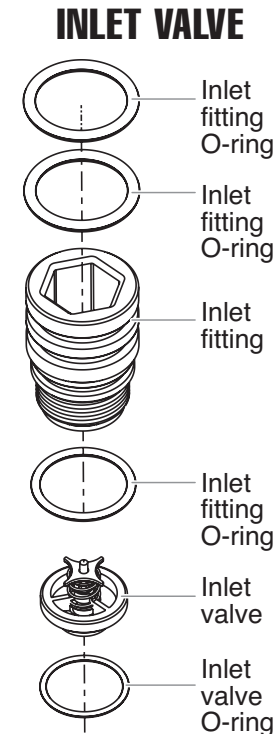

**4.** Inspect the three inlet fitting O-rings and replace if worn. If not replacing O-rings do not remove them but clean with appropriate cleaning solution based on material being used. Lubricate with light household oil

**5.** Place inlet valve O-ring in housing and set inlet valve on top of O-ring

**6.** Replace inlet fitting in house and tighten with inlet valve tool and ratchet wrench

## Parts and Accessories • Pièces et Accessoires • Piezas y Accesorios

### Sprayer • Pulvérisateur • Rociador

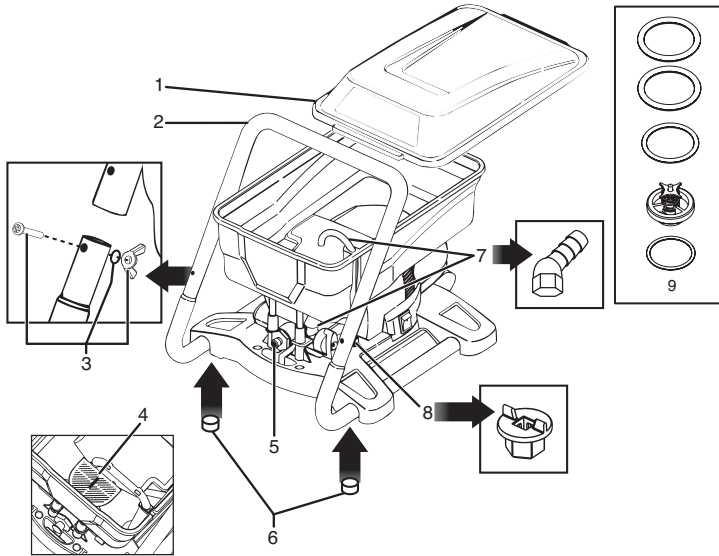

Item Article Artículo	Part No. No de pièce Pieza No.	English - Description	Français - Description	Español - Descripción	Quantity Quantité Cantidad
1	0515223	Hopper lid	Couvercle de trémie	Tapa de tolva	1
2	0515297	Handle, upper	Poignée	Mango	1
3	0515225	Bolt, washer, and wing nut kit	Trousse de boulon, rondelle et écrou	Juego de perno, rondana y tuerca	1
4	0515417	Inlet filter	Filtre d'entrée	Filtro de entrada	1
5	0515237	Outlet valve	Soupape de sortie	Válvula de salida	1
6	0515999	Feet	Supports	Soportes	4
7	0515226	Return tube / fitting	Tube de retour / raccord	Tubo de retorno / conector	1
8	0515370	Inlet valve tool	Outil de soupape d'entrée	Herramienta de válvula de entrada	1
9	0515221	Inlet valve kit	Trousse de joint de soupape d'entrée	Juego de sellos para la válvula de entrada	1

### Spray Gun • Pistolet • Pistola

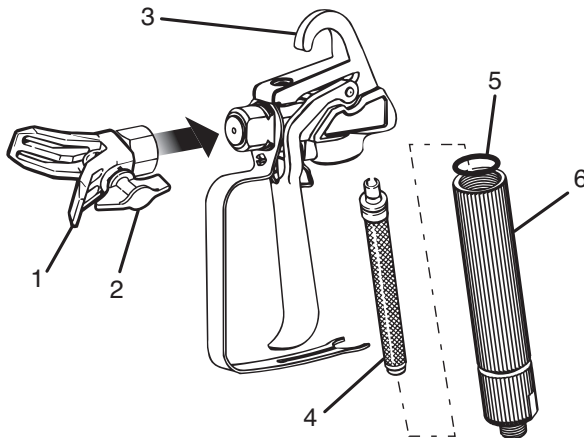

Item Article Artículo	Part No. No de pièce Pieza No.	English - Description	Français - Description	Español - Descripción	Quantity Quantité Cantidad
1	0501011	Guard assembly	Protège-embout	Ensamblaje de protección	1
2	0501413	Tip, 413	Buse, 413	Boquilla, 413	1
3	0515229	Complete gun assembly Includes items 3,4,5,6	Pistolet et ses composants (inclus les articles 3-6)	Ensamblaje de la pistola (incluye artículos 3-6)	1
4	0154675	Filter, 100 mesh (yellow, 2 pack)	Filtre, maille 100 (jaune, trousse de 2)	Filtro, malla 100 (amarillo, juego de 2)	1
5	0515228	Seal	Joint d'étanchéité	Sello	1
6	-----	Filter housing	Logement de filtre	Alojamiento de filtro	1

## Limited Warranty for Your Paint Crew 770

### Limited Warranty

#### AIRLESS PAINT SPRAY EQUIPMENT

This product, manufactured by Wagner Spray Tech Corporation (Wagner), is warranted to the original retail purchaser against defects in material and workmanship for one year from date of purchase.

This warranty does not cover damage resulting from improper use, accidents, user's negligence or normal wear. This warranty does not cover any defects or damages caused by service or repair performed by anyone other than a Wagner Authorized Service Center. This warranty does not apply to accessories.

ANY IMPLIED WARRANTY OF MERCHANTABILITY OR FITNESS FOR A PARTICULAR PURPOSE IS LIMITED TO ONE YEAR FROM DATE OF PURCHASE.

WAGNER SHALL NOT IN ANY EVENT BE LIABLE FOR ANY INCIDENTAL OR CONSEQUENTIAL DAMAGES OF ANY KIND, WHETHER FROM BREACH OF THIS WARRANTY OR ANY OTHER REASON.

If any product is defective in material and/or workmanship during the applicable warranty period, return it with proof of purchase, transportation prepaid to any Wagner Authorized Service Center. (Service Center listing is enclosed with this product.) Wagner's Authorized Service Center will either repair or replace the product (at Wagner's option) and return it to you, postage prepaid.

**SOME STATES DO NOT ALLOW LIMITATIONS ON HOW LONG AN IMPLIED WARRANTY LASTS OR THE EXCLUSION OF INCIDENTAL OR CONSEQUENTIAL DAMAGES, SO THE ABOVE LIMITATION AND EXCLUSION MAY NOT APPLY TO YOU.**

**THIS WARRANTY GIVES YOU SPECIFIC LEGAL RIGHTS, AND YOU MAY ALSO HAVE OTHER RIGHTS WHICH VARY FROM STATE TO STATE.**

### GARANTIE LIMITÉE

#### MATÉRIEL DE PULVÉRISATION DE PEINTURE SANS AIR

Ce produit, fabriqué par Wagner Spray Tech Corporation (Wagner), est garanti, au bénéfice de l'acheteur au détail d'origine, contre tout vice de matières et toute malfaçon pour un an à compter de la date d'achat.

La présente garantie ne s'applique pas aux dégâts entraînés par une utilisation incorrecte, par la négligence de l'utilisateur ou par l'usure normale. La présente garantie ne s'applique pas non plus aux défauts ou dommages résultant de l'entretien ou de la réparation que fait une personne quelconque qui ne soit pas membre d'un centre d'entretien autorisé pour les produits Wagner. La présente garantie ne s'applique pas aux accessoires.

TOUTE GARANTIE IMPLICITE DE QUALITÉ MARCHANDE OU D'ADAPTATION À UN USAGE PARTICULIER EST LIMITÉE À UNE PÉRIODE DE 30 JOURS POUR UNE UTILISATION PROFESSIONNELLE OU DE LOCATION ET D'UNE ANNÉE POUR L'UTILISATION DOMESTIQUE, À COMPTER DE LA DATE D'ACHAT.

TOUTE GARANTIE IMPLICITE DE VENDABILITÉ OU DE CONVENANCE À UNE DESTINATION PARTICULIÈRE EST LIMITÉE À UN AN À COMPTER DE LA DATE D'ACHAT.

Si un produit est défectueux en ce qui concerne les matériaux ou l'exécution pendant la période de garantie applicable, vous devez le retourner, avec une preuve d'achat et frais de port payés, à n'importe quel centre d'entretien autorisé pour les produits Wagner. (Une liste de ces centres d'entretien est jointe à ce produit.) Le centre d'entretien autorisé pour les produits Wagner réparera ou remplacera le produit (à la discrétion de Wagner) et vous le retournera par la poste, avec frais de port payés.

**CERTAINES PROVINCES INTERDISSENT LES RESTRICTIONS SUR LA DURÉE D'UNE GARANTIE IMPLICITE OU L'EXCLUSION DES DOMMAGES ACCESSOIRES OU INDIRECTS. IL SE PEUT DONC QUE LA RESTRICTION ET L'EXCLUSION ÉNONCÉES CI-DESSUS NE S'APPLIQUENT PAS À VOUS.**

**LE PRÉSENTE GARANTIE VOUS ACCORDE DES DROITS JURIDIQUES SPÉCIFIQUES, ET VOUS AVEZ PEUT-ÊTRE D'AUTRES DROITS, QUI PEUVENT VARIER D'UNE PROVINCE À L'AUTRE.**

### GARANTÍA LIMITADA

#### EQUIPO DE ATOMIZACIÓN DE PINTURA SIN AIRE

Este producto, fabricado por Wagner Spray Tech Corporation (Wagner), está garantizado ante el comprador original contra defectos de materiales y mano de obra durante un año contado a partir de la fecha de compra.

Esta garantía no cubre los daños que sean resultado de un uso inapropiado, accidentes, negligencia del usuario o un desgaste normal. Esta garantía no cubre ningún defecto o daño que haya sido causado por los servicios o reparaciones llevadas a cabo por alguien que no sea un técnico del Centro de Servicio Autorizado de Wagner. Esta garantía no es válida para ningún accesorio.

CUALQUIER GARANTÍA IMPLICITA DE COMERCIALIZACION O IDONEIDAD PARA CUALQUIER PROPOSITO EN PARTICULAR QUEDA LIMITADA A UN AÑO A PARTIR DE LA FECHA DE COMPRA.

WAGNER NO SERÁ EN NINGÚN CASO RESPONSABLE DE NINGÚN DAÑO INCIDENTAL O DE CONSECUENCIA DE NINGUNA CLASE, QUE RESULTE DE VIOLAR ESTA GARANTÍA O POR CUALQUIER OTRA RAZÓN.

Si algún producto llegara a tener defectos de material y/o mano de obra durante el periodo de validez de la garantía, devuélvalo junto con el comprobante de compra y flete previamente pagado, a cualquier Centro de Servicio Autorizado de Wagner. (La lista de Centros de Servicio viene adjunta con este producto.) El Centro de Servicio Autorizado de Wagner reparará o reemplazará el producto (según la opción de Wagner) y se lo devolverá, con porte previamente pagado.

**ALGUNOS ESTADOS NO PERMITEN LIMITACIONES EN CUANTO A LA DURACIÓN DE UNA GARANTÍA IMPLICITA O LA EXCLUSIÓN DE DAÑOS INCIDENTALES O DE CONSECUENCIA, DE MANERA QUE LA LIMITACIÓN Y EXCLUSIÓN ANTERIORES PODRÍAN NO SER VÁLIDAS PARA USTED.**

**ESTA GARANTÍA LE CONCEDE DERECHOS LEGALES ESPECÍFICOS, PERO USTED PODRÍA TENER DERECHO A OTROS, LOS CUALES VARIAN DE UN ESTADO A OTRO.**