



**nevo<sup>®</sup>**

**New evolution in home control**

**Nevo<sup>SL</sup><sup>™</sup>**  
**Quick Guide**

Nevo<sup>SL</sup> provides fully-customizable control of all of your home theater devices and digital media content. Its touch-sensitive screen is software-based, so you or your installer/integrator can include only those controls you actually use. For more information on customizing Nevo<sup>SL</sup>, your installer/integrator may refer to *NevoStudio Design Guide*.

## Unpacking Nevo<sup>SL</sup>

Packaging includes the following components:

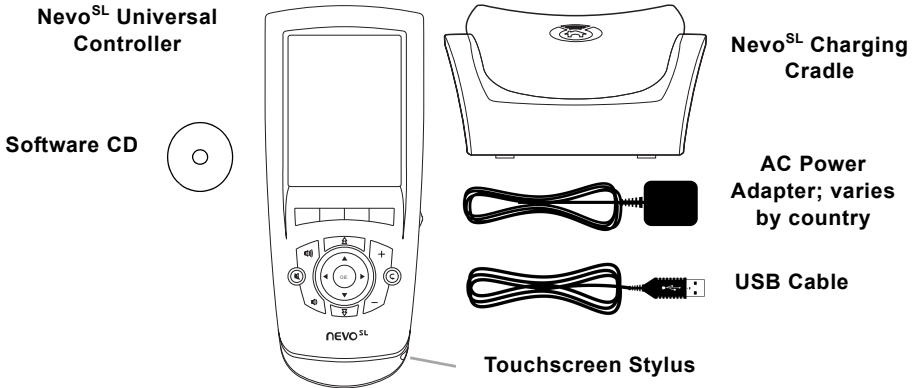

Once you unpack Nevo<sup>SL</sup>:

1. Connect the power adapter to the charging cradle and plug the adapter into a wall outlet.
2. Dock Nevo<sup>SL</sup> and begin charging the battery. If it has not already been charged, it will take 3-4 hours to fully charge the battery the first time.

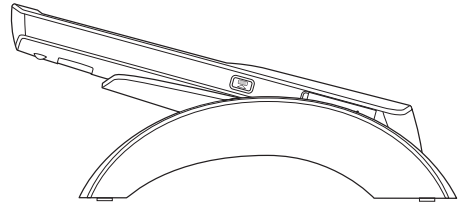

### Recharging Nevo<sup>SL</sup>

Nevo<sup>SL</sup> includes a Lithium-ion rechargeable battery. Nevo<sup>SL</sup> beeps and the battery indicator turns red when the battery is running low. Dock Nevo<sup>SL</sup> to charge the battery.

To dock Nevo<sup>SL</sup>, simply set the remote in the charging cradle. When it is correctly docked, the blue light will appear on the bottom of the remote.

### About Battery Life

As with all battery-operated devices, battery life will vary depending on use. It is a good practice to keep Nevo<sup>SL</sup> in its charging cradle when you are not using it. Your installer/integrator may refer to the *NevoStudio Design Guide* for information on changing power settings or please see the *Nevo<sup>SL</sup> User Manual*.

# Getting to Know Nevo<sup>SL</sup>

Nevo<sup>SL</sup> offers the following types of controls:

**TOUCHSCREEN.** To use the touchscreen, gently touch the buttons that appear on it. If you prefer, slide the stylus from its storage port on the bottom of the Nevo<sup>SL</sup>:

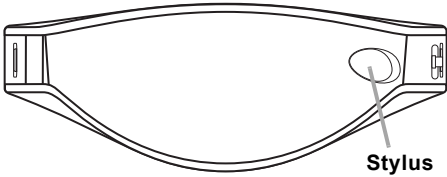

Using the stylus, gently tap buttons on the touchscreen to control your home theater system or digital media. You may prefer to always use the stylus when you are configuring settings. See the *Nevo<sup>SL</sup> User Manual* for more information on these settings.

Nevo<sup>SL</sup>'s fully-customizable touch screens can be set up via NevoStudio. Your installer/integrator may see *NevoStudio Design Guide* for more information.

**FRONT KEYS.** The keys on Nevo<sup>SL</sup> can be customized to your preference. An additional set of unlabeled keys (function keys) appear immediately below the touchscreen, above the hard buttons. A label appears on the touchscreen above them to indicate the functions assigned to those keys.

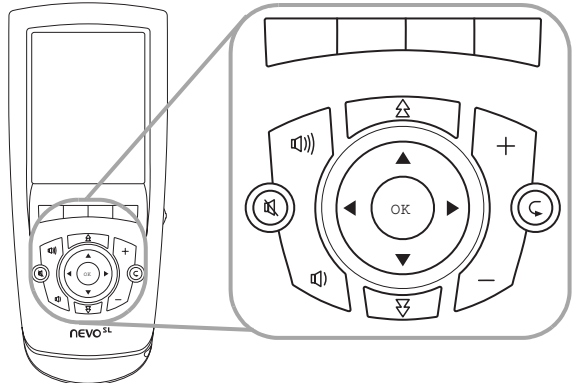

Nevo<sup>SL</sup> has additional, non-customizable keys on its sides:

## LEFT SIDE

Home Page of Home Control

On/Off Switch  
up=ON  
down=OFF

Reset Button

USB Port

## RIGHT SIDE

Backlight Key;  
hold to put in standby

Toggle Wheel

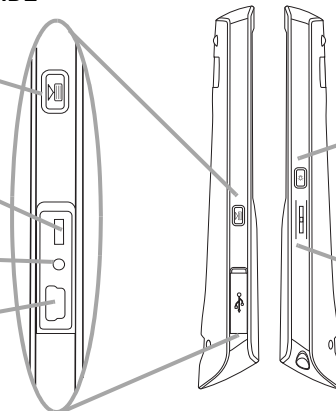

- Press the **Backlight On/Off** key to turn the backlight on or off, regardless of how you have set the backlight timing
- Move the **toggle wheel** up and down to move between the screens in the Home Control section or through the media listings in the Media Control section. Press the toggle wheel in to return to the first page of the page collection in Home control or to make a selection in Media Control.
- Use the stylus to move the On/Off switch to **Off** if you will be away from home for an extended period. This conserves your battery power.
- In the rare instance Nevo<sup>SL</sup> fails to operate properly, use the stylus to press the **Reset Button**.

If your installer/integrator has enabled it, Nevo<sup>SL</sup> provides Media Zones to control digital media on a Windows XP™ PC with NevoMedia Manager or other digital media server installed. For more information on NevoMedia Manager, see *Nevo<sup>SL</sup> User Manual*. You will need a wireless home network to use Media Zones.

## Caring for Nevo<sup>SL</sup>

Use only the stylus to switch Nevo<sup>SL</sup> on or off. Avoid using sharp objects.

Clean your remote with a soft, damp cloth using a gentle, non-caustic cleaner.

**CAUTION:** Do not use a caustic or abrasive cleaner. This may damage the surface of your remote.

## Where to Find More Information

**NEVO<sup>SL</sup> USER MANUAL.** This volume explains how to use the features that appear on Nevo's touchscreen to control your home entertainment equipment. Since Nevo<sup>SL</sup> is completely customizable, not all of the features discussed in *Nevo<sup>SL</sup> User Manual* may appear on your Nevo<sup>SL</sup>—only the ones your installer/integrator set up will be included.

**NOTICE:** Nevo, NevoStudio, NevoLink, and NevoMedia are registered trademarks or trademarks of Universal Electronics Inc., in the United States and/or other countries. Microsoft, Windows, the Windows logo, and Windows Media are registered trademarks or trademarks of Microsoft Corporation in the United States and/or other countries. Other product and company names may be trademarks of their respective companies.

Copyright © 2005 Universal Electronics  
All rights reserved.

Software Version 1.0

Document Version NSL00801

**For more information, contact  
your installer/integrator:**

Installer/integrator, attach your  
business card or business sticker  
here