

# WORK<sup>®</sup>

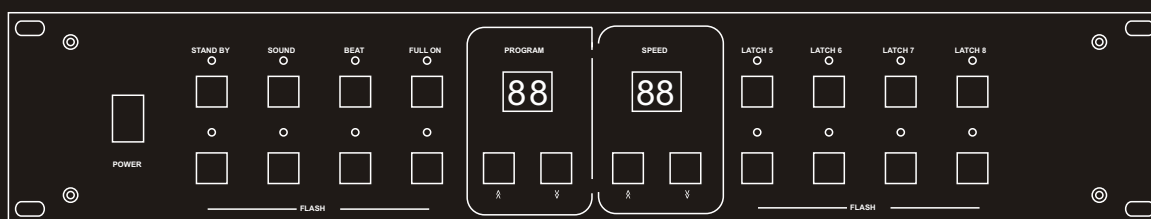

## PROLIGHT 844 P

**User Manual**



# ***Contents***

## **Features 1**

## **General Instructions 2**

### **1. Overview 3**

1.1 Front View 3

1.2 Rear View 5

### **2. Operation Guide 6**

#### **2.1 4 Channel Chaser 6**

2.1.1 Select Programs 6

2.1.2 Select Speed 6

2.1.3 Sound Mode 7

2.1.4 Beat Mode 7

2.1.5 Flash & Latch Effects 7

#### **2.2 4 Channel Switchpack 8**

#### **2.3 Stand By & Full On 9**

#### **2.4 1,2,3 Channel Chaser 10**

## **Technical Specifications 11**

Improvement and changes to specifications, design and this manual, may be made at any time without prior notice.

All rights reserved.

# Features

---

Thank you for your purchase. This product features include:

- 8 channel output
- 4 channel chaser with 17 chase programs
- 4 Latch/Flash buttons override the chase programs
- 4 channel switch pack with Flash and Latch effects
- 99 adjustable chase speeds
- Sound Chase/Beat Chase
- Stand by and Full on
- Power failure memory

# General Instructions

---

Please read through this operating instructions before installing or using your new product. After you have finished reading the instructions, put them away in a safe place for future reference.

## Safe and Efficient Use

- This product must be earthed.
- Do not make any inflammable liquids, water or metal objects enter the unit.
- Take care not to damage the power cord.
- Replace the fuse with the same type.
- In the event of a malfunction(burning smell, etc.), immediately stop operation, disconnect the power supply plug, and consult authorized service personnel.
- To prevent fire or shock hazard, do not expose this product to rain or moisture.

## Product Care

- This product is intended for indoor use only.
- Unplug the power plug from the sockets when not using the unit for extended period.
- Do not use the unit in places subject to excessive humidity, vibration or bumps.
- Place this unit in a stable location.
- Do not dismantle or modify the unit.

# 1. Overview

## 1.1 Front View

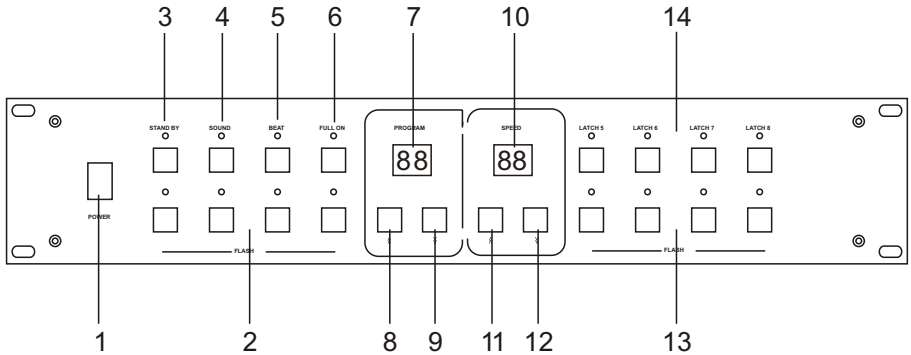

### 1. Power switch

Turns on or off the power.

### 2. Flash/Latch buttons 1-4 & LEDs

Press to activate flash function, corresponding channel(s) will be momentarily turned on, release will turn off.

Keep pressing these buttons will maintain the corresponding channel on regardless of the chase of programs. The second tap will deactivate latch.

### 3. Stand By & LED

Tap the button to kill the output of channel 1-4, its LED blinks. The second tap returns to normal mode and its LED goes out.

### 4. Sound & LED

Tap the button to activate SOUND mode, its LED is lit, the chase programs will be controlled by the music rhythms. Tap again to deactivate SOUND mode, its LED goes out.

# 1. Overview

---

## 1.1 Front View

- |                              |   |
|------------------------------|---|
| 5. Beat & LED                | When Sound LED is lit, tap the button to activate BEAT mode, its LED is lit. When a music beat is picked up, the chase programs will execute one step and the channel LEDs will go out.<br>When Sound LED is off, Beat mode is not available. |
| 6. Full On & LED             | Tap the button to maintain all channels full on, its LED is lit. The second tap deactivates this function and its LED goes out.   |
| 7. Program Display           | Shows the current program.  |
| 8. Program Up                | Press to select the program by increasing the program.  |
| 9. Program Down              | Press to select the program by decreasing the program.  |
| 10. Speed Display            | Shows the current speed from 01-99.   |
| 11. Speed Up                 | Press to select the chase speed by increasing the speed.  |
| 12. Speed Down               | Press to select the chase speed by decreasing the speed.  |
| 13. Flash buttons 5-8 & LEDs | Keep pressing these buttons to momentarily turn the corresponding channel on, the corresponding LED is lit, release will deactivate this function.  |
| 14. Latch buttons 5-8 & LEDs | Tap the buttons to maintain the corresponding channel on regardless of the chase of programs, the corresponding LED is lit. The second tap will deactivate this function.   |

# 1. Overview

## 1.2 Rear View

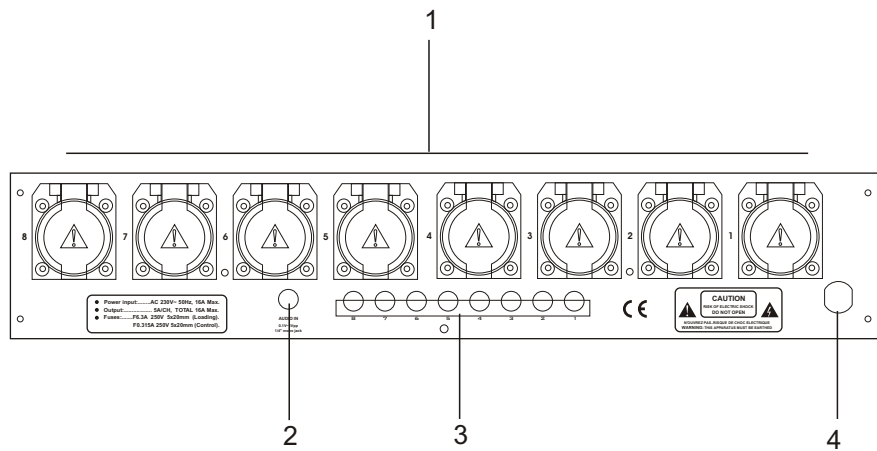

- |                          |                           |
|--------------------------|---------------------------|
| 1. Channels .1-8 OUTPUTS | 5A per channel            |
| 4. AUDIO INPUT           | 1/4" mono jack, 0.1V-1Vpp |
| 5. CHANNEL FUSE x8       | F6.3A 250V 5x20mm         |
| 6. POWER INPUT           | AC 230V~50Hz, 16A max.    |

## 2. Operation Guide

---

### 2.1 4 Channel Chaser

This unit can serve as a 4 channel chaser with 17 chase programs, the chase programs can be recalled by Program UP/DOWN buttons and the chase speed can be controlled by Speed UP/DOWN buttons. Sound, Beat mode can be selectable to run chase programs, and each channel features Flash or Latch effects.

#### 2.1.1 Select Programs

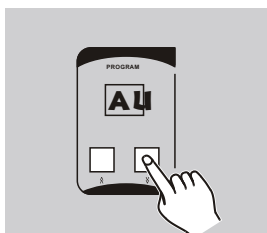

Press Program UP/DOWN buttons to select desired program from 01-16/Au programs, the Program Display shows the current program.

#### 2.1.2 Select Speed



Press Speed UP/DOWN buttons to select chase speed. 01 gives the slowest speed, 99 gives the fastest speed, and the Speed Display shows the current speed.



## 2. Operation Guide

---

### 2.1.3 Sound Mode

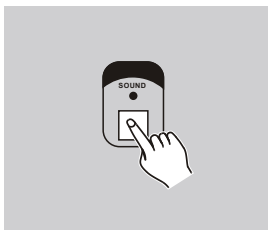

Press Sound button, its LED is lit, the chase programs will be controlled by the music rhythms. Press Sound button again, its LED goes out, the chase program will be controlled by Speed UP/DOWN buttons.

### 2.1.4 Beat Mode

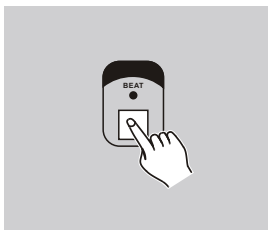

Beat mode is available only when Sound mode is activated.

When Sound LED is lit, press Beat button causing its LED is lit, the chase programs will be executed by one step according music beat, after while the channel LEDs go out.

### 2.1.5 Flash & Latch Effects

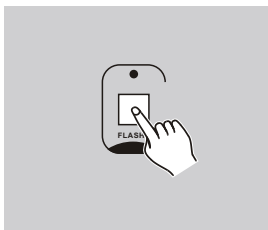

When a chase program is running, you can press Flash buttons 1-4 to select Flash or Latch effect.

## 2. Operation Guide

---

### 2.1.5 Flash & Latch Effects

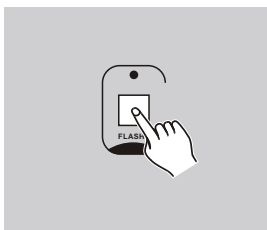

If you want to momentarily turn on certain channel, just press the Flash button, release this button to deactivate this function.



If you want to maintain a channel on, keep pressing the Flash button for 2 seconds, the channel will be turned on regardless of the chase programs.

Tap the Flash button a second time to "unlock" Latch.

### 2.2 4 Channel Switchpack



If you want to momentarily turn on a channel of CH.5-8, just press the Flash button, release this button will deactivate this function.

## 2. Operation Guide

### 2.2 4 Channel Switchpack

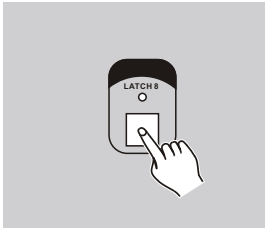

If you want to maintain a channel of CH.5-8 to full on, just press the Latch button the channel will be turned on regardless of the chase programs.

Tap the Latch button a second time to "unlock" Latch function.

### 2.3 Stand By & Full On

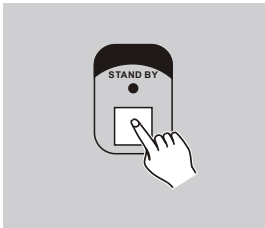

Press Stand By button, its LED blinks, channel 1-4 will be turned off. Press this button again, its LED goes out, channel 1-4 will return to normal mode.

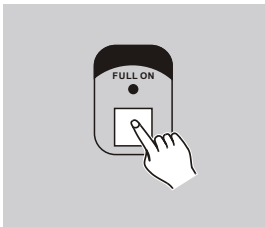

Press Full On button, its LED is lit, all channel will be full on regardless of chase programs. Press this button again, its LED goes out, all channel will return to normal mode.

## 2. Operation Guide

---

### 2.4 1,2,3 Channel Chaser

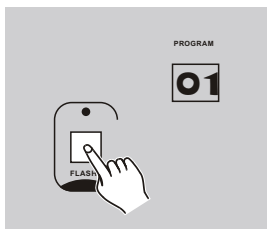

When Program Display shows 01 or 02, press Flash button 1-4 will take the corresponding channel out of the chase program, that is, this unit serves as 1,2,3 channel chaser.

# Technical Specifications

---

Power Input .....	AC 230V~50Hz, 16A max.
Channel Output .....	5A/CH., Total 16A max.
Audio Input .....	1/4" mono jack, 0.1V-1Vpp
Fuse .....	F6.3A 250V 5x20mm>Loading) .F0.315A 250V 5x20mmControl)
Dimensions .....	482x157x89mm
Weight(appro.) .....	3.3 kg

AUTHORIZED DISTRIBUTOR:

Equipson S.A.

[www.equipson.es](http://www.equipson.es)  
[support@equipson.es](mailto:support@equipson.es)



**WORK**

All rights reserved.