



## SK629

### WIRELESS REMOTE CONTROLS

The wireless remote control is compatible with the following Ideal receivers: SK622, SK623 and SK626.

- One button cell battery per remote included
- Remote controls for Arm, Disarm and Panic   
- Remote range from receiver is up to 25 meters



### Battery installation and replacement

1. Remove the battery compartment cover by sliding it in the direction of the arrow.
2. Install battery. Make sure the polarity (+ or -) of the battery matches the polarity marks inside the unit. As shown below. (Fig.1)
3. Replace battery cover.

### Learn ID Code to main unit

The remotes have to be "learned" to the receivers of these units. Follow the steps below to learn to each receiver.

Learn ID code to: SK622 Auto Dialler (Fig.2),  
SK626 Wireless Outdoor Siren with Flashing Light (Fig3),  
SK623 Wireless Garage Door Alert (Fig.4)

1. Unit must be in standby mode. (ON)
2. Open terminal compartment of main unit.
3. Use a pen to press and hold the LEARN button for 2 seconds, you will hear one beep, release the button. The unit is now ready to receive a learn code signal from the remote control.
4. Press any button of the remote control to send a signal.
5. You will hear one long beep tone confirming that the programming of learn code was done successfully, if programming the learn code is unsuccessful you will hear four short beep tones, repeat learning process.
6. To "learn" additional units to this remote, repeat all steps from #1.
7. Both remotes included in this package must be learned separately, you can learn one to the siren and the other to another IDEAL receiver.
8. NOTE: the   on the remote will ARM and DISARM all units that are learned to it at the same time.
9. Both remotes in this package have to be learned to the receivers.

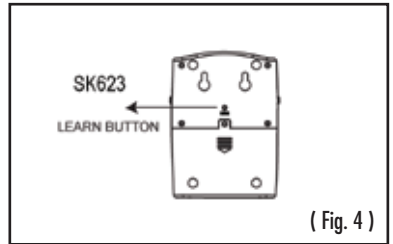
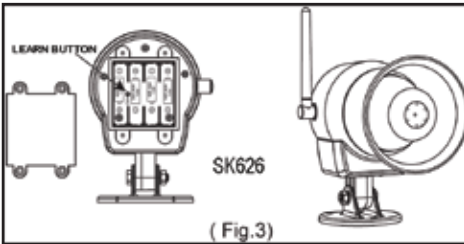
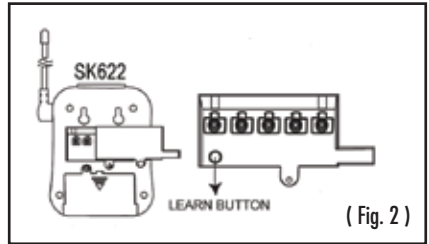
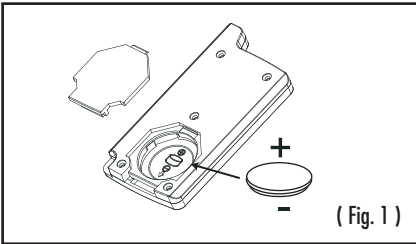

For more complete instructions on how to learn please refer to the user manual for each receiver, or visit our web site at [www.idealinc.com](http://www.idealinc.com)

If the remote has to be moved closer to the receiver in order to function please replace batteries.

The battery life is about six months under normal use.