

# Always there to help you

Register your product and get support at  
[www.philips.com/welcome](http://www.philips.com/welcome)

DVP3602



|                       |    |
|-----------------------|----|
| EN User manual        | 7  |
| ES Manual del usuario | 17 |

**EN: For further assistance, call the customer support service in your country.**

- To obtain assistance in the U.S.A., Canada, Puerto Rico, or the U.S. Virgin Islands, contact Philips Customer Care Center at 1-866-309-0866
- To obtain assistance in Mexico, contact Philips Customer Care Center at 01 800 839 19 89; Mexico city: 5887-9736

**ES: Para obtener mas informacion, llame al servicio de soporte al cliente de su pais.**

- Para obtener asistencia en los Estados Unidos, en Canada, Puerto Rico o en las Islas Virgenes de los Estados Unidos, comuniquese con Centro de atencion al cliente de Philips al 1-866-309-0866
- Solo para Mexico CENTRO DE ATENCION A CLIENTES LADA. 01 800 839 19 89 Mexico, Mexico city: 5887-9736

For Product recycling information, please visit - [www.recycle.philips.com](http://www.recycle.philips.com)

Para obtener informaci3n del reciclaje de productos, por favor visite - [www.recycle.philips.com](http://www.recycle.philips.com)



- EN Please refer to the safety information before using the product.  
ES Consulte la información de seguridad antes de utilizar el producto.

|                                    |  |
|------------------------------------|--|
| Descripción/Description:           | <b>REPRODUCTOR DE DISCO DE VIDEO DIGITAL</b>                                       |
| Modelo/Model:                      | <b>DVP3602/F8</b>  |
| Alimentación/Mains:                | 110-127 V ~ 60 Hz  |
| Consumo/Consumption:               | <b>&lt; 10W</b>  |
| Importador/Importer:               | <b>P&amp;F MEXICANA, S.A. DE C.V.</b>  |
| Domicilio/Street:                  | Av. La Palma No. 6 Col. San Fernando La Herradura<br>Huixquilucan, Edo. de México. |
| Localidad y Teléfono/City & Phone: | C.P. 52787 Tel. 52 69 90 00  |
| Exportador/Exporter:               | P&F USA INC.   |
| País de Origen/Origin:             | CHINA  |

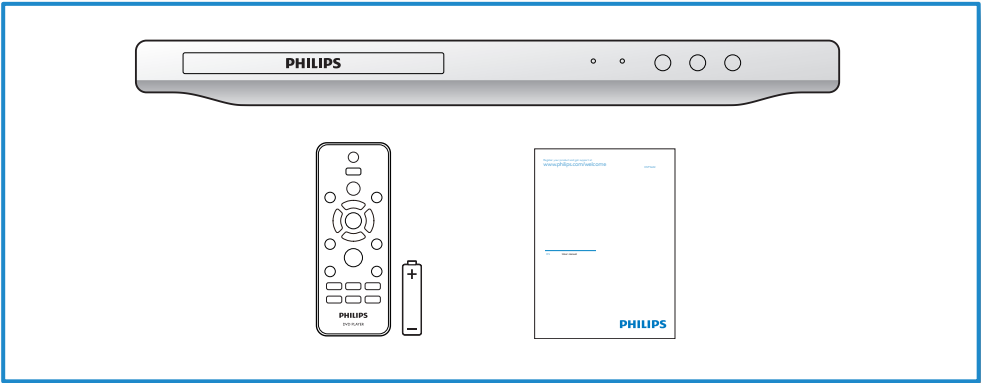

# 1

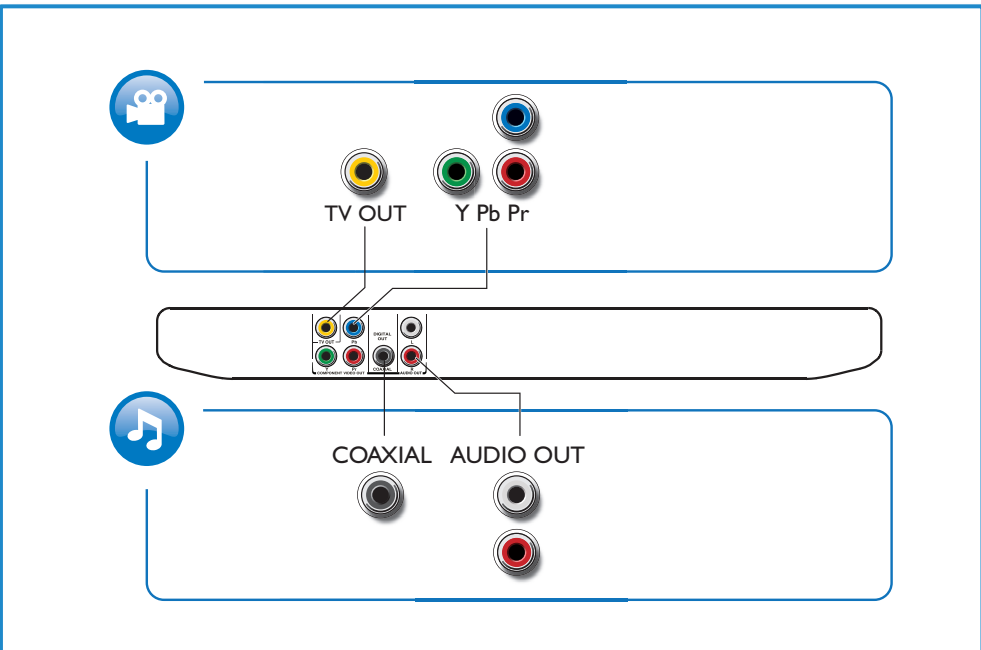

# 2

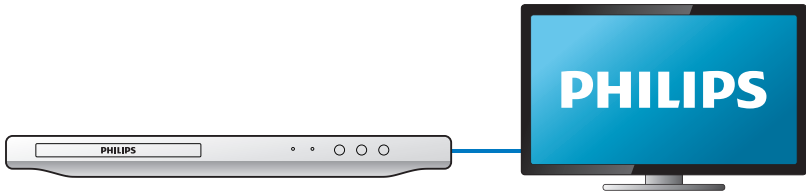

## Pr Pb Y + AUDIO OUT

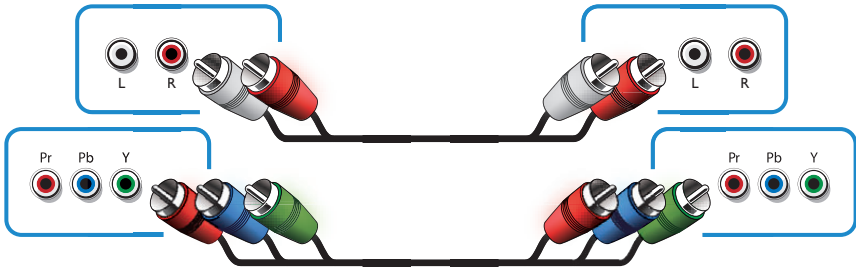

## TV OUT + AUDIO OUT



3

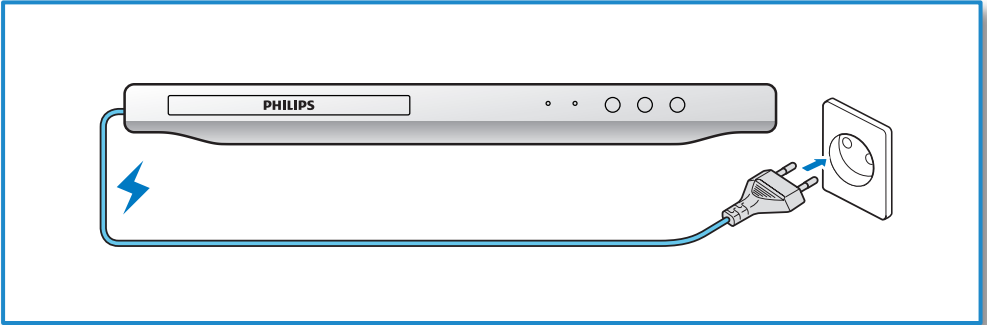

4

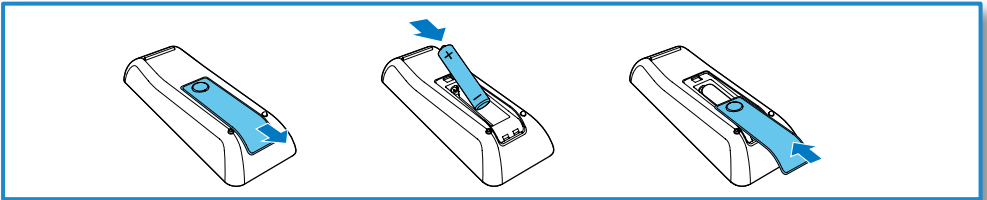

5

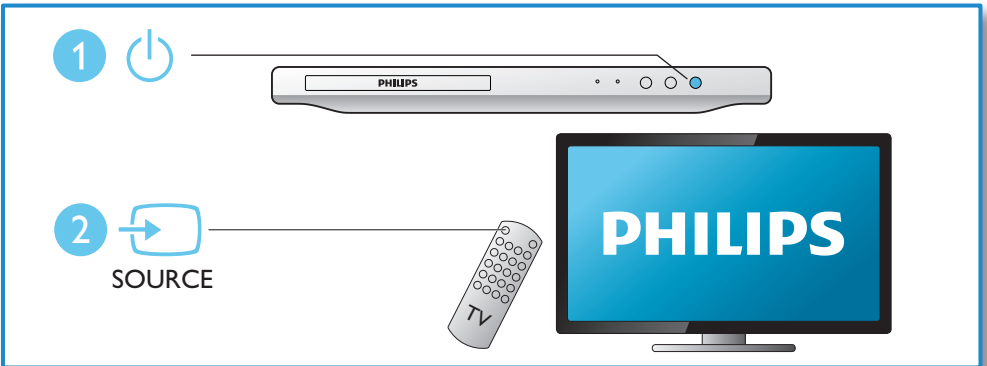

# 6

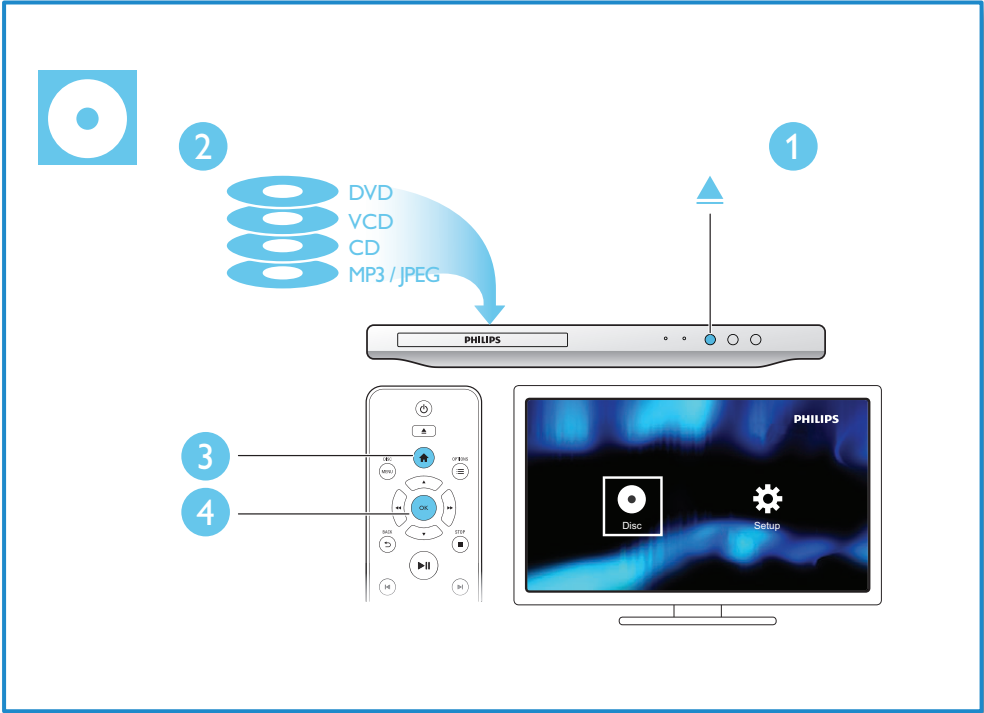

# Contents

---

|          |                        |     |
|----------|------------------------|-----|
| <b>1</b> | <b>Hookup and play</b> | 2-6 |
|----------|------------------------|-----|

---

|          |                            |   |
|----------|----------------------------|---|
| <b>2</b> | <b>Use your DVD player</b> | 8 |
|          | Basic play control         | 8 |
|          | Video options              | 9 |
|          | Play a musical slideshow   | 9 |
|          | Repeat play                | 9 |
|          | Skip play                  | 9 |

---

|          |   |    |
|----------|---|----|
| <b>3</b> | <b>Change settings</b>                      | 10 |
|          | General (sleep, standby...)                 | 10 |
|          | Picture                                     | 10 |
|          | Sound                                       | 10 |
|          | Preference (languages, parental control...) | 11 |

---

|          |                        |    |
|----------|------------------------|----|
| <b>4</b> | <b>Software update</b> | 12 |
|----------|------------------------|----|

---

|          |                       |    |
|----------|-----------------------|----|
| <b>5</b> | <b>Specifications</b> | 13 |
|----------|-----------------------|----|

---

|          |                        |    |
|----------|------------------------|----|
| <b>6</b> | <b>Troubleshooting</b> | 14 |
|----------|------------------------|----|

---

|          |                                    |    |
|----------|------------------------------------|----|
| <b>7</b> | <b>Safety and important notice</b> | 15 |
|----------|------------------------------------|----|

## 2 Use your DVD player

Congratulations on your purchase, and welcome to Philips! To fully benefit from the support that Philips offers, register your product at [www.philips.com/welcome](http://www.philips.com/welcome).

### Basic play control

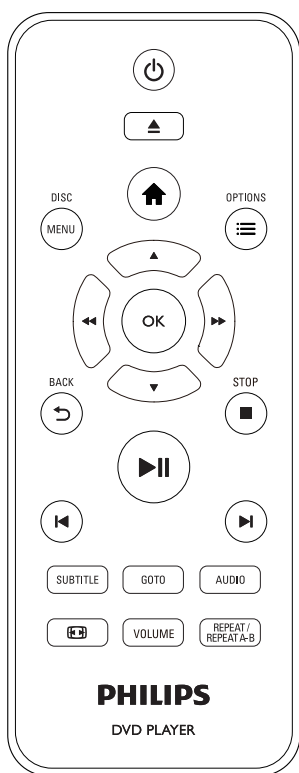

During play, press the following buttons to control the player:

| Button                   | Action   |
|--------------------------|--|
|                          | Turn on the player, or switch to standby.  |
|                          | Open or close the disc compartment.  |
|                          | Access the home menu.  |
| <b>DISC MENU</b>         | Access or exit the disc menu.  |
|                          | Access more options during video play.   |
|                          | Navigate the menus. Slow forward or backward. Press repeatedly to change a search speed. |
|                          | Navigate the menus. Fast forward or backward. Press repeatedly to change a search speed. |
| <b>OK</b>                | Confirm a selection or entry.  |
|                          | Return to a previous display menu.   |
|                          | Stop play.   |
|                          | Start, pause or resume play.   |
|                          | Skip to the previous or next track, chapter or file.                                     |
| <b>SUBTITLE</b>          | Select a subtitle language.  |
| <b>GOTO</b>              | Skip to a title, a chapter or a track.   |
| <b>AUDIO</b>             | Select an audio language or channel.   |
|                          | Fit the picture display to the TV screen. Zoom the picture in or out.                    |
| <b>VOLUME</b>            | Activate volume control, and then press  to change a volume level.                       |
| <b>REPEAT/REPEAT A-B</b> | Select a repeat play option.   |



## Video options

During video play, press **≡** **OPTIONS** to access the following options.

- **[Info]**: Display the current play information.
- **[PBC]**: Display or skip the content menu for VCD and SVCD.
- **[Aspect ratio]**: Select a picture display format to fit the TV screen.
- **[Volume]**: Change a volume level.
- **[Angle]**: Select a camera angle from which video is viewed.

## Play a musical slideshow

Play music and pictures simultaneously to create a musical slideshow.

- 1 From a disc, play a music file.
- 2 Press **▲▼** to navigate to the picture files.
- 3 Select a picture from the same disc, and press **OK** to start slideshow.
- 4 Press **■** to stop slideshow.
- 5 Press **■** again to stop music play.

## Control photo play

During a photo slideshow, use the remote control to control the play.

| Button                     | Action   |
|----------------------------|--|
| <b>▲▼</b>                  | Rotate a picture horizontally/vertically.  |
| <b>◀▶</b>                  | Rotate a picture anti-clockwise/clockwise.   |
| <b>≡</b><br><b>OPTIONS</b> | Access to select <b>[Color]</b> to display a picture in color or black and white.<br>Access to select <b>[Photo preview]</b> to display pictures in thumbnail. |
| <b>(Z)</b>                 | Zoom in or out of a photo.<br>Play pauses in zoom mode.  |
| <b>OK</b>                  | Start or resume a play.  |
| <b>■</b>                   | Stop a play.   |

## Repeat play

During play, press **REPEAT/REPEAT A-B** repeatedly to select a repeat play option.

- Repeat the current title, chapter, or track.
- Repeat all the contents on a disc.
- Repeat play for a specific section.

### To Repeat play for a specific section

- 1 Press **REPEAT/REPEAT A-B** repeatedly to select **↻A** as a start point.
- 2 Press **REPEAT/REPEAT A-B** again to select **↻AB** as an end point.  
↳ The repeat play of the marked section starts.
- 3 To cancel repeat play, press **REPEAT/REPEAT A-B** until **[Off]** is displayed.

### Note

- Repeat play of the marked section is only possible within a title or track.

## Skip play

You can skip play to a specific title, chapter or track.

- 1 During play, press **GOTO**.  
↳ An input field bar is displayed, and "0" blinks.
- 2 Press **▲▼** to select a digit as a title, chapter, or track number.
- 3 After a digit is selected, press **◀▶** to change a digit position.
- 4 If necessary, repeat step 2 and 3 to complete the input of a title, chapter, or track number.
- 5 Press **OK**.  
↳ The play skips to the selected title, chapter or track.

# 3 Change settings

15 minutes of inactivity (for example, in pause or stop mode).

This section helps you change the settings of this player.

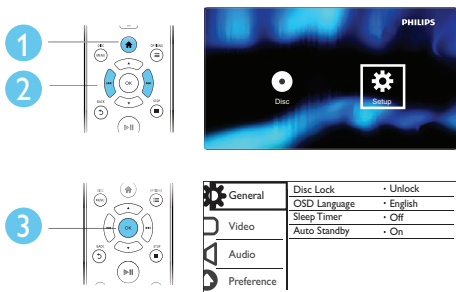

## Note

- You cannot change a menu option that is grayed out.
- To access **[Preferences]**, stop the disc play.
- To return to the previous menu, press **⏪**. To exit the menu, press **⏠**.

## General (sleep, standby...)

- 1 Press **⏠**.
- 2 Select **[Setup] > [General]** to access the general setup options.
  - **[Disc Lock]**: Lock or unlock a disc for play. To play a locked disc, you need to input your password: press **▲▼** to enter a digit, and press **◀▶** to change a digit position. The default password is "136900".
  - **[OSD Language]**: Select a language for on-screen menu.
  - **[Sleep Timer]**: Set a period of time for this player to switch automatically to standby mode from play.
  - **[Auto Standby]**: Enable or disable auto standby. If enabled, this player switches automatically to standby after

## Picture

- 1 Press **⏠**.
- 2 Select **[Setup] > [Video]** to access the video setup options.
  - **[TV System]**: Select a TV system that matches your TV. By default, this setting matches the common TVs in your country.
  - **[Aspect ratio]**: Select a picture display format to fit the TV screen.
  - **[Progressive]**: Turn on or off the progressive scan mode. If a progressive scan TV is connected to this player, turn on the progressive scan mode.
  - **[Picture Setting]**: Select a predefined color setting, or customize a setting.

## Note

- To achieve progressive scan pictures, make sure that your TV supports the progressive scan feature, and your TV is connected to this player through the **Y/Pb/Pr** connectors.

## Sound

- 1 Press **⏠**.
- 2 Select **[Setup] > [Audio]** to access the audio setup options.
  - **[Analogue Output]**: Select an audio format for sound output when this player is connected through the **AUDIO OUT L/R** connectors.
  - **[Digital Audio]**: Select an audio format for sound output when this player is connected through the **COAXIAL** connector.

- **[Digital Output]** - Select a type of digital output: **[Off]** - Disable digital output; **[All]** - Support multi-channel audio formats; **[PCM Only]** - Downmix to two-channel audio signal.
- **[LPCM Output]** - Select a LPCM (Linear Pulse Code Modulation) output sampling rate. The higher the sampling rate, the better the sound quality. **[LPCM Output]** is enabled only when **[PCM Only]** is selected under **[Digital Output]**.
- **[Volume]**: Change a volume level.
- **[Sound Mode]**: Select a preset sound effect.
- **[Night Mode]**: Select quiet or full dynamic sound. Night mode decreases the volume of loud sound and increases the volume of soft sound (such as speech).



#### Note

- Night mode is only available for Dolby encoded DVD discs.

password field is highlighted, press **OK** to enter an input stage, press **▲▼** to select a digit and press **◀▶** to change a digit position.

- **[PBC]**: Display or skip the content menu for VCD and SVCD.
- **[Password]**: Set or change a password to play a restricted disc. Input "136900" if you do not have a password or if you have forgotten your password.
- **[Version Info]**: Display the software version for this player.
- **[Default]**: Reset all settings to the factory default, except for the settings for **[Disc Lock]**, **[Parental Control]** and **[Password]**.



#### Note

- If your preferred language is not available for disc language, audio or subtitle, you can select **[Others]** from the menu options and input 4-digit language code which can be found at the back of this user manual.
- The rating levels are country-dependent. To allow all discs to be played, select **[8 Adult]**.

## Preference (languages, parental control...)

- 1 Press **⬆**.
- 2 Select **[Setup]** > **[Preferences]** to access the preference setup options.
  - **[Audio]**: Select an audio language for video.
  - **[Subtitle]**: Select a subtitle language for video.
  - **[Disc Menu]**: Select a menu language for a video disc.
  - **[Parental Control]**: Restrict access to discs that are encoded with ratings. Input "136900" to access the restriction options: when the

# 4 Software update

## Note

- Power supply must not be interrupted during software update.

To check for updates, compare the current software version of this player with the latest software version (if available) at the Philips website.

- 1 Press **⏠**.
- 2 Select **[Setup] > [Preferences] > [Version Info]**, and then press **OK**.
- 3 Write down the model name and the software version number.
- 4 Visit [www.philips.com/support](http://www.philips.com/support) to check for the latest software version, using the model name and software version number.
- 5 Refer to the upgrade instructions given on the website to complete the software update.

# 5 Specifications



## Note

- Specifications are subject to change without notice

## Region code

This player can play discs with the following region code.

| DVD region code   | Countries     |
|---|---------------|
|  | Latin America |

## Playable media

- Disc**
  - DVD, DVD-Video, VCD, SVCD, Audio CD
  - DVD+R/+RW, DVD-R/-RW, DVD+R/-R DL (Dual Layer), CD-R/-RW (Maximum number of files: 648)
- File**
  - Video: MPEG 1, MPEG 2
  - Audio: .mp3, .wma
  - Picture: .jpg, .jpeg

## Video

- Signal system: PAL, NTSC
- Composite video output: 1 Vp-p (75 Ohm)
- Component video output: 0.7 Vp-p (75 Ohm)

## Audio

- 2-channel analog output
  - Audio Front L&R : 2 Vrms (47k Ohm)
- Digital output: 0.5 Vp-p (75 Ohm)
  - Coaxial
- Sampling frequency:
  - MP3: 22.05 kHz, 24 kHz, 32 kHz, 44.1 kHz, 48 kHz
  - WMA: 44.1 kHz, 48 kHz
- Constant bit rate:
  - MP3: 8 kbps - 320 kbps
  - WMA: 32 kbps - 192 kbps

## Main unit

- Dimensions (W x H x D): 310 x 39.5 x 210 (mm)
- Net Weight: 1.5 kg

## Power

- Power supply rating: 110-127V~, 60Hz
- Power consumption: 10 W
- Power consumption in standby mode: 0.5 W

## Accessories supplied

- Remote control and one battery
- User Manual

## Laser specification

- Type: Semiconductor laser InGaAlP (DVD), AlGaAs (CD)
- Wave length: 658 nm (DVD), 790 nm (CD)
- Output Power: 7.0 mW (DVD), 10.0 mW (VCD/CD)
- Beam divergence: 60 degrees

# 6 Troubleshooting



## Warning

- Risk of electric shock. Never remove the casing of the player.

To keep the warranty valid, never try to repair the player yourself.

If you have problems using this player, check the following points before you request service. If you still have a problem, register your player and get support at [www.philips.com/support](http://www.philips.com/support).

If you contact Philips, you will be asked for the model and serial number of this player. The model number and serial number are on the back of this player. Write the numbers here:

Model No. \_\_\_\_\_

Serial No. \_\_\_\_\_

### No picture.

- Refer to the TV user manual for how to select the correct video input channel.
- If you have turned on the progressive scan or changed a TV system setting, switch back to the default setting: 1) Press ▲ to open the disc compartment. 2) Press **DISC MENU** (for progressive scan) or **SUBTITLE** (for TV system).

### No sound output from the TV.

- Make sure that the audio cables are correctly connected between this player and the TV.

### No audio output from the loudspeakers of the connected external audio device (for example, stereo system, amplifier receiver).

- Make sure that the audio cables or coaxial cable are correctly connected.
- Switch the external audio device to correct audio input source.

### Disc cannot be read.

- Make sure that this player supports the disc (see "Specifications" > "Playable media").
- For a recorded disc, make sure that the disc is finalized.

### Files cannot be displayed or read.

- Make sure that the number of files or folders does not exceed the supported limit of this player (maximum 648 files or 299 folders).
- Make sure that this player supports these files (see "Specifications" > "File format").

# 7 Safety and important notice

Read and understand all instructions before you use this DVD player. If damage is caused by failure to follow the instructions, the warranty does not apply.

---

## Safety

### Risk of electric shock!

- Never expose the product and accessories to rain or water. Never place liquid containers, such as vases, near the product. If liquids are split on or into the product, disconnect it from the power outlet immediately. Contact Philips Consumer Care to have the product checked before use.
- Never place the product and accessories near naked flames or other heat sources, including direct sunlight.
- Never insert objects into the ventilation slots or other openings on the product.
- Where the mains plug or an appliance coupler is used as the disconnect device, it shall remain readily operable.
- Batteries (battery pack or batteries installed) shall not be exposed to excessive heat such as sunshine, fire or the like.
- Disconnect the product from the power outlet before lightning storms.
- When you disconnect the power cord, always pull the plug, never the cable.

### Risk of short circuit or fire!

- Before you connect the product to the power outlet, make sure that the power voltage matches the value printed on the back of the product.

- Avoid applying pressure on the power plugs. Loose power plugs can cause arcing or fire.

### Risk of injury or damage to the product!

- To avoid exposure to laser radiation, do not disassemble.
- Do not touch the optical lens inside the disc compartment.
- Never place the product or any objects on power cords or on other electrical equipment.
- If the product is transported in temperatures below 5°C, unpack the product and wait until its temperature matches room temperature before connecting it to the power outlet.

### Risk of overheating!

- Never install this product in a confined space. Always leave a space of at least four inches around the product for ventilation. Make sure that curtains or other objects never cover the ventilation slots on the product.

### Risk of contamination!

- Remove the batteries if flat or if the remote control is not to be used for a long time.
- Batteries contain chemical substances. They should be disposed of properly.

### Risk of swallowing batteries!

- The product/remote control may contain a coin type battery, which can be swallowed. Keep the battery out of reach of children at all times!



---

## Care for your product

- Do not insert any objects other than discs into the disc compartment.
- Do not insert warped or cracked discs into the disc compartment.
- Remove discs from the disc compartment if you are not using the product for an extended period of time.
- Only use microfiber cloth to clean the product.

---

## Care of the environment



Your product is designed and manufactured with high quality materials and components, which can be recycled and reused. Never dispose of your product with other household waste. Please inform yourself about the local rules on the separate collection of electrical and electronic products and batteries. The correct disposal of these products helps prevent potentially negative consequences on the environment and human health. Your product contains batteries, which cannot be disposed of with normal household waste. Please inform yourself about the local rules on separate collection of batteries. The correct disposal of batteries helps prevent potentially negative consequences on the environment and human health. Please visit [www.recycle.philips.com](http://www.recycle.philips.com) for additional information on a recycling center in your area.

---

## Compliance



This is CLASS II apparatus with double insulation, and no protective earth provided.

---

## Copyright



Be responsible  
Respect copyrights

This item incorporates copy protection technology that is protected by U.S. patents and other intellectual property rights of Rovi Corporation. Reverse engineering and disassembly are prohibited.

---

## Trademarks



Manufactured under license from Dolby Laboratories. Dolby and the double-D symbol are trademarks of Dolby Laboratories.



'DVD Video' is a trademark of DVD Format/Logo Licensing Corporation.



# Language Code

|                             |      |                             |      |                       |      |
|-----------------------------|------|-----------------------------|------|-----------------------|------|
| Abkhazian                   | 6566 | Inupiaq                     | 7375 | Pushto                | 8083 |
| Afar                        | 6565 | Irish                       | 7165 | Russian               | 8285 |
| Afrikaans                   | 6570 | Íslenska                    | 7383 | Quechua               | 8185 |
| Amharic                     | 6577 | Italiano                    | 7384 | Raeto-Romance         | 8277 |
| Arabic                      | 6582 | Ivrit                       | 7269 | Romanian              | 8279 |
| Armenian                    | 7289 | Japanese                    | 7465 | Rundi                 | 8278 |
| Assamese                    | 6583 | Javanese                    | 7486 | Samoan                | 8377 |
| Avestan                     | 6569 | Kalaallisut                 | 7576 | Sango                 | 8371 |
| Aymara                      | 6589 | Kannada                     | 7578 | Sanskrit              | 8365 |
| Azerbaijani                 | 6590 | Kashmiri                    | 7583 | Sardinian             | 8367 |
| Bahasa Melayu               | 7783 | Kazakh                      | 7575 | Serbian               | 8382 |
| Bashkir                     | 6665 | Kernewek                    | 7587 | Shona                 | 8378 |
| Belarusian                  | 6669 | Khmer                       | 7577 | Shqip                 | 8381 |
| Bengali                     | 6678 | Kinyarwanda                 | 8287 | Sindhi                | 8368 |
| Bihari                      | 6672 | Kirghiz                     | 7589 | Sinhalese             | 8373 |
| Bislama                     | 6673 | Komi                        | 7586 | Slovensky             | 8373 |
| Bokmål, Norwegian           | 7866 | Korean                      | 7579 | Slovenian             | 8376 |
| Bosanski                    | 6683 | Kuanyama; Kwanyama          | 7574 | Somali                | 8379 |
| Brezhoneg                   | 6682 | Kurdish                     | 7585 | Sotho; Southern       | 8384 |
| Bulgarian                   | 6671 | Lao                         | 7679 | South Ndebele         | 7882 |
| Burmese                     | 7789 | Latina                      | 7665 | Sundanese             | 8385 |
| Castellano, Español         | 6983 | Latvian                     | 7686 | Suomi                 | 7073 |
| Catalán                     | 6765 | Letzburgesch;               | 7666 | Swahili               | 8387 |
| Chamorro                    | 6772 | Limburgan; Limburger        | 7673 | Swati                 | 8383 |
| Chechen                     | 6769 | Lingala                     | 7678 | Svenska               | 8386 |
| Chewa; Chichewa; Nyanja     | 7889 | Lithuanian                  | 7684 | Tagalog               | 8476 |
| 中文                          | 9072 | Luxembourgish;              | 7666 | Tahitian              | 8489 |
| Chuang; Zhuang              | 9065 | Macedonian                  | 7775 | Tajik                 | 8471 |
| Church Slav; Slavonic       | 6785 | Malagasy                    | 7771 | Tamil                 | 8465 |
| Chuvash                     | 6786 | Magyar                      | 7285 | Tatar                 | 8484 |
| Corsican                    | 6779 | Malayalam                   | 7776 | Telugu                | 8469 |
| Česky                       | 6783 | Maltese                     | 7784 | Thai                  | 8472 |
| Dansk                       | 6865 | Manx                        | 7186 | Tibetan               | 6679 |
| Deutsch                     | 6869 | Maori                       | 7773 | Tigrinya              | 8473 |
| Dzongkha                    | 6890 | Marathi                     | 7782 | Tonga (Tonga Islands) | 8479 |
| English                     | 6978 | Marshallese                 | 7772 | Tsonga                | 8483 |
| Esperanto                   | 6979 | Moldavian                   | 7779 | Tswana                | 8478 |
| Estonian                    | 6984 | Mongolian                   | 7778 | Türkçe                | 8482 |
| Euskara                     | 6985 | Nauru                       | 7865 | Turkmen               | 8475 |
| Ελληνικά                    | 6976 | Navaho; Navajo              | 7886 | Twi                   | 8487 |
| Faroese                     | 7079 | Ndebele, North              | 7868 | Uighur                | 8571 |
| Français                    | 7082 | Ndebele, South              | 7882 | Ukrainian             | 8575 |
| Frysk                       | 7089 | Ndonga                      | 7871 | Urdu                  | 8582 |
| Fijian                      | 7074 | Nederlands                  | 7876 | Uzbek                 | 8590 |
| Gaelic; Scottish Gaelic     | 7168 | Nepali                      | 7869 | Vietnamese            | 8673 |
| Galleghan                   | 7176 | Norsk                       | 7879 | Volapuk               | 8679 |
| Georgian                    | 7565 | Northern Sami               | 8369 | Walloon               | 8765 |
| Gikuyu; Kikuyu              | 7573 | North Ndebele               | 7868 | Welsh                 | 6789 |
| Guarani                     | 7178 | Norwegian Nynorsk;          | 7878 | Wolof                 | 8779 |
| Gujarati                    | 7185 | Occitan; Provençal          | 7967 | Xhosa                 | 8872 |
| Hausa                       | 7265 | Old Bulgarian; Old Slavonic | 6785 | Yiddish               | 8973 |
| Herero                      | 7290 | Oriya                       | 7982 | Yoruba                | 8979 |
| Hindi                       | 7273 | Oromo                       | 7977 | Zulu                  | 9085 |
| Hiri Motu                   | 7279 | Ossetian; Ossetic           | 7983 |                       |      |
| Hrwtaski                    | 6779 | Pali                        | 8073 |                       |      |
| Ido                         | 7379 | Panjabi                     | 8065 |                       |      |
| Interlingua (International) | 7365 | Persian                     | 7065 |                       |      |
| Interlingue                 | 7365 | Polski                      | 8076 |                       |      |
| Inuktitut                   | 7385 | Português                   | 8084 |                       |      |

P&F USA, Inc.  
PO Box 430 Daleville, IN 47334-0430

P&F Mexicana, S.A. de C.V.  
Av. La Palma No. 6, Col. San Fernando La Herradura,  
Huixquilucan Edo. de México C.P. 52787



Reproductor de Disco de Video Digital (DVD)

DVP3602/F8

110-127 V ~ 60 Hz

Consumo de Energía Eléctrica

10 Wh

Consumo de Energía Eléctrica del aparato en Modo de Espera

0.5 Wh

Comercializado por : P&F MEXICANA. S.A. DE C.V.

IMPORTADOR: P&F MEXICANA. S.A. DE C.V.

La Palma #6.  
Col. San Fernando La Herradura  
Huixquilucan, Edo. México.  
MEXICO C.P.52787.  
Tel: 52 (55) 5269 - 9000

EXPORTADOR: P&F USA Inc.

HECHO EN: CHINA



**GARANTIA INCLUIDA EN EL INSTRUCTIVO DE USO**

**LEA CUIDADOSAMENTE ESTE INSTRUCTIVO  
ANTES DE USAR SU APARATO.**

