



MIRA

**ELECTRONIC CONTROL BOARD SUITABLE FOR
AUTOMATIONS WITH 1 MOTOR
WITH INPUTS FOR LIMIT SWITCHES**

INSTALLATION AND USER MANUAL

Product designed and manufactured in Italy



CONFIGURATION WITH DIP 1 OFF

WARNING!!! : CHECK ALWAYS THE CONNECTION TYPE
(N.C) NORMALLY CLOSED, (N.O.) NORMALLY OPEN AND
THE CORRESPONDING WIRING

LEDS

AP/PP : OPEN OR STEP BY STEP
CH/STOP : CLOSE OR STOP
FTC : PHOTOCELLS
COS : SAFETY EDGE
L24 : 24V ACCESSORIES POWER SUPPLY

LPR : PROGRAMMING LED

LFC A : OPENING LIMITSWITCH
LFC C : CLOSING LIMITSWITCH

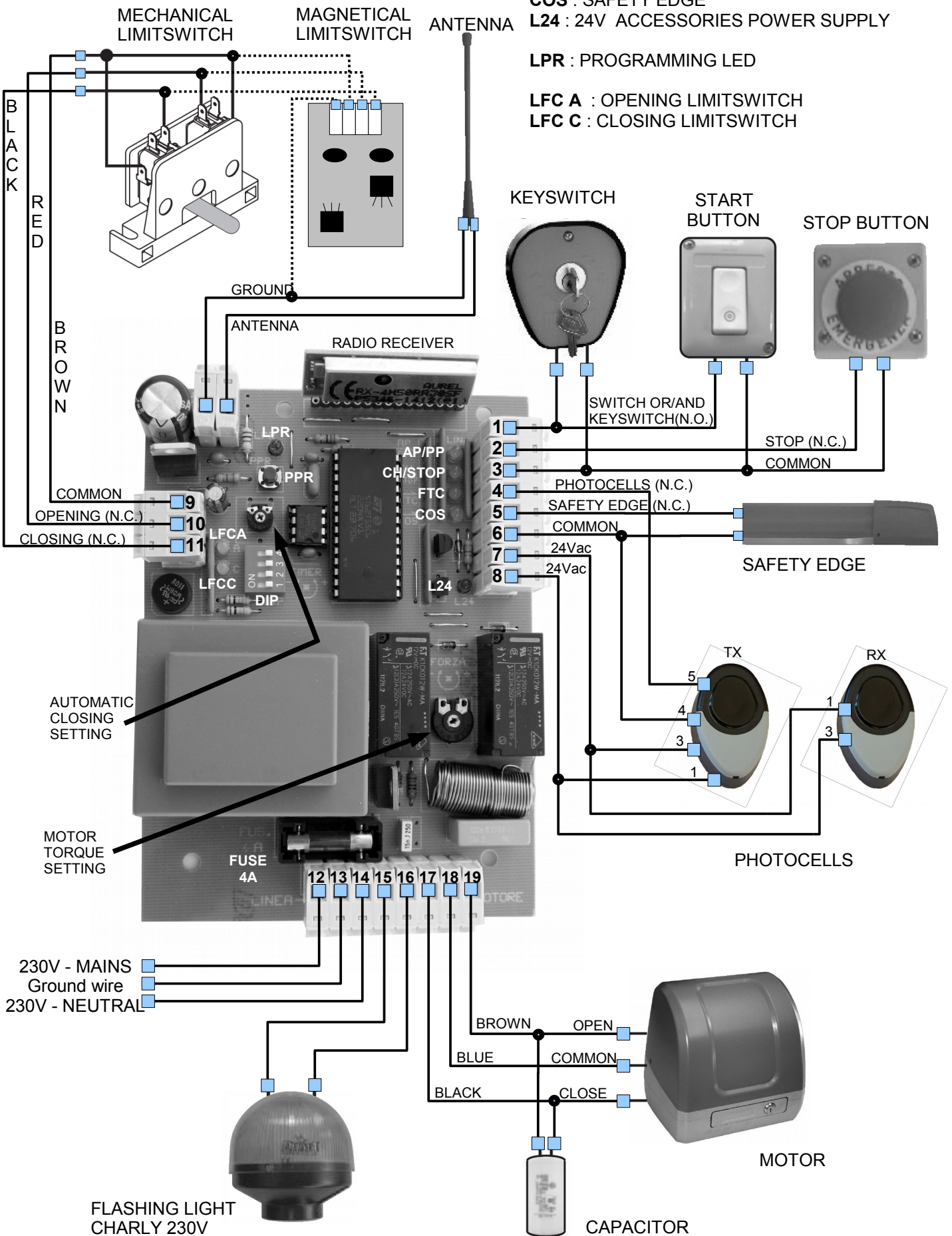

PLEASE BRIDGE STOP, PHOTOCELLS AND SAFETY EDGE IF NOT CONNECTED

CONFIGURATION WITH DIP 1 ON

WARNING!!! : CHECK ALWAYS THE CONNECTION TYPE (N.C) NORMALLY CLOSED, (N.O.) NORMALLY OPEN AND THE CORRESPONDING WIRING

LEDS

- AP/PP : OPEN OR STEP BY STEP
- CH/STOP : CLOSE OR STOP
- FTC : PHOTOCELLS
- COS : SAFETY EDGE
- L24 : 24V ACCESSORIES POWER SUPPLY
- LPR : PROGRAMMING LED
- LFC A : OPENING LIMITSWITCH
- LFC C : CLOSING LIMITSWITCH

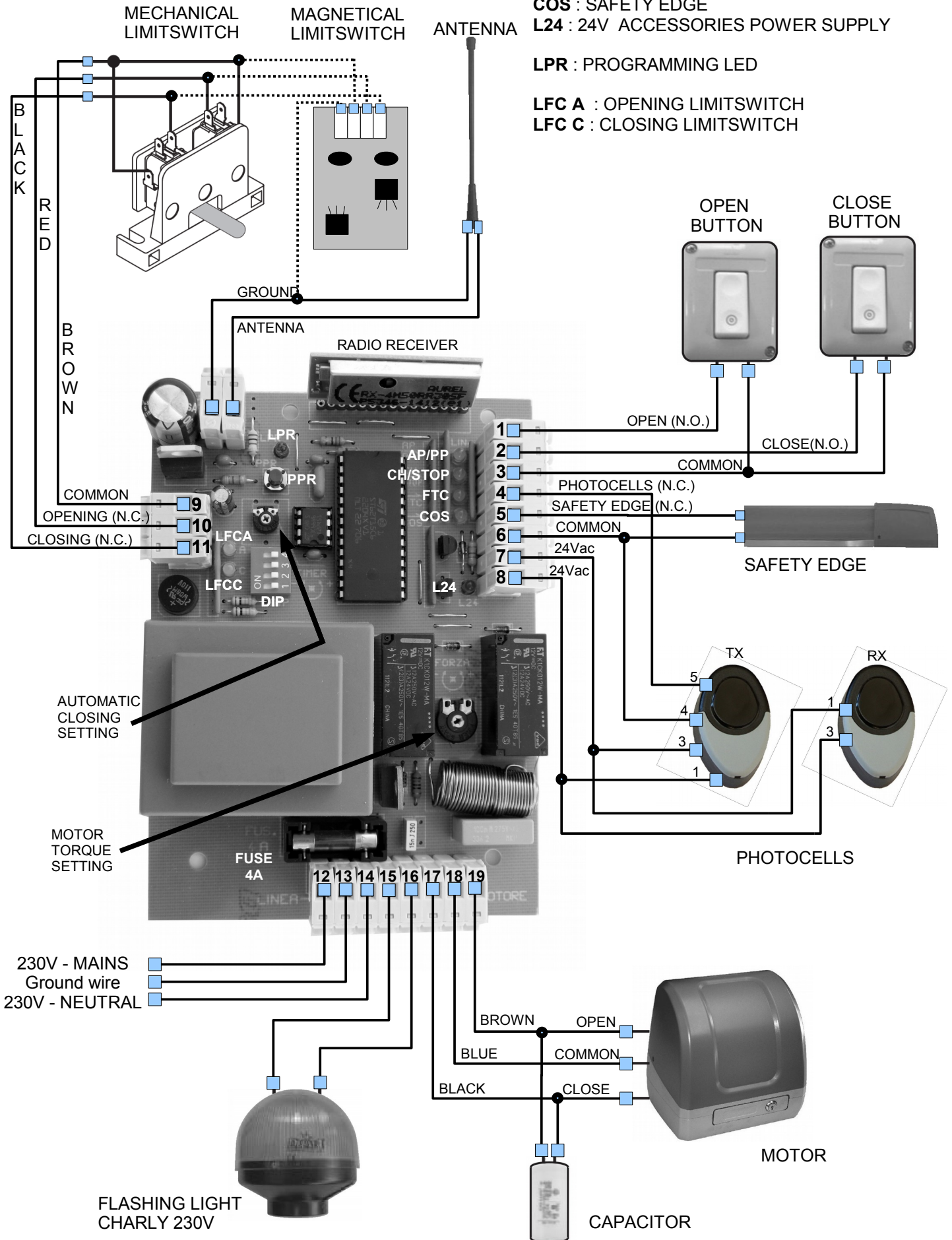

PLEASE BRIDGE STOP, PHOTOCELLS AND SAFETY EDGE IF NOT CONNECTED

INSTALLATION REMARKS

The Mira-L is a simple and innovative control unit that does not require any programming for the work timing.

Working times are set automatically when power is applied to the control unit and after the first movements are performed.

No special actions are required for installers and end users.

The MIRA-L is the first self programming control unit.

In addition 4 switches are available to customize operations.

The input of the mains voltage is protected against voltage surges and the power supply line of the 24V accessories does not need fuses because we have placed a thermal protection inside the transformer.

If there is a shortcircuit on the 24V line the power LED goes off and if the installer does not notice immediately the problem, the processor will shutdown the control unit.

After removing the short-circuit the control unit will restart instantaneously without damage and without replacing any fuses.

The Mira-L is designed to work with mechanical and electronic limit switches and can not be used if there are no limit switches.

WORK TIMING PROGRAMMING:

Automatic, no action required by the installer or end user.

To restore the factory setting, position the gate on the closing limit switch, turn power off, wait 5 seconds, then turn power on again.

PROGRAMMING REMOTE CONTROL CODES:

1. Press and release the button PPR
2. The programming LED starts flashing
3. Press the desired button on the remote control, repeat the operation with all the remotes to store
4. Press the button PPR to exit the programming mode

Please note:

If a code sent by the remote control already exists in memory it will be deleted.

After a few seconds the control unit will automatically exit programming.

ERASING ALL REMOTE CONTROL CODES:

To clear all the remote codes stored in memory press and hold the PPR button until LED lights up again.

PROGRAMMING THE MOTOR TORQUE:

Turn trimmer 1 counterclockwise to increase the torque of the motor.
Turn trimmer 1 in a clockwise direction to decrease the torque of the motor.

PROGRAMMING THE AUTOMATIC CLOSING TIME :

Turn the trimmer 2 counterclockwise to increase the automatic closing time

Turn trimmer 2 clockwise to decrease the automatic closing time or remove it entirely

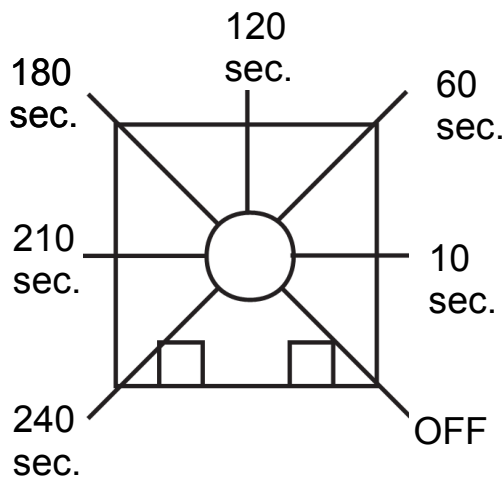

AUTOMATIC CLOSING

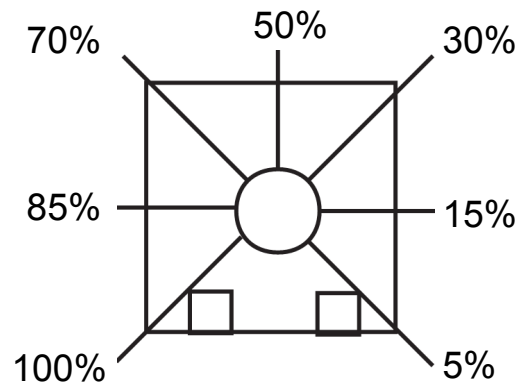

MOTOR TORQUE

CUSTOMIZATION WITH DIP SWITCHES:

DIP 1: Operating logic

OFF: contacts 1 and 2 are working as STEP-BY-STEP (NO) and EMERGENCY STOP (NC)

ON: The contacts 1 and 2 are working as OPEN (NO) and CLOSE (NO)

DIP 2: Remote control logic

OFF: The remote control works with STEP BY STEP logic (start-stop)

ON: The remote control works with CONDOMINIAL logic (executes only opening when fully open sends closing pulse)

DIP 3: Activation inversion for brake

OFF: Inversion turned off

ON: The motor reverses the sens of rotation when it intercepts the limit switches, it working as brake

DIP 4: Direction of travel

This dip changes the motor direction of travel and the limit switches readings without physically having to exchange the electrical connections.

EXAMPLE:

If your sliding gate should open to the right but with the standard wiring instead moves to the left simply reverse the position of DIP from ON to OFF or vice versa. It is not necessary to exchange the electrical connections.

The same principle explained in the above example also applies to doors if the movements of opening / closing are reversed.

SHORT CIRCUIT PROTECTION

In the control unit a fuse is present to protect the mains line input (230V - 4A), there are no fuses for the protection of the 24V line for accessories. In case of a 24V line short circuit the corresponding led will be turned off and the transformer automatic protection will safeguard the control unit components. To restart the control unit remove the short circuit.

WARNINGS!!!

OUR COMPANY, AS MANUFACTURER, CAN NOT BE HELD RESPONSIBLE FOR DAMAGES DUE TO WRONG OR MISSING CONNECTIONS OR DUE TO AN IMPROPER SETTING.

THE SAFETY DEVICES SHOULD BE ALWAYS INSTALLED AND KEPT IN FULL WORKING ORDER.

ONCE TERMINATED THE SYSTEM SETTING THE CONTAINER SHOULD BE PLACED BACK ON ITS POSITION, FASTENING TIGHT ITS SCREWS.

OUR COMPANY, AS MANUFACTURER, CAN NOT BE HELD RESPONSIBLE FOR DAMAGES DUE TO IMPROPER USE OF THE DOOR/GATE.

IT IS FORBIDDEN TO REPLACE ANY ELECTRIC, ELECTRONIC OR MECHANIC PART WITH NOT ORIGINAL SPARE PARTS.

OUR COMPANY, HAS THE RIGHT TO MODIFY OR CHANGE THE ELECTRONIC BOARDS AND MANUALS, WITHOUT PRIOR NOTICE.

ALWAYS REGULATE ACCURATELY THE TORQUE OF THE MOTORS. AN INCORRECT SETTING OF THE TORQUE, MAY CAUSE DAMAGE TO PEOPLE, ANIMALS OR OBJECTS.

WARRANTY:

Devices and accessories are guaranteed for a period of 24 months after production, whose date is printed on each item. The company will replace or repair its devices, provided that they are returned to our factory with the warranty label in good conditions. In case of replacement of the returned items, these will remain property of the company.

The warranty does not include damages due to any incorrect use, such as: non fulfillment of the instruction detailed for each device, maintenance and servicing carried out without the previous written consent of our company. Moreover, warranty does not cover any damage due to wrong tension supply and any other reason for which the manufacturer cannot be made responsible. Any device returned must be delivered to our company with carriage paid and will be sent back with freight collect.

Warranty validity ceases if customer's payments are not fulfilled. Each device manufactured by our company meets the european safety standards.

Our company declines all responsibility for the non-observance of the safety rules by the installers. In order to reduce the time spent for servicing the returned items, all faulty materials which have been sent back to us must be accompanied by the installer description of the item fault.

