

USER MANUAL

Ref: CAR-T50

Wireless door chime with temperature indicator ,150m range



DESCRIPTION

- Choice of 32 chime sounds
- Adjustable volume
- 16 codes selectable
- 200m distance in open air

RECEIVER :

- LED indicator
- 32 chime sounds selectable; Adjustable volume
- Temperature indoor
- Temperature outdoor
- Week indicator
- Date indicator
- Time indicator
- With bracket to stand on desk
- 3x 1.5V LR6 AA batteries (not included)

TRANSMITTERS :

- LED indicator
- IP44
- With rain cap
- Transmission frequency: 433-434 MHz
- 2x 1.5V LR03 AAA batteries (not included)

INSTALLATION

TRANSMITTER :

- Open the battery cover, install 2x 1.5v AAA batteries; take note of the polarities (+ -)
- Set the codes: the transmitter and receiver have the 16 codes selector. It can work only the transmitter and receiver match the same code.

TRANSMITTER :

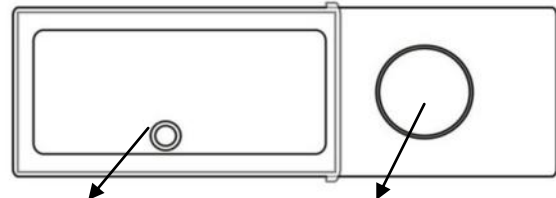

- LED indicator
- Push button

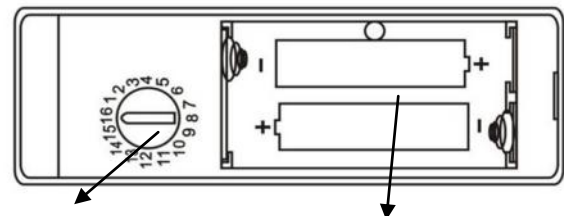

- Codes selector (1-16)
- 2x 1.5V LR03 AAA batteries
- Screw fixing to the rain cap or using Double Sides Adhesive Tape

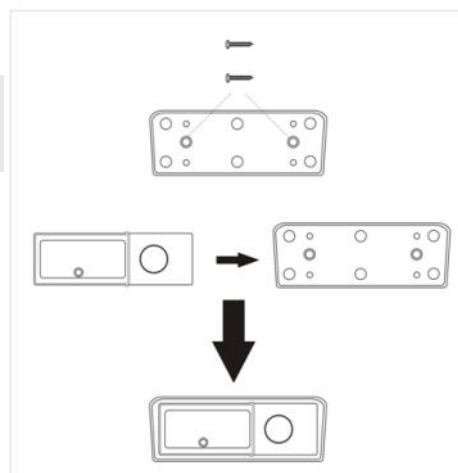
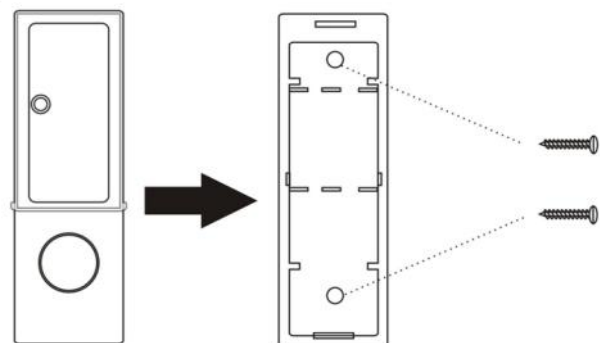

- Rain cap
- Fix the transmitter to the rain cap
- Screw fixing to the wall

INSTALLATION

RECEIVER :

- Open the battery cover, install 3x 1.5v AA batteries; take note of the polarities (+ -)
- Set the codes: the transmitter and receiver have the same 16 codes selector. It can work only the transmitter and receiver match the same code.

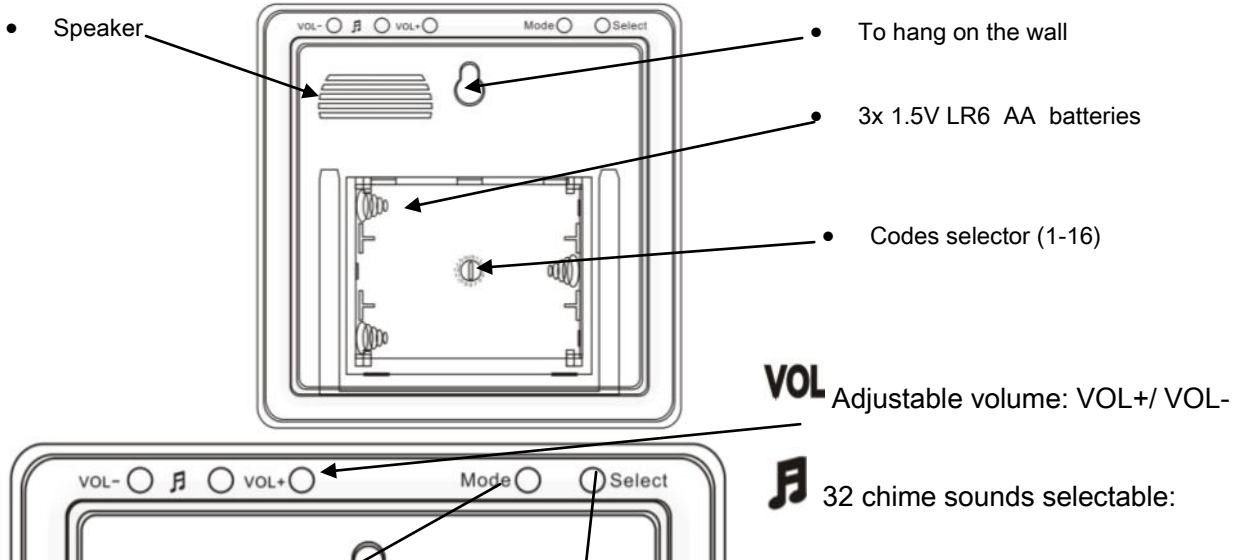

- **Mode:** including:
 - Week indicator
 - Date indicator
 - Time indicator
 - Temperature indoor
 - Temperature outdoor
- **Select.** After you chose a Mode (e.g. Date indicator) by pushing the "Mode" button, you can push the "Select" button to fix; and the relevant number will flash, push the "Select" button, then you can edit and make the correct data, etc.

- By using the "Mode" and "Select" key, you can make the correct data



• Outside temperature is updated every 3mn, so once device has been installed, end-user may need to wait few minutes to get accurate temperature.

- LED indicator

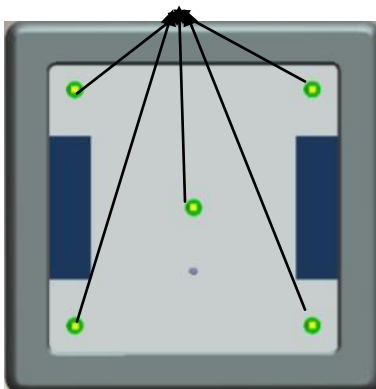

- With bracket to stand on desk

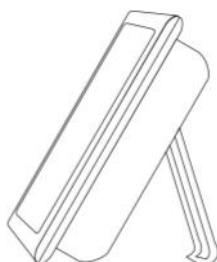

- DC : 5V DC 200mA

