

TESLATRON

ELECTROSTATIC FIELD THERAPY

JP-9000

(Please read this manual carefully before use this device and keep this manual for future reference.)

USER MANUAL



ISO 9001, ISO 13485 CERTIFIED



Importer: FIT FOR LIFE S.R.L.
ADD: Bucuresti, Str. C-tin Brancusi, Nr. 5, Sector 3, Romania
Tel: +40 762 217 911
Web: www.fitforlife.ro

Made in P.R.C.

Table of Contents

Foreword	1
Effects of electric field on cells	
Effects of electric field on blood	
Effects of electric field on meridian	
Effects of electric field on nerves	
Technical specifications	3
Names of parts	4
Functions of buttons	5
Operation methods	7
Illustrations of operation	
Operation methods of the energy cushions	
Operation methods of the Electronic Pen	
Operation methods of sleep field	
Output checking	9
Checking of electric potential field	
Checking of high cycle energy field energy	
Scope of application & Contraindications	10
Scope of application	
Contraindications	
Remarks & Warnings and Indicating Instructions	11
Remarks	
Warnings and Indicating Instructions	
Maintenance and Repair	12
Troubleshooting	
Corresponding table between field energy mode and field energy strength	
Responsibility Exemption	13
Any of the following cases is out of our responsibilities	
Warnings	
Accessory list	13

Preface

Thank you for choosing our electrostatic field therapy device Teslatron. It will make your healthy life better and better! Teslatron acts on the body by employing electric field physiotherapy, with the purpose of realizing health care and auxiliary treatment. Please read carefully this manual to master the correct operation methods before operation.

Mechanism

1.Effect of electric field on cells

Human body is made up of approximately 60 trillion cells. Each static cell has cellular potential(field). Under the effects of membrane potential, the cells make the surrounding sodium ions, calcium ions and chlorine ions become gradient array and carry metabolic activities in the forms of ion exchange.

By cellular metabolic activities, we get to know the mechanism of action potential: the most important part for sustaining cellular metabolism is various mineral ions. In intracellular fluids, the potassium and sodium ions can produce a action potential. From determination analysis, it is known that, 2 ions are being exchanged inside the cell at a dramatic rate of 1% second.

2.Effect of electric field effects on blood

Blood takes up 1/12 of the body weight, i.e a man weighs 60Kg has approx. 5 liter blood. Blood not only replenishes various nutrients and fresh air to the body, but also carries out the metabolic decomposition from various tissues, blocks and neutralizes various bacteria. The blood of healthy people is of weak alkalescency (pH 7.35~7.44). While the blood of the people who are sub-healthy and ill is prone to acidity, this is because the calcium ions in the blood decrease but the manganese ions increase. When blood is acidic, its viscosity can increase and a great amount of organic matters (such as triglyceride,

cholesterol, etc.) stay in the blood and adhere to the inner wall of the blood vessel, becoming the key factor to cause atherosclerosis, cardiovascular and cerebrovascular diseases.

Medical specialists often say “acid constitution is the source of all diseases” . Therefore, preventing blood from being acidic is the important precondition to keep healthy. The energy of electric potential field can effectively increase the calcium ions in the blood and bring all the minerals in the blood into full play, thus to purify the blood and adjust pH value to the normal state (slight alkalescency). In order to keep a slightly alkaline state, the high speed vibration function of the high-cycle field energy can help you, in addition, it can effectively massage the blood vessels and accelerate the separation of the matters clinging to the blood vessels and restore the elasticity of the blood vessels. In order to keep the blood in a slightly alkaline state, it is necessary to eat fresh alkaline food (such as vegetables), release psychic pressure and have good living habits physically and spiritually.

3. Electric field effects on meridians

As a Chinese proverb says “meridian blockage leads to pain” , the Traditional Chinese Medicine emphasizes on the blood recycling and smooth meridians. According to modern science research findings, “Qi” in “Qi Xue” refer to the “Dian Qi” , i.e. the biocurrent of the human body. As the continuous movement and recycle of the bio-current in the body, in the ancient China, people had Taiji, also called as “enclosed body biologic exchange” . The blockage of the meridians indicates the potential of cells is not in balance. With the action



of the electric field, the potential of cells can restore to normal, local resistance can be lowered and current can flow through, thus, with electric field, the meridians can be opened, blood and biological current can be smooth and diseases and illnesses can be eradicated.

4. Electric field effects on nerves

The brain obtains information from and sends commanding information to every tissue via the neural system distributing all over the whole body. The information the neural system transmits, according to modern scientific research findings, is a kind of electric signal. If the potential of the neural cells is out of balance, resistance will greatly increase and the current will be blocked. The blockage of electric signals can cause illnesses of related nerves and tissues. With the action of the high potential and negative ions, the potential of the neural cells can be restored, the resistance lowered, the current kept smooth, the electric signals of the neural system transmitted smoothly; therefore, the illnesses of the related tissues disappear and the tissues recover to their healthy state.

Technical Specifications

Field Energy Mode	High Potential/ Negative Potential	Sleep Field	Light Wave
Field Energy Strength	±1500V ±3500V ±5000V ±9000V	1500V	2000V
Operating Time Setting	30 minutes ~6 hours		
Dimensions	Φ 261mm* h520mm		
Working Environment Temperature	5~40℃(-40~55℃ during transportation and storage)		
Relative Humidity	≤80%(≤93% during transportation and storage)		
Atmospheric pressure	86~106kPa(70~106kPa during transportation and storage)		
Power Consumption	20W±10%		
Rated Power Supply	AC 220V± 22V/ 50Hz±1Hz		

Names of parts



Main energy cushion (extendable)
Every function of the rehabilitation device is exported through this energy cushion. The user sits or lies on the energy cushion. Via the extension jack, one more energy cushion can be linked together.



Auxiliary energy cushion (non-extendable)
Every function of the rehabilitation device is exported through this energy cushion. The user sits or lies on the energy cushion, which is only for one person.



Energy cushion for sleep field
It is especially for sleep field exportation. Receiving treatment during sleep is both time-saving and more efficient.



Electronic Pen (acupuncture type and massage type)
Electronic Pen , via high-voltage discharge, produces air ions flow, high-voltage micro current and local stimulation effect, thus can lower the excitability of some nerves, promote blood circulation and remove blood stasis, diminish inflammation and ease pain and quickly eliminate symptoms of local numbness, swelling and pains.

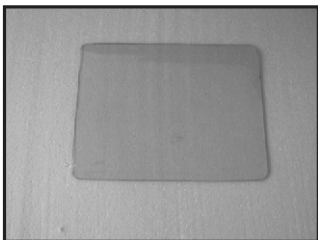

Isolation cushion
While in treatment, it is placed on the surface, separating the user and the earth to ensure the safety of treatment.



Controller
With “Mute” button, you could operate or stop the voice function. For friendly use, we have separated buttons for different modes.

Functions of Buttons

1. “POWER” button: power on / off the device.
2. “RUN/PAUSE” button: it is for starting/pause the operation after selecting the operation mode, treatment potential and treating time.
3. “MODE” button: it is for selecting the HIGH POTENTIAL/NEGATIVE POTENTIAL mode, SLEEP FIELD mode, LIGHT WAVE ENERGY mode and AUTO mode.
“AUTO” mode: Both high potential/negative potential modes has its AUTO mode, and follows the sequence of 1500V-3500V-5000V-9000V-1500V and -1500V--3500V--5000V and --9000V—1500V respectively and recycles automatically. Each voltage runs for 2 minutes and switches to the next voltage. The starting potential is $\pm 1500V$ respectively. “LIGHT WAVE ENERGY” mode: it is for selecting light wave energy, the potential is set as 2000V. “SLEEP FIELD” mode: it is for selecting sleep field energy, the potential is set as 1500V. “HIGH POTTENTIAL/NEGATIVE POTENTIAL” mode: it is for selecting high potential/negative potential field, the starting potential is $\pm 1500V$.
4. “VOLTAGE SELECTION” button: Only after having selected the “HIGH POTENTIAL/NEGATIVE POTENTIAL” mode, pressing this “VOLTAGE SELECTION” button is allowed. Starting from 1500V, each press switches to next potential, follows the sequence of 1500V-3500V-5000V-9000V-1500V and recycles.
5. “TIME SETTINGS” : it is used to set the operation time of the device. The shortest time setting is 30 minutes, longest is 360 minutes (6 hours). The timer calculates the operating time only, and does not calculate the interval of pause.
6. “VOICE” Button, : Long press the “Voice button” for 3 seconds, it will display a voice level, then quick press the button to adjust voice as you wish.
7. “Negative Ion” Button: for starting/shut off the negative ion function.

Remarks:1. When the device is in use, it is not valid to choose “Mode Selection” and “Voltage Selection”.

Voice prompt for operation panel

Press " POWER"	Welcome to use electrostatic field therapy device, please select mode of treatment, intensity of treatment,time of treatment, press startup button to begin.
Press " MODE SELECTION"	"High potential mode is selected", "Negative potential mode is
Press "VOLTAGE SELECTION"	"Intensity level 1", "Intensity level 2", "Intensity level 3", "Intensity level 4"
Press"NEGATIVE ION"	"Negative ion functin starts", "Negative ion function closes"
Press "RUN/PAUSE"	"Treatment starts", "Treatment stops"

Functions of Buttons

Buttons Directives on Operation Panel

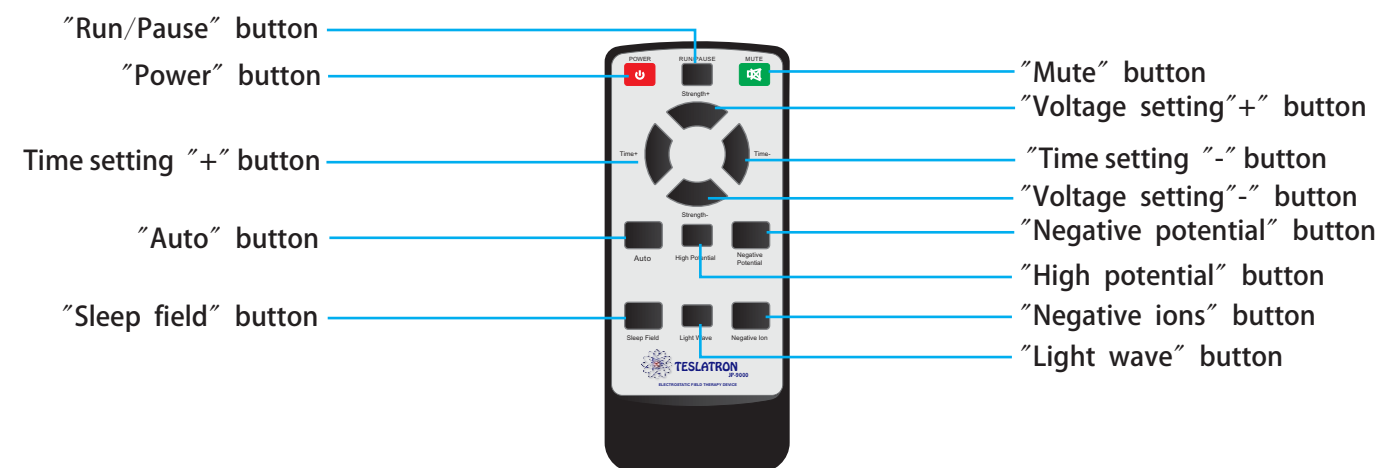
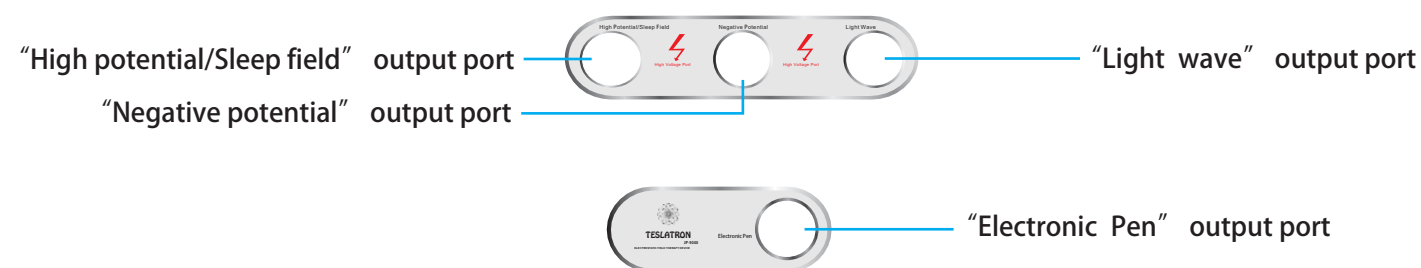
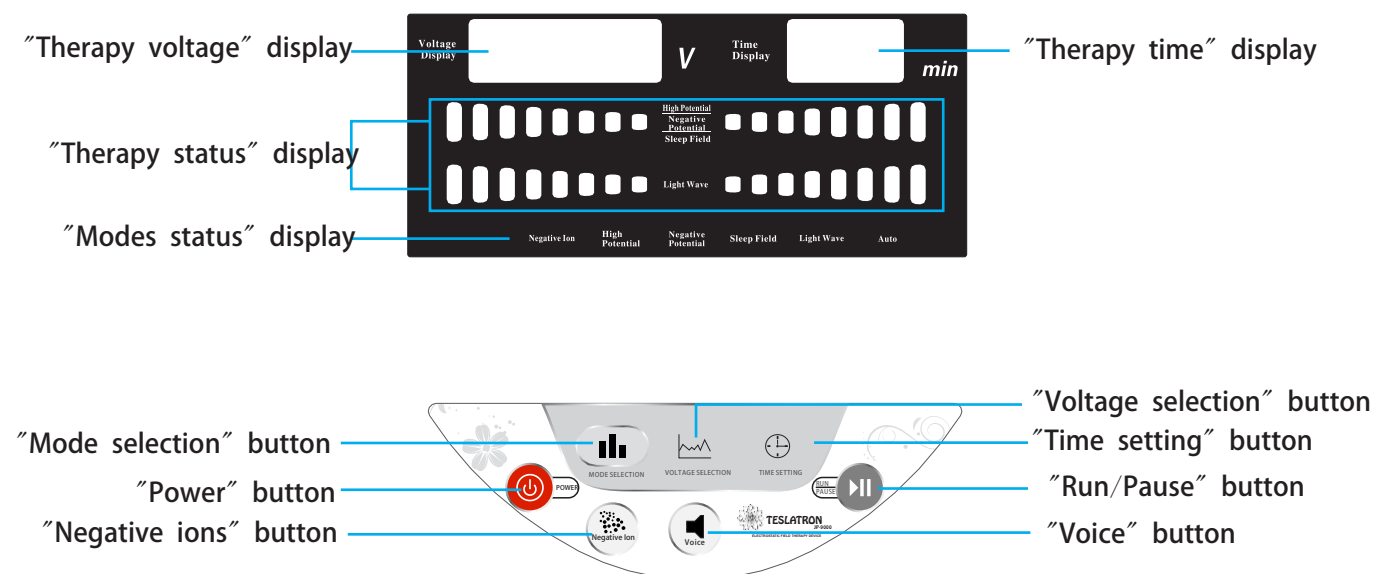

Operation Methods

1. Illustration of operation

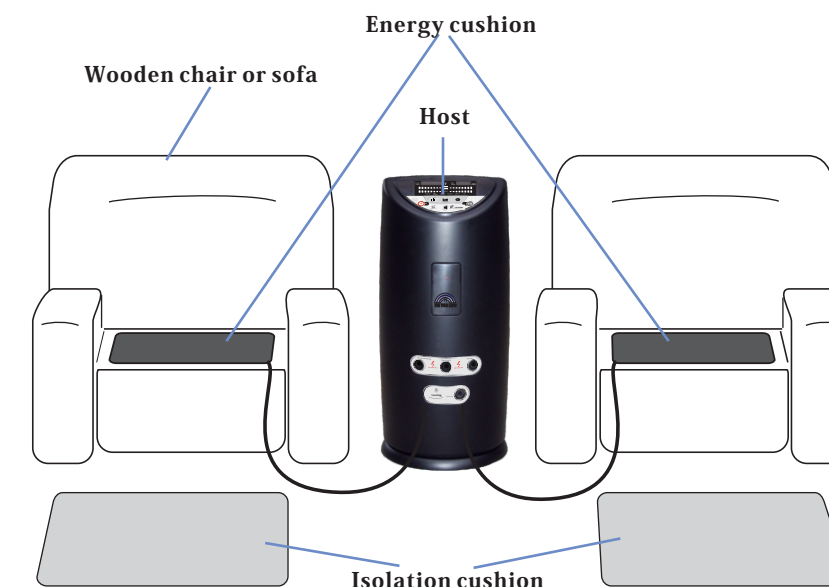

2. Operation methods of the energy cushion

- 1). Install the device in a dry place with good ventilation and keep the host more than 20cm away from the wall.
- 2). Lay the energy cushion on wooden furniture (chair, bed). Keep the lead of the energy cushion more than 20cm away from the ground and wall, and insert the input terminal of the energy cushion into the output terminal of the field energy mode required.
- 3). Connect to the power supply and turn the power switch on the back of the device on. When the standby indicator light is on, it indicates that the device is in standby state. Press the "POWER" button, and the power indicator light is on, which indicates that the device is on. In power-on state, press "POWER" button, the power indicator light is off, which indicates that the device is off.
- 4). The default open mode is "AUTO" mode, the "AUTO" mode indicator light is on. The starting high potential/negative potential has been set as 1500V. (When in operation, the high potential/negative potential follows this sequence 1500V-3500V-5000V-9000V-1500V, automatically recycles and switches to the next level every 2 minutes.) Pressing the "MODE" button can switch the operation mode.
- 5). When switching to "HIGH POTENTIAL/NEGATIVE POTENTIAL" mode, the corresponding indicator light is on, then, pressing "VOLTAGE SELECTION"

button is allowed. Each press switches the potential to the next level, follows this sequence 1500V-3500V-5000V-9000V-1500V.

- 6). When switching to sleep field energy mode, sleep energy field mode light is on. Then, “VOLTAGE SELECTION” button is not allowed, the potential indicator displays as “1500V” .
- 7). When switching to Light Wave energy mode, the indicator light of the Light Wave energy mode is on. Then, the “VOLTAGE SELECTION” button is not allowed, the therapy potential indicator displays as “2000V” .
- 8). After the field mode and therapy potential selection are chosen, press the “TIME SETTINGS” button. Each press extends 30 minutes, the longest is 360 minutes. In case the set time is over 360 minutes, it will automatically set as 30 minutes.
- 9). After therapy time is set, the user sits on the energy cushion (the feet of the user must be on the isolator 20cm above the earth), pressing the “RUN/PAUSE” button, the device starts treatment. Then the operating indicator light flickers, which indicates it is in operation. Pressing the “RUN/PAUSE” button during operation stops the therapy.
- 10). After starting operation, if you need to adjust the therapy potential or operating time, press the “RUN/PAUSE” button to discontinue operation, then press the “VOLTAGE SELECTION” button to switch the therapy potential, then press the “TIME SETTINGS” button to set the therapy time, then press the “RUN/PAUSE” button to start operation again.

3.The operation methods of the Electronic Pen

- 1). Insert the plug of the energy cushion into the output terminal of the high potential or negative potential, the user seats on the energy cushion;
- 2). Properly connect the Electronic Pen with isolating handle and insert the input terminal of the Electronic Pen into the output terminal of the device.
- 3). First, select the potential of 1500V, press the “START” button to start operation, hold the Electronic Pen, approach to (or hit) the local area to be strengthened. If there is no soreness and numbness or the sensation is too weak, then increase the therapy potential untill proper sore and numb sensation appear.

Warning

- 1). No start is allowed if no energy mode or therapy potential are selected.
- 2). The energy cushion must be connected to the selected output socket of field energy mode.
- 3). The input terminal of the Electronic Pen must be inserted into the Electronic Pen output terminal.

4.The operation methods of sleep field

- 1). Lay the special energy cushion for sleep field under the bedsheet or mattress;
- 2) Insert the plug of the energy cushion into the output terminal of the sleep field.
- 3) Press the “MODE” button to select “SLEEP FIELD” mode, and select proper therapy time (no visible feeling, does not affect sleep), press the “RUN/PAUSE” button to start operation.

Output Checking

In order to confirm whether the therapy device has output, regular checking should be conducted. The checking methods are as follows:

1.Checking of electric potential field

Starting the device, adjust the therapy potential to 9000V and press “RUN/PAUSE” button. Put the palms (slightly) onto the energy cushion, and shaking on the palms should be felt.

2.Checking of Light Wave energy

Starting the device, adjust the field energy to Light Wave and press the “RUN/PAUSE” button. Check around the experiencing person by holding and electrical test pen (or fluorescent lamp tube); the electrical test pen (or fluorescent lamp tube) will light up.

Warning

During checking, the operator must wear shoes and keep dry.

Scope of Application & Contraindications

● Scope of application

Applicable to auxiliary treatment for neurasthenia, neck-shoulder-waist-leg pain (caused by pain of cervical vertebra, lumbar vertebra, lumbago muscle strains, osteoarthritis, scapulohumeral periarthritis, soft-tissue sprains, strains and bruises).

● Contraindications

1. Patients with pace maker or implanted metal;
2. Patients with severe cardio-cerebrovascular diseases;
3. Patients with debilitating heart, lung and kidney functions;
4. Pregnant women and women in menstruation;
5. Patients with malignant tumor or acute infectious diseases;
6. Patients in high fever and with high fever diseases;
7. Patients with bleeding disease in bleeding period;
8. Patients in recovery after heart surgery;
9. Patients with structural heart disease.

● IT IS PROHIBITED TO

1. Contact other persons physically when using this therapy device;
2. Use this device during lightning, thunderstorm or in a humid environment;
3. Transfer objects to other persons when using this device;
4. Use other device at the same time.

Remarks & Warnings and Indicating Instruction

Remarks

Before use

- 1) Please read the user manual carefully before using the device, follow proper indications and obviate contraindication.
- 2) Strictly stick to the operation instructions in user manual.
 - a. Take off the metal objects, such as mobile, watch, key, glasses, etc.
 - b. Make sure to use the device in completely insulation state. Keep the host, energy cushion and the wire 20cm or above away from the wall and ground.
 - c. Keep the home appliances (such as TV, radio, etc.) 2 metres away from the host and energy cushion.
 - d. Children, sufferers of metal retardation and mental diseases must not use this device without professional supervision.
 - e. Never use the device in a wet environment, such as wet head, body or clothes.
 - f. Never use the device simultaneously with other similar device or other electrical appliance.
 - g. Before use, the user should sit on the energy cushion with two feet on the insulation pad (or other insulator) and 20cm or more above the ground.
 - h. Do not place the energy cushion on the chest or broken skin; people with uncontrolled hypertension or debilitation should use it with caution.
 - i. Women in menses should not receive treatment.

During use

- 1) Stop using it temporarily and consult the professionals if experiencing symptoms of dizziness, headache and rapid heart beat the first time you use the device.
- 2) During use, never touch other people or objects (such as wall, ground, etc.), especially around metal objects; do not pass any object; and do not fold the energy cushion.
- 3) Immediately stop using and turn off the device when thunder and lightning occurs.
- 4) After the device starts working, anyone with pacemaker implant can not approach to the device.
- 5) For the first time users and for weak and/or old users, start from little time and low field energy and gradually prolong treatment time and increase field strength according to the situation.
- 6) Strictly follow the user manual to install, operate the device and receive treatment; prohibit to prolong the treatment time at will beyond the preset time.
- 7) If abnormality occurs during use, immediately power off the device and contact the distributor or manufacturer for consultation or repair; the user can not disassemble and repair the device cushion without permission.
- 8) Prohibit to insert any conductor into the field energy output of host or the jack of the energy to avoid high-voltage shock.

After use

- 1) When finish the treatment, turn off the operation. Only after hearing the reminding ending sound (beep) of the device, can the user leave the energy cushion.
- 2) Keep the device clean all the time. Before clean it make sure to power off it. Clean it with a wet towel. Never use it until it is completely dry.
- 3) Be sure to use 220V AC. After use, switch off the main power so as to keep the device free of power.

Warnings and Indicating Instructions

1. If abnormality cannot be solved by instructions in the user manual, or abnormality that is not mentioned in the user manual occurs, please contact your distributor.
2. Discontinue the treatment once abnormality happens after using the device, and go to see a doctor and follow doctor's recommendations.

Maintenance and Repair

1. Maintenance

- a.Keep it in a dry and well ventilated place;
- b.Do not keep it in a place in direct sunshine;
- c.Shut off the power after use or when leaving the device unused for a long time;
- d.Clean the cover of energy cushion regularly; when the cover is dirty, please take it off and clean with general detergent. Reuse only after sterilization with sunshine;
- e.Do not share the socket with other electronic appliance;
- f.Please cut off the power and do not use the device when there is thunder or lightning or the weather is very humid;
- g.Never use the device when it's damp and watery;
- h.Do not rudely draw out the power cord and cable;
- i.Keep the well packed device in a well ventilated place with humidity no higher than 80% and no corrosive gas.
- j.Please cut off the power and contact the distributor or manufacturer when abnormal failure occurs.

2. Troubleshooting

Failure	Causes	Solutions
Standby indicator light does not light up	Maybe the power cord is not well plugged	Insert the power cord properly
Standby indicator light does not light up	Maybe the power switch is not turned on	Turn on the power switch
Standby indicator light does not light up	The fuse may be burned out	Replace the fuse
Output strength reduces	Maybe the energy cushion lead contacts with the ground, a wall, etc.	Keep the energy cushion at least 20cm away from the ground and walls.

3.Corresponding table between field energy mode and field energy strength

Field Energy Mode	High Potential/ Negative Potential	Sleep Field	Light Wave	Auto mode
Field Energy Strength	± 1500V ± 3500V ± 5000V ± 9000V	1500V	2000V	Each voltage (1500V, 3500V, 5000V and 9000V) runs for 2 minutes

Responsibility Exemption

1. Any of the following cases is out of our responsibilities

- 1)The damage from irresistible natural disasters such as fire, earthquake, war, etc.
- 2)The damage due to the error or mistake of the user.
- 3)The device is disassembled or modified before sent for repair.

2.Warnings

- 1)The copyright and interpretation right of this user manual are reserved by us. Without our permission, the contents of the user manual cannot be altered or duplicated.
- 2)Should any difference between the user manual and the actual product, the product shall govern. We have the right to change the information in the user manual without further notification and we reserve the final interpretation rights.
- 3)The illustrations in this user manual are very simple and abstract.
- 4)We try our best to reach accuracy, but subtle errors can not be avoided. Should any errors are found, please contact us.
- 5)The pictures for the parts in the user manual are for reference only. The actual products in the package shall govern.

Accessory List

SN	Name	QTY	Unit
1	Energy Cushion	2	sheet
2	Energy Cushion for sleep	1	sheet
3	Insulation pad	2	sheet
4	Electronic Pen	1	pcs
5	Power Cable	1	pcs
6	Fuse	2	pcs
7	User Manual	1	copy
8	Warranty Certificate	1	sheet