



Mitsubishi PLC

2001 No.156E

NEW PRODUCT RELEASE

Type Q6TE-18S Spring Clamp Terminal Block

New!

Introducing a new terminal block for the Q Series that reduces the number of wiring steps!

For the spring clamp terminal block (Q6TE-18S)

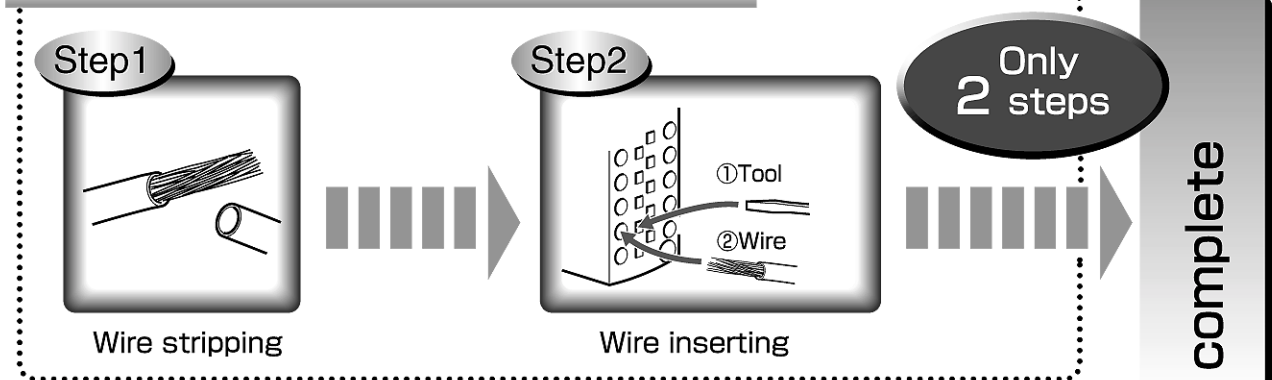

For the screw-type terminal block

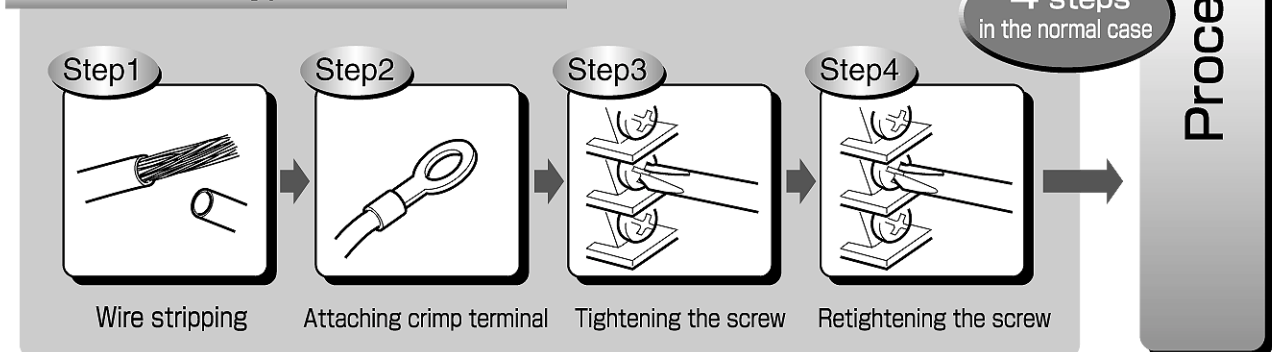

- What is the 'spring clamp terminal block'?

The spring clamp terminal block prevents poor contact and wire loosening due to vibration by securing the wire conductor with the constant spring force of the metal fixture inside it. This offers high contact reliability.

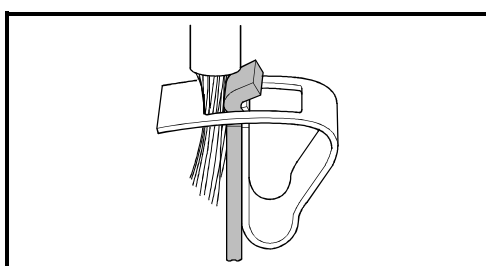

[Features]

(1) Reduction in the number of wiring steps!

It requires only two steps, wire stripping and wire inserting.

(2) High reliability!

The spring force of the metal fixture secures the wire, which prevents loosening of the wire due to varying manual installation, or wire damage and momentary disconnection due to vibration.

(3) Less maintenance work required!

The Q6TE does not use screws to secure the wire, therefore no retightening is required, eliminating the risk of screws being loosened due to vibration.

[Specifications]

Item	Specifications
Applicable wire size	0.3 to 1.5mm ² (AWG22 to 16)
Wire strip length	8 to 11mm
Mounting screw tightening torque range	66 to 89N•cm
Weight	0.07kg

[Compatible Models]

The Q6TE-18S should be attached to a Q-series 16-point terminal block type I/O unit or intelligent function unit.

The following models are compatible with the Q6TE-18S.

Model type	Model name					
I/O module	QX10	QX28	QX40	QX40-S1	QX70	QX80
	QY10	QY18A	QY22	QY40P	QY50	QY68A
	QY70	QY80	QX48Y57	QI60		
Intelligent function module	Q62DA	Q64DA	Q68DAV	Q68DAI		
	Q64AD	Q68ADV	Q68ADI			
	Q64TCRT	Q64TCRTBW	Q64RD			

Point
<p>The terminal numbers of the Q6TE-18S are equivalent to those of the compatible modules.</p> <p>Please refer to the User's Manual of the module for information regarding the signal names corresponding to the terminal numbers, when connecting with an external device.</p>

[How to use]

(1) Removal of terminal block

- Unscrew the two terminal block mounting screws situated at the top and bottom of the terminal block.
- Gently remove the terminal block.

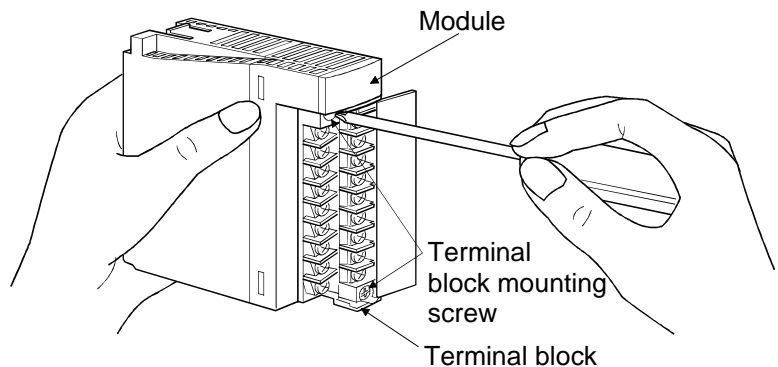

(2) Installation of Q6TE-18S

- Attach the Q6TE-18S to the module.
- Tighten the terminal block mounting screws within the specified torque range.

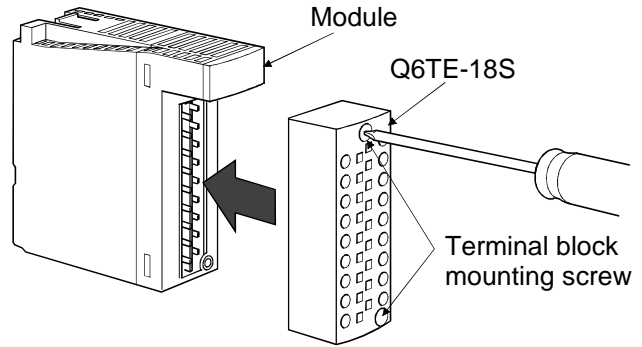

(3) Cable Installation

Insert the tool into the square shaped hole, which corresponds to the terminal you wish to use. While the tool is inside the hole, insert the wire into the circular shaped hole (as shown below). Remove the tool from the square shaped hole, taking care not to remove the wire. After the wire has been clamped, gently pull the wire to confirm that it is secure.

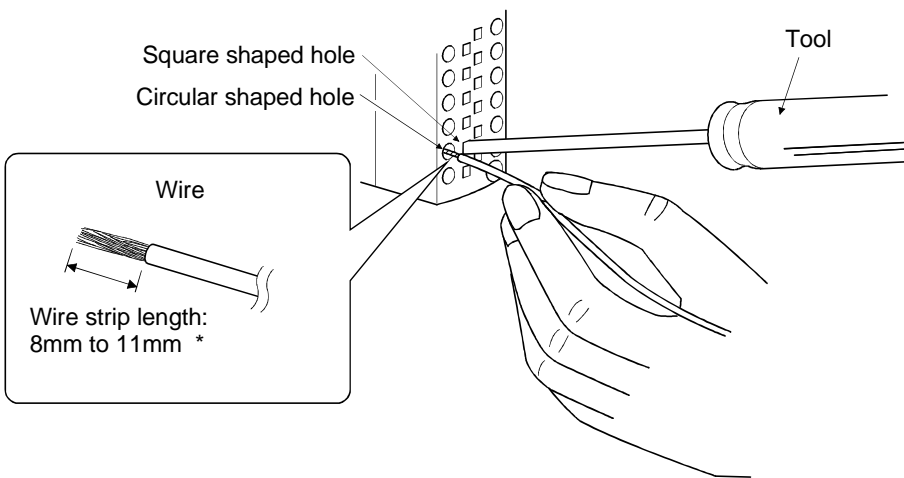

[Caution]

* Take care that the wire strip length is between 8mm to 11mm. If the wire strip length is too long, this will expose the bare wire, which increases the risk of electric shock or short circuit. If the wire strip length is too short, this will result in the wire not being securely attached.

(4) Cable removal

Insert the tool into the corresponding square shaped hole until it stops, which releases the clamp. Gently pull the wire out of the hole completely, remembering to keep the tool firmly inside the hole.

[External Connections]

Q6TE-18S

Installed on a module (Example: QX10)

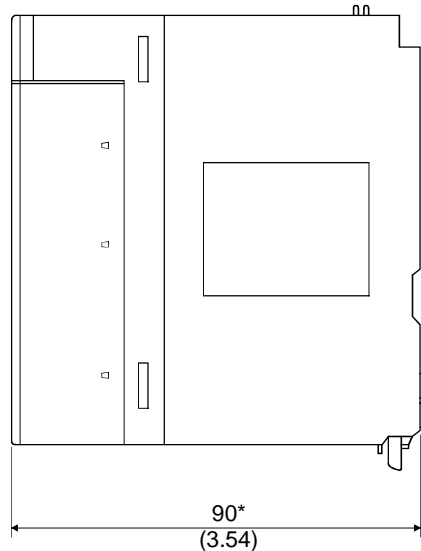
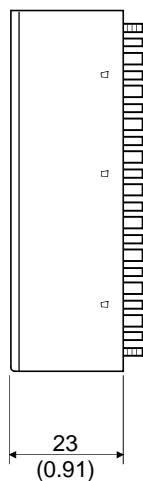
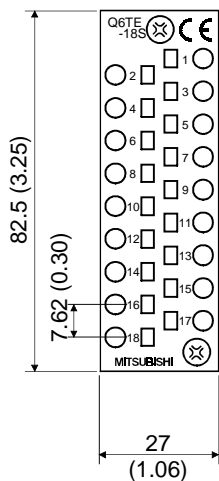

Unit: mm(inch)

*: The depth of the module installed with a Q6TE-18S is equivalent with the factory default dimensions for that module.

[Manual]

Manual name	Manual shipping form	IB/SH number	Model code
Spring Clamp Terminal Block Module Model Q6TE-18S User's Manual	Enclosed with product	IB-0800204	13JT72
I/O Module Type Building Block User's Manual	Sold separately	SH-080042	13JL99

Country/Region	Sales office	Tel/Fax
U.S.A	Mitsubishi Electric Automation Inc. 500 Corporate Woods Parkway Vernon Hills, IL 60061	Tel : 1-847-478-2100 Fax : 1-847-478-0328
Brazil	MELCO-TEC Rep. Com.e Assessoria Tecnica Ltda. Av. Rio Branco, 123-15 ,and S/1507, Rio de Janeiro, RJ CEP 20040-005, Brazil	Tel : 55-21-221-8343 Fax : 55-21-221-9388
Germany	Mitsubishi Electric Europe B.V. German Branch Gothaer Strasse 8 D-40880 Ratingen, GERMANY	Tel : 49-2102-486-0 Fax : 49-2102-486-717
U.K	Mitsubishi Electric Europe B.V. UK Branch Travellers Lane, Hatfield, Herts., AL10 8XB, UK	Tel : 44-1707-276100 Fax : 44-1707-278695
Italy	Mitsubishi Electric Europe B.V. Italian Branch Centro Dir. Colleoni, Pal. Perseo - Ingr.2 Via Paracelso 12, 20041 Agrate B., Milano, Italy	Tel : 39-039-6053301 Fax : 39-039-6053312
Spain	Mitsubishi Electric Europe B.V. Spanish Branch Carretera de Rubi 76-80 08190 - Sant Cugat del Valles, Barcelona, Spain	Tel : 34-935-653135 Fax : 34-935-891579
South Africa	Circuit Breaker Industries LTD. Private Bag 2016, Isando 1600, Johannesburg, South Africa	Tel : 27-11-928-2000 Fax : 27-11-392-2354
Hong Kong	Ryoden International Ltd. 10th Floor, Manulife Tower, 169 Electric Road, North Point, HongKong	Tel : 852-2887-8870 Fax : 852-2887-7984
China	Ryoden International Shanghai Ltd. 3F Block5 Building Automation Instrumentation Plaza 103 Cao Bao Rd. Shanghai 200233 China	Tel : 86-21-6475-3228 Fax : 86-21-6484-6996
Taiwan	Setsuyo Enterprise Co., Ltd. 6F., No.105 Wu-Kung 3rd.RD, Wu-Ku Hsiang, Taipei Hsine, Taiwan	Tel : 886-2-2299-2499 Fax : 886-2-2299-2509
Korea	HAN NEUNG TECHNO CO.,LTD. 1F Dong Seo Game Channel Bldg., 660-11,Deungchon-dong Kangsec-ku, Seoul, Korea	Tel : 82-2-3668-6567 Fax : 82-2-3664-8335
Singapore	Mitsubishi Electric Asia Pte, Ltd. 307 ALEXANDRA ROAD #05-01/02, MITSUBISHI ELECTRIC BUILDING SINGAPORE 159943	Tel : 65-473-2480 Fax : 65-476-7439
Thailand	F. A. Tech Co.,Ltd. 898/28,29,30 S.V.CITY BUILDING,OFFICE TOWER 2,FLOOR 17-18 RAMA 3 ROAD,BANGKONGPANG,YANNAWA,BANGKOK 10120	Tel : 66-2-682-6522 Fax : 66-2-682-6020
Indonesia	P.T. Autoteknindo SUMBER MAKMUR JL. MUARA KARANG SELATAN BLOK A UTARA NO.1 KAV. NO.11 KAWASAN INDUSTRI/ PERGUDANGAN JAKARTA - UTARA 14440	Tel : 62-21-663-0833 Fax : 62-21-663-0832
India	Messung Systems Put,Ltd. Electronic Sadan NO:111 Unit No15, M.I.D.C BHOSARI,PUNE-411026	Tel : 91-20-7128927 Fax : 91-20-7128108
Australia	Mitsubishi Electric Australia Pty. Ltd. 348 Victoria Road, PostalBag, No 2, Rydalmere, N.S.W 2116, Australia	Tel : 61-2-9684-7777 Fax : 61-2-9684-7245

MITSUBISHI ELECTRIC CORPORATION

HEAD OFFICE : 1-8-12, OFFICE TOWER Z 14F HARUMI CHUO-KU 104-6212, JAPAN
NAGOYA WORKS : 1-14, YADA-MINAMI5, HIGASHI-KU, NAGOYA, JAPAN