

MAGIC 5

User Manual



PHILIPS

Dear Customer,

In purchasing this machine, you have decided on a quality PHILIPS product. Your machine satisfies the full range of requirements for private use or in everyday office and business environments.

Your machine is sold with a free ink film inserted for a few test pages. You do not require a Plug'n'Print card for this ink film (= chip card with information on the ink film capacity).

In the telephone book of your machine, you can save entries with multiple numbers and collect multiple entries into groups. You can assign various ring tones to the entries.

You can assign short dial numbers to frequently dialled telephone numbers. You can load these numbers quickly with the short dial button and the number buttons.

The built-in answering machine saves up to 30 minutes of messages. You can record internal and external voice messages (= memos). You can listen to new messages from any telephone using the remote control function. With the VIP code, callers can also reach you even while the answering machine is switched on.

You can send fax messages in various resolutions to one or more recipients or a group. You can also poll faxes and offer documents for polling.

Five fax templates, which you can use, are stored in your device. With these templates you can quickly create, for example, a short fax note or an invitation.

Select the resolution for text and photo in order to copy documents with your machine. You can also create multiple copies.

You can send SMS messages from your machine if this service is activated for your telephone line (this function is not supported in all countries and networks). Received SMS messages can be managed with the extensive functions of the SMS menu.

Activate notification by SMS to receive an SMS message, for instance on your mobile phone, when calls, fax transmissions or other messages arrive in your absence (this function is not supported in all countries and networks).

If you want, your device can print Sudoku puzzles in four different difficulty levels with solution.

We hope you enjoy your machine and its many functions!

About this User Manual

With the installation guide on the following pages, you can start using your machine quickly and easily. Detailed descriptions can be found in the following sections of this user manual.

Read the entire user manual carefully. Follow all safety instructions in order to ensure proper operation of your machine. The manufacturer accepts no liability if these instructions are not followed.

Symbols Used



Warns about dangers for people, damage to the machine or other objects as well as possible loss of data. Injuries or damage can result from improper handling.



This symbol designates tips that will help you to use your machine more effectively and easily.

Installation Guide

Package Contents

- ❶ Machine
 - ❷ Telephone handset
 - ❸ Spiral cable for telephone handset
 - ❹ Paper tray
 - ❺ Power cable with plug (country-specific)
 - ❻ Telephone cable with plug (country-specific)
- User manual with installation guide (not depicted)

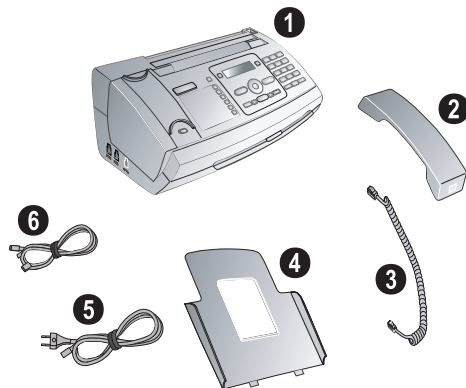

💡 If one of the parts is missing or damaged, please contact your retailer or our customer service.

Attaching the Paper Tray

Insert the paper tray into the openings behind the paper feed mechanism.

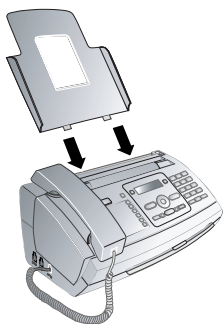

Inserting Paper

Before you can receive or copy documents, you must insert paper. Please use only suitable paper in the standard format **A4** (210 × 297 millimetre · preferably 80 g/m²). Observe the information in the technical data.

💡 Separate the paper sheets by fanning them out, then align them by tapping edge of the stack lightly against a flat surface. This will prevent several sheets of paper from being drawn in all at once.

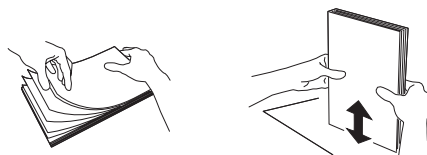

- ❶ Pull the lever on the right next to the paper feed mechanism forward.
- ❷ Insert the paper into the paper feed mechanism. You can insert a **maximum of 50 pages** (A4 · 80 g/m²).
- ❸ Push the lever on the right next to the paper feed mechanism back to lock the paper.

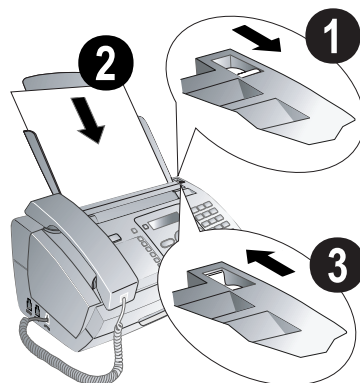

Connecting the Handset

Plug one end of the spiral cable into the socket on the telephone handset. Insert the other end into the socket designated with the ☞ symbol.

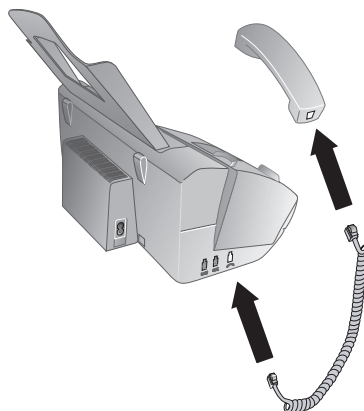

Connecting the Telephone Cable

Connect the telephone cord to the device by inserting it in the socket designated with **LINE** (RJ-11-Connector). Insert the telephone plug into your telephone connection socket.

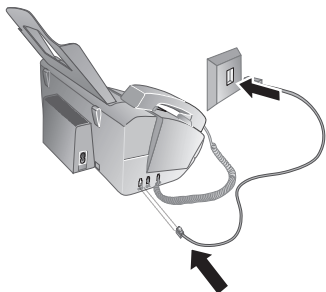

 If you connect your device as extension to a telephone system, you must set it for working as an extension (also see Chapter "Telephone connections and additional devices, page 25).

Connecting the Power Cable

 Check whether the power type of your machine (indicated on the type plate) matches the power type available at the setup location.

Insert the power cable into the connection located on the rear side of the machine. Connect the power cable to the electrical socket.

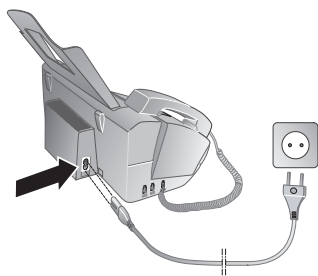

Initial Installation

After you connect your device to the mains, the initial installation commences. Press **[i]**. Your device prints a help page.

Selecting the Language

- 1 Use **▲/▼** to select the desired display language.
- 2 Confirm with **OK**.

Selecting the Country

 Always set the country in which you are operating the machine. Otherwise, your machine is not adapted to the telephone network. If your country is not included in the list, you must select a different setting and use the correct telephone cable for the country. Consult your retailer.

- 1 Use **▲/▼** to select the country in which you are operating the machine.
- 2 Confirm with **OK**.

After this input, the machine prints another help page and checks the telephone line.

Entering Your Number

Your number and name are printed in the top margin of every page (= header) together with the date, time and page number.

- 1 Enter your telephone number. You can enter a plus sign with **Ⓢ** or **Ⓢ***.
- 2 Confirm with **OK**.

Entering Your Name

- 1 Enter your name. Letters are entered with the number buttons (see labels). Enter special characters with **Ⓢ**. Press the respective button repeatedly until the desired letter or special character appears on the display.

 You can move the cursor with **▲/▼**. You can delete individual characters with **C**.

- 2 Confirm with **OK**.

After the input, the machine prints an overview of the functions.

Entering the Time and Date

- 1 Enter the time, for example **ⓈⓈ ⓈⓈ ⓈⓈ** for 2 o'clock p.m.
- 2 Enter the date (two digits for each field), for example **ⓈⓈ ⓈⓈ ⓈⓈ ⓈⓈ** for June 8th, 2007.
- 3 Confirm with **OK**.

 You can restart the initial installation process any time. Press **[i]** and **[2]**.

Overview

Overview of the Menu Functions

The following functions are available on your device. There are two ways in which you can call functions:

Navigating in the menu: Press **OK** or one of the two arrow keys **▲/▼** to open the function menu. Page through **▲/▼** menu entries. Use **OK** to select a function. Press **C** to return to the previous menu level. Press **STOP** to close the menu and return to the starting mode.

Calling functions directly: You can call a menu function directly using the function number. Press **OK** and enter the appropriate function number using the numeric keypad. Confirm using **OK**. You will find the function number in the following list.

 Press **[1]** and **[6]** to print a list of all functions and settings of your device.

I Telephone Book

①① Looking up an entry	page 10
①② New entry.....	page 10
①③ Creating groups	page 11
①④ Short dialling	page 11
①⑤ Modifying an entry	page 11
①⑥ Deleting entries	page 11
①⑦ Printing entries	page 12

2 Calls

②① Received calls.....	page 10
②② Outgoing calls	page 10
②③ Printing entries	page 24

3 Fax

③① Polled reception.....	page 17
③② Polling send.....	page 17
③③ Transmission with delay	page 17
③④ Sending to multiple recipients (= broadcast).....	page 16
③⑤ Fax journal	page 23
③⑥ Transmission report.....	page 23
③⑦ Print reduced in size	page 22
③⑧ Transmission speed.....	page 22

4 Miscellaneous

④① Call log.....	page 23
④② Call Waiting.....	page 12
④③ Fax templates.....	page 17
④④ Contrast	page 22
④⑤ Service code	page 30
④⑥ Ink film stock	page 28
④⑦ Firmware version	page 24
④⑧ Sudoku	page 21

5 Fax Switch

⑤① Day.....	page 23
⑤② Night.....	page 23
⑤③ Timer	page 23
⑤④ Easylink	page 26
⑤⑤ Ringer Tone.....	page 22

6 SMS

⑥① Sending SMS	page 19
⑥② Reading SMS	page 19
⑥③ Printing SMS	page 20
⑥④ Deleting SMS	page 20
⑥⑤ Communication by SMS	page 19
⑥⑥ SMS access.....	page 20

7 Answering Machine

⑦① Activation	page 13
⑦② Messages	page 13
⑦③ Short messages	page 15
⑦④ Recording time	page 15
⑦⑤ Outgoing message.....	page 13
⑦⑥ Only outgoing message (= external memo).....	page 13
⑦⑦ Forwarding	page 14
⑦⑧ VIP Code.....	page 15
⑦⑨ Access code	page 14

9 Settings

⑨① Time/Date	page 22
⑨② Language selection	page 22
⑨③ Country selection.....	page 22
⑨④ Your Number	page 22
⑨⑤ Your name	page 22
⑨⑥ Connection type	page 25

Machine Overview

- ❶ Handset
- ❷ Paper tray
- ❸ Document feeder (printed part up)
- ❹ Panel with display
- ❺ Telephone handset socket – connection socket for the telephone handset
- ❻ **EXT**-Socket – connection socket for additional devices
- ❼ **LINE**-Socket – connection socket for telephone cord

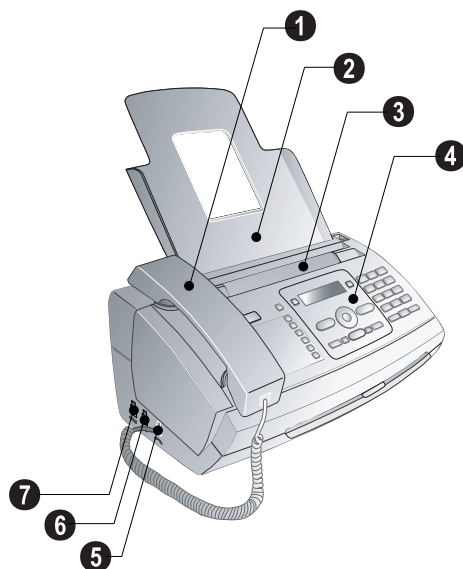

- ❶ Scanner
- ❷ Rollers of the automatic document feeder
- ❸ Rests of the intake rollers
- ❹ Document guide / scanner film
- ❺ Cover for scanner and automatic document feeder
- ❻ Toothed wheel for tightening the ink film
- ❼ Ink film roll in the rear ink film compartment
- ❸ Ink film roll in the front ink film compartment
- ❹ Slot for the Plug'n'Print card
- ❺ Locks for the cover of the scanner and automatic document feeder

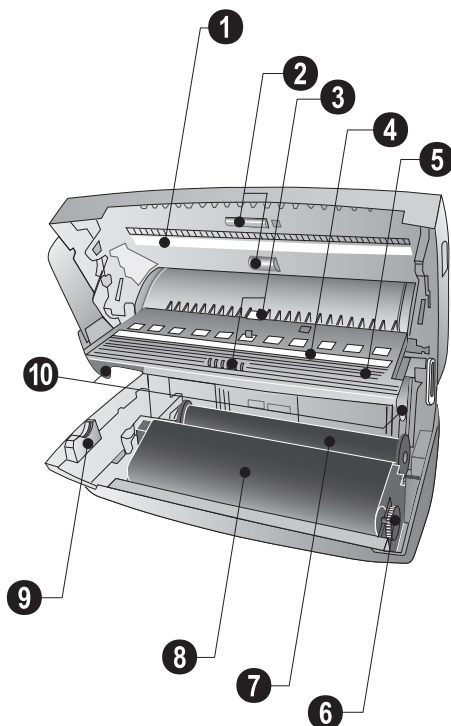



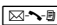

Panel

—Lights up, if new messages are received / list of the new messages with submenus / blinks in the case of device error (for example no ink film)

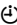
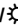
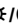
[0-9]—Press briefly: Recalling short dial numbers. Selecting the entries with the ▲/▼ or numeric keys / press and hold: Assigning short dial entry

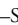
[A-Z]—Press briefly: Calling up the telephone book entries. Selecting the entries with the ▲/▼ / press and hold: saving new entries

  —Setting the timer and the fax reception modes (= fax switch). Modes set on the display  (day),  (night). Activated timer also with 

STOP—Function abort / return to the output mode / documents eject / ending message playback

C—Return to the previous menu level / press briefly: deleting individual characters / press and hold: deleting complete entry / during a playback: Deleting individual message / in the starting mode: Deleting all messages

▲/▼—Calling the menu functions / navigation within the menu / selecting options / moving the cursor / adjusting the volume level

OK—Calling the menu functions/ confirming input

START—Press briefly: Starting transmission of messages / press and hold: Starting fax polling

—Calling answering machine menu

i—Press briefly: Printing help pages and setting lists / press and hold: Starting initial installation process

COPY—Press briefly: creating a copy / press and hold: creating multiple copies

—Setting higher resolution for faxes and copying (RESOL.: STANDARD, RESOL.: FINE, RESOL.: PHOTO)

—Calling the SMS menu (function is not supported in all countries and networks)

Numeric keypad—Inputting digits, characters and special characters / press and hold: Recalling short dial numbers

—Press briefly: List of the last ten numbers dialled (= redialling list) / press and hold: List of last ten callers (caller list)

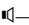
—Dialling with the handset replaced / hands-free

R—Switching between calls (= call hold) / inserting dialling pause / outside line access code

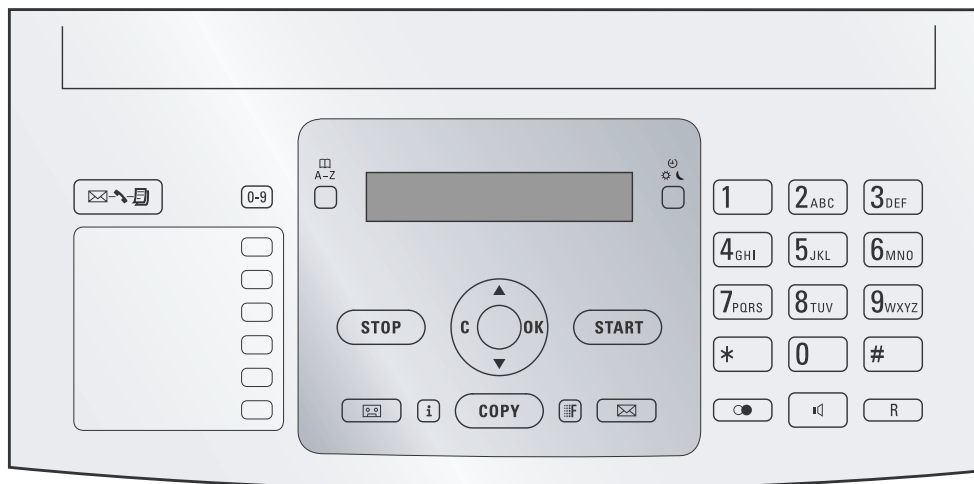

General Safety Information

Your machine has been tested in conformity with standards EN 60950-1 and IEC 60950-1 and should only be operated with telephone networks and power systems that meet these standards. The machine was built exclusively for use in the indicated sales region.

Do not make any changes or settings that are not described in this user manual.

Setting Up the Machine

The machine should rest securely on a stable, flat surface. If the machine should fall, it can be damaged or cause injury to people, especially small children. The distance between the machine and other devices or objects must be at least 15 centimetres; this also applies to the use of additional cordless telephones. Do not place the machine in the vicinity of radios or televisions. Position all cables in such a way that no one will stumble on them, thus avoiding possible injuries to persons or damage to the machine itself.

Lock the cover of the machine completely into place when opening the machine. You could be injured if the cover falls while you are working on the machine.

Protect the machine against direct sunlight, heat, large temperature fluctuations and moisture. Do not place the machine in the vicinity of heaters or air conditioners. Observe the information on temperature and humidity in the technical data.

The machine must have sufficient ventilation and may not be covered. Do not put your machine in closed cabinets or boxes. Do not place the machine on soft surfaces such as tablecloths or carpets and do not cover the ventilation slits. Otherwise, the machine can overheat and catch on fire.

In the event that the machine becomes too hot, or if you see smoke coming from the device, you must immediately pull the power cable out of the power socket. Have your machine examined by trained professionals at a technical service location. To prevent the spread of fire, open flames should be kept away from the machine.

Do not plug in the machine in moist rooms. Never touch the power plug, power connection or the telephone socket with wet hands.

Do not allow liquids to enter into the machine. Disconnect the machine from the power socket if liquids or foreign objects have entered the machine and have your machine examined by trained professionals at a technical service location.

Do not allow children to handle the machine without supervision. The packing materials should be kept out of the hands of children.

Caution, metallic objects may be retained if placed near or on the handset receiver.

Power Supply

Check whether the power type of your machine (indicated on the type plate) matches the power type available at the setup location. Use only the power and telephone cables supplied.

Set up your machine so that the power socket is easily accessible. The machine does not have an on/off button. In an emergency, disconnect your machine from the power supply by pulling the power plug.

Never touch the power or telephone cable if the insulation is damaged.

Disconnect your machine from the power and telephone networks during an electrical storm. If this is not possible, do not use the machine during an electrical storm.

Before cleaning the surface of your machine, disconnect it from the power and telephone networks. Never use liquid, gaseous or easily flammable cleansers (sprays, abrasives, polishes, alcohol).

Only clean the display with a dry, soft cloth. If the display breaks, a mildly corrosive liquid may escape. Avoid all contact with your skin and eyes.

In the event of a power failure, your machine will not function; saved data is retained.

Repairs

Should disruptions occur, follow the instructions on the display and on the error report.

Do not make any repairs to the machine yourself. Improper maintenance can result in injuries or damage to the machine. Only have your device repaired by an authorised service centre.

Do not remove the type plate from your machine; this would void the warranty.

Consumable Materials

Use only original consumable materials. These are available from a specialised retailer or through our order service. Other consumable materials could damage the machine or shorten its service life.

Dispose of old consumable materials according to the waste regulations of your country.

Table of Contents

Dear Customer,	2	5 SMS	19
About this User Manual	2	SMS Requirements	19
Installation Guide	3	Sending an SMS	19
Package Contents	3	Notification by SMS	19
Attaching the Paper Tray	3	Receiving an SMS	19
Inserting Paper	3	Reading an SMS	19
Connecting the Handset	3	Loading SMS Functions	20
Connecting the Telephone Cable	4	Printing an SMS	20
Connecting the Power Cable	4	Deleting an SMS	20
Initial Installation	4	Changing Settings	20
Overview	5	6 Fun and Games	21
Overview of the Menu Functions	5	Sudoku	21
Machine Overview	6	7 Settings	22
Panel	7	Entering the Time and Date	22
General Safety Information	8	Selecting the Language	22
1 Telephone Functions	10	Selecting the Country	22
Making Telephone Calls on the Machine	10	Entering Your Number	22
Chain Dialling	10	Entering Your Name	22
Inserting a Dialling Pause	10	Setting the Contrast	22
Hands-Free	10	Lowering the Transmission Speed	22
Recording a telephone conversation	10	Switching Page Adjustment On and Off	22
Telephone Book of the Machine	10	Setting Ring Tones	22
Groups	11	Configuring the Fax Switch	23
Short Dial	11	Printing Lists and Help Pages	23
Printing the Telephone Book	12	Starting the Initial Installation	24
Caller Line Identification Presentation (CLIP)	12	Checking the Firmware Version	24
Missed Calls	12	8 Telephone Lines and Additional	
Switching Call Waiting On and Off	12	Devices	25
2 Answering Machine	13	Configuring Telephone Lines and Services	25
Switching On and Off	13	Connecting Additional Devices	25
Editing the Outgoing Message	13	Using Additional Telephones (Easylink)	26
Listening to Messages	13	9 Service	27
Deleting Messages	14	Changing the ink film	27
Setting Up Forwarding and Remote Control	14	Checking the Ink Film Reserve	28
Using the Remote Control	14	Fixing a Paper Jam	28
Remote Control Functions	15	Fixing a Document Jam	29
Recording Internal Memos	15	Cleaning	29
Changing Settings	15	Using Service Codes	30
3 Fax	16	Power Cycling	30
Sending a Fax	16	10 Appendix	32
Manually Sending a Fax	16	Technical Data	32
Broadcasting	16	Guarantee	32
Delayed Fax Transmission	17	Declaration of Conformity (DoC)	33
Receiving Faxes	17	Customer Information	36
Polling Faxes	17		
Using Fax Templates	17		
4 Copier	18		
Inserting Documents	18		
Creating a Copy	18		
Creating Multiple Copies	18		

I Telephone Functions

 Press **1** and **3** to print an overview of the telephone book functions.

How to connect additional telephones and what functions are available to you can be found in the section on telephone lines and additional devices, page 25.

Making Telephone Calls on the Machine

Dial the desired telephone number. There are multiple ways to do this. Then lift up the handset.

 You can also lift up the receiver first, then dial a number. The dialling process starts immediately.

Manual dialling: Dial the desired telephone number with the number pad.

Telephone book:

1 Press **A-Z**

 You can also load telephone book entries by pressing **OK**, **1** and **OK**.

2 Use **▲▼** to select an entry. Enter the initial letters with the number buttons to navigate more quickly in the telephone book.

 You can save an entry multiple times with the same name but in a different category. In the telephone book, the first letter of the category appears after the entry.

Short dial: Press **0-9**. Select the desired entry with **▲▼** or the number button.

 You can also load short dial entries by holding the respective number button pressed (for at least two seconds).

Redial list: Press **☎**. Use **▲▼** to select an entry from the list of dialled numbers.

 You can also load the redial list by pressing **OK**, **2** and **OK**.

Caller list: Hold **☎** pressed (for at least two seconds). Use the **▲▼** to select an entry from the list of callers.

 You can also load the caller list by pressing **OK**, **2** and **OK**.

 For this function to work, the caller line identification (CLIP) must be activated for your telephone connection (country and network dependent). The number and name will not be shown if the caller suppresses his number.

Chain Dialling

You can combine and edit manually entered digits and saved entries, before the dialling process starts. If you have saved, for example, the telephone number prefix of an inexpensive telephone service provider (call-by-call) as a telephone book entry, select this entry and manually enter the subsequent telephone number or select another saved entry.

Inserting a Dialling Pause

It can be necessary to insert a dialling pause into the telephone number, for instance for the outside line access code, for an extension or sub-address or in a long distance number. Press **R**. The second part of the number is only dialled once the connection with the main number has been established.

Hands-Free

1 Press **📞** to dial without lifting up the handset. You will hear a dial tone from the loudspeaker.

2 Enter the desired number using the numeric keypad or dial a saved entry. The dialling process begins immediately. Any incorrectly entered numbers can no longer be changed now.

 Put the handset near the device with the microphone facing up in order to achieve an optimum communication.

Recording a telephone conversation

You can record a telephone conversation. After recording, the **📞** button flashes, and you can hear the recording like a message on the answering machine.

 You must inform your caller when recording a telephone conversation.

1 During a telephone call, press **📞**. The recording begins.

2 Press **📞** again to end the recording.

Telephone Book of the Machine

In the telephone book of your machine, you can save entries with multiple numbers and collect multiple entries into groups. You can assign various ring tones to the entries. Observe the information in the technical data.

 You can move the cursor using **▲▼**. Use **C** to delete individual digits. Press **STOP** to close the menu and to return to the starting mode.

Saving Entries

1 Press and hold **A-Z** (at least two seconds).

2 Enter the name. You can enter characters using the numeric keys (see button labels) Press **0** to enter special characters. Press the respective key several times until the desired character or special character appears on the display.

- 3 Confirm using **OK**.
- 4 Using **▲/▼**, select the category for which you would like to enter a number: **CATEGORY: HOME**, **CATEGORY: WORK**, **CATEGORY: MOBILE** or **CATEGORY: FAX**.
- 5 Confirm using **OK**.
- 6 Enter the telephone number.
- 7 Confirm using **OK**.
- 8 You can assign a ring tone to the number. Using the numeric keys from **0** to **9**, select a ring tone. Using **▲/▼** you can set the volume.
- 9 Confirm using **OK**. The entry is saved.

Editing an Entry

- 1 Press **OK**, **1** **3** and **OK**.
- 2 Using **▲/▼** select the entry which you would like to edit.
- 3 Confirm using **OK**.
- 4 Edit the name.
- 5 Confirm using **OK**.
- 6 Using **▲/▼** select the number you would like to enter.
- 7 Confirm using **OK**.
- 8 Edit the number.
- 9 Confirm using **OK**.
- 10 You can assign a ring tone to the number. Using the numeric keys **0** to **9** select a ring tone. Using **▲/▼**, set the volume.
- 11 Confirm using **OK**.

Deleting an Entry

- 1 Press **OK**, **1** **6** and **OK**.
- 2 Use **▲/▼** to select the entry you would like to delete.
- 3 Confirm with **OK**.
- 4 Confirm **DELETE: YES** with **OK**.

Groups

You can combine several telephone book entries into a group. A message is sent to all members of this group in succession.

Adding Group Entries

- 1 Press **OK**, **1** **3** and **OK**.
- 2 Use **▲/▼** to select the group you would like to create.
- 3 Confirm with **OK**. You can add entries to the group, display the members of the group, delete the group or send a fax to the group.
- 4 Use **▲/▼** to select **ADD MEMBER?**.
- 5 Use **▲/▼** to select the entry you would like to add to the group.
- 6 Confirm with **OK**.
- 7 Repeat steps 4 to 6 to add additional entries to the group.
- 8 Press **STOP** to end the input.

Displaying Group Entries

- 1 Press **OK**, **1** **3** and **OK**.
- 2 Use **▲/▼** to select the group you would like to display.
- 3 Confirm with **OK**.
- 4 Use **▲/▼** to select **VIEW MEMBERS?**.
- 5 Confirm with **OK**.
- 6 Page through the entries of the group with **▲/▼**.
- 7 Press **STOP** twice to return to the starting mode.

Deleting Individual or All Group Entries

Deleting an Individual Entry

- 1 Press **OK**, **1** **3** and **OK**.
- 2 Using **▲/▼** select the group from which you would like to delete entries.
- 3 Confirm with **OK**.
- 4 Select using **▲/▼** **DELETE MEMBER?**.
- 5 Confirm with **OK**.
- 6 Using **▲/▼** select the entry which you would like to delete.
- 7 Confirm with **OK**.
- 8 Select using **▲/▼** **DELETE: YES**.
- 9 Confirm with **OK**. The entry is deleted.



Deleting a Group

- 1 Press **OK**, **1** **3** and **OK**.
- 2 Use **▲/▼** to select the group you would like to delete.
- 3 Confirm with **OK**.
- 4 Use **▲/▼** to select **DELETE MEMBER?**.
- 5 Confirm twice with **OK**.
- 6 Use **▲/▼** to select **DELETE: ALL**.
- 7 Confirm with **OK**. All entries in the group are deleted.

Short Dial

You can assign short dial numbers to frequently dialled telephone numbers. You can load these numbers quickly with the short dial button and the number buttons.

Assigning or Changing a Short Dial Entry

- 1 Hold **0-9** pressed (for at least two seconds).
 You can also load the function by pressing **OK**, **1** **4** and **OK**.
- 2 Use **▲/▼** or the respective number button to select the short dial number you would like to assign or change.
 If you select a short dial number that is already assigned, the entry is overwritten.
- 3 Confirm with **OK**.
- 4 Use **▲/▼** to select the telephone book entry you would like to assign as a short dial entry.
- 5 Confirm with **OK**.

Deleting a Short Dial Entry

 This function not only deletes the short dial entry, it also deletes the entire entry from the telephone book. Overwrite the short dial entry if you would like to change the assignment.

1 Press **0-9**.

 You can also load the function by pressing **OK**, **1** **4** and **OK**.

2 Use **▲/▼** or the respective number button to select the entry you would like to delete.

3 Press **C**.

4 Confirm the deletion with **OK**.

 For this function to work, the caller line identification (CLIP) must be activated for your telephone connection (country and network dependent). The number and name will not be shown if the caller suppresses his number.

1 Press **OK**, **4** **2** and **OK**.

2 Use **▲/▼**, to select whether you would like to turn the call waiting on or off.

3 Confirm using **OK**.

 You can switch between the calls (= call toggling) with **R**.

Printing the Telephone Book

Press **OK**, **1** **7** and **OK**. The machine prints a list with the telephone book entries and saved assignments.

Caller Line Identification Presentation (CLIP)

(country and network dependent)

The number of an incoming call appears on the display. For this function to work, the caller line identification (CLIP – Caller Line Identification Presentation) must be activated for your telephone connection. Enquire with your telephone company. Caller identification may be associated with a fee.

 If the caller line identification does not work even though the function is activated for your telephone connection, check if you have set the correct country (also see Chapter "Settings", Page 22)

Missed Calls

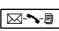
If you received a call while away, the  - button flashes.

1 Press .

2 Using **▲/▼**, you can page through the list of missed calls.

 If you have received additional messages, first select the missed calls using **▲/▼** and confirm with **OK**.

3 To call back, pick up the handset.

 Your machine displays the name with which you have saved the number in the telephone book. The number and name will not be shown if the caller suppresses his number.

Switching Call Waiting On and Off

During a call, you can be informed about another call by a notification tone (= call waiting) Contact your telephone company to inquire about whether or not this additional function is available for your line.

2 Answering Machine

 Press **[1]** and **[3]** to print an overview of the answering machine functions.

Switching On and Off

 If you do not record a personal announcement, the answering machine uses the anonymous announcement set by the factory.

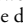
Press **[2]** three times to turn the answering machine on or off. If the answering machine is turned on, the symbol  appears on the display.

 You can also load the function by pressing **OK**, **[7]** **[1]** and **OK**.

Editing the Outgoing Message

 During playback, press **C** and **OK** in order to delete the currently playing outgoing message. Adjust the volume with **▲/▼**. Stop the playback with **STOP**.

Recording the Outgoing Message

1 Press **[2]**.

2 Dial using **▲/▼** **OUTGOING MSG..**

3 Confirm using **OK**.

 You can also load the function by pressing **OK**, **[7]** **[5]** and **OK**.

4 Dial using **▲/▼** **MESSAGE: RECORD.**

5 Confirm using **OK**.

6 Press **OK** to record an outgoing message. Wait for the confirmation tone before you say your text.

 The outgoing message must be longer than ten seconds and shorter than twenty seconds.

7 Press **OK** to end the recording. The recording is played back.

 If the volume of the outgoing message is too low, rerecord the same. For recording, lift up the handset of the device and speak the text into the microphone.

Listening to the Outgoing Message

1 Press **[2]**.

2 Dial using **▲/▼** **OUTGOING MSG..**

3 Confirm using **OK**.

 You can also load the function by pressing **OK**, **[7]** **[5]** and **OK**.

4 Use **▲/▼** to select **MESSAGE: PLAY.**

5 Confirm with **OK**. The outgoing message is played back.

Using the Anonymous Outgoing Message

You can replace your personal outgoing message with the factory default anonymous message.

1 Press **[2]**.

2 Dial using **▲/▼** **OUTGOING MSG..**

3 Confirm using **OK**.

 You can also load the function by pressing **OK**, **[7]** **[5]** and **OK**.

4 Use **▲/▼** to select **MESSAGE: DEFAULT.**

5 Confirm with **OK**. The outgoing message is played back.

Using the Outgoing Message Without Recording of Messages

You can record an outgoing message which the caller hears for which no message can be recorded in reply (= external memo).

1 Press **[2]**.

2 Dial using **▲/▼** **EXTERN. MEMO.**

3 Confirm using **OK**.

 You can also load the function by pressing **OK**, **[7]** **[6]** and **OK**.

4 Use **▲/▼** to select whether you would like the outgoing message to be switched on/off without recording the message.

5 Confirm using **OK**.

 When you record an outgoing message, you are asked, if you would like to use the old outgoing message or would like to record a new one. Confirm using **OK**.

6 **Recording a new outgoing message:** Press **OK** to record the outgoing message. Wait for the confirmation tone before you say your text.

 The outgoing message must be longer than ten seconds.

7 Press **OK** to end the recording. The recording is played back.

 If the volume of the outgoing message is too low, rerecord the same. For recording, lift up the handset of the device and speak the text into the microphone.

Listening to Messages

 Press **[#]** to listen to the next message. With the number keys, you can load the desired message directly. During playback, press **C** and **OK** in order to delete the currently playing message. Adjust the volume with **▲/▼**. Stop the playback with **STOP**.

Listening to New Messages

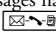





If new messages have been received on the answering machine, the  button blinks. The number of new messages is shown on the display.

1 Press **[MESSAGE]**.

2 Confirm with **OK**.

3 The new messages are played back.

Listening to Messages Again

- 1 Press .
- 2 Use  to select **MESSAGES**.
- 3 Confirm with **OK**.
 You can also load the function by pressing **OK**,   and **OK**.
- 4 Use  to select **MESSAGE: PLAY**.
- 5 Confirm with **OK**. The messages are played back.







Deleting Messages

Deleting an Individual Message

During playback, press **C** and **OK** in order to delete the currently playing message.

Deleting Heard Messages

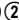
 Messages not yet heard must be heard first before deleting them.



- 1 Press .
- 2 Use  to select **MESSAGES**.
- 3 Confirm with **OK**.
 You can also load the function by pressing **OK**,   and **OK**.
- 4 Use  to select **MESSAGE: DELETE**.
- 5 Confirm with **OK**. The heard messages are deleted.
 You can also delete the already heard messages by pressing **C** and **OK** in the starting mode.

Setting Up Forwarding and Remote Control

Entering the Access Code



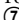
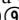

In order that you can receive forwarded messages as well as check or control the answering machine from other telephones, you must enter an access code.

 The access code may not be identical to the VIP code.

- 1 Press .
- 2 Use  to select **ACCESS CODE**.
- 3 Confirm with **OK**.
 You can also load the function by pressing **OK**,   and **OK**.
- 4 Enter a four-digit code.
- 5 Confirm with **OK**.

Forwarding Messages

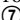
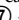
The machine forwards messages to a specified telephone number. Once the configured number of messages is reached, the machine calls the number. If the call is answered, a greeting text is played. Then the person on the line must enter the access code. If no code is entered or an incorrect code is entered three times, the machine hangs up.

- 1 Press .
- 2 Use  to select **FORWARDING**.
- 3 Confirm with **OK**.
 You can also load the function by pressing **OK**,   and **OK**.
- 4 Use  to select whether you would like to switch forwarding on or off.
- 5 Confirm with **OK**.
- 6 Enter the number to which the received messages should be forwarded.
- 7 Confirm with **OK**.
- 8 Use  to select how many messages should be collected and forwarded together.
- 9 Confirm with **OK**.

10 Recording a new greeting text: Press **OK** to record the greeting text. Wait until hearing the confirmation tone before starting the text.

11 Press **OK to end the recording.** The recording is played back.

Using the Remote Control

With a telephone call, you can listen to and delete messages, record a new outgoing message or switch the answering machine on or off.

 The telephone on this connection must be set to tone dialling. Press a button within 50 seconds, otherwise the connection is cut-off (country and network dependent).

- 1 Call your telephone number.
- 2 Wait until the answering machine switches on and plays back the outgoing message.
- 3 Enter the access code.
- 4 The machine interrupts the outgoing message and plays new messages. If no new messages have been received, you will hear two confirmation tones.
 If you select the **5/2** option for the number of rings of the answering machine, the answering machine switches on after two rings, when you have received new messages. If there are no new messages, the device rings five times. If the device does not pick up after two rings, you have no new messages. You can terminate the remote access without incurring any telephone costs.
- 5 The functions below are available via the number buttons.
- 6 Hang up to end the remote control session.

Remote Control Functions

Listening to Messages

Listen to the current message again: Press **1**.

Listen to all messages: Press **2**.

Listen to the next message: Press **3**.

Deleting Messages

Delete the current message: While listening to a message, press **6**.

Delete all messages: After listening to all messages, press **6**.

Press **6** again within five seconds to confirm the deletion.

Outgoing Message

Listen to the outgoing message: Press **5**.

Recording a new outgoing message:

- 1 Press **4**.
- 2 Wait for the two confirmation tones.
- 3 Press **4**.
- 4 Wait for the long confirmation tone before starting the text.
- 5 Press **4** to end the recording.

Control Functions

Cancel last function: Press **8**.

Switch off the answering machine: Press **7**.

Switch on the answering machine: Press **9**.

Recording Internal Memos

You can record voice messages (= memos), which can be played as messages. The limit on duration of recording set for messages applies even to the recording duration of memos.

 The configured recording length for incoming messages also limits the length of the internal memos.

- 1 Press **29**.
- 2 Dial using **▲/▼** **QUICK NOTE**.
- 3 Confirm using **OK**.

 You can also load the function by pressing **OK**, **73** and **OK**.

- 4 Press **OK** to record a voice message. Wait for the confirmation tone before you say your text.
- 5 Press **OK** to end the recording. The recording is played back. After that the **29** button starts flashing. The voice message is displayed as a new message.

 If the volume of the outgoing message is too low, rerecord the same. For recording, lift up the handset of the device and speak the text into the microphone.

Changing Settings

Entering the VIP Code

If callers enter the VIP code, the machine continues to ring, even if the answering machine has taken over the call. With this function, certain persons can reach you even if you have set the number of rings to zero.

 The VIP code may not be identical to the access code for remote control.

- 1 Press **29**.
 - 2 Use **▲/▼** to select **VIP CODE**.
 - 3 Confirm with **OK**.
-  You can also load the function by pressing **OK**, **78** and **OK**.
- 4 Enter a four-digit code.
 - 5 Confirm with **OK**.

Setting the Recording Length

You can limit the length of the incoming messages and internal memos.

- 1 Press **29**.
 - 2 Use **▲/▼** to select **RECORD. TIME**.
 - 3 Confirm with **OK**.
-  You can also load the function by pressing **OK**, **74** and **OK**.
- 4 Use **▲/▼** to select the desired recording length or unlimited time (automatic).
 - 5 Confirm with **OK**.

3 Fax

 Press **1** and **4** to print the instructions for sending faxes and for fax switch settings.

 Do not insert any documents into the machine that ...

... are wet, have been edited with correction fluid, are soiled or have a coated surface.

... are written on with a soft pencil, with paint, chalk or charcoal.

... originate from newspapers or magazines (printing ink).

... are held together with office or notebook staples or with tape or glue.

... are pasted with note papers.

... are creased, crumpled or torn.

Use documents with sizes **A5** or **A4** with 60 to 100 g/m² weight. You can insert **up to 10 documents** at a time.

Press **STOP** to eject the documents without sending them.

Sending a Fax

1 Insert the documents face down into the document feeder. The top most document will be fed in first.



2 Then configure the desired resolution. You can choose between **RESOL.: STANDARD** (for documents without special features), **RESOL.: FINE** (for texts with small print or drawings) and **RESOL.: PHOTO** (for photos). Press **[F]**. The configured resolution appears on the display. Press **[F]** again to change the resolution.

 You can adjust the default contrast (see also section Settings, page 22).

3 Dial the desired telephone number. There are multiple ways to do this.

4 Press **START**.

 If the subscriber is busy, the device dials the number again after some time. Press **STOP**, in order to cancel the transmission process. After the transmission, the machine prints out a transmission report depending on the settings.

Manual dialling: Dial the desired telephone number with the number pad.

Telephone book:

1 Press **[A-Z]**

 You can also load telephone book entries by pressing **OK**, **11** and **OK**.

2 Use **▲/▼** to select an entry. Enter the initial letters with the number buttons to navigate more quickly in the telephone book.

 You can save an entry multiple times with the same name but in a different category. In the telephone book, the first letter of the category appears after the entry.

Short dial: Press **[0-9]**. Select the desired entry with **▲/▼** or the number button.

 You can also load short dial entries by holding the respective number button pressed (for at least two seconds).

Redial list: Press **[●]**. Use **▲/▼** to select an entry from the list of dialled numbers.

 You can also load the redial list by pressing **OK**, **22** and **OK**.

Caller list: Hold **[●]** pressed (for at least two seconds). Use the **▲/▼** to select an entry from the list of callers.

 You can also load the caller list by pressing **OK**, **21** and **OK**.

 For this function to work, the caller line identification (CLIP) must be activated for your telephone connection (country and network dependent). The number and name will not be shown if the caller suppresses his number.

Manually Sending a Fax

1 Insert the document.

2 Press **[*]**.

3 Enter the desired telephone number with the number pad or select a saved entry.

4 Press **START**.

Broadcasting

You can send one fax to multiple recipients in succession.

Entering Recipients Individually

1 Insert the document.

2 Press **OK**, **34** and **OK**. The document is scanned.

3 Enter the desired telephone number with the number pad or select a saved entry.

4 Confirm with **OK**.

- 5 Enter the additional telephone numbers.
- 6 Confirm with **OK**. You can enter up to 25 recipients.
- 7 Press **START**. The machine sends the fax message to all recipients in succession.

Sending a Fax to a Group

- 1 Insert the document.
- 2 Press **OK**, **①③** and **OK**.
- 3 Use **▲/▼** to select the group to which you would like to send a fax.
- 4 Confirm with **OK**.
- 5 Use **▲/▼** to select **SEND FAX?**.
- 6 Confirm with **OK**.

 If your machine cannot reach a recipient, the fax message is sent to the other recipients. After the machine has called all recipients, it once again dials the numbers that previously could not be reached.

Delayed Fax Transmission

If you would like to make use of the lower telephone tariffs or if the recipient can be reached at some specific time only, you can send the fax at a later time – within 24 hours.

- 1 Insert the document.
- 2 Press **OK**, **③③** and **OK**.
- 3 Enter the time, at which the document should be transmitted, e.g. **①④ ①①** for 2 pm.
- 4 Confirm using **OK**.
- 5 Enter the desired telephone number with the number pad or select a saved entry.
- 6 **Selecting a saved entry:** Confirm the selected entry using **OK**.
- 7 Press **START**. The device goes into standby mode and transmits the fax at the entered time. You can continue to place calls and receive faxes.

Press **STOP** to eject the document. This interrupts the standby mode.

Receiving Faxes

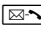
If you have not changed the factory settings, received faxes will be printed out immediately. If no paper or no ink film is inserted, the machine saves the incoming faxes. The  button blinks. Once paper or a new ink film is inserted, the saved faxes are printed out.

 Check whether you have inserted and clamped in the paper correctly. The lever on the right next to the paper feed mechanism must be pushed back.

If the message memory is full, no additional messages can be received. A warning appears on the display. Observe the information in the technical data.

 If there are problems with printing out saved fax messages, a service code is available (see also section Service, page 30).

Polling Faxes

With the fax polling function, you can retrieve faxes that lie ready in the dialled fax machine. You can also provide documents on your machine to be polled by others.

Polling Faxes Directly

- 1 Enter the desired telephone number with the number pad or select a saved entry.

 If you would like to poll fax messages from an extension number or a sub-address, add this after the telephone number. After entry, press the number **R** then enter the extension number or sub-address. The second part of the number is only dialled once the connection with the main number has been established.

- 2 Hold **START** pressed (for at least two seconds).

Polling Secure Faxes

With this function, you can poll faxes that are protected with a code.

- 1 Press **OK**, **③①** and **OK**.
- 2 Enter the code.
- 3 Confirm with **OK**.
- 4 Enter the desired telephone number with the number pad or select a saved entry.
- 5 Press **START**.

Sending Faxes via Polling

 Protect your document against unauthorised access with a code.

A caller who knows the code can poll the fax from your machine. You can continue to make telephone calls and receive faxes.

- 1 Insert the document.
- 2 Press **OK**, **③②** and **OK**.
- 3 Enter a code (max. 20 characters).
- 4 Confirm with **OK**.

Press **STOP** to eject the document. This interrupts the standby mode.

Using Fax Templates

Five fax templates, which you can use, are stored in your device. With these templates you can quickly create, for example, a short fax note or an invitation.

- 1 Press **OK**, **④③** and **OK**.
- 2 Using **▲/▼** select the template you would like to print.
- 3 Confirm using **OK**. The device prints the template.
- 4 Fill the template and send it to the desired recipient per fax.

4 Copier

 Press **1** and **5** to print help for copying.

Use documents with sizes **A5** or **A4** with 60 to 100 g/m² weight. You can insert **up to 10 documents** at a time.

Inserting Documents

- 1 Insert the documents face down into the document feeder. The top most document will be fed in first.



- 2 Then configure the desired resolution. You can choose between **RESOL. : STANDARD** (for documents without special features), **RESOL. : FINE** (for texts with small print or drawings) and **RESOL. : PHOTO** (for photos). Press **1**. The configured resolution appears on the display. Press **1** again to change the resolution.

 You can adjust the default contrast (see also section Settings, page 22).

Creating a Copy

Press **COPY** briefly. The copy is created.

Creating Multiple Copies

- 1 Hold **COPY** pressed (for at least two seconds).
- 2 Enter the number of times you would like to copy the document (maximum of 15 copies).
- 3 Press **COPY**.
- 4 Use **▲/▼** to select whether the document should be magnified or reduced in size when copied. You can magnify up to 200 percent or reduce to as small as 50 percent of the original size.
- 5 Confirm with **OK**. The copy is created.

Press **STOP** to eject the documents without copying them.

5 SMS

(Function is not supported in all countries and networks)

 Press **1** and **8** to print the instructions for SMS functions.

SMS Requirements

Your device is preset for using the SMS (Short Messaging Service) services. Caller identification (CLIP) must be activated for the SMS to work. It is possible that you will not be able to send and receive SMS messages from a private branch exchange (depending on the country and network).

 Should you face problems in sending SMS, the reason for the same could be that you are using a secret number or that the device is connected to an old ISDN System.

 Ask your telephone service provider ...
... whether you must register for the SMS Service.
... to which mobile telephone service providers you can send SMS
... which costs are applicable.
... which functions are available.

Sending an SMS

1 Press .

 You can also load the function by pressing **OK**, **6** **1** and **OK**.

2 You can enter characters using the numeric keys (see button labels) Press **0** to enter space or special characters. You can move the cursor using **▲/▼**. Use **C** to delete individual characters. Press and hold **C** (at least two seconds) to delete the entire text.

You can enter 160 characters. Press **COPY** to print the SMS before sending it.

 The last five SMS messages written remain saved as templates. Press **●** until the desired message appears.

3 Confirm using **OK**.

4 Enter the desired telephone number with the number pad or select a saved entry.

 You can send an SMS message to up to five recipients. Press **OK** after entering the entry.

5 Press . The message is sent.

Notification by SMS

You can have an SMS message sent to a telephone number of your choice when faxes or SMS messages are received or the answering machine receives calls or voice messages in your absence.

1 Press **OK**, **6** **5** and **OK**.

2 Use **▲/▼** to select whether you would like to be informed about new SMS messages.

3 Confirm with **OK**.

4 Use **▲/▼** to select whether you would like to be informed about calls in your absence.

5 Confirm with **OK**.

6 Use **▲/▼** to select whether you would like to be informed about new fax messages.

7 Confirm with **OK**.

8 Use **▲/▼** to select whether you would like to be informed about new messages on the answering machine.

9 Confirm with **OK**.

10 Enter the number to which the SMS should be sent.

11 Confirm with **OK**. A message appears on the display stating the notification by SMS is activated.

Receiving an SMS

 Check whether you have inserted and clamped in the paper correctly. The lever on the right next to the paper feed mechanism must be pushed back.

Received SMS messages are printed out automatically. If you have turned the automatic printing function off, the SMS messages will be stored. Your machine stores up to 30 received SMS messages.

Reading an SMS

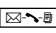
After reception of a new SMS message, the  button lights up.

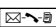
1 Press .

2 Use **▲/▼** to select the SMS messages.

3 Press . The Read SMS menu opens.

Loading Previously Read SMS Messages

1 Press **OK**, **6** **2** and **OK**.

2 Use **▲/▼** to select the SMS message you would like to read. Unread SMS messages are marked with a *.

3 Confirm with **OK**.

 You can move the cursor with **▲/▼**. Press **COPY** to print the SMS message.

4 Press **STOP** to return to the SMS list.

 Press **OK** to load additional SMS functions.

Loading SMS Functions

- 1 While reading an SMS message, press **OK** to load additional SMS functions.
- 2 Use **▲/▼** to select an option: You can display information about the SMS message, print or delete the message, forward the message to another recipient or send an SMS response. You can return to the list of SMS messages, or view the next or previous SMS message.
- 3 Confirm with **OK**.

Printing an SMS

- 1 Press **OK**, **⑥③** and **OK**.
- 2 Use **▲/▼** to select the SMS messages you would like to print out.

PRINT: ALL—Prints all received and composed SMS messages

PRINT: INBOX—Prints all received SMS messages

PRINT: OUTBOX—Prints all sent SMS messages

PRINT: NEW—Prints all unread SMS messages

- 3 Confirm with **OK**.



If you would like to print an individual SMS message, load the message. Press **COPY** to print the message.

Deleting an SMS

If the message memory is full, the machine cannot receive any more messages. Delete SMS messages to free up memory.

- 1 Press **OK**, **⑥④** and **OK**.
- 2 Use **▲/▼** to select the SMS messages you would like to delete:

DELETE: ALL SMS—Deletes all received and composed SMS messages

DELETE: READ SMS—Deletes all read SMS messages

DELETE: SENT SMS—Deletes all sent SMS messages

- 3 Confirm with **OK**.
- 4 Confirm the deletion with **OK**.



If you would like to delete an individual SMS message, load the message. Press **OK**, then select **DELETE** with **▲/▼**. Confirm with **OK**.

Changing Settings

Changing Send and Receive Numbers

All numbers that you need to send and receive SMSs are stored in your device. In case you moved to another telephone service provider, you must change these numbers. You can set your device for two SMS service providers.

- 1 Press **OK**, **⑥⑥** and **OK**.
- 2 Use **▲/▼** to select the SMS service provider that you would like to set.
- 3 Confirm using **OK**.

- 4 Enter the number for sending SMSs.
- 5 Confirm using **OK**.
- 6 Enter the number for receiving SMSs.
- 7 Confirm using **OK**.
- 8 Use **▲/▼** to select the SMS service provider through which you would like to send SMSs.
- 9 Confirm using **OK**.



You can receive SMS messages via both providers.

Switching Off Automatic Printing

You can deactivate the automatic printing of SMS messages.

- 1 Press **OK**, **⑥⑥** then **OK** repeatedly until **PRINT SMS: YES** appears on the display.
- 2 Use **▲/▼** to select whether you would like to switch the printing on or off.
- 3 Confirm with **OK**.

Switching SMS Reception On and Off

If you are using a cordless telephone with SMS function on the same telephone line, then the specific device at which you will receive an SMS message will depend on the specific manufacturer. Only one of the devices will receive the SMS message. Try to turn off the SMS reception on your cordless telephone. If this is not possible, switch off SMS reception on the machine. You can continue to send SMS messages even while SMS reception is switched off.

Switching SMS Reception Off

- 1 Press **OK**, **④⑤** and **OK**.
- 2 Enter the service code **③①②⑦**.
- 3 Confirm with **OK**.
- 4 Use **▲/▼** to select **SURE: YES**.
- 5 Confirm with **OK**.



If you have entered the incorrect code, you can cancel the entry with **SURE: NO**.

Switching SMS Reception On

- 1 Press **OK**, **④⑤** and **OK**.
- 2 Enter the service code **④①②⑦⑥**.
- 3 Confirm with **OK**.
- 4 Use **▲/▼** to select **SURE: YES**.
- 5 Confirm with **OK**.



If you have entered the incorrect code, you can cancel the entry with **SURE: NO**.

6 Fun and Games

 Press **1** and **7** to print the instructions for the Games and Fun functions of your device.

Sudoku

Sudoku is a Japanese number puzzle. The game has 3×3 squares divided into 3×3 fields. Depending on the difficulty level, lesser or more digits are already given at the beginning of the game. The aim of the game is to fill digits from 1 to 9 in the game field in such a way that each digit appears only once in a row, a column and each of the nine blocks. There is only one solution.

 The solution of the last printed game is saved. The solutions of earlier games are no longer available.

Printing a Game

- 1 Press **OK**, **4****8** and **OK**.
- 2 Dial using **▲/▼** **SUDOKU:NEW**.
- 3 Confirm using **OK**.
- 4 Using **▲/▼** select the difficulty level.
- 5 Confirm using **OK**.
- 6 Enter, how many copies of the Sudoku you would like to print (maximum 9 copies).
- 7 Confirm using **OK**.
- 8 Using **▲/▼** select if you would like to print the solution.
- 9 Confirm using **OK**.

Printing the Last Game Again

- 1 Press **OK**, **4****8** and **OK**.
- 2 Dial using **▲/▼** **SUDOKU:LAST**.
- 3 Confirm using **OK**.
- 4 Enter, how many copies of the Sudoku you would like to print (maximum 9 copies).
- 5 Confirm using **OK**.
- 6 Using **▲/▼** select if you would like to print the solution.
- 7 Confirm using **OK**.

Printing the Solution

- 1 Press **OK**, **4****8** and **OK**.
- 2 Dial using **▲/▼** **SUDOKU:SOLUTION**.
- 3 Confirm using **OK**.

7 Settings

 You can move the cursor using ▲/▼. Use C to delete individual digits. Press **STOP** to close the menu and to return to the starting mode.

Entering the Time and Date

- 1 Press **OK**, ⑨① and **OK**.
- 2 Enter the time, for example ①④ ⑩⑩ for 2 o'clock p.m.
- 3 Enter the date (two digits for each field), for example ⑩⑧ ⑩⑥ ⑩⑦ for June 8th, 2007.
- 4 Confirm with **OK**.

 After a brief power failure, you must check the time and date. Confirm with **OK**.

Selecting the Language

- 1 Press **OK**, ⑨② and **OK**.
- 2 Use ▲/▼ to select the desired display language.
- 3 Confirm with **OK**.

Selecting the Country

 Always set the country in which you are operating the machine. Otherwise, your machine is not adapted to the telephone network. If your country is not included in the list, you must select a different setting and use the correct telephone cable for the country. Consult your retailer.

 When you select a new country, all settings are reset to the factory defaults for that country. Saved data is retained. Check the number entered for the header.

- 1 Press **OK**, ⑨③ and **OK**.
- 2 Use ▲/▼ to select the country in which you are operating the machine.
- 3 Confirm with **OK**.
- 4 Use ▲/▼ to select **SURE: YES**.
- 5 Confirm with **OK**.

Entering Your Number

Your number and name are printed in the top margin of every page (= header) together with the date, time and page number.

- 1 Press **OK**, ⑨④ and **OK**.
- 2 Enter your telephone number. You can enter a plus sign with # or *.
- 3 Confirm with **OK**.

Entering Your Name

- 1 Press **OK**, ⑨⑤ and **OK**.
- 2 Enter your name. You can enter characters using the numeric keys (see button labels) Enter special characters using ⑩. Press the respective key several times until the desired character or special character appears on the display.
- 3 Confirm using **OK**.

Setting the Contrast

Various contrast levels are available to you for copying and printing of faxes.

- 1 Press **OK**, ④④ and **OK**.
- 2 Use ▲/▼ to select the desired contrast:
CONTR.: LIGHT—For lighter printing
CONTR.: NEUTRAL—For all types of documents (including white text on a black background)
CONTR.: OPTIMISED (factory default)—Optimised adjustment for text and photo printing
CONTR.: DARK—For darker printing
- 3 Confirm with **OK**.

Lowering the Transmission Speed

The machine adapts the transmission speed to the line quality. This may take some time, especially for overseas connections. Set a lower transmission speed if you are sending faxes into networks with poor line quality.

- 1 Press **OK**, ③⑧ and **OK**.
- 2 Use ▲/▼ to set whether you would like to use a lower transmission speed.
- 3 Confirm with **OK**.

Switching Page Adjustment On and Off

In order that no information is lost, received faxes are reduced in size when printed.

- 1 Press **OK**, ③⑦ and **OK**.
- 2 Use ▲/▼ to select whether you would like to switch size reduction on or off.
- 3 Confirm with **OK**.

Setting Ring Tones

Selecting the Ring Tone

You can select from among ten different ring tones.

- 1 Press **OK**, ⑤⑤ and **OK**.
- 2 Use the number buttons ① to ⑨ to select a ring tone. Use ▲/▼ to adjust the volume.
- 3 Confirm with **OK**.

Setting the Volume

You can adjust the volume of the ring tone when the device is ringing or when you set the ring tone. You can save different volumes for the * (day) and € (night) modes, (also see Chapter Fax Switch).

Using ▲/▼ you can set adjust the volume when the device is ringing.

Configuring the Fax Switch

The built-in fax switch of your machine distinguishes between fax messages and telephone calls. Faxes are automatically received, telephone calls can be received—even on additionally connected devices. While the machine is checking the call, it continues to ring.

You can set how often the machine should ring before picking up separately for the modes * (day) and € (night). This makes it possible to receive faxes silently at night, so as not to disturb you.

Press ☀/☾ to switch between day and night mode. With the activated timer ⌚, the machine switches between the modes * (day) and € (night) at the configured times.

Configuring Day Mode

- 1 Press **OK**, ⑤① and **OK**.
- 2 Using ▲/▼ select the number of rings for the answering machine. The answering machine responds after these many number of rings.
- 3 Confirm using **OK**.
- 4 Using ▲/▼ select the number of rings for the fax switch. After these many rings, the fax switch switches on and distinguishes between fax transmissions and telephone calls. While the device is checking the call, it continues to ring.
- 5 Confirm using **OK**.
- 6 Using ▲/▼, set the volume.
- 7 Confirm using **OK**.



If you select the 5/2 option for the number of rings of the answering machine, the answering machine switches on after two rings, when you have received new messages. If there are no new messages, the device rings five times. If the device does not pick up after two rings, you have no new messages. You can terminate the remote access without incurring any telephone costs.

Configuring Night Mode

- 1 Press **OK**, ⑤② and **OK**.
- 2 Configure the same settings as for the day mode (see steps 2 to 7).

Setting the Timer

The timer switches between the modes * (day) and € (night) at the configured times.

- 1 Press **OK**, ⑤③ and **OK**.
- 2 Enter the time at which the machine should switch to * (day) mode, for example ⑩⑥ ⑩⑩ for 6 o'clock a.m.

- 3 Confirm with **OK**.
- 4 Enter the time at which the machine should switch to € (night) mode, for example ②② ⑩⑩ for 10 o'clock p.m.
- 5 Confirm with **OK**.

Special Settings

Silent Fax Reception

If you would like to accept a fax without preceding rings, set the number of rings of the fax switch to 0.

Switching Off All Rings

If you don't want to be disturbed, e.g. in the night, by any incoming calls, you can set the number of rings to 0. The device switches immediately to silent fax reception.

Manually Receiving Faxes

Select manual reception under number of rings of the fax switch. The device will not receive faxes on its own. You can start fax reception manually, by pressing **START**. This setting is useful, when you want to receive faxes via a modem connected to a computer.

Printing Lists and Help Pages

Printing the Call List

The call list contains the last 50 numbers dialled.

- 1 Press **OK**, ④① and **OK**.
- 2 Use ▲/▼ to select whether you would like to switch the printing on or off.
- 3 Confirm with **OK**.
- 4 **Switch on printing:** Use ▲/▼ to select whether the call list should be printed immediately or after every 50 calls.
- 5 Confirm with **OK**.

Printing a Transmission Report

After every transmission, the machine prints out a transmission report. If a transmission error occurs, an error report is printed out. You can switch off printing of the transmission report.

- 1 Press **OK**, ③⑥ and **OK**.
- 2 Use ▲/▼ to select whether you would like to switch the printing on or off.
- 3 Confirm with **OK**.

Printing the Fax Journal

The fax journal is a list of the last ten faxes sent and received.

- 1 Press **OK**, ③⑤ and **OK**.
- 2 Use ▲/▼ to select whether you would like to switch the printing on or off.
- 3 Confirm with **OK**.
- 4 **Switch on printing:** Use ▲/▼ to select whether the fax journal should be printed immediately or after every ten transmissions.
- 5 Confirm with **OK**.

Printing Numbers and Entries

The list of numbers and entries contains the last ten calls received and numbers dialled as well as the saved entries and groups.

Press **OK**, **2** **3** and **OK**. The list is printed.

Printing Help Pages

Help 1 • Overview

Press **i** and **1** to print an overview of the help pages.

Help 3 • Telephone Book

Press **i** and **3** to print an overview of the telephone book and answering machine functions.

Help 4 • Fax Transmission

Press **i** and **4** to print instructions for sending fax messages and for configuring the fax switch.

Help 5 • Copier

Press **i** and **5** to print the help for copying.

Help 6 • Function List

Press **i** and **6** to print a list of all functions and settings of your machine.

Help 7 • Games and Fun

Press **i** and **7** to print the instructions for the Games and Fun functions of your device.

Help 8 • SMS

Press **i** and **8** to print the instructions for SMS functions.

Starting the Initial Installation

- 1 Press **i** and **2**.
- 2 The machine prints out a help page and starts the initial installation process.

Checking the Firmware Version

- 1 Press **OK**, **4** **7** and **OK**.
- 2 The model designation and the configured country appear on the display.
- 3 Confirm with **OK**.
- 4 The information on the firmware version of the machine is displayed.
- 5 Confirm with **OK**.

8 Telephone Lines and Additional Devices

Configuring Telephone Lines and Services

Private Branch Exchanges

Private branch exchanges (PABX) are typical in many offices and private households. You must dial an outside line access code in order to establish a connection with the public telephone network (PSTN) from an extension.

 An additional telephone connected to the machine on a telephone socket is not considered an extension.

- 1 Press **OK**, **9****6** and **OK**.
- 2 In many countries, you can set either pulse dialling or tone dialling (DTMF tones). Use **▲▼** to select the desired dialling method.

 Only use pulse dialling if tone dialling is not yet activated for your telephone line.

- 3 Confirm with **OK**.
- 4 Use **▲▼** to set whether you operate your machine on an extension.
- 5 Confirm with **OK**.
- 6 **Configuring an extension:** Enter the outside line access code with which you reach the public telephone network. This is usually **0**.
- 7 When finished, the machine tests the telephone line. Confirm with **OK**.
- 8 Your machine checks whether it can establish a connection with the public telephone network. If it cannot establish the connection, you are once again asked for input.

 In rare cases, the outside line access code may be a different number or a two-digit number. For older telephone systems, the outside line access code can be **R** (= Flash). Press **R** to enter this outside line access code. Should a connection to the public telephone network not be possible, contact the provider of your telephone system.

DSL Connection

In the event that you use a DSL modem: Connect the machine after the modem. For additional information, please consult the operating manual of your DSL system.

ISDN Connection

Details for ISDN connections can be found in the instructions provided with the terminal adapter or the dial-up router.

Voice Mailbox

You cannot simultaneously use the answering machine facility of your telephone service provider (= voice-mail box) and receive faxes on your devices. Get the mail-box function for your telephone connection deactivated or set the number of rings for the fax switch to lower than **5** on your device (also see Chapter Setting the Fax Switch, Page 23). When the fax switch accepts the call, the mail-box of the service provider does not step in. Enquire with your telephone company.

Connecting Additional Devices

You can operate additional devices on a telephone line, such as cordless telephones, answering machines, modems or charge counters.

 If you are using a cordless telephone with SMS function on the same line, then the specific device at which you will receive an SMS message will depend on the specific manufacturer. Only one of the devices will receive the SMS message. Try to turn off the SMS reception on your cordless telephone.

Connection to the Machine

You can connect additional devices directly to your machine. Plug the telephone cable of the additional device into the **EXT** socket (RJ-11 connection) of your machine.

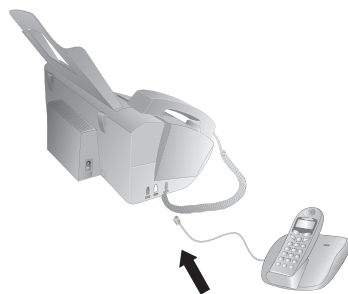

 We recommend direct connection to the machine because this allows the fax switch to function optimally and to control the additional devices.

Connection to the Telephone Line

In order for the fax switch to function, the machine must be first in the series if multiple devices are connected to the same telephone socket. Follow the correct order.

 If you have multiple telephone sockets for the same telephone line, the machine must be connected to the first telephone socket.

Using Additional Telephones (Easylink)

With the Easylink function, you can control your machine with additional telephones. To use this function, additional telephones must be set to tone dialling (DTMF tones); see here the user manual of your additional telephone.

Starting Fax Reception

If you pick up on an additional device and hear that you are receiving a fax message (whistle or silence), you can start the fax reception by pressing ***5** on the additional telephone or the **START** button on the machine.

Taking Over the Line

If you pick up on an additional telephone and the machine continues to ring or attempts to receive a fax, you can disconnect the machine from the line. Press ****** on the additional telephone.

Changing Codes



Only change the codes if it is absolutely necessary. The codes must begin with ***** or **#** and must be different.

- 1 Press **OK**, **54** and **OK**.
- 2 Enter the new code for starting fax reception.
- 3 Confirm with **OK**.
- 4 Enter the new code for taking over the line on an additional device.
- 5 Confirm with **OK**.

9 Service

 Should disruptions occur, follow the instructions on the display and on the error report.

Changing the ink film

 Use only original consumable materials. These are available from a specialised retailer or through our order service. Other consumable materials can cause damage to the machine.

 Follow the instructions on the packaging of the consumable materials.

For receiving or copying documents, an ink film must be inserted in your device. Your device is delivered with an already inserted free ink film for a few test pages. For this film, you do not require any Plug'n'Print card (= chip card with information regarding ink film capacity). For every next film that you insert, you must load the capacity memory with the included Plug'n'Print card.

- 1 Remove the paper from the paper feeder and take the paper tray out of the device.
- 2 Open the device by lifting the panel using grip in the centre and folding it down.

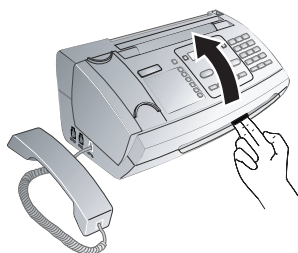

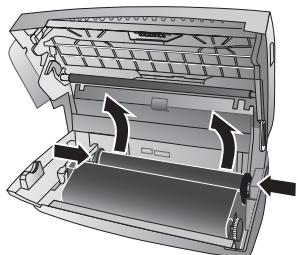

 Lock the cover of the machine completely into place when opening the machine. You could be injured if the cover falls while you are working on the machine.

- 3 Grip the rear ink film roll at both the sides and place it next to the front ink film roll.

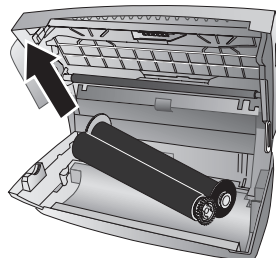

- 4 Remove both the rolls from the device. The used ink film cannot be reused.



 The messages and copies you have printed out can be read from used ink films. Consider data protection issues when disposing of used ink films.

- 5 Pull the used Plug'n'Print card out of the plug socket on the left hand side next to the ink film tray. The Plug'n'Print card cannot be reused.

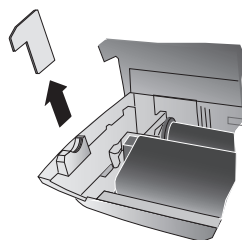

- 6 Carefully remove the rubber bands from the new ink film. Make sure that the film is not damaged!

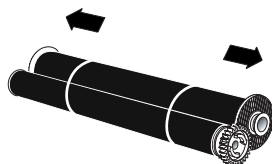

- 7 Place the larger roll with the ink film in the rear ink film tray. The blue gear wheel must be on the right hand side.

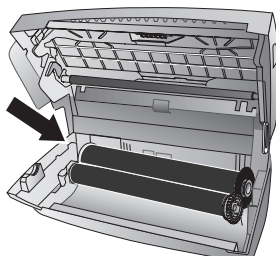

- 8 Place the smaller roll without film in the front tray. The blue gear wheel must be on the right hand side and the pin must be inserted in the depression on the left hand side.

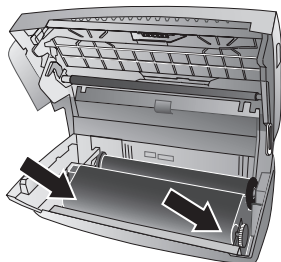

- 9 Break the chip card from the Plug'n'Print card. Insert the chip card in the plug socket on the left hand side next to the ink film tray.

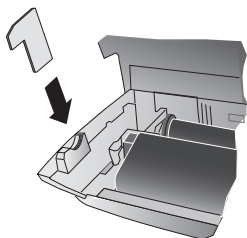

- 10 Turn the blue gear wheel forward to tension the ink film. The ink film must not have any creases.

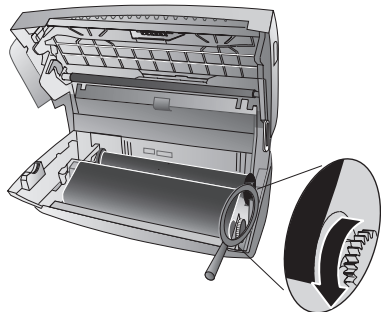

- 11 Close the device. Insert the paper tray in the opening provided for it behind the paper feeder. Insert paper again.

Checking the Ink Film Reserve

- 1 Press **OK**, ④⑥ and **OK**.
- 2 The number of pages that can still be printed with the ink film is shown on the display.
- 3 Press **STOP** to return to the starting mode.

If the ink film used up or if there is no ink film in the machine, a message appears on the display.

Fixing a Paper Jam

- 1 Remove the paper from the paper feeder and take the paper tray out of the device.
- 2 Open the device by lifting the panel using grip in the centre and folding it down.

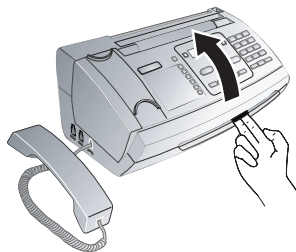

- ⚠ Lock the cover of the machine completely into place when opening the machine. You could be injured if the cover falls while you are working on the machine.

- 3 Carefully pull the paper out.

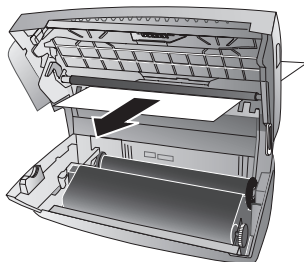

- 4 Turn the blue gear wheel forward to tension the ink film. The ink film must not have any creases.

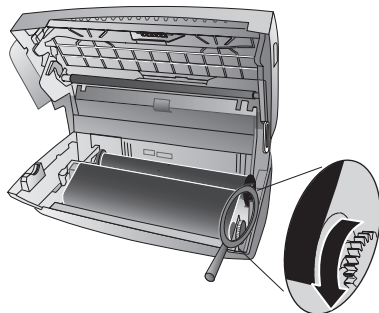

- 5 Close the device. Insert the paper tray in the opening provided for it behind the paper feeder. Insert paper again.

Fixing a Document Jam

- 1 Remove the paper from the paper feeder and take the paper tray out of the device.
- 2 Open the device by lifting the panel using grip in the centre and folding it down.

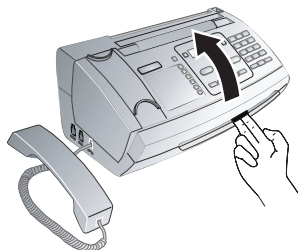

⚠ Lock the cover of the machine completely into place when opening the machine. You could be injured if the cover falls while you are working on the machine.

- 3 Open the scanner cover and the cover of the automatic document cover by first pushing the support (A) and then the support (B) inside. The cover (C) folds below.

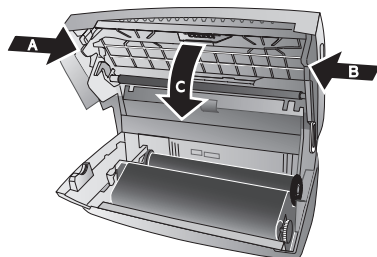

- 4 Carefully pull the document to the front or to the back out of the device.

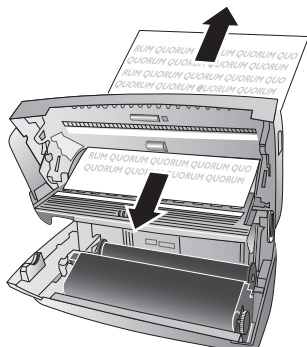

- 5 Close the scanner cover and the cover of the automatic document feeder. Both the supports must securely snap into place.

- 6 Turn the blue gear wheel forward to tension the ink film. The ink film must not have any creases.

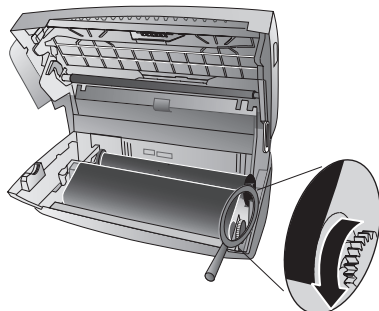

- 7 Close the device. Insert the paper tray in the opening provided for it behind the paper feeder. Insert paper again.

Cleaning

⚠ Unplug the machine from the power socket before cleaning it. Use a soft, lint-free cloth. Never use liquid or easily flammable cleansers (sprays, abrasives, polishes, alcohol, etc.). Do not allow any moisture to reach the interior of the machine.

💡 Special fax cleaning sheets are available as accessories from our call centre. Insert a sheet into the document feeder. Press **STOP**; the page is ejected. Repeat this process at a few times.

- 1 Remove the paper from the paper feeder and take the paper tray out of the device.
- 2 Open the device by lifting the panel using grip in the centre and folding it down.



⚠ Lock the cover of the machine completely into place when opening the machine. You could be injured if the cover falls while you are working on the machine.

- 3 Open the scanner cover and the cover of the automatic document cover by first pushing the support (A) and then the support (B) inside. The cover (C) folds below.

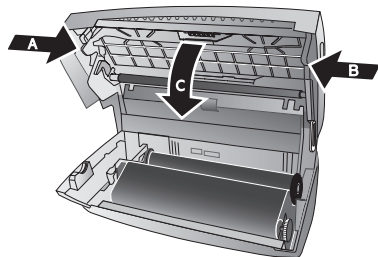

- 4 Lightly wipe the upper side of the scanner glass (A) and the lower side of the document feeder/scanner film (= white plastic plate) (B) with a cloth.

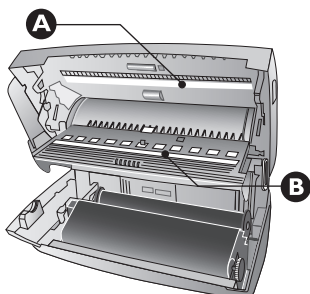

- 5 Clean the feed roller (A) and the underside of the support pad of the feeder roller (B) with a soft, lint-free cloth moistened with cleaning alcohol (96 percent). Rotate the feed roller; You must clean the entire roller.

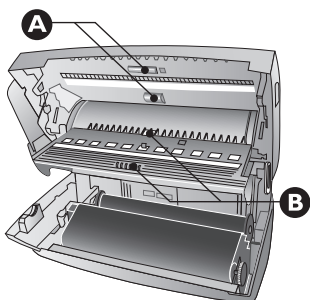

- 6 Close the scanner cover and the cover of the automatic document feeder. Both the supports must securely snap into place.

- 7 Turn the blue gear wheel forward to tension the ink film. The ink film must not have any creases.

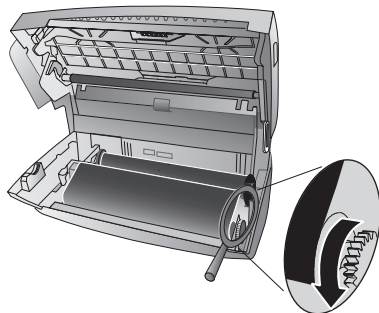

- 8 Close the device. Insert the paper tray in the opening provided for it behind the paper feeder. Insert paper again.

Using Service Codes

The service codes delete all the changed settings and your device is reset to factory settings. It may be possible that the device with the changed settings reacts differently than expected.

⚠ Only use the service code if this is absolutely necessary. Many service codes also delete saved messages and telephone book entries.

1 Press **OK**, **4** **5** and **OK**.

2 Enter a service code:

7 1 1 7—Deletes all changed settings and saved data. The device is reset to factory settings and the initial installation process is started.

7 1 4 0—Deletes all changed settings. Saved data and telephone book entries remain intact.

7 2 2 7—Deletes saved faxes, when there are problems with printing.

3 Confirm using **OK**.

4 Dial using **▲/▼ SURE: YES**.

5 Confirm using **OK**.

⚠ If you have entered the incorrect code, you can cancel the entry with **SURE: NO**.

Power Cycling

If a problem occurs that cannot be corrected with the instructions in this user manual (see also the help below), follow the steps given here.

1 Pull out the power plug.

2 Wait at least ten seconds, then plug the power plug back into the socket.

3 If the error occurs again, please contact our technical customer service or your retailer. Follow the instructions on the display and on the error report.

General information	
The time and date flash on the display.	You must check the time and date after a short power failure. Confirm using OK .
Problems when faxing or printing	
Faxes sent are of poor quality.	<p>Change the resolution from RESOL. : STANDARD to RESOL. : FINE or RESOL. : PHOTO.</p> <p>Change the contrast.</p> <p>Clean the scanner and the document feed slot.</p> <p>Test the device by making a copy of the document. If the device is in order, the fax machine of the recipient is defective.</p>
The device produces black lines when sending or printing.	Clean the scanner and the document feed slot.
Copy is blank.	Insert the documents face down into the document feeder.
Printing is interrupted.	<p>Paper or document jam, no paper or ink film. Follow the instructions on the display and in the error report.</p> <p>There could be a small pause after printing several pages. The device continues printing automatically.</p>
No printing	Check if you have inserted clamped paper correctly. The lever on the right hand side next to the paper feeder must be folded backwards.
Documents are not properly fed.	Clean the scanner and the document feed slot.
Problems with the connection	
The device rings once, remains silent for a short while and starts ringing again.	This is absolutely normal. The fax switch checks the call after the first ring. If it is a voice call, the device continues to ring.
No dial tone	Check the installation of the device. Connect the telephone cable to the socket marked LINE . Insert the telephone plug into your telephone connection socket.
Fax transmissions are constantly interrupted.	<p>Try to send the fax manually: Press ⏏ and dial the number. If the recipient is using an answering machine, wait until you hear a whistling tone. Press START.</p> <p>It is possible that the recipient's machine is not ready to receive.</p>
You hear a whistling tone or silence in the handset.	The call is a fax: Press START on the device In addition, press (*)5 on the telephone. Hang up.
No fax reception or a short fax audio signal as message on the answering machine	<p>Using function 51, set the number of rings for the fax switch to 4 and the total number or the number of rings for the answering machine (model dependent) to 5 (see Page 23).</p> <p>You cannot simultaneously use the answering machine facility of your telephone service provider (= voice-mail box) and receive faxes on your devices(see page 25).</p>

I 0 Appendix

Technical Data

Dimensions (L x H x W)	313 x 129 x 197 mm
Weight	1.9 kg
Power supply	220 – 240 V-/ 50 – 60 Hz
Power consumption	
..... Stand-by mode: < 1.5 W (without Dect)	
..... Stand-by mode: < 2.5 W (with Dect)	
..... Transmission: < 20 Watt	
Recommended Ambient Temperature	18 – 28 °C
..... Relative humidity 20 – 80 % (non-condensing)	

Standards

Safety	EN60950-1
Emissions	EN55022 Class B
Immunity to electrical noise	EN55024

Paper

Capacity	50 sheets
Size	A4 · 210 x 297 mm
Thickness	0.07 – 0.11 mm
Weight	60 – 90 g/m ²

Document Feeder

Capacity	10 sheets
Breadth	148 – 212 mm
Length	100 – 600 mm
Thickness	0.06 – 0.15 mm

Telephone

Type of connection	PSTN · PABX
Dialling mode: Tone / pulse dialling (country dependent)	
Telephone book	200 entries

Fax

Type	Group 3
Compatibility	ITU-T T.30
Data compression	MH · MR
Modulation	V.17 · V.29 · V.27ter · V.21
Transmission speed	14,000 bps

Scanner

Scan width	212 mm
Horizontal resolution	8 dots/mm
Vertical resolution	Standard : 3.85 lines/mm
..... Fine: 7.7 lines/mm	

Message Memory

Fax messages	up to 50 pages (standard test letter)
SMS messages	up to 30 SMS messages
Voice messages	up to 30 minutes

Technical specifications subject to change without notice.

Guarantee

(UK Terms and Conditions)

At the beginning of April 2002, SAGEM SA bought the PHILIPS fax business unit. SAGEM SA is now the European Number 1 in fax and offers a complete range of fax terminals with Internet access and SMS function, multi-functional terminals and servers covering the needs of all its customers—from home-users to multinational organisations.

In order to apply the guarantee, you should contact your dealer. Proof of purchase will be required. Should malfunctioning arise, the dealer will advise you what to do.

If you bought your equipment from SAGEM directly, the following shall apply:

A SAGEM undertakes to remedy by repair, free of charge for labour and replacement parts, any defects in the equipment during a period of twelve (12) months from the date of original delivery of the Equipment, where those defects are a result of faulty workmanship. During this twelve month guarantee period, the defective equipment will be repaired free of charge; the customer must however first contact the SAGEM After Sales Department, the phone number of which can be found on the delivery slip or in the user manual. Unless the customer has concluded with SAGEM a maintenance contract in respect of the equipment which specifically provides for repairs to be carried out at the customer's premises, the repairs will not be carried out on the equipment at the customer's premises. The following sentence applies to purchases of equipment for the customer's trade, business or profession. Except as otherwise expressly provided in this Document and to the extent permitted by law, SAGEM makes no representations or warranties, express or implied, statutory or otherwise, and to such extent, all terms and conditions implied by law are hereby excluded. This guarantee does not affect the Customer's statutory rights.

B Exclusions From Guarantee

SAGEM shall have no liability under the guarantee in respect of:

- damage, defects breakdown or malfunction due to:
 - failure to properly follow the installation process and instructions for use; or
 - an external cause to the equipment (including but not limited to, lightning, fire, shock or water damage of any nature); or
 - modifications made without the written approval of SAGEM SA; or
 - a failure or neglect to maintain the equipment or inappropriate maintenance; or
 - unsuitable operating conditions, particularly of temperature and humidity; or
 - repair or maintenance of the equipment by persons not authorised by SAGEM; or
- wear and tear from normal daily use of the equipment and its accessories
- damage due to insufficient or bad packaging of equipment when returned to SAGEM

- supply of new versions of software
- work on any equipment or software modified or added without the prior written consent of SAGEM
- malfunctions not resulting from the Equipment or from software installed in user workstations for the purpose of use of the equipment
- communication problems related to an unsuitable environment, including:
 - problems related to access and/or connection to the Internet such as interruptions by access networks or malfunction of the line used by the subscriber or his correspondent
 - transmission faults (for example poor geographical coverage by radio transmitters, interference or poor line quality)
 - the local network fault (wiring, servers, workstations) or the failure of the transmission network
- the normal servicing (as defined in the user guide supplied with the equipment) as well as malfunctioning due to servicing not being carried out, servicing costs are in any event always borne by the customer.

C In the cases set forth in § B as well as after expiry of the twelve month guarantee period, the customer must ask SAGEM for an estimate, and he/she must accept the estimate and agree to pay the charges mentioned in it before returning the equipment to SAGEM. The repair and delivery costs will be invoiced to the customer.

The foregoing shall apply unless otherwise agreed in writing with the customer and only for the UK. If any provision of this guarantee shall be held to be in whole or in part invalid or illegal due to an obligatory rule applicable to consumers pursuant to their national legislation, such invalidity or illegality shall not impair or affect the remaining provisions or parts of this guarantee.



The CE symbol confirms conformity with the EU directives that apply to the device.

Declaration of Conformity (DoC)

Hereby, **Sagem Communication Austria GmbH** declares that this **PPF 675** is in compliance with the essential requirements and other relevant provisions of Directive 1999/5/EC.

You can find the complete Declaration of Conformity on our website www.sagem.com



As an Energy Star Program Participant, SAGEM Communication Austria GmbH has determined that this product meets the Energy Star guidelines for energy efficiency.

Environment: Respect of environment is a key objective of SAGEM SA. The SAGEM Group uses environmentally friendly processes to run its operations and has chosen to integrate strong environmental constraints in the full life-cycle of its products including manufacturing, product use and end of life.



Packaging: To facilitate packaging recycling, please conform to your local selective recycling rules.

Batteries: Old batteries have to be deposited in designated collection areas.



Product: The crossed out dustbin logo on your product signifies it is classified as Electrical and Electronic Equipment covered by special disposal regulations.

To enforce recycling, recovery of The Waste Electrical and Electronic Equipment (WEEE) and to protect the environment and human health, European regulations requires that you selectively collect waste equipment using one of the following options :

- Your retailer will take your equipment back if you are buying a replacement product.
- Waste equipment can also be deposited in designated collection areas.

This user manual was printed on recycled paper bleached without chlorine. This satisfies the highest standards for low environmental impact. The cardboard packaging used and the packaging inserts of paper and cardboard can be disposed of as waste paper. The plastic foil may be submitted for recycling or disposed of with waste not intended for recycling, depending on the requirements in your country.

Trademarks: The references mentioned in this manual are trademarks of the respective companies. The lack of the symbols ® and ™ does not justify the assumption that these dedicated terms are free trademarks. Other product names used herein are for identification purposes only and may be trademarks of their respective owners. Sagem SA disclaims any and all rights in those marks.

The reproduction of certain documents (e.g. by scanning, printing, copying) is prohibited in many countries. The list of such documents below is not intended to be complete, it only offers a general overview. In case of doubt, consult your legal advisor.

- Passports (personal identification)
- Entrance and exit visa papers (immigration papers)
- Military service documents
- Bank notes, travel checks, payment orders
- Postage stamps, tax stamps (stamped or unstamped)
- Loan papers, certificates of deposit, bonds
- Documents protected by copyright

Follow the statutory regulations of your country with regard to the legal validity of fax transmissions – particularly in connection with the validity of signatures, meeting delivery deadlines or disadvantages resulting from the loss of quality in the transmission, etc.

Take care to maintain the statutory regulations of your country regarding telecommunications secrecy and data privacy.

This product is intended for use on an analogue public telecommunications network (PSTN) and in the country specified on the packaging. Use in other countries can result in faulty functioning.

For more information, please contact the technical service centre for your country. Should problems arise during use of your machine, please contact your retailer first.

Neither Sagem SA nor its affiliates shall be liable to the purchaser of this product or third parties for damages, losses, costs, or expenses incurred by the purchaser or third parties as a result of accident, misuse, or abuse of this product or unauthorized modifications, repairs, or alterations to this product, or failure to strictly comply with Sagem SA operating and maintenance instructions.

Sagem SA shall not be liable for any damages or problems arising from the use of any options or any consumable materials other than those designated as original Sagem products or Sagem approved products.

Sagem SA shall not be held liable for any damage resulting from electromagnetic interference that occurs from the use of any interface cables other than those designated as Sagem products.

All rights reserved. No part of this publication may be reproduced, stored in a retrieval system or transmitted in any form or by any means, electronic, mechanical, photocopying, recording, or otherwise, without the prior written permission of Sagem SA. The information contained herein is designed only for use with this product. Sagem is not responsible, if this information is applied to other devices.

This user manual is a document that does not represent a contract.

Errors, printing errors and changes are reserved.

Copyright © 2006 Sagem Communication Austria GmbH

Customer Information

We constantly strive to develop our products according to the highest quality standards and with the greatest possible user-friendliness.

In your user manual you will find all the information required to use your machine. If you nevertheless require assistance in addition to the user manual, our call centre is available. Our employees are trained experts who would be happy to answer your questions.

We can assist you more quickly if you do not call us from the machine, rather an external telephone. Keep a printout of the settings as well as the serial number of the machine handy. The serial number can be found on the type plate.

United Kingdom

Telephone: 09 05 - 693 02 40 (0.15 £/minute)

Fax: 08 70 - 124 02 02

Use only PHILIPS accessories. The warrantee does not cover damages to the device resulting from other consumables.

In United Kingdom, you can order PHILIPS accessories on telephone using our toll-free number.

United Kingdom

Telephone: 08 00 - 358 08 07

E-Mail: dti.faxinfo@sagem.com

Internet: www.sagem.com

We hope that you will have lots of joy using your new product.

SAGEM COMMUNICATION (SAFRAN Group)

Broadband Business Group
Printing Terminals

Headquarters : Le Ponant de Paris
27, rue Leblanc · 75015 Paris · FRANCE
Tél. : +33 1 58 11 77 00 · Fax : +33 1 58 11 77 50 · www.sagem.com
Limited company · Capital 300.272.000 Euros · 480 108 158 RCS PARIS
Sagem is a registered brand of SAFRAN Group

PPF 675
GB · INT
252357181-B

