

**C-MAG**®

**USER MANUAL**



**C-MAG MAGAZINE  
SYSTEM 9MM**

**UZI**

## CONTENTS

	Pages
Introduction	2, 3
Description	4, 5
Drawing: Assembly Parts	6
Loading	7
Use of Personal Loader	8, 9
Precautionary Measures	10
Technical Data	11
Disassembly of the C-MAG	12 – 15
Assembly of the C-MAG	16 – 19
Troubleshooting	20, 21
Accessories	22, 23
C-MAG Magazine System UZI	24
List of Part Numbers	25

## **INTRODUCTION**

The C-MAG Magazine UZI 9MM is a 100 round ammunition magazine, manufactured to the highest production standards. It meets and exceeds NATO Military Specifications.

The patented design provides for equal distribution of the ammunition in each of the twin-drums. Rounds are fed alternately from each drum through the feed clip into the weapon, resulting in a fixed center of gravity during firing. Using a unique rotation device and low torsion stress springs, the C-MAG is the world's first magazine with a full 100-round capacity, capable of being pre-loaded and stored indefinitely.

The compact design allows for better ground clearance and stability.

The C-MAG UZI 9MM is installed in the weapon like the standard issue magazine. The bolt will be in the closed position when the magazine is empty.

The C-MAG can be reloaded and reused repeatedly with an estimated life cycle in excess of 60,000 rounds.



## DESCRIPTION

The C-MAG magazine consists of two main component assemblies:

- **Double Drum Housing**
- **Feed Clip Assembly.**

*Feed Clip Assembly*

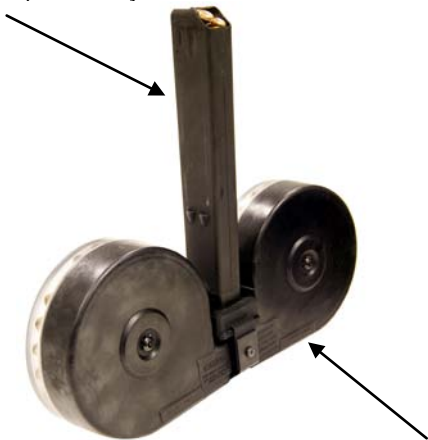

*Double Drum Housing*

The **double drum housing** comprises of:

- double drum,
- drive gear assemblies with pusher arms
- set of covers.

The housing acts as storage facility for the ammunition.

The **feed clip** is filled with

- 40 spacer rounds and
  - 1 last-round-link-assembly,
- which occupy the feed clip when the magazine is empty.

The **last-round-link-assembly** is positioned vertically at the open end of the feed clip, when the magazine is empty. The assembly is tapered to allow the weapon bolt to pass over it after the last round has been fired.

**WARNING:** Do not remove Spacer rounds and Linked Assembly!!

**The bolt will stop in the closed position.**

# C-MAG UZI

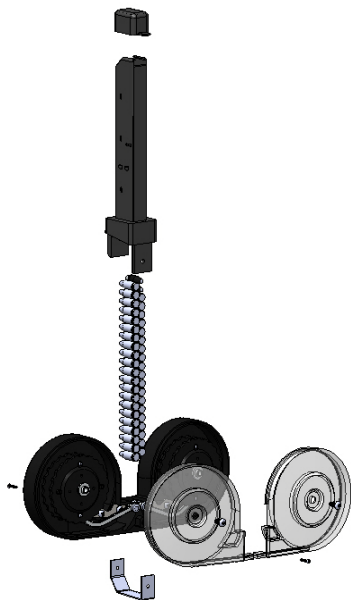

Assembly Parts

## LOADING

- The C-MAG loads and functions just like a standard magazine.
- Live cartridges are loaded by pressing them into the feed clip (on top of the spacer round assembly). Cartridges will automatically feed alternately into each drum. The springs are tensioned during the process without the need for any supplementary operations.
- The magazine does not need to be empty to be loaded and remains completely operational at all times.
- Loading can be done by hand but is recommended with the Personal Loader.
- Regularly add **Graphite (dry lubricant)** to top of spacer rounds prior to loading to distribute graphite through the drum housing. **Do not use oil!**





## Use of the Personal Loader

The Personal Loader consists of two parts:

- **Housing** – fits over the feed clip of the C-MAG
- **Plunger** – pushes rounds into the magazine



To operate the loader, raise the plunger and insert 5 cartridges into the side opening of the housing, depress plunger to load the rounds into the C-MAG.

**WARNING:** DO NOT load ammunition backward. The 9mm cartridge has a tendency to turn over easily, when dropped into the loader.

Ammunition loads easily and does not require extra force. If extra force is required, STOP immediately and check for reversed rounds. **The magazine will jam during firing, if rounds are loaded backwards.**

## **CAUTION**

### **PRECAUTIONARY MEASURES FOR USE IN SAND ENVIRONMENT**

- Keep BOLT CLOSED when C-MAG is in the weapon.
- Keep DUST COVER on the feed clip whenever C-MAG IS NOT in the weapon.
- Keep C-MAG in Carrying Pouch when not in use.

# C-MAG 9MM

## Technical Data

**AMMUNITION:**

NATO Standard, 9 x 19 mm Parabellum

**CAPACITY:** Variable, 1 to 100 rounds

**FEED RATE:**

Variable, up to 1,500 rounds per minute

**DIMENSIONS:**

284 mm x 120 mm x 40 mm

11.17 x 4.72 x 1.57 inches

**WEIGHT:** Empty: 1 kg / 2.2 lbs.

**STORAGE LOADED:** Indefinite

**MATERIALS:**

Main Components Filled thermoplastic

Minor Components Non-corrosive steel; alloy

## **DISASSEMBLY OF THE C-MAG**

The C-MAG can be taken apart for cleaning or, if necessary, for the clearing of stoppages due to contamination or the accidental reversal of an ammunition cartridge during loading.

### **1. DISASSEMBLY FOR CLEANING**

Take the empty C-MAG and

#### **1.1. Remove Clip Assembly**

1.1.a Loosen clip screws.

1.1.b Turn C-MAG over and remove 2 screws and clip strap.

1.1.c Remove 40 spacer rounds and 1 last-round-link-assembly from feed clip.

#### **1.2. Remove Cover Set**

### **WARNING:**

**Do not disassemble any further.**

## 1.3. Cleaning

- 1.3.a Clean drum assembly, covers, feed clip, spacer rounds and linked assembly as recommended below.

<b>CONTAMINATION &amp; ACTION</b>
<b>HARSH SAND, DIRT ETC.:</b> Use cloth, compressed air or flush with water.
<b>FINE SAND, SILT, MUD ETC.:</b> Soak in water with detergent (optional) to saturate and dissolve deposits. Flush with clean water.
<b>OILS, GREASE, RESIDUES OF SOLVENTS/FUELS:</b> Use acetone or alcohol. Do not use oily fuels such as diesel, mineral spirits or kerosene. Follow up with detergent and water.
<b>SALT DEPOSITS FROM SEAWATER:</b> Light deposits: Soak in water to dissolve. Heavy deposits: Return to manufacturer.
<b>CLEANING CLEAR COVERS:</b> DO NOT use any solvent on clear covers. <i>Clear covers will turn cloudy!</i> Use water, soap or detergent.

## 2. **DISASSEMBLY FOR CLEARING OF BLOCKAGES**

### **USE CAUTION**

#### **2.1. Remove Clip Assembly**

2.1.a Hold down clip assembly and loosen screws.

2.1.b HOLD DOWN clip assembly while removing screws and clip strap.

#### **Point C-MAG away from you.**

Removing the clip strap may release the blockage. Cartridges may be forced out of the drum housing. Control release of rounds by holding down the feed clip assembly.

#### **2.2. Remove Cover Set.**

**Put C-MAG in container to avoid uncontrolled release of rounds.**

**Point away from you!**

- 2.2.a Carefully remove screws and remove cover. Grasp and slowly rotate drive gear to dislodge ammunition. Shake drum assembly if necessary. Do not allow drive mechanism to snap back into place.
- 2.2.b Check for damaged parts.

### **2.3. Repairs**

Magazines with obvious and serious damage to the drum assembly cannot be field repaired and must be returned to the manufacturer for repair.

Removable components are available as spare parts for field replacement.

C-MAG products can be returned to the manufacturer for warranty or post warranty work at any time.

#### **THE BETA COMPANY**

2137B Flintstone Drive, Tucker, GA 30084, USA  
1-800-669-2382 & 770-270-0773 [www.betaco.com](http://www.betaco.com)



## **ASSEMBLY OF THE C-MAG**

### **1. Inspection**

All parts of the C-MAG should be inspected for function or damage prior to assembling. Drive gears in the double drum housing should rotate freely.

### **2. Attach covers**

Place covers on drum assembly and attach.

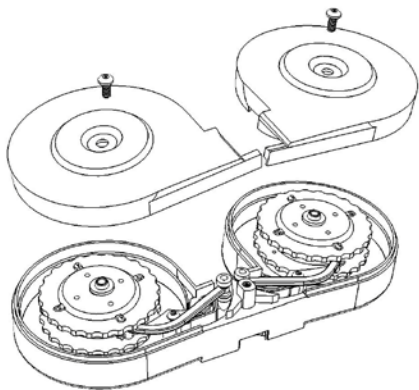

### 3. Attach feed clip assembly.

#### 3.1. Load feed clip

The feed clip holds 40 spacer rounds and 1 last-round-link-assembly.

- Turn feed clip sideways and insert loading tool into clip as shown.
- Place one loose spacer round on top of the last-round-link-assembly as shown and place assembly into bottom of feed clip on loading tool.

Last-round-link assembly must be vertical on right side of feed clip.

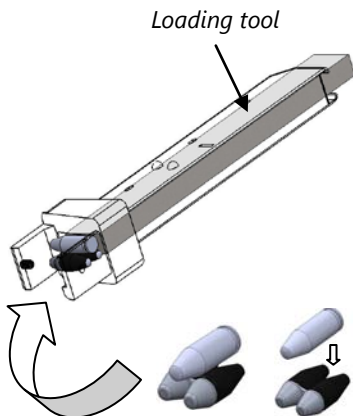

- Turn feed clip upside down. Add spacer rounds in a staggering manner while moving down the loading tool to hold rounds in place. Continue until all spacer rounds are loaded.

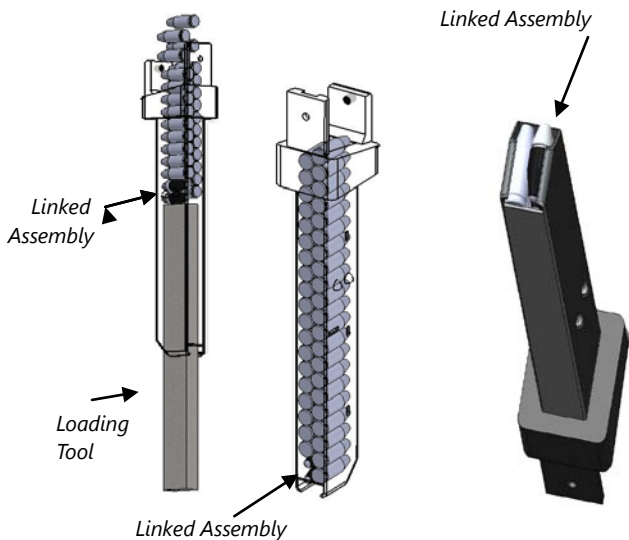

Linked Assembly must be installed **vertically** at **top** of feed clip.

### 3.2. **Attach feed clip to drum housing**

- Invert double drum housing and feed clip assembly. Slide feed clip assembly on to drum housing.
- Add clip strap.
- Turn around holding down feed clip assembly and attach screws. Assembly is complete.
- Depress spacer rounds to check for free movement.
- Add graphite for lubrication.

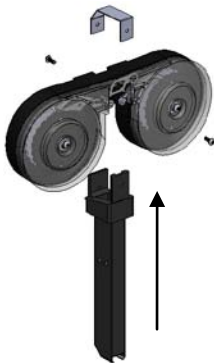

## TROUBLESHOOTING

<b>Characteristic</b>	<b>Cause</b>
Loading stops after about 40 rounds	Last-round-link-assembly is installed horizontally (incorrect).
Loading is very difficult.	(a) Rounds loaded backward (b) Dirty magazine
Life rounds mixed with spacer rounds in feed clip below linked assembly	One drum hesitated feeding. Sign of dirty magazine.
Spacer round is chambered	Same as above
Weapon bolt drives linked assembly into front of feed clip	Linked assembly is installed upside down.

## TROUBLESHOOTING

<b>Characteristic</b>	<b>Cause</b>
Linked assembly drags in feed clip	Linked assemblies have become lengthened. Maybe pushed back together and re-used, or exchanged.
Magazine falls out of weapon	Magazine is not fully seated in weapon.
Weapon fires several rounds, then jams. Magazine feeds well by hand when out of the weapon.	Check for secure attachment between the feed clip and drum assembly.
C-MAG rattles when empty full	This is normal.
C-MAG will not hold 100 rounds	More than 40 spacer rounds in the feed clip.

## **ACCESSORIES**

### **1. ACCESSORIES**

#### **1.1. Personal Loader** **See pages 8 and 9.**

#### **1.2. Pouch**

1.2.a The pouch is designed to hold

- 1 C-MAG Magazine
- 1 Personal Loader
- 2 Graphite Tubes
- 1 User Manual
- 1 Foam Loading Tool

1.2b The pouch is equipped with MOLLE attachment.

# POUCH UZI

USER MANUAL  
(INSIDE)



LOADER POCKET

GRAPHITE  
TUBE POCKET



## **C-MAG MAGAZINE SYSTEM UZI**

Includes the following components:

**C-MAG Magazine UZI**

**Personal Loader**

**Pouch UZI**

**User Manual UZI**

**Graphite Tube**

**Loading Tool**



## LIST OF PART NUMBERS

<b>Part No.</b>	<b>Description</b>
MUZ901	C-MAG SYSTEM UZI
MUZ921	C-MAG SYSTEM UZI with clear covers
CUZ900	C-MAG Magazine UZI
CUZ900-1	C-MAG Magazine UZI with clear covers
LCS905	Personal Loader
PUZ906	Pouch UZI
SUZ930	Feed Clip UZI
SHM931	Spacer Round 9MM
AHM933	Last-Round-Link-Assembly UZI
SHM902	Drum Back Cover Set 9MM with screws
SHM902CL	Drum Back Cover Set 9MM CLEAR with screws
SHM901	Clip Strap 9MM with screws
SHM960	Dust Cover 9MM

For further information contact:

**THE BETA COMPANY**

**2137B Flintstone Drive, Tucker, Georgia 30084, USA**

**Phone: +770 270 0773 OR 1 800 669 2382**

**Fax: +770 270 0599**

**Internet: [www.betaco.com](http://www.betaco.com)**