

# 998HVLP SIPHON FEED HVLP SYSTEM

**SHARPE**  
THE SPRAY GUN PEOPLE®

FOR PRODUCT INFORMATION CALL:  
**1 (800) SHARPE 1**

**System Includes:** 1-Model 998HVLP-S-85 Siphon Spray Gun (Comp. #5666)  
1-Model 450 "No Drip" Cup Assembly (Comp. #6610)

## System Description:

The 998HVLP SIPHON SYSTEM has been designed to provide you with the function and feel of a conventional spray gun while complying with all environmental regulations governing HVLP use. This Sharpe System affords the painter total control of all elements of painting: Pattern Size, Pattern Shape, Fluid Delivery and Atomization.

## SPECIFICATIONS:

### 998HVLP-S-85 Siphon Feed Spray Gun (Comp. #5666)

- Works and feels like conventional equipment.
- Superior atomization with less overspray.
- Superior corrosion resistant Niflor™ Fluid Tip.
- Stainless Steel Fluid Passage.
- Conforms to all environmental regulations governing high volume, low pressure (HVLP) spray equipment
- Requires 13.9 CFM for optimum performance

### 450T "No Drip" Cup Assembly (Comp. #6610)

- One Quart Capacity.
- Will not drip when spraying in any position.
- No accidental spills or damaged work.

## ORDER NO.

**5685 998HVLP-2.2S (2.2mm)**  
HVLP SIPHON FEED SYSTEM  
Recommended for  
medium solids colors and clears  
(Not for use with High Solids Materials)



## CAUTION: Read First Before Using

THE 998HVLP Siphon Feed Spray Gun is recommended for use with thin to medium viscosity materials (14-20 seconds Zahn #2 Cup).

If heavy materials are to be used it is recommended you use a pressure or gravity feed spray gun.

Please call customer service at (800) SHARPE1 or visit our website @ [www.sharpe1.com](http://www.sharpe1.com) for recommendations on specific paint company products.

## 998HVLP SIPHON FEED SYSTEM

### HVLP SYSTEM SPRAY GUN MAINTENANCE:

#### 998HVLP Siphon Feed Spray Gun:

1. The spray gun should be lubricated frequently, using a non-silicone oil. Place a drop on all moving parts, as shown in illustration.
2. Do not completely disassemble the spray gun if poor spray pattern occurs. See trouble shooting guide for information on how to correct this problem.
3. Never submerge complete spray gun in any cleaning solution.
4. Never use any hard objects, such as wire, paper clip, or welding tip cleaner to clean the air cap orifices. The air cap is made of high alloy heat treated aluminum and hard objects will damage the orifices. To clean the air cap, soak it in a compatible cleaning solution and use soft objects, such as a medium bristle brush.
5. Gun can be cleaned in gun washer.

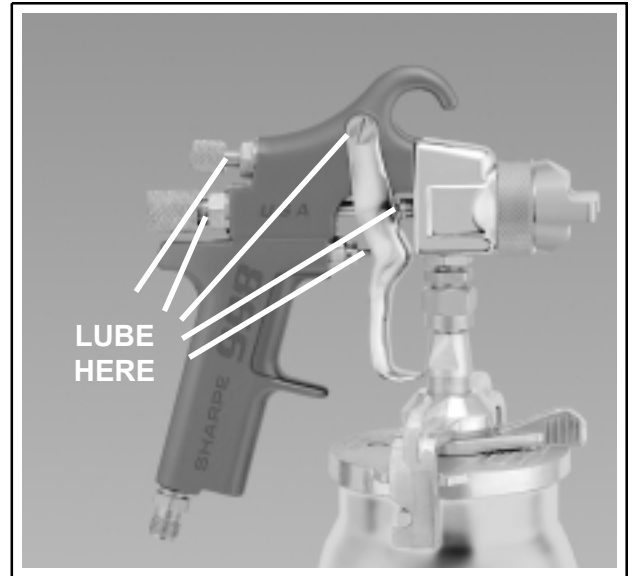

#### 450PTFE -Lined "No-Drip" Cup Assembly:

1. PTFE cup assembly may be cleaned with compatible solvents by hand or in gun washer.

### SPRAYING OPERATION:

**WARNING: Never pull trigger on spray gun when pointed in the direction of face, eyes or body.**

**To ensure optimum performance and compliance with applicable HVLP regulations, the following set-up procedure is necessary:**

1. The Model 998HVLP Series spray gun requires an air supply of 13.9 CFM. This would normally be supplied by a minimum 4 hp compressor in good working condition. In addition, the air hose leading to the gun should be at least 3/8" (inside diameter) also in good condition.
2. Insure that no air restrictions such as low-volume cheater-valves impede the air flow to the HVLP System. If an air adjusting valve is desired, use a SHARPE 24AAV (Comp. # 2210) Air Adjusting Valve.
3. After supplying adequate air to the gun, adjust the inlet pressure to the lowest level recommended by your paint manufacturer (usually 30-50 PSI). This will give you the best transfer efficiency and also optimize your paint savings. The gun will automatically reduce the spraying pressure to 10 PSI or less at the air cap.
4. The 998HVLP Series spray guns are designed to function at inlet pressure less than 40 PSI.  
**If you exceed 40 PSI inlet pressure, the pattern may distort and you may also exceed some HVLP compliance regulations.**
5. Once desired atomization is achieved, pattern size and shape is determined by adjusting the spray width adjuster knob (top knob on spray gun handle). Turn knob clockwise to reduce pattern size, turn knob counter-clockwise to increase pattern size. NOTE: See enclosed trouble shooting guide if you experience an irregular pattern.

# 998HVLP SIPHON SPRAY GUN

# SHARPE

THE SPRAY GUN PEOPLE®

(COMP. NO. # 5566)

## MODEL 975HVLP SIPHON FEED SPRAY GUN

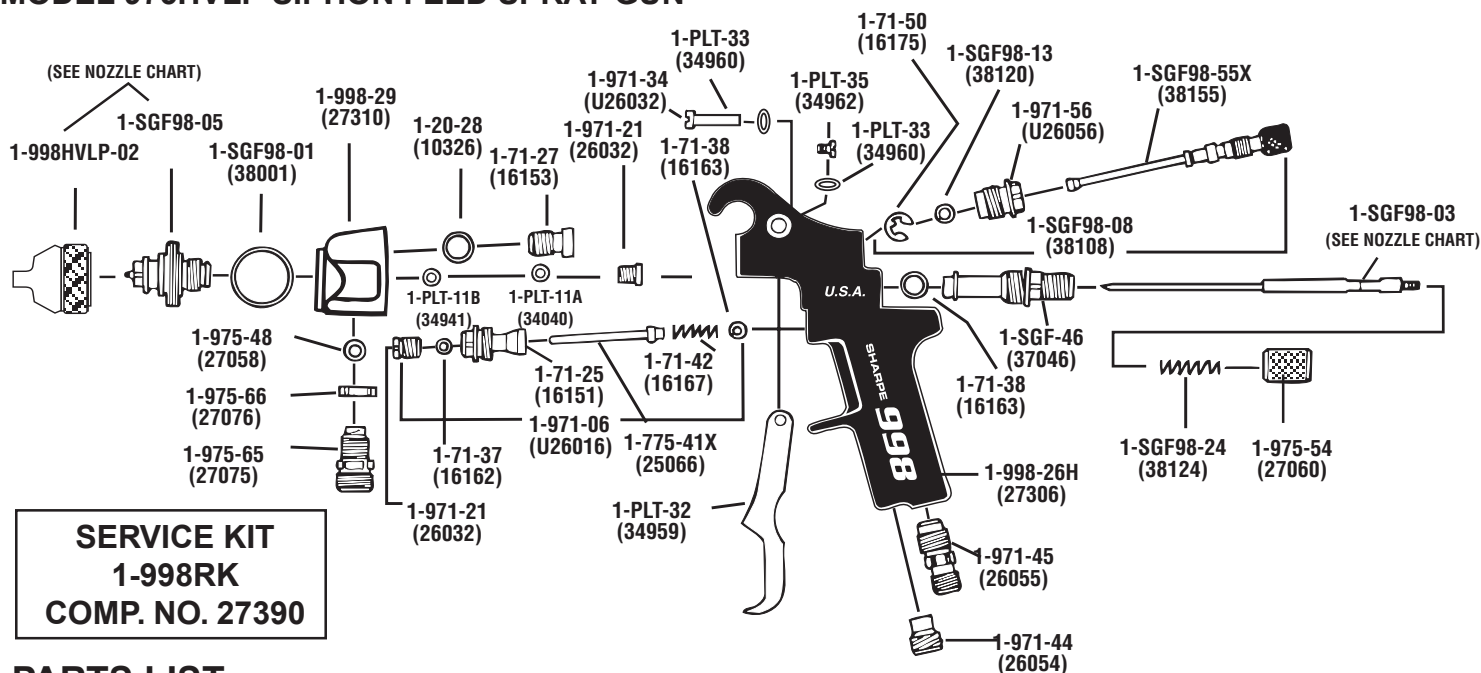

### PARTS LIST

PART NO.	COMP. NO.	DESCRIPTION	PART NO.	COMP. NO.	DESCRIPTION
1-20-28	10326	HEAD ATTACHMENT GASKET	1-SGF98-03	*	ORDER SGF-05 MATCHED SET (See Nozzle Chart)
1-PLT-35	34962	TRIGGER SCREW	1-971-06	U26016	AIR VALVE ASSEMBLY
1-SGF98-01	38001	TIP GASKET	1-SGF98-08	38108	WIDTH CONTROL ASSEMBLY
1-71-27	16153	HEAD ATTACHING SCREW	1-SGF98-13	38120	WIDTH CONTROL O-RING
1-71-37	16162	AIRVALVE PACKING	1-71-25	16151	AIR VALVE CAGE
1-71-38	16163	GASKET	1-998-26H	27306	HVLP GUN HANDLE
1-71-38	16163	GASKET	1-998-29	27310	HVLP GUN HEAD
1-71-42	16167	AIR VALVE SPRING	1-SGF-46	37046	MATERIAL CONTROL BUSHING
1-71-50	16175	"E" CLIP	1-975-48	27058	FLUID INLET GASKET
1-SGF98-24	38124	NEEDLE SPRING	1-975-54	27060	MATERIALCONTROL KNOB
1-775-41X	25066	AIR VALVE	1-SGF98-55X	38155	WIDTH CONTROL KNOB & VALVE
1-PLT-11A	34040	PACKING	1-971-56	U26056	WIDTH CONTROL BODY
1-PLT-11B	34941	PACKING SEAL	1-975-65	27075	FLUID INLET NIPPLE
1-PLT-33	34960	SPRING WASHER	1-975-66	27076	FLUID INLET LOCK NUT
1-PLT-33	34960	SPRING WASHER	1-SGF98-05	*	FLUID TIP & FLUID NEEDLE MATCHED SET(See Nozzle Chart)
1-971-21	26032	PACKING NUT			
1-971-21	26032	PACKING NUT			
1-PLT-32	34959	TRIGGER			
1-971-34	U26044	TRIGGER SHAFT			
1-971-44	26054	PLUG			
1-971-45	26055	AIR INLET NIPPLE			
1-998-02	*	AIR CAP (See Nozzle Chart)			

### NOZZLE CHART

SYSTEMS AVAILABLE	SPRAY GUNS AVAILABLE	AIR CAP	FLUID TIP & FLUID NEEDLE MATCHED SET	RECOMMENDED USAGE
998HVLP-2.2S COMP #5685	(2.2 mm) 998HVLP-S-85 COMP #5666	1-998HVLP-02#S Comp #27290	1-SGF98-05-2.2mm Comp #38119	Medium Solids Colors and Clears

# MODEL 450T PTFE LINED "NO DRIP" CUP ASSEMBLY

(COMP. NO. 6615)

# SHARPE

THE SPRAY GUN PEOPLE

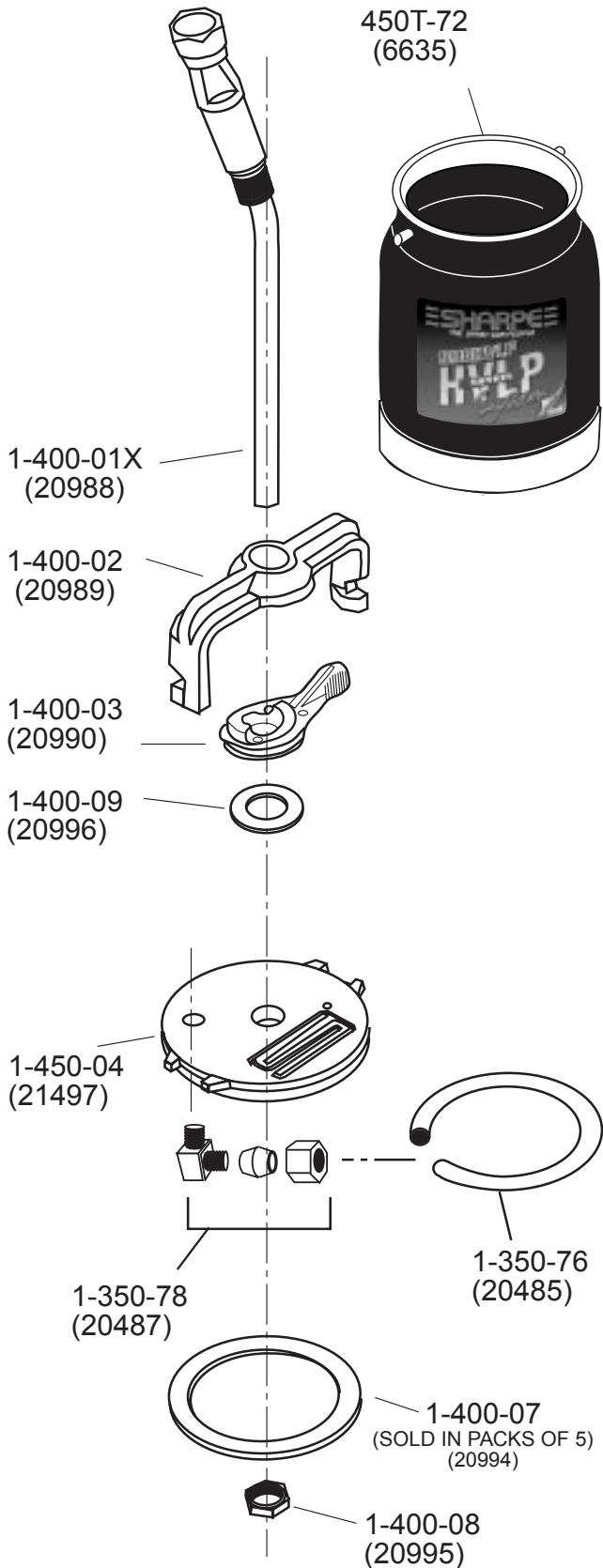

## PARTS LIST

PART NO.	COMP. NO.	DESCRIPTION
1-350-76	20485	NO-DRIP TUBE
1-350-78	20487	NO-DRIP ELBOW (Includes Nut & Ferrule)
1-400-01X	20988	FLUID ASSEMBLY (Includes Nut, Stem & Tube)
1-400-02	20989	BRIDGE
1-400-03	20990	LEVER
1-400-07	20994	GASKET
1-400-08	20995	LOCK NUT
1-400-09	20996	THRUST WASHER
450T-72	6635	<b>PTFE</b> LINED CUP
1-450-04	21497	LID