

BEKO

BKS 9118

Vacuum Cleaner

User's Manual



This product has been produced in environmentally friendly, modern facilities

Dear customer,

We would like our product, which is manufactured in modern facilities and which has been subject to detailed quality control process, to provide you with the highest productivity. **Therefore, we would like you to read this manual thoroughly before you start using the product and we would like you to keep it as a reference.**

BEKO

C O N T E N T S



Part 1: Safety Warnings / 3



**Part 4: Maintenance and
Cleaning / 7**



**Part 2: Technical Aspects of
your machine / 4**



Part 3: Using your machine / 5-6

Part 1: Safety Warnings

When using an electrical appliance, basic safety precautions should always be followed, including :

- ☛ Make sure that the voltage indicated on the appliance corresponds with the main voltage in your home.
- ☛ To prevent harming your appliance, do not use extension cords that supply insufficient current.
- ☛ Always unplug your appliance from outlet when not in use and before putting in and taking of any accessories, and before cleaning and maintenance.
- ☛ Do not use harmful chemicals and/or abrasive cleansers.

CAUTION : Do not use your appliance for vacuuming any flammable liquids such as gasoline, thinner, alcohol, kerosene, etc; as well as abrasive liquids such as acids, etc.

Attention!

Before using the product, read carefully the following operating instructions. It is suggested that you keep these instructions in safe place.

Check whether the voltage indicated on the base of the product is the same as the voltage in your home.

CAUTION : Do not let use your appliance to vacuum burning cigarettes, active cigarette ashes or matchsticks.

- ☛ Your close supervision is necessary when any appliance is used by or near children, old persons, or infirm persons.
- ☛ Your appliance has been designed for household use only. Do not use for industrial or commercial purposes, or under heavy duties.
- ☛ Ensure not to move the appliance over its cord, which may damage the insulation of the unit.
- ☛ Do not place on or near direct heat sources, such as hot stove, burner, or a heated oven.
- ☛ Never immerse the main body (i.e. the motor section) of your unit in water, and prevent from spilling out any water on the appliance.
- ☛ When using your appliance, never hold the suction hose close to your eyes and ears.
- ☛ Do not attempt to remove any sharp objects such as glasses, etc.

- ☛ To unplug, grasp the plug and pull from the power outlet. Never pull the cord.
- ☛ Do not attempt to remove the main plug when your hands are wet.
- ☛ If you are in doubt that the cord or plug is damaged, or that your device malfunctions in any manner whatsoever, including dropping down, etc., never turn on your appliance, nor attempt to repair by yourself. Take it to the nearest authorized service centre immediately.
- ☛ This appliance is not intended for use by persons (including children) with reduced physical, sensory or mental capabilities, or lack of experience and knowledge, unless they have been given supervision or instruction concerning use of the appliance by a person responsible for their safety.
- ☛ Children should be supervised to ensure that they do not play with the appliance.





Part 2: Technical Aspects of your machine

Voltage / Frequency : 220-240V~ 50/60 Hz.
Power : 1800 W Max.
Isolation Class : □
Net weight : 8900 gr.
Dimensions : 405 x 405 x 635 mm.
Protection Class : IPX 4
Water/Liquid Suction Capacity : 11 lt.

1. Motor Unit
2. Handle
3. On/Off Button
4. Blow Cover Lid
5. Hose Inlet Hole
6. Container
7. Container Locking / Unlocking Part
8. Wheels
9. Hose Inlet Part
10. Hose
11. Hose Handle
12. Extension Tubes
13. Wet Surface Tool
14. Small Brush
15. Crevice Tool
16. Floor Brush
17. Dust Bag
18. Cloth Filter

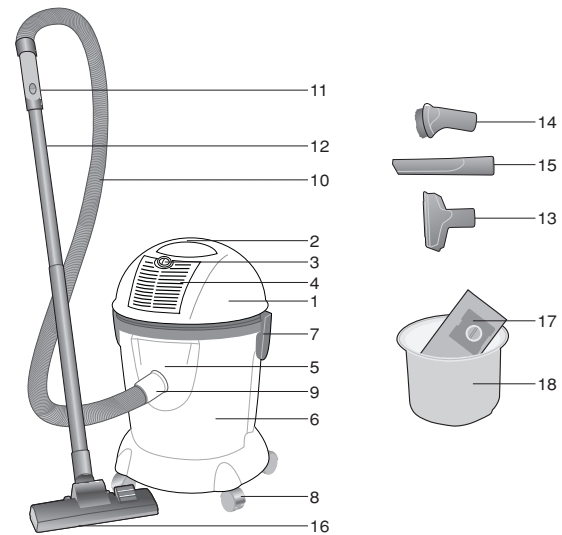

Part 3: Using your machine

Operating the appliance:

After checking if the voltage meet the rated voltage, plug in the appliance.

Press switch button located on the top of the appliance.

For Dry Use:

If the appliance has already been operated for wet cleaning, ensure that all accessories, filters and float sponge are properly dried. You can operate the appliance for about 5 minutes without cleaning to facilitate

the drying.

Dust filter should be attached to the appliance before beginning the dry vacuum.

All accessories are allowed to be used during the dry vacuum.

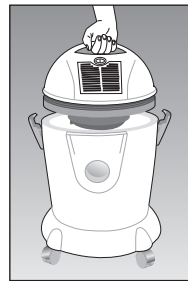

Figure 1

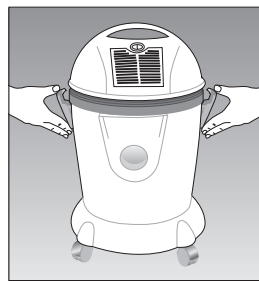

Figure 2



Figure 3

For Wet Use:

You must not use the accessories of dry use while vacuuming water. Dust filter should also be removed. Only wet ground cleaning accessory can be used during this operation. To ensure that there is no water

remaining in the hose and tubes, hold up these parts before switching off the appliance.

Blower Function:

Remove the blower cover lid and insert the hose into the opening on

the body.

Please make sure that the dust bag or the cloth filter has been removed from the unit before using the blower function.

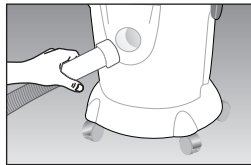

Figure 4

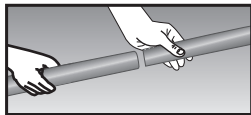

Figure 5

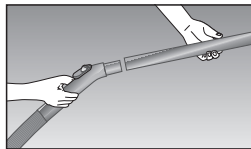

Figure 6

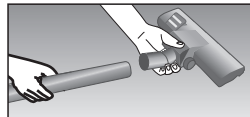

Figure 7

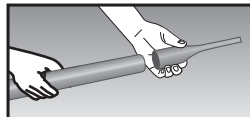

Figure 8

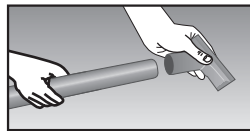

Figure 9

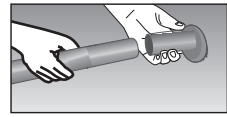

Figure 10

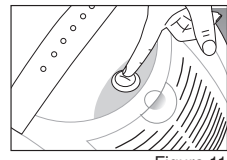

Figure 11

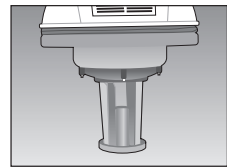

Figure 12

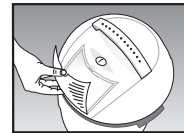

Figure 13

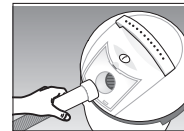

Figure 14

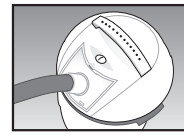

Figure 15



Part 4: Maintenance and Cleaning

Emptying The Tank and Cleaning the Filters

- Since the appliance has volume of 16 lt. for dry cleaning, there is no need to clean up often.
- If the suction significantly drops, it can be understood that the filter is saturated.
- You can rinse the filter with tepid water after shaking the filter to remove dusts.
- The wet capacity of the appliance is 11 lt.

- During the wet suction, when the liquid reaches to the maximum level the float automatically block the motor entrance and the suction will be cut off. In this case you can empty the tank and restart to process.

Warnings

- Except wet vacuuming, dust filter should always be attached to the appliance.
- During the wet use, if the float come up and block the suction before the liquid reaches the max.

level, switch off the appliance and wait until the float drops back into its previous position (you can hear the noise when the float drops back). If the problem repeats, stop the appliance, unplug and check if the float sponge is saturated. You should clean up the filter and replace it after drying, then you can restart the appliance. During the use, if the appliance overturns, the float will block the suction again. You should stop the motor, put into original position, and wait until the float drops back.

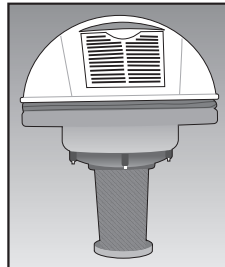

Figure 16

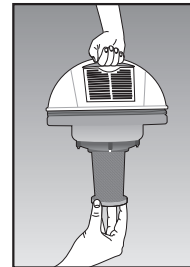

Figure 17