

STREACOM™
FC5WS^{EVO}
USER GUIDE

Page

2.....	Index, Foreword
3.....	Product Overview
4.....	Preparing for Assembly
5-6.....	Installing the Motherboard
7-8.....	Installing the CPU Cooler
9.....	Installing PSU & Other Accessories
10.....	Wiring Diagram
11.....	Installing Hard Drives
12-13.....	Installing PCI Card (Optional)
14.....	Replacing the Top Panel
15.....	Notes

Foreword

Thank you for your purchase of this Streacom product, every care has been taken to ensure that it meets with the high standards that we have set for ourselves.

Should you have any questions that are not covered in this user guide, support can be offered via email through our website at www.streacom.com

We sincerely hope that you enjoy using our product!



Specification

Chassis Material	Aluminum
Available Colours	Silver / Black - Sandblast Finish
Motherboard Compatibility	Micro ATX, Mini ITX
HDD Drive Support	4 x 2.5" or 3 x 3.5"(Mini ITX Only) or mix of both (see guide)
Cooling Method	Passive - 4 x Heatpipe Direct Touch (Recommended 65W TDP*)
Expansion Ports	1 x Half or Full Height (Riser Card Required)
Dimensions	435 x 325 x 60mm (WxDxH)
Power Supply Support	Optional NanoPSU DC power
IR Solution	Optional MCE Compatible IR Receiver & Remote
Net Weight	5.2KG

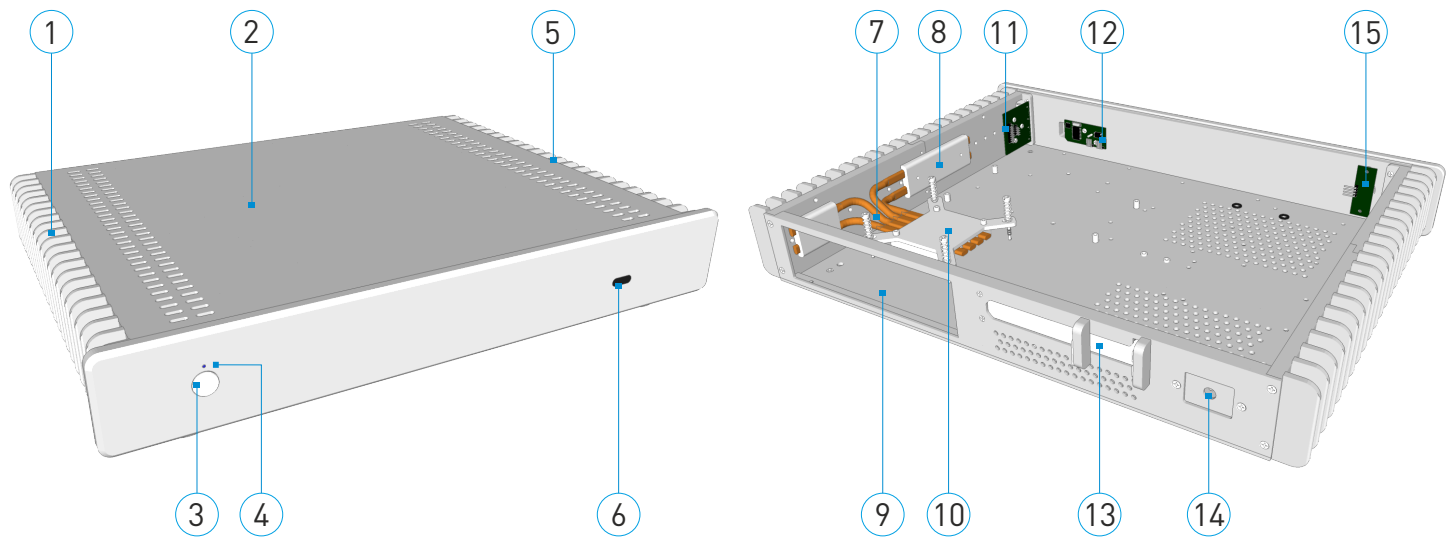

Key Features

1..... Heatsink	7..... CPU Cooler Heatpipe	13.... PCI Expansion Slot
2..... Top Panel	8..... Heatsink Connectors	14.... DC Power Jack Hole
3..... Power Button	9..... IO Shield Slot	15.... Power Button PCB
4..... Power LED	10.... CPU Cooler	
5..... Heatsink	11.... USB Ports PCB	
6..... IR Receiver Window	12.... IR PCB (Optional)	

Removing the Top Panel

The top panel is held in place with 4 screws, 2 each side of the case that are accessible between the heatsink fins. Remove the screws, slide the top panel back then upwards away from the chassis.

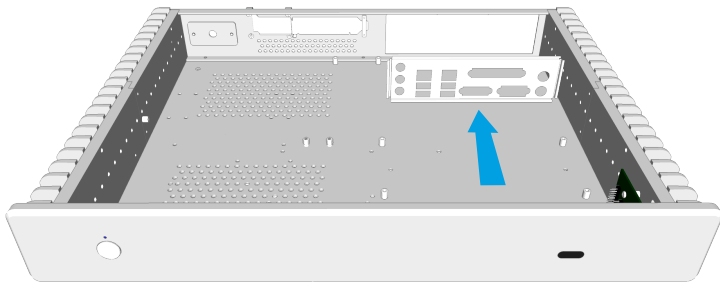
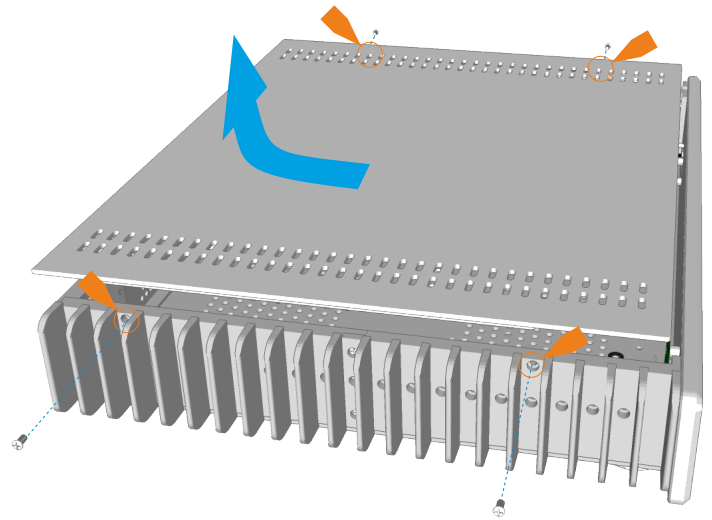

Installing the I/O Shield

Locate the I/O shield that is supplied with your motherboard and firmly push it in place. Ensure that it clicks in place fully otherwise the motherboard will be difficult to fit.

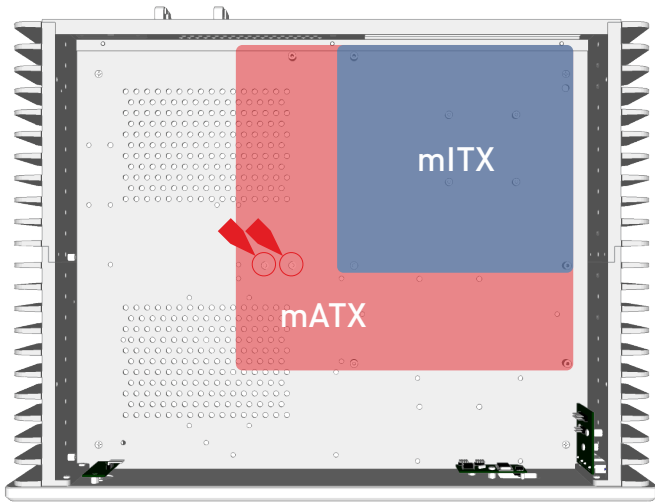

Installing the Motherboard

The FC5 Evo can accommodate either a mini-ITX or micro-ATX motherboard. The choice of motherboard will determine the number of hard drives that can be installed and the location. For mATX boards, additional standoffs can be added to the positions shown in red.

Fitting the CPU Cooler Mounting Nuts

The kit includes 4 mounting nuts which should be attached to the motherboard prior to fitting it inside the chassis. The nuts are held in place by adhesive pads and will be required later to mount the CPU cooler.

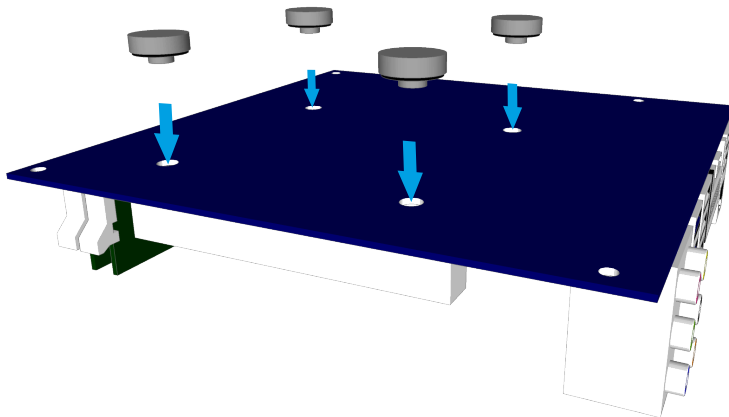

CPU Cooler Mounting Nut

Adhesive Pad

Protective Label

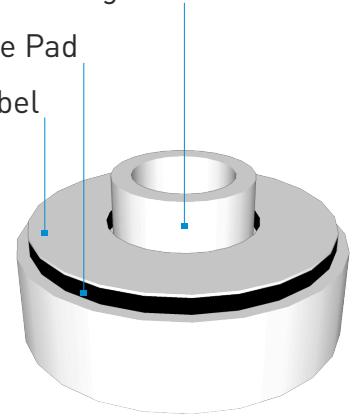

With the motherboard upside down, located the 4 CPU cooler mounting holes. Peel the protective label off the mounting nuts and stick them to the underside of the motherboard ensuring they correctly align with the holes. The raised rim of the nut should fit inside the motherboard hole.

Fitting the Motherboard

Carefully lower the motherboard into the chassis, with the I/O port side leading so that the ports can fit into the I/O shield.

When the motherboard is correctly in position, fix it to the chassis stand-offs using the screws provided. Ensure that all the holes correctly align before fully tightening the screws.

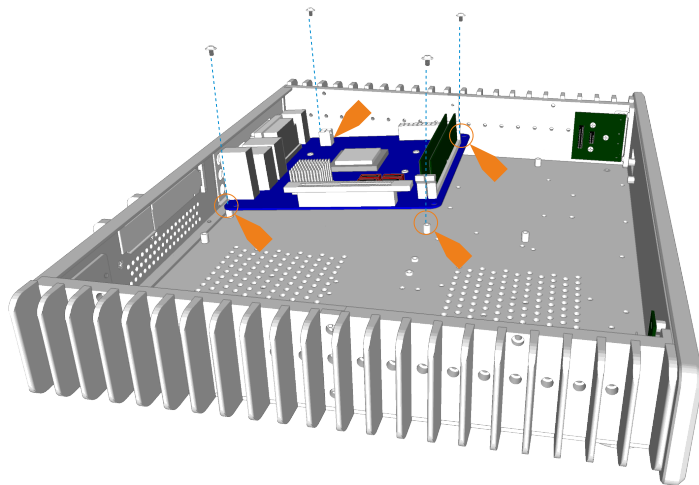

Upper CPU Mount
(Intel® or AMD® type)

Heatsink Connector
Blocks

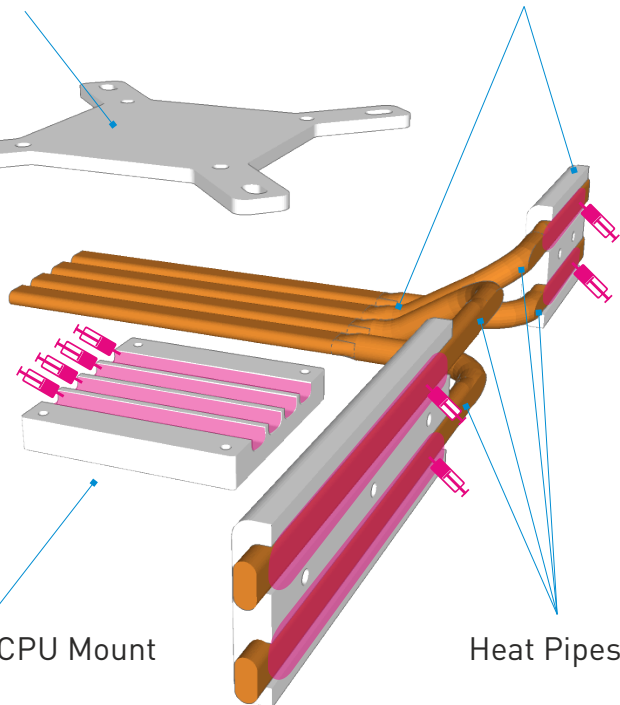
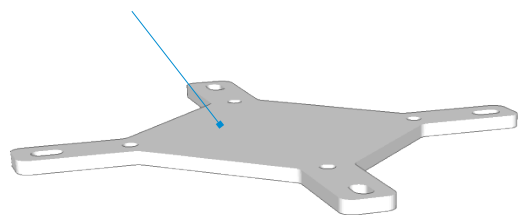

Lower CPU Mount

Heat Pipes

CPU Cooler Overview

The passive CPU cooler comprises of 3 main parts. The CPU mount which fixes to the CPU & motherboard, the heat pipes that transfer the heat, and the heatsink connector blocks that fix the heatpipes to the chassis side panel (heatsink).

In order to ensure efficient heat transfer, thermal paste should be applied to the surfaces shown. Do not apply the thermal paste until the parts are ready to be installed.

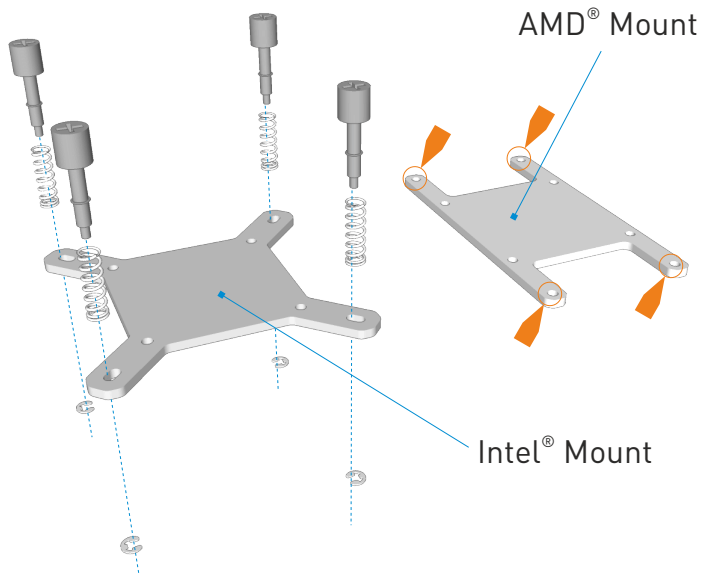

Assemble the Upper CPU Mount

Depending on which type of motherboard and CPU socket you have purchased, you will either need to assemble the Intel® or AMD® type upper CPU mount. You do not need to assemble both.

The mount is assembled as shown with the long CPU retention screws, springs and C clips attached to the outer arms of the mount..

Affix the Lower CPU Mount

Apply a thin and even layer of thermal paste to the surface of the CPU then carefully position the lower CPU mount onto the CPU ensuring it is centrally located. The heatpipe grooves should be facing in the direction of the heatsink.

Thermal paste can also be applied to the heatpipe grooves in perpetration for the next step.

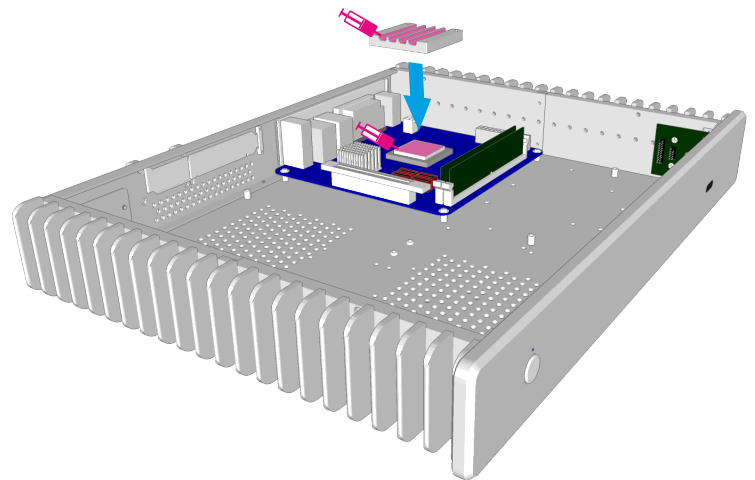

Installing the CPU Cooler Assembly

1. Attach the heatsink connector blocks and heatpipes to the chassis. We recommend fitting one side at a time (pairs of heatpipes). Secure the connector blocks with screws ensuring the heatpipes align and sit accurately in the grooves of the lower CPU connector. Do not fully tighten the screws.
2. With all 4 heatpipes attached, position the upper CPU connector onto the lower CPU connector, sandwiching the heatpipes between them and secure upper and lower parts together using the HEX screws and allen key supplied. Do not fully tighten the screws.
3. Ensuring the 4 spring loaded screws correctly align with the CPU cooler mounting nuts (you installed earlier under the motherboard), carefully tighten each screw (one turn each side, alternating sides) until fully secured. You can now fully tighten all the screws.

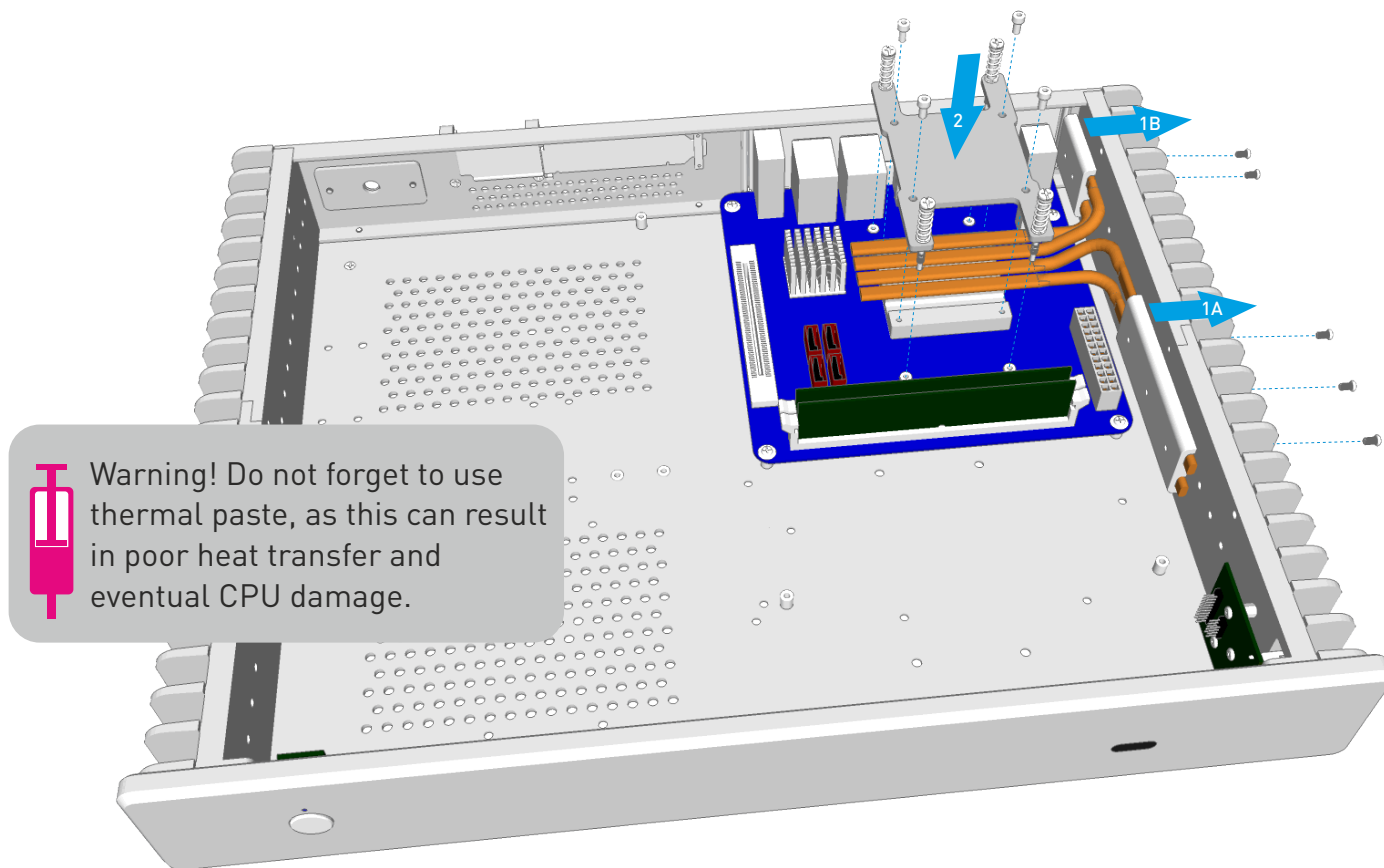

Connect the PSU, Optional IR & Other Cables

With the motherboard and CPU cooler in place, you can now connect the PSU and any other internal connections such as the SATA cables in preparation for installing the hard drives. For more details on installing the PSU and IRRC, see the user guides supplied with those accessories.

Connect the front USB ports and the power button switch to the motherboard. As the majority of current motherboards do NOT support an INTERNAL USB3.0 header, this case is only supplied with the USB2.0 cable. Customers that do purchase a USB3.0 compatible motherboard must purchase the internal USB3.0 cable separately. See diagram on next page for wiring details.

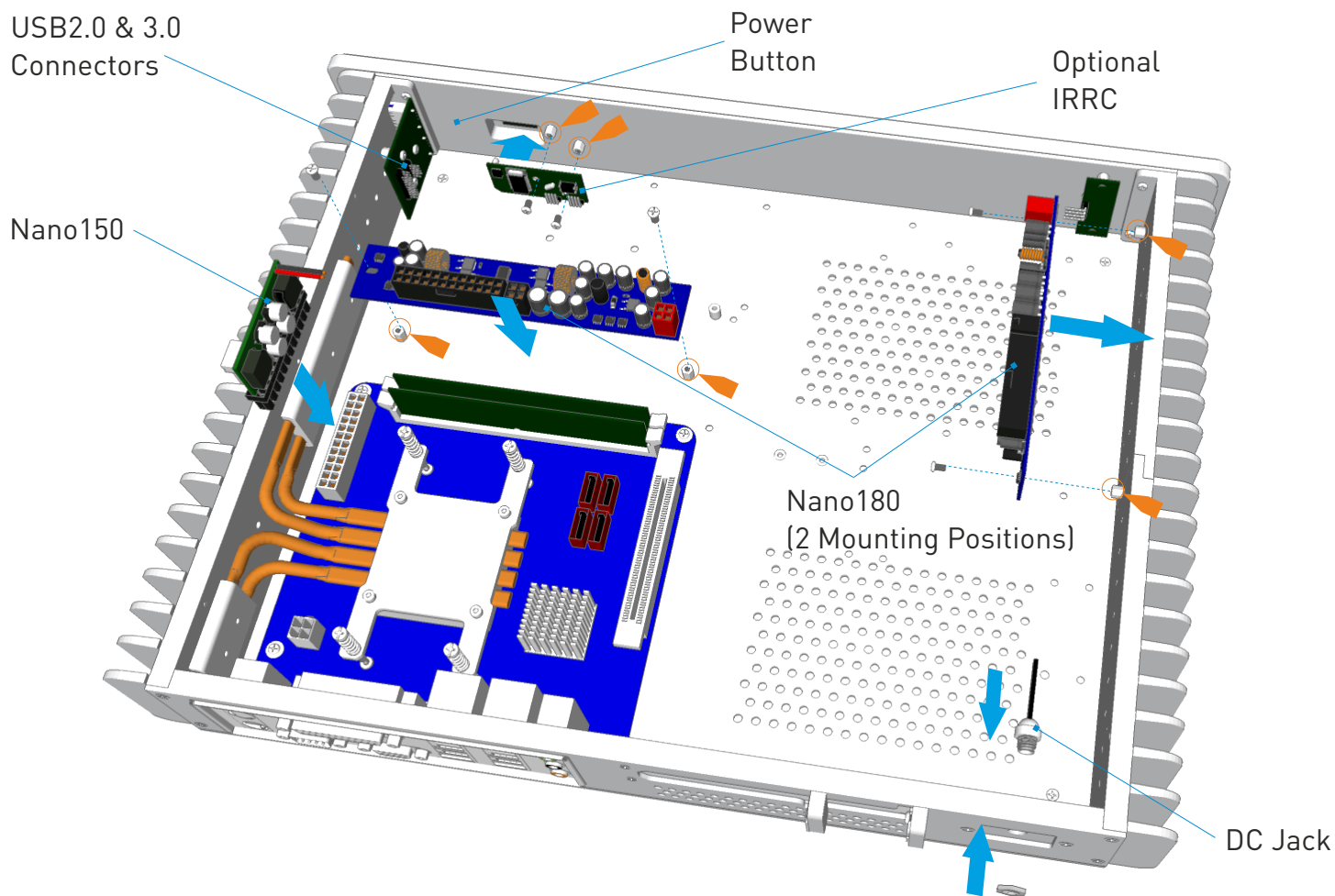

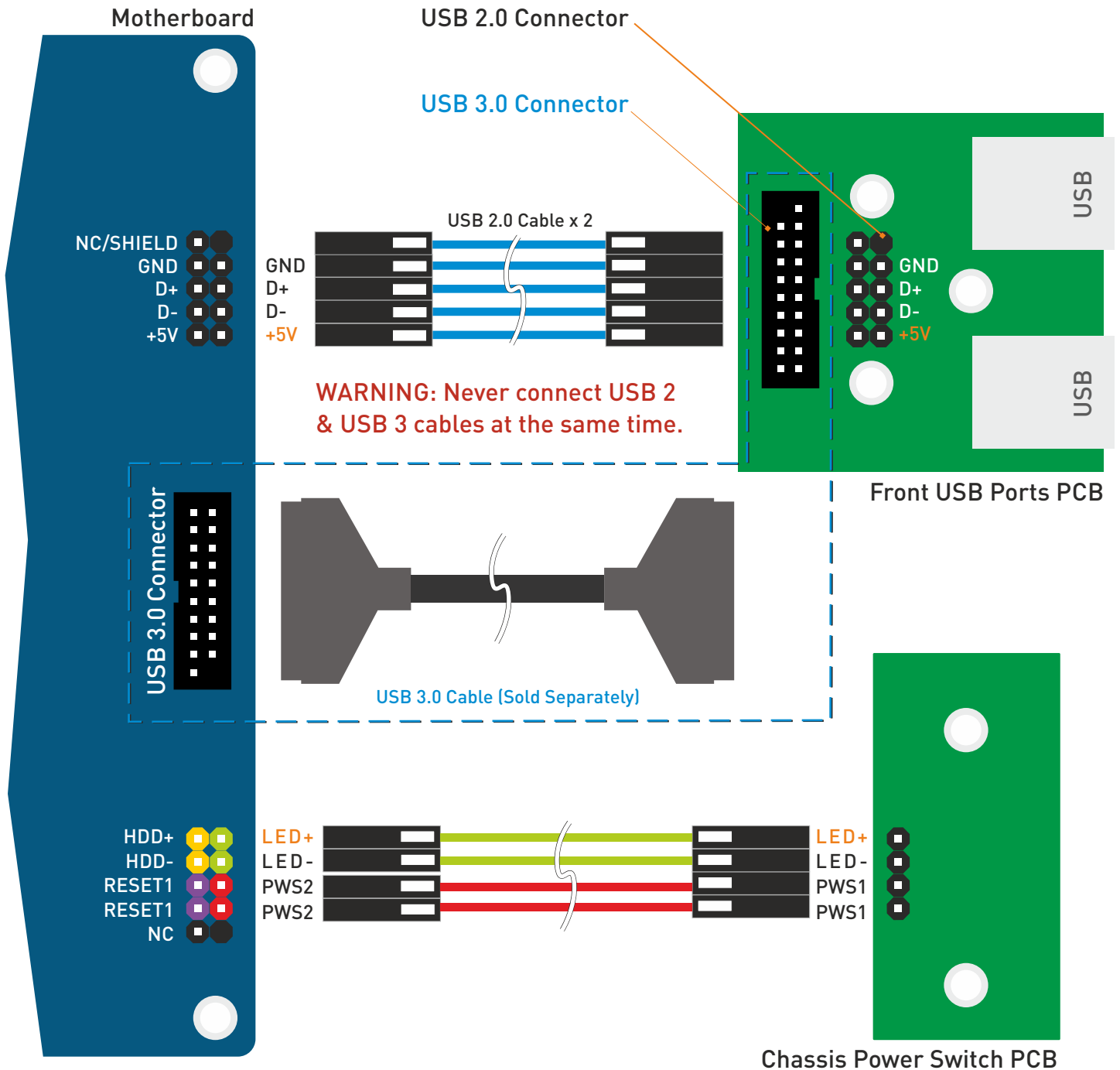

Cable colours shown are for illustrative purposes only, actual colours will vary.

Installing the Hard Drives

The FC5 Evo has 7 drive mounting areas which are available depending on which size motherboard is fitted. Additionally, the total number of drives that can be installed will depend on which size hard drive is being installed, 2.5" (shown in purple) or 3.5" (shown in blue). Areas that have overlap indicated that either a 3.5" or 2.5" can be installed, but not both at the same time and drives marked 'ITX ONLY', can only be used when an ITX board is fitted. Drives are fitted by screwing them to the bottom panel from underneath. Rubber pads are supplied and should be fitted to the mounting holes prior to fitting the drives.

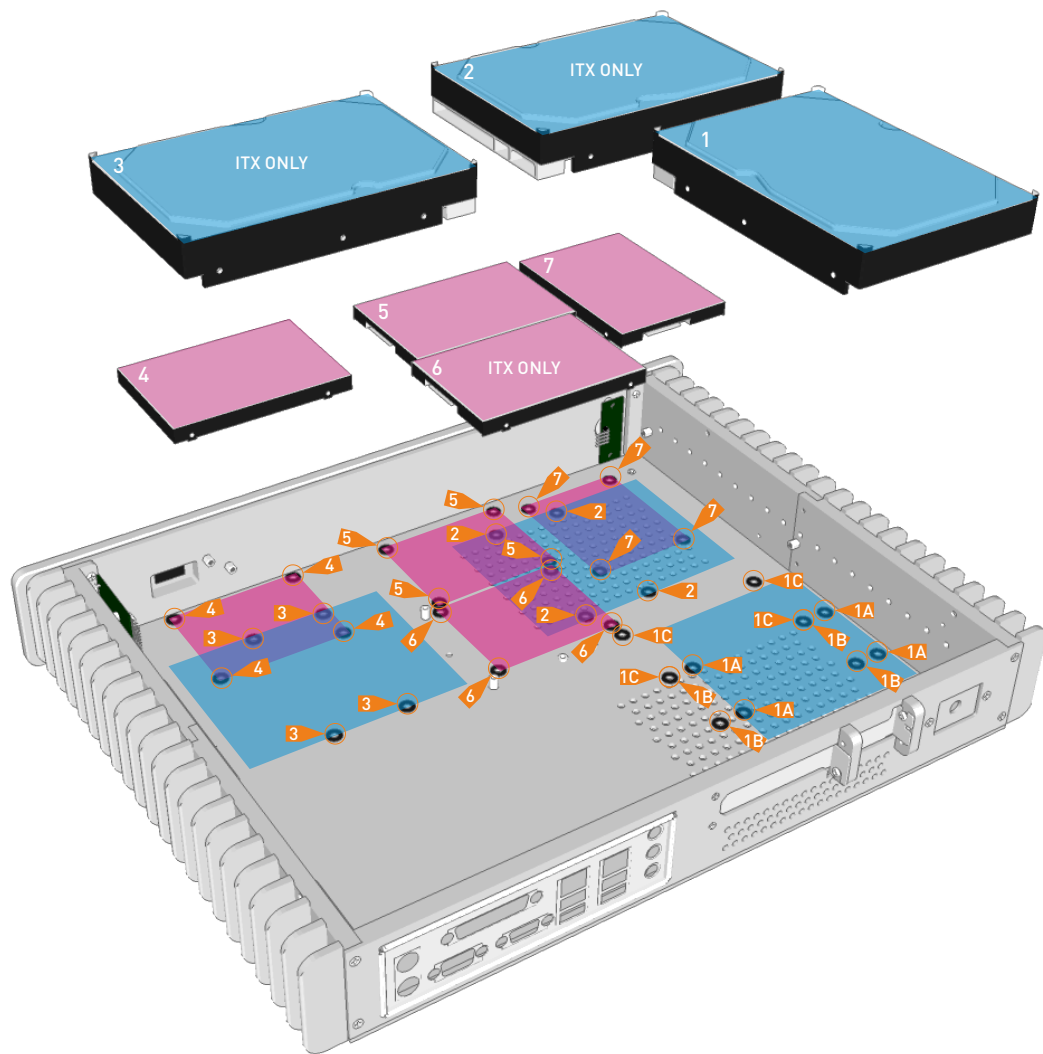

Installing PCI Card (Optional)

The FC5 Evo can accept either a half height or full height expansion card. When installing a half height card, you only need to remove the low profile blanking plate (A). When installing a full height card, remove both blanking plates and the low profile support (A+B)

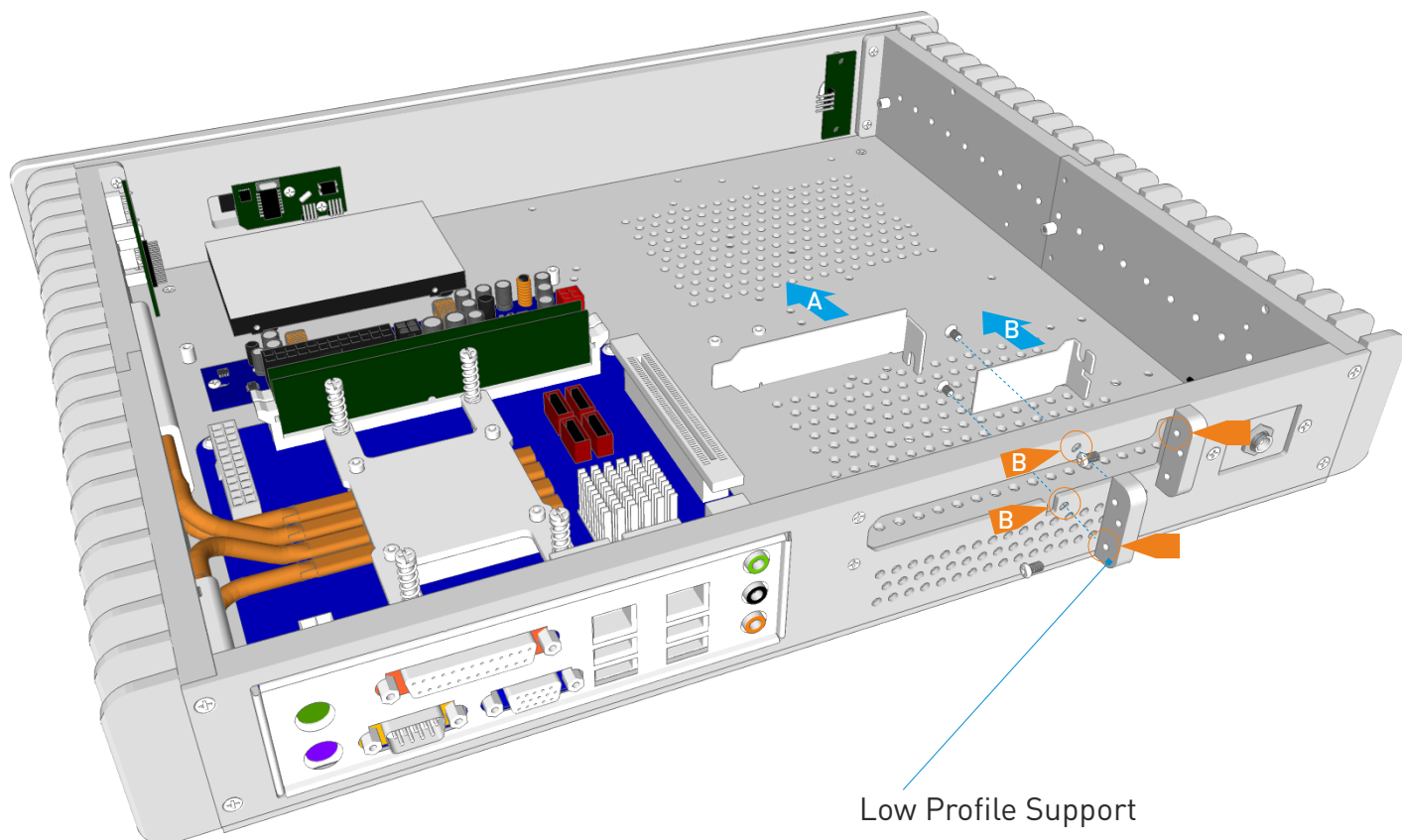

Fit the PCI card into the opening and secure it in place with the PCI bracket screw. If you are having trouble fitting the card, try removing the screws shown in red. After the card fits into the opening, replace the screws and bracket.

A flexible riser card is required to connect the card to the motherboard (the riser card is not supplied with the chassis)

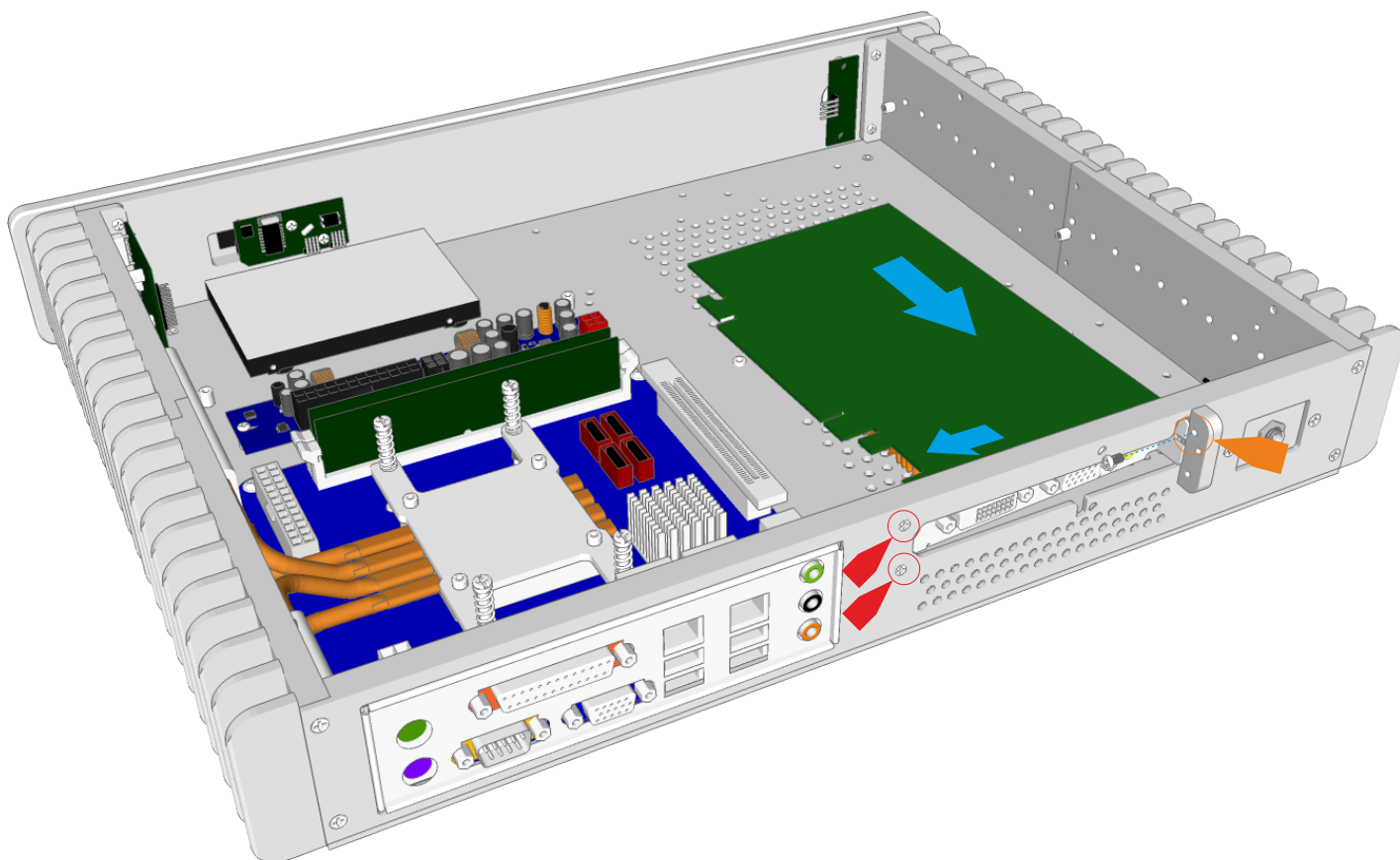

Replace the Top Panel

With all the components installed, the chassis can now be closed. Prior to doing this, ensure that all cables are connected and all components are securely fitted. Replace the top panel and secure it in place using 4 screws, 2 from either side of the case, between the heatsink fins.

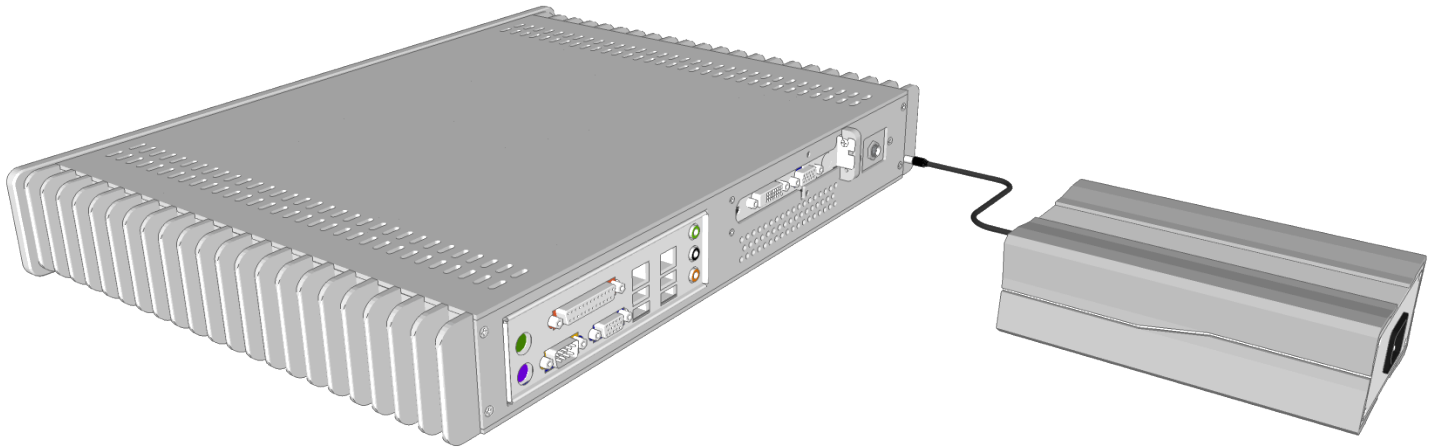
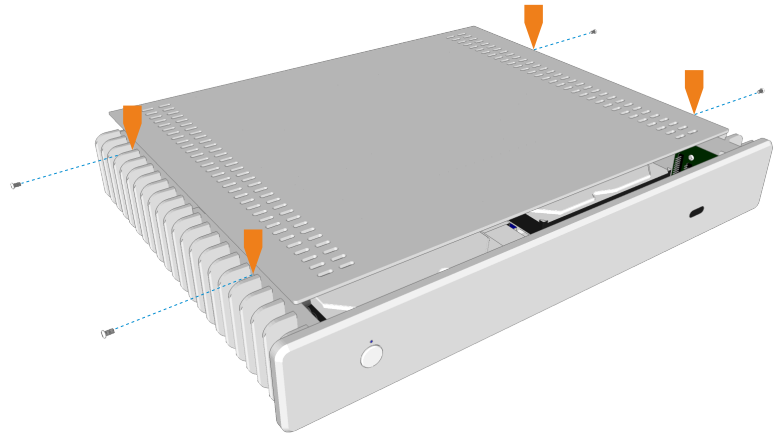

Connect Power & Other Cables

With the chassis now fully assembled, all that remains is to connect the power and other cables.

When choosing a suitable place to position your chassis, please consider an area with adequate air flow and a moderate room temperature.

A series of 20 horizontal dotted lines spanning the width of the page, providing a template for writing notes.

STREACOM

Melbournestraat 56,
3047 BJ Rotterdam,
The Netherlands
www.streacom.com

V1.12.08