

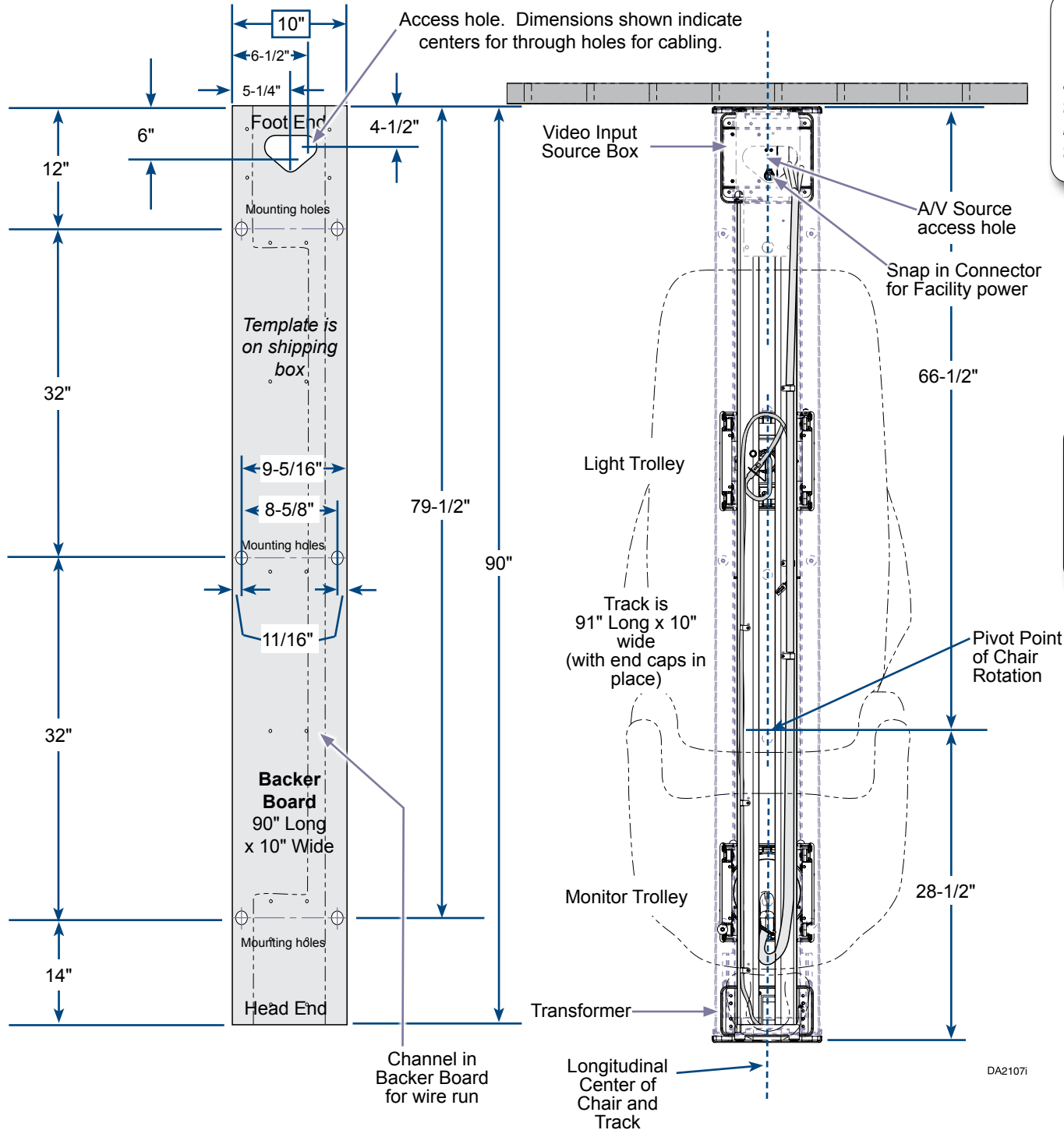

## Recommended Mounting Locations



### Equipment Alert

The A/V Cable and Facility Power line require two 2-1/2" minimum diameter access holes thru the ceiling. Visually confirm that you will have room to feed the cables thru the backer board access hole before mounting the track to the ceiling.

### Note:

Consult a professional to verify installation complies to all local building codes.



### Equipment Alert

Remove the Video Input Source Box Cover and Power Source Cover while the track is still in the box so you can see the Facility Power and A/V Cable input access holes as you mount the track on the ceiling.

### Note

In addition to a template on the shipping box, a full size paper template, part number 003-2022-00, is also available.



### Equipment Alert

The orientation and position of the track mounted light and monitor in relation to the chair is critical!

## Recommended Ceiling Support Structure

### Note

Midmark does not supply the ceiling support structure; these illustrations show suggestions only. Consult a qualified professional to install the appropriate support structure. The weights listed apply only to the track system, not the ceiling support. To prevent the flex arms from drifting, the track assembly must be level and not deflect more than 1/16" over a 12" span.



### WARNING

Use only the Lag Bolts (3 1/2" x 5/16") supplied with the track assembly. Do not substitute a lower grade. All 6 Lag Bolts and Washers must be used to secure track to support structure and they each must be anchored in a supporting stud. Pre-drill pilot holes in structure with a 7/32" diameter drill bit to prevent cracking the support structure. Drill holes 2 3/8" deep.

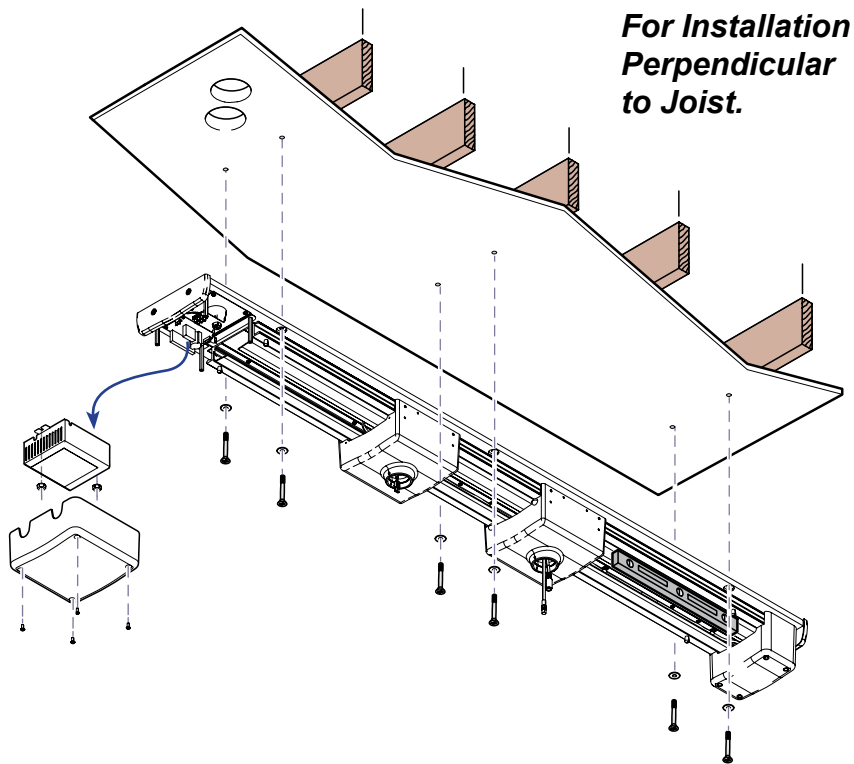

**For Installation  
Perpendicular  
to Joist.**

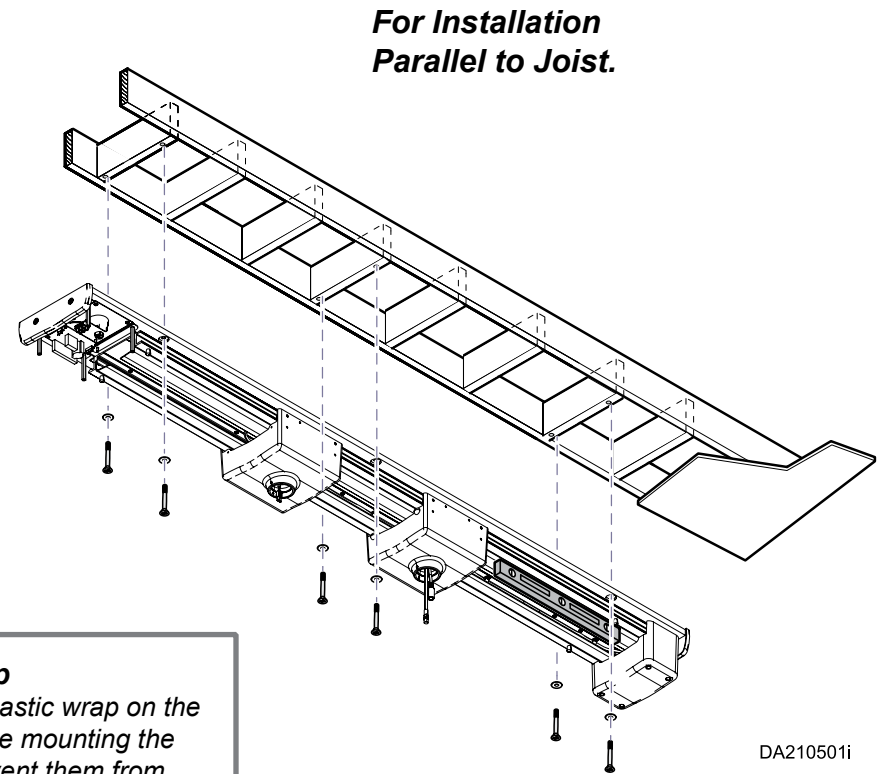

**For Installation  
Parallel to Joist.**

### Service Tip

Leave the plastic wrap on the Trolleys while mounting the track to prevent them from rolling up and down the track.

DA210501i



### Equipment Alert

The A/V Cable and Facility Power line require two 2-1/2" minimum diameter access holes thru the ceiling. Visually confirm that you will have room to feed the cables thru the backer board access hole before mounting the track to the ceiling.



### Equipment Alert

Track with Light and Monitor  
Weight (Max.)..... 157 Lbs. (71 kgs)

## Recommended Ceiling Support Structure...continued

### Note

Midmark does not supply the ceiling support structure; these illustrations show suggestions only. Consult a qualified professional to install the appropriate support structure. The weights listed apply only to the track system, not the ceiling support. To prevent the suspension arms from drifting, the track assembly must be level and not deflect more than 1/16" over a 12" span.



### Equipment Alert

The A/V Cable and Facility Power line require two 2-1/2" minimum diameter access holes thru the ceiling. Visually confirm that you will have room to feed the cables thru the backer board access hole before mounting the track to the ceiling.



### Equipment Alert

Track with Light and Monitor  
Weight (Max.).....157 Lbs. (71 kgs)



### WARNING

Use only the Lag Bolts (3-1/2" x 5/16") supplied with the track assembly. Do not substitute a lower grade. All 6 Lag Bolts and Washers must be used to secure track to support structure and they each must be anchored in a supporting stud. To prevent cracking of support structure, pre-drill pilot holes in structure using a 7/32" diameter drill bit. Drill holes 2-3/8" deep.

### For Existing Construction with Joists running parallel

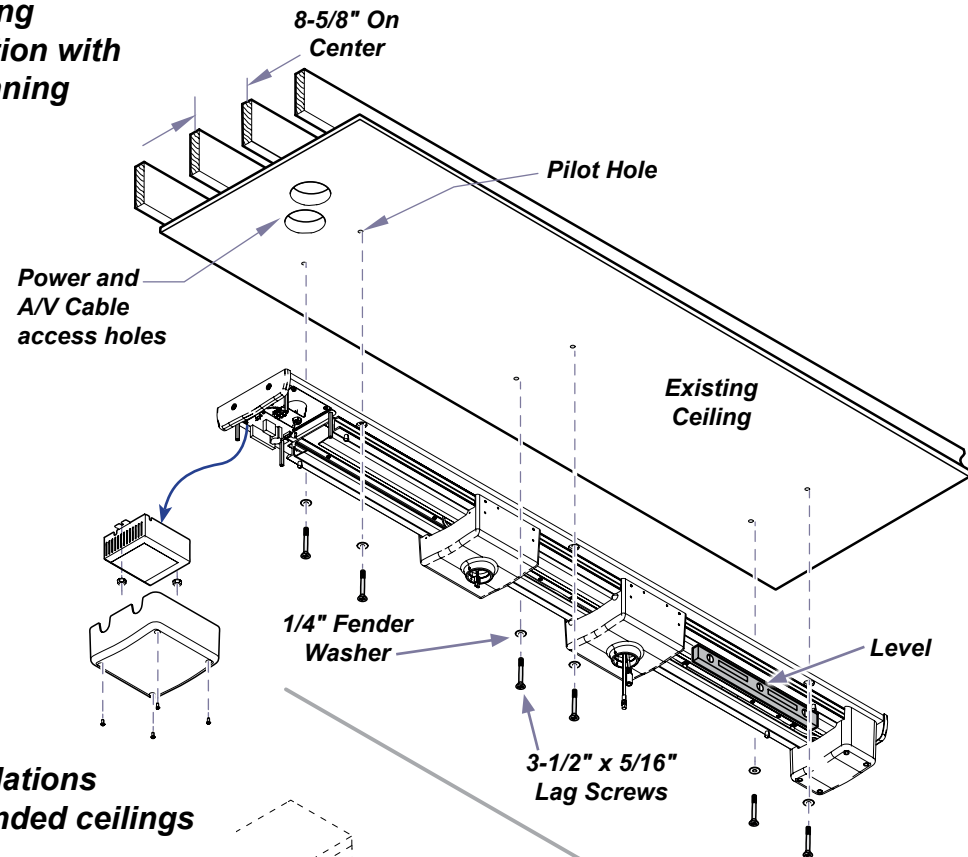

### For installations on suspended ceilings

Support Structure built to Local Codes

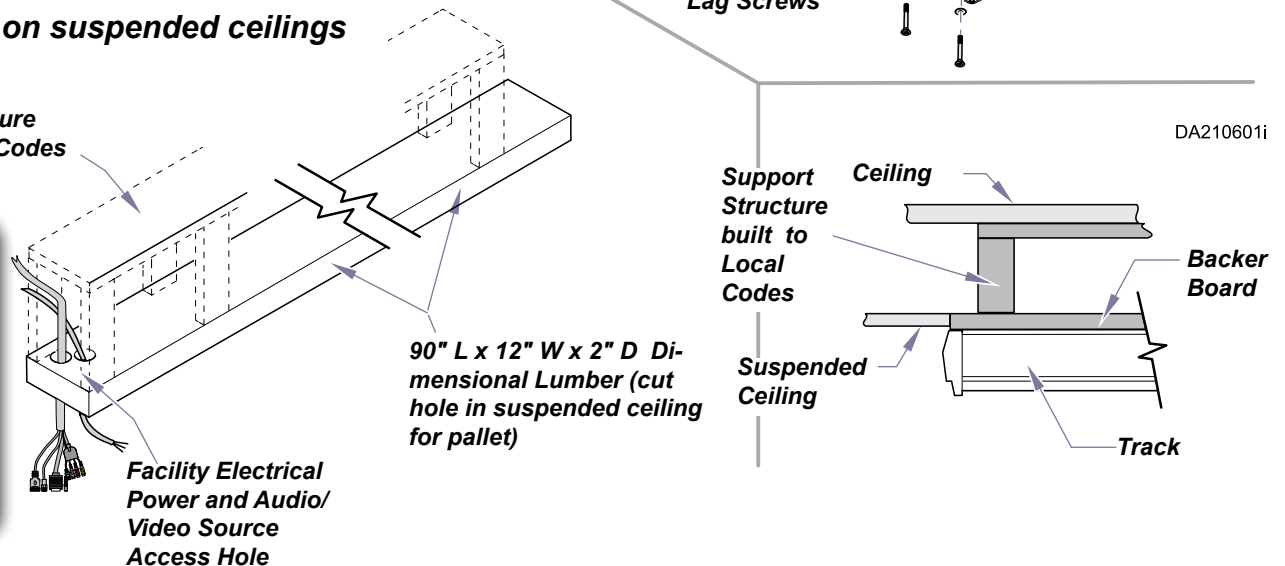

## Connections at the Video Control End (Foot of the Chair)



### WARNING

Turn off the Facility power to this circuit at the Electrical Control Panel before wiring the power to this unit.

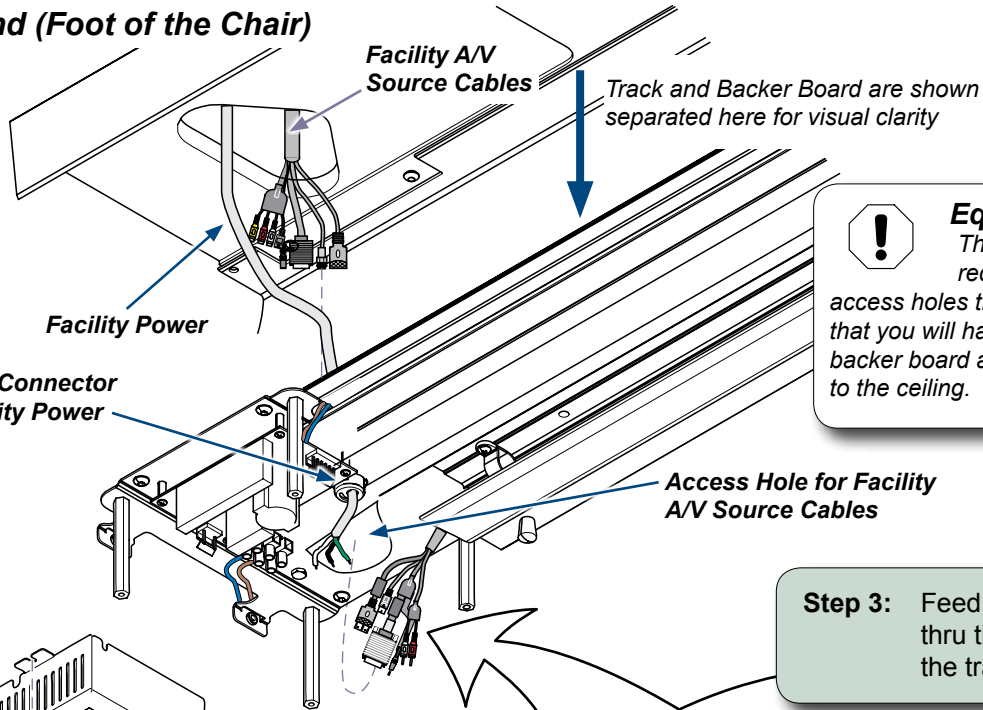

### Equipment Alert

The A/V Cable and Facility Power line require two 2-1/2" minimum diameter access holes thru the ceiling. Visually confirm that you will have room to feed the cables thru the backer board access hole before mounting the track to the ceiling.



### WARNING

Always disconnect light from the power source before removing any covers. Failure to do so may result in personal injury.

**Step 1:** Remove the video input source box cover (four screws) and the power source cover (two nuts).

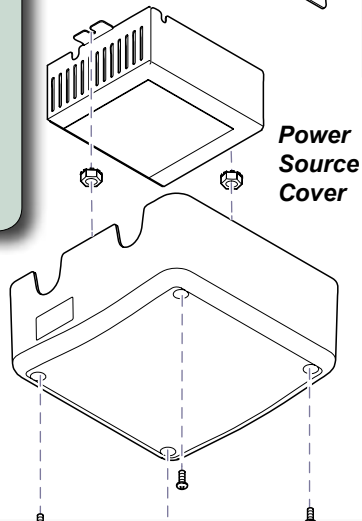

**Step 3:** Feed the facility A/V source cables thru the access hole and connect to the track A/V cables.



### Caution

Connect ground wire to ensure system ground continuity. Failure to do so may result in electric shock.

**Step 2:** Feed the facility power through the clamp hole and connect to terminal block as shown.

Note: To assure proper grounding, keep the star washer on the painted surface of the mounting plate, place the ground wire on top of it and tighten down both with the Keps nut.

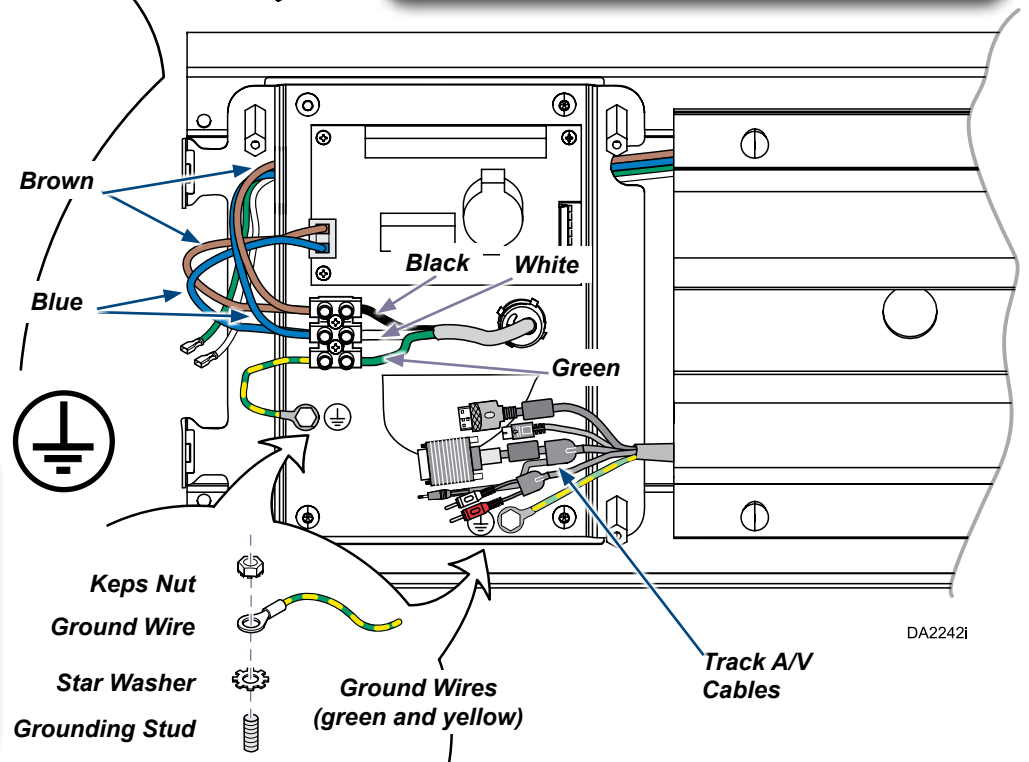

DA22421



### Equipment Alert

Disconnect power from the Track Light Monitor with the use of a wall mounted light switch may cause issues with display settings on the Personal Computer. While power is still being applied to the TLM, the PC has the ability to detect and communicate with the monitor. Communication between the PC and the monitor of the TLM can happen even if the monitor has been placed in Standby Mode using the power button on the monitor or the remote control. If a wall mounted light switch is used to cut power to the TLM, the PC may revert back to the default display settings of a single monitor. To avoid this, please do not install a wall mounted light switch to cut power to the TLM. If a wall monitor light switch must be installed for service reasons, please contain switch inside of a locked cover.

### Note

Recommendation, to properly connect multiple Track Light Monitors together on one coax cable connection, please read the following:

- Do not use a splitter to connect multiple TLM's together without an amplifier. Adding splitters decreases the signal power, plus long runs of coax cable further increases the power losses.
- Proper connection of splitters and amplifiers should occur as follows: SPLITTER → AMPLIFIER → SPLITTER → AMPLIFIER. Do not connect a TLM directly from a splitter output. Best performance is achieved when the TLM's are directly connected to the output of an amplifier.
- Use a Bidirectional Cable-TV Amplifier to split and amplify the cable signal power up so that each output is as strong as or stronger than the original signal. Amplifying the signal helps the signal propagate down a long cable and still maintain enough power at the monitor or TV to display a nice picture.
- It is recommended to use an Bidirectional CableTV Amplifier that comes with an adjustable gain control knob. Gain knob to be used to properly adjust signal for TLM.

### Examples of Bidirectional Cable -TV Amplifier Set-up

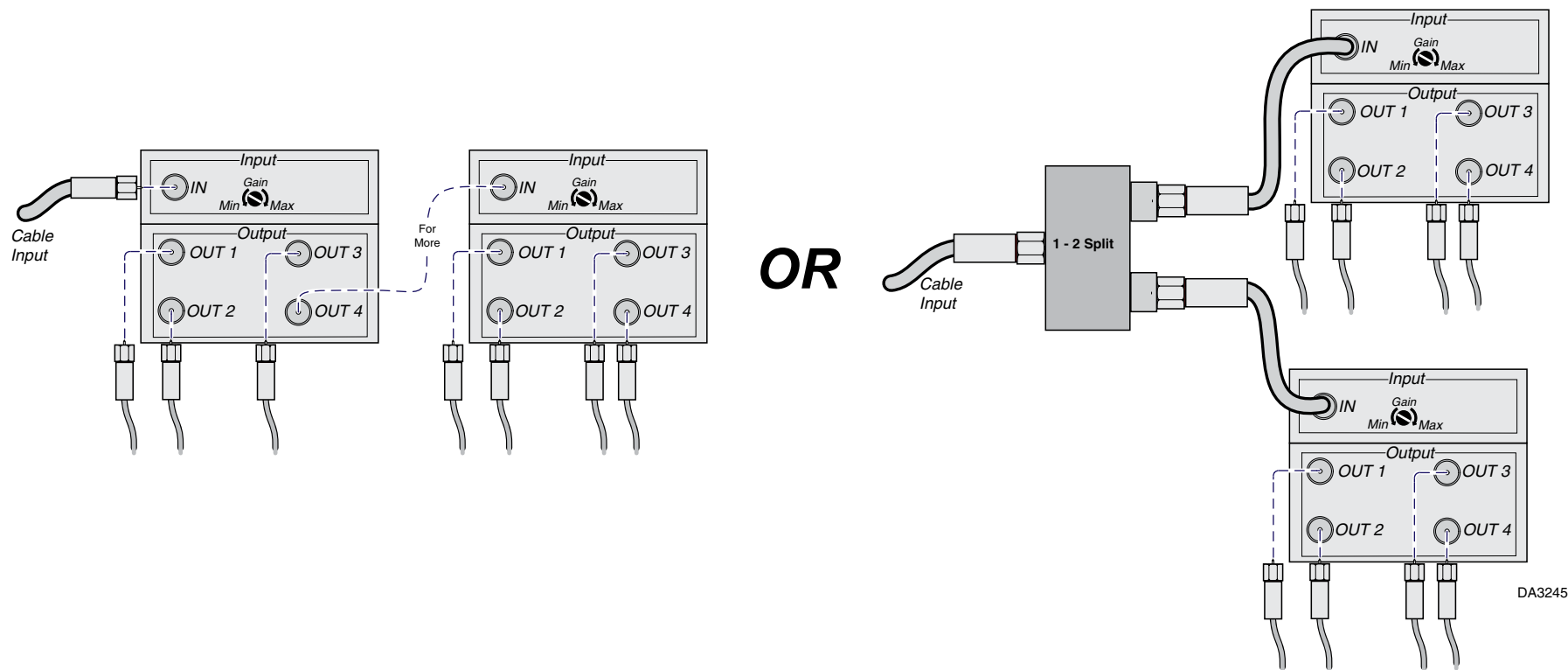

DA3245

## Monitor and Light Down Tubes

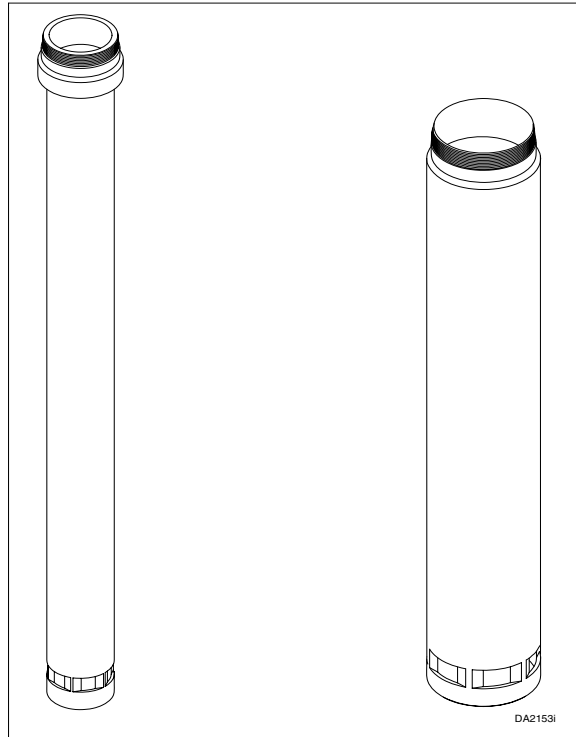

**Light Down  
Tube Weldment**

**Monitor  
Down Tube**

## Installing the Monitor and Light Down Tubes

**Step 1:** Screw the monitor down tube into the monitor trolley casting as far as it will go and secure by tightening the two lock patch set screws in the trolley casting.

**Step 2:** Screw the light down tube weldment into the light trolley casting as far as it will go and secure by tightening the two lock patch set screws in the trolley casting.

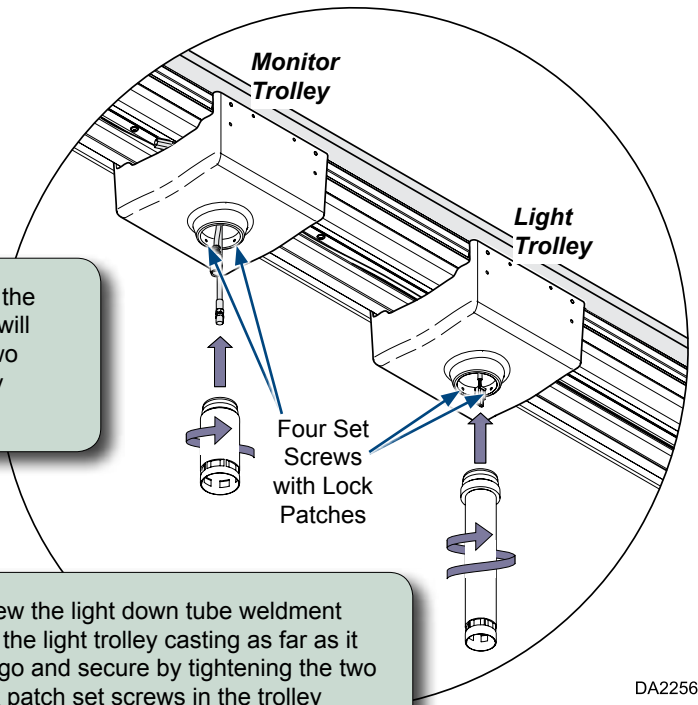

DA2256

Ceiling Height inches (cm)	Tape Color  (see Note)	Coiler Bowl Assembly 029-4871- <b>OX</b>	Monitor Suspension Tube 052-0678- <b>OX</b> -216		Light Suspension Tube 030-1845- <b>OX</b> -216	
		Dash No.	Dash No.	Tube Length	Dash No.	Tube Length
96*/98 in. (244/249 cm)	<b>Red</b>	-00	-00	5.69 in. (15 cm)	-00	11.71 in. (30 cm)
99/102 in. (251/259 cm)	<b>Orange</b>	-01	-01	8.69 in. (22 cm)	-01	15.71 in. (40 cm)
103/106 in. (262/269 cm)	<b>Yellow</b>	-02	-02	9.69 in. (25 cm)	-02	19.71 in. (50 cm)
107/110 in. (272/279 cm)	<b>Green</b>	-03	-03	10.69 in. (27 cm)	-03	23.71 in. (60 cm)
111/114 in. (282/290 cm)	<b>Blue</b>	-04	-04	14.69 in. (37 cm)	-04	27.71 in. (70 cm)
115/118 in. (292/300 cm)	<b>Violet</b>	-05	-05	18.69 in. (47 cm)	-05	31.71 in. (80 cm)
119/122 in. (302/310 cm)	<b>Gray</b>	-06	-06	22.69 in. (58 cm)	-06	35.71 in. (90 cm)
123/126 in. (312/320 cm)	<b>Brown</b>	-07	-07	26.69 in. (68 cm)	-07	39.71 in. (101 cm)
>126 in. (320 cm)	<b>Black</b>	-08	-08	30.69 in. (78 cm)	-08	43.71 in. (111 cm)

**Note:**  
The "Tape Color" Column corresponds to the correct tape color on the VGA and Coax Harnesses for a specific suspension tube. That color will be exposed directly beneath the coiler bowl assembly. If you should ever move this unit to another location with a different ceiling height, you will need different down tubes and the harness will have to be retracted or extended in the coiler bowl until the correct tape color is exposed.

\* There are no Down Tubes available for ceilings lower than 96 " in height

## Light Flex Arm Connections and Installation

### Note

Have an assistant support the Flex Arm as you make the connections necessary for installation.



### Equipment Alert

To ensure quiet operation, apply a thin coat of lubricant to the inside of the Light Down Tube and to the outer surface of the bearing shaft.

**Step 1:** Connect the light cable connector to the pivot arm. bend any excess cable as shown and push it up into the down tube.

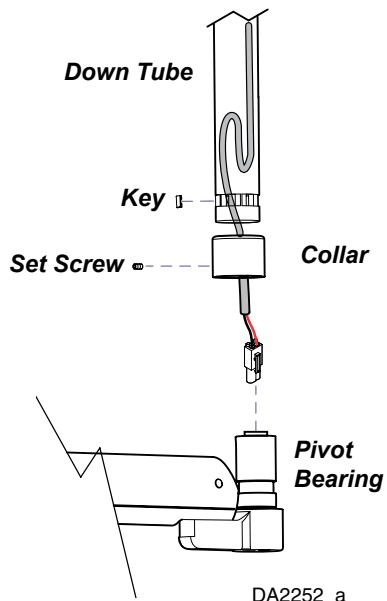

**Step 3:** Rotate flex arm as needed to align nearest two mating slots and insert the key. Lower collar over key.

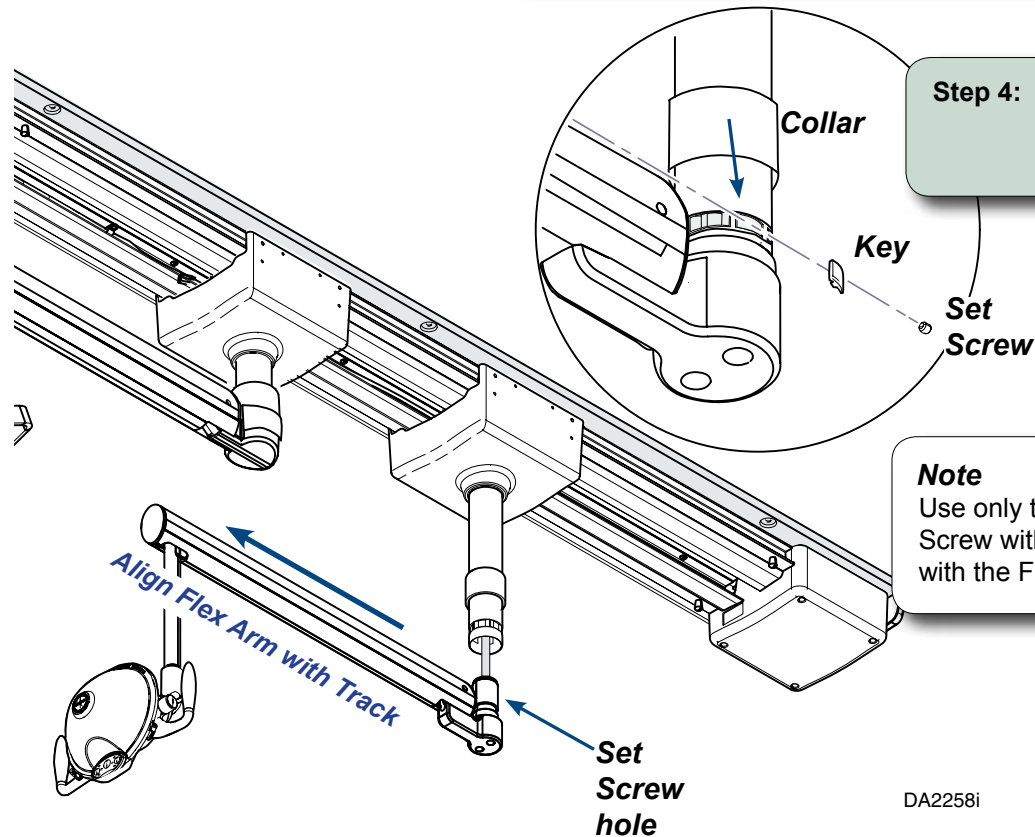

**Step 4:** Align set screw directly over key and tighten.

### Note

Use only the 10-32 x 3/16 Set Screw with lock patch supplied with the Flex Arm.

**Step 2:** Slip the flex arm into down tube. Align the flex arm with the track, light facing the head end. (Set screw hole will be 180° across from flex arm.)



## Tension Adjustments

### To adjust tension at Light pivot joint...

- A) Remove screw cover as shown.
- B) Loosen set screw.
- C) Loosen or tighten light pivot adjustment screw.
- D) Tighten set screw.

### To adjust tension at Arm / Yoke pivot joints...

- A) Remove neck cover as shown (see Note).
- B) Loosen or tighten appropriate screws to adjust tension.

Note: Some halogen models have a short neck on the lighthouse. It is not necessary to remove the neck cover on these models.

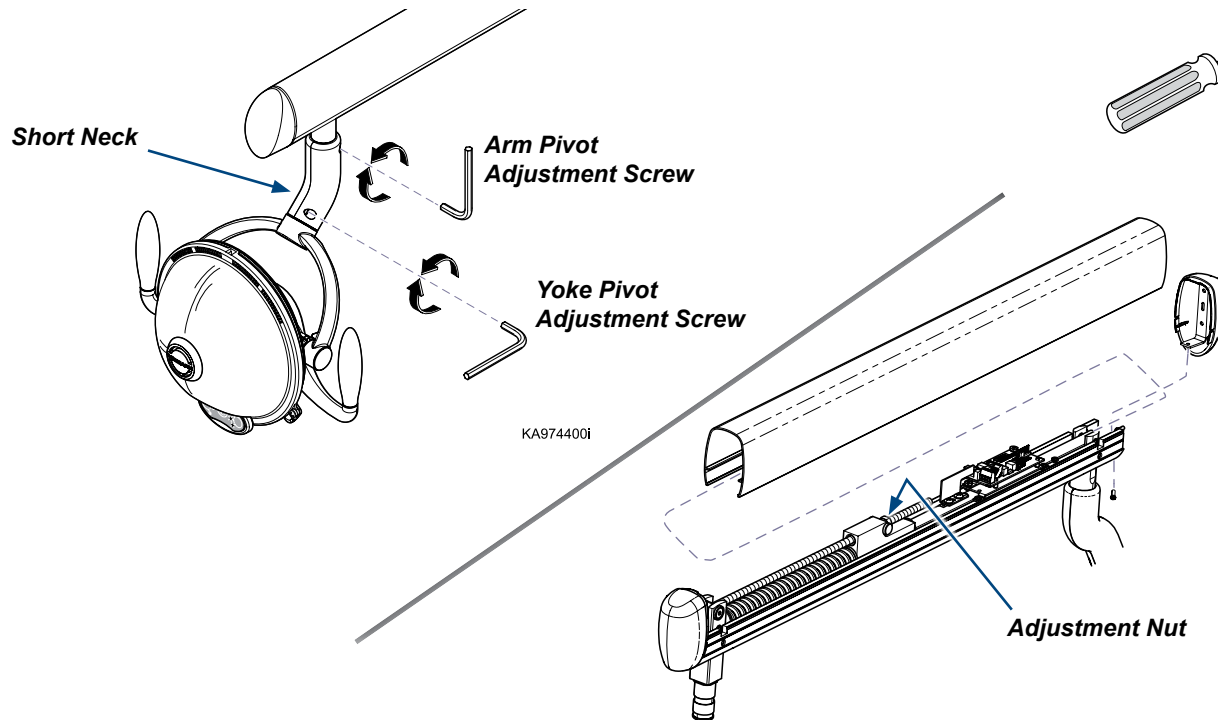
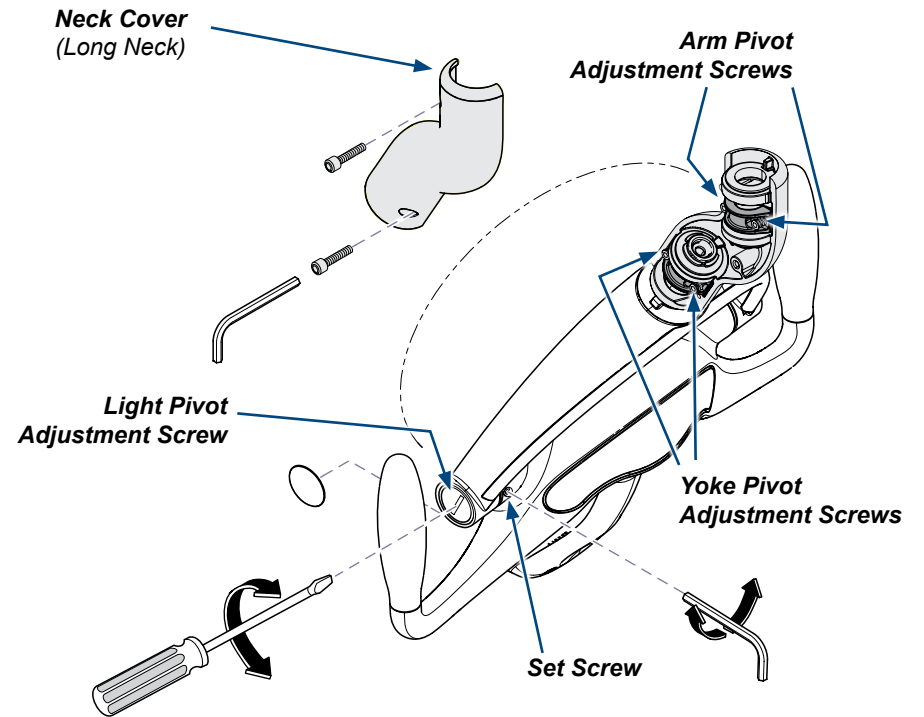

### To adjust Flex Arm tension...

- A) Remove end cap and top cover as shown.
- B) Loosen or tighten adjustment nut as desired.

DA3633i

## Monitor Flex Arm Installation

**Step 1:** Place the top half of the down tube cover (from flex arm box) and the collar temporarily onto the down tube above the key slot. Lightly tighten the set screw to hold in place.

### Note

Have an assistant support the Flex Arm as you make the connections necessary for installation.

**Step 3:** Slip the flex arm pivot bearing into the down tube.

- Align the flat on the pivot arm with the right weldment flat.
- Rotate the flex arm assembly as needed to bring the nearest two slots into alignment.
- Insert the key and lower the collar.
- Align Set screw directly over key and tighten.

### Note

Use only the 10-32 x 3/16 Set Screw with lock patch supplied with the Flex Arm.

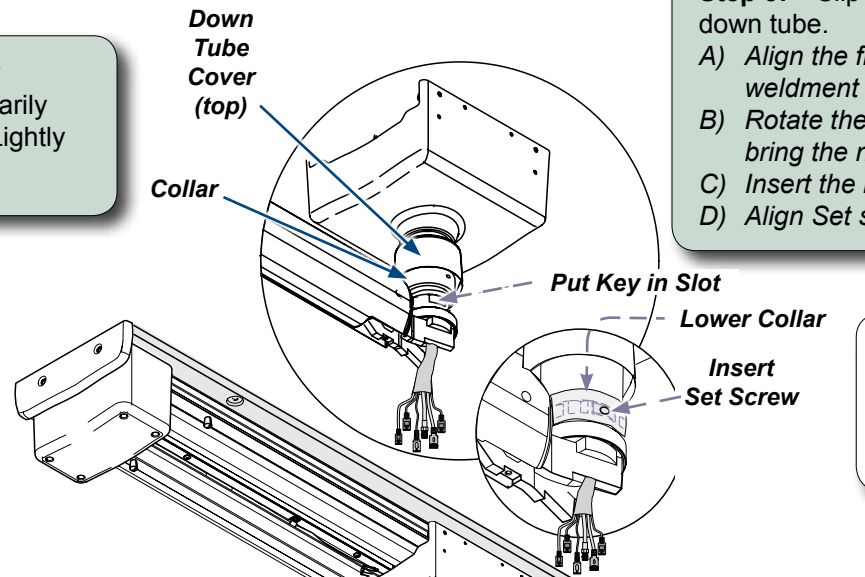

**Step 6:** Pull cable down thru the pivot bearing and route it into the flex arm channel.

**Step 2:** Pull the bottom half of the down tube cover off the flex arm (held in place with magnets).

**Step 5:** Remove two screws and the bracket from flex arm channel.

**Step 4:** Remove the screw from the end and slide the channel cover off.

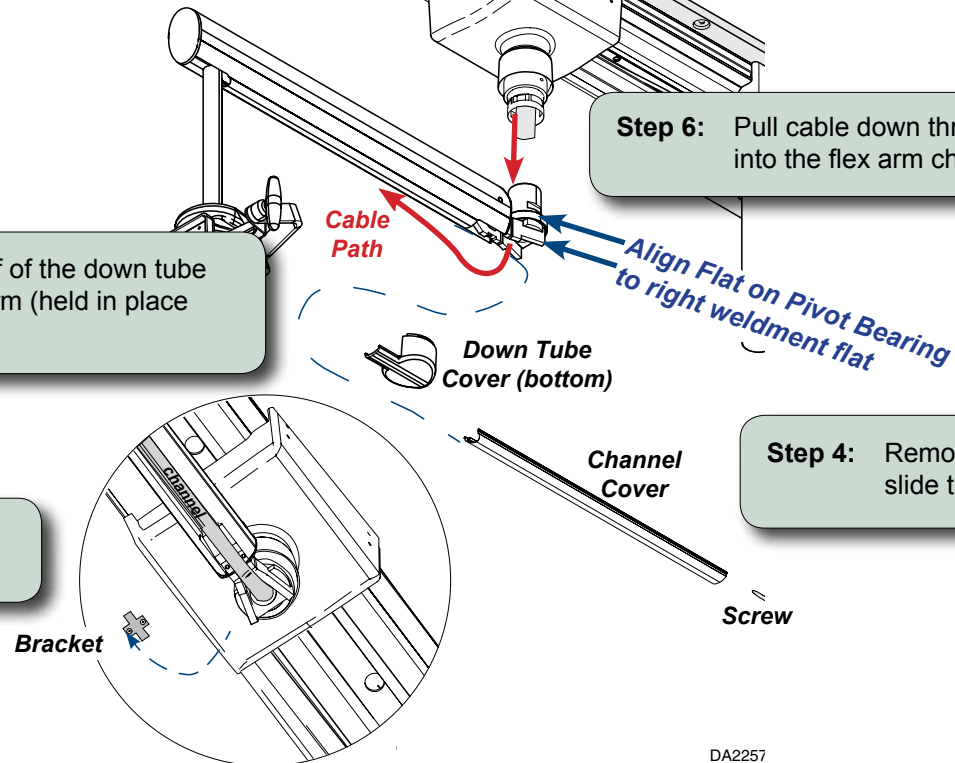

DA2257

## Flex Arm Cable Connections

**Step 1:** Route the A/V cable into the flex arm channel as shown. The cable connections are staggered for a better fit along the length of the channel.

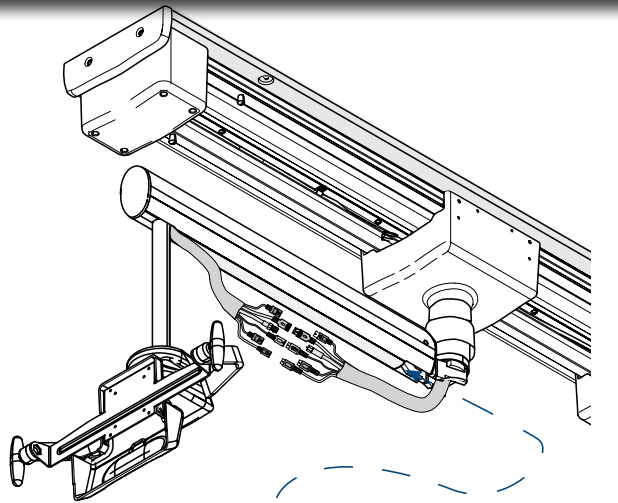

Channel Cover and Screw

Down Tube Cover (bottom)

Bracket

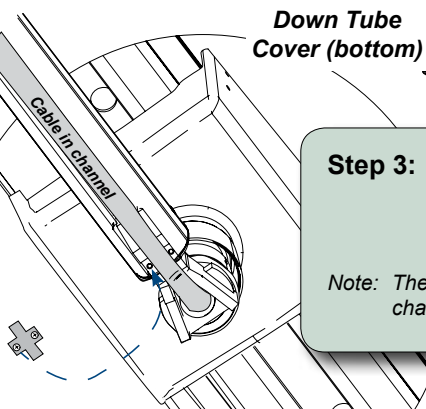

**Step 3:** Slide the channel cover into the bottom of the flex arm and secure with the screw.

*Note: The screw can be installed on either side of the channel.*

**Step 2:** Install the bracket (two screws) over the cable to hold it in place.

**Step 4:** Replace the bottom down tube cover, lower and screw the top cover onto it.

## Monitor Mounting and Tension Adjustment

**To adjust tension on monitor mount...**  
Remove screw, handle and cover. While holding mount, turn adjustment nut to increase or decrease the tension.

*Note: Remove monitor from mount before adjusting tension.*

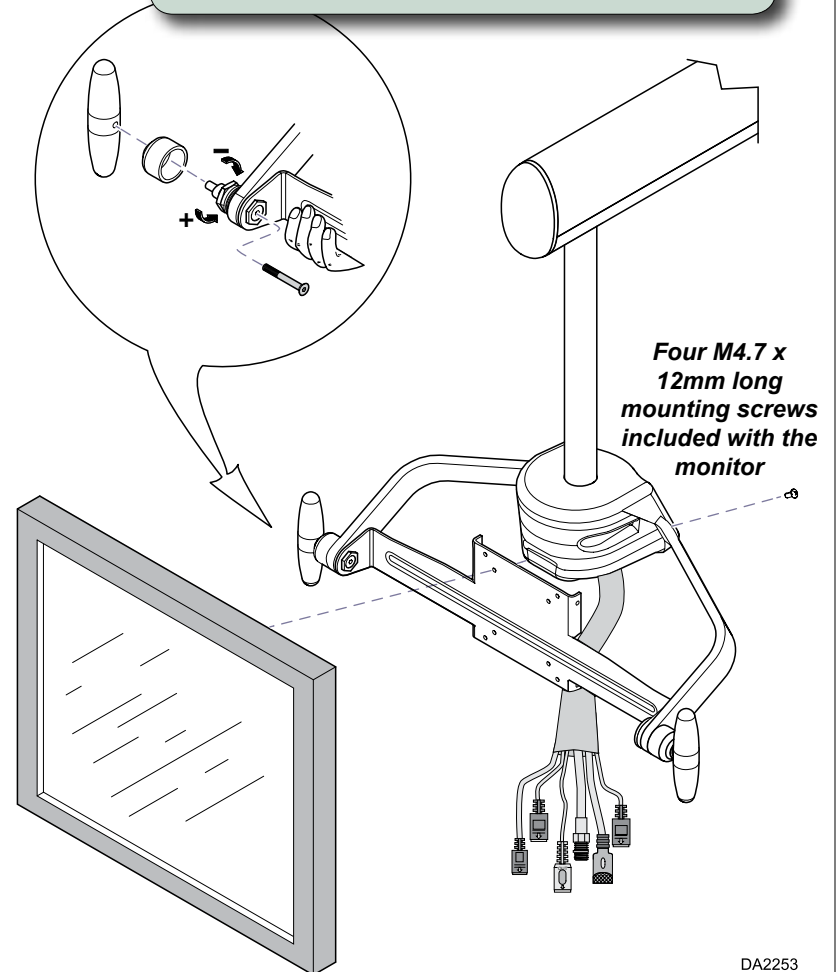

Four M4.7 x 12mm long mounting screws included with the monitor

**To mount the monitor on the hoop arm assembly...**  
Insert the four screws included with the monitor thru the hoop arm assembly mounting plate and into the back of the monitor as shown.

DA2253

## Monitor A/V Connections

**Step 1:** Plug cables into the back of the Monitor:

*Note:*  
For a clean appearance, attach all connectors to the monitor even though some may not be attached to a source.

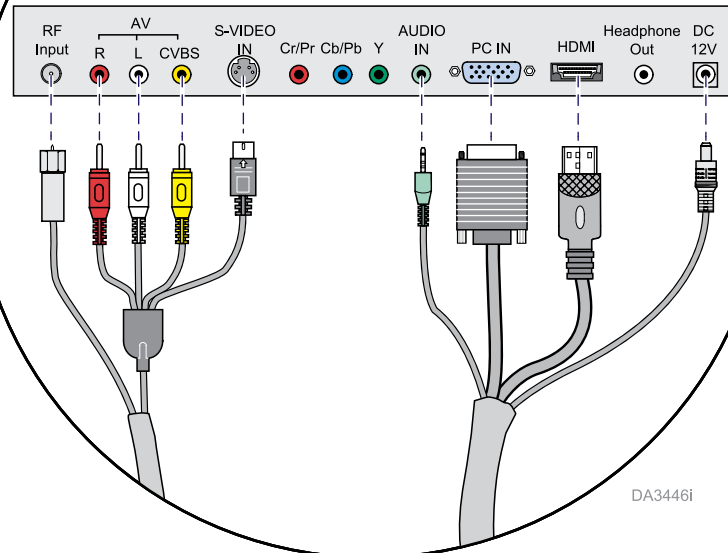
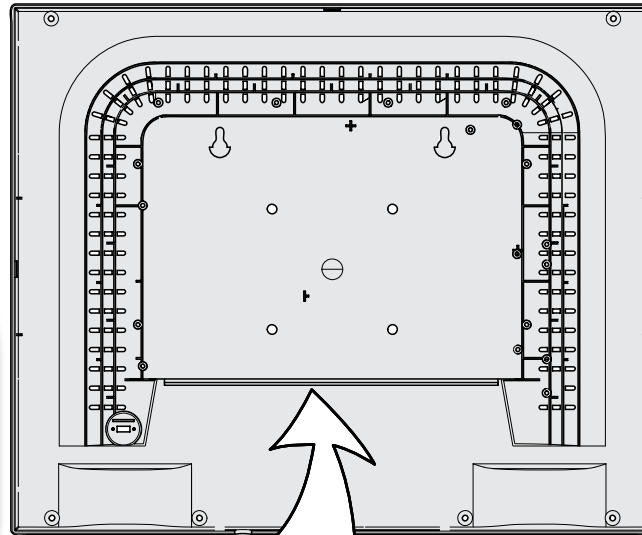

DA3446i

**Step 2:** Remove and reuse two screws from the monitor back to attach bracket onto monitor back.

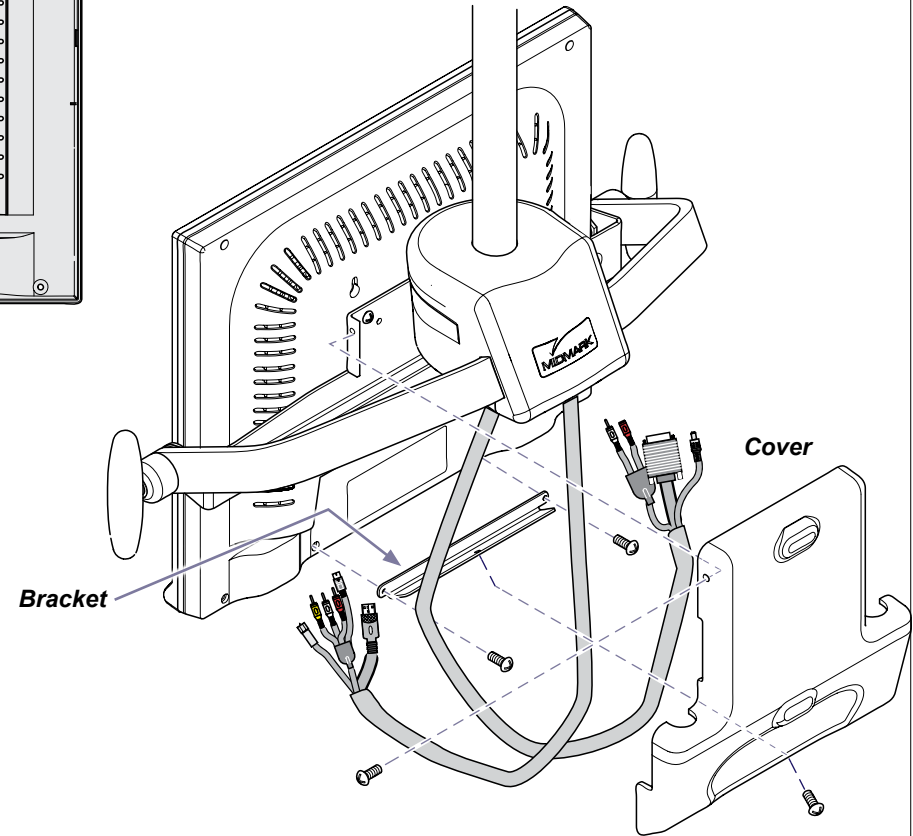

**Step 3:** Divide cables around the mounting plate, looping at the bottom while making connections to the monitor. Install cover (3 screws) securing the cables.

## Side Rail Installation

### Note

The side rails are notched at each end to prevent them from hitting the mounting brackets on the track.

**Step 1:** Remove the 2 screws and the end cap from the front end of the track.

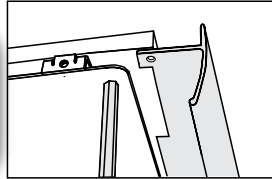

**Step 2:** Use a rubber mallet to lightly tap the side rails into the space between the track extrusion and the backer board.

End Cap

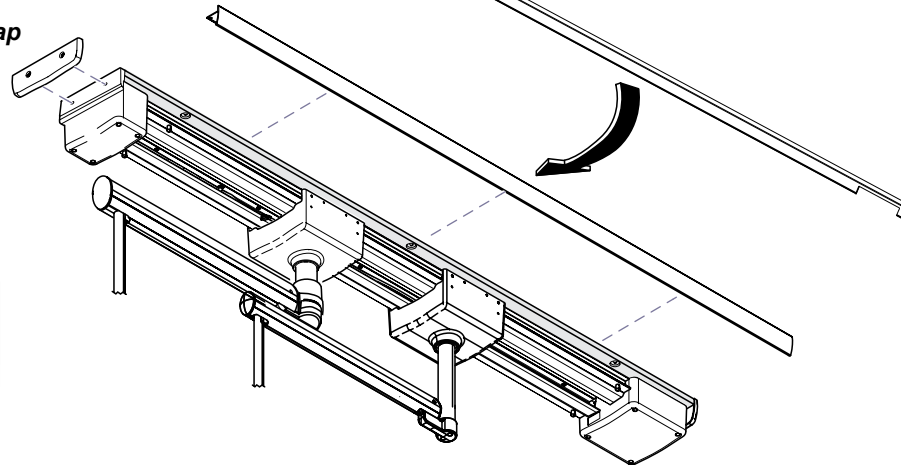

**Step 3:** Secure the end cap on the front end of the track with 2 screws.

DA2259

# Range of Motion



## Equipment Alert

The light and monitor flex arms can come into contact with one another.

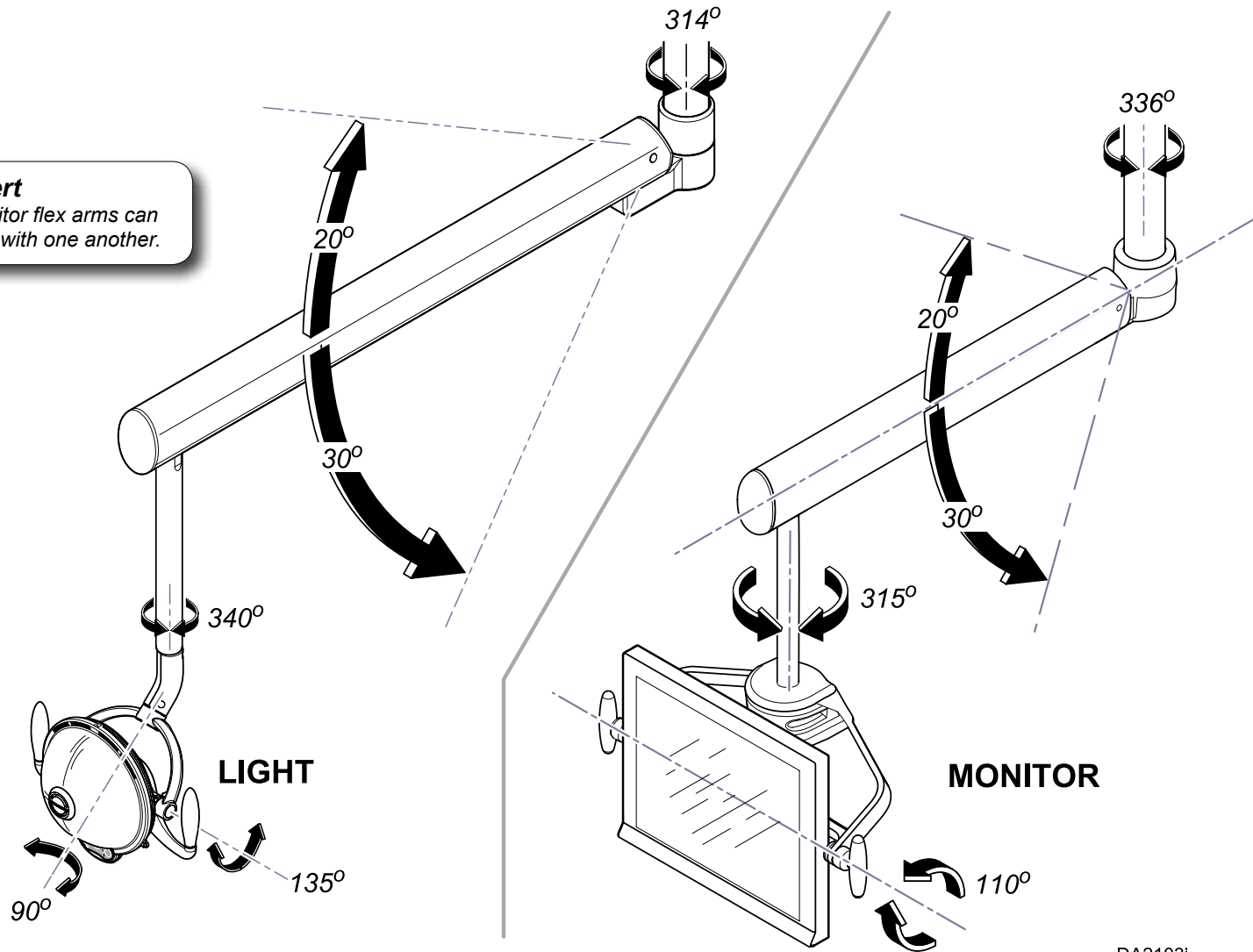

DA2103i

# Monitor and Light Flex Arm Tension Adjustments

## Monitor Flex Arm Tension Adjustments

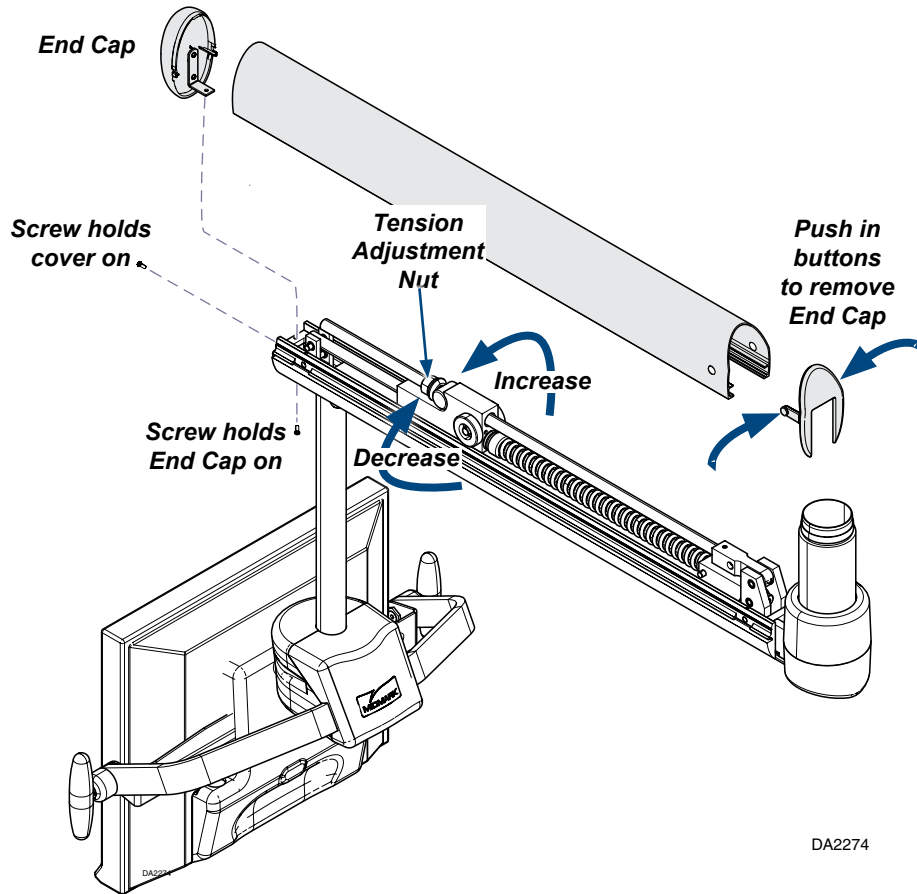

## Light Flex Arm Tension Adjustments

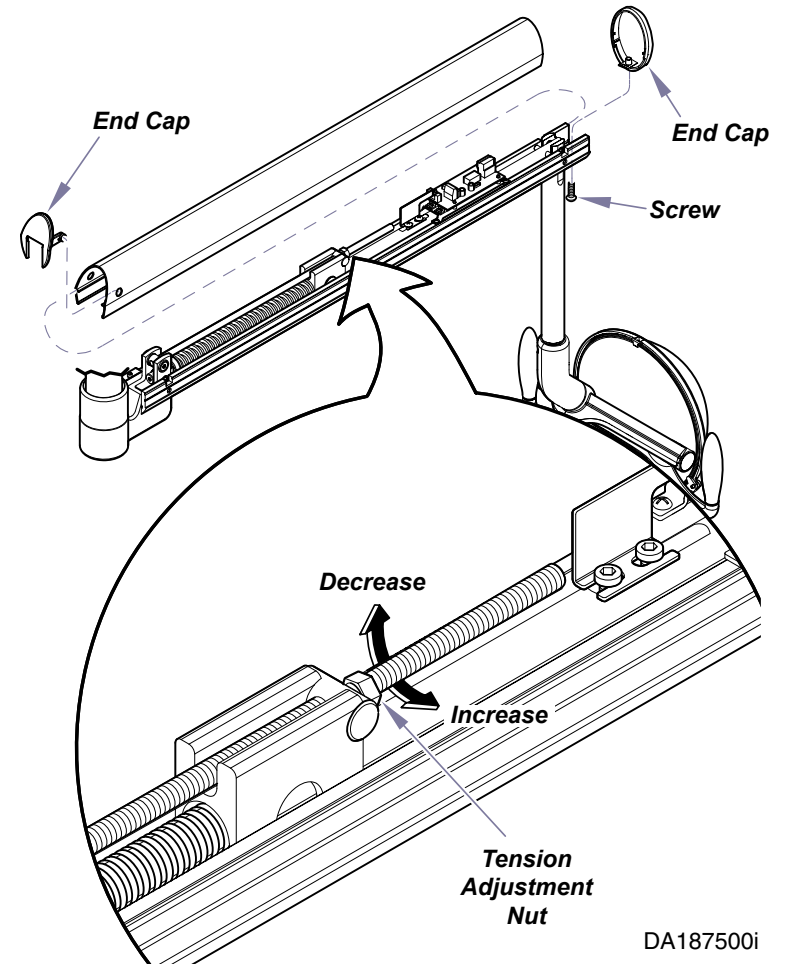

### Monitor Specification:

Refer to Manufacturer's User Manual for monitor specifications.

### Note

Refer to: [www.exorvision.com](http://www.exorvision.com) for additional information on service and warranty for the monitor and remote control.

The Model and Serial Number will be required.