USER MANUAL

**MODEL NUMBER:
GI-30N-AM
GI-30NK-AM
GI-30NV-AM
AND RELATED UNITS**

**30 Gallon Air Operated Portable Gel Unit
with Agitator**

English (Original Instructions)

READ ALL INSTRUCTIONS BEFORE OPERATING EQUIPMENT



WARNING



Read this manual completely and understand the machine before operating or servicing it.

- Read all instructions before installing or operating unit.
- Always wear appropriate personal protective equipment (PPE) when operating or servicing unit.
- Always follow all chemical safety precautions and handling instructions provided by the chemical manufacturer and Material Safety Data Sheet (MSDS).
- If this unit is modified or serviced with parts not listed in this manual the unit may not operate correctly.
- Never point the discharge wand at yourself, another person, or any object you do not want covered in chemical.
- Always depressurize unit after use (as described in the After Use Instructions). Always store unit depressurized, with the discharge ball valve in the closed position.
- Do not exceed an incoming air pressure of 100 psi (7 bar).
- Do not exceed a fluid temperature of 100°F (37°C).
- Always flush the unit with fresh water for 5 minutes when switching from an alkaline to an acid or an acid to an alkaline.
- Only use clean and dry air. Air must be filtered and free of moisture or pump life will be diminished. If needed, install a water separator (WS-20CFM) before the unit.
- Do not use an air lubricator before the unit.
- Never use unit with hydrocarbons or flammable products.

PROTECT THE ENVIRONMENT

Please dispose of packaging materials, old machine components, and hazardous fluids in an environmentally safe way according to local waste disposal regulations.



Always remember to recycle.

*Specifications and parts are subject to change without notice.

READ ALL INSTRUCTIONS BEFORE OPERATING EQUIPMENT

OPTIONS		
	Pump Seal Material	
GI-30N	Santoprene (<i>standard</i>)	-AM
	Viton (V)	
	Kalrez (K)	

Add bold option codes to item number as shown. For standard options, no option code is needed.

Examples:

- GI-30N-AM (standard unit with Santoprene pump seals)
- GI-30NV-AM (unit with Viton pump seals)

REQUIREMENTS	
Compressed air requirements	40-80 psi (3-5 bar) with 15-18 cfm (425-510 l/min)
Liquid temperature range	40-100°F (4.4-37°C)
Chemical compatibility	Chemical products used with this equipment must be formulated for this type of application and compatible with unit materials and pump seals. For more information on chemical compatibility, consult the manufacturer or MSDS for your product or contact our customer service department.

SPECIFICATIONS	
Power type	Compressed air
Chemical pickup type	Draws from pre-mixed solution
Number of products unit can draw from	One product
Suction line length/diameter	3/8 in. (9.5 mm) inside diameter
Capacity	30 gallons (132.15 liters)
Discharge hose diameter/length	30 ft. (9 m) hose, with 1/2 in. (12.7 mm) inside diameter
Discharge wand/tip type	24 in. (60.9 cm) stainless steel wand with fan tip and ball valve (Fan tips included: ST2520SS, ST1510, ST2508, and ST4008SS)
Output distance	6-10 ft. (1.8-3 m) (Varies based on viscosity of product)
Output volume	0.5-1 gal/min (1.89-3.79 l/min) (Varies based on viscosity of product and fan tip size)
Flow rate*	2 gal/min (7.6 l/min) (Varies based on fan tip used)
Pump seals	Santoprene, Viton, or Kalrez
Wheel type	Two 10 inch non-marking wheels, two 5 inch casters with lock

*Dilution rates and flow rates given are based on chemical with viscosity of water and factory air pressure settings.

READ ALL INSTRUCTIONS BEFORE OPERATING EQUIPMENT

Operation Instructions

1. Follow all instructions from chemical manufacturer. Fill the tank with the desired gel product.
2. With the discharge valve (HV60) in the closed position, plug an air line into the air fitting (AP25).
3. Ensure agitator is submerged in gel product. Activate the air motor by opening the ball valve (BVB14) on the back plate. It is not recommended to run air motor agitator while applying product.
4. Adjust the needle valve (NV14Y) to achieve the desired speed of the air motor agitator following the steps below:
 - a. Close needle valve completely in clockwise direction.
 - b. Open needle valve in counter-clockwise direction to increase speed of motor. Adjust needle valve until desired speed is achieved.
 - c. Note: Speed of the agitator should be adjusted based on the volume and viscosity of the gel product used.
5. Discontinue use of air motor agitator if solution level is below the agitator propeller. Close the ball valve (BVB14) on the back of the plate to stop air motor.
6. Slowly open the discharge valve (HV60) completely.

After Use Instructions:

1. Flush the unit with fresh water for 5 minutes.
2. Disconnect the air line from the air fitting (AP25) and relieve any remaining pressure in the system by opening the discharge valve (HV60).
3. Close the discharge valve (HV60) after all pressure has been relieved from the system.

Maintenance Instructions:

Note: Disconnect coupler (FAC114) from air lines on the back of the unit before opening the back plate and servicing the unit.

To keep your portable unit operating properly, periodically perform the following maintenance procedures:

- Check the air pump (P56/P56K/P56V) for wear and leaks.
- Inspect hoses for leaks or excessive wear. Make sure all hose clamps are in good condition and properly secured.
- Replace filter (AFR25) in regulator (R25) as needed.
- Check the suction tube and screen for debris and clean as needed.
- Drain compressor tank on a regular basis to ensure proper operation of pump.

Troubleshooting Instructions:

- Check to ensure that the discharge hose is uncoiled properly, and that there are no kinks that could obstruct fluid flow.
- Check to ensure that the agitator is below the solution level. Agitator will not mix properly if solution level is too low.
- Check the air regulator bowl (ABR25) and air filter (AFR25) for debris such as water, oil, or rust particles. Clean by unthreading the air regulator bowl (ABR25) from the air regulator (R25).
- If needle valve (NV14Y) valve is open too far, the pump (P56/P56K/P56V) will cycle improperly due to lack of air pressure. If this occurs, reset needle valve as described in Operation Instruction #4.
- If air passes through the pump (P56/P56K/P56V) without cycling, the pump needs to be replaced.
- Check for proper air pressure on the air gauge (AG100). The air regulator (R25) is factory set at 50 psi (3.4 bar). Operating range is 40 to 80 PSI (3 to 5 bar).
- If the unit operates at a reduced pressure:
 - Check the air compressor supplying the unit. If the pressure is less than 40 psi, turn the unit off until the compressor can catch up.
 - If the air supply is 50 psi (3.4 bar) or above, check the air gauge (AG100), which should read near 50 psi (3.4 bar). If the air gauge reads more or less than 50 psi (3.4 bar), adjust the pressure by turning the knob on the top of the air regulator (R25).

READ ALL INSTRUCTIONS BEFORE OPERATING EQUIPMENT

TANK ASSEMBLY ITEM NUMBER: TANK-30N-A

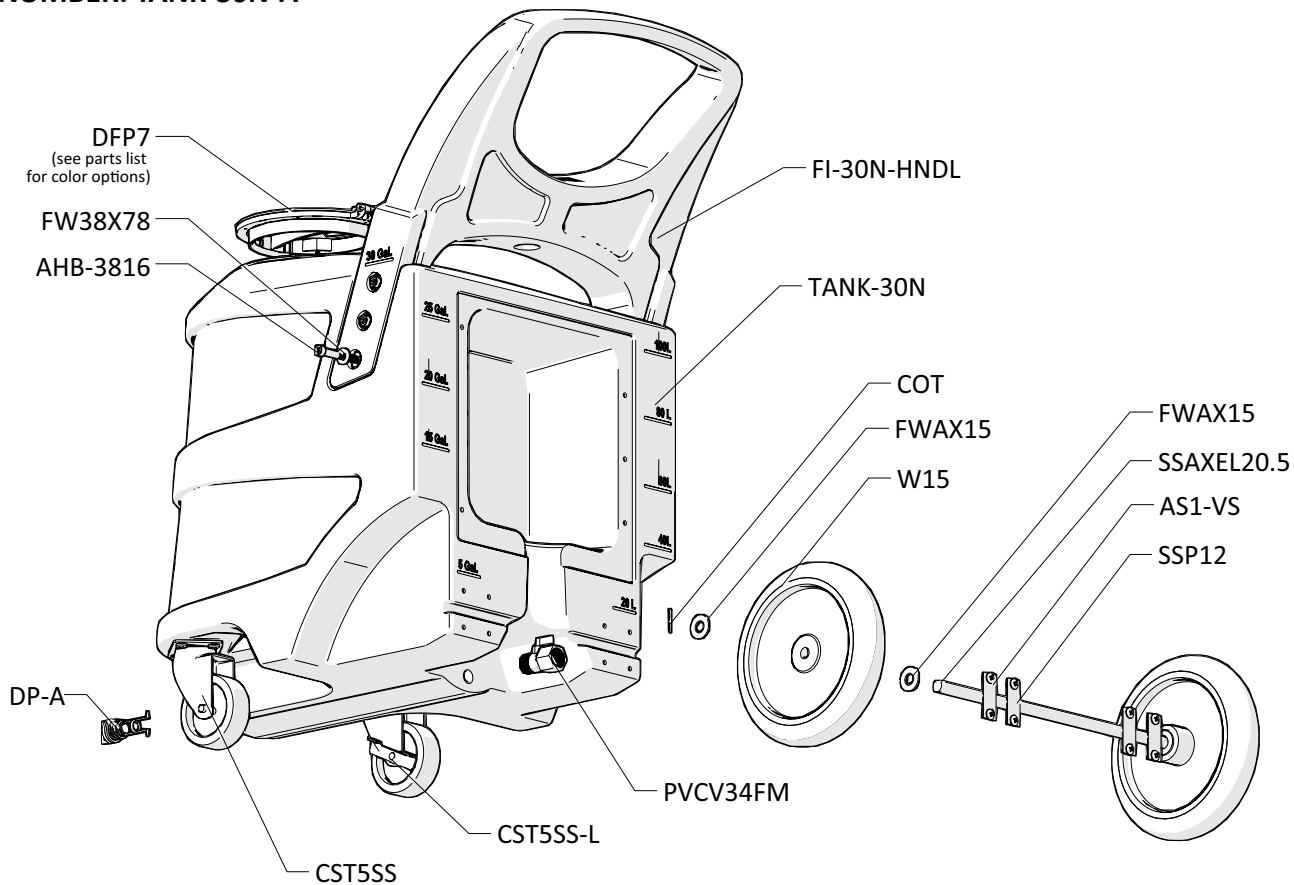

DISCHARGE WAND ITEM NUMBER: SSGWA12

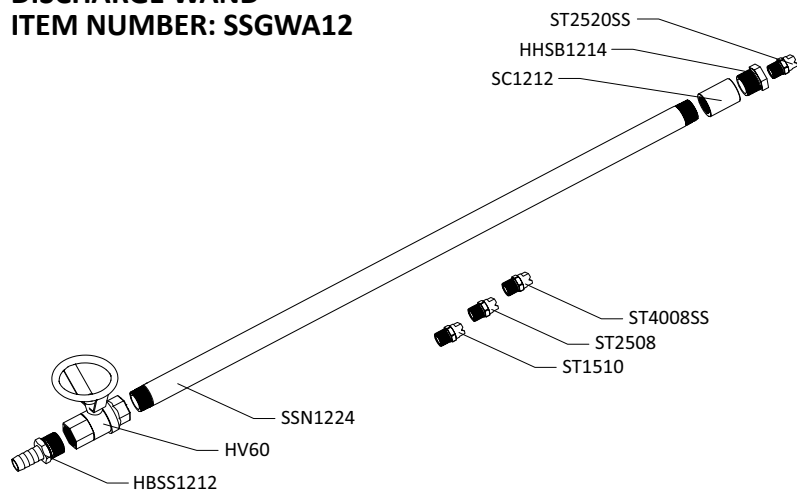

AIR MOTOR AND AGITATOR

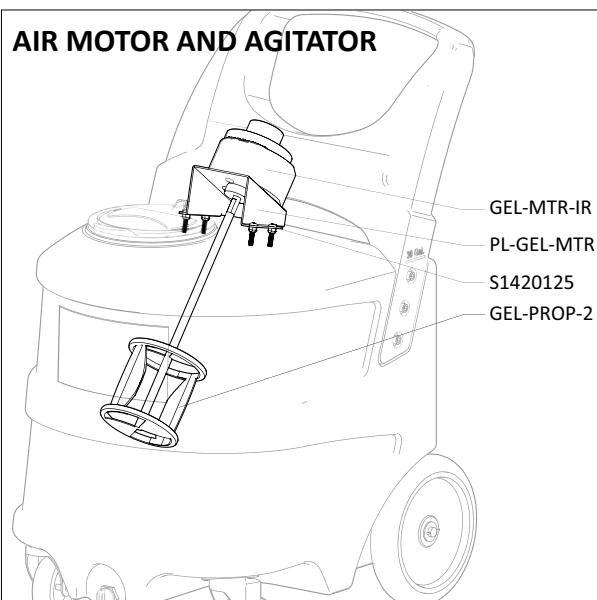

READ ALL INSTRUCTIONS BEFORE OPERATING EQUIPMENT

PLATE ASSEMBLY Inside View

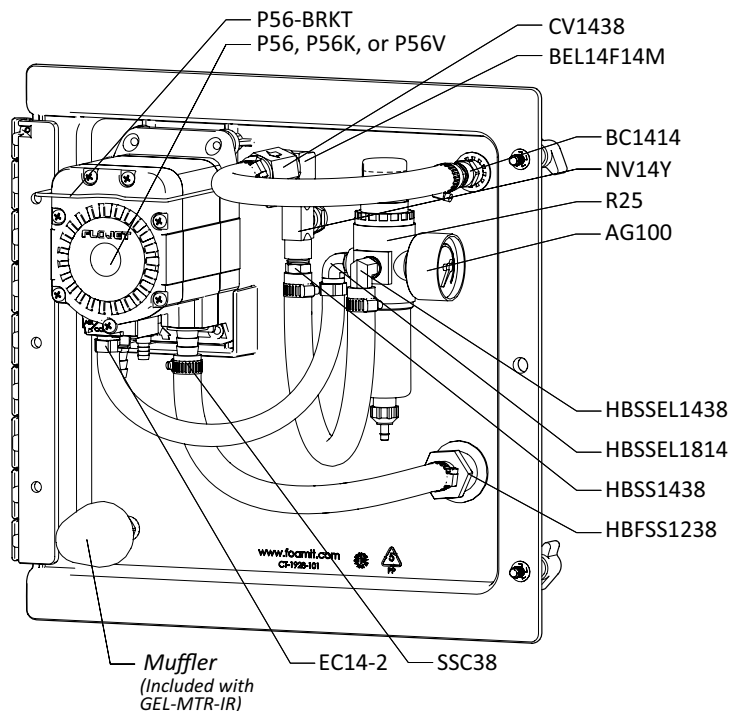
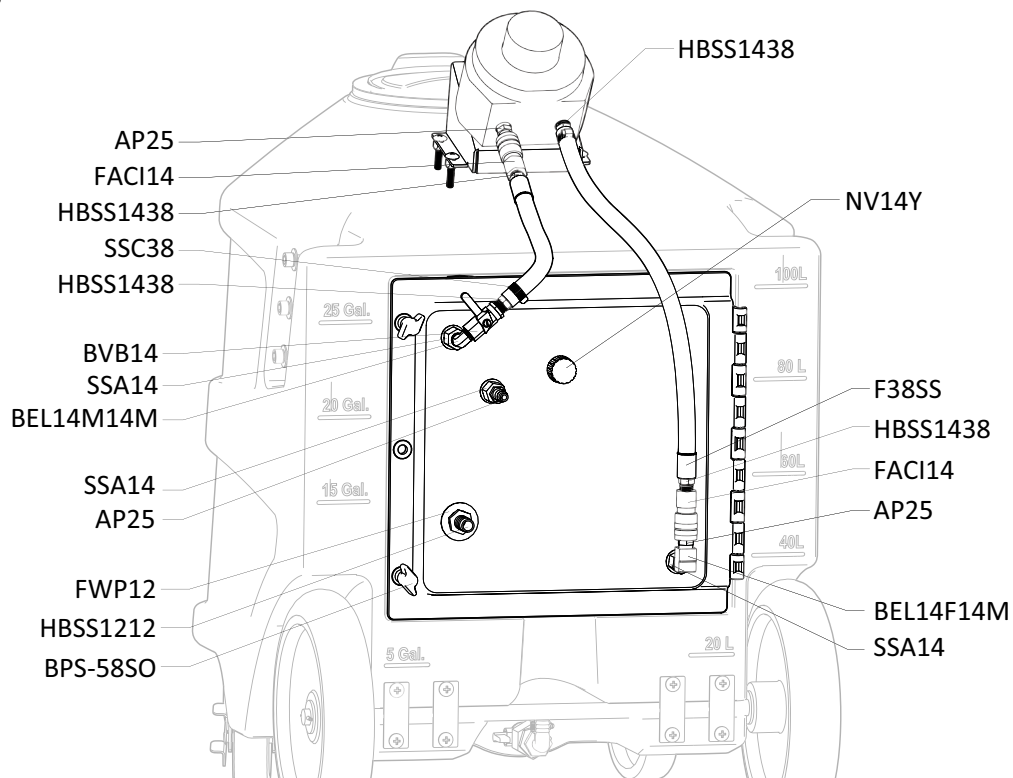
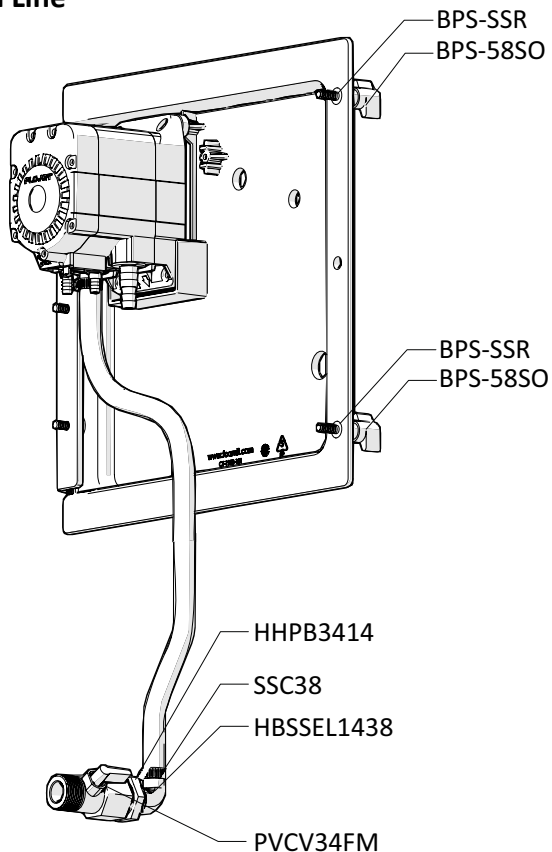

PLATE ASSEMBLY Outside View



READ ALL INSTRUCTIONS BEFORE OPERATING EQUIPMENT

PLATE ASSEMBLY Suction Line



DISCHARGE HOSE ASSEMBLY ITEM NUMBER: H12-30

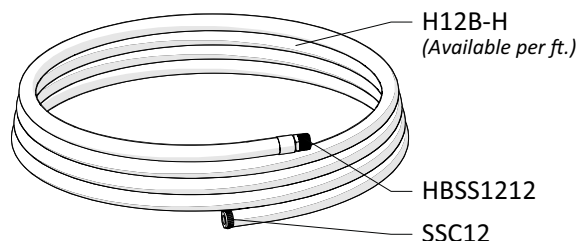

ANTI-KINK SPRING WITH RETAINING PIN ITEM NUMBER: AKSS12

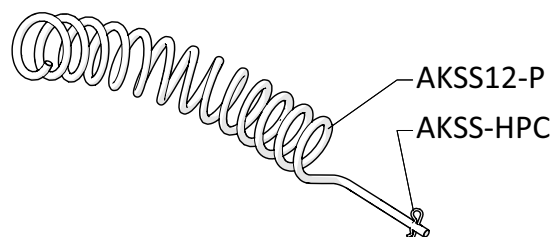

OPTIONAL COMPONENTS

WATER SEPARATOR ITEM NUMBER: WS-20CFM

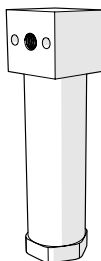

30 ft (9 m) AIR HOSE ASSEMBLY ITEM NUMBER: AH30

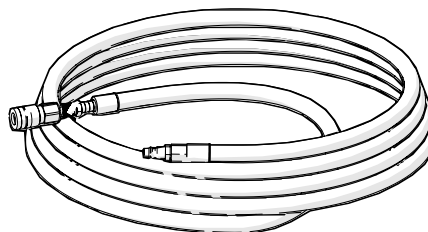

READ ALL INSTRUCTIONS BEFORE OPERATING EQUIPMENT

ITEM NUMBER	DESCRIPTION
AG100	1.5 INCH DRY MODEL 20 DUAL SCALE GAUGE
AHB-3816	ALLEN HEAD BOLT 3/8 -16
AKSS12	SS ANTI-KINK SPRING FOR 1.2 INCH HOSE WITH PIN
AKSS12-P	SS ANTI-KINK SPRING FOR 1.2 INCH HOSE
AKSS12-HPC	ANTI-KINK STAINLESS STEEL HITCH PIN CLIP
AP25	PLUG 1/4 NPTM AIR FITTING - BRASS
AS1-VS	1/4-20 X 1/2 PHIL TRUSS MACH SCREW 19-8 W/516 ORANGE VIBRASEAL PATCH
AW516	5/16 LONG ARM HEX KEY HARD #519011
B8XS8	8-15 X 5/8 inch PHIL FLAT TY-A 316 S.S.
BC1414	BRASS PIPE COUPLING 1/4in
BEL14F14M	BRASS ELBOW 1/4in FPT X 1/4in MPT
BEL14M14M	BRASS ELBOW 1/4in MPT X 1/4in MPT
BPS-58SO	Back Panel Screw - 5/8 inch with Stand Off
BPS-SSR	1/4 INCH PUSHNUT BOLT RETAINER STAINLESS STEEL
BVB14	AIR INLET VALVE - VA BRS 025-4F4F-BT, NICKEL
COT	1/8 X 1 COTTER PIN 18-8 S/S
CST5SS	5in S.S. SWIVEL CASTER WITH 4 IN WHEEL
CST5SS-L	5in S.S. SWIVEL CASTER WITH 4 IN WHEEL AND LOCK
CV1438	PVC CHECK VALVE 1/4 MPT X 3/8 BARB - SS SPRING
DFP7	7 INCH HINGED CAP ASSEMBLY - INCLUDES BLACK CAP, LID FLANGE AND HINGE PIN
DFP7-C	7 INCH FILL CAP POLYPRO BLACK
DFP7-F	7 INCH TANK LID FLANGE POLYPRO
DFP7-PIN	HINGE PIN FOR DFP7-C & DFP7-C
DFP7-C-BL	7 INCH FILL CAP POLYPRO BLUE PANTONE
DFP7-C-GR	7 INCH FILL CAP POLYPRO GREEN PANTONE
DFP7-C-RD	7 INCH FILL CAP POLYPRO RED PANTONE
DFP7-C-YL	7 INCH FILL CAP POLYPRO YELLOW PANTONE
DP-A	DRAIN PLUG ASSEMBLY FOR TANK-10N TANK-20N
DP	FRONT DRAIN PLUG FOR PORTABLE UNIT POLYPRO
DP-G	FKM SQUARE CUT DRAIN PLUG GASKET
EC12	OETIKER CLAMP 21.0-706R
EC14-2	OETIKER CLAMP 13.8
F12SS	STAINLESS .875 ID FERRULE FOR 1/2 INCH HOSE
F38SS	STAINLESS 3/8 INCH FERRULE
FAC114	FEMALE COUPLER - 1/4in NPTF
FI-30N-HNDL	TANK-30N HANDLE
FW38X78	FLAT WASHER 3/8X7/8 X 13/32X.050
FWAX15	FLAT AXLE WASHER
FWP12	7/8 ID X 1.5 OD X 0.05 THK SSFW
FWP14	C-816 1/2in SS WASHER
GEL-MTR-IR	GEL MOTOR-AIR OPERATED-LUBE FREE-INCLUDES INLET FITTINGS
GEL-PROP-2	GEL IT PROP AND SHAFT
H12B-H	1/2 inch BLUE HOSE - GOODYEAR HORIZON
H14B-H	1/4 INCH BLUE HOSE- GOODYEAR HORIZON
H38B-H	3/8 inch BLUE HOSE - GOODYEAR HORIZON

HBFS1238	HOSE BARB 3/8 X FEMALE PIPE THREAD 1/2 IN SS
HBSS1212	STAINLESS HOSE BARB 1/2 X 1/2
HBSS1438	STAINLESS HOSE BARB 1/4 MPT X 3/8 BARB
HBSSEL1438	STAINLESS HOSE BARB ELBOW 1/4 INCH NPT X 3/8 HOSE BARB
HBSSEL1814	304 STAINLESS ELBOW 1/8 IN NPT X 1/4 IN HOSE BARB
HHPB3414	HEX HEAD POLY REDUCER BUSHING 3/4 X 1/4
HHSB1214	HEX HEAD S.S. REDUCER BUSHING 1/2 X 1/4
HV60	1/2in STAINLESS BALL VALVE - w/ WELDED NUT
LN14	1/4-20 NE NYL INS LOCKNUT 18-8 PLN
NV14Y	FLOW CONTROL VALVE - INCLUDES BLACK KNOB
P56	5700 PUMP WITH SANTOPRENE SEALS - INCLUDES HOSE BARBS, AIR FITTING, AND AIR PORT
P56K	5700 PUMP WITH KALREZ SEALS - INCLUDES HOSE BARBS, AIR FITTING, AND AIR PORT
P56V	5700 PUMP WITH VITON SEALS - INCLUDES HOSE BARBS, AIR FITTING, AND AIR PORT
HB14P	1/4in BRASS HB AIR FITTING /G57/P56
HB5638	HOSE BARB FOR P56 PUMP
HB5638K	HOSE BARB FOR P56K PUMP
HB5638V	HOSE BARB FOR P56V PUMP
P56-BRKT	PUMP BRACKET- STAINLESS STEEL
P56-BRKT-SCREW	HI LO SCREW FOR RETAINING P56-BRKT
PL-GEL-MTR	MOUNTING PLATE FOR FOR GEL-IT30N MOTOR
PLPF	PORTABLE FOAMER BACK PLATE W/ HINGE AND HOLES
PLPF-PIN	302 STAINLESS PORTABLE PLATE HINGE PIN
PVCV34FM	PVC VALVE 3/4in FPT X 3/4in MPT
R25	AIR REGULATOR - SILVER COLOR - 1/4ft TWO PORT 1/8ft TWO PORT - INCLUDES FILTER AND BOWL
AFR25	AIR FILTER for R25
ABR25	METAL AIR BOWL for R25
S1420125	1/4 20 Pan Head Screw 1 and 1/4 inch Stainless
S142058-VS	1/4-20 X 5/8 PHIL TRUSS MACHINE SCREW 18-8 W/#516 VIBRASEAL ORANGE PATCH
S5161812	5/16-18 x 1/2 Phil Pan 18-8
SC1212	S.S. COUPLER 1/2in BY 1/2in
SSA14	SS304 MALE/FEMALE ADAPTOR 1/4 NPT X 1/4 NPT
SSAXLE20.5	STAINLESS STEEL AXLE 20.5 INCHES LONG BY 5/8 INCH IN
SSC38	WORM GEAR CLAMP, S/S (.25-.63)
SSN1224	1/2in X 24in S40 304 STAINLESS STEEL NIPPLE - TBE
SSP12	STAINLESS STEEL AXLE PLATE - 2.5 inch X 1 inch - 2 HOLE
ST1510	VEEJET NOZZLE, BRASS 1510
ST2508	VEEJET NOZZLE, BRASS 2508
ST2520SS	VEEJET NOZZLE, S.S. 2520
ST4008SS	VEEJET NOZZLE, S.S. 4008
TANK-30N	ROTO MOLDED 30 GALLON UNIT W/ HANDLE
TW916	1/2 INT TOOTH L/W 410SS
W15	NONMARKING WHEEL FOR PORTABLE UNITS
WS-20CFM	TSUNAMI WATER SEPARATOR 20 CFM