

## Advantages & Features

1. Fashion hand free design, large keyboard;
2. Large LCD display current time, temperature, and alarm info;
3. GSM/SMS/GPRS/3G Transmission, no distance limitation;
4. Bedtime monitoring, if not get up in time can generate alarm;
5. Away/back home time monitoring;
6. Daily action monitoring;
7. 32 wireless zones support variety wireless detectors: fall detector, CO, smoke, water and Gas detectors, etc;
8. Equips 4 quick dial numbers;
9. Alarm clocks for reminding elderly to take medicine or other activities.
10. Backup rechargeable battery.
11. Wireless transmit the Blood Pressure Meter out to server or apps.
12. Setting by Android APP (Search Senior Helper T4 on Google Play store) or SMS commands remotely.
13. Ademco Contact ID protocol over GPRS data supported.

## Specifications

GSM Frequency	Quad-band 850/900/1800/1900 MHz
Wireless Zones	32
Radio Frequency	433.92MHz for sensors
Rated Power Supply	9~24V DC/1A
Power Consumption	12V input Max. 270mA, Standby 30mA
SIM Card	Support 3V SIM Card
Antenna	50 Ω SMA Antenna interface
Temperature Range	-20~+60 ° C
Humidity Range	Relative humidity 90% (condensing free)
Backup Battery	3.7V/900mAH Li-ion rechargeable

# GSM/3G Elderly Health Care Alarm System

# T4



## Product View



- 1 Stay Home Arm
- 2 Volume +
- 3 Disarm
- 4 Volume -
- 5 Away Arm
- 6 Answer Call
- 7 BP measure 1  
Press to start,  
repress to cancel
- 8 BP measure 2  
Press to start,  
repress to cancel
- 9 End Call
- 10 SOS button  
Press and hold 3  
seconds for alarm

## Bottom View

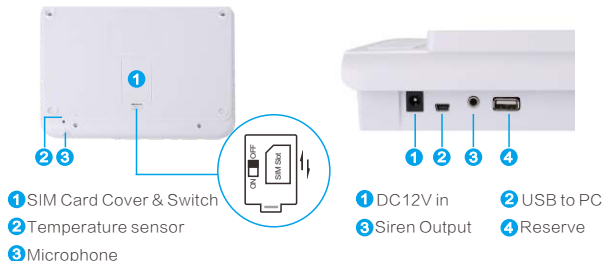

- 1 SIM Card Cover & Switch
- 2 Temperature sensor
- 3 Microphone

- 1 DC12V in
- 2 USB to PC
- 3 Siren Output
- 4 Reserve

## How T4 works for your family?

### ► Push-to-Talk



Stick an easy recognized photo on the buttons, just push these buttons to talk with your families.

You can also press the Answer button  to pick up the phone call.



### ► SOS alarm on emergency situation



Push the SOS button for 3 seconds, T4 will send SOS alert SMS text and make a phone call to receivers for asking emergency help.

Other Wireless SOS button or fall detectors optional.

### ► Answering phone call

Press for  answer the call in, press  for end calls.

### ► 7x24 house safety guard

When smoke, gas, CO or water flood detected, T4 will make audible alarm, send alert SMS text and call to the alarm receivers/CMS.

Audio volume can be adjust by Volume + and - button.

### ► 7x24 home security alarm

On Stay Home Arm  status, T4 makes audible alarm and send alert SMS text & call when intrusion sensor triggered.

## How T4 works for your family?



### ► Daily life care

T4 sends alert SMS if no activities detected by sensors during the monitoring time period.

For example, install one door contact sensor on the main gate, setting time period at 16:00-18:00pm, if the main gate not opened during that time, T4 sends alert SMS.

### ► Alarm Clocks

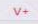
T4 will make audible alarm and flash on LCD according to the timing setting. Alarm audio can be stopped by end button .

Audio volume can be adjust by  and  .  
(the same volume for phone call, alarm too).

### ► Temperature monitoring

T4 sends alert SMS text when indoor temperature is too hot or cold.



### ► Other care

T4 sends alert SMS text when AC/DC power lost and recovery, back up battery low power, wireless sensor's battery low power (if have).

## Health care (Blood pressure measurement)

Wearing the cuff to measure the blood pressure and heart rate, connect the cuff to T4 unit, make the connection tightly:



press  or , measurement records will save on the T4's memory for download by PC software or upload to CMS or other could server system, relatives can get alert SMS text when the measurement value higher/lower than pre-set threshold too.

If the measurement error, T4 unit make two di di sound, LCD will display E1 or S1 and the LED beneath the button will keep red light, then please do it again.

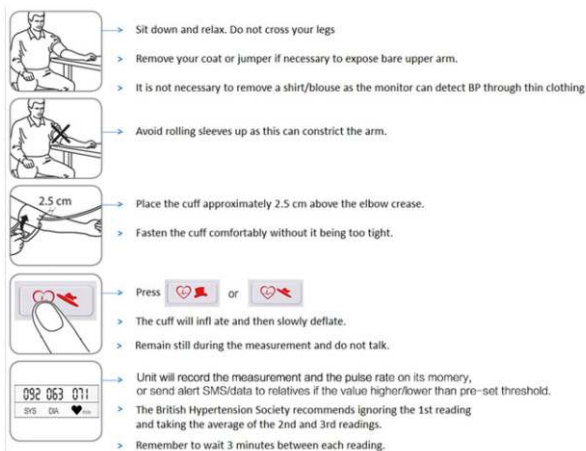

## Wiring and Start Setting

- ▶ Open the SIM Card Slot cover on back side.
  - ▶ Insert the SIM Card and close it correctly.
  - ▶ Connect power supply to DC12V in port, switch power ON.
- 
- ▶ Using smart phone APP is easy and simple, search **Senior Helper T4** on **Google Play** store, download and install the APP to your Android Smart phone for configuration.
  - ▶ You can also send SMS commands as below explanation to configure the T4.
  - ▶ The 1234 on below SMS commands is default password, change it to your new password if you previous changed.
  - ▶ The **Bold font letters** on below SMS command must be Capital letter and have no space.

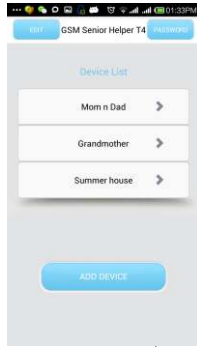

You can manage numbers of T4 on APP, modify the T4 information by click EDIT and the device name.

### Tips:

- ▶ T4 setup the best working method already before shipping to you, in most cases, what you need to do is just:
  1. confirm the T4 SIM Card number to get date & time
  2. add Speed dial numbers,
  3. add alarm receiver's phone number.

## Confirm T4 SIM Card Number



You should ALLOW the APP can send SMS and Call out.

### SMS Command:

1234L **the T4's SIM Card number**#

### Inquiry:

1234L

T4 will get mobile operator's date and time according to the phone number, LCD will correct and display the real date & time after few minutes when setting done. If T4 can't get right date & time automatically, please try to remove or add the [country code](#).

For example, **0086**13510150873, **+86**13510150873 instead of 13510150873.

## Alarm Receiver Numbers



### SMS Command:

1234B1T *phone number*

1234B2T *phone number*

...

1234B10T *phone number*

### Inquiry:

1234B

### Delete:

1234B1

...

1234B10

The 1st number can receive all alarm SMS, call, and temperature, AC power lost, back up battery low power, wireless sensor low power alarm SMS in default.

## Zone Alarm SMS Content (Zone name)

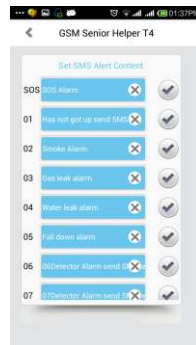

### SMS Command:

1234M00*zone alarm SMS content*

1234M01*zone alarm SMS content*

...

1234M32*zone alarm SMS content*

### Default Zone alarm SMS content:

00: SOS Alarm! ---For the SOS button on T4 unit.

01: Has not Get Up! ---For monitoring sensor.

02: Fall Down Alarm! ---For EM-90 fall down sensor/SOS pedant.

03: Fall Down Alarm! --- For EM-90 fall down sensor/SOS pedant(\*optional).

04: Panic Help Alarm! --- For EM-60/70/100/100B/YK series buttons(\*optional).

05: Emergency Alarm! --- For EM-60/70/100/100B/YK series buttons(\*optional).

06: Gas Leakage Alarm! --- For GL-100A Gas detector (\*optional).

07: Smoke Detector Alarm! --- For SM-100 Smoke detector (\*optional).

08: Water Leakage Alarm! --- For WL-100 Water detector (\*optional).

09: Wireless Zone 09 Alarm! - For PIR/door sensors installed for home intrusion alarm (\*optional, the same zone type from zone 09-32).

10: Wireless Zone 10 Alarm!

...

32: Wireless Zone 32 Alarm!

## Main Control Menu

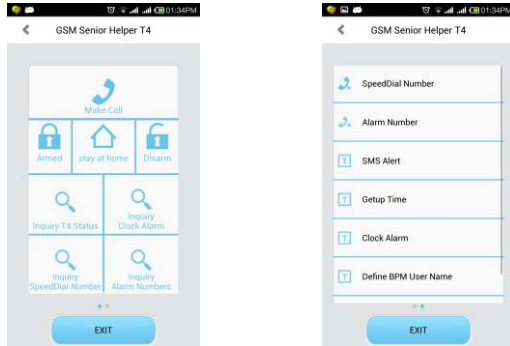

You can operate T4 by this main page.

**Make Call:** Call to the T4 for two way talk.

**SMS Command and detail:**

Arm: 1234AA

Disarm: 1234BB

Stay home Arm: 1234CC

Inquiry: 1234EE

Inquiry 8 Speed Dial numbers: 1234A

Inquiry Alarm receiver numbers: 1234B

Inquiry Alarm Clock times: 1234C

## Speed Dial Numbers

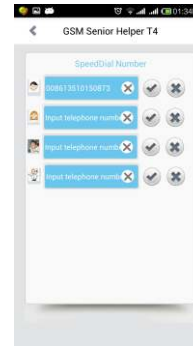

**SMS Command:**

1234A1T [phone number](#)

1234A2T [phone number](#)

1234A3T [phone number](#)

1234A4T [phone number](#)

**Inquiry:**

1234A

**Delete:**

1234A1

1234A2

1234A3

1234A4

## Blood Pressure Name



**SMS Command:**

1234U#[female name](#)#[male name](#)

For example, 1234U#[Mom](#)#[Dad](#)

## Get up Monitoring Time



SMS Command:

1234Sstart timeEnd time

Example on the APP screen shot is:

1234S0520E0830

That means: install one curtain PIR Motion detector outside of the bedroom, setting time period at 05:20~08:30am, if the PIR sensor not triggered during that time, T4 sends alert SMS to receivers say "Has not Get Up!". Also you can just install one door sensor on the bedroom's door frame, setting the time duration and if the door not opened during this time, T4 sends alert SMS out.

Disable the Getup Alarm:

1234S0000E0000

## Alarm Clocks



SMS Command:

1234C1time

1234C2time

1234C3time

1234C4time

1234C5time

Inquiry:

1234C

Remove Alarm Clock:

1234C1

1234C2

1234C3

1234C4

1234C5

## Add Wireless Sensors

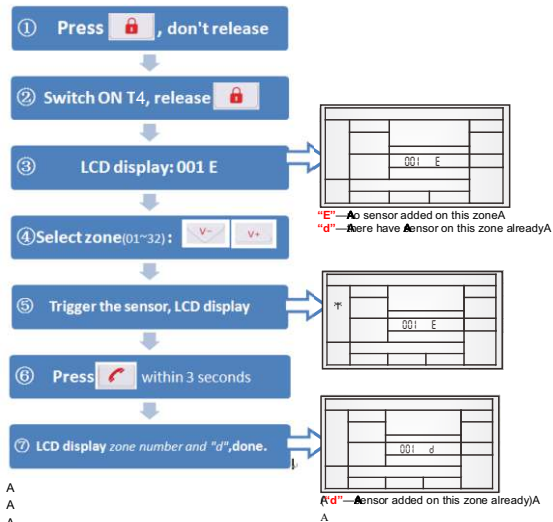

Delete wireless sensor: After step A, press  more than 2 seconds A

A  
A  
A  
Exit: Press , or T4 will exit "add wireless sensors" mode automatically if no Action more than 2 minuteA

## Safety Directions



### Safe Startup

Do not use the alarm system when GSM/3G equipment is prohibited or might bring disturbance or danger.



### Interference

All wireless equipment might interfere network signals of the alarm system and influence its performance.



### Avoid Use at Gas Station

Do not use the alarm system at a gas station. Power off it when near fuels or chemicals.



### Power it off near Blasting Places

Please follow relevant restrictive regulations. Avoid using the device in blasting places.



### Reasonable Use

Please install the product at suitable places as described in the product documentation. Avoid signal shielded by covering the mainframe.



### Use Qualified Maintenance Service

Maintenance can be carried out only by qualified person.