

LIGHTMOODS™

RGB Dome LED Neon Ribbon Light

USER MANUAL DMRGB-24V-60 (RGB)

PLEASE READ THESE INSTRUCTIONS CAREFULLY BEFORE INSTALLATION AND LEAVE A COPY FOR THE END USER/MAINTENANCE ENGINEER FOR FUTURE REFERENCE

FEATURES

1. Model: DMRGB-24V-60
 2. Rated input voltage: DC 24V
 3. Rated Power: 12W/m
 4. Dimension: 11.5*29mm
 5. LED quantity: 60LEDs/mtr
 6. LED Spacing: 16.67mm
 7. Min. cutting length: 100mm(6LEDs)
 8. Max. running length: 10mtrs for single end feed;
20mtrs for double ends feed
 9. Light color: RGB; Use LED Controller to realize color changes.
 10. Min. bent diameter: 120mm. Do not twist the light.
 11. Protection rate: IP68/IP65
 12. Protection rate for IP68: Protected against dust and submersion in water (1 meter above).
- NOTE: All connector joints must be connected correctly to achieve IP68 rating.
13. Can be cut and extended
 14. Long lifetime: 5 years
 15. Working ambient temperature: -4°~113°F (-20°~45°C)
 16. Operating(bending) ambient temperature: 32°~113°F (0°~45°C)

ACCESSORIES (SOLD SEPARATELY)

IP68 Accessories Kit

Both Ends Connection Application Accessories Kit

| | |
|-------------------------|-------|
| 01 Front Connector | 1 pc |
| 02 Front Connector | 1 pc |
| Rubber Gasket | 2 pcs |
| Aluminum Mounting Piece | 2 pcs |
| Anti-skidding clip | 2 pcs |
| Screws | 8 pcs |

Single End Connection Application Accessories Kit

Front Connector Accessories Kit

| | |
|----------------------------|-------|
| 01 (or 02) Front Connector | 1 pc |
| Rubber Gasket | 1 pc |
| Aluminum Mounting Piece | 1 pc |
| Anti-skidding Clip | 1 pc |
| Screws | 4 pcs |

End Cap Accessories Kit

| | |
|-------------------------|------|
| The Tail Plug | 1pc |
| Aluminum Mounting Piece | 1pc |
| Anti-skidding Clip | 1pc |
| Rubber Gasket | 1pc |
| Screws | 4pcs |

IP65 Accessories Kit

Both Ends Connection Application Accessories Kit

| | |
|--------------------|-------|
| 01 Front Connector | 1 pc |
| 02 Front Connector | 1 pc |
| Cover | 2 pcs |
| Anti-skidding clip | 4 pcs |
| HST | 2 pcs |

Remark: HST--Heat Shrink Tube

Both Ends Connection Auxiliary Accessories Kit

| | |
|------|------|
| Glue | 1 pc |
|------|------|

Single End Connection Application Accessories Kit

Front Connector Accessories Kit

| | |
|----------------------------|-------|
| 01 (or 02) Front Connector | 1 pc |
| Cover | 1 pc |
| Anti-skidding clip | 2 pcs |
| HST | 1 pc |

Remark: HST--Heat Shrink Tube

End Cap Accessories Kit

| | |
|---------------|-----|
| End Cap | 1pc |
| Shading Sheat | 1pc |
| HST | 1pc |

Remark: HST--Heat Shrink Tube

Single End Connection Auxiliary Accessories Kit

| | |
|------|------|
| Glue | 1 pc |
|------|------|

WARNING AND CAUTION

WARNING

1. Before making any cuts, installation, maintenance or connection, be sure the mains is disconnected!
2. NOTE: ALL CONNECTOR JOINTS MUST BE CONNECTED CORRECTLY TO ACHIEVE IP68 RATING.
3. Please operate this flex light according to the instructions, and confirm the work voltage, it must be matched with product requirements.
4. Please confirm the polarity of connector before insertion front connection cable.
5. Connect and cut this product correctly. Any wrong operation will damage this product.
6. No pressing on this product during storage, long term pressing may lead to damage.
7. Using qualified DC power supply.
8. Min. bent diameter 120mm, see Fig.1.
9. Do not twist the light as Fig.2 and follow the correct bending direction as Fig.3.
10. Do not hang this light in the air as Fig.4.
11. Cutting at the wrong location will result in a failure of the light! See Fig.5.

CAUTION

1. Suitable for mounting on normally flammable surfaces..
2. Use only factory-recommended connectors and accessories.
3. To ensure its long life span, operate the light properly in accordance with the instructions.
4. Do not operate in more than 113°F (45°C) ambient temperature.
5. Assemble the Connector correctly as in Fig.6.
6. Max. running length depends on the energizing way as Fig.7 shown.
7. Do not operate light when ambient temperature is below 32°F (0°C) thais may injure the light .

ASSEMBLY AND INSTALLATION

1. Turn off the electricity before operation.
2. Cut the light at correct location (if need).
3. Assemble the light according to Fig. 8, Fig. 9.
4. Install U channel and light according to Fig. 10.
5. Wire all connectors to the power line and check wiring of the whole circuit.
Cable color coding basics Refer to Fig.11.
6. Applying controller to Fig. 12.

FIGURES

Fig. 1 Minimum bent diameter 120mm

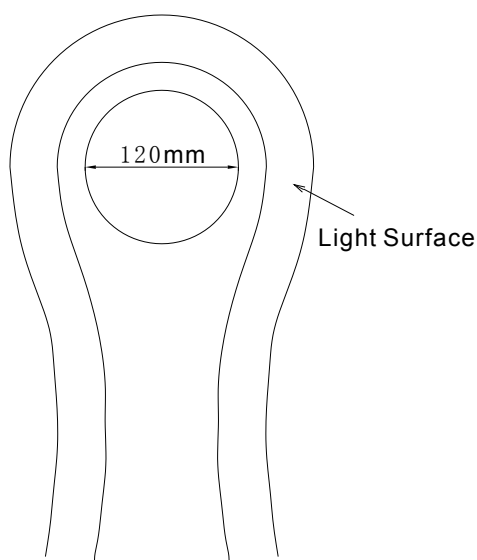

Twisting the light is forbidden and observe to correct bending orientation

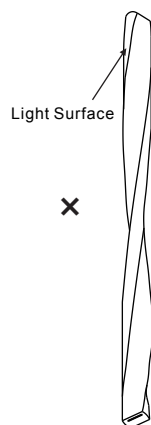

Fig. 2

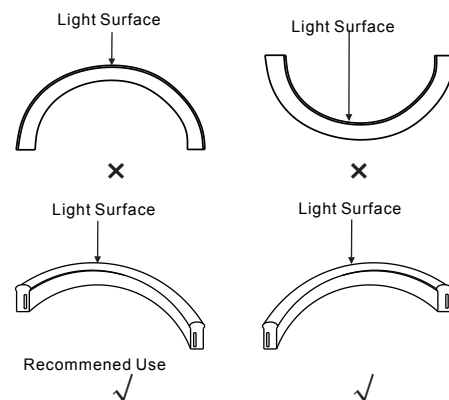

Fig. 3

Fig. 4 Installation of the light hanging suspended in the air as the picture illustrates is forbidden.

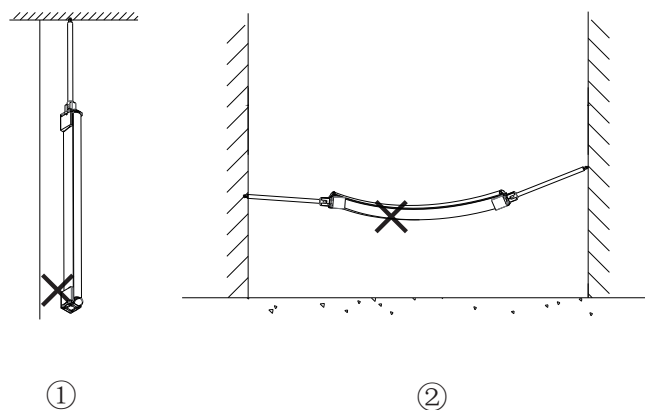

Fig. 5 Unit cutting guide

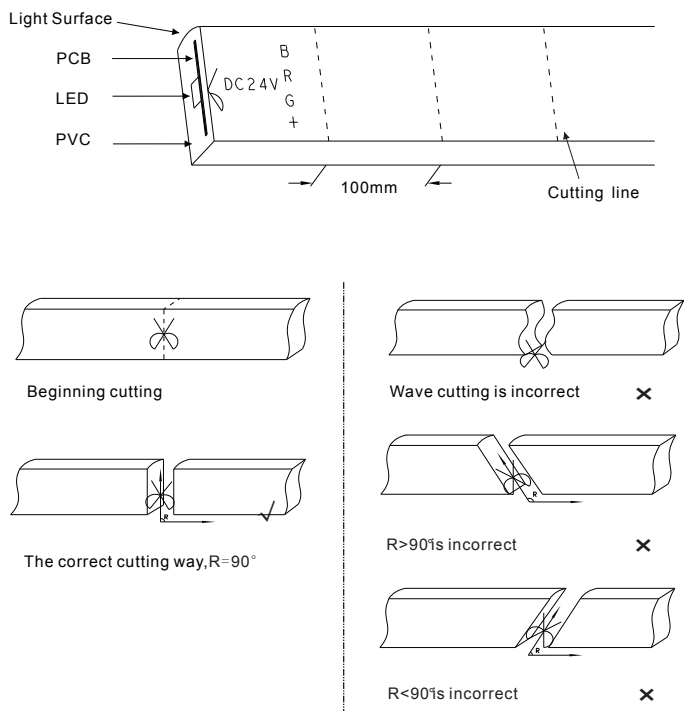
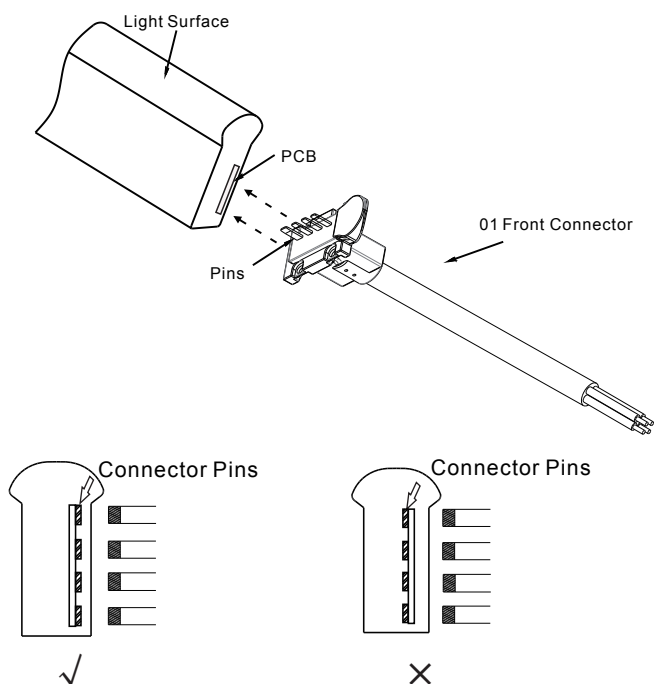

Fig.6 Correct insertion of connector pins

For 01 Type Front Connector



For 02 Type Front Connector

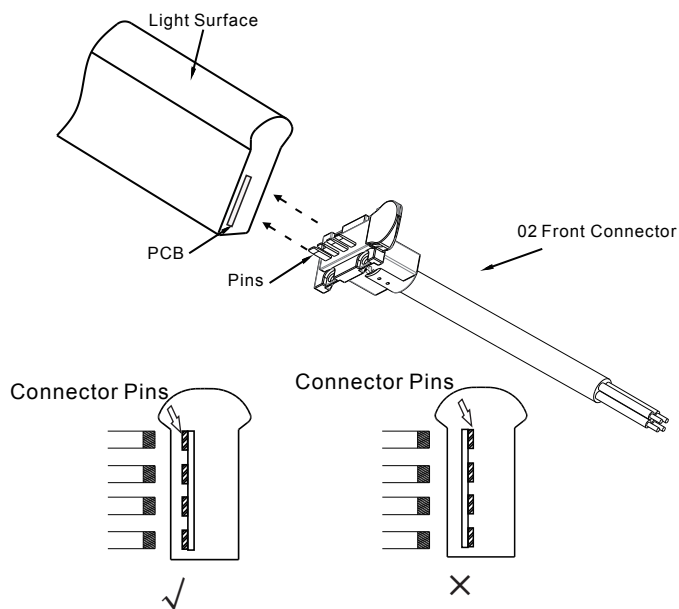
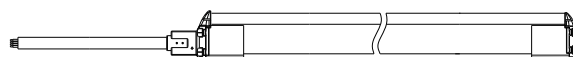

Fig.7 Energizing Method

① Single ends connection for Max. length 10m



② Both ends connection for Max. length 20m

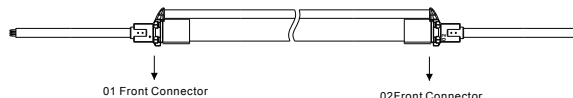
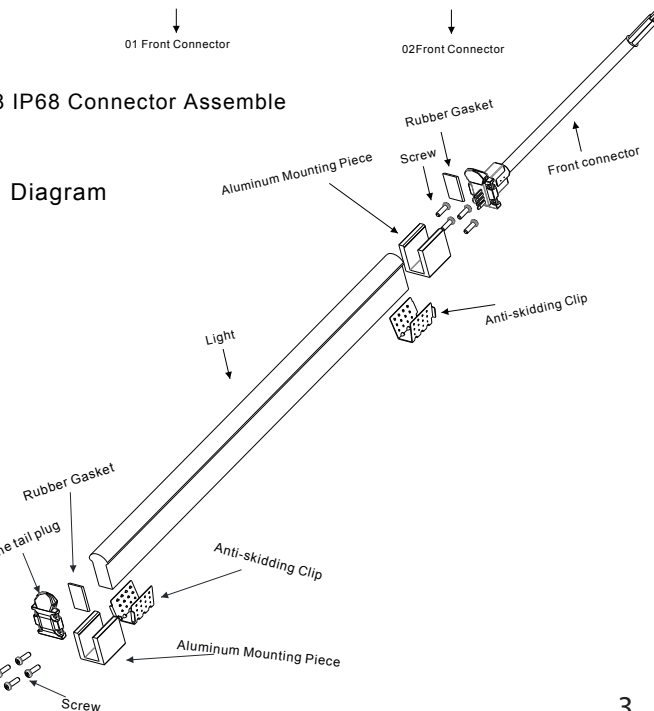

Fig. 8 IP68 Connector Assemble



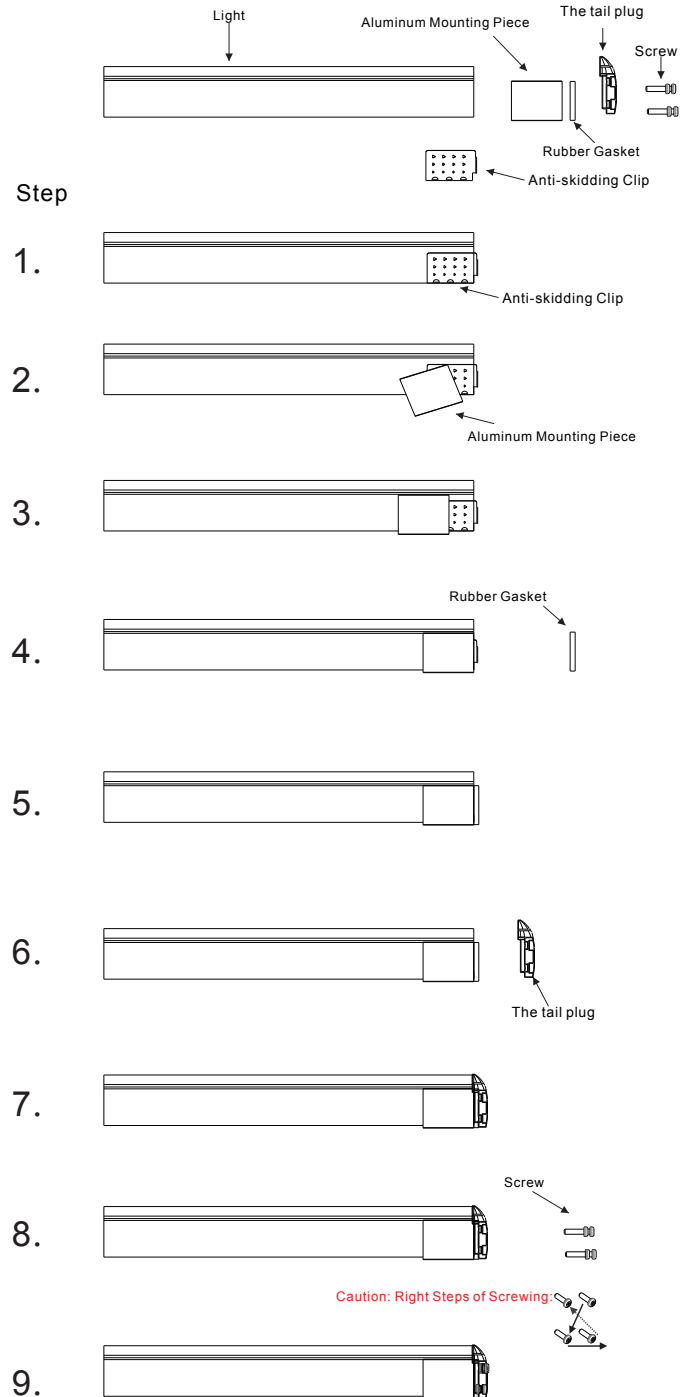
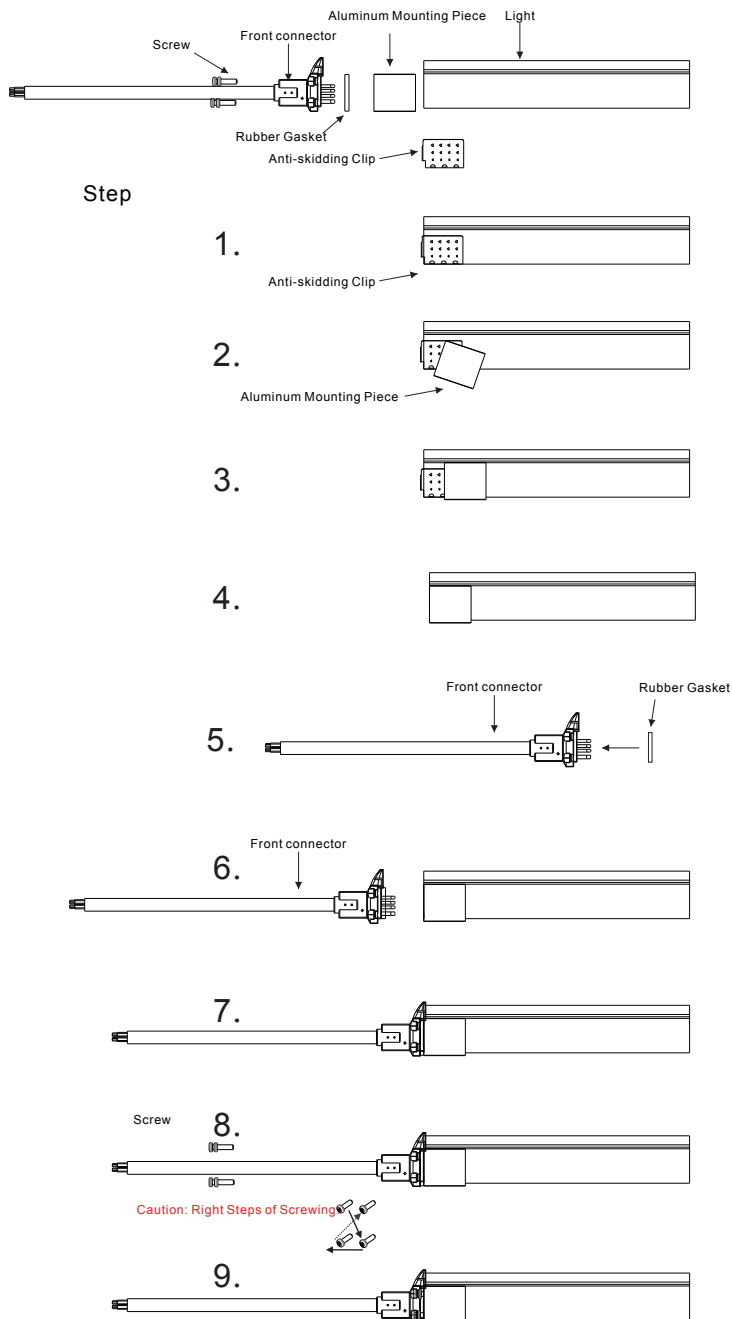

Fig. 9 IP65 Connector Assemble

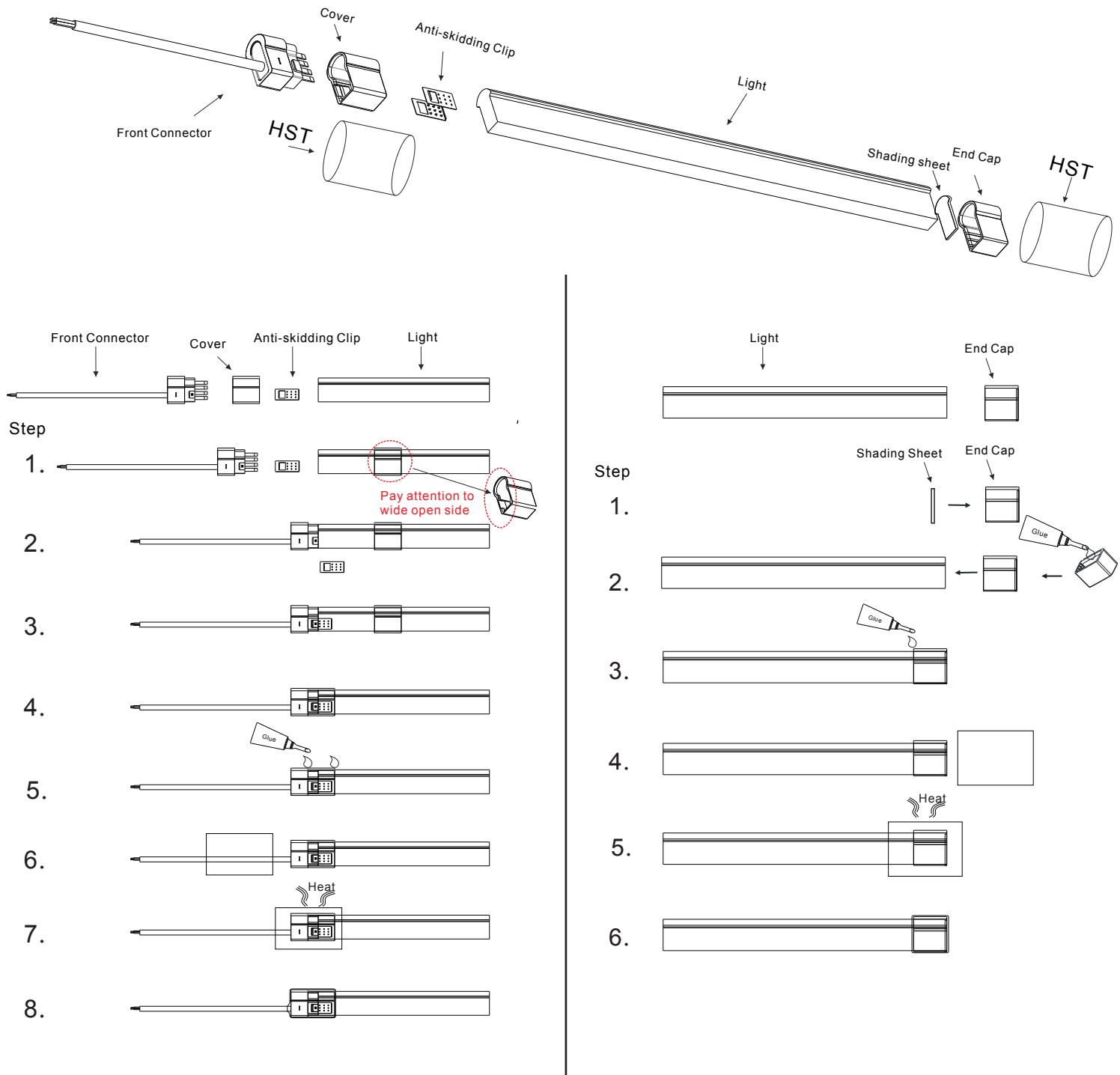
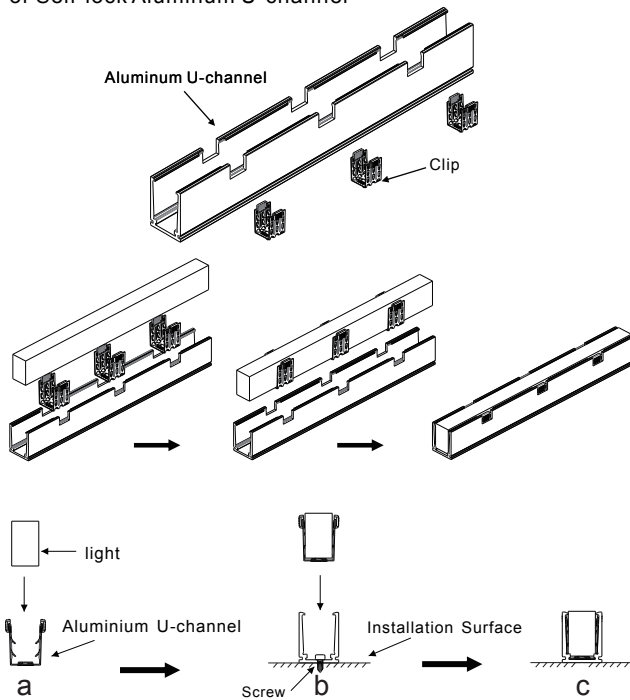

Fig. 10 Installation Guide

For Self-lock Aluminum U-channel



For Common Aluminum U-channel

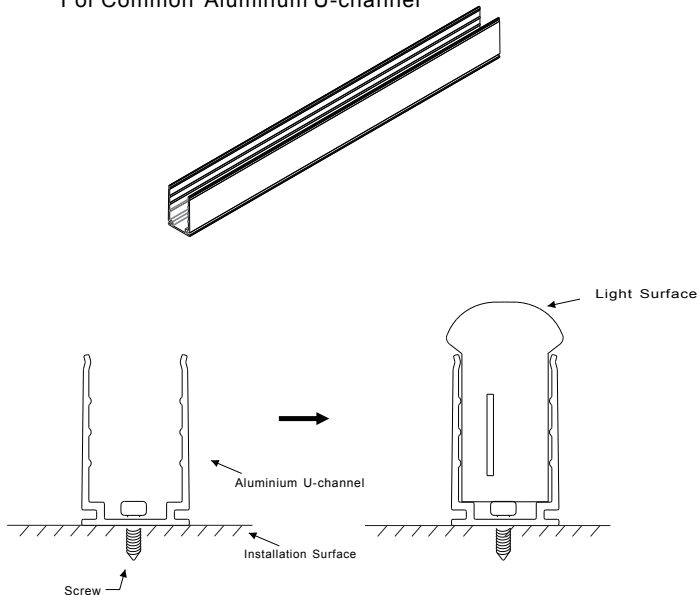

Fig. 11 Cable color coding basics

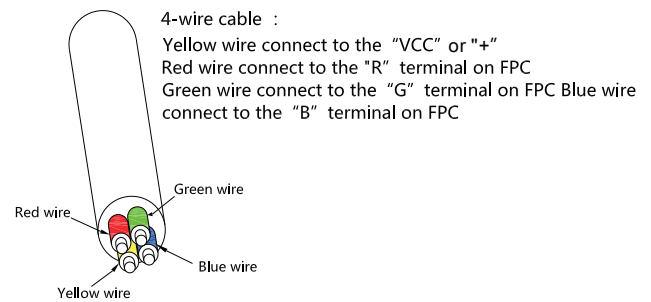
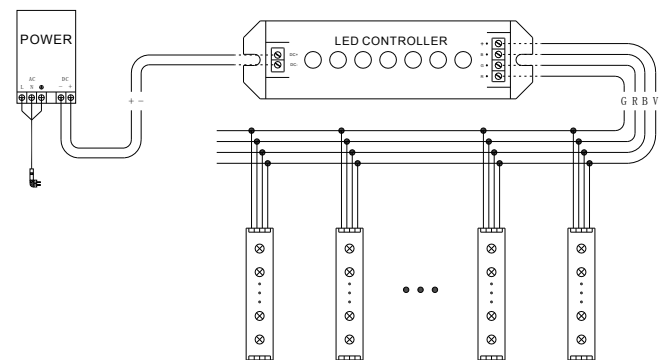

Fig. 12 Wiring Diagram



GUARANTEE

1. We provide lifelong technical assistance with this product:
A 3 year warranty is given from the date of original purchase.
The warranty is for free repair or replacement and covers manufacturing faults only.
For faults beyond the 3 year warranty we reserve the right to charge for time and parts.
Current technology will be selected first for repair or replacement.
2. Warranty excludes below:
Any man-made damages caused from improper operation, assembly, wiring, connection, installation, transport and storage.
Improper input voltage, current, operating and working environment.
The product appears to have excessive physical damage.
Damage due to natural disasters and force majeure.
Product label or data code have been damaged.
3. Repair or replacement as provided under this warranty is the exclusive remedy to the customer.
We shall not be liable for any incidental or consequential damages for breach of any stipulation in this warranty.
4. Any amendment or adjustment to this warranty must be approved in writing by us only.
5. This manual only applies to this model. We reserves the right to modify the manual and keep the right to make final edition of this manual.