

### Congratulations

By purchasing a Gigaset, you have chosen a brand that is fully committed to sustainability. This product's packaging is eco-friendly! To learn more, visit [www.gigaset.com](http://www.gigaset.com).



GIGASET. INSPIRING CONVERSATION.  
MADE IN GERMANY

### Pack contents



- 1 one Gigaset Base station
- 2 one power adapter for the base
- 3 one phone cord
- 4 one Gigaset handset
- 5 two batteries
- 6 one battery cover
- 7 one rubber seal for the USB connection
- 8 one belt clip
- 9 one user guide plus one Quick start guide

If you have purchased a model with multiple handsets, the package should contain two batteries, one battery cover, one rubber seal for the USB connection, one belt clip and one charger 1 with a power adapter 2 for each additional handset.



### Connecting the base station

- ▶ Plug the telephone cable into the connection socket 1 on the back of the base until it clicks into place; then push the cable into the clips.
- ▶ Plug the power adapter cable into the socket 2 on the back of the base and twist the angle plug underneath the cable clips.
- ▶ First, connect the power adapter 3.
- ▶ Then connect the phone jack 4.

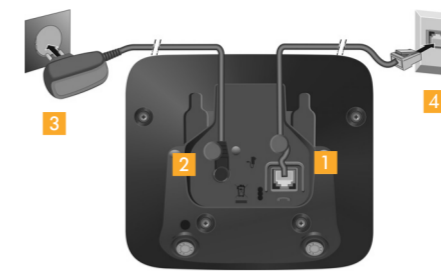

#### Please note:

- ▶ The power adapter must **always be connected**, as the phone will not operate without a power supply.
- ▶ Use only the power adapter and phone cord **supplied**. Pin connections on telephone cables can vary.

### Connecting the handset charger (if included)

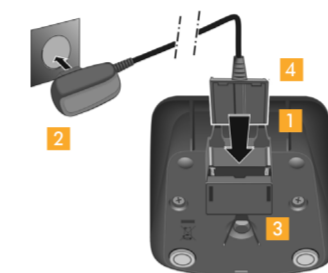

- ▶ Connect the flat plug to the power adapter 1.
  - ▶ Plug the power adapter into the plug socket 2.
- If you have to remove the plug from the charger again:
- ▶ Disconnect the power adapter from the mains power supply.
  - ▶ Press the release button 3 and disconnect the plug 4.

### Frequently asked questions

- Q: There is no dial tone.**  
A: Press call button for 2 seconds (long press) to obtain dial tone. A short press opens the redial list.
- Q: The line is crackling / not clear.**  
A: Have you used the new line cable provided? Please do not use an old cable.
- Q: The display is not clear / seems to be broken.**  
A: The display is protected by a plastic film, please make sure you have removed the protective film.
- Q: The handset is not registered.**  
A: If your handset is not registered, please follow the Registration handset procedure. (see user manual)
- Q: The caller ID is not working.**  
A: Have you subscribed to this service (CLIP) from your provider?
- Q: Message indicator flashing and I cannot retrieve my message.**  
A: Message indicator will flash to indicate missed calls as well as new messages of text messages. (see user manual)
- Please check:**
- Have you used the phone cord supplied ..
  - Have you fully inserted the power cable into the base station ..
  - Have you inserted the batteries correctly ..
  - Have you charged the battery for 9.5 hours ..
  - Have you set up the Date/Time ..

To download the latest manuals, visit our web-site: <http://www.gigaset.com>

You have questions? As a Gigaset customer, you can take advantage of our comprehensive service offerings. You can find help quickly in this User Manual and in the service pages of our Gigaset online portal: <http://www.gigaset.com>

**If you have problems setting up or operation this product please call**  
**GIGASET UK HELPLINE +44 84503 18190**  
**GIGASET IRL HELPLINE +353 818 200 033**

Product may not be fully compatible with the national telephone network. It is clearly specified on the box near the CE mark as well as on the bottom of the base station for which country/countries the equipment has been developed. If the equipment is used in a manner inconsistent with this advice or with the instructions of the manual and on the product itself, this may have implications on the conditions for warranty or guarantee claims (repair or exchange of product). In order to make use of the warranty, the product purchaser is asked to submit a receipt which proves the date of purchase (date from which the warranty period starts) and the type of goods that have been purchased.

### Preparing the handset

- ▶ Insert the rubber seal for the USB plug socket into the groove.



- ▶ Insert the batteries with the polarity in the correct direction. The polarity is indicated in the battery compartment.



- ▶ Insert the battery cover from above.
- ▶ Then press the cover until it clicks into place.

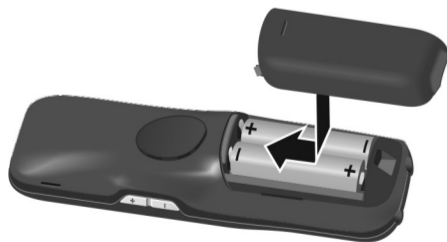

To reopen the battery cover to replace the battery:

- ▶ Insert your fingernail into the notch on the top of the cover and push downwards.



### Charging the battery



The battery is supplied with a partial charge. Please charge it completely before use.

- ▶ Charge the handset in the base for 9.5 hours.

#### Please note

The handset must only be placed in the designated base or charger.

### Setting up the base and handset

The installation wizard starts automatically the first time your handset is connected to the base after switching on or after registration. It helps you to configure the following key settings on the handset and base.

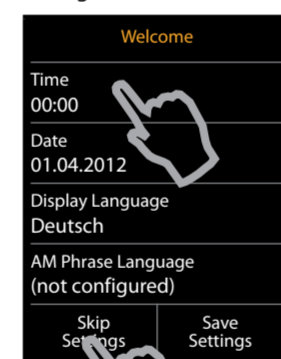

If you want to adjust the settings at a later date:

- ▶ Touch the **Skip Settings** option at the bottom of the display.

The handset then switches to idle status.

You can configure the settings at any time using the **Settings** menu on your handset.

To configure the settings:

- ▶ Touch the **Time** field to configure this setting.

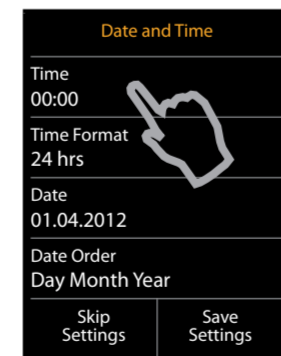

The **Date and Time** submenu opens.

- Set the
- Time
  - Time Format (12 hrs/24 hrs)
  - Date
  - Date Order (Day Month Year/Month Day Year)

by touching the fields in sequence and adjusting the settings (see the following illustrations).

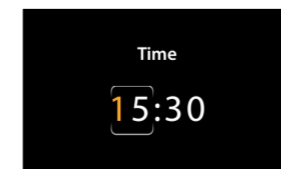

#### Setting the time

The current position is shown in colour and the digit flashes.

- ▶ Enter the digits via the keypad. You can change the cursor position by touching the digit you want to change.
- ▶ Touch the  icon to save your changes or press **Back** to return to the **Date and Time** page without saving any changes.

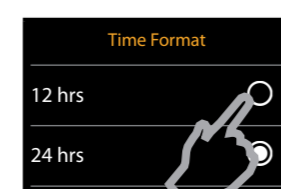

#### Setting the time format

The time format setting is indicated by .

- ▶ Touch the  icon to change the format.
- ▶ Touch the  icon. The setting is saved automatically. You return to the **Date and Time** page.

### Setting up the base and handset

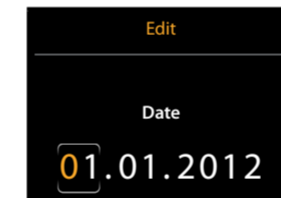

#### Setting the date

The current position is shown in colour and the digit flashes.

- ▶ Enter the digits via the keypad. You can change the cursor position by touching the digit you want to change.
- ▶ Touch the  icon to save your changes or press **Back** to return to the **Date and Time** page without saving any changes.

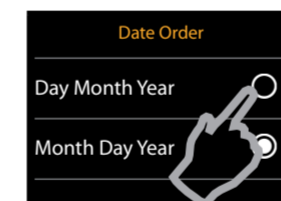

#### Setting the date order

The date order setting is indicated by .

- ▶ Touch the  icon to change the format.
- ▶ Touch the  icon. The setting is saved automatically. You return to the **Date and Time** page.
- ▶ Touch **Save** to return to the **Welcome** page.

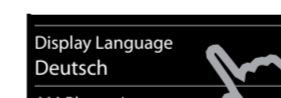

#### Setting the display language

The current language is displayed under **Display Language**.

If you want to change the setting:

- ▶ Touch the **Display Language** field.



The current language setting is indicated by .

▶ Touch the  icon next to the language you want to set. If your language is not displayed, the list may be "longer" than the display. You must then scroll through the list. To do this, put a finger on the display and move it slowly upwards.

- ▶ Touch the  icon. The setting is saved automatically. You return to the **Welcome** page.

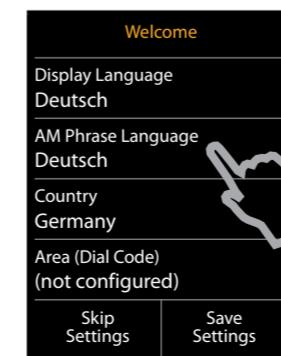

#### Setting the answering machine language

- ▶ Touch the **AM Phrase Language** field.
- ▶ Set the answering machine language as described above.

#### Setting the country

Set the country in which you are going to use the phone.

- ▶ Touch the **Country** field.
- ▶ Set the country as described above.

#### Entering the local area code

- ▶ Touch the **Area (Dial Code)** field.

### Setting up the base and handset

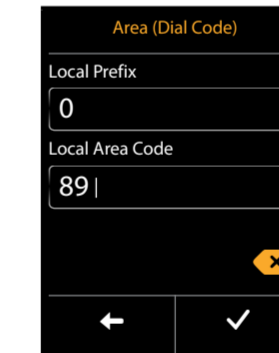

The **Local Prefix** is the country-specific area code that precedes the **Local Area Code** when the country code is not dialled. In Germany, the "0" **Local Area Code** is then e.g., 89 for Munich or 221 for Cologne.

- ▶ Enter the **Local Prefix** of your country (max. 4 characters; "0" in the example). The field is already populated for the selected country.
- ▶ Briefly touch the second input field and enter the **Local Area Code** (maximum 8 characters, "89" in the example). You can correct incorrect entries using **Back**.
- ▶ Touch  after entering the numbers to save the entry.

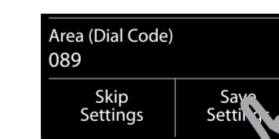

The **Welcome** page is displayed again.

- ▶ Touch the **Save** option to save your settings.

### Handset in idle status (configurable page)

Once you have configured all the necessary settings, your handset switches to idle status. The **configurable page** that you can customise is displayed. Here, you can compile important functions for quick access. Some are set by default.

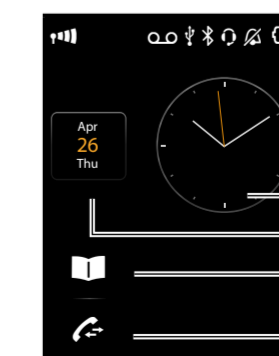

#### Status bar

Contains the internal handset name (e.g., INT 1; if multiple handsets are registered) and icons that display the current settings and the operating status of the phone. To discover the meaning of the icons, see user manual. Touch the status bar to display the status page.

#### Time

Current date

Open Contacts

Open call lists

Your phone is now ready for use.

