



USER MANUAL



**C-MAG MAGAZINE
SYSTEM 9MM**

MP5

CONTENTS

	Pages
Introduction	2, 3
Technical Data	4
Description	5, 6
Drawing: exploded view	7
Loading	8, 9
Use of Personal Loader MP5	10, 11
Precautionary Measures Sand	12
Disassembly of the C-MAG	13 - 16
Assembly of the C-MAG	17 - 21
Troubleshooting	22, 23
Accessories	24, 25
C-MAG MAGAZINE SYSTEM MP5	26
List of Part Numbers	27

INTRODUCTION

The C-MAG Magazine MP5 9mm is a 100 round ammunition magazine, manufactured to the highest production standards. It meets and exceeds NATO Military Specifications.

The patented design provides for equal distribution of the ammunition in each of the twin drums. Rounds are fed alternately from each drum through the feed clip into the weapon, resulting in a fixed center of gravity during firing. Using a unique rotation device and low torsion stress springs, the C-MAG is the world's first magazine with a full 100-round capacity, capable of being pre-loaded and stored indefinitely.

The compact design allows for better ground clearance and stability.

The C-MAG for the MP5 series of Submachine Guns is installed in the weapon like the standard issue magazine, but with **the bolt in the open position** (recommended).

The C-MAG can be reloaded and reused repeatedly with an estimated life cycle of more than 60,000 rounds.



C-MAG 9MM

Technical Data

AMMUNITION:

NATO Standard, 9 x 19 mm Parabellum

CAPACITY: Variable, 1 to 100 rounds

FEED RATE:

Variable, up to 1,500 rounds per minute

DIMENSIONS:

284 mm x 120 mm x 44 mm

11.17 x 4.72 x 1.57 inches

WEIGHT: Empty: 1 kg / 2.2 lbs.

STORAGE LOADED: Indefinite

MATERIALS:

Main Components Filled thermoplastic

Minor Components Non-corrosive steel; alloy

DESCRIPTION

The C-MAG magazine consists of two main component assemblies:

- **Double Drum Housing**
- **Feed Clip Assembly.**

Feed Clip Assembly

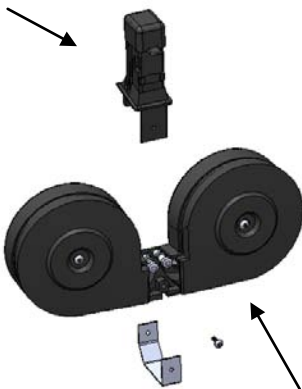

Double Drum Housing

The **double drum housing** comprises of:

- double drum,
- drive gear assemblies with pusher arms
- set of covers.

The housing acts as storage facility for the ammunition.

The **feed clip** is filled with

- 13 spacer rounds and
 - 1 last-round-link-assembly,
- which occupy the feed clip when the magazine is empty.

The **last-round-link-assembly** is positioned at the open end of the feed clip when the magazine is empty. The upper half of the assembly is tapered to allow the weapon bolt to pass over it after the last round has been fired.

WARNING: Do not remove Spacer rounds and Linked Assembly !!

The bolt will stop in the closed position.

C-MAG MP5

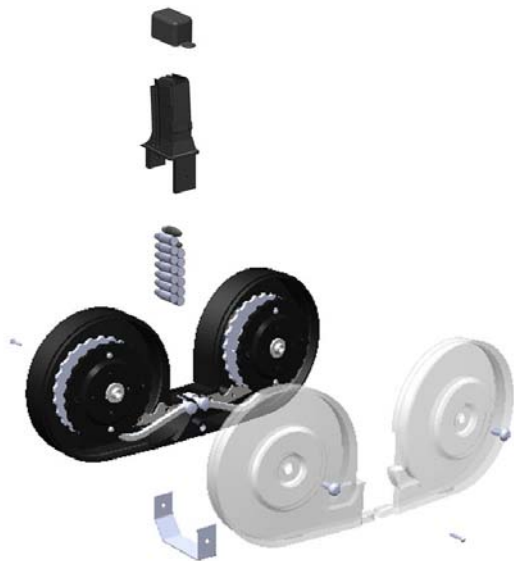

Assembly Parts

LOADING / LUBRICATION

- The C-MAG loads and functions like a standard issue magazine.
- Live cartridges are loaded by pressing them into the feed clip (on top of the spacer rounds). Cartridges will feed alternately into each drum. The springs are tensioned during the process without the need for any supplementary operations.
- The magazine does not need to be empty to be loaded and remains completely operational at all times.
- Load with the Personal Loader.
- Regularly **add Graphite** (dry lubricant).

Do not use Oil!



C-MAG Loading Action

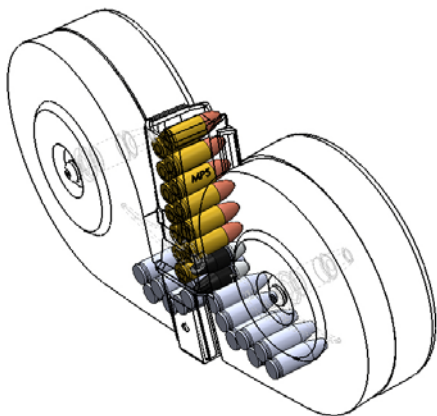

Rounds on the **left side** of the feed clip are loaded into the **left drum**.

Rounds on the **right side** of the feed clip are loaded into the **right drum**.

Use of the Personal Loader MP5

The Personal Loader consists of two parts:

- **Housing** – fits over the feed clip of the C-MAG
- **Plunger** – pushes rounds into the magazine

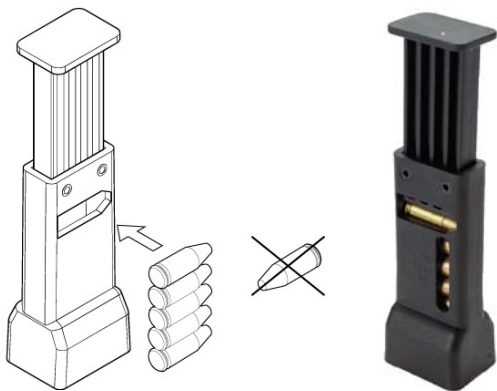

To operate the loader, raise the plunger and insert 5 cartridges into the side opening of the housing, depress plunger to load the rounds into the C-MAG.

WARNING: DO NOT load ammunition backward! The 9mm cartridge has the tendency to turn over easily, when dropped into the loader.

The loading process is easy and does not require extra force. STOP immediately, if extra force is required and check for reversed rounds.

The magazine will jam during firing, if rounds are loaded backwards.

CAUTION

PRECAUTIONARY MEASURES FOR USE IN SAND ENVIRONMENT

- Keep BOLT CLOSED when C-MAG is in the weapon.
- Keep DUST COVER on the feed clip whenever C-MAG IS NOT in the weapon.
- Keep C-MAG in Carrying Pouch when not in use.

DISASSEMBLY OF THE C-MAG

The C-MAG can be taken apart for cleaning or, if necessary, for the clearing of stoppages due to contamination or the accidental reversal of an ammunition cartridge during loading.

1. DISASSEMBLY FOR CLEANING

Take the empty C-MAG and

1.1. Remove Clip Assembly

1.1.a Loosen clips screws.

1.1.b Turn C-MAG over and remove 2 screws and clip strap.

1.1.c Remove 13 spacer rounds and 1 last-round-link-assembly from feed clip.

1.2. Remove Cover Set

WARNING:

Do not disassemble any further.

1.2. Cleaning

- 1.3. a Clean drum assembly, covers, feed clip, spacer rounds and linked assembly as recommended below.

CONTAMINATION & ACTION
HARSH SAND, DIRT ETC.: Use cloth, compressed air or flush with water.
FINE SAND, SILT, MUD ETC.: Soak in water with detergent (optional) to saturate and dissolve deposits. Flush with clean water.
OILS, GREASE, RESIDUES FROM SOLVENTS OR FUELS: Use acetone or alcohol. Do not use oily fuels such as diesel, mineral spirits or kerosene. Follow up with detergent and water.
CLEAR COVERS: Use water, soap or detergent. Do not use solvent.

USE CAUTION

1. DISASSEMBLY FOR CLEARING OF BLOCKAGES

2.1. Remove Clip Assembly

2.1.a Hold down clip assembly and loosen screws.

2.1.b HOLD DOWN clip assembly while removing screws and clip strap.

CAUTION:

Point C-MAG away from you.

Removing the clip strap may release blockage. Cartridges may be forced out of drum housing. Control release of rounds by holding down clip.

2.2. Remove Cover Set. CAUTION:
Put C-MAG in container to avoid uncontrolled release of rounds.
Point away from you!

- 2.2.a Carefully remove screws and remove cover. Grasp and slowly rotate drive gear to dislodge ammunition. Shake drum assembly if necessary. Do not allow drive mechanism to snap back into place.
- 2.2.b Check for damaged parts.

2.3. Repairs

Magazines with obvious and serious damage to the drum assembly cannot be field repaired and must be returned to the manufacturer for repair. Removable components are available as spare parts for field replacement.

C-MAG products can be returned to the manufacturer for warranty or post warranty work at any time.

THE BETA COMPANY

2137B Flintstone Drive, Tucker, GA 30084, USA
1-800-669-2384, www.betaco.com

ASSEMBLY OF THE C-MAG



1. **Inspection**

All parts of the C-MAG should be inspected for function or damage prior to assembling. Drive gears in the double drum housing should rotate freely.

2. **Attach covers**

Place covers on drum assembly and attach. Covers are designed for a tight fit.

1. Attach feed clip assembly.

1.1. Load feed clip

The feed clip holds 13 spacer rounds and 1 last-round-link-assembly.

- Hold feed clip horizontal as shown
- Place one loose spacer round on top of the last-round-link-assembly as shown and slide into the bottom of the feed clip. Use your finger or any object to hold the 3 round assembly in position.
- Add spacer rounds in a staggering manner and move towards the top of the feed clip until all spacer rounds are loaded.

CAUTION:

The tapered round of the linked assembly must be at the open end of the feed clip. The assembly must be installed vertically as shown.

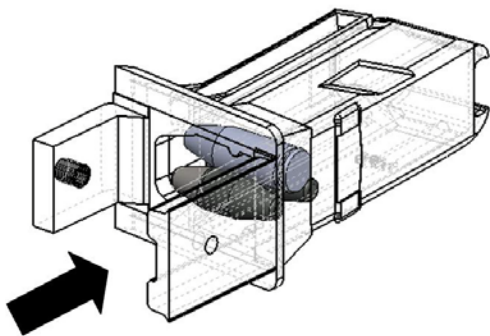
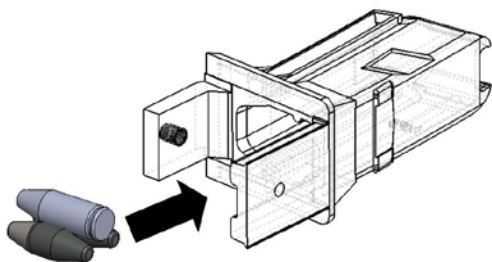

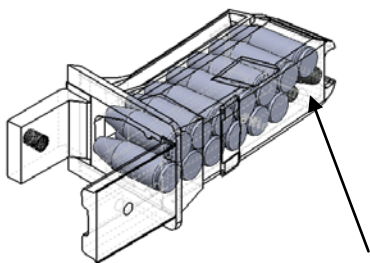

Tapered linked assembly

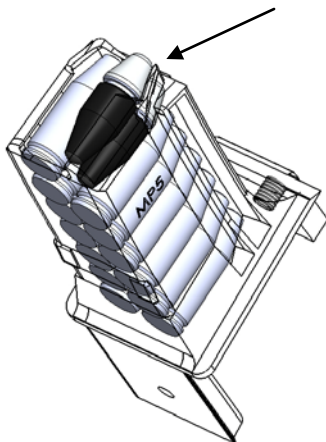

3.2. **Attach feed clip to drum housing**

- Invert double drum housing and feed clip assembly. Slide feed clip assembly on to drum housing.
- Add clip strap.
- Turn around holding down feed clip assembly and attach screws. Assembly is complete.
- Depress spacer rounds to check for free movement.
- Add graphite for lubrication.



TROUBLESHOOTING

Characteristic	Cause
Loading stops after about 14 rounds	Last-round-link-assembly is installed incorrectly.
Loading is very difficult.	(a) Rounds loaded backward (b) Dirty magazine
Double feeds in weapon	Feed Clip may be cracked
Life rounds mixed with spacer rounds in feed clip below linked assembly	One drum hesitated feeding. Sign of dirty magazine.
Spacer round is chambered	Same as above
Weapon bolt drives linked assembly into front of feed clip	Linked assembly is installed upside down.

TROUBLESHOOTING

Characteristic	Cause
Linked assembly drags in feed clip	Linked assemblies have become lengthened. Maybe pushed back together and re-used, or exchanged.
Magazine falls out of weapon	Magazine is not fully seated in weapon.
Round missed stagger 	Will feed and fire if it loaded easily. If loading required extra force, unload and load again.
Weapon jams after it fires several rounds. Magazine feeds well by hand.	Check for secure attachment between feed clip and drum assembly.
C-MAG rattles when empty or full.	This is normal.

ACCESSORIES

1. ACCESSORIES

1.1. Personal Loader

See pages 10 and 11.

1.2. Pouch

1.2.a The pouch is designed to hold

- 1 C-MAG Magazine
- 1 Personal Loader
- 1 Graphite Tube
- 1 User Manual

1.2b The pouch is equipped with a dual attachment system:

- Belt loop
- Webbing for keeper attachment

Pouch

USER MANUAL
(inside behind logo panel)



GRAPHITE
TUBE
PANEL



LOADER
POCKET



C-MAG MAGAZINE SYSTEM MP5

Includes the following components:

C-MAG Magazine MP5

Personal Loader MP5

Pouch MP5

User Manual MP5

Graphite Tube



LIST OF PART NUMBERS

Part No.	Description
MHM901	C-MAG SYSTEM MP5
MHM921	C-MAG SYSTEM MP5 clear
CHM900	C-MAG Magazine MP5
CHM900-1	C-MAG Magazine MP5 clear
LHM905	Personal Loader MP5
PHM906	Pouch MP5
SHM930	Feed Clip MP5
SHM931	Spacer Round 9MM
AHM932	Last-Round-Link-Assembly
SHM902	Drum Back Cover Set 9MM with screws
SHM901	Clip Strap 9MM with screws
SHM960	Dust Cover MP5

For further information contact:

THE BETA COMPANY

2137B Flintstone Drive, Tucker 30084, Georgia, USA

Phone: +770 270 0773, Fax: +770 270 0599

Internet: www.betaco.com