

## **User's manual**

### **LIGHT EDGERS**



### **WARNING**

Please read the operating instructions carefully before using the machine.

### **REPEX Floor SAS**

8-10 rue de l'insurrection Parisienne  
94600 CHOISY LE ROI  
Tel : 33 (0)1.46.80.03.92  
Fax : 33 (0)1.46.80.12.09  
Email : [repex@wanadoo.fr](mailto:repex@wanadoo.fr)

Keep carefully this manual.

## Index

1. Important safety precautions .....	3
2. Introduction to the « Light Edgers » .....	4
3. The machine and its components .....	5
4. Using the machine .....	6
4.1 – Assembling the dust bag .....	6
4.2 – Changing the abrasives.....	7
4.3 – Positioning the long nose .....	7
4.4 – Adjusting the wheels .....	8
5. Starting the machine .....	8
6. Service and maintenance .....	9
6.1 – Emptying the dust bag .....	9
6.2 – Replacing the brushes.....	9
6.3 – changing the cogged belt.....	9
7. Maintenance queries.....	9



## **1. Important safety precautions**

This machine is not a vacuum cleaner !

This machine must only be used on dry surfaces and should not be used in humid conditions !

Do not touch any part of the machine with wet hands !

This machine is not a toy ! Children should be kept away from it during use !

Do not forget to attach the dust bag !

Do not use this machine without a sanding disc !

Do not use this machine if you find that any component is missing ! Each component is vital !

Never try to repair this machine yourself ! If you have a problem, you must contact a qualified technician !

Use this machine in accordance with the instruction manual !

Never use this machine without wearing suitable safety equipment : you must wear a mask over your mouth and you are strongly advised to wear ear plugs.

This machine must be disconnected from power sockets during cleaning and maintenance.

Voltage 230 Volts.

## **2. Introduction to the “Light Edgers”**

First of all check that all the parts of the machine have been supplied. **Please, contact your supplier if any parts of this machine are missing.**

**You should have :**

- **1 instruction manual,**
- **1 dust bag**
- **1 Light Edger,**
- **1 handle bag (with nut and bolt for attaching) ,**
- **1 spanner (n° 13).**

### **The “Light Edger”**

When used correctly (follow necessary precautions) this machine is easy to use. It can be used on various surfaces. For example, on stairs and under radiators.

The motor turns at 12.000 rpm, with its sanding disc driven by a belt.

This machine has an universal motor. As with other machines it should be used for no longer than 20-30 minutes at each time, and you should let it rest for a few minutes between two operations. It is strongly recommended to not use the machine for extended periods, and to use it in accordance with the above precautions.

**Charcteristics of this machine :**

- **Can be easily dismantled,**
- **Can be easily transported in the trunk of the car,**
- **Light-weight (7,2 kg),**
- **Comes with a disc with a diameter of 150 mm,**
- **Sound level A : 80 dB(A),**
- **Specifics of the chassis : Universal motor - 1,2 kW (1,6 CV), 230 V,**
- **Voltage 230 V - fuse 10A.**

## 3. The machine and its components

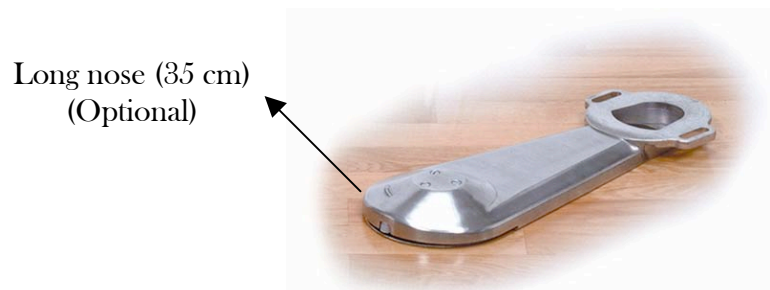
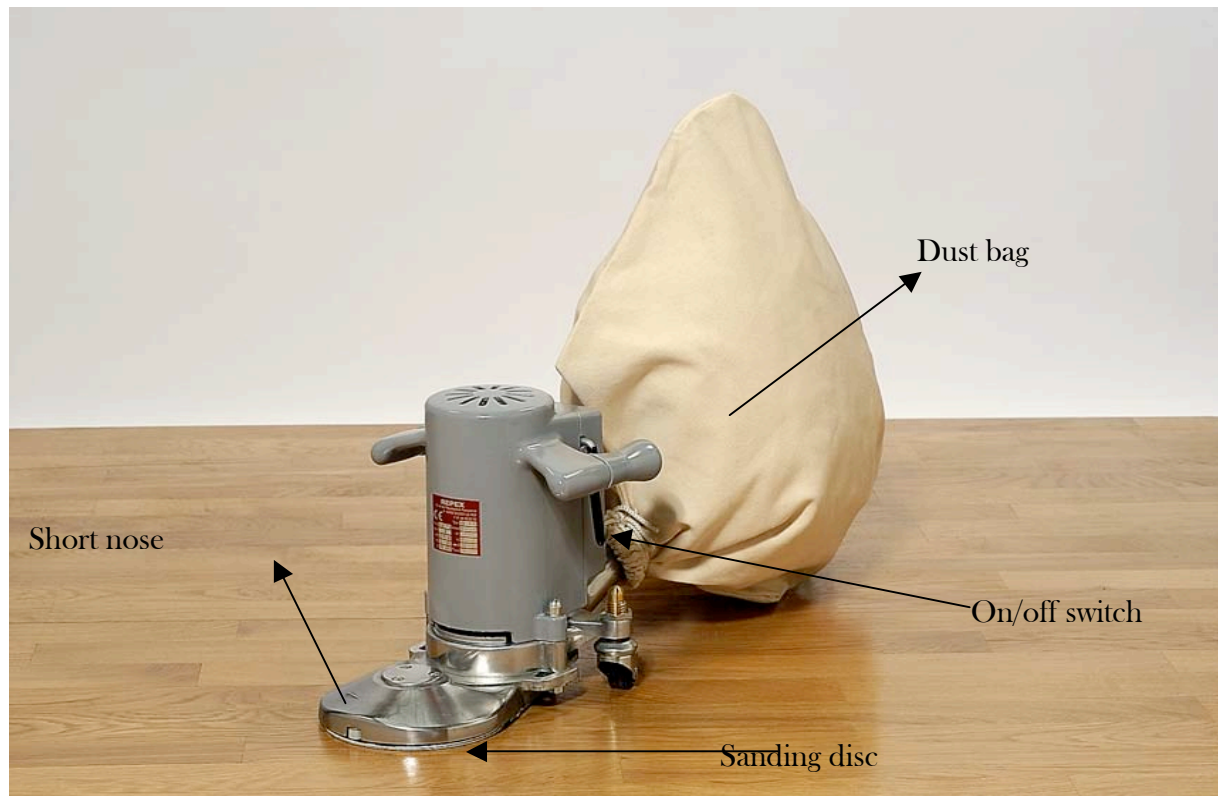

Sanding disc for this machine.



Center fix sanding with hole.



Sanding disc with « velcro »

## **4. Using the machine**

### ***4.1 – Assembling the dust bag***

To fit the dust bag correctly, you must screw it onto the rod that sticks out of the back of the machine. The bag should not be trailing along the ground.

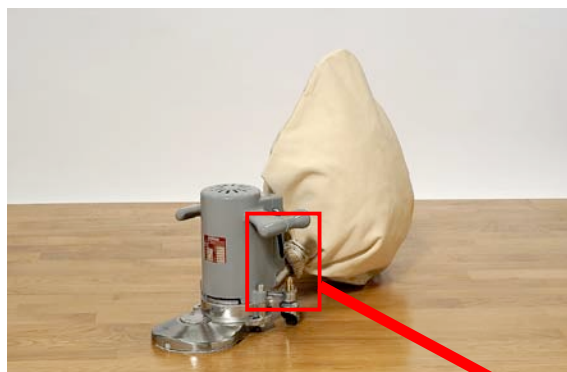

Secure the bag to the rod with the cord provided.



(fig.1)

#### **Safety warning :**

- Never use this machine without a dust bag. Sand dust can damage your health if inhaled.
- This machine is only suitable for use on wooden surfaces.
- This machine must be checked regularly for faults or damage. If you have a problem with your machine, please contact your supplier.



# REPEX Floor

## 4.2 – Changing the abrasives

To change the sanding disc (150mm), use the spanner (key N°13) provided to unscrew the central disc (see fig 2). To change the Norgrip (Velcro) disc, simply pull it off - it is not necessary to use the spanner.



(fig.2)

### NOTE :

- Don't forget to fit at least 2 sanding discs.
- Handle this machine with care. Do not drop it and make sure the disc is protected during transportation.

## 4.3 – Positioning the long nose

The long nose is fitted to the main body of the machine by two 13mm screws. The short nose reaches area up to 11cm. The long nose is used to reach covered or hidden areas like under radiators.

Fig 3 shows where the screws to change the nose are. To fit the long nose correctly you must place the belt around the pulley. The disc will then turn in the same way as the other disc.

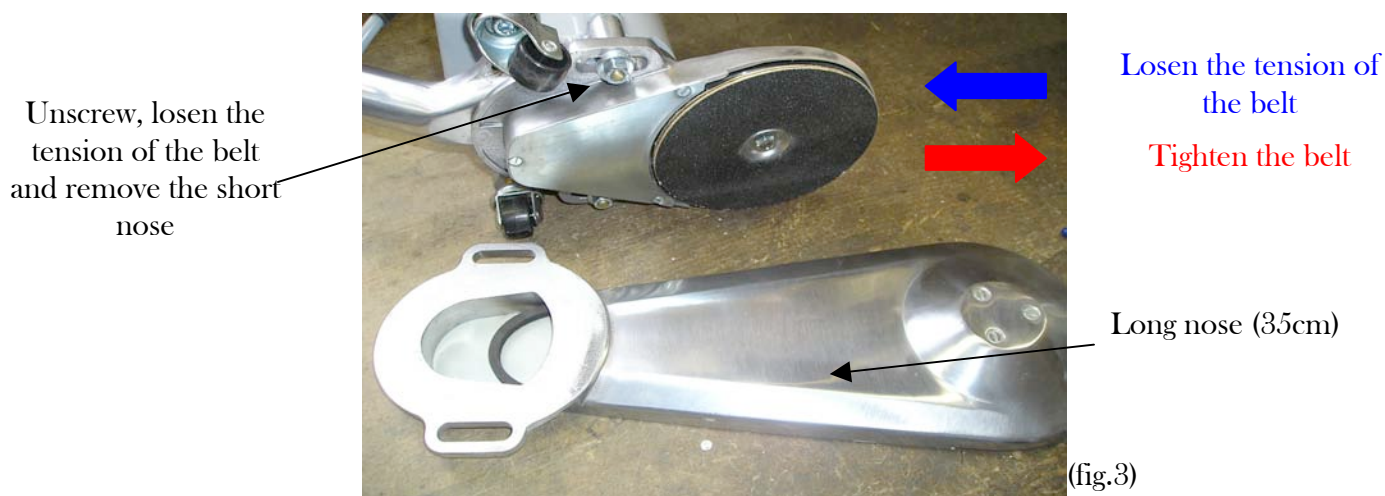

(fig.3)

# REPEX Floor

## 4.4 – Adjusting the wheels

The two wheels are easily removable for cleaning simply by unscrewing the gold (PAL) screw above each wheel.

The PAL screw is also used to adjust the wheels.

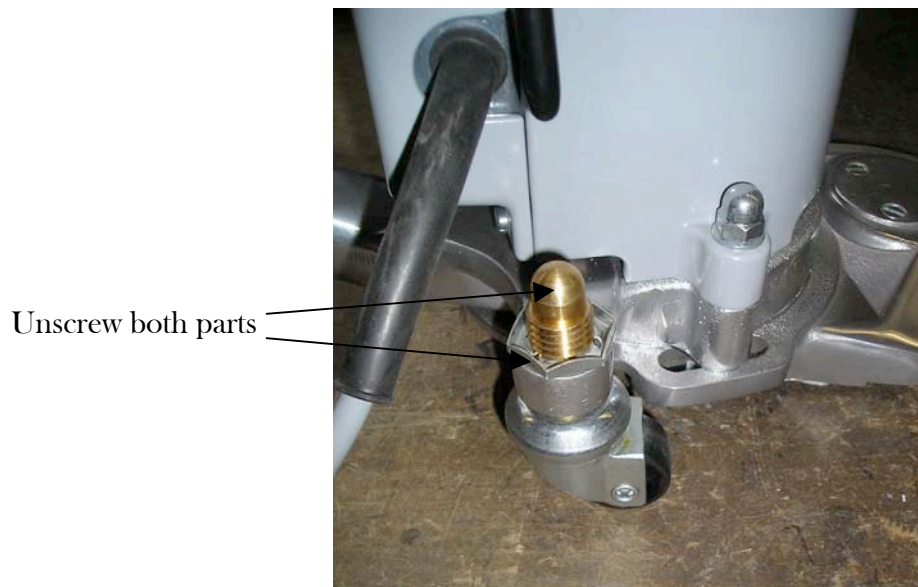

(fig.4)

### ➤ SAFETY WARNING :

- never make adjustments to the machine when the sanding disc is flat on the ground in order to avoid damage to the machine.
- Sand dust can seriously damage your health if inhaled.

## 5. Starting the machine

Starting the machine is very simple. Pull the black safety lever up about 90° so it's level with the grey handle. The machine will never work unless you have the safety lever in line with the handle.

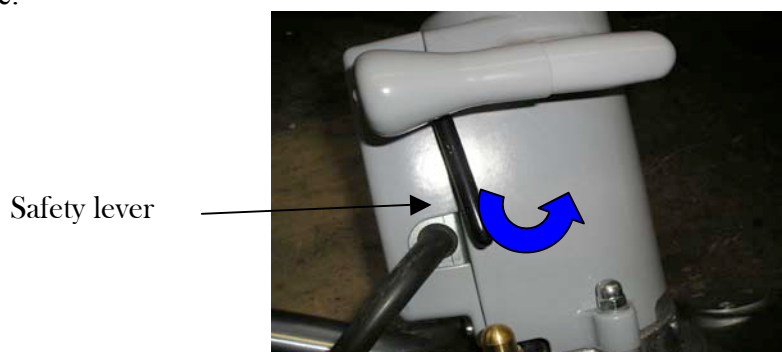

Bring the safety lever  
up so it is in line with  
the handle

picture.

fig 5 -As you see the machine is on stop mode in this

### ➤ SAFETY WARNING :



# ***REPEX Floor***

---

This machine must be checked regularly for faults or damage. If you have a problem with your machine, contact your supplier.

## **6. Service and maintenance**

### ***6.1 – Emptying the dust bag***

The dust bag must be emptied when it is at a maximum of 1/3 full.

Open the dust bag gently without applying any pressure in order to avoid a dust cloud.

### ***6.2 – Replacing the brushes***

The brushes must be changed after between 600-800 hours of use. Unscrew the 3 screws around the switch enclosure.

- Loosen 2 screws on the motor cover,
- Unscrew the nuts that fix the motor to the base,
- Lift the cover off and the two brushes are accessible,
- When you have refitted the brushes, gently blow away any excess dust on the motor.

### ***6.3 – Changing the belt***

To replace the belt, you must first take off the long or short nose (depending which one is attached) by unscrewing the 3 screws on top of the arm. The sanding disc will never be detached.

While the machine is dismantled, you have easy access to the wheels should they need oiling.

## **7. Maintenance queries**

For any questions on how to use this machine, or if you don't understand any of the instructions, please contact us at REPEX.

phone : 33 (0)1.46.80.03.92

Adresse email : [repex@wanadoo.fr](mailto:repex@wanadoo.fr)