

AIR45/50 Range

Weatherproof Colour/Mono IR Camera

USER MANUAL



CAUTION

1. This installation should be made by a qualified service person and should abide to all local codes.
2. In order to prevent electronic shock and/or destroy waterproof seals, do not loosen any screws on the camera body.
3. Adjust the sunshield cover to avoid exposure of direct sunlight on the lens.
4. Do not touch the front glass directly. If necessary, use a soft cloth moistened with alcohol to wipe off dust or debris.
5. Avoid installation on a surface subjected to frequent vibration or shocks.
6. Do not operate the camera beyond its temperature range or power source ratings.
7. Should any damage or suspected damage occur, shutdown the power source, unplug and contact your service provider.
8. Do not install the camera under unstable lighting conditions. Severe lighting change or flicker can cause the camera to work improperly.
9. Never use the camera close to a gas or oil leak.
10. Do not disassemble the camera.
11. Do not drop the camera or subject the unit to physical shocks. Never keep the camera face to strong light directly, this can damage the CCD.
12. Ensure all removable covers are replaced to protect the inner components.
13. Do not install near devices which emit a strong electro-magnetic field.
14. Use a dry or damp cloth only for cleaning.

PLEASE FOLLOW THE ABOVE CAUTIONS – FAILURE TO DO SO MAY INVALIDATE THE WARRANTY OR CAUSE SERIOUS INJURY

Remark: Changes or modifications not expressly approved by the manufacturer can cause the camera to be damaged and become inoperable. This may invalidate the user warranty.

The Concept Pro AIR45 / 50 range are weatherproof IR cameras, suitable for monitoring areas in hostile conditions and in low light.

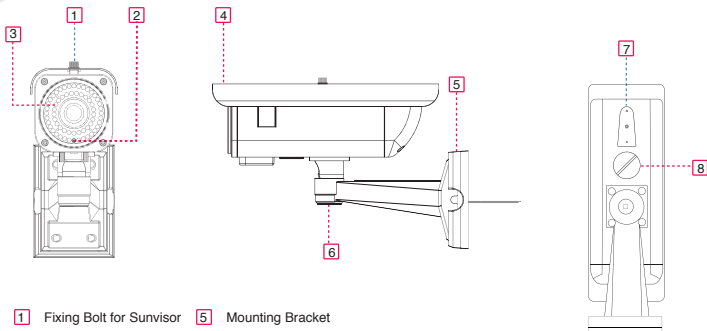

- | | |
|-----------------------------------|-----------------------------------|
| 1 Fixing Bolt for Sunvisor | 5 Mounting Bracket |
| 2 Photo Sensor | 6 Bracket Adjustment |
| 3 IR LED | 7 External Lens Adjustment |
| 4 Sunvisor | 8 Service Video Output |

PACKING CONTENTS



WALL SCREW

X4



FIXING PLATE

X1



FIXING PLATE
LOCATING SCREW

X2

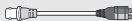

EASY FIT BNC CONNECTOR

X1



BRACKET/FIXING
PLATE SCREW

X4



LENS ADJUSTMENT
COVER SCREW

X1



ALLEN KEY

X1



EASY FIT POWER CONNECTOR

X1



LENS ADJUSTMENT
TOOL

X1



USER
MANUAL

X1



MOUNTING
DRAWING PAPER

X1



OSD CABLE

X1

INSTALLATION

Important: Ensure all cautionary procedures are observed during installation.

It is recommended the camera is tested during the most demanding environmental conditions such as low light or bright sunlight to ensure continuity of effective CCTV monitoring. You may find the use of an ND filter helpful.

Remove the camera unit carefully from the box, reserving the accessory contents in a safe place.

FIXING TO A WALL

- Use the supplied drill mounting template to mark the spacing for drilling.
- Following drilling, securely attach the bracket and camera to the wall.

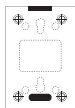
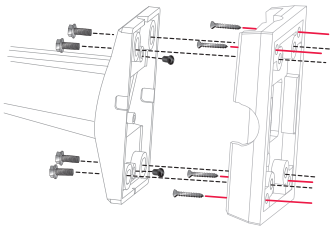
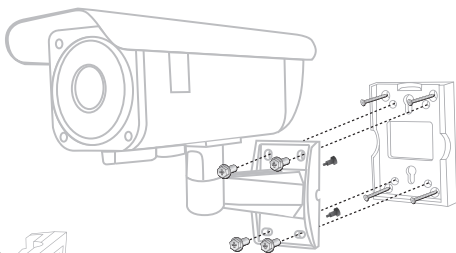

MOUNTING TEMPLATE

POSITIONING

Point the Camera towards the intended area to be monitored.

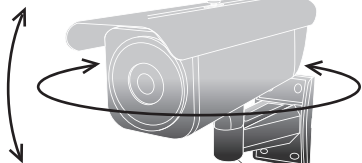

CONNECTION

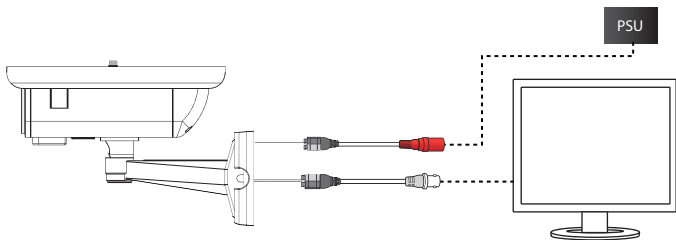
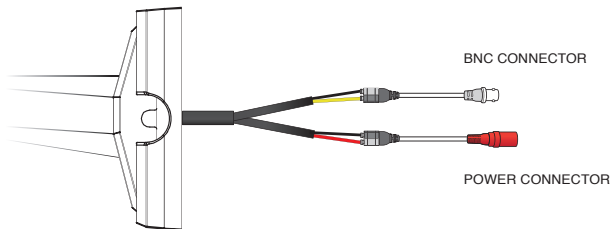

- Connect the video out port to your video cable running to the monitoring recorder.
- Check the power supply is of the correct level and connect your power supply into the power port on the Camera.
- View the picture on a monitoring device to check the power and video connection is working properly.

Troubleshooting

- Ensure all power and cable connections are correct with the Camera, DVR and Test monitor or Telemetry devices if used.
- Power Voltage Check - Remove the OSD cover to see if the green correct power LED is lit. If there red LED is lit the power voltage is too high. If the yellow LED is lit the power voltage is not high enough. If there are no LEDs lit there is no power getting to the camera
- If all power and cable connections are correct and the camera picture can not be produced or configured then contact your supplier for technical support.

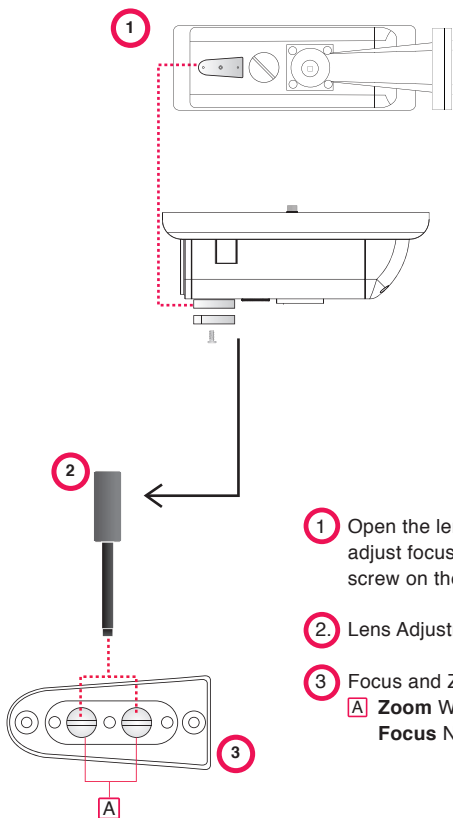

1 Open the lens adjuster cover and adjust focus and zoom. Loose the screw on the lens adjuster cover.

2. Lens Adjustment Tool

3 Focus and Zoom Adjustments
A **Zoom** Wide / Narrow
Focus Near / Far

DIMENSIONS

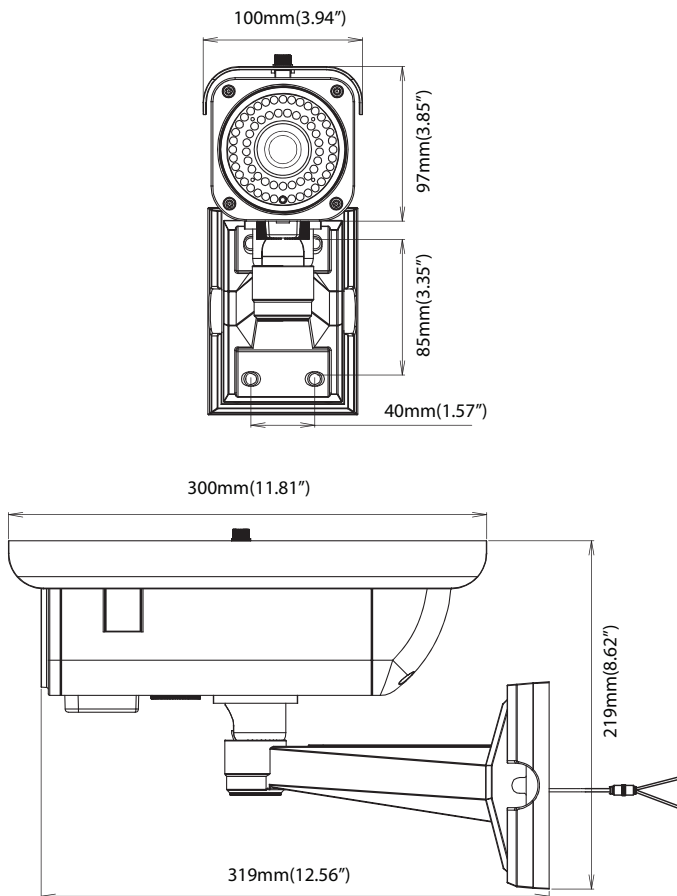

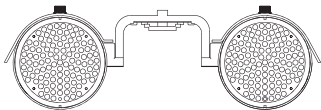

AIR-IR
IR LAMPS

Extend the IR range up to 80m with AIR-IR.

* Lens should be used at 6mm or above to achieve even illumination

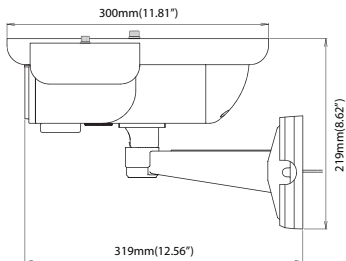
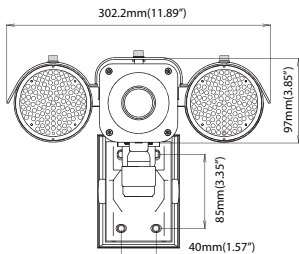
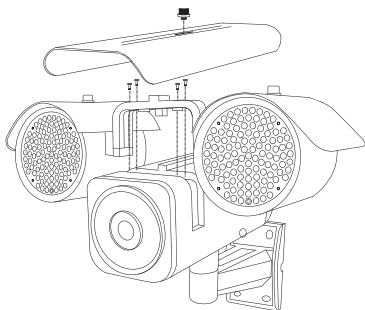
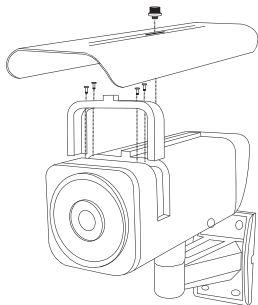

The Service Video Out panel contains a power indicator and test monitor connection for ease of adjusting the camera settings during installation.

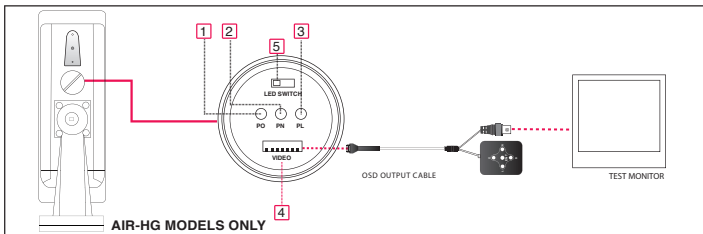

The power indicator LEDs display the power supply being fed into the camera and whether it is too high, low or correct.

1. "PO": Red LED - Voltage is too high
2. "PN": Green LED - Voltage is correct
3. "PL": Yellow LED - Voltage is too low
4. Extra video out and OSD Connector - Attach your Video test monitor with the service video cable enclosed in your camera box. The camera footage will appear on your test monitor and zoom/focus adjustments can be carried out as the installation requires.
5. LED Switch: Adjust LED switch to turn IR LEDs of main body on/off



OSD Controller

- 1) Press "U" to navigate upwards
- 2) Press "D" to navigate downwards
- 3) Press "L" to navigate left
- 4) Press "R" to navigate right
- 5) Press "ENT" to open menu/sub-menu

MAIN MENU

MAIN MENU	
1. LENS	MANUAL
2. EXPOSURE	↘
3. BACKLIGHT	OFF
4. WHITE BAL	ATW
5. DAY&NIGHT	EXT ↘
6. NR	↘
7. SPECIAL	↘
8. ADJUST	↘
9. EXIT	SAVE&END ↘

1 LENS	MANUAL / DC#
2 EXPOSURE	#
3 BACKLIGHT	OFF/BLC#/HSBLC#
4 WHITE BALANCE	ATW/AWB/AWC-SET/INDOOR /OUTDOOR/MANUAL#
5 DAY&NIGHT	AUTO#/COLOR/B/W#EXT#
6 NR	#
7 SPECIAL	#
8 ADJUST	#
9 EXIT	SAVE&END/#RESET#/NOT SAVE#

LENS

LENS MODE	
1. MODE	INDOOR
2. IRIS SPEED	MAXIMUM 8
3. RETURN	RET ↘

1 MODE	INDOOR/OUTDOOR#
2 IRIS	0-15
3 RETURN	RET#

EXPOSURE

SHUTTER	
1. SHUTTER	AUTO
2. AGC	MAXIMUM 7
3. SENS-UP	OFF ↘
4. BRIGHTNESS	MAXIMUM 50
5. D-WDR	OFF
6. DEFOF	OFF
7. RETURN	RET ↘

1 SHUTTER	AUTO/ 1/25 / 1/50 / FLK / 1/200 / 1/400 / 1/1000 / 1/2000 / 1/5000 / 1/10000 / 1/50000 / X2 / X4 / X6 / X8 / X10 / X15 / X20 / X25 / X30
2 AGC	0-15
3 SENS-UP	OFF/AUTO#
4 BRIGHTNESS	1-100
5 D-WDR	OFF/AUTO/#
6 DEFOF	OFF/AUTO
7 RETURN	RET#

DEFOG	
1. POS/SIZE	↘
2. GRADATION	MAXIMUM 0
3. DEFAULT	↘
4. RETURN	RET ↘

1 POS/SIZE	POSITION/SIZE/RET AGAIN
2 GRADUATION	0-2
3 DEFAULT	#
4 RETURN	RET#

BACKLIGHT

BLG	
1. LEVEL	MIDDLE
2. AREA	↗
3. DEFAULT	↗
4. RETURN	RET ↗

1 LEVEL	MIDDLE/LOW/HIGH
2 AREA	POSITION/SIZE/RET-AGAIN
3 DEFAULT	#
4 RETURN	RET#

DAY&NIGHT

D/N	
1 BURST	OFF
2 IR SMART	OFF
3 IR PWM	0-100
4 RETURN	RET ↗

1 BURST	OFF/ON
2 IR SMART	OFF/ON#
3 IR PWM	OFF/0-100
4 RETURN	RET#

DIA AUTO	
1 D--N(CDS)	0-255
2 D--N (DELAY)	0-60
3 N--D (CDS)	0-249
4 N--D (DELAY)	0-60
5. RETURN	RET ↗

1 D--N (CDS)	6-255
2 D--N (DELAY)	0-60
3 N--D(CDS)	0-249
4 N--D(DELAY)	0-60
5 RETURN	RET#

NR

NR	
1. 2DNR	MIDDLE
2. RETURN	RET ↗

1 2DNR	HIGH/MIDDLE/LOW/OFF
2 RETURN	RET#

SPECIAL

SPECIAL	
1. MENU STYLE	ON ↘
2. D-EFFECT	↘
3. MOTION	OFF
4. PRIVACY	OFF
5. LANGUAGE	ENG ↘
6. DEFECT	↘
7. RS485	↘
8. RETURN	RET ↘

D-EFFECT	
1. FREEZE	ON
2. MIRROR	XXXXXXXXXX 0
3. NEG. IMAGE	OFF
4. RETURN	RET ↘

DEFECT	
1. LIVE DPC	ON ↘
2. WHITE DPC	ON ↘
3. BLACK DPC	ON ↘
4. RETURN	RET ↘

1 CAM TITLE	OFF/ON#
2 D-EFFECT	FREEZE/MIRRORING/ NEG.IMAGE/RETURN
3 MOTION	OFF/ON#
4 PRIVACY	OFF/ON#
5 LANGUAGE	ENG#/CHN1#/CHN2#/GER#/ FRA#/ITA#/SPA#/POL#/ RUS#/POR#/NED#/TUR#
6 DEFECT	#
7 RS485	#
8 RETURN	RET#

1 FREEZE	OFF/ON
2 MIRROR	OFF/MIRROR/V-FLIP/ROTATE
3 NEG.IMAGE	OFF/ON
4 RETURN	RET#

1 LIVE DPC	OFF/AUTO#
2 WHITE DPC	OFF/MIRROR/V-FLIP/ROTATE
3 BLACK DPC	OFF/ON
4 RETURN	RET#

ADJUST

ADJUST	
1. SHARPNESS	AUTO ↘
2. MONITOR	LCD ↘
3. LSC	ON
4. VIDEO OUT	PAL
5. MONITOR OUT	4:3
6. COMET	OFF
7. RETURN	RET ↘

1 SHARPNESS	OFF/AUTO#
2 MONITOR	LCD#/CRT#
3 LSC	OFF/ON
4 VIDEO OUT	NTSC/PAL
5 MONITOR OUT	4:3/16:9
6 COMET	OFF
7 RETURN	RET#

EXIT

EXIT	
1. EXIT	RESET ↘

1 EXIT	SAVE&END#/RESET#/NOTSAVE#
--------	---------------------------

ITEM	AIR4526HGS
Type	Colour/Monochrome (Removable IR Cut Filter)
Signal System	PAL
Pick Up Device	1/3" Super DIS
Picture Elements	1280H×1024V
Resolution	1000TVL
Min Illumination	0Lux (60Pieces IR LED ON)
Vertical Frequency	50Hz
Horizontal Frequency	15.625KHz
Clock Frequency	6MHz
Scanning System	Progressive
S/N Ratio	≥52dB
Electronic Shutter	1/25-1/50,000s
Lens	3.5-8mm IR Varifocal Lens
White Balance	ATW
Back Light	OFF
Auto Gain Control	OFF
GAMMA	0.45
Video Out-put	1V p-p,75Ω
Power Supply	DC12V ±10%/AC24V±10%
Current Consumption	DC:620mA/AC380mA (Max)
IR Effect Distance	30~35m (98.4~114.8ft) (Outdoor)
Dimension	319x219x100mm
Weight	2.4Kg
Storage Temperature	-30°+60° (-22°+140°)
Operating Temperature	-30°+40° (-22°+104°)

Design and specification are subject to change without notice.

ITEM	AIR4527HGS	AIR5026HGS
Type	Colour/Monochrome (Removable IR Cut Filter)	
Signal System	PAL	
Pick Up Device	1/3" Super DIS	
Picture Elements	1280H×1024V	
Resolution	1000TVL	
Min Illumination	0Lux (60Pieces IR LED ON)	
Vertical Frequency	50Hz	
Horizontal Frequency	15.625KHz	
Clock Frequency	6MHz	
Scanning System	Progressive	
S/N Ratio	≥52dB	
Electronic Shutter	1/25-1/50,000s	
Lens	9-22mm Varifocal Auto iris IR Lens	6-50mm Varifocal Auto Iris IR Lens
White Balance	ATW	
Back Light	OFF	
Auto Gain Control	OFF	
GAMMA	0.45	
Video Out-put	1V p-p,75Ω	
Power Supply	DC12V ±10%/AC24V±10%	
Current Consumption	DC:770mA / AC:420mA (Max)	
IR Effect Distance	45~50m (Outdoor)	50~55m (Outdoor)
Dimension	319x219x100mm	
Weight	2.4Kg	
Storage Temperature	-30°+60° (-22°+140°)	
Operating Temperature	-30°+40° (-22°+104°)	

Design and specification are subject to change without notice.



AIR15 Range

18 IR LEDs

700TVL

3.6mm / 6mm Fixed Lens Options

182 x 70 x 81mm (WxHxD)



AIR30 Range

42 IR LEDs

Varifocal Lens Options

Service Video Output Option

On Screen Display Option

External Lens / Zoom Adjustments

202 x 85 x 118mm (WxHxD)

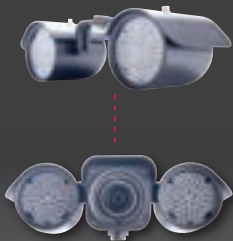

AIR-IR

It is possible to extend the IR range of the AIR 45/50 range with an easy to attach bolt-on twin IR lamp. The AIR-IR twin lamp allows the camera unit to view up to 80m.

Concept Pro

