

Type 1

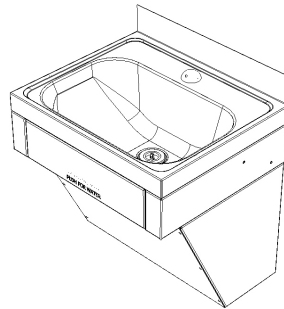

Type 2

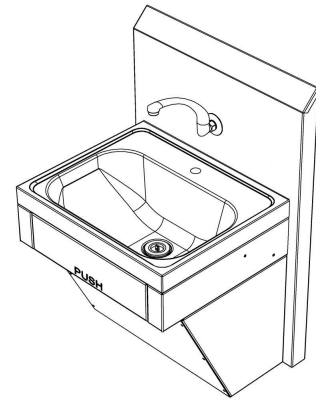

Type 3

Installation and Operation Manual for Stainless Steel Knee Operated Wash Basins

This manual is suitable for the following models:

Models:

Knee Operated Wash Basin

SPPL.WB.KO1

Knee Operated Basin – Type 1

SPPL.WB.KO1.300

Knee Operated Basin – Type 1 – 300mm Splashback

SPPL.WB.KO1.TV

Knee Operated Basin – Type 1 – Tempering Valve

SPPL.WB.KO1.300.TV

Knee Operated Basin – Type 1 – 300mm Splashback – Tempering Valve

SPPL.WB.KO1.300.TMV

Knee Operated Basin – Type 1 – 300mm Splashback – Thermostatic Mixing Valve

SPPL.WB.KO1.300.TMVE

Knee Operated Basin – Type 1 – 300mm Splashback – Thermostatic Mixing Valve (Enware)

SPPL.WB.KO2

Knee Operated Basin – Type 2

SPPL.WB.KO2.300

Knee Operated Basin – Type 2 – 300mm Splashback

SPPL.WB.KO2.TV

Knee Operated Basin – Type 2 – Tempering Valve

SPPL.WB.KO2.300.TV

Knee Operated Basin – Type 2 – 300mm Splashback – Tempering Valve

SPPL.WB.KO3

Knee Operated Basin – Type 3

SPPL.WB.KO3.TV

Knee Operated Basin – Type 3 – Tempering Valve

Please ensure this document is issued to the installing plumber.
For warranty to be valid, installation instructions must be followed.



CONTENTS

RECOMMENDATIONS.....	2
RESPONSIBILITIES.....	2
REFERENCED AUSTRALIAN STANDARDS	2
INSTALLATION OF KNEE OPERATED WASH BASINS.....	3
Water & Waste Requirements	3
Installation of Knee Operated Wash Basins	3
SAFETY PRECAUTIONS	3
TROUBLESHOOTING	3
SERVICING THE VALVE.....	4
SPARE PARTS.....	4
CLEANING INSTRUCTIONS	4
CUSTOMER INQUIRY	4

RECOMMENDATIONS

Upon receiving a Stoddart product, inspect immediately for any visible signs of shipping damage and notify the carrier immediately. When removing the product from its packing, be careful not to dent or scratch outer surface. Any concealed damage should be noted and reported immediately to the freight carrier. A claim should be filed with carrier if appropriate.

RESPONSIBILITIES

Stoddart thoroughly inspect all products they are despatched from our factory. Stoddart Manufacturing will not accept responsibility for shipping damage.

The Plumber is responsible to ensure that the system is installed in accordance with all specific requirements of local codes and regulations (including AS 3500). If questions or complications should arise during the installation of a Stoddart product that cannot be solved using the accompanying instructions, please contact our offices or local representatives.

Note: It is the Plumbers responsibility to install this product in accordance with AS3500.

REFERENCED AUSTRALIAN STANDARDS

Design	Design for access Design & fit out of Food Premises	AS 1428.1 – 2009 AS 4674 - 2004
Markings & Labels	Watermarked components must have Watermark logo and license. Copper alloy products marked 'DR'	AS 3500.1-2003 AS 5200.000 – 2006 Appendix B AS 6400 – 2005 Clause 2.4.6 AS 2345 - 2006
Dezincification resistance	Dezincification resistance applicable to copper alloy components in contact with mains water	AS 2345 - 2006
Contamination of water	Products For Use In Contact With Drinking Water	AS 4020 - 2005
Pipes and Fittings	Dimensional compliance with relevant or corresponding Australian Standard for the pipe or fitting	AS 3688 - 2005
Joints (i.e. Spigots, sockets, flanges, or other joint components, where interfacing other authorized components)	Dimensional compliance with relevant or corresponding Australian Standard for the pipe or fitting Pipe Threads of Whitworth Form. – Part 2 Fastening Pipe Threads	AS 3688 - 2005
Installation	Warranty / Installation instructions shall be provided by the manufacture	AS3500.2 - 2003

INSTALLATION OF KNEE OPERATED WASH BASINS

Water & Waste Requirements

- Flow pressure 300kPa – 500kPa.
- Max. static pressure 800 kPa.
- Min. supply connecting pipe size* 15 mm.
- Waste is 40mm. Trap provided by others.

*Pipe work to the valve fixture must be sized to and installed to water service rules and regulations (AS/NZS 3500.1 and local regulations). To ensure proper sizing of the pipe work it is recommended to engage a qualified hydraulic designer.

Installation of Knee Operated Wash Basins

All Stoddart basins are supplied with mounting holes pre-punched for easy installation.

- Remove the packing from the wash basin and check for damage.
- Remove access panel.
- Unscrew the screws on either side of the basin to remove the removable galvanised bracket from the basin.
- Place the bracket at desired height and mark the locations of screw holes and/or outline around the bracket if adhesive is being used, making sure bracket is level.
- Ensure the water supply and waste are in the zone marked in the image to the right, and the waste is approximately 673.85mm above FFL (for 900mm basin height).
- Attach bracket to the wall with sufficient load bearing fasteners.
- Slide the wash basin on to the bracket & replace the screws on either side of basin.
- Ensure water lines have been thoroughly flushed before connecting to valve.
- Connect supply to valve inlet.
- Replace access panel (KO2 & KO3).
- Clean stainless steel surfaces.

Note: Protect the product at all times by wrapping in plastic until all other work is complete.

Note: Warranty does not cover dirt in valves – install a line strainer/ filter to protect the valve.

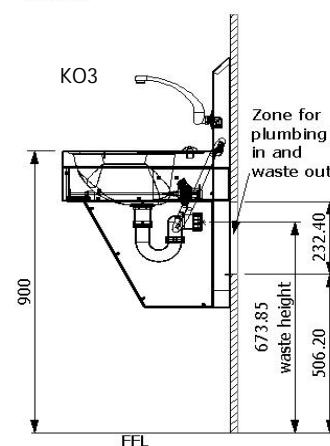
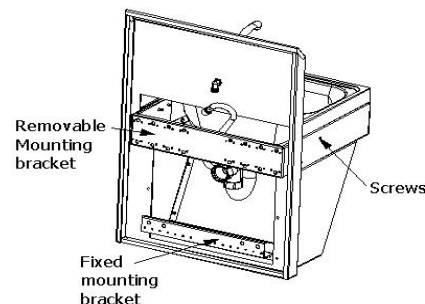

SAFETY PRECAUTIONS

- For the installation and operation observe all relevant electrical, plumbing and building standards.

TROUBLESHOOTING

Water does not switch off or water continues to run from outlet after timed out.

- Check Front panel has some free play; Make sure there is a 2mm gap between push rod and push panel. (valve must be able to travel freely to fully close) – if not adjust push rod.
- Check that a line strainer or filter is installed & is clean.
 - If a line strainer is installed, & has contaminants present – could some have got through to valve seat? Check Valve Cartridge.
 - If a Line strainer is not installed, check for dirt and grit in valve cartridge.
- If above checked out o.k. contact service.

Note: cartridge is a service part & not covered by warranty if damaged by dirt in water. Stoddart Recommend Customers install a line strainer/ filter to protect the valve.

Water runs for too short or too long.

AS4676 requires min. 15 seconds for hand washing. CMPL.0647 is designed to run 15 – 30 secs.

- Make sure there is a 2mm gap between push rod and push panel & rod slides freely.
 - If gap is too big, valve might not get pushed in fully giving short cycle.
 - If rod doesn't slide freely, it may cause the valve to take longer to time out.
- Check position of circlip on valve spindle; inner = short, outer = long.
- Check water pressure; low water pressure = longer time.
- Check ¼ turn stop-valve in inlet of valve. Partially closed may slow time

Water flow from outlet is too little;

- Check supply pressure and stopcocks are open.
- Check lines are not flattened or kinked.

Water leaks onto floor under basin;

- Check plumbing connections – tighten as required.
- Check seal between spout and basin – replace seal or apply silicon sealant.
- Check valve spindle (valve stem seal) – replace faulty cartridge.

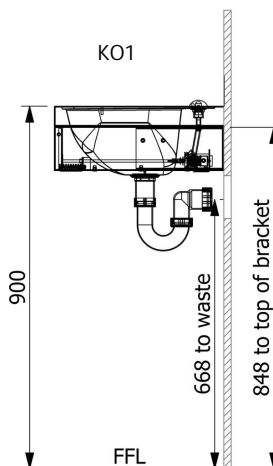

SERVICING THE VALVE

- 1) Remove Circlip; 2) Unscrew pushrod, 3) press in the valve & remove the push rod. 4) Turn the stop cock off (quarter turn in supply side of valve). 5) Unscrew the valve cartridge out of the front of the valve body.



- Inspect the valve seat. If dirty, identify source of contamination, clean the cartridge and the valve body. Apply a thin smear of food grade grease to the sealing surfaces & re-install. If sealing surfaces are damaged, replace the cartridge. Warranty does not cover dirt in valves – install a line strainer/ filter to protect the valve.



SPARE PARTS

Article No	Description
CMPL-0255	Waste and Plug
CMPL-0352	Valve Housing (complete)
CMPL-0647	Valve Cartridge (15 – 30 seconds) fitted as Standard.
CMPL-0353	Valve Cartridge (5 – 7 seconds) alternative spare part.
CMGE.0510	Spring for Push Basin front panel.
CMPL.0025	Braided Hose; 300mm
CMPL.0413	Gooseneck Spout used in SPPL.WB.KO1
CMPL.0438	Domed SS Bubbler used in SPPL.WB.KO2
CMPL-0464	Wall Spout used in SPPL.WB.KO3

CLEANING INSTRUCTIONS

All surfaces of the product should be cleaned with mild soap and water or a neutral product. Carefully rinse away all surplus cleaning product.

IMPORTANT: Never use harsh or abrasive cleaners on stainless steel. Do not use chlorinated or bleach water

CUSTOMER INQUIRY

All customer inquiries regarding Stoddart Stainless Steel Wash Basin's should be referred to:

Customer Service Department
Stoddart Manufacturing
39 Faisal Hatia Way
Karawatha 4117
Brisbane Queensland Australia.
Ph +61 7 3440 7602
Fax +61 7 3344 1000
Email: plumbing@stoddart.com.au
Web: www.stoddart.com.au