

IN-SR LowDown Stay Installation Instructions

RV-INNO

The IN-SR Stays include the parts shown below. Verify that all of these parts are included in the package you have purchased. In the event any of these parts is missing, contact ORS RACKS DIRECT / 1-800-894-7547. Other parts, such as bars and attachments are sold separately, unless you are buying a complete system.

| No. | Contents | Qty |
|-----|---------------|--------------|
| ① | Stay | 4 |
| ② | Holder | 4 |
| ③ | Rubber Pad | 4 |
| ④ | Knob | 4 |
| ⑤ | Washer | 4 |
| ⑥ | Hex Wrench | 1 |
| ⑦ | Key | 2 |
| ⑧ | User's Manual | 1 |
| ⑨ | Bars | Not Included |

1 Clean the roof of your car to remove any dirt or debris. Release lock with key and remove lock cover.

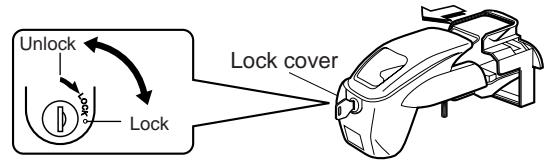

2 Slide washer over stay bolt and loosely tighten knob until bolt end extends 2-3mm past end of bolt.

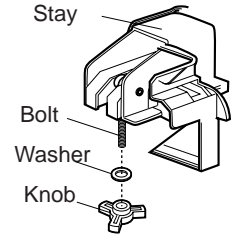
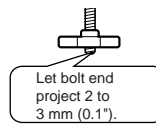

3 Hook holder onto barrel nut on stay. Slide notch of holder over bolt and place holder on washer. Assemble all 4 stays in the same way.

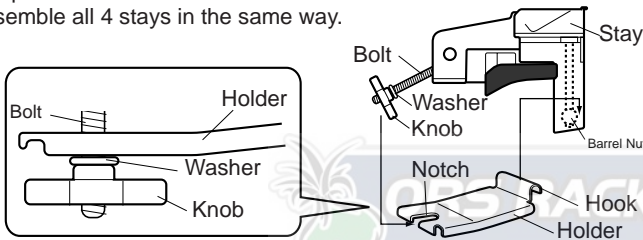

Mounting the Carrier on the Car

4 Place bars on right and left roof rails perpendicular to moving direction of car. The side of the bar with the 8 grooves should face

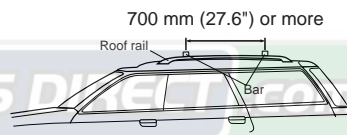

CAUTION
Set distance between front and rear bars to 700 mm (27.6") or more, whenever possible. Minimum safe spread is 600mm (23.6")

5 Slide stay over bar and remove bolt from holder.

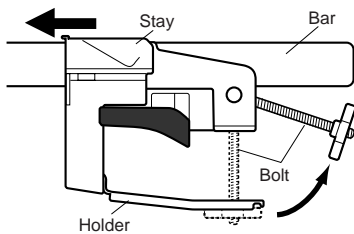

6 Rest stay on rail. Holder should be positioned under rail.

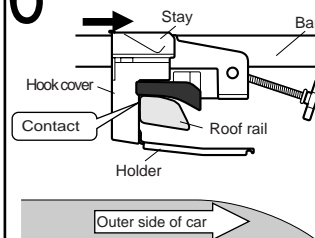

CAUTION
Stay bolt should face outer side of car.

CAUTION
Hook cover must contact roof rail.

7 Slide notch of holder over bolt and place holder on washer.

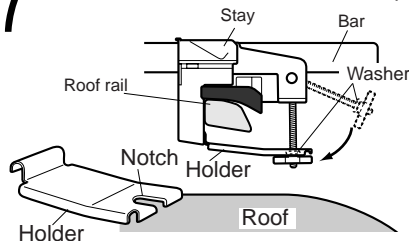

Note
For some vehicles with fatter rails, it may be necessary to completely remove knob and washer and reinstall them once bolt is positioned in notch of holder.

8 While pressing stay down onto roof rail, lift holder until it is parallel with either the bottom of roof rail or bar.

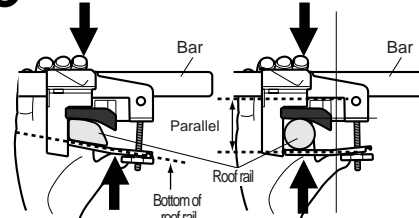

Note
If roof rail has round bottom, holder should be parallel to bar.

9 While lifting holder, tighten the 2 barrel-nut bolts alternately with hex wrench to adjust holder angle. Loosely tighten knob.

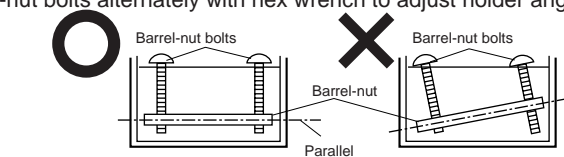
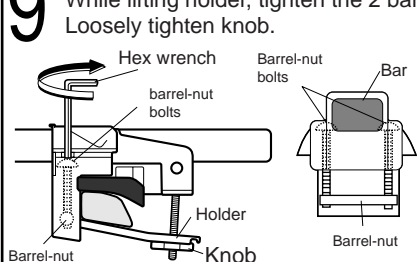

CAUTION
Confirm that holder is securely engaged on barrel nut.

10 Adjust bar position again.

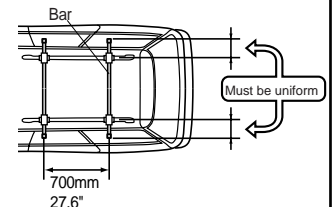

11 Align centers of holder and stay.

Note
Misaligned holder and stay may prevent installation of lock cover.

Labels: Stay, Bolt, Roof rail, Holder, Knob, Centers, Holder center, Stay center.

12 Tighten knob.

Note
Lock cover cannot be installed if bolt end is not projecting from knob. Lower barrel-nut with hex wrench and tighten knob further.

Labels: Knob, Lock cover won't fit properly due to knob, Down view, Knob, Holder.

13 Install bar end caps on both ends of bar.

Label: End cap.

14 Install lock cover.

Note
If lock cover doesn't fit properly, check knob or holder position.

Label: Lock cover.

15 Lock key.

Note
If key doesn't lock, check the following:
- Is knob preventing cover from sliding on all the way?
- Is holder contacting lock cover?

Labels: Key, Lock.

16 Check to make sure that carrier system is installed properly and securely.

CAUTION
Before driving the vehicle, rock the stays and bars in the all directions to ensure that there is no looseness in any of the mounting knobs. Retighten any loose knobs.

17 When mounting attachments straddling the stays, attach one of the included rubber pads on the contact surface of the stay for protection.

CAUTION
Boat & canoe attachments cannot be installed.

Labels: Rubber sheet, Attachment, Stay.

Genuine RV-Inno Replacement Parts

The following genuine replacement parts are available for this RV-Inno carrier system component. Specify the part number when ordering parts from your dealer.

Note

Specifications and appearance of the carrier system and genuine replacement parts are subject to change without prior notice in the interest of product improvement.

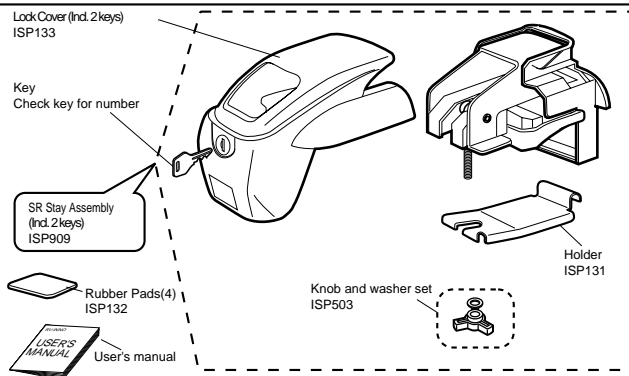

Contact Information

If you have any comments or suggestions, please contact ORS RACKS DIRECT / www.orsracksdirect.com / 1-800-894-7547. ORS Racks Direct shall not be held liable for any accidents or incidental losses arising from improper installation or use, nor for those arising from installation or use after the customer has made any change to the system's original configuration or specifications.

Guidelines for Using the Carrier System

Before using your new Carrier System, carefully read these guidelines as well as the installation and usage instructions for all the components that make up your system.

After reading these guidelines, keep them in a safe place with the instructions for the rest of the system.

If you have any questions regarding the information in this manual, please contact the service center listed in the installation instructions.

⚠ Precautions

| | | |
|--|--|---|
| | <p>The carrier system's compatibility with an automobile is determined by the type of stay used. Certain vehicles require the use of a carrier base and mounting hooks. Be sure to consult the FIT GUIDE, which is available at your dealer or online.</p> | <p>Other manufacturer's attachment</p> <p>While other companies' attachments may fit our crossbars, we can only guarantee the safe performance of our rack when used with RV-Inno attachments.</p> |
| | <p>The mounting position, loadable cargo and maximum carrier capacity vary by vehicle type. Be sure to read "Mounting Methods by Vehicle Type" in the Installation Instructions for the Mounting Hooks.</p> | <p>When using the Carrier System, avoid driving at excessively high speeds. Do not make hard starts, unnecessarily sharp turns, abrupt maneuvers or emergency braking. In case you have to perform such a maneuver, always check afterwards to see that the carrier system and cargo remain secure.</p> |
| | <p>Do not attempt to modify the carrier system.</p> | <p>Always check to see that the carrier and cargo are secured in place after driving continuously at high speeds, in adverse weather conditions, or when driving over rough roads.</p> |
| | <p>Always use the key lock to secure the carrier. The locks are an extra safety measure preventing the racks from coming loose.</p> | <p>Check the fastening knobs and bolts, width-adjustment screws and any other mounting hardware on a periodic basis to see that they are securely tightened.</p> |
| | <p>Exercise caution when opening or closing the sunroof, hatch or tailgate. Failure to do so may cause the sunroof, hatch, gate or rear spoiler to hit the carrier and/or cargo.</p> | <p>Always remove the carrier system before running your car through a car wash.</p> |
| | <p>Do not concentrate the cargo in one area. Doing so may damage the carrier and/or cargo.</p> | <p>Mount the carrier system to your vehicle in a well-lit, open space on flat, stable ground.</p> |

Care and Storage

- 1** Wash any mud off the carrier system. Use a damp towel to wipe away dust and dirt. Do not use any thinner or solvents to clean any part of the carrier system - use only mild soap or detergent if necessary.
- 2** After cleaning carrier, check for any of the following:
 - 1) Worn screw threads
 - 2) Key deformation
 - 3) Holder deformation
 - 4) Cracks in any of the components of the carrier system.
- 3** Store all components of the carrier system together in one place to prevent any component from being lost. Avoid storage in areas subject to direct sunlight, high temperature or excessive humidity.