

## User's Manual

---

# PAL42BWF

42 Bottle Wine Cooler

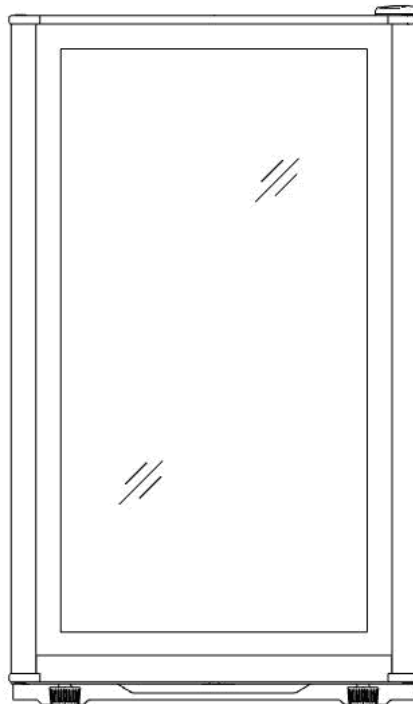



This appliance is intended to be used exclusively for the storage of wine.

## I . GENERAL

PAL42BWF is extensively used in places such as hotels, offices and house. It is mostly suitable for conserving red wine, white wine and champagne. It enjoys the advantages of small size, light weight, high efficiency and low energy consumption.

## II .UNPACKING, REPACKING AND MOVING

### 1.Unpacking

Just cut off the packing band, then pull the carton up.

### 2. Repacking

Please remember to put the original foamed pads in place.

### 3. Moving

Be sure electric wine cellar stays in upright position during moving it.

Do not tilt it for more than 45° from upright. Never upset it.

Do not apply force on any external part such as pipe, condenser, door and its handle for moving, electric wine cellar must be well packed and secured in long distance transportation to avoid damage from impacting and or great rocking.

## III. INSTALLATION

The electric wine cellar should be placed on a flat and solid-top surface. It should be kept away from sunlight, heat source, humid or mess place. The electric wine cellar should be kept away from the wall for a proper space for good air circulation. When the electric wine cellar is placed in a cupboard, the rear of the cupboard must be removed out for good circulation. For good ventilation keep enough space between the side walls and your fridge. Its back needs to be at least 100mm away from the wall, its sides at least 100mm separately and the height from over its top is not less than 200mm. A clear space should be left to open the door to 160° .

This fridge can be opened either from the left or right side. The default way of opening the door is from the right side. If you want to open the door from the left side, please follow the instructions below.

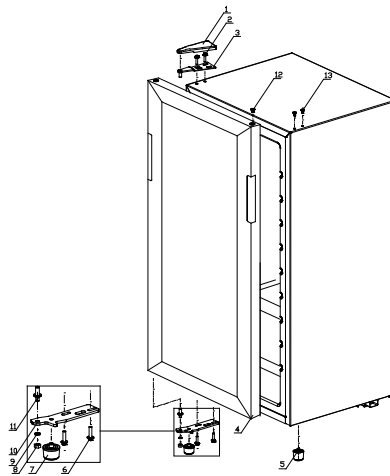
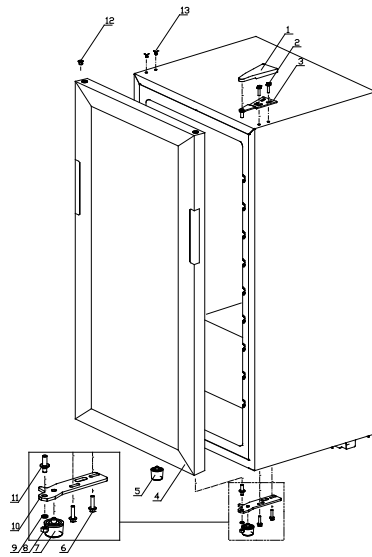

1. Upper hinge cover    2. Screw    3. Upper hinge    4. Door    5. Adjustable leg  
 6. Screw    7. Adjustable leg    8. Nut    9. Washer    10. Lower door hinge    11. Pin  
 12. Pin cap    13. Hole cover

1. Remove the upper hinge cover(1), remove the screws(2) and the upper hinge(3), keep the hinge for later use.
2. Remove the door(4) from the upper hinge(3), and keep the padded surface upwards to prevent the scratching.
3. Remove the screws(6) that hold the lower door hinge(10), then remove the pin(11) from the lower door hinge, keep the hinge for later used.
4. Insert the pin(11) previously moved from the right side and transfer it into the other hole at the left lower side of the door.
5. Insert the lower door hinge(5) in the left lower side, fix the lower hinge on the cabinet by tightening the screws. (Showing the assembly instruction of the low hinge with the door opening at the right side & left side as below)



Hinge on the left side



Hinge on the right side

6. Remove the hole cover(13), and transfer it to the same location on the opposite side.
7. Remove the pin cap(12) from the left side of the upper frame of the door, and then transfer it to the same location on the opposite side.
8. Put the door on the lower door hinge(10), keep the door level, then fix door on the cabinet by the upper hinge(3), then fasten the screws.
10. Put the upper hinge cover(1) on the hinge(3).

#### IV. TEMPERATURE SETTINGS

- (1) When pressing ▲ ▼ at the same time, the temperature will be changed to show in °C or °F.
- (2) Pressing 'LAMP' can turn on or turn off the LED.
- (3) Temperature can be adjusted by pressing ▲ or ▼, temperature can be set between 7°C and 18°C(45°F~65°F).
- (4) When the temperature be set at 7°C~9°C(45°F~49°F), the Yellow light next to 'CHAMPAGNE' will become bright; When the temperature be set at 10°C~15°C(50°F~59°F), the Green light next to 'WHITE WINE' will become bright; When the temperature be set at 16°C~18°C(60°F~65°F), the Red light next to 'RED WINE' will become bright.
- (5) The thermostat can detect temperature between 0°C and 37°C(32°F~99°F) and display the cabinet's temperature in temperature zone, if the cabinet's temperature is lower than 0°C(32°F), 'LL' will be shown; if the cabinet's temperature is higher than 37°C(99°F), 'HH' will be shown; if there is something wrong with the thermostat 'F1' will be shown.

#### VI: CLEANING AND MAINTENANCE

1. To clean the electric wine cellar, disconnect power supply and remove foods, shelves, trays etc. Use a solution mixed with 2 spoons of baking soda per litre of warm water to clean the interior. Then wipe it clean with fresh water.  
Never use acids, chemical thinner, gasoline, benzene or the like for cleaning any part of the electric wine cellar.  
Never use oiling water and benzene to clean plastic parts because they may deform or damage the plastic parts.
2. Too much wines or a too large container in the electric wine cellar will affect cold air circulation, so some free space must be left. Do not store volatile and or explosive materials such as ethers, gasoline, liquefied petroleum gas, adhesives etc. in the electric wine cellar. Otherwise there will be a danger of explosion caused by electric sparks.

#### VII. SAFETY INSTRUCTIONS

Before plugging your electric wine cellar in check that the electric supply in your house must comply with the rating (voltage, frequency) of the electric wine cellar, the rating plate is usually on the back of the electric wine cellar. The electric wine cellar should always be plugged in its own individual electrical outlet to prevent overload, which could cause a possible fire hazard from overheating wires. Do not splash water on the electric wine cellar as this will cause electrical leakage or failure. If the power cord becomes damaged, ask on electrician to replace it immediately. The electric wine cellar must be properly earthed.

Our corporation is not responsible for any accident caused by improper earthing or improper operation.

Any repairs and work on the appliance should only be carried out by the customer service department, as unauthorized work could prove highly dangerous for the user.

Do not store explosives or sprays using combustible propellants such as butane, propane, pentane etc. In the appliance. Electrical components might cause leaking gas to ignite. You may identify such sprays by the printed contents or a flame symbol.

Do not allow naked flames or ignition sources to enter the appliance.

Do not use steam cleaners for defrosting and cleaning.

Do not use mechanical devices or the other means to accelerate the defrosting process, other than those recommended by the manufacturer.

Do not damage the refrigerant circuit.

Do not use electrical appliance inside the food storage compartments of appliance, unless they are of type recommended by the manufacturer.

If the supply cord is damaged, it must be replaced by the manufacturer or its service agent or a similarly qualified person in order to avoid a hazard.

The appliance must be positioned so that the plug is accessible.

The appliance is not intended for use by young children or infirm persons without supervision.

Young children should be supervised to ensure that they do not play with the appliance.

If the supply cord is damaged, it must be replaced by a special cord or assembly available from the manufacturer or its service agent.

The appliance is not intended for use by persons (including children) with reduced physical, sensory or mental capabilities, or lack of experience and knowledge, unless they have been given supervision or instruction concerning use of the appliance by a person responsible for their safety.

**Warning:** Keep ventilation openings, in the appliance enclosure or in the built-in structure, clear of obstruction.

**Warning:** Do not use mechanical devices other means to accelerate the defrosting process, other than those recommended by the manufacturer.

**Warning:** Do not damage the refrigerant circuit.

**Warning:** Do not use electrical appliance inside the food storage compartment of the appliance, unless they are of the type recommended by the manufacturer.

#### VIII. SPECIFICATIONS

##### PAL42BWF

- |                     |          |
|---------------------|----------|
| 1. Input power:     | 100W     |
| 2. Rated current:   | 0.6A     |
| 3. Rated voltage:   | 220~240V |
| 4. Rated frequency: | 50Hz     |
| 5. Capacity:        | 126L     |

Note: Specifications subject to change without notice.

#### IX. SERVICE

If the electric wine cellar is not functioning properly, check that:

1. When the electric wine cellar does not operate:

- the power plug is firmly in the wall outlet.
- the mains power switch is off.
- the fuse is not burned out.

2. When the electric wine cellar does not cool enough:

- the thermostat is at the correct setting, there are too frequent and too long door openings.

3. When the electric wine cellar operates too noisily:

- the electric wine cellar is not touching furniture that can transmit or amplify a noise or a vibration.
- the electric wine cellar properly leveled.
- the wines stored inside are not touching each other.
- the mains supply is stable.

If your electric wine cellar is still not functioning properly after making the above checks, please contact the sale dealer immediately.

Note: During the period of high humidity, moisture may form on the outside of the electric wine cellar, it is not unusual. You may just wipe it up yourself.

#### X. Old appliances

The cabinet of appliance is formed by cyclopentane or R141b. old appliances contain harmful materials and should be disposed of with bulk refuse.

1. Remove the spring-action or bolt catch from the appliance or render it unusable so that children cannot become trapped inside and suffocate.
2. Ensure that the refrigerant circuit is not damaged before the appliance that is no longer needed is taken away for disposal. In this way the refrigerant will not escape into the environment.

Note: If the refrigerant is R600a, do not let the appliance near any fire source as the R600a gas is flammable.

Information concerning the refrigerant and insulating materials used can be found on the type plate and disposal instructions on the appliance.

Information on collection dates or collection points can be obtained from the waste disposal authorities or your local council.

# **Palsonic**

**The AUSTRALIAN Company**

Palsonic Customer Service  
Telephone (Australia) 1300 657 888

Palsonic Corporation Pty Ltd ABN 34 000 474 108  
1 Joynton Avenue, Waterloo NSW 2017 Australia

Telephone (02) 9313 7111 Facsimile (02) 9697 0655  
[www.palsonic.com.au](http://www.palsonic.com.au)