

Register your product and get support at

[www.philips.com/welcome](http://www.philips.com/welcome)

HP4638



**PHILIPS**

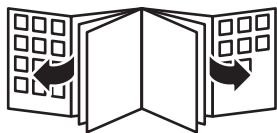

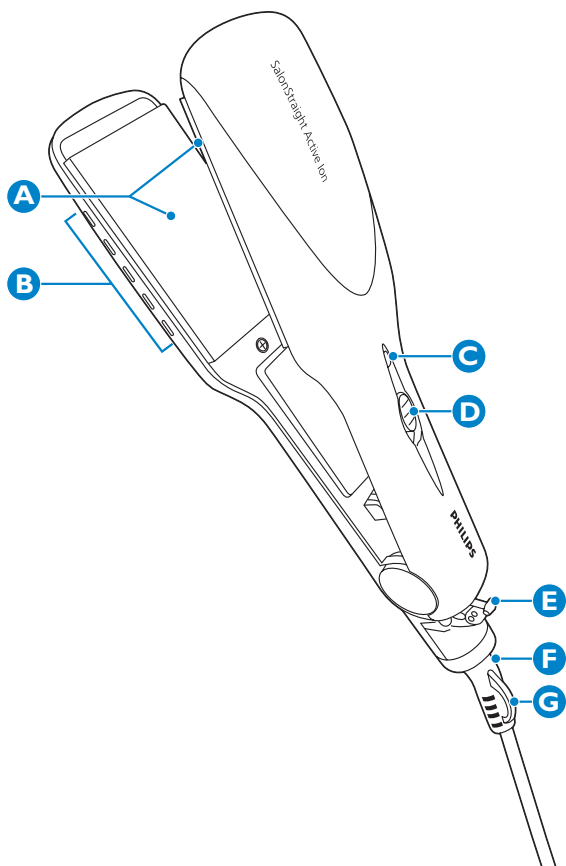



<b>ENGLISH</b>	<b>6</b>
<b>БЪЛГАРСКИ</b>	<b>12</b>
<b>ČEŠTINA</b>	<b>19</b>
<b>EESTI</b>	<b>25</b>
<b>HRVATSKI</b>	<b>31</b>
<b>MAGYAR</b>	<b>37</b>
<b>ҚАЗАҚША</b>	<b>43</b>
<b>LIETUVIŠKAI</b>	<b>50</b>
<b>LATVIEŠU</b>	<b>56</b>
<b>POLSKI</b>	<b>62</b>
<b>ROMÂNĂ</b>	<b>69</b>
<b>РУССКИЙ</b>	<b>76</b>
<b>SLOVENSKY</b>	<b>83</b>
<b>SLOVENŠČINA</b>	<b>90</b>
<b>SRPSKI</b>	<b>96</b>
<b>УКРАЇНСЬКА</b>	<b>102</b>

## Introduction

The new Philips SalonStraight Active Ion provides super-shiny straightening results. The ioniser generates streams of negative ions that surround and condition your hair. Ions reduce frizz and static electricity and leave your hair looking soft, smooth and shiny.

## General description (Fig. 1)

- A** Ceramic-coated plates
- B** Ion outlet openings
- C** Power-on light
- D** On/off slide
- E** Closing lock
- F** Swivel cord
- G** Hanging loop

## Important

Read this user manual carefully before you use the appliance and save it for future reference.

### Danger

- Keep the appliance away from water. Do not use it near or over water contained in baths, washbasins, sinks etc. When you use the appliance in a bathroom, unplug it after use. The proximity of water presents a risk, even when the appliance is switched off.

### Warning

- Check if the voltage indicated on the appliance corresponds to the local mains voltage before you connect the appliance.
- Check the condition of the mains cord regularly. Do not use the appliance if the plug, the mains cord or the appliance itself is damaged.
- If the mains cord is damaged, you must have it replaced by Philips, a service centre authorised by Philips or similarly qualified persons in order to avoid a hazard.
- This appliance is not intended for use by persons (including children) with reduced physical, sensory or mental capabilities, or lack of experience and knowledge, unless they have been given supervision

or instruction concerning use of the appliance by a person responsible for their safety.

- Children should be supervised to ensure that they do not play with the appliance.
- Keep the appliance away from non-heat-resistant surfaces and never cover the appliance with anything (e.g. a towel or clothing) when it is hot.
- Keep the appliance away from flammable items.
- Never leave the appliance unattended when it is plugged in.
- Always return the appliance to a service centre authorised by Philips for examination or repair. Repair by unqualified people could cause an extremely hazardous situation for the user.

### **Caution**

- For additional protection, we advise you to install a residual current device (RCD) in the electrical circuit that supplies the bathroom. This RCD must have a rated residual operating current not higher than 30mA. Ask your installer for advice.
- The straightening plates and the plastic parts near the plates reach a high temperature quickly. Prevent the hot surfaces of the appliance from coming into contact with your skin.
- You may notice a characteristic odour when using this straightener. This is caused by the ions that are generated and it is not harmful to the human body.
- Do not probe the ion outlet openings with metal objects.
- Do not use the appliance on artificial hair.
- Only use the appliance on dry or damp hair.
- Do not leave the plates in your hair for more than a few seconds at a time as this may cause damage to your hair.
- Always unplug the appliance after use.
- Do not wind the mains cord round the appliance.
- Wait until the appliance has cooled down before you store it.
- Keep the straightening plates clean and free of dust, dirt and styling products such as mousse, spray and gel. Dust, dirt and styling products may cause damage to the ceramic-coated straightening plates.

- The ceramic coating on the plates slowly wears away over time. This does not affect the performance of the appliance.
- If you use the appliance on colour-treated hair, the straightening plates may stain.
- The maximum temperature occurs just after heating up. The actual temperature during use may be lower.

### **Electromagnetic fields (EMF)**

This Philips appliance complies with all standards regarding electromagnetic fields (EMF). If handled properly and according to the instructions in this user manual, the appliance is safe to use based on scientific evidence available today.

## **Preparing for use**

### **Washing your hair**

---

Everybody wants shiny and beautiful hair. A good hair-washing routine can help to achieve this.

- 1** Wet your hair thoroughly for 30-60 seconds.
- 2** Pour some shampoo into the palm of your hand. Spread it between your hands and distribute it evenly through the hair.
- 3** Gently massage your hair and scalp. Do not rough up the hair or pull up long hair onto the scalp, as this may cause tangles.
- 4** Massage your scalp with your fingertips. This stimulates blood circulation and is gentler to the hair cuticles.
- 5** Rinse your hair thoroughly, as poor rinsing can result in dull hair. Finish with a cold rinse for extra shine.

### **Drying your hair**

---

To get super-smooth results, it is essential to prepare your hair for straightening. Dry your hair with a hairdryer until it is dry or almost dry to ensure a professional, smooth finish.



- 1 After washing, squeeze excess water out of the hair with your hands and then towel-dry the hair. Use a comb to disentangle the hair gently from the roots to the tips.
- 2 Divide the hair into sections using clips. Start at the back.
- 3 To dry each section, pull a straightening brush down the hair length. Follow the brush with the hairdryer, with its nozzle pointing towards the hair ends.
- 4 When you have finished drying each section, set the hairdryer to the cool setting for a final cool shot. This closes the cuticles and adds shine to the hair.

*Tip: Philips SalonPro hairdryers have a lower drying temperature and a stronger airflow than regular dryers. Thanks to this combination, they dry just as quickly as regular hairdryers but in a gentler way*

## Using the appliance

### Straightening your hair

---

Straighteners are powerful styling tools and must always be used with care.

As with all straighteners that reach salon-high temperatures, do not use the appliance frequently to avoid damage to the hair. If you use the straightener incorrectly, you could overheat your hair or even burn it. Always follow the steps below:

- 1 Put the plug in the wall socket.
- 2 Push the on/off slide to 'ON'.
  - ▶ The power-on light goes on (Fig. 2).
  - ▶ The straightening plates heat up rapidly and are ready for use within 90 seconds.

Never leave the appliance unattended when it is plugged in. Never put the appliance on a surface that is not heat-resistant when it is heating up and when it is hot.

*Tip: If you lock the plates with the closing lock, the straightener heats up more quickly.*

- 3** Comb or brush your hair so that it is disentangled and smooth. (Fig. 3)
- 4** Use a comb to divide the hair into sections. Do not put too much hair in one section.

*Tip: It is better to section off the crown area and to straighten the hair underneath first, followed by the top area.*

- 5** Take a section that is not wider than 4cm. Place it between the straightening plates and press the handles of the appliance firmly together.
- 6** Slide the straightener down the length of the hair in 5 seconds, from root to hair end, without stopping to prevent overheating (Fig. 4).
- 7** Repeat this process after 20 seconds until you have achieved the desired look.
- 8** Let your hair cool down. Do not comb or brush it before it has cooled down, as this would ruin the hairstyle you have just created.
- 9** Push the on/off slide to 'OFF' and unplug the appliance after use. Put the appliance on a heat-resistant surface.

## **Cleaning**

- 1** Make sure the appliance is switched off and unplugged.
- 2** Let the appliance cool down completely on a heat-resistant surface.
- 3** Clean the appliance with a damp cloth.

## **Storage**

Never wind the mains cord round the appliance.

- 1** Make sure the appliance is switched off and unplugged.

- 2 Let the appliance cool down on a heat-resistant surface before you store it.
- 3 Use the closing lock to lock the straightening plates together before you store the appliance.

## Environment

- Do not throw away the appliance with the normal household waste at the end of its life, but hand it in at an official collection point for recycling. By doing this, you help to preserve the environment (Fig. 5).

## Guarantee & service

If you need information or if you have a problem, please visit the Philips website at **www.philips.com** or contact the Philips Customer Care Centre in your country (you find its phone number in the worldwide guarantee leaflet). If there is no Customer Care Centre in your country, go to your local Philips dealer or contact the Service Department of Philips Domestic Appliances and Personal Care BV.

## Troubleshooting

If problems arise with your straightener and you cannot solve them with the information below, please contact the nearest Philips service centre or the Philips Customer Care Centre in your country.

Problem	Solution
The appliance does not work	Perhaps there is a power failure or the socket is not live. Check if the power supply works. If it works, plug in another appliance to check whether the socket is live.
	Perhaps the mains cord is damaged. If the mains cord is damaged, you must have it replaced by Philips, a service centre authorised by Philips or similarly qualified persons in order to avoid a hazard.

**Увод**

Новата Philips SalonStraight Active Ion осигурява супер бляскава и права коса. Ионизаторът създава струи от отрицателни йони, които обграждат косата ви и подобряват нейното състояние. Йоните намаляват чупливостта и статичното електричество, като придават на косата мек, гладък и блестящ вид.

**Общо описание (фиг. 1)**

- A** Плочи с керамично покритие
- B** Отвори за йонизиран въздух
- C** Индикаторна лампа
- D** Плъзгач включване/изключване
- E** Ключалка
- F** Въртящ се кабел
- G** Ухо за закачване

**Важно**

Преди да използвате уреда, прочетете внимателно това ръководство за експлоатация и го запазете за справка в бъдеще.

**Опасност**

- Пазете уреда от вода! Не го използвайте близо до или над вода в баня, вана, мивка и др. Ако използвате уреда в банята, след употреба го изключвайте от контакта. Близостта до вода води до риск, дори когато уредът е изключен.

**Предупреждение**

- Преди да свържете уреда към мрежата, проверете дали посоченото върху уреда напрежение отговаря на напрежението на местната електрическа мрежа.
- Проверявайте редовно състоянието на хранващия кабел. Не използвайте уреда, ако са повредени щепселът, хранващият кабел или самият уред.
- Ако хранващият кабел се повреди, той трябва винаги да се подменя от Philips, упълномощен сервиз на Philips или подобни квалифицирани лица, за да се избегне опасност.