

phaiser™

**BHS-710
Bluetooth® Headset
User manual**

1. Notice Before Using

Thank you for purchasing the Bluetooth® Headset BHS-710. Please read this User's Manual completely before you use the Headset.

BHS-710 designed for listening the high quality music wirelessly that based on the latest Bluetooth® wireless technology. BHS-710 can be easily

connected to a mobile phone for call conversation and music listening, it is also capable to connect to the other Bluetooth®-enabled devices like Notebook, iPod etc.

BHS-710 is compliant with Bluetooth V4.0 specification, supports HSP, HFP, A2DP and AVRCP profiles. Please make sure your phone or other device supports these profiles.

2. Specification

Bluetooth specification: V4.0

Operation frequency: 2.402-2.48GHz

Supported profile: HSP, HFP, A2DP,AVRCP

Operation range: Up to 10 meters

Talk time: 5hours

Play time: 4 hours

Standby time: 160 hours

Charge time: 1 Hours

3. Package Contents List

Please inspect this package and refer to the package contents list below to verify all items were included in this package:

- 1) BHS-710 Bluetooth® headset(1)
- 2) USB Charging Cable(1)

- 3) User's Manual(1)
- 4) Ear Cap (2x3 Sizes)
- 5) Ear Cap B (2x3 Sizes)

4. BHS-710 Bluetooth® Headset Overview

- 一. Ear Cap
- 二. Volume Up/Previous
- 三. Power/Play
- 四. Volume Down/Next
- 五. Micro USB Charge Port
- 六. Microphone
- 七. Indicator

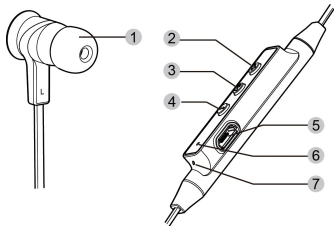

5. Battery information

The device is equipped with an integrated lithium-polymer battery. The battery cannot be replaced. Do not attempt to remove the battery from the device since it would damage the device. The full performance of a new battery is not achieved until after two or three complete charging-discharging cycles. The battery can be charged and discharged several hundred times, but it loses its capacity over time.

Disconnect the BHS-710 from the power supply as soon as the battery is

fully charged, overcharging would reduce the service life of the battery. A charged battery will lose its capacity if it is not used on a regular basis. Important: Ensure that the battery is fully charged if you do not use the device for a long period of time. To avoid a complete discharge of the battery, the BHS-710 should be charged at least every 3 months.

6. Charging the battery

The BHS-710 is operated with a rechargeable battery. Charge the battery completely before its first use. Read the section "Battery information" before starting the charging process.

- 1) Connect USB cable to a general USB power supplier.
- 2) Connect the charger to the correct outlet.
- 3) When the charger is connected to the headset, the red indicator light will turn on. Charging the battery fully may take up to 1hours.

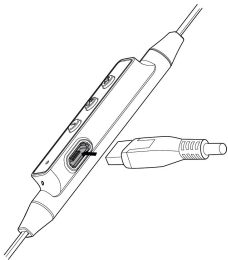

- 4) When the battery is fully charged, the red indicator light will turn blue. Disconnect the charger from the headset and the outlet. The headset is ready to use.

NOTE:

- For first time use, please charge the headset fully.
- The fully charged battery has power for up to 5 hours of talk-time and 4.5 hours music playing time, and up to 300 hours of standby time. However, the talk and standby times may vary when used with different mobile phones or other compatible Bluetooth® devices, usage settings, usage styles, and environments. When the battery power is low, the headset will remind you by voice prompt "**Battery low**" every 20 seconds, and the red

indicator light starts to flash.

- For using the BHS-710 with iPhone, an additional battery meter (🔋) will be activated and the remaining battery capacity will display on your phone.



7. Pair to your Bluetooth® phone

Before you use your headset the first time, you must pair the unit with a Bluetooth® enabled mobile phone. Pairing is a one-time process and required only for the first connection with the Mobile phone. The BHS-710 can be connected with two mobile phones simultaneously.

- 1) Keep the BHS-710 within 1 meter range of a Bluetooth®-ready Mobile phone.

- 2) Press and hold the **Power/Play** button for about 5s, the indicator light will flash red and blue intermittently, the device is now in pairing mode.
- 3) Find the Bluetooth® setting of your Mobile phone and start the search for Bluetooth® devices. (For further details, please read the operating instructions of your Mobile phone).
- 4) From the list of devices found, select the "BHS-710".
- 5) If required, enter the PIN code "0000" and confirm the entry. Once the pairing process was successful, the BHS-710 will connect to Mobile phone automatically then switch to standby mode, the indicator will flash blue every 5 seconds.

Note:

- 1) If pairing is not completed within 2 minutes, the headset will turn off. If this happens, please repeat the pairing steps.
- 2) The BHS-710 supports Multi-connection that allows for the simultaneous use of the BHS-710 with two mobile phones. After pairing successfully with 2 mobile phones, switch off the headset and switch on again, the headset will connect to both 2 mobile phones automatically. Otherwise, you can connect the headset on the cellphone manually.

8. Turning headset on /off

Turn on your headset

Long press the **Power/Play** for 3s to turn on your headset. If your headset has completed the pairing process successfully, when the headset is turned on, it will connect to the phone you last connected automatically. Please ensure your phone's Bluetooth® function is active.

Turn off the headset

Long press the power button for 3s to turn off the headset. the Red indicator will flash red.

Note:

To conserve power, if the headset is not connected to a device for approximately 10 minutes, the headset will turn off automatically.

9. Selecting the Voice prompt language

The BHS-710 supports voice prompt for the headset's status announcement in 5 different languages(English, Chinese, Spanish, French, German). At the standby state with connection, long press **Answer** button to shift the languages one by one, short press the **Power/Play** to select the languages.

10.Wearing the headset

For the best sound performance and a secure, comfortable fit, be sure the ear buds to rest gently in your ear and drape around the back of our neck. Use the provided fit kit to find the ear tip that works best for you.

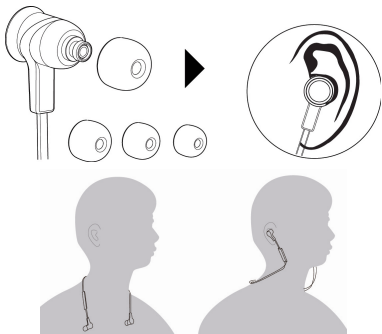

11. Using for music play

Play/Pause

Press **Power/Play** button to get the music play or pause.

Next/Previous song

Press and hold **Next** button to skip to next song or chapter, press and hold **Previous** button to go back previous song or chapter.

Increase/Decrease volume

Press **Volume Up** button to increase volume, press **Volume Down** button to decrease volume.

Note:

The BHS-710 supports A2DP profile that allows stereo music streaming from a Bluetooth phone. The music will pause automatically while a call is dialed out/incoming, and resume when the call conversation has ended.

12.Using for phone call

Last number re-dialing

At standby status, double press the **Answer**, the last number you dialed will be re-dialed.

Note: the last number re-dialing is available only for the first device if two Mobile phones are connected. The connection sequence can be determined by reconnect manually.

Answering a call

Press **Answer** shortly to answer the incoming call.

Reject an incoming call

Press and hold **Answer** for 2 seconds to reject the incoming call.

Transferring a call

Press and hold **Volume Up** for 2 seconds to transfer the call between the phone and headset.

Ending a call

Press the **Answer** shortly to end a call.

Call-waiting

- If there is an incoming call while a call is in progress, press **Answer** shortly to accept the waiting call and end current calling.
- If there is an incoming call while a call is in progress, press and hold **Answer** for 3 seconds to accept the incoming call and place the current call on hold.

Note:

The same operation could be performed in case of Multi-connection.

Volume adjusting

Press the **Volume Up** and **Volume Down** button to adjust the volume.

Mute

While a call is in progress, press and hold **Volume Down** button for 2s to mute the headset, a remindful tone would be heard every 10 seconds. Repeat the operation to un-mute.

13. Safety and general information

- 1) Please read this User's Manual carefully and follow all instructions.
- 2) To avoid any damage or malfunction of the device do not drop the device from high places.
- 3) Keep device away from humidity, water and any other liquid. If the device is exposed to water, moisture and other liquids do not operate it to avoid any electrical shock, explosion and damage to the device or yourself.

- 4) Do not place or keep this device near any heat sources, such as, direct sunlight, radiators, stoves or other apparatus that produce heat. This may cause an explosion, degrade the performance and/ or reduce battery life.
- 5) Do not modify, repair or disassemble device (Especially the battery). Doing this will void the warranty.
- 6) Do not place heavy objects on the device.
- 7) Use only the supplied and approved chargers.
- 8) Unplug this device when unused for long periods of time or during lightening storms.
- 9) The battery used in this device may present a risk of fire or chemical burn if mistreated.

14.FCC & IC Statement

Operation is subject to the following two conditions:

- (1) This device may not cause harmful interference.
- (2) This device must accept any interference received, including interference that may cause undesired operation.

Note: The manufacturer is not responsible for ANY interference, for example RADIO or TV interference, caused by unauthorized modifications to this equipment. Such modifications could void the user's authority to operate the equipment.

15. EC Declaration of Conformity

Operation is subject to the following two conditions:

- (1) This device may not cause harmful interference.
- (2) This device must accept any interference received, including interference that may cause undesired operation.

Note: The manufacturer is not responsible for ANY interference, for example RADIO or TV interference, caused by unauthorized modifications to this equipment.

Such modifications could void the user's authority to operate the equipment. This product is CE certified according to the provision of the R&TTE Directive (99/5/EC). This declares that this product is in compliance with the essential requirements and other relevant provisions of Directive 1999/5/EC. Please note that this product uses radio frequency bands not harmonized within EU.

Within the EU this product is intended to be used in Austria, Belgium, Denmark, Finland, France, Germany, Greece, Ireland, Italy, Luxembourg, The Netherlands, Portugal, Spain, Sweden, and United Kingdom and within EFTA in Iceland, Norway and Switzerland.

16. Warranty

The condition of this warranty and supplier's responsibilities under this warranty are as follows:

Warranty is non-transferable and is limited to the original purchaser only.

- You must be able to prove the date of original purchase of the unit with a dated receipt.
- The warranty is not applicable if the product has been subject to physical abuse, improper installation, modification or repair by an unauthorized third party.
- Supplier's responsibility shall be limited to the repair or replacement of the product at its sole discretion.
- Specifically exempt from any warranty are limited-life consumable components subject to normal wear and tear such as batteries, decorates and other accessories.
- Supplier is not responsible, for failure resulting from accident, abuse, misuse, or any unauthorized repair, or modification.
- Modification and repair of the unit should be done by an authorized and qualified service center or returned to the manufacturer.
- This warranty gives you specific legal rights, and you may also have other rights, which vary under local laws.