

Luggage Tracker User Manual

Front & Rear View

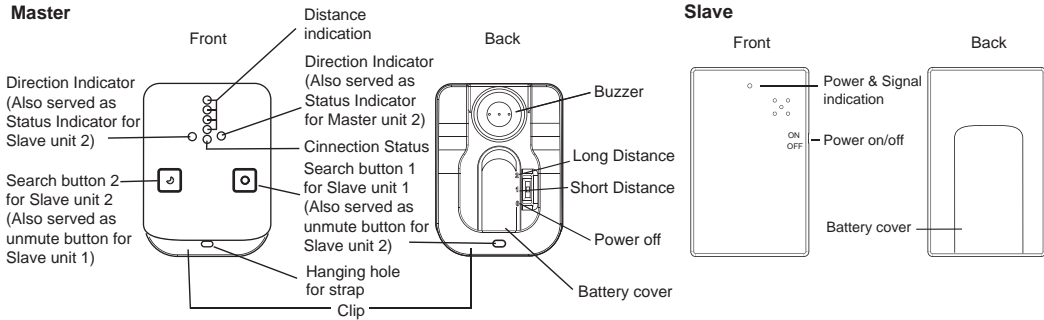

Specifications

Model Name	105L		105LM		105LM2	
	Search, Alarm, 1 to 1		Search, Alarm with Vibration, 1 to 1		Search, Alarm with Vibration, 1 to 2	
Function	Search, Alarm, 1 to 1		Search, Alarm with Vibration, 1 to 1		Search, Alarm with Vibration, 1 to 2	
Search Range	0-120m/328ft		0-120m/328ft		0-120m/328ft	
Alarm Distance	Short Distance : 10±5m/33±16ft Long Distance : 20±5m/65±16ft		Short Distance : 10±5m/33±16ft Long Distance : 20±5m/65±16ft		Short Distance : 10±5m/33±16ft Long Distance : 20±5m/65±16ft	
Master/Slave	Master (M05S)x1	Slave (S01)x1	Master (M05SM)x1	Slave (S01)x1	Master (M05SM)x1	Slave (S01)x2
Battery Type	LR44	CR2016	LR44	CR2016	LR44	CR2016
Battery Life Time with Standby	50 days (8 hrs)	60 days (8 hrs)	50 days (8 hrs)	60 days (8 hrs)	30 days (8 hrs)	60 days (8 hrs)
Battery Life Time with Sleep	Over 90 days	Over 90 days	Over 90 days	Over 90 days	Over 90 days	Over 90 days
Beep Sound (at 10cm/3.9inch)	95±3db	95±3db	95±3db	95±3db	95±3db	95±3db
Vibration	None	None	Vibration Motor	None	Vibration Motor	None
Dimension (L/W/H)	52.8x39x13.2mm 2x1.6x0.52inch	52.8x39x13.2mm 2x1.6x0.52inch	52.8x39x13.2mm 2x1.6x0.52inch	80x50x2.8mm 3.1x1.9x0.11inch	52.8x39x13.2mm 2x1.6x0.52inch	80x50x2.8mm 3.1x1.9x0.11inch

Package Contents

Package Contents	105L	105LM	105LM2
Master(M05S)	1 pc	1 pc	1 pc
Slave(S01)	1 pc	1 pc	2 pcs
Nameplate	1 pc	1 pc	2 pcs
Batteries	LR44x2 CR2016x2	LR44x2 CR2016x2	LR44x2 CR2016x4
Luggage tag	1 pc	1 pc	2 pcs
Strap	1 pc	1 pc	1 pc
User manual	✓	✓	✓

Suggested Setting place

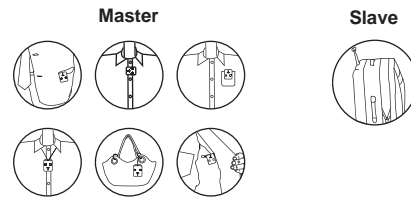

Getting Started

- For the first time use, please insert the batteries into the Master and the Slave sets according to the battery installation instruction as follows.

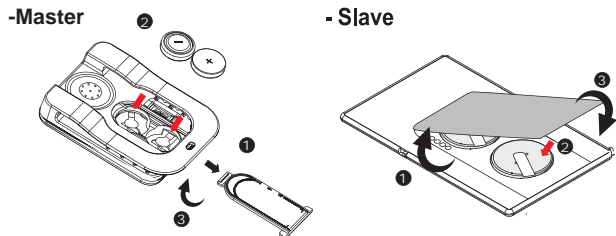

- Slide out the battery cover.
- Insert batteries (included) following the polarity markings in the battery compartment.
- Close the battery compartment cover as shown.

- Switch the power button of the Master and the Slave to "ON", it will enter "Search Mode", please press search button to enter "Standby mode".
- Place the Slave to your luggage, and take the Master with you or clip it on your belt.

Luggage Tracker User Manual

Search

One Slave only: To search the Slave unit, please press the "Search button 1" on the Master unit once.

To search the Slave 2, please press the "Search button 2" on the Master unit once.

Two Slaves: To search the Slave 1, please press the "Search button 1" on the Master unit once.

- Once you press the "Search button" on the Master unit, the signal status, right and left LED on the Master unit will start to blink (which tells you the Master unit is linking to the Slave unit now). Same as the signal strength LEDs on the Master unit, which indicates distance, will start to blink at the same time.
- After you press the search button, sway the Master unit at a slow speed from your right side to left side, then reverse from left side to right side twice to collect signal strength from all directions. After second you sway, the Master unit to the correct direction, both (left and right) status LEDs will be lit and start blinking. You can move forward to search for your luggage now.
- The closer the distance is between the Master unit and the Slave unit, more signal strength LED lights are lit and the melody on the Master unit will become more rapid. Contrarily, less LED lights are lit and the melody on the Master unit becomes slower. Press the "Search button" on the Master unit again to stop searching.

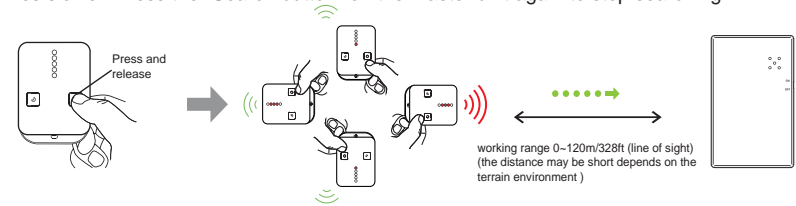

Search Tip:

- While searching, always place the Master unit in front of your chest and turn around your body slowly to find the correct direction. If you point at the correct direction, both status LEDs will be lit and blinking.
 - If the distance between the Master unit and the Slave unit is out of detectable range, the Master unit beeps every second to remind you.
 - Press the "Search button" on the Master unit again to stop searching.
 - While searching, the Master unit makes low beep sounds every second. This can assist you in finding its position by tracking the sound when the Master unit and the Master unit are nearby.
- (Suggestion: Press and hold the Mute button on the Master unit to turn off the melody temporarily. Once you release the Mute button, the searching melody resumes again.)

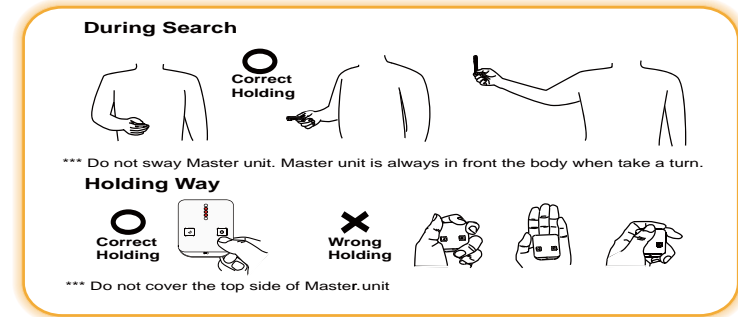

Alarm

If you hear a high beep alarm from the Master, it means that distance between the Master and Slave has been over safe range (Set in short distance is 10±5m, and Long distance is 20±5m). The Master unit alarms and vibrates at this moment.

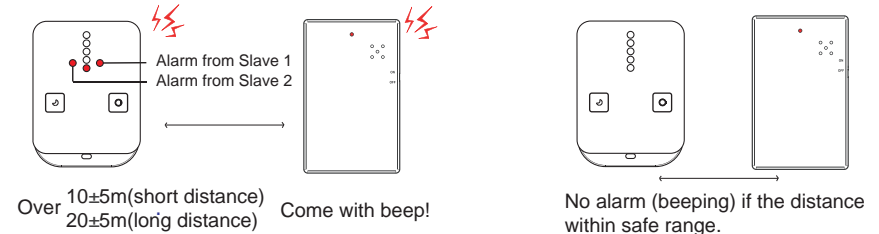

Luggage Tracker User Manual

Mute

For one Slave unit: Press the Mute button to mute searching melody from the Master unit. Listen to beep sound from the Slave unit to assist short range searching.

For two Slave units: Keep pressing the Search button 1 or 2 to mute searching melody from the Master unit. Listen to beep sound from the Slave unit to assist short range searching.

Wake up / Standby

- Switch Master unit & Slave unit power On, Master unit will enter wake-up process. The Signal indicator, right and left LEDs blink while Master unit is waking Slave unit up within 8~15 seconds if Slave unit is within range and NOT being blocked. After Slave unit been woken up, Master unit enters Search mode. Press Search key to go back to Standby mode.
- Under Standby mode, Master unit LED blinks every second. When wake-up, Master unit enters Search mode automatically. If Master unit cannot wake-up Slave unit within 50 seconds, due to out of range or signal is blocked, it will enter Standby mode and beeps to indicate lost signal. User can push Search key to enter wake-up process again.
- Slave unit beeps when it's awake. Under Standby mode, Slave unit LED blinks every second.

Important: Please turn off the Master unit and Slave unit if NOT in use to save battery life.

Out of range or Loss signal

- Master unit beeps, vibrates and signal LED blinks for 20 seconds out of range or loss signal; then Master unit will enter sleep mode automatically.
- Master unit beeps once every two minutes (to remind user to switch power OFF for Master unit for power-saving.)
- To wake-up Master, press Search button to go to wake-up process.
- Slave unit LED blinks for 20 seconds and into sleep mode.

Low battery

When the Master unit and Slave unit is under low battery condition, it will beep every 2 minutes interval, please change the battery.

Important: Under low battery condition, it may cause abnormal function of alarm or searching.

The pairing process of additional Slave unit

- To avoid the pairing failure, please make sure the Slave unit 1, 2 and Master unit are under power off status.
- Press the "left" key on the Master unit and turn on the Power at the same time. At the moment, two of the LEDs light. (As Graph 1)
- Keep pressing "left" key and press the "right" key. Then release "left" key and LEDs start flashing, and then release "right" key.
- At this moment the Master unit is under code-setting status and awaiting to be paired. (As Graph 2)
- Turn on the power of Slave unit and position it 0~20cm from Master unit to proceed the pairing.(As Graph 3)
- While Master unit and Slave unit are paired, both units enter Search mode.

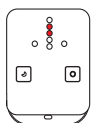

Graph 1

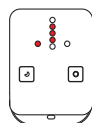

Graph 2

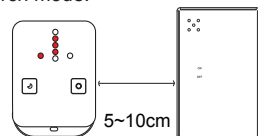

Graph 3

Frequent Asked Questions

Q. The Master unit shows more than one directions when it searches:

A. This is caused by the reflection of radio signal, our system collects and compares the signal strength to determinate the direction. Sometimes because the signal from different direction have similar signal strength with each other, this might cause the Master unit to show more than one direction.

This normally happens when the Slave unit is already very close to the Master unit and both units are in an enclosed environment or with a lot of material, which causes signal reflection. If the signal strength LED tell you that you are already very close with the Slave unit and the easiest way to fix this problem is to mute the Master unit and track the beeping sound from the Slave unit to locate your Slave.

Q. I follow the direction guide but the Master unit bring me to a wrong direction.

A. This is also caused by the reflection of the signal. Sometimes, the signal from the correct direction has been weakened by signal blocker(s), but the signal from a wrong direction has been enlarged by combining several signals from different sources. To find out if this is a wrong direction, you can just follow the direction and move forward a few steps, once both status LED lights turn off for over 1 second, you know you are moving toward a wrong direction. You can restart your search for correct direction again then.

Q. I got a false Range alarm:

A. Experienced false alarms caused by following reasons:

Luggage Tracker User Manual

- Both Master and Slave unit has been kept together too closely.
- Battery low but the batteries have not been replaced.
- Unit has been placed in a pocket with a lot of other materials.

Q. Range alarm distance is not consistent.

A. Our device only reads signal strength. And the signal strength will be affected by its environment. Users can select short or long.

Please Note

- The connection range is based on clear line of sight. Actual range will vary depending on use environment and location.
- When the Master unit and Slave units are turned ON, it takes 8 to 15 seconds for the synchronization.
- The signal will be disconnected while the Master unit and Slave units are too close within 10 cm (the signal connection will be overloaded). When the Master unit unit can't connect to Slave unit unit, Master unit alarms every second and Slave unit unit's LED light flashes.

Care and Maintenance

- Keep the device dry. Precipitation, humidity, and all types of liquids or moisture can contain minerals that may corrode electronic circuits. If your device gets wet, remove the battery, and allow the device to dry completely before replacing it.
- Do not use or store the device in dusty, dirty areas as its moving parts and electronic components can be damaged.
- Do not store the device in hot areas. High temperatures can shorten the life of electronic device, damage Batteries, and warp or melt certain plastics.
- Do not store the device in cold areas. When the device returns to its normal temperature, moisture can from inside the device and damage electronic circuit boards.
- Do not attempt to open the device other than as instructed in this guide.
- Do not drop ,knock or shake the device. Rough handling can break internal circuit boards and fine mechanics.
- Do not use harsh chemicals, cleaning solvents, or strong detergents to clean the device.
- Do not paint the device. paint can clog the moving parts and prevent proper operation.
- Do not put the Master and Slave unit at same place in case of this kit is unable playing functions to guard your luggage.
- Search, detection, and alarm range depend on the terrain environment.
- If the beep sound is not loud enough, the batteries may be low. Change with new batteries for louder alarm sound.
- This product only assists in providing a warning alarm to remind the user. It does not guarantee to prevent theft or robbery of personal property.
- If you want to use the device during flight trips, please comply with the flight safety law according to each country.
- We reserve the right in changing the specification of the hardware and software designs to manuals at any time and without prior notice. Information in this document is subject to change without notice.
- This product operational temperature is between 32°F ~131°F(0°C~50°C). Storage Temperature is between -4°F~185°F(-20°C~85°C) .

Recycle: The Batteries provided in this product should be recycled to protect the local environment.

Warning: Do not put the batteries into the fire or heat sources. It may cause danger or even explosion.

FCC Certifications

Federal Communication Commission Interference Statement

This equipment has been tested and improved to comply with the limits of a Class B digital device, pursuant to Part 15 of the FCC Rules. These limits are designed to provide reasonable protection against harmful interference in a residential installation. This FCC Certifications equipment generates, uses and can radiate radio frequency energy, if installed and used not in accordance with the instructions, may cause harmful interference to radio communications.

However, there is no guarantee that interference will not occur in a particular installation. If this equipment does cause harmful interference to radio or television reception, which can be determinedly turning the equipment off and on, the user is encouraged to try to correct the interference by one of the following measures:

- Reorient or relocate the receiving antenna.
- Increase the separation between the equipment and receiver.
- Connect the equipment into an outlet on a circuit different from that to which the receiver is connected.
- Consult the dealer or an experienced radio/TV technician for help.

This device complies with Part 15 of the FCC Rules. Operation is subject to the following two conditions:

(1) This device may not cause harmful interference, and (2) this device must accept an interference received, including interference that may cause undesired operation.

FCC Caution: Any changes or modifications are not expressly approved by the party responsible for compliance which could void the user's authority to operate this equipment.

EU Declaration Conformity

This product is carrying the CE-Mark in accordance with the related European Directives.

