

# Gavita **Master** Controller EL2

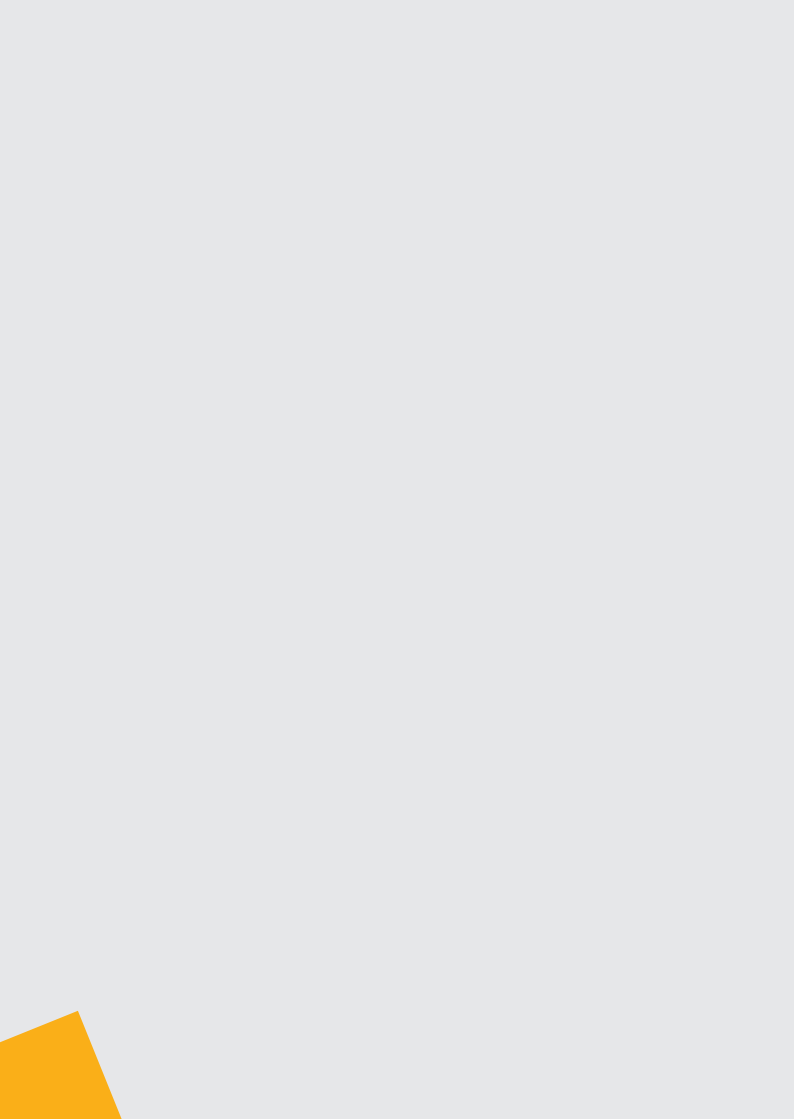

User manual



# User manual

## Gavita Master controller EL2

Dear Customer,

Congratulations on the purchase of your Gavita Master controller EL2. This manual contains all the information necessary to install, use and maintain the Gavita Master controller EL2. Please read and understand this manual completely before installing and using the product. Consult the index at the start of this manual to locate information relevant to you.

In this manual, the Gavita Master controller EL2 will be referred to as the controller.

This is the original manual, keep it in a safe location!

# Table of contents

<b>1. Introduction</b>	<b>7</b>
1.1. Product description	7
1.2. Glossary of Terminology	8
1.3. Used symbols	8
<b>2. Product specifications</b>	<b>9</b>
2.1. General product information	9
2.2. Technical specifications	9
2.3. Environment	9
2.4. Required tools	9
2.5. Components	10
2.6. Controls	10
2.7. Indications	11
2.8. Connections	12
2.9. Accessories	13
2.10. Compatible ballasts	13
<b>3. Safety guidelines and measures</b>	<b>14</b>
<b>4. Installing the controller</b>	<b>14</b>
4.1. Placing the controller	14
4.2. Installing and connecting the temperature sensor(s)	15
4.2.1. Installing the temperature sensor in "Follow mode" (one room)	16
4.2.2. Installing the temperature sensors in "Inverse mode" (two rooms)	17
4.3. Connecting the controller to the ballasts	18
4.3.1. Connecting the controller to remote ballasts	18
4.3.2. Connecting the controller to complete fixtures	19
4.3.3. Shortening RJ cables	20
4.4. Connecting the controller to External Contactor Modules (ECMs) to control auxiliary equipment	20
4.4.1. Connecting the signal cable to the controller and the ECM(s)	21
4.4.2. Controlling auxiliary equipment in "Follow mode" (one room)	22
4.4.2.1. Connecting equipment which must be used during lights-on periods	22
4.4.2.2. Connecting equipment which must be used during lights-off periods	23
4.4.3. Controlling auxiliary equipment in "Inverse mode" (two rooms 12h/12h)	23
4.4.3.1. Connecting equipment which must be used during lights-on periods	24
4.4.3.2. Connecting equipment which must be used during lights-off periods	24
4.5. Connecting a temperature shutdown, sensor failure or power-off alarm to the controller	24
4.5.1. Connecting an alarm wire to the controller	25
4.6. Connecting the controller to the mains	26

<b>5. Preparations before use</b>	<b>27</b>
5.1. Localizing your controller	27
5.1.1. Selecting your default language	27
5.1.2. Switching between 24 hour and AM/PM clock mode and setting the time	27
5.1.3. Switch temperature units between °Fahrenheit and °Celsius	28
5.2. Calibrating the temperature sensor(s)	28
5.3. Change the display mode from the controller output from % to Watts	29
<b>6. Programming and using the controller</b>	<b>30</b>
6.1. Adjust ballast output to change light intensity	31
6.1.1. Control a lamp with a lower power rating than its ballast	31
6.2. Programming a light cycle	31
6.3. Set follow- or inverse mode (aux function)	32
6.4. Set temperature safety settings	33
6.4.1. Setting the auto-dim temperature	33
6.4.2. Setting safety shutdown temperature	34
6.5. Setting the sunrise and sunset period	34
6.6. Activate or deactivate the lights manually or set automatic mode	35
6.7. Resetting the controller to factory settings	35
<b>7. Interpreting controller information</b>	<b>36</b>
7.1. Reading the default screen	36
7.2. Show system time	36
7.3. Interpreting LED signals	36
7.3.1. Green light [22A]	37
7.3.2. Blue light [22C/22D]	37
7.3.3. Red light [22E/22F]	37
7.4. Interpreting display messages	37
7.4.1. Sensor disconnected	37
7.4.2. Sensor failure	37
7.4.3. Controller Overload	37
7.4.4. Auto-dim	38
7.4.5. Temp Alarm	38
7.5. View the software version on the controller	38
<b>8. Maintenance and Repair</b>	<b>39</b>
<b>9. Environment and Disposal</b>	<b>39</b>
<b>10. Warranty</b>	<b>39</b>
<b>11. Appendix I – Overview of all screens on display</b>	<b>40</b>



## 1. Introduction

### 1.1. Product description

The Gavita Master controller EL2 is a dual channel controller which can control up to 80 ballasts/lights in climate rooms.

Unlike a switchboard, which switches the power supply of regular ballasts on and off, the controller can control appropriate Gavita e-series ballasts by means of a low voltage control signal.

The controller has two channels; a main channel and an auxiliary channel. Both channels can control a group of up to 40 e-series ballasts.

The controller can be set to activate and deactivate all ballasts connected to it simultaneously. In this manual, this mode will be referred to as the "Follow Mode".

The controller can also be set to alternate between the main and auxiliary channel. This means the auxiliary channel and the ballasts connected to it, are switched off when the main channel and the ballasts connected to it are switched on and vice versa. An inverted light cycle is intended to be used to alternate light between two rooms in a 12/12 hour system, to optimize power utilization. In this manual this mode will be referred to as the "Inverse Mode".

The ballasts and lights connected to the controller form a significant heat source within the climate room. If for whatever reason, the climate control system cannot prevent the temperature from rising in the climate room, the lights should be dimmed or even shut down to prevent crop damage. The controller can be connected to either one temperature sensor (in follow mode) or two temperature sensors (in inverse mode) to sense the temperature in the climate room(s). The controller offers the possibility to set the temperature at which it will dim the lights and a temperature at which it will shut the lights down.

The controller is not meant to replace climate control equipment. Its auto-dim and shutdown function are primarily meant to prevent crop damage.

Besides controlling up to 80 ballasts, the controller can also control two Gavita External Contactor Modules (ECMs). These modules can be used to switch auxiliary equipment during light on or light off periods (CO<sub>2</sub> equipment, heating, cooling, etc). The ECMs may also be used to switch non-dimmable supplemental lighting, such as the regular (non e-series) plasma lamps. Auxiliary equipment is also governed by the controller's temperature safety features.

The controller is provided with a set of alarm contacts which may be connected to a standard alarm installation or cell phone module to provide

instant messaging. An alarm will be triggered by temperature shutdown, sensor failure or power failure.

The controller is equipped with a 16x2 character green OLED display, which ensures high contrast and clarity in dark and light environments. It provides a self-explaining menu system with a full text interface for extremely easy and intuitive use. There is no need to go through a code table to set your controls or read your statuses. The system is also equipped with LEDs as status indicators to see the status of your controller at a glance.

The interface language is user selectable: English, Spanish, French, German and Dutch are standard available.



The Controller uses a low DC voltage to control both ballasts and contactor modules, making the system safe to install. Cables for plug & play installation are provided with the controller and the ballasts.

## 1.2. Glossary of Terminology

ECM	External Contactor Module
EL	Entry level
Light cycle	A 24 hour period in which the lights are activated and deactivated once
Lights-on period	The period of the light cycle in which the lights are activated
Lights-off period	The period of the light cycle in which the lights are not activated
Follow mode	Main and auxiliary channel are switched on and off simultaneously
Inverse mode	Main and auxiliary channel are switched alternating (one on, one off and vice versa)
Cage clamp	Wire clamp
Ballast	A ballast is a device intended to ignite and power HID lamps
Complete fixture	A ballast integrated with a reflector and lamp

## 1.3. Used symbols

The following icons will be used throughout the manual:

-  **Warning!** A warning indicates severe damage to the user and/or product may occur when a procedure is not carried out as described.
-  **Caution!** A caution sign indicates problems may occur if a procedure is not carried out as described.
-  **Note/Example:** A note or example provides tips and addition information to the user.



## 2. Product specifications

### 2.1. General product information

Product name	Master Controller EL2
Product code	60.56.00.xx.xx
Producer	Gavita Holland bv

### 2.2. Technical specifications

Controller dimensions (LxWxH)	127 x 22 x 75 mm
Weight	170 gram
Power supply	Adapter: 100V-240V AC 50/60hz - 5V DC (2000mA)
Maximum control voltage	11.5V
Maximum voltage/current alarm contacts (NO/NC)	13,5V/50mA
Maximum cable length per port	100m (328ft)
Maximum number of ballasts per port	40
Total number of ballasts per controller	80

### 2.3. Environment

**⚠ Warning!** The product may not be exposed to moisture, condensing humidity, contamination or dust.

Temperature range	0-35 °C / 32 - 95 °F
Operating humidity (non-condensing)	<80%

### 2.4. Required tools

Task	Tool
Mounting controller	Screwdriver
Mounting controller	Drill
Modify cable length (optional)	RJ14 crimp tool

## 2.5. Components

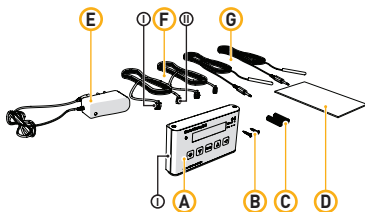

- A. Gavita Master controller EL2
  - I. Mounting plate
- B. 2x Countersunk screw
- C. 2x Plug
- D. Manual
- E. 120-240V AC - 5V DC power adapter (2000mA)
- F. 2x Controller cable (5m/16ft)
  - I. RJ14 (6P4C) plug (connect to ballasts)
  - II. RJ9 (4P4C) plug (connect to controller)
- G. 2x Temperature sensor with cable (5m/16ft)

## 2.6. Controls

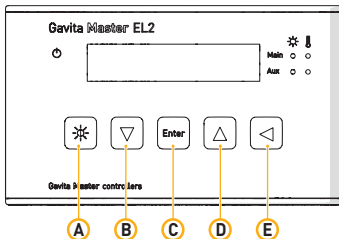

	Key	Function
A	Quick-key	View and adjust output level
B	Down	Navigate down in menu/decrease value
C	Enter	Go to menu/confirm
D	Up	Navigate up in menu/increase value
E	Back	Navigate back in menu/cancel/reset

## 2.7. Indications

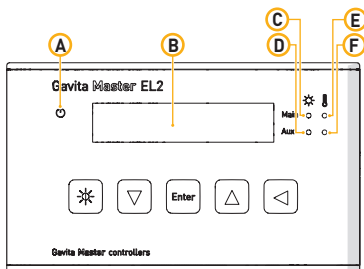

For more information on indications go to chapter 7

	Indication signal	Function
A	Power indication	A burning green light indicates controller is active. A blinking green light indicates a power interruption has occurred during operation.
B	Display	Displays status, warnings and controller menu.
C	Light indication main	A burning blue light indicates the port is active. A blinking blue light indicates an overload/short circuit in a cable connected to the port.
D	Light indication aux	Blue light off indicates the port is inactive.
E	Temperature warning main	A burning red light indicates the auto-dim temperature has been exceeded in the past. A blinking red light indicates the auto-dim temperature threshold is currently exceeded. The corresponding output channels are being dimmed.
F	Temperature warning aux	A fast blinking red light indicates the shutdown temperature threshold has been exceeded. All output channels have been shut down.

## 2.8. Connections

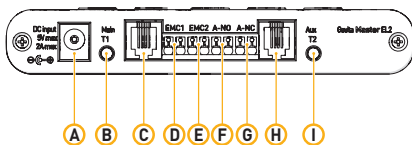

- A. 5V DC input
- B. 3,5 mm jack main temperature sensor (T1)
- C. RJ9 (4P4C) Main port for controlling up to 40 ballasts
- D. Cage clamp connector ECM1 (output is active when main channel is on)
- E. Cage clamp connector ECM2 (output is active when main channel is off)
- F. Cage clamp alarm Normally Open (potential free contact)
- G. Cage clamp alarm Normally Closed (potential free contact)
- H. RJ9 (4P4C) Auxiliary port for controlling up to 40 ballasts
- I. 3,5 mm jack auxiliary temperature sensor (T2)

## 2.9. Accessories

- 1** **Note:** Accessories are not included, they have to be bought separately. Visit the website of Gavita Holland: [www.gavita-holland.com](http://www.gavita-holland.com) for the latest Gavita products.

Part	Variants	Product code
Interconnect cable (RJ14-RJ14)	2 ft / 0,60 m	60.50.00.08
	5 ft / 1.5 m - standard cable	60.50.00.04
	8 ft / 2,4 m	60.50.00.09
	10 ft / 3.0 m	60.50.00.10
Controller cable (RJ9-RJ14)	5 ft / 1.5 m	60.50.00.11
	16 ft / 5 m - standard cable	60.50.00.12
	25 ft / 7.5 m	60.50.00.13
Three-way RJ14 Splitter		60.50.00.01
Power supply Gavita Master Controller EL1/EL2 (with 2 m cord, universal voltage 120-240 V)	US version 120V	90.02.02.03
	UK version 240V	90.02.02.02
	EU version 230V	90.02.02.01
	AUS version 240V	90.02.02.05
ECM1 External Contactor Module (with 10 ft / 3 m cable)	US version 120V 15A	60,57,00,12,20
	US version 240V 15A	60,57,00,24,20
	UK version 240V 13A	60,57,00,24,11
	EU version 230V 16A	60,57,00,23,10
	AUS version 240V 10A	60,57,00,24,60
CH version 240V 10A	60,57,00,23,12	
ECM controller cable 3m/10 ft	10 ft / 3.0 m standard cable	90.03.01.15
Temperature sensor (with 5 m cable - 3.5 mm mini jack plug)	16 ft / 5.0 m cable length - standard	60.50.00.14

## 2.10. Compatible ballasts

- 1** **Note:** Ballasts are not included, they have to be bought separately. Visit the website of Gavita Holland: [www.gavita-holland.com](http://www.gavita-holland.com) for the latest Gavita products.

The Gavita Master controller EL2 is compatible with all Gavita e-series ballasts.

### 3. Safety guidelines and measures

- ⚠ **Warning!** Keep the controller away from fire, excessive heat, water, dust and contamination.
- ⚠ **Warning!** The Gavita Master controller EL2 may only be used to control compatible Gavita e-series ballasts. Do not connect the Controller to other products as this may be dangerous and may cause malfunctions in the connected equipment. Doing so will void the warranty.
- ⚠ **Warning!** The ECM channels of the Gavita Master controller EL2 may only be connected to Gavita ECMs. Do not connect the Controller to other products as this may lead to malfunctions or damage and can be dangerous. Doing so will void the warranty.
- ⚠ **Warning!** Do not open or disassemble the controller, it contains no serviceable parts. Opening the controller will void its warranty.

### 4. Installing the controller

#### 4.1. Placing the controller

- ⚠ **Warning!** The area in which the product is placed must comply with the conditions specified in paragraph 2.3.
- ⚠ **Caution!** Only mount the product on a sturdy, solid background.
- 📌 **Note:** Use the included plugs for hard surfaces.
  - Determine the optimal location for the controller
  - Carefully pry the mounting clamp from the controller using a prying tool or a flat head screwdriver (1) (tape it to prevent damage to the housing).

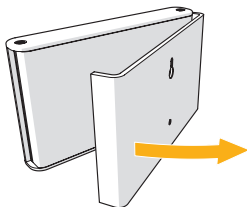

1 Removing mounting clamp

- Hang the controller mounting plate against the desired surface using one of the countersunk screws (2A)
- Secure the mounting plate with a second screw (2B)
- Click the controller on the mounting clamp (3).

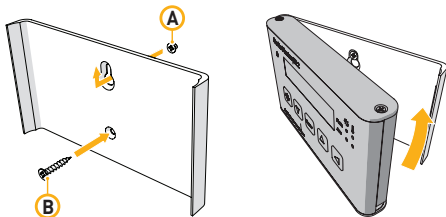

- 2 Hanging the mounting clamp      3 Clicking the controller on the clamp

#### 4.2. Installing and connecting the temperature sensor(s)

- ⚠ **Warning!** The Gavita Master controller is not a climate controller. Do not use the product to manage the temperature in your climate room.
- ⚠ **Caution!** Only use Gavita temperature sensors.
- ⚠ **Caution!** Ensure the controller measures the same temperature as the climate control system [see paragraph 5.2].

The controller can only be used when it is connected to either one or two temperature sensors. The controller uses these sensors to monitor the temperature in the climate room(s). The controller will automatically dim or shut down the lights if the temperature in a climate room becomes too high. For more information on temperature safety, consult paragraph 6.4.

The controller must be connected to ONE temperature sensor when the controller is in "Follow mode". [see paragraph 4.2.1] The controller must be connected to TWO temperature sensors if the controller is in "Inverse mode" [see paragraph 4.2.2].

#### 4.2.1. Installing the temperature sensor in “Follow mode” (one room)

Only one of the provided temperature sensors is needed in “Follow mode”.

- Place the provided temperature sensor as close as possible to the sensor of the existing climate control system, so both sensors will measure the same temperature (4A)
- Ensure the sensor is covered from the light, as this will disrupt temperature measurements. Use a hood if necessary (4B).  
A template for a hood is included on the last page
- Insert the plug of the temperature sensor into the T1 port (4C)
- The temperature measured by the sensor will be displayed on the controller display.

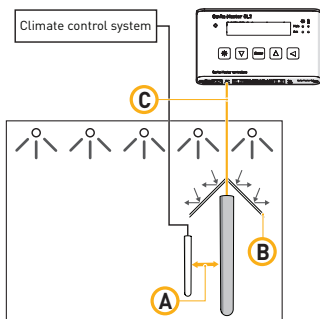

#### 4 Placing a temperature sensor in “follow mode”

- ! **Note:** The displayed temperature may take some time to level out.
- ! **Note:** If the length of the sensor cable is insufficient to reach the controller, try to relocate the controller. If this is not possible, the sensor cable may be lengthened an extra 5 meters by using a standard 3,5 mm jack extension cable. If the message “sensor removed” appears, the plug of the sensor is not (fully) plugged in. Plug the sensor in completely.
- ! **Note:** If the message “sensor failure” appears, the sensor is defect. Replace the sensor.



#### 4.2.2. Installing the temperature sensors in “Inverse mode” (two rooms)

Two temperature sensors are needed in “Inverse mode”.

- Before placing the temperature sensors, determine which controller channel (main/aux) controls the lights in which room (“main” room/“aux” room) (5)
- Place one temperature sensor in each room. Ensure both sensors are placed as close as possible to the temperature sensors of the existing climate control system (5A)
- Ensure the sensor is covered from the light, as this will disrupt temperature measurements. (5B) Use a hood if necessary. A template for a hood is included on the last page
- Insert the plug of the sensor placed in the “main” room (5C) in the T1 input of the controller
- Insert the plug of the sensor placed in the “aux” room (5D) in the T2 input of the controller
- The temperature measured by both sensors will be displayed on the controller display.

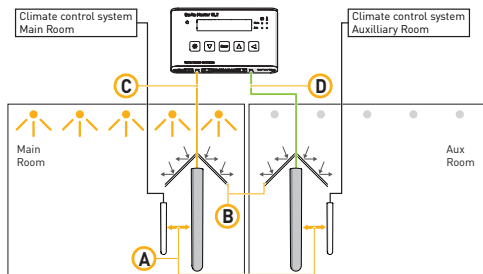

#### 5 Placing a temperature sensor in “inverse mode”

- ! **Note:** The displayed temperature may take some time to level out.
- ! **Note:** If the length of the sensor cable is not long enough to reach the controller, relocate the controller. If this is not possible, the sensor cable may be lengthened an extra 5 meters using a standard 3,5 mm jack extension cable. If the message “sensor removed” appears, the plug of the sensor is not (fully) plugged in. Plug the sensor in completely.
- ! **Note:** If the message “sensor failure” appears, the sensor is defect. Replace the sensor.

### 4.3. Connecting the controller to the ballasts

**Warning!** The controller may only be connected to compatible Gavita e-series remote ballasts and complete fixtures. For a list of compatible products, consult paragraph 2.10 or go to [www.gavita-holland.com](http://www.gavita-holland.com).

**Note:** for more information on shortening RJ cables, consult paragraph 4.3.3.

A group of up to 40 e-series ballasts can be connected to both the main RJ9 port and the auxiliary RJ9 port of the controller. Consult paragraph 4.3.1 to connect the controller to remote ballasts. Consult paragraph 4.3.2 to connect the controller to complete fixtures.

#### 4.3.1. Connecting the controller to remote ballasts

**Warning!** When connecting the fixture to the controller it may ignite. Make sure either fixture power is disconnected or the controller is switched off.

**Warning!** Ensure the remote ballasts are connected to their lamps and reflectors.

- Switch the rotary knob on all Gavita ballasts to "EXT" (external control)
- Plug the RJ9 end of one of the controller cable(s) (6A) into the RJ9 main port of the controller. If a two room setup is used or if more than 40 ballast have to be connected, plug a second ballast connection cable in the RJ9 aux port (6B)
- Plug the RJ14 end of the controller cable(s) into one of the two RJ14 ports of the first ballast (6C)
- Interconnect the remote ballast to the next ballast in line using an interconnect cable with RJ14 plugs (6D). Up to 40 ballasts may be daisy chained this way.

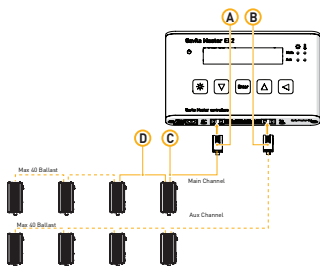

#### 6 Connecting the controller to remote ballasts

#### 4.3.2. Connecting the controller to complete fixtures

**⚠ Warning!** When connecting the fixture to the controller it may ignite. Make sure either fixture power is disconnected or the controller is switched off.

**! Note:** A RJ14 splitter and two cables are provided with each complete fixture since complete fixtures have only one RJ14 port.

- Switch the rotary knob on all Gavita ballasts to "EXT"
- Plug the RJ9 end of one of the provided controller cable into the RJ9 main port of the controller (7A)
- If a two room setup is used or if more than 40 ballast have to be connected, plug a second controller cable in the RJ9 aux port (7B)
- Plug the RJ14 end of the controller cable(s) (7C) into the input of a RJ14 splitter (7D). Use an interconnect cable to connect one output of the RJ14 splitter to the RJ14 port of the ballast (7E)
- Use an interconnect cable to connect one output of the RJ14 splitter to the input of the following RJ14 splitter (7F)
- Repeat this process to connect up to 40 ballasts per group.

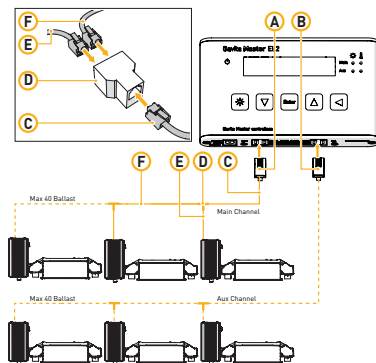

#### 7 Connecting the controller to complete fixtures

#### 4.3.3. Shortening RJ cables

- ❗ **Note:** A RJ14 crimp tool is needed to shorten a RJ cable and install a RJ14 plug!
- ❗ **Note:** Don't remove RJ9 plugs unless you have a RJ9 crimp tool!
- ⚠️ **Caution!** Always follow the instructions provided with the crimp tool!
  - Shorten the cable on the desired length
  - Strip the outer insulation off the RJ cable (8 mm). Leave the inner insulation intact!
  - Push the four wires into the middle openings of a RJ14 plug. The orientation of the plug does not matter as long as the wires are entered in the central four openings (8A).
- ⚠️ **Caution!** If the wires are not inserted in the middle of the plug, the wires will short circuit, when plugged into a ballast or complete fixture, causing a controller overload (8B, see also paragraph 7.4.3).
  - Crimp the RJ 14 plug on the RJ wire.

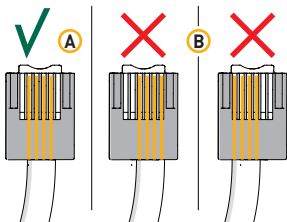

8 Wiring a RJ14 plug

#### 4.4. Connecting the controller to External Contactor Modules (ECMs) to control auxiliary equipment

- ⚠️ **Warning!** ECMs can handle equipment with a resistive load (AC1) up to 16A. The maximum allowable current can be limited by local type of plugs (e.g. UK = 13A). Higher currents may be supported by using ECMs to trigger heavier contactors.
- ⚠️ **Warning!** To prevent over-current, always determine the maximum allowable current for your (local) cabling before connecting a load to the ECM.
- ⚠️ **Warning!** Never connect the cage clamps of the ECM to any other device than the Gavita EL2 controller.
- ⚠️ **Warning!** Never connect more than one ECM to each set of cage clamps of the controller.

- ⚠ **Warning!** Ensure all wire ends are fully inserted into the cage clamps. Exposed wire endings can be dangerous!
- ⚠ **Caution!** To prevent potential crop damage, ECMs are automatically shut down after a temperature alarm, a sensor failure or during a power interruption. This function only works in the "Auto" mode (see paragraph 6.6).

The Controller can control up to two External Contactor Modules. These ECM modules are contactors and can activate or deactivate auxiliary equipment. Auxiliary equipment may include a CO<sub>2</sub> source or a non-dimmable light during "lights-on" periods or for example a room heater during "lights off".

The controller is connected to the ECM by means of a signal cable. This signal cable is plugged into the cage clamps of the controller and the ECM. The controller has two ECM ports marked "ECM1" and "ECM2". ECM port 1 follows the output of the main channel of the controller (on when lights in main room are on). ECM port 2 works inverse of ECM port 1 and is switched on when the main channel is off (on when when the lights in the main room are off, in the dark period). For more information about connecting ECMs to the controller, consult paragraph 4.4.2 and 4.4.3.

#### 4.4.1. Connecting the signal cable to the controller and the ECM(s)

- Press the white buttons above the contact openings of the cage clamps to open them (9A) (when using solid cable ends this is not required)
- Insert the endings of the included signal cable into the desired cage clamps of the controller (9B). A cable of up to 20 meters may be used. The endings need to be stripped 8mm and preferably be tinned or finished with cable end sleeves
- Release the buttons to lock the wires in place
- Connect the wire to the cage clamps of the ECM in the same way (10).

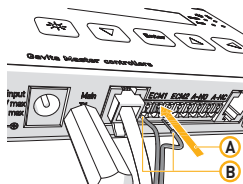

9 Connecting a signal cable to the controller

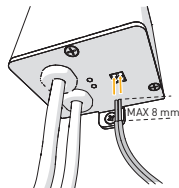

10 Connecting a signal cable to the ECM

- ⓘ **Note:** For more information on connecting an ECM to the auxiliary equipment, consult the ECM manual.

#### 4.4.2. Controlling auxiliary equipment in “Follow mode” (one room)

**⚠ Caution!** Gavita recommends you install and connect the ECM before plugging it into the mains.

**! Note:** When activated, the blue light on the ECM will burn.

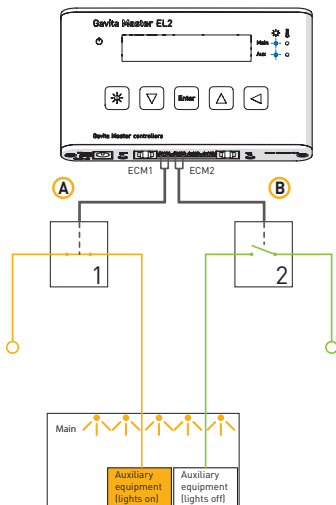

### 11 Controlling auxiliary equipment in “Follow mode”

#### 4.4.2.1. Connecting equipment which must be used during lights-on periods

**! Example:** a CO<sub>2</sub> source, light or watering unit may be activated during lights-on periods.

- Connect the ECM to the cage clamps marked “ECM1” (11A)
- Plug the auxiliary equipment into the female plug of the ECM power cords
- Plug the ECM male plug into a mains receptacle.

#### 4.4.2.2. Connecting equipment which must be used during lights-off periods

- ❗ **Example:** a heater may be activated during lights-off periods.
  - Connect the ECM to the cage clamps marked "ECM2"(11B)
  - Connect the auxiliary equipment which must be activated during lights-off periods to the ECM connected to clamps marked "ECM2".

#### 4.4.3. Controlling auxiliary equipment in "Inverse mode" (two rooms 12h/12h)

- ⚠ **Caution!** Gavita recommends you install and connect the ECM before plugging it into the mains.
- ❗ **Note:** Two ECMs are needed for a two room setup.
- ❗ **Note:** When activated, the blue light on the ECM will burn.
  - Link one ECM to the controller cage clamps marked "ECM1" and a second ECM to the controller cage clamps marked "ECM2".

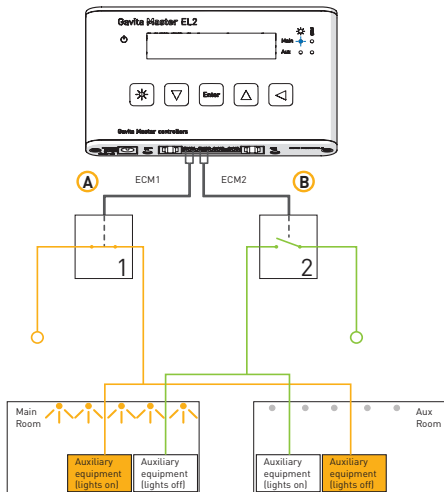

### 12 Controlling auxiliary equipment in "Inverse mode"

#### 4.4.3.1. Connecting equipment which must be used during lights-on periods

- ① **Example:** a CO<sub>2</sub> source, light or watering unit may be activated during lights-on periods.
- Connect the auxiliary equipment in the “main” room which must be activated during lights-on periods to the ECM connected to clamps “ECM1” (12A)
  - Connect the auxiliary equipment in the “aux” room which must be activated during lights-on periods to the ECM connected to clamps “ECM2” (12B).

#### 4.4.3.2. Connecting equipment which must be used during lights-off periods

- ① **Example:** a heater may be activated during lights-off periods.
- Connect the auxiliary equipment in the “main” room which must be activated during lights-off periods to the ECM connected to clamps “ECM2” (12B)
  - Connect the auxiliary equipment in the “aux” room which must be activated during lights-off periods to the ECM connected to clamps “ECM1” (12A).

### 4.5. Connecting a temperature shutdown, sensor failure or power-off alarm to the controller

- ⚠ **Warning!** The alarm feature only works in the “auto” mode (see paragraph 6.6).
- ⚠ **Warning!** The alarm contacts are rated for a maximum of 13,5V/50mA.

The controller has two pairs of cage clamps marked “A-NC” (normally closed) and “A-NO” (normally open).

When a temperature shutdown, sensor failure, or power failure occurs, the “A-NC” contact opens and the “A-NO” contact closes. Both pairs of cage clamps may be connected to an alarm installation or a text messaging module.



#### 4.5.1. Connecting an alarm wire to the controller

- To connect an alarm to a cage clamp, take the wire from the alarm, split it in two and strip the ends bare. The endings need to be stripped 8mm and preferably be tinned or finished with cable end sleeves
- Press the white buttons above the contact openings of the cage clamps under A-NC or A-NO (when using solid cable ends this is not required)
- Insert both wire ends of the alarm system in a separate opening, the polarity of the wires does not matter
- Release the buttons to lock the wires in place.

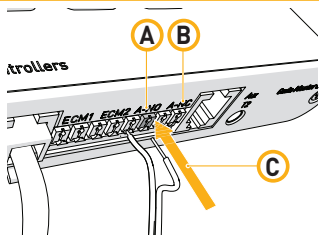

13 Connecting the alarm wire to the controller

## 4.6. Connecting the controller to the mains

**⚠ Warning!** When power on the controller, the connected ballasts may ignite. Either:

- make sure your ballasts are not connected to mains yet or
- the signal cable of the ballasts is not inserted in the controller yet

before connecting and programming the controller.

- Plug the adapter into the AC outlet
- Plug the DC connector of the adapter into the DC inlet of the controller. (14A) The green power indication (14B) will start blinking, to indicate the power was interrupted
- Hold the reset button ◀ for 3 seconds. The green power indication will start to burn continuously.

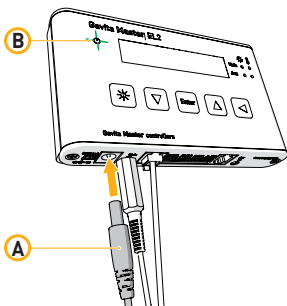

14 Connecting the controller to the mains

## 5. Preparations before use

**⚠ Caution!** Set the controllers output mode to "OFF" (see paragraph 6.6.) to ensure no ballasts will be accidentally activated during the controller setup. After this it is safe to either connect the ballasts to mains or insert the signal cable to the ballasts into the controller.

**ⓘ Note:** after 60 seconds of inactivity the controller interface will return to the main menu.

**ⓘ Note:** to leave any screen without saving changes, press the arrow key ◀.

**ⓘ Note:** lesser used functions can be accessed faster by clicking the arrow key ▲.

- Ensure you have carried out all applicable steps from chapter 4
- Plug the ballast in the mains. The status led on the ballast will indicate that they are connected to the controller
- Examine whether all LEDs show the correct code. Check the connections when you see an error code. In case an overload is indicated on the controller display please check if you did not make a cabling error connecting a RJ connector [see paragraph 4.3.3.]
- Verify your controller is ready for use by performing the actions described in this chapter.

### 5.1. Localizing your controller

#### 5.1.1. Selecting your default language

The controller can be set to five languages: Dutch, English, German, French and Spanish.

- Press "enter", the controller menu will open
- Press the arrow keys ▲▼ to locate "language" and press "enter". The "language" screen will open
- Press the arrow keys ▲▼ to locate your language. Press "enter" to confirm your choice and return to the controller menu.

#### 5.1.2. Switching between 24 hour and AM/PM clock mode and setting the time

- Press "enter", the controller menu will open
- Press the arrow keys ▲▼ to locate "System time" and press "enter". The "System Time" screen (15) will open. In this screen the "clock mode" indication blinks (15A)
- Press the arrow keys ▲▼ to switch between the 24-hour and the AM/PM-hour clock mode. Press "enter" to confirm your choice. The "hour" indication (15B) will start blinking
- Press the arrow keys ▲▼ to select the correct hour. In a AM/PM-hour clock mode, continue pressing to select AM/PM. Press "enter" to confirm.
- Use the same procedure to set the "minutes" (15C). Press "enter" to confirm your choice and return to the controller menu.

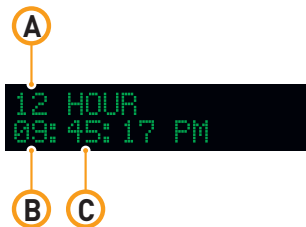

## 15 Switching clock mode and setting the time

### 5.1.3. Switch temperature units between °Fahrenheit and °Celsius

- Press "enter", the controller menu will open
- Press the arrow keys ▲▼ to locate "Temp units" and press "enter". The "temperature units" screen will open
- Press the arrow keys ▲▼ to switch between °F and °C. Press "enter" to confirm your choice and return to the controller menu.

### 5.2. Calibrating the temperature sensor(s)

- ⚠ **Caution!** The controller will not immediately display the correct temperature when the sensor is plugged in. The sensor will take some time to respond to temperature changes.
- ⚠ **Caution!** To allow for accurate temperature management within the climate room, the temperature measured by the controller must match the temperature measured by the climate control system. If these values do not match, the temperature safety system of the Gavita controller may interfere with the climate control system.
- ⚠ **Caution!** Always place the temperature sensor of the controller as close as possible to the temperature sensor of the climate control system.

If necessary, the temperature measured by the Gavita controller can be adjusted to match the temperature measured by the climate control system.

- Press "enter", the controller menu will open
- Press the arrow keys ▲▼ to locate "Calibrate" and press "enter".

The "Calibration" screen will open (16). This screen displays the temperature measured by the main temperature sensor "T1" (16A) and auxiliary temperature sensor "T2" (16B). If one or both temperature sensors are not or incorrectly connected, the text "removed" or "failure" will be displayed behind the applicable temperature sensor.

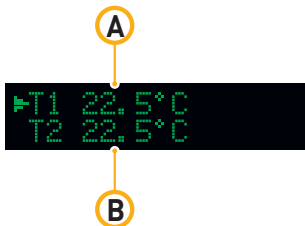

#### 16 Calibrating the temperature sensor

- Use the arrow keys ▲▼ to switch between “T1” or “T2” and press “enter” to select the temperature value you wish to adjust
- Use the arrow keys ▲▼ to adjust the temperature to the desired value and press “enter” to confirm your choice.

**!** **Note:** The calibrated temperature values are stored in the internal memory of the controller. Resetting the controller will restore these values (see paragraph 6.7).

### 5.3. Change the display mode from the controller output from % to Watts

- ⚠ Caution!** The wattage displayed by the controller only serves as a visual aid, calculating the output in wattage from the set percentage. If a 400W ballast model is selected in the controller but a 1000W ballast is connected, the ballast will still provide a 1000W output at 100%.
- ⚠ Warning!** Always use the % setting when ballasts with different wattages are used simultaneously.

By default the controller represents ballast output as a percentage of the total output (17A). The controller can also convert this percentage into Watts if the wattage of the ballast is known.



---

#### 17 Default output display

- Press "enter", the controller menu will open
- Press the arrow keys ▲▼ to locate "Display mode" and press "enter". The "Display mode" screen opens
- Press the arrow keys ▲▼ to select which type of ballasts you have connected: 400W, 600W, 750W, 1000W, or select percentage in a mixed environment
- Press "enter" to confirm your choice.

The "main" screen and the "output level" screen (see paragraph 6.1) will now represent the ballast output in Watts (18B).

---



---

#### 18 Output display in Watts

## 6. Programming and using the controller

**⚠ Caution!** Set the controller's output mode to "OFF" (see paragraph 6.6.) to ensure no ballasts will be accidentally activated during the controller setup.

Follow the actions listed below to quickly start using the controller.

- Set the controller output level (see paragraph 6.1)
- Program a light cycle (see paragraph 6.2)
- Set the output mode of the controller to "follow" or "inverse" (see paragraph 6.3)
- Set the auto-dim temperature (see paragraph 6.4.1)

- Set the shutdown temperature [see paragraph 6.4.2]
- Set sunrise/sunset period (optional) [see paragraph 6.5]
- Activate the auto mode on the controller [see 6.6.]

## 6.1. Adjust ballast output to change light intensity

The controller can set the output of a ballast between 50 and 115 percent. Adjusting this ballast output enables the user to change the light intensity in the climate room.

- Press the \* quick-key, the “output level” screen opens
- Press the arrow keys ▲▼ to set the ballast output between 50 and 115 percent (400W, 600W and 750W fixtures can only be boosted up to 110%)
- Press “enter” to confirm your choice.

**Note:** the output level can also be found in the general menu.

### 6.1.1. Control a lamp with a lower power rating than its ballast

**Warning!** When fitting a lamp with a lower output than its ballast, ALWAYS adjust the output level of the ballast before switching the light on. Failing to do will cause immediate damage to the lamp.

A ballast may be used to control a lamp with a lower power output than the nominal value of the ballast. For example: a 1000 watt ballast set at 750 watt can be used to control a 750 watt lamp. To prevent damage to the light, the controller output must be adjusted to the appropriate value.

- Disconnect the ballast(s) from the mains
- Make sure the display mode of the controller is set to represent the output power of your ballast, NOT of your lamp [see paragraph 5.3]
- Adjust the ballast output to match the wattage of the lamp [see paragraph 6.1]
- Exchange the lamps of all connected ballasts
- Reconnect the ballast to the mains.

## 6.2. Programming a light cycle

- Press “enter”, the controller menu will open
- Press the arrow keys ▲▼ to locate “Light Cycle” and press “enter”. The “Light Cycle” screen will open. [19] In this screen the hour indication behind “ON” blinks [19A]
- Press the arrow keys ▲▼ to select the hour on which the lights must be activated and press “enter” to confirm your choice.
- Use the same procedure to set the minute [19B] on which the lights must be activated and the hour [19C] and minute [19D] on which the lights must be deactivated.

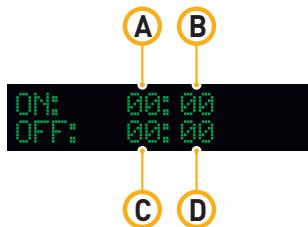

## 19 Programming a light cycle

### 6.3. Set follow- or inverse mode (aux function)

The controller can be set to activate and deactivate all ballasts connected to it simultaneously. In this manual, this mode will be referred to as the "Follow Mode".

The controller may also be set to invert the output of its main and the auxiliary channel. This means the auxiliary channel and the ballasts connected to it, are switched off when the main channel and the ballasts connected to it are switched on. An inverted light cycle may be used to alternate light between two rooms in a 12/12 hour system. Such a system may be used in the generative phase to optimize power utilization. In this manual this mode will be referred to as the "Inverse Mode".

**⚠ Caution!** Always set the light interval to 12 hour periods in the "Inverse mode".

- Press "enter", the controller menu will open
- Press the arrow keys ▲▼ to locate "Aux function" and press "enter". The "Aux Function" screen opens.
- Press the arrow keys ▲▼ to switch between "follow" and "inverse".
- For the "Inverse mode", select "inverse" and press "enter". The output of the Aux channel will now be off when the main channel is on.
- Set the light interval to 12 hour periods (see paragraph) to ensure both climate rooms are equally lit. The selected "ON"- "OFF" period will be set for the main channel. (The aux channel operates inverse of the main channel).



## 6.4. Set temperature safety settings

When the temperature in a climate room gets above a certain value, the planted crops will start to degrade. If this rise in temperature occurs, it is desirable to dim or shut down the lights in the climate room to reduce the temperature in the room.

The controller offers the possibility to set a temperature at which it will dim the lights and a temperature on which it will shut down the lights. Through its temperature sensors, it can sense when a harmful temperature is reached. To set the auto-dim temperature, go to paragraph 6.4.1. To set the shut-down temperature, go to paragraph 6.4.2.

### 6.4.1. Setting the auto-dim temperature

- Note:** The default auto-dim temperature is set at 30 °C / 86 °F.
- Note:** The auto-dim temperature cannot be set higher than the shutdown temperature.
- Note:** The auto-dim will decrease the light intensity to 50% over a span of two degrees Celsius or 3,6 degrees Fahrenheit (20)
- Warning!** Always set the auto-dim temperature at least two degrees Celsius / 3,6 degrees Fahrenheit above the temperature of the climate control system. This will prevent the controller from interfering with the climate control system.

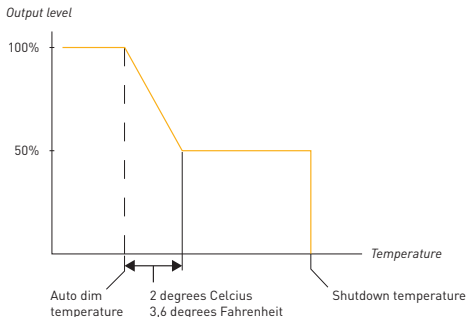

20 Auto-dim and shutdown behavior

- Press "enter", the controller menu will open
- Press the arrow keys ▲▼ to locate "Auto-Dim Temp" and press "enter". The auto-dim temperature screen opens
- Press the arrow keys ▲▼ to increase or decrease the temperature.
- Press "enter" to confirm.

Once the auto-dim temperature is reached, the controller will automatically start dimming the lights. No auto-dim will occur if the shutdown temperature is set at the auto-dim temperature.

- ! **Note:** the auto-dim will stay on until half a degree Celsius / 0,9 degrees Fahrenheit under the set temperature.

#### 6.4.2. Setting safety shutdown temperature

- ! **Note:** The default shutdown temperature is set at 35 °C /95 °F.
- ! **Note:** The safety shutdown temperature of the controller cannot be set lower than the auto-dim temperature.
- ⚠ **Warning!** Always set the shutdown temperature so it does not accidentally deactivate the lights.
- ⚠ **Warning!** After a shutdown, a manual reset is required.

- Press "enter", the controller menu will open
- Press the arrow keys ▲▼ to locate "Shutdown Temp" and press "enter". The "Shutdown temperature" screen opens
- Press the arrow keys ▲▼ to increase or decrease the temperature.
- Press "enter" to confirm.

Once the shutdown temperature is reached (20), the controller will automatically shut down all the lights and all the equipment connected to the ECMs. The A-NC and A-NO alarm contacts will also switch (see paragraph 4.5).

### 6.5. Setting the sunrise and sunset period

To allow crops to adjust to either a lights-on or lights-off period, a sunrise and sunset period may be set. During this period, the light intensity increases from 50 percent to up to the desired intensity.

- Press "enter", the controller menu will open
- Press the arrow keys ▲▼ to locate "Sunrise/sunset" and press "enter". The "Set ramp time" screen opens
- Press the arrow keys ▲▼ to increase the ramp up/down time to up to 30 minutes. 0 minutes indicates no ramp up/down time
- Press "enter" to confirm your choice.

## 6.6. Activate or deactivate the lights manually or set automatic mode

- ⚠ **Warning!** When replacing a light, setting the ballast to "Off" to override the clock is insufficient! ALWAYS disconnect the ballast from the mains.
- ⚠ **Warning!** When the controller "Output mode" is set to "on" or "off", the temperature safety features of the controller will not work.
- ⓘ **Note:** The on and off mode are included to allow for replacement of ballasts and testing of lamps.
  - Press "enter", the controller menu will open
  - Press the arrow keys ▲▼ to locate "Output mode" and press "enter"
  - Press the arrow keys ▲▼ to switch between "auto", "on" and "off"
    - Select "on" to turn all the lights on. This setting will ignore temperature safety settings. (see paragraph 6.4)
    - Select "off" to turn all the lights off
    - Select "auto" to follow the programmed light cycle (see paragraph 6.2) and temperature safety settings (see paragraph 6.4)
  - Press "enter" to confirm your choice.

## 6.7. Resetting the controller to factory settings

The factory reset will return all values to factory settings. It will also undo any changes to the temperature calibration of the temperature sensors.

- Press "enter", the controller menu will open
- Press the arrow keys ▲▼ to locate "Factory Reset" and press "enter". The "Factory Reset" screen opens
- Press the arrow keys ▲▼ to switch to "yes" and press "enter". The controller is now reset to factory settings.

## 7. Interpreting controller information

### 7.1. Reading the default screen

The default screen displays the temperature measured by one or two temperature sensors (21A). The screen also displays the output of both its channels, either in % or in Watts (21B). If an error occurs, it may also be displayed in the display. (See paragraphs 7.3 and 7.4 for potential error messages).



21 Default screen

### 7.2. Show system time

- Press an arrow key ▲ or ▼ in the default screen to show the system time
- Press an arrow key ▲ or ▼ again to return to the default screen.

### 7.3. Interpreting LED signals

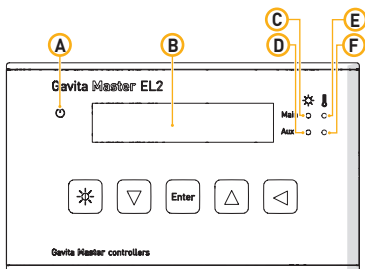

22 LED signals

#### 7.3.1. Green light (22A)

A burning green light indicates the controller is functioning.

A blinking green light indicates the power has been interrupted.

After a power failure the blinking green indicator must be reset;

- Hold the reset button ◀ for three seconds to reset the indicator.

#### 7.3.2. Blue light (22C/22D)

A burning blue light indicates the ballasts connected to the “main” and/or “aux” channel are activated.

A blinking blue light indicates an overload in the main or aux channel (see paragraph 7.4.3).

When a blue light is off, it indicates the connected ballasts are deactivated.

#### 7.3.3. Red light (22E/22F)

A blinking red light indicates the auto-dim temperature is exceeded (see paragraph 7.4.4).

A fast blinking red indicates the shutdown temperature has been exceeded (see paragraph 7.4.5).

A burning red light indicates the auto-dim temperature has been exceeded in the past (see paragraph 7.4.4).

### 7.4. Interpreting display messages

#### 7.4.1. Sensor disconnected

The message “Sensor disconnected” appears when one or two temperature sensors are not plugged in. All devices connected to the controller are deactivated.

- Plug in the missing sensor to resolve.

#### 7.4.2. Sensor failure

If the message “sensor failure” appears, the sensor is defect. All devices connected to the controller are deactivated. The controller must be reset.

- Replace the temperature sensor
- Hold the reset button ◀ for 3 seconds.

#### 7.4.3. Controller Overload

If the message “controller overload” appears, either the main or aux channel of the controller has been overloaded. The blue led indicator behind the overloaded channel will also start flashing. An overload may occur when the wiring connected to the main or aux channel of the controller has

short circuited. All devices connected to the controller will be deactivated. The controller must be reset;

- Check which channel indicates the overload
- Search for faulty wiring or contacts and replace it
- Hold the reset button ◀ for 3 seconds.

#### 7.4.4. Auto-dim

When the auto-dim temperature has been exceeded, the message “auto dim” will appear on the display next to the corresponding channel. The red light will also flash. The flashing will continue until the temperature drops half a degree Celsius/ 0.9 degrees Fahrenheit below the auto-dim temperature for at least 30 seconds.

A burning red light indicates the auto-dim temperature has been exceeded in the past.

- To resolve a burning red light, hold the reset button ◀ for three seconds to reset the warning.

#### 7.4.5. Temp Alarm

When the shutdown temperature has been exceeded, the message “Temp alarm” will appear on the display and the red light will flash rapidly. All devices connected to the controller are deactivated. The controller must be reset;

- Ensure the temperature of the room is below the shutdown temperature. If the temperature is still above shutdown temperature, the controller cannot be reset
- Hold the reset button ◀ for three seconds to reset the controller (see for more information about wiring the RJ4 connector paragraph 4.3.3).

### 7.5. View the software version on the controller

Your reseller or Gavita Holland bv may request the software version of your controller to check for compatibility with (future) Gavita products.

- Remove the DC plug from the controller (your data will be saved by an internal battery)
- Plug the DC plug back in, the software version will be displayed for a few seconds [23].



---

23 Example display software version

## 8. Maintenance and Repair

- ⚠ **Warning!** Do not open or disassemble the controller, it contains no serviceable parts. Opening the controller will void its warranty.
- ⚠ **Warning!** Do not use acids, solvents, abrasives or other aggressive substances to clean the controller as this may cause damage.

The Gavita Master controller EL2 is maintenance free.

- The Controller may be cleaned with a soft dry cloth
- Please contact your reseller in case of controller malfunction.

## 9. Environment and Disposal

ATTENTION: THIS PRODUCT CONTAINS A BATTERY.  
MUST BE DISPOSED OF PROPERLY.



The symbol on the material, accessories or packaging indicates that this product may not be discarded as household waste. Dispose of the equipment through a recycling center that handles electronics and electrical appliances within the EU and in other European countries which use separate collection systems for used electronics and electrical appliances. By disposing of the equipment in the proper way, you will be helping to prevent possible risks to the environment and public health, which might otherwise be caused by improper handling of the discarded equipment. Recycling of materials contributes to the conservation of natural resources. Therefore, please do not dispose of your old electronics and electrical appliances via household waste.

## 10. Warranty

Gavita Holland warrants the mechanical and electronic components of their product to be free of defects in material and workmanship if used under normal operating conditions for a period of two (2) years from the original date of purchase. If the product shows any defects within this period and that defect is not due to user error or improper use Gavita Holland shall, at its discretion, either replace or repair the product using suitable new or reconditioned products or parts. In case Gavita Holland decides to replace the entire product, this limited warranty shall apply to the replacement product for the remaining initial warranty period, i.e. two (2) years from the date of purchase of the original product. For service return the product to your shop with the original sales receipt.

## 11. Appendix I – Overview of all screens on display

	▶OUTPUT MODE OUTPUT LEVEL	OUTPUT MODE ▶AUTO	OUTPUT MODE ▶ON
	OUTPUT MODE ▶OUTPUT LEVEL	OUTPUT LEVEL ▶100%	OUTPUT LEVEL ▶893W
	OUTPUT LEVEL ▶LIGHT CYCLE	ON: 09:00 OFF: 21:00	ON: 09:00 OFF: 21:00
	LIGHT CYCLE ▶AUX FUNCTION	AUX FUNCTION ▶FOLLOW MAIN	AUX FUNCTION ▶INVERSE
	AUX FUNCTION ▶AUTO-DIM TEMP	AUTO-DIM TEMP ▶30.0°C	
	AUTO-DIM TEMP ▶SHUTDOWN TEMP	SHUTDOWN TEMP ▶35.0°C	
	SHUTDOWN TEMP ▶DISPLAY MODE	DISPLAY W OR % ▶100%	DISPLAY W OR % ▶400W BALLASTS
	DISPLAY MODE ▶SUNRISE/SUNSET	SET RAMP TIME ▶NONE	SET RAMP TIME ▶03 MIN
	SUNRISE/SUNSET ▶SYSTEM TIME	24 HOUR 21:45:17	12 HOUR 09:45:17 PM
	SYSTEM TIME ▶TEMP UNITS	TEMP UNITS ▶°C	TEMP UNITS ▶°F
	TEMP UNITS ▶CALIBRATE	▶T1 22.5°C T2 22.5°C	T1 22.5°C ▶T2 22.5°C
	CALIBRATE ▶LANGUAGE	LANGUAGE ▶ENGLISH	LANGUAGE ▶ESPANOL
	LANGUAGE ▶FACTORY RESET	FACTORY RESET ▶NO	FACTORY RESET ▶YES
FAILURES	27.5°C OFF SENSOR FAILURE ↔	27.5°C OFF 9.9°C OFF	Sunrise/set 22.5°C ↑ 550W 25.2°C OFF 27.8°C ↓ 783W 22.4°C OFF
	27.5°C OFF SENSOR REMOVED ↔	27.5°C OFF 9.9°C OFF	
	27.5°C 1000W OVERLOADED ↔	27.5°C OFF 23.2°C OFF	
TEMP	28.5°C 1000W AUTO-DIM 926W ↔	28.5°C 1000W 30.0°C 926W	TIME SYSTEM TIME 08:42:38 PM
	23.5°C OFF TEMP SHUTDOWN ↔	23.5°C OFF 35.3°C OFF	



OUTPUT MODE  
▶OFF

GAVITA - EL2  
02013 v1.1

ON: 09:00  
OFF: 21:00

ON: 09:00  
OFF: 21:00

DISPLAY W OR %  
▶600W BALLASTS

DISPLAY W OR %  
▶750W BALLASTS

DISPLAY W OR %  
▶1000W BALLASTS

12 HOUR  
09:45:17 PM

12 HOUR  
09:45:17 PM

LANGUAGE  
▶FRANCAIS

LANGUAGE  
▶DEUTSCH

LANGUAGE  
▶NEDERLANDS

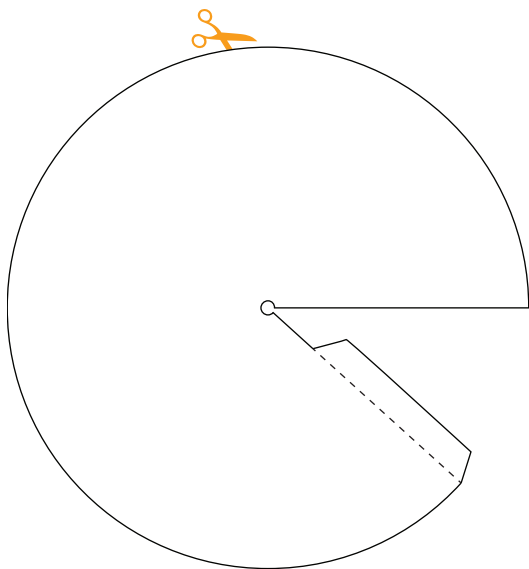



CE

