

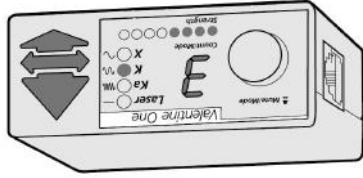

THIS INTERFACE IS COMPATIBLE WITH



*Valentine One + remote display*

**INTERFACE**



## 1. Congratulations

Thank you for purchasing the Cheetah Radar Detector Interface for your Valentine One.

Cheetah invented the concept of using GPS speed to suppress false alarms on other manufacturers' radar detectors. This product will wirelessly link your V1 with your Cheetah GPS camera detector, making them work as one complete, integrated system to enhance the V1 with voice alerts and false alarm suppression. Make sure you read the section on "Setting up your Cheetah" to get the most out of your set up.

Enjoy your new "quieter" detector. I know you're going to love the way they work together.

Drive safely,

Al Smith, Director, Cheetah Advanced Technologies Ltd

## 2. Pack Contents

- 1 x RADARnode wireless transmitter
- 1 x RDI software card for the V1 (inserted in RADARnode)
- 1 x Cheetah connector cable for the V1
- 1 x Cheetah V1 remote adapter
- 1 x Cheetah connector cable for the RADARnode
- 1 x User manual

© 2009 Cheetah Advanced Technologies Ltd, Scotland. All rights reserved.

This device complies with Part 15 of the FCC Rules. Operation is in compliance with the essential requirements and other relevant provisions of Directive 1999/5/EC. Cheetah Advanced Technologies Ltd. declares that this product is in compliance with the essential requirements and other relevant provisions of Directive 1999/5/EC.



If any problems persist, or to arrange a product return, please email [support@SpeedCheetah.com](mailto:support@SpeedCheetah.com)

Europe & Rest of World - visit [www.SpeedCheetah.com](http://www.SpeedCheetah.com)

USA & Canada - visit [www.GPSdetector.com](http://www.GPSdetector.com)

If for any reason your Cheetah product develops a fault, please check our Customer Service page on:

**Service & Support**

[www.SpeedCheetah.com](http://www.SpeedCheetah.com)

Limited Warranty Cheetah Advanced Technologies Ltd. warrant our products against all defects in materials and workmanship for a period of **one year** from the date of the original purchase. Full warranty terms and conditions available online at:

**Limited Warranty**

Register online at [www.SpeedCheetah.com](http://www.SpeedCheetah.com)

**Warranty Registration**

**Warranty & Support**

## 3. The RADARnode Transmitter

The RADARnode is a wireless transmitter (433 Mhz) that connects up to your radar detector's power supply socket. When your radar detector gives an alert, the RADARnode digitally analyzes the alert data and instantly transmits a radio code to your Cheetah GPS detector, which immediately gives you the V1 alert using Cheetah voice and tones.

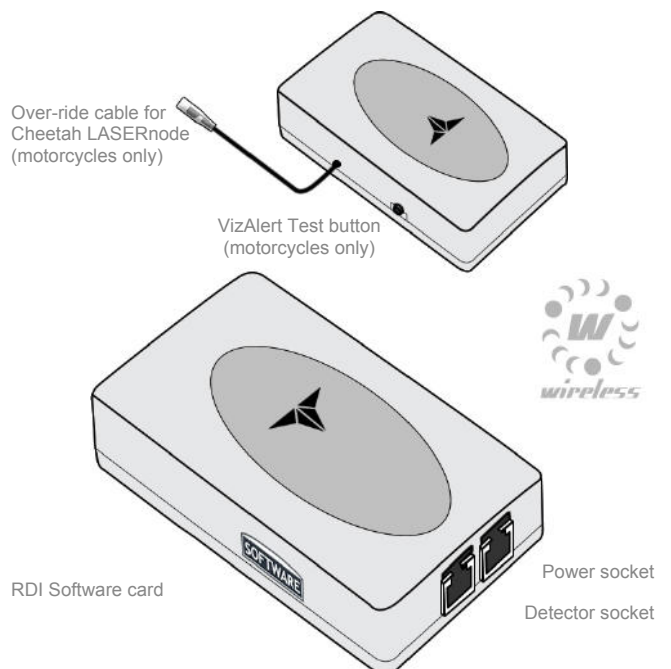

# Cheetah Radar Detector INTERFACE

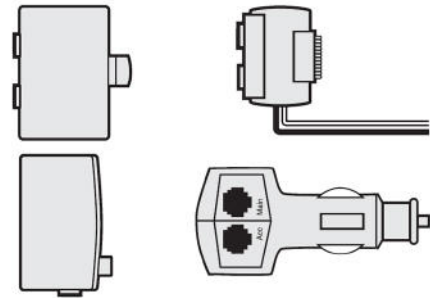
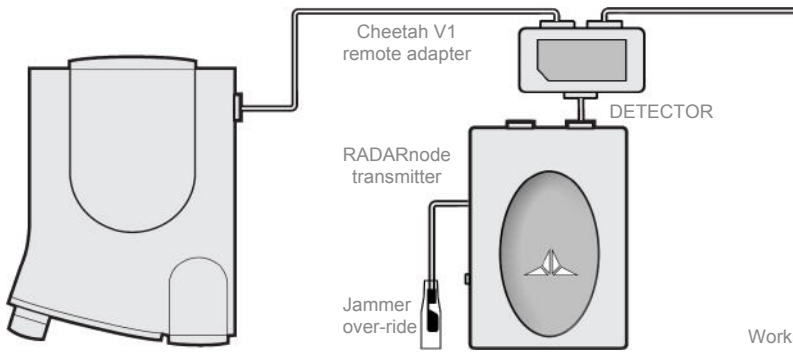

Works with any combination of Valentine remote displays and power supplies

## 4. Installing the RADARnode

Before you begin installation, double check that the RDI software card and connector cable are correct for your radar detector. The RDI software card is pre-installed in the side of the RADARnode transmitter. **Always ensure that the power is OFF before removing or inserting your RDI software card.**

Instal the RADARnode according to one of the wiring options above.

**4.1** Remove your Valentine power cord from your V1. Plug the end of the Cheetah connector cable labelled "V1" into your Valentine detector.

**IMPORTANT** - the Cheetah connector cable for the V1 must be installed the correct way round. **If the cable is inserted the wrong way round it will not work.**

**4.2** Safely route the RDI connector cable from your V1 to the Cheetah V1 remote adapter and plug it into the socket marked DETECTOR.

**4.3** Connect the Cheetah V1 adapter to the DETECTOR socket on the RADARnode transmitter. The POWER IN socket on the RADARnode is not used in this application.

**4.4** Plug your existing Valentine power supply into the POWER IN socket of the Cheetah V1 adapter.

**4.5** Plug your existing Valentine power cord into the POWER IN socket on the RADARnode.

## 5. Setting up your Valentine 1

V1 menu items can be set according to personal preference.

## 6. Setting up your Cheetah

Use Button 1 on your Cheetah to cycle through the main menu. Use button 2 (+) and button 3 (-) to adjust the settings of any menu item and press button 4 to save your changes.

### False Alarm Suppression (Button 1)

**1. Audible Alert Speed** - set the speed limit threshold for radar alerts, e.g. 35mph. Drive slower and radar alerts are automatically muted, drive faster and you hear them again. There is an automatic override for serious alerts (KA band and laser).

### Radar Band Selection (Button 1)

**5. X Band 6. K Band 7. KA Band 8. KU Band**

Use button 2 (+) and button 3 (-) to enable or disable alerts for these radar bands, then press button 4 to save.

### Voice Only alerts or Voice plus Alert Tones (Button 4)

Pressing button 4, outside of the main menu, swaps the alerts between "Voice + Tone" alerts (city mute OFF) and "Voice Only" alerts (city mute ON).

## 7. Using your Cheetah & V1 together

**7.1 Start-up tones** - When you switch on your V1, it's start-up tones will trigger a brief K band and laser alert on your Cheetah to confirm that the wireless link is operational. **To avoid this, switch on the V1 first, before your Cheetah.**

**7.2 Wireless link** - A short time after you switch on your detectors, you will see a small red wireless symbol appear on the Cheetah GPS detector. This shows that the wireless datalink is active and V1 alerts will be provided instantly.



**7.3 Radar detector alerts** - When your Valentine One picks up a signal, a voice alert from your Cheetah will announce the radar band being picked up.

Warning tones are also given for the duration of an alert. There are different warning tones for each radar / laser band. The Cheetah detector will continue alerting for as long as the V1 does. **A confirmation "chirp" signals the end of an alert.**

**7.4 Ku band users (Europe)** -Please note the V1 uses the same audio tone for K and Ku bands. The RADARnode listens to the audio, so therefore it will transmit a K band warning for both K and Ku alerts.

**7.5 Signal strength** - Radar alerts on the Cheetah will ramp up in 5 stages as the signal strength increases, from 1 tone per second, up to 5 tones per second:

V1 display strength 1-2 is transmitted as signal strength 1  
V1 display strength 2-4 is transmitted as signal strength 2  
V1 display strength 4-5 is transmitted as signal strength 3  
V1 display strength 5-6 is transmitted as signal strength 4  
V1 display strength 7-8 is transmitted as signal strength 5

The actual alert given by your Cheetah may vary occasionally from the V1 display as the RADARnode responds to the V1's AUDIO signal and NOT the display.

**7.6 Radar Mute** - During a radar alert, press button 3 to mute the remainder of an alert.

**7.7 City Mute during an alert** - If you want to swap from VOICE+TONE alerts to VOICE ONLY alerts (or vice versa) during an alert, you still need to press button 4, but hold it down for a little longer than normal, until you hear the voice confirmation that the mode has changed.

## 8. Troubleshooting

**8.1 Constant KU Band radar alert** - RDI software card is not correctly installed. It must be fully inserted into the slot on the side of the RADARnode. Switch off power, then remove the card and re-insert flush. **Always ensure the power is OFF before removing or inserting your RDI software card.**

### 8.2 No wireless link symbol

Check the power connections to the RADARnode and V1.