

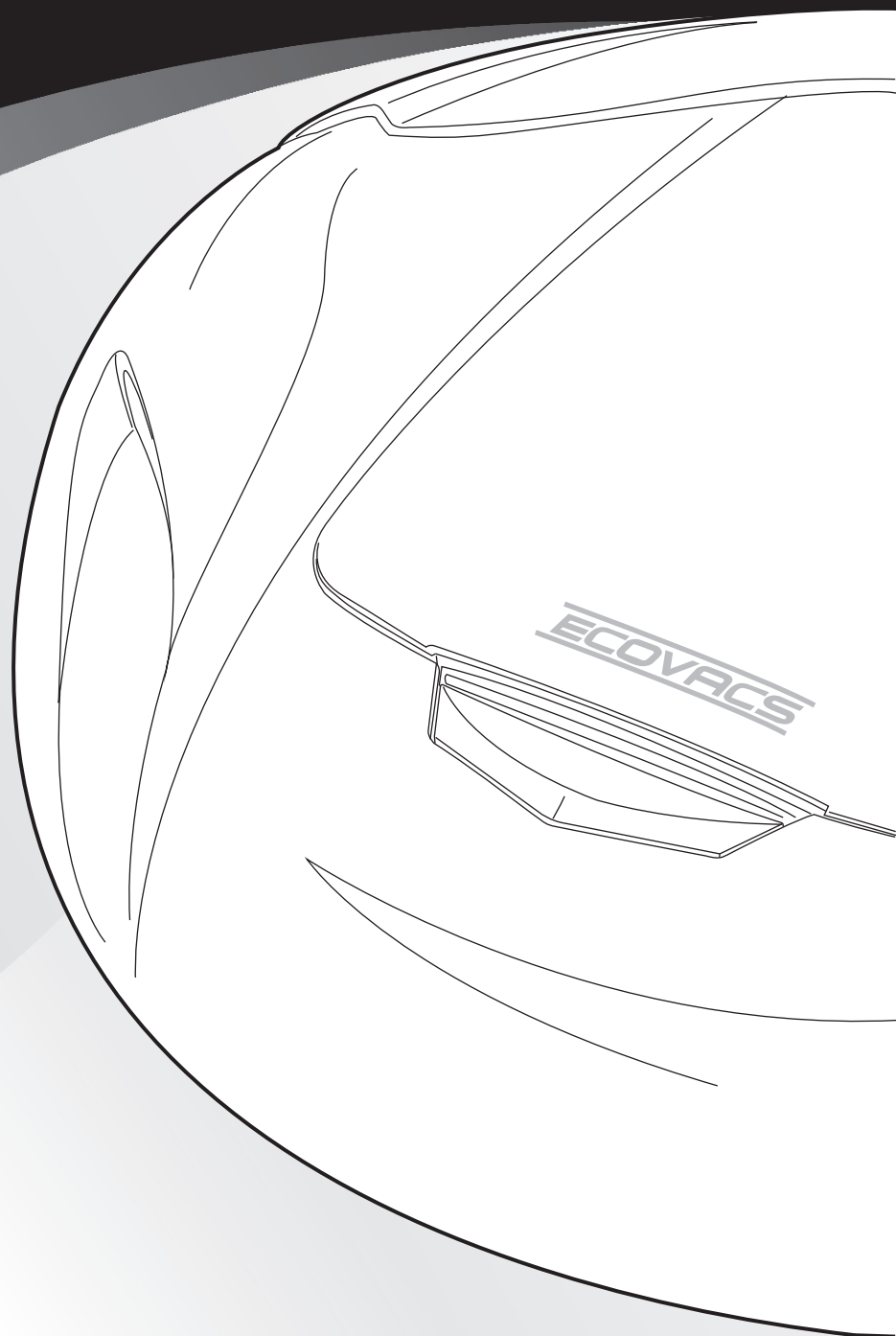

ECOVACS

Robot Vacuum Cleaner

Deebot

D54 USER GUIDE



Thanks for purchasing ECOVACS  patented Robot Vacuum Cleaner products. Hope you can enjoy it !
Thanks again for your choice!

Thank you for your choice!

Content

1. Safety Instruction.....	3	7. Go Back Charging.....	13
User Guide.....	3	8. Cycle cleaning.....	14
Power Supply for the Product.....	3	Set Cycle Cleaning.....	14
The Spectrum of Product Use.....	4	Cancel Cycle Cleaning.....	14
Notes before Cleaning.....	5	9. Day-to-Day Storage.....	14
Child Safety.....	5	10. Maintenance.....	15
Battery Replacement and Disposal.....	6	Host Cleaning.....	15
Resource Utilization.....	6	Dust Box Cleaning.....	15
When Product is in Failure.....	6	Sponge Filter and Dust Box Cleaing.....	16
2. Content in the Original Package and Technical Parameter.....	7	Sponge Filter Replacement.....	17
3. Name of Parts.....	8	Main Brush Cleaning.....	17
Host.....	8	Side Brush Cleaning.....	18
Control Panel.....	9	Replace Side Brush.....	18
4. Battery Charging.....	9	Up-Ground Height Sensor Cleaning....	18
Placement of Charging Block.....	10	Dust Sensor Cleaning.....	19
Robot charging.....	10	11. Alarm function.....	19
5. Power On/Pause/Power Off.....	10	12. Common Failure.....	20
Get pawer supply and power On.....	10	13. Other Problems.....	21
Pause.....	11		
Power Off.....	11		
6. Mode Selection.....	12		
Auto Mode.....	12		
Intensive cleaning Mode.....	12		

1. Safety Instruction



Where there is a drop off in the cleaning area due to a step or stairs and they are not carpeted, you should operate the unit to see that the unit can detect the step without falling over the edge. It may become necessary to place a physical barrier at the edge to keep the unit from falling over the drop but make sure the physical barrier is high enough so that you or a family member will not trip on the barrier and cause themselves injury.

⚠ Note:

- ▶ Do not open the equipment. The components inside the robot host are beyond repair by user himself.
- ▶ This product is only for domestic use, not suitable for industry or outdoor surroundings.

The User Guide

Please conform to the basic safety precautions as follows:

- Read the content in this user guide carefully and install the robot according to the detailed instructions.
- Safekeeping this guide. If you transfer this machine to another person, please make sure attach this booklet.
- Any inconsistent operation with this guide would probably cause serious damage to both human being and the machine itself.

Power Supply for the Product

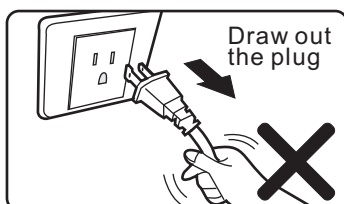
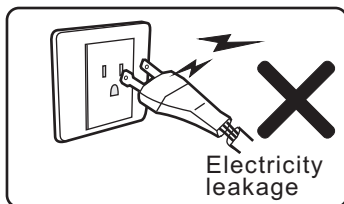
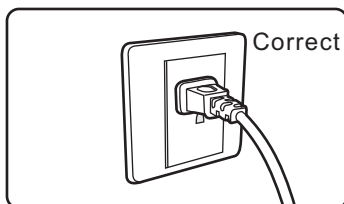

- The power supply is from a Ni-MH chargeable battery inside the host of the robot and it is specially assigned with a charging block to do recyclable charge.
- Please double check the marked supply voltage on the charging block and make sure it is applied according to the instructions.
- Do not use the damaged power cord or plug, while contact our after-sales service or find our authorized supplier to maintain.
- As the charging block is heavy, please never drag the block via pulling it's power cord.
- Remember never to twist and swing or screw the power cord excessively, neither to block it when close the door. We should not put heavy things on it as well.
- Do not let power cord touch hot or sharp surfaces.
- Do not draw out the plug by pulling the cord.
- Keep wet hands away from the plug or machine.
- Pull the plug out of socket when you no longer use the charging block for some time.
- Use dry cloth to wipe the dust on the plug frequently.

The Spectrum of the Product Use

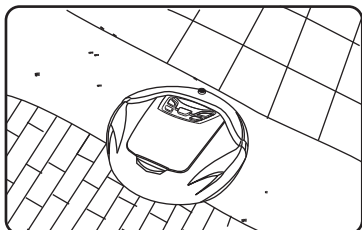

- This robot is applicable to domestic sweeping, including wooden floor, rubber floor, ceramic tile, linoleum and medium or short-haired carpet however, it is inapplicable to long-haired carpet.

- It can not be used for the floor as below:

----- Have water on the surface (including flammable liquids), such as wet floor.

----- Inside toilet, shower room or other humid situation.

----- Staircase

----- The room with furnace or flame

- The following objects are definitely forbidden:

----- Not extinguished soot, burning cigarette butts or match, because these objects would cause fire.

----- Sharp objects like glass debris, pin, paper clip, stones, gypsum, and large piece of paper. These things may block the machine.

----- Water or other kind of liquid, especially detergent, kerosene, petrol, paint, alcohol, perfume, as well as carpet or floor cleaning solution. It would make the interior of the machine wet, so that may cause short-circuit.

----- The toner of laser printer and copier which may bring fire and explosion.

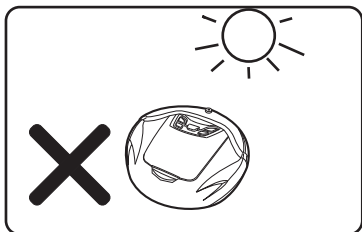
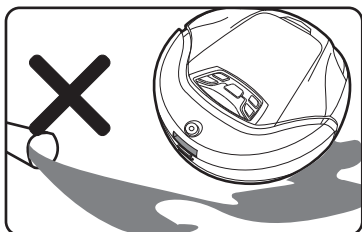
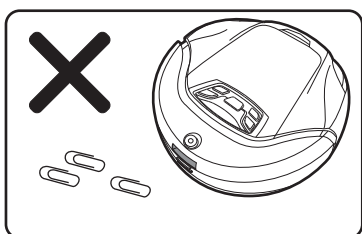

- Please keep the machine away from hot source such as oven and fireplace, because the hot can distort the crust.
- Do not use the machine in the surroundings with any explosion risk. For example, at gas station, oil depot, chemical plant and so on.
- Never use the machine outdoors. As rain or solid dust may get inside it and cause damage.
- Do not repair or change any performance by yourself.
- Do not throw or bend the machine.
- Do not dampen it, or else the short-circuit would cause fire or electric shock accident.
- Take care of routine maintenance and keep it in a clean place.
- Do not expose the machine in the extreme hot or cold surroundings. This product is not allowed to long-time kept in the temperature below zero or over thirty degree.
- Do not keep the machine in the liquid or expose it to high humidity.
- Do not place the machine close to burning cigarette or fire.

Notes before Cleaning

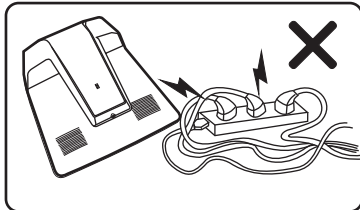
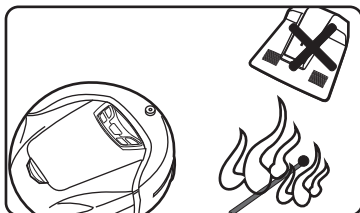
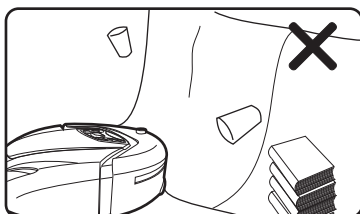
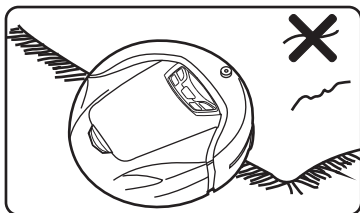

- Take extra care of the robot when the first it works. Please remove the obstacles when it is beyond the robot. Try to avoid the situation that the robot stops working.
- Make precautions to solve the problem which may make the cleaning in trouble, such as:
 - Keep the easily knock over objects in a safe place.
 - Permian the edge of the carpet.
 - The hanging table cloth and curtain should not touch the ground.
 - The flammable object should be cut from the fire source.
 - Sort out the tangled power cord on the floor.
 - Pick up the newspaper, book, magazine and large piece of paper scattered on the floor.
- Check whether the main brush is correctly fixed inside the robot before cleaning.
- Examine if the dust box is empty and insure it is fixed before it works.
- See if up-ground height sensor and dust sensor are wiped clean.
- If you only need to clean one room, please close the door.

Child Safety



- Child, physically or mentally disabled and inexperienced are not allowed to use it, unless their safety supervisor is there to give instruction.

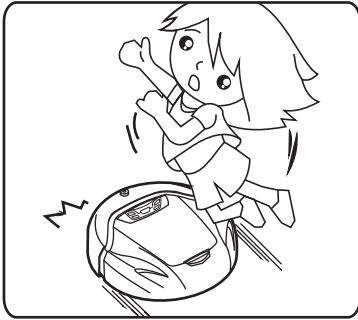

- Take good care of the product and keep it beyond child and people who can not judge danger nearby. Extra attention should be paid when it starts working.
- You should get the person inside the room know that the machine is working, in order to avoid man-made damage like tripping.
- Do not take robot as toy. Carefully attention should be paid when child or pet is around.
- The plastic package may bring danger of asphyxia and is supposed to keep away from child.

Battery Replacement and Disposal

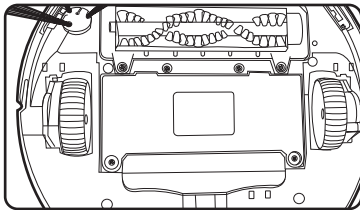

- You need to contact our after-sales when you want to change the battery. It will cause explosion if you use replacement battery of wrong model.
- There is potential danger if you use other producer's battery and charging block. The damage cause hence is not within the warranty.
- Please dispose the spent battery properly, because there is hazardous substance which may pollute the environment.
- Conform with local environmental legislation and dispose it at the recovery site.

Resource Utilization



- Do not take the package material as domestic garbage and discard it freely.
- Please deliver the package material to proper recovery site for recycle.

When Product is in Failure

- Do not repair or disassemble the machine when there is damage of the power cord or failure of the host.
- Contact our after-sales service or our designate maintenance organization for professional repair.

2. Content

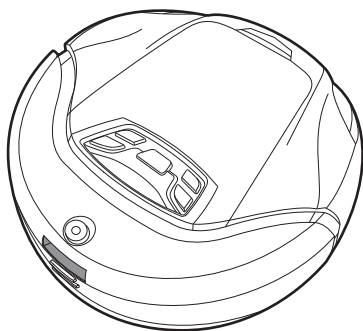

Host

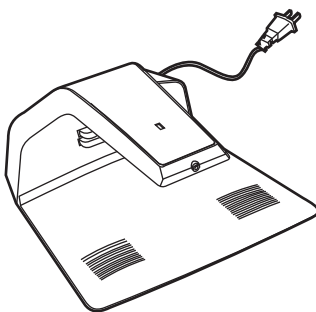

Charging block

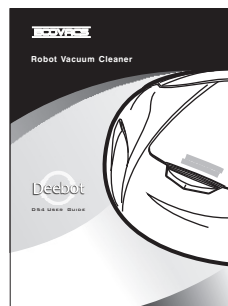

User guide

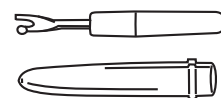

Roll brush clean-up gadget

technique parameter

The host		The charging block	
Working voltage	DC14.4V	In-put voltage	220-240V~
Rated power	30W	rated out-put voltage	DC17.5V
Speed	0.25meter/second	rated frequency	50Hz
Capacity of dust box	0.7L	rated power	30W
Noise	≤62dB	rated out-put currency	0.7A
Charging duration	About 4~5 hours		
Duration upon full battery 60 minutes	45 minutes		
Max Coverage upon full battery	90-120M ²		
Size	335×335×100mm		
Net weight	2.8Kg		

3.Name of parts

host

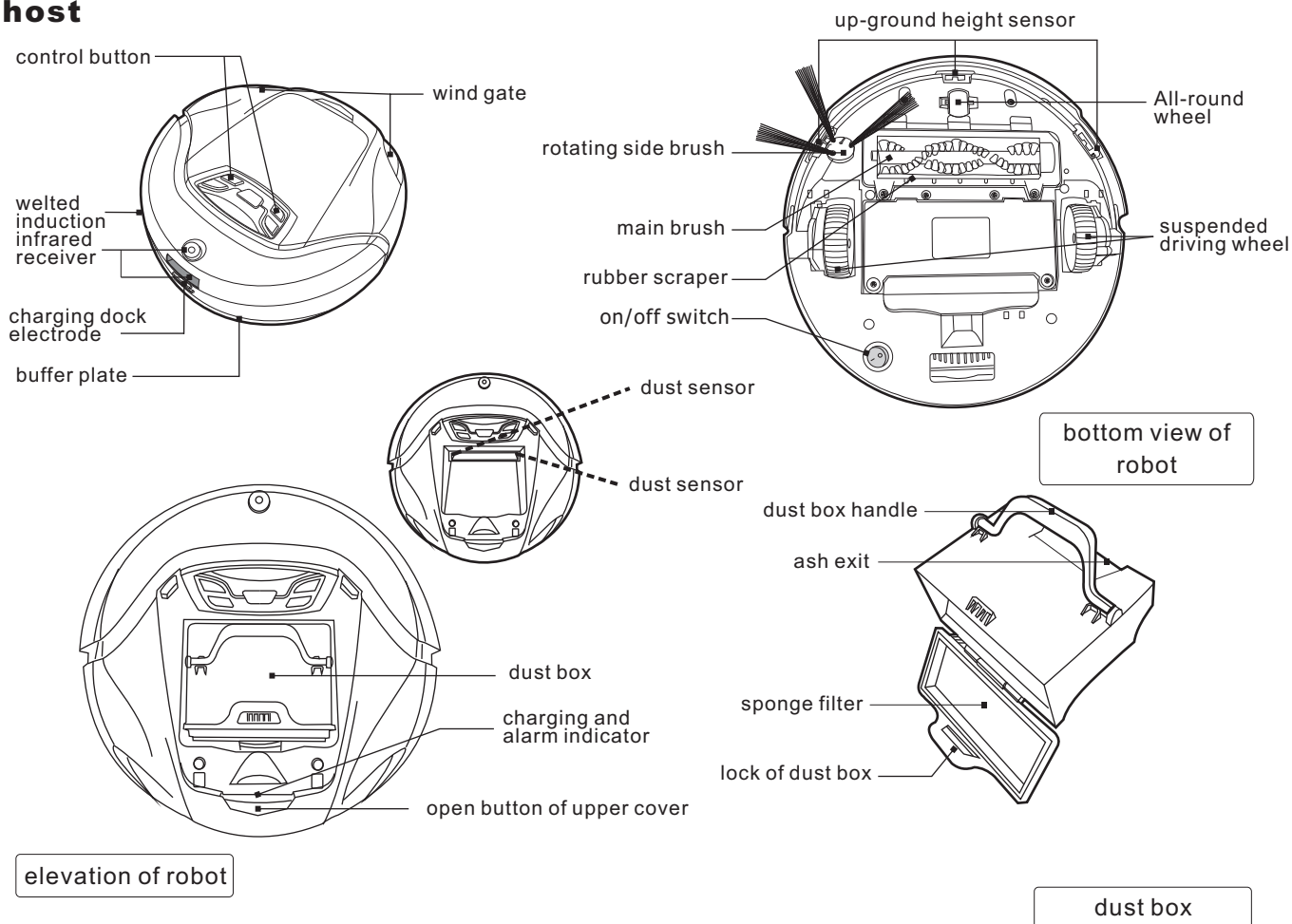

Control Panel

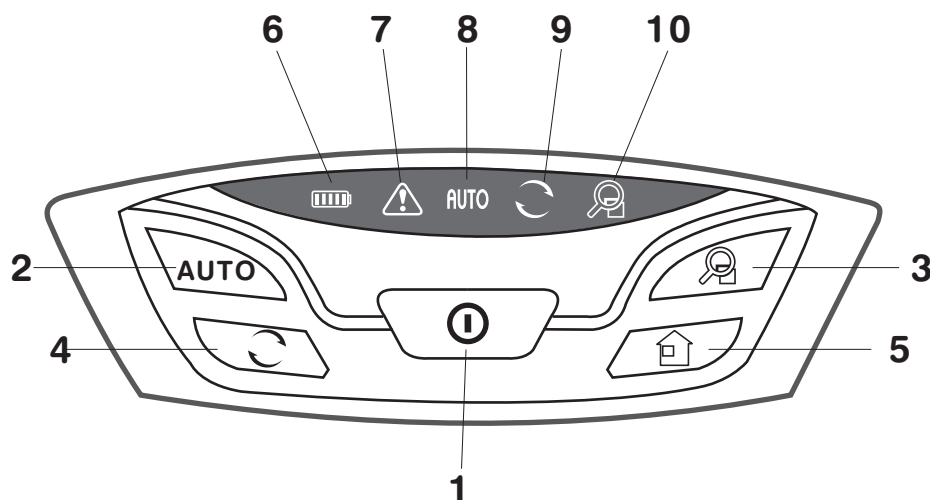

1. Power
2. AUTO mode button
3. intensive mode button
4. Cycle mode button
5. Back charging button
6. Battery level
7. Alarming indicator
8. Auto mode indicator
9. Cycle mode indicator
10. Intensive mode indicator

4. Robot Charging

Placement of charging block

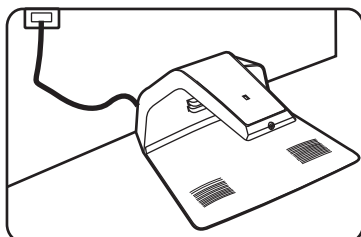

Put the block at an even place and make the base perpendicular to the ground. Meanwhile, take a look at the marked electricity voltage to make sure the product is used under instruction.

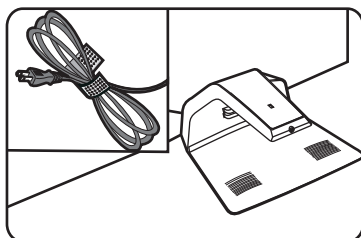

Tangle the power cord and do not scatter it besides the block in case that robot would get impeded when it turns back.

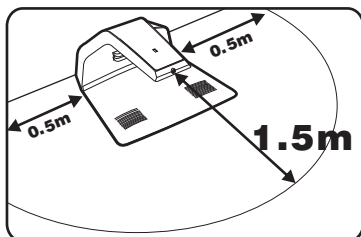

There should not be any object at least 1.5 meter in front of the charging block. Besides, anything with strong reflector is not supposed to stay ahead of the infrared receiver. For example, ground glass, smooth ceramic vase and so on. Otherwise, the machine shall not detect the charging block.

Tips:

Please do not put the charging block to the staircase to avoid accidental cases.

Robot Charging

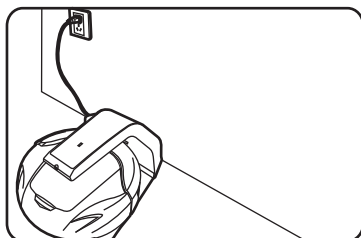

- You need to charge the robot the first time it works. Put away the full-charged battery for use to ensure it's performance.
- Charging duration should be around 4-6 hours.
- Charging is only allowed under the temperature between 0 and 45 degree and extreme hot or cold would extend charging duration or even cause damage to the battery.

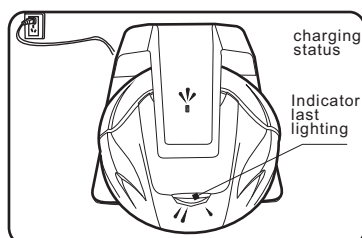
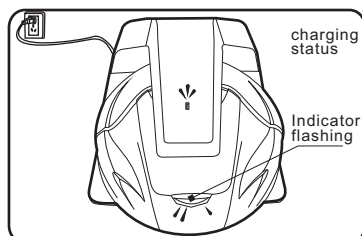

Tips:

- ▶ To make sure the robot is working in saturation, we suggest you to keep charging connected even though the charging indicator lasts lighting. At the same time, the system would transfer to weak current for supplementary charging.
- ▶ According to actual ground situation, robot can keep working for around **45** minutes after being charged full.
- ▶ The capacity of battery, which is not used for long time, will get certain decrease, so the use time can be shorten accordingly.

5.Power On/Pause/Power

Get power supply and power on

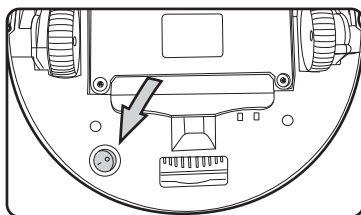

- Turn on the power switch on the bottom firstly.

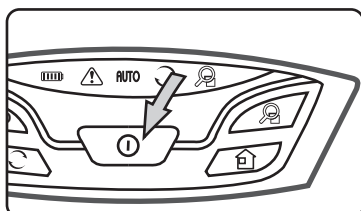

- Get power supply and press the  button on host. There would be a short music tip and at the same time the battery indicator lights.

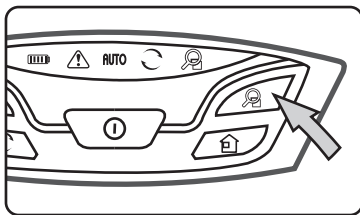

- Then choose the cleaning mode according to your needs. Press **AUTO** or  button, the robot starts to work.

Pause

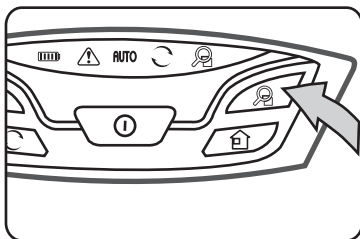



- Press any button except the power button, it can pause the operation of robot and keep it stay where it is.

Tips:

- ▶ On the status of pause, you can reset the cleaning mode, then press **AUTO** or  button to restart the robot.
- ▶ Another way to pause the robot is that you can press any button or lift the robot.

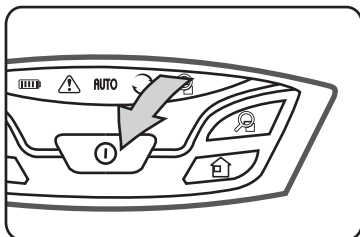
Power off



- Press  button, power is off and robot stops running.

Tips:

- ▶ If you want the robot to stop running, you can press  button under pause status.
- ▶ Put the robot back to the charging block after it stops working for fear that others would be tripped.

Tips:

- ▶ Put the robot on the charging block and keep it charging after finishing house cleaning.
- ▶ Do not keep the robot on pause status for long time, because the full charged battery could only last for around **20** hours. We suggest you to turn it off when you do not want it to work.

6. Mode Selection

AUTO Auto Mode

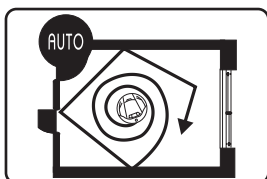
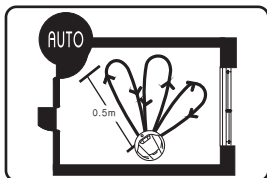
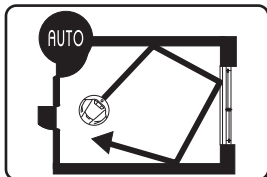

Under the Auto Mode, the AUTO indicator lights.

Route description: First the robot going straight ahead, it turns when it meets obstacle. The robot will go back charging before run off the battery.

- If take this mode, the cleaning coverage would reach maximum compared by the same ground situation.
- We recommend this mode when the ground is not too dirty and needs the quick cleaning.

If robot detects that there is plenty of dust during the clean process. It will take the fan-shaped or spiral route.

- ▶ Under normal circumstance, it will take spiral route when it detects plenty of large particles, and will take fan-shaped route when few of small particles.
- ▶ The clean can last 45 minutes under this mode, when it detects low battery, the robot will go back charging automatically and the AUTO indicator disappeared.

Intensive Cleaning Mode

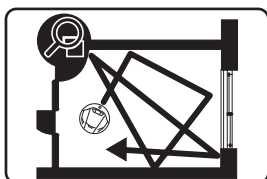

Route description: under this mode, robot takes the same route as automatic cleaning. It would search for charging block by itself before it runs of battery.

- ▶ Under the same ground circumstance, the cleaning effect is the best.
- ▶ If the ground is quite dirty, we recommend this mode.

7. Go Back Charging

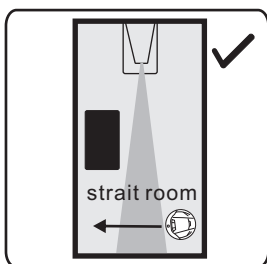
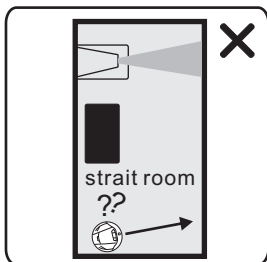
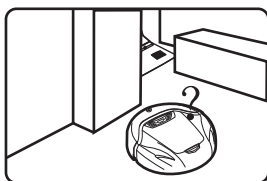
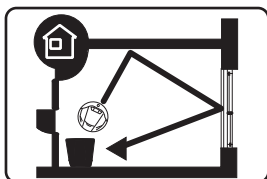

- When robot detects the low battery, it will go back charging automatically. Now, the battery indicator is yellow. You also can press  button to stop the working and go back charging, and the color of the battery indicator will not change.

Route description: Robot will search for charging block automatically when it detects low battery, after the charger connected successfully, the indicator light flashing.

- To make it easy for robot to search for charging block, you need to put the block back to the wall and make sure there is no obstacle within 1.5 meters ahead of the infrared receiver. Check carefully whether there is strong reflector in front of the charger, such as ground glass, smooth ceramic vase and so on.
- It takes time for robot to seek the charger. Robot can reserve enough battery to go back the charging block.
- If put the robot in a strait room, please make sure that there is enough space for robot to go back charging.
- Robot can return to the charger if the ground situation is not too complicated. Under extreme circumstance, such as, huge house, complex layout would bring difficulty for robot to seek for charger. So, you should help to put the robot back to the charging block.
- Please take care of the first automatic charging, if you find the robot keeps turning in the certain area after trying several times to seek back, you can help to place it on the charging block and look through the charging.
- When the robot goes back charging, the main brush will stop working. And robot shall stay at the charger when it finishes charging and it transfer to small currency to charge until you start operating.



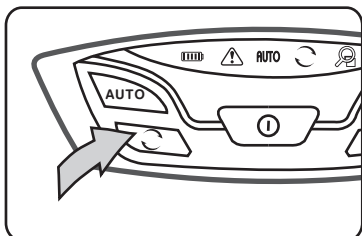

8. Cycle Cleaning

Set Cycle Cleaning



If you need the robot to work in the fixed time every day, please set the procedure as belowing instruction :

Turn on the power button, then press the  button, robot will work according to the AUTO mode till it show the low battery and go back to charging.

- The time you press the  button, then robot will start to work at that time next.
- If you set the Cycle Cleaning,  indicator will light on.
- After you set the cycle cleaning, please do not choose another mode, and also not press  button, otherwise, the cycle function will be canceled. If want to pause the robot, press any button (except power button). However, when you need to restart the robot, please still press  button. Press any button will cancel the cycle function.
- After set the cycle function, if you need the robot return to charging, please pause it at first, and move it to the charging block manually. Do not press the  button, which will cancel the cycle function.
- If you turn off the robot, although you have set the Cycle Cleaning, the robot will not work when the setting time coming.
- Please make sure the charging block have connected with the electrical source, otherwise, robot will not work due to the run out of the battery, even it is in the standby status.

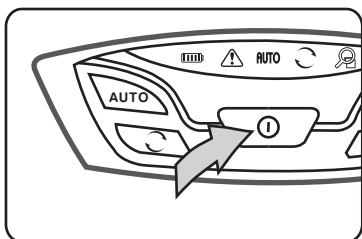

Cancel the Cycle Cleaning

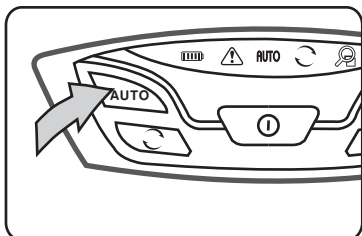

If you need to cancel the cycle function:

Method One: Turn off the power and restart the robot; the cycle function will be canceled.



Method Two: During the working status, press any button (except power button) to pause the robot, and then press  or  or  button, the cycle function will be canceled.

9. Day-to-day Storage

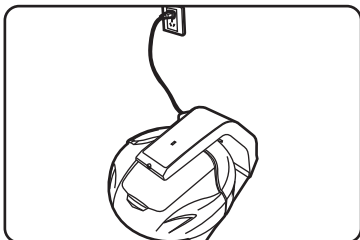

- You should keep robot stay at charger even though it finishes charging, because it will change to small current to supplement charging.
- Charge the robot until full battery and put it back to the package if you do not need to use it for long time. Keep the package in dry surroundings to avoid sunshine or humidity.

10. Maintenance

Host Cleaning

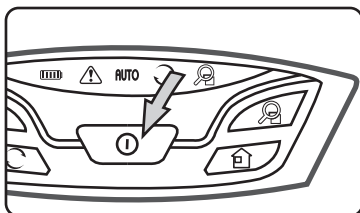

- Turn off the power before cleaning the host.
- Draw out the plug of charger before cleaning the block.

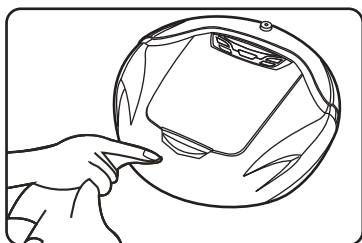

- Do not use petrol or oil-like to clean the surface, while you can use water or neutral detergent to scrub. Make sure you use dry cloth to wipe, because any water is not allowed to infiltrate into the machine.

Dust Box Cleaning

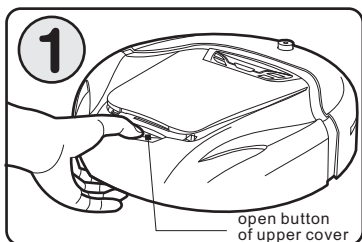

1. Turn off the power.
2. Press "open" button.
3. Take off the upper cover.

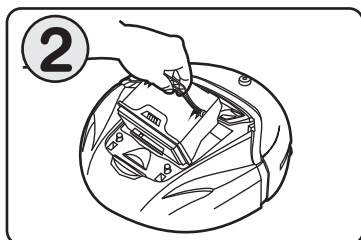

Hold the handle of dust box and lift it to take out.

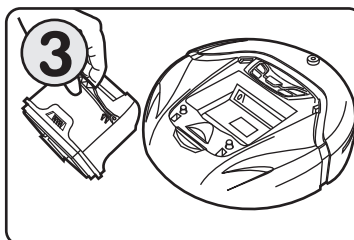

In order to avoid dust leaking, lift the suction up when you take out dust box. Please mind your speed doing this step.

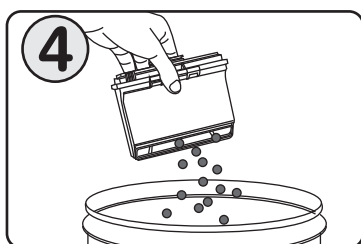

Match the bottom with trash can and swing dust box gently. You can mildly beating it along the edge of the can to get the dust out.

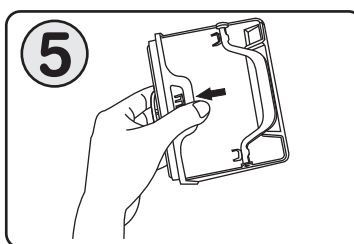

If there is too much dust on sponge filter, you can open the lock and take off the cover.

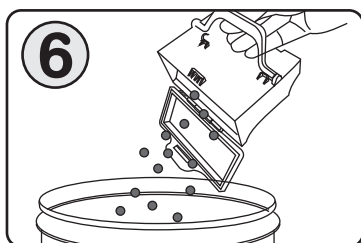

Pour out the dust on sponge filter.

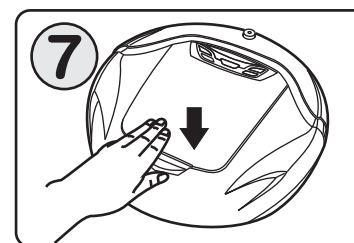

Close the cover and hear "kaca" sound which shows that it is placed. Put the dust box back into the host.

Tips:

If the dust box is not placed back or not properly placed. The  indicator lights.

Sponge filter and dust box cleaning

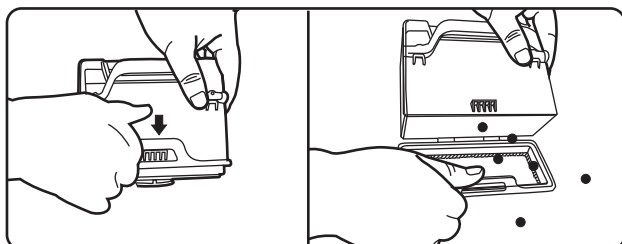

Open the lock at the bottom of dust box.

Pour out the dust on sponge filter.

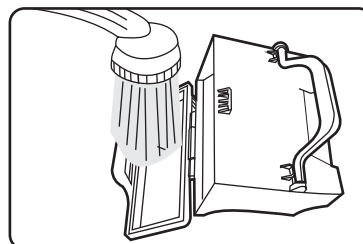

If there is too much dust along dust box, you can put the box under running water to get rid of the dust (make it dry under sunshine for 24 hours). Put it back into the host after the box and sponge filter is completely dry.

Sponge Filter Replacement

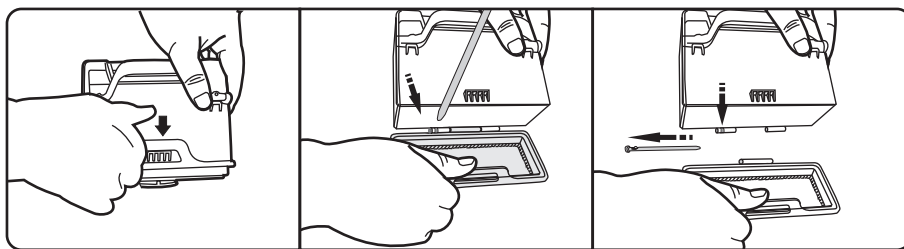

1. Open the cover of the Deebot, take out the dust box.
2. Push aside the lock catch of the dust box, then open the dust box and clean it.
3. Extract the axle of the dust box's cover.
4. Replace the sponge filter and fix the cover, then put it back into Deebot.

Main brush cleaning

Tips: Clean the main brush after it has operated for 4 or 5 recycles.

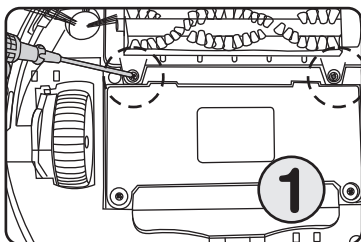

Undo the screw fixed on the main brush.

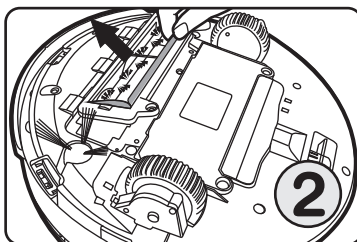

Take off the frame of main brush.

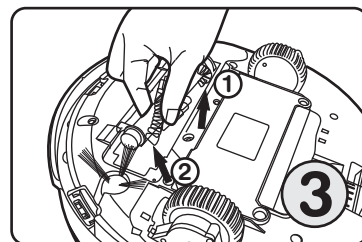

Take out one side of main brush from the belt.

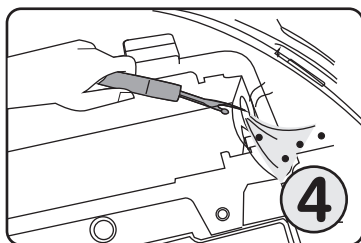

Remove the hair and dust which is in-between the belt.

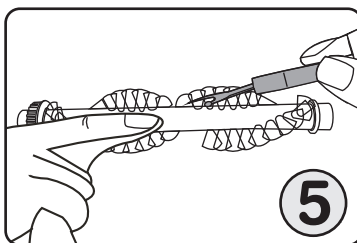

Rip off the hair on main brush with equipped roll brush cleaning gadget to break off the hair on main brush along the groove.

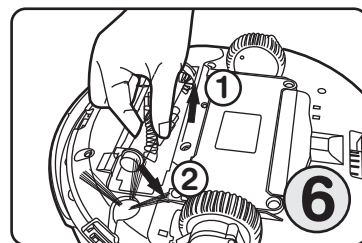

Wipe the dust on the roller and put it back.

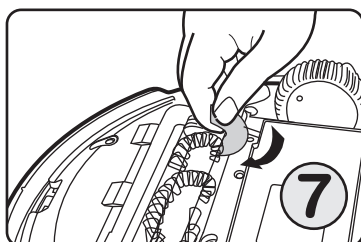

Put the main brush back to the host and take care of the anastomosis of belt.

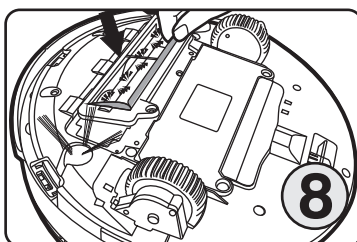

Fix the frame into host.

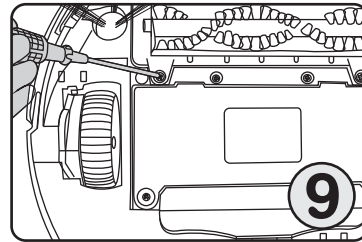

Tie up the screw.

Side brush cleaning

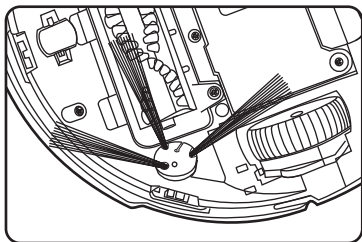

Side brush is a kind of easy wear part. We suggest you to check it every time it takes cleaning task. Please change it if necessary.



Note:

The host will alarm when the side brush tangled and the lights.

Replace side brush

Please replace the side brush when it is destroyed.

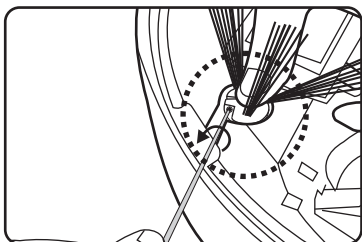

Please remove the screws, and take out the side brush.

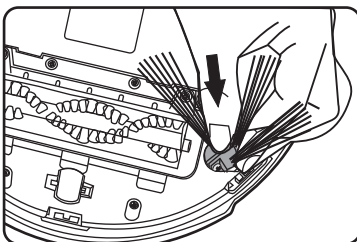

Please push the new side brush into the correct position.

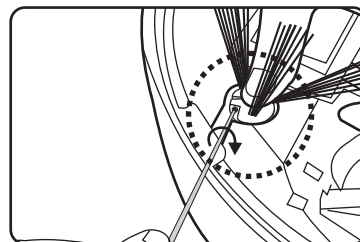

Tight the screws.

Driving wheel cleaning

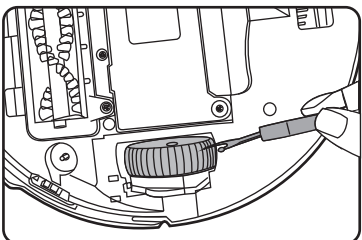

Please use the roll brush cleaning gadget to remove the dust or hair on driving wheel.



Note:

If the wheel is tangled by hair or cloth, the host will alarm and indicator will light.

Up-ground height sensor cleaning

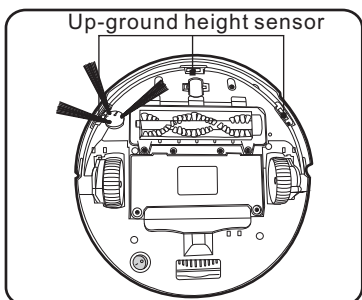

Up-ground height sensor is on the front bottom of robot. It can detect the height difference above 8 centimeters. We suggest you to wipe the optical board with dry cotton cloth after it finishes task to prevent the dust piling on it, which would affect its performance.

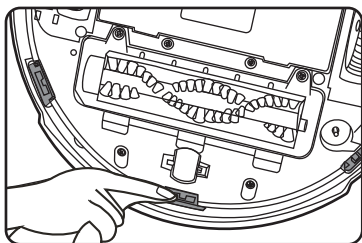

1. Turn off the power and remove the trash.
2. Invert the robot, and then put it on the even and clean platform.
3. Use dry cotton cloth to wipe three optical board of up-ground.

Dust sensor cleaning

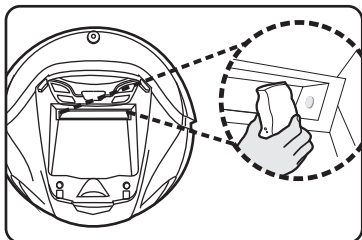

The dust sensor is located at the front of dust entrance. It is able to detect the concentration of dust so that it can choose efficient mode to work. We suggest you to clean dust sensor once you clean dust box to improve work efficiency.

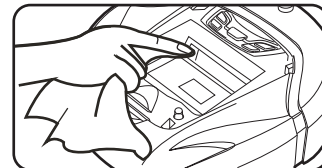

1. Turn off power.
2. Take out dust box and clean it.
3. Wipe the dust sensor with dry cotton cloth.

11. Alarm function



Note:

The robot will stop working and be alarm and tip sound at the same time. Please do as belowing to solve the problem.

Icon	Cause of failure	Solution	Instruction
	<ol style="list-style-type: none"> 1. Dust box is not fixed into host. 2. Dust box is not fixed properly. 	<ol style="list-style-type: none"> 1. Put dust box back into host. 2. Re-install dust box and press it down at the same time. 	
	<ol style="list-style-type: none"> 1. Main brush or driving wheel is tangled by hair or cloth. 2. Side brush is blocked. 	<ol style="list-style-type: none"> 1. Clean main brush. 2. Clean side brush and put it back. 	
	Driving wheel is suspended.	Put the robot at the even ground.	This function can prevent danger of child or pet lifting the robot when it is operating.
	Low battery.	Put the robot back manually.	<p>Yellow indicator means that the robot starts to look for the charging block.</p> <p>Red indicator means that the lower battery level, and please put the robot to the charging block manually.</p>

12. Common Failure

No.	Problem	Solution
1	Robot keeps proceeding or moving backward once power is on.	<p>Turn off the power.</p> <ol style="list-style-type: none"> 1. Check if there is dust on up-ground height sensor, which cause robot to make wrong signal. Use dry cloth to clean it. 2. Buffer collision is out of control. Put your hand at left, middle and right in turn to see if it can rebound by itself.
2	Robot is in trouble.	<p>Robot may fall in trouble when it is working. In such case, it will try every possibility to get out of trouble, but it shall stay at a certain place when it fails and starts alarm. You should help it and get rid of the obstacle.</p> <p>The trouble may be as follows:</p> <ol style="list-style-type: none"> 1. It is tangled by power cord. 2. It is tangled by hanging curtain or fringe. 3. Too many obstacles before the robot.
3	Robot fails to detect the stairs.	<p>Robot is able to detect most of the stairs over 8 centimeters height difference. However, its performance will weaken when it is smooth floor with height difference or the floor with strong reflector.</p>
4	The capacity to clean weakens.	<p>Turn off power and take out the dust box, then follow the steps as below:</p> <ol style="list-style-type: none"> 1. Check whether there is too much dust on sponge filter so that it needs to change it. 2. Make sure there is no dust which blocks the suction. 3. Take out main brush and clean it. Insure the both ends of main brush is not tangled by hair or fiber. Fix it back after it is been cleaned. 4. Examine if there is dust or debris near driving wheels. 5. Clean dust sensor. <p>If the failure still there after following the steps above, please contact our after-sales.</p>

5	There is much noise when the robot works.	<p>Turn off the power supply, and then take out of dust box. After removing the garbage, overturn the robot.</p> <ol style="list-style-type: none"> 1. Check whether the suction of main brush is blocked. 2. Examine and clean the main brush. 3. Examine and clean the side brush. <p>If the failure is still there after operating according to the above procedure, Please contact out after-sales service.</p>
---	---	--

13. Other Problems

<ol style="list-style-type: none"> 1. How long can robot last working under full battery? Answer: It differs from the ground situation, It takes around 45 minutes for even floor such as wooden floor and ceramic tile, and 20 minutes for short-haired carpet. 2. Is it allowed for the robot to work independently without taking care of? Answer: Yes. However, you should keep person in the room informed about robot operating to avoid tripping. 3. What kind of equipment inside the robot is used for dealing with failure? Answer: It is equipped with photosensitive components which can detect the stair over the height of 8 centimeters; for fear that it would fall over. 4. Is robot able to clean the bottom of the furniture? Answer: It is flat design, during normal cleaning, it can go into table and bed corner whose height is over 10 centimeters, such as bed, wardrobe, sofa and tea table. 5. Why does robot fail to work under set mode? Answer: Because when there is low battery, it will do back to charging mode automatically. 6. What's the cleaning coverage once it is charged full?(under automatic cleaning 	<p>mode)</p> <p>Answer: Under normal circumstance, it is around 90-120 sq, but it differs from the ground situation.</p> <ol style="list-style-type: none"> 7. Why does robot stop working once it meets obstacle? Answer: Under normal circumstance, robot will return or seek other route when it meets obstacle. However, if it controlled by remote control, it is not able to change route in case of obstacle. 8. Why there is garbage leaking from the machine while robot operating? Answer: a. Please check whether there is too much garbage in dust box (if there is too much dust on the floor, robot is not able to alarm after working for some time even though there is too much garbage in dust box.). That's why you need to clean dust box. b. See whether main brush is not cleaned for long time, as it is tangled with much hair and dust. 9. Why does robot fail to start cleaning on appointment time? Answer: a. Confirm whether there is much remaining battery. Appointment timing is not applicable when robot is returning to charge after operating cleaning. b. Check if robot is under standby status.
---	--

10. **Why robot is not charging as it is put in the charger? The charging indicator does not light as well.**

Answer: a. Examine whether the battery at the bottom is installed in place, if cover screw is loose, you need to fasten it. b. Check if there is power supply for the socket. c. Please contact our after-sales service when the failure is still there.

11. **Why does the speed of robot slow down sometimes?**

Answer: When robot detects there is much garbage and dust on the floor, it would turn to low speed proceeding automatically.

12. **Is there any danger to furniture and child when robot is proceeding?**

Answer: No. There is a soft rubber buffer made of PVC in front of the host. It would try other route once it touches furniture or child.

13. **Would robot affect pet?**

Answer: Robot makes low noise when operating, so there would be no shrill sound which may cause pet restless or even distrust. If you keep pet at home, we suggest you to notice the first time the robot operating.

14. **What should be noticed when cleaning the carpet?**

Answer: Robot is not able to clean long hair over 2 centimeters. Fold the banding first when you start cleaning.

15. **Does it matter to keep the robot at the charger when not using it?**

Answer: Yes. Robot will transfer to small currency to supplement charging. Please avoid wrong operation by child.

16. **Is there any danger to wrongly touch the docking electrode film between the host and charger?**

Answer: No. The two electrodes of charger is of no voltage under output mode (when there is no power supply); it's maximum voltage is 24V which is safe one under input mode (when it is charging).

17. **How does main brush avoid being tangled by power cord?**

Answer: Robot is probably get tangled by the wire scattered on the floor when it is operating. At that time, robot will try to turn back to get rid of it, and it will make alarm sound when it fails after trying several times.

18. **How can I stop the robot from operating on appointment time since I will be away from home for sometime?**

Answer: You can cancel cycle cleaning.

19. **How can I transfer my robot?**

Answer: You can lift it up with both your hands and lay on the ground quickly, dust and garbage in dust box will come out if it is not place back in time.

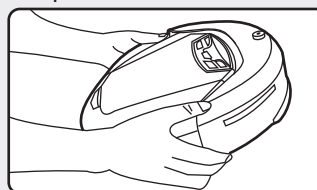

20. **How to use robot most effectively?**

Answer: Put the robot and charger in the same room, because it would shorten seeking time and it can extend the working time. If you need robot to clean every room of house, you should put the charger in the middle of house for the convenience of return back to charge.

21. **What should do if robot sucked liquid?**

Answer: a. Turn off the power and take out dust box, then empty it and wipe it dry. b. Draw out the sponge filter and wipe it dry. c. Take out main brush and clean it, then use day cloth to wipe the brush and its interior. Wait until the brush is dry and place it back. d. Let the product dry by itself for at least 12 hours (make sure circuit board is dry and then get power on).

If the procedures above still do not make it work, please contact our after-sales service.

Enjoy smarter life !

ECOVACS

D54-000IM201101