

**JAY**-tech®

# Photoframe + Scanner PF07



## User's Manual

Before operating this unit,  
please read this manual thoroughly  
and retain it for future reference.

**GB**



# User Manual

For correct usage, please read these instructions carefully and keep in a safe place for future reference!

## Contents

---

1. General Safety Instructions .....	1
Important safety precautions .....	1
2. Package contents .....	3
3. Product description .....	4
4. Using the film holders .....	7
5. Getting started .....	9
6. Operation Guide .....	11
1: Capture .....	11
2: Playback .....	14
3: USB Connect .....	15
4: Setup .....	16
7. Connecting to a TV .....	20
8. Troubleshooting .....	21
9. Cleaning & Maintenance .....	22
10. Technical Specifications .....	23

Congratulations on the purchase of your photoframe film scanner. Before operating it, please take some time to read this manual thoroughly and keep it for future reference. Follow these important safety and operation instructions.

## 1. General Safety Instructions

### Important safety precautions

- The apparatus shall not be exposed to dripping or splashing and no objects filled with liquids, such as vases, shall be placed over the product. Dry location use only.
- Keep the scanner clean and never store it next to a heat source or in dirty, humid or wet places. Keep it out of direct sunlight.
- Press the buttons gently. The product may damage if you press them too hard.
- Do not use the product in an extremely dry environment.
- Do not subject the product to harsh impacts. Do not drop the appliance; this may result in damage to the product.
- Do not attempt to dismantle or repair it yourself. Only qualified personnel can repair the product.
- Disconnect the appliance from the power supply before you clean it.
- Use a slightly damp, lint-free cloth to clean this appliance. We strongly suggest using a clean, dry, non-alcohol cotton swab to insert into the film scanner and clean the glass surface periodically to produce a clear image.
- Care required with the use of this apparatus in tropical and/or moderate climates.
- This product is not intended for commercial use. Household Use Only.
- Do not disassemble this unit. In order to prevent the product from risk of electric shock, do not remove cover. No user-serviceable parts inside. Refer servicing to qualified personnel.

- The device should be situated in ventilation surroundings for proper ventilation. The unit should not be situated on a bed, sofa, rug or similar surface that may block the ventilation openings.
- The USB cord of the device should be unplugged from the computer when the unit does not use for a long period of time.
- Do not overload the USB connections on your computer. If you have other devices connected to your computer such as a wireless mouse, Media player, mobile phone or other USB powered devices. If too many devices are connected to the computer there may be inadequate power for the film scanner to operate properly.
- The film holder is designed to accept 35mm film negatives in ISO 1007 standard. It is not recommended to use the film holder for other film formats. In some cases using a non-standard 35mm camera may result in the perforations on the film not aligning correctly with the holder. In this case there will be a small black line on the edge of the frame that can easily be cropped out using the Blaze Photo Software.
- **ISO--International Organization for Standardization**
- **For environmental protection and energy conservation, the device will powered off automatically without any operation in 30 minutes.**

## 2. Package contents

The package contains the following items:

- ◆ Photoframe film scanner
- ◆ Film holder
- ◆ AC Adapter
- ◆ TV cable
- ◆ USB cable
- ◆ User manual

Please contact your retailer if you have not received any of these items.

### 3. Product description

- Photoframe film scanner

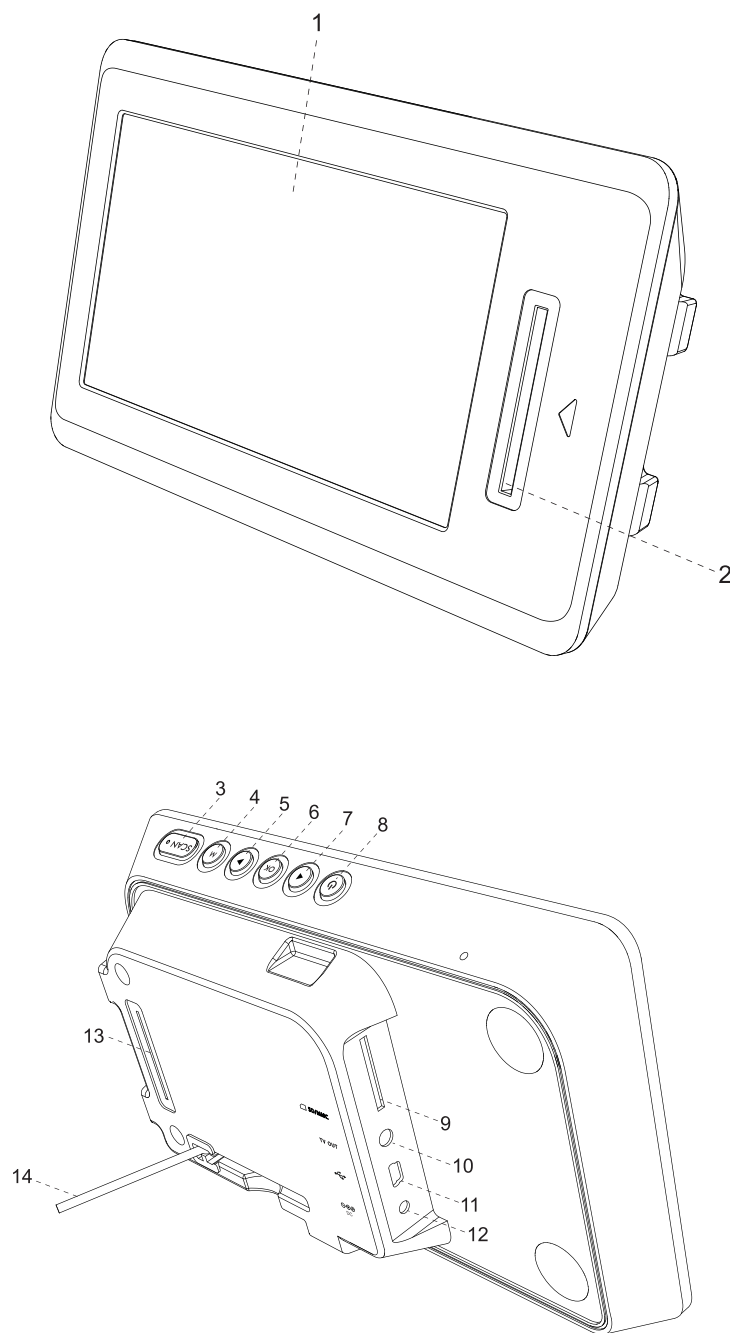

- Positioning the film scanner

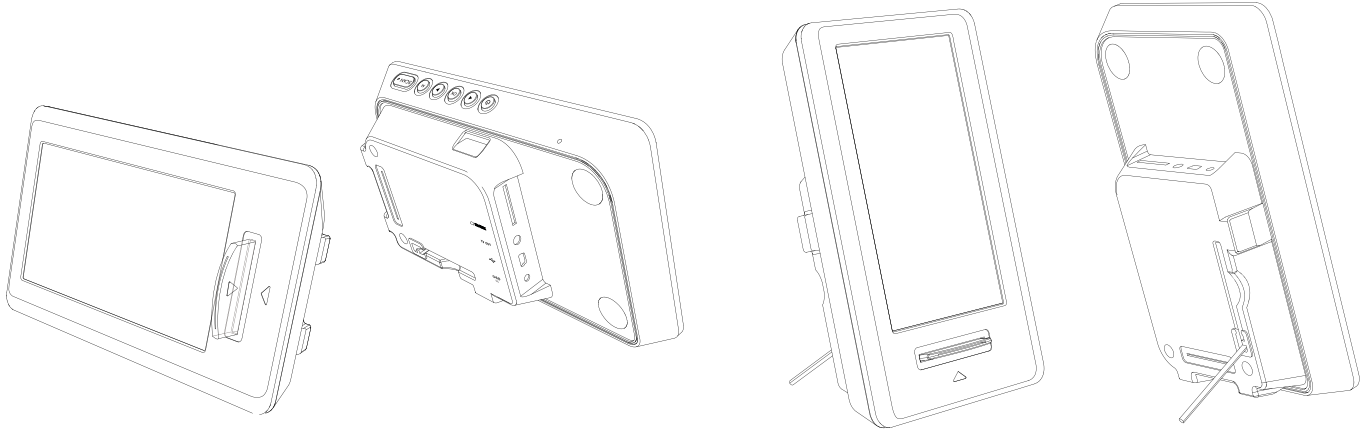

Landscape

Portrait: extend the leg at the back of the product when in this position

- Film holder

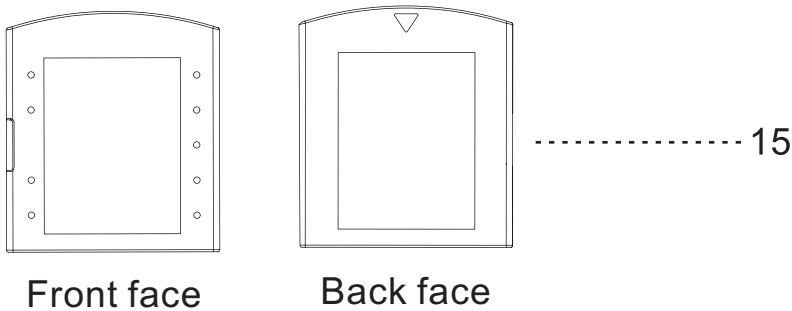

Front face

Back face

No.	Part	Function
1	Screen	7" color screen
2	Film entry slot	Insert film here
3	Scan button + LED	Start scanning LED: 1.Red: no card or no memory left 2.Green: Ready 3.Flashing green: capturing



4	Home button	Return to the main menu
5	Next Button	1.Selects on the right 2.Capture mode: flip image
6	OK button	1.Enter selection 2.Capture mode: long hold (EV mode), short press (Film type mode)
7	Previous button	1.Selects on the left 2.Capture mode: mirror image
8	Power button	On/off button
9	SD card slot	Insert SD card here
10	TV out	Connects to the provided TV out cable
11	USB	Connects to the provided USB cable
12	AC adaptor	Connects to the provided AC cable
13	Film exit slot	Film exits here
14	Leg stand	Extend leg when in photoframe scanner is in the portrait position
15	Strip film holder	Holder for positive and negative strip film, holds 3 frames and above

**Note:** Upon turning on the scanner, the green LED light will be on to startup the machine. After 2 seconds, the color of the LED will show the status of the scanner. (Refer above for LED light indicators)

## 4. Using the film holders

Slides: The light, shade and color of the slide look exactly the same as the original image.

Negatives: The light and shade, color of the Negative is exactly inverted from the original image.

**Note:** Please remove the protection film on the film holder before use.

### Loading single frame cartridge (not included in the package)

1. Insert the holder into the slot at the front of the film scanner. Make sure that the positive side faces to the left (front face of the holder faces left).

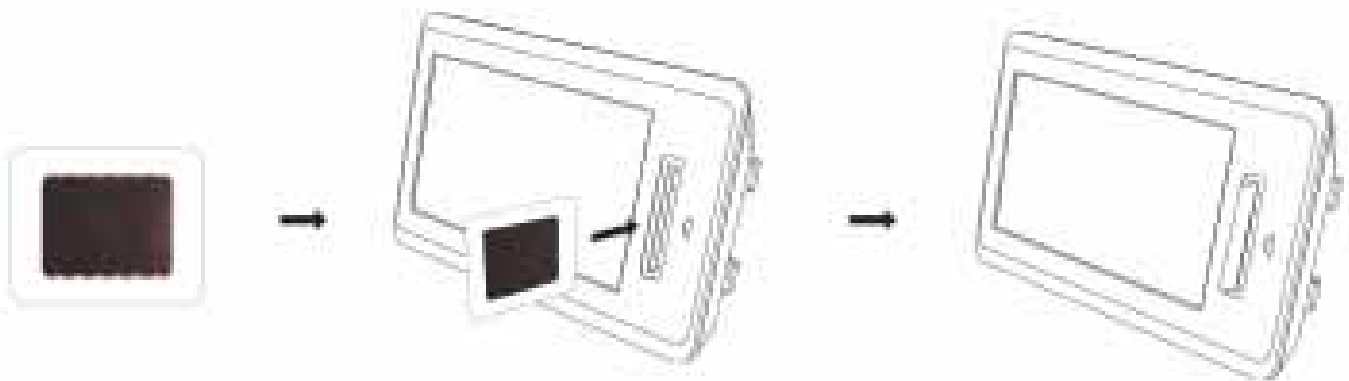

Positive side of the  
film faces left

### **Note:**

•The maximum thickness of these cartridges is 3mm.

## Loading a roll of film

1. Insert the holder into the slot from the top of the film scanner.
2. Insert the strip of slide or negative holder into the slot at the front face of the film scanner. Make sure that the positive side faces to the left.

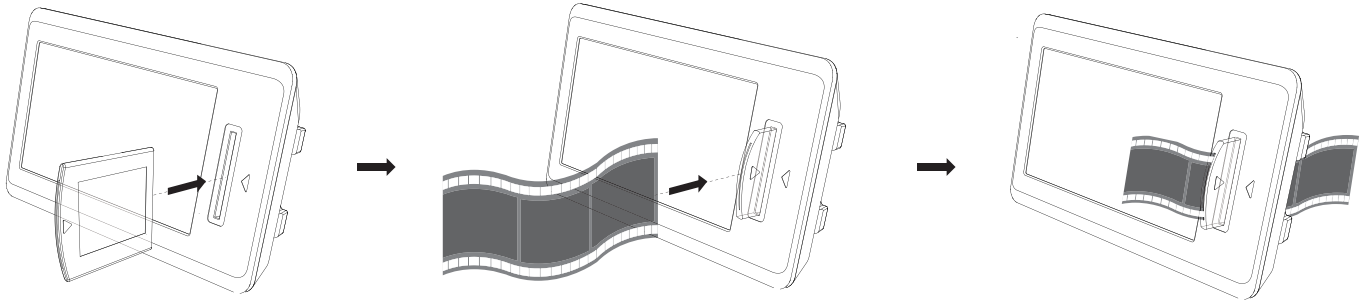

Match arrow to arrow

Positive side of the film faces left

3. Insert the film parallel to the direction of entry. Please do not slant or tilt the film.

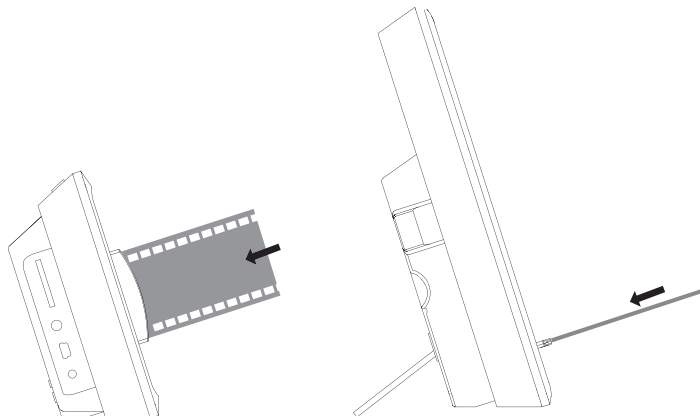

4. Pull out the film from the back in a steady manner.

### Note:

- Handle films with care. Any dust, scratches or fingerprints will show up on your saved images. It is recommended to wear cotton gloves when handling films and to use compressed air to remove any dust on the films. The compressed air canister and gloves are not included with the film scanner but they can be purchased from an office or electronics supply retailer.

## 5. Getting started

1. Insert SD/MMC card into the film scanner.
2. Please connect the power to the film scanner and plug into a power source.
  - USB: Connect to PC with USB cable
  - 5V adapter: Connect to power socket with AC adapter and USB cable
3. Press the POWER button to turn on the film scanner.
4. Insert the Slide/Negative film into the slot on the right side of the film scanner. (Refer to using the film holders for loading instructions)

### NOTE:

- After you turned on the device, if there is no SD/MMC card inserted, a warning screen will be shown and it will entering main menu automatically.



- Once the images in the internal memory or memory card are full, a memory full icon will be shown on screen when you press SCAN button. You have to download the images to PC or use another memory card for the next capture. Please turn off the scanner before removing the SD card

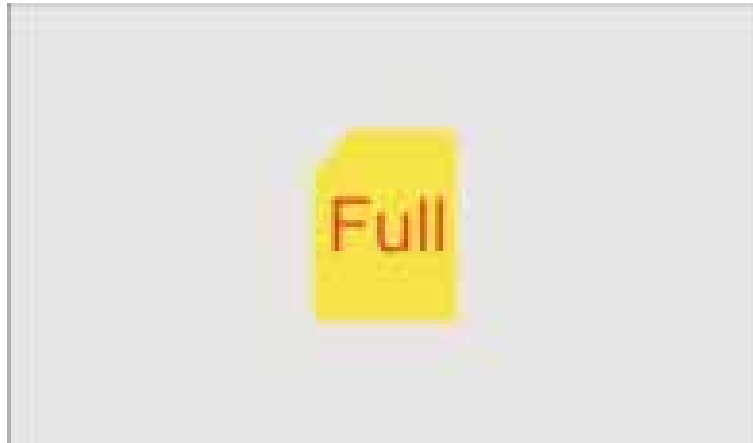

Memory full indicator

- Before you turn on the film scanner, you need to insert the SD/MMC card into the film scanner. Otherwise the device may be powered off.
- Do not remove the memory card when the device is powered on. Device will power off when the SD card is removed.
- The film scanner has a built-in memory card for storage. When there is an external SD/MMC card, the default storage location will automatically switch to the SD/MMC card.
- You can view scanned images in Playback mode or via a computer in USB mode. (You can also view pictures by other devices which supports JPEG format with SD/MMC card compatibility)

## 6. Operation Guide

### Home: Main menu

The film scanner has four main functions:



No.	Mode	Function
1	Capture	Captures positive and negative film
2	Playback	Plays back images stored in the internal storage or SD card
3	USB Connect	Connects to PC
4	Setup	Options to customize the film scanner

### 1: Capture

Press OK button to enter capture mode.

When the film scanner is left idle for more than 5 seconds, upon powering on, it will automatically enter capture mode.

#### 1.1 (Live View): Mirror/Flip (Hard Key)

If any image requires Mirror or Flip function before capturing:

1. PREVIOUS button: mirror image

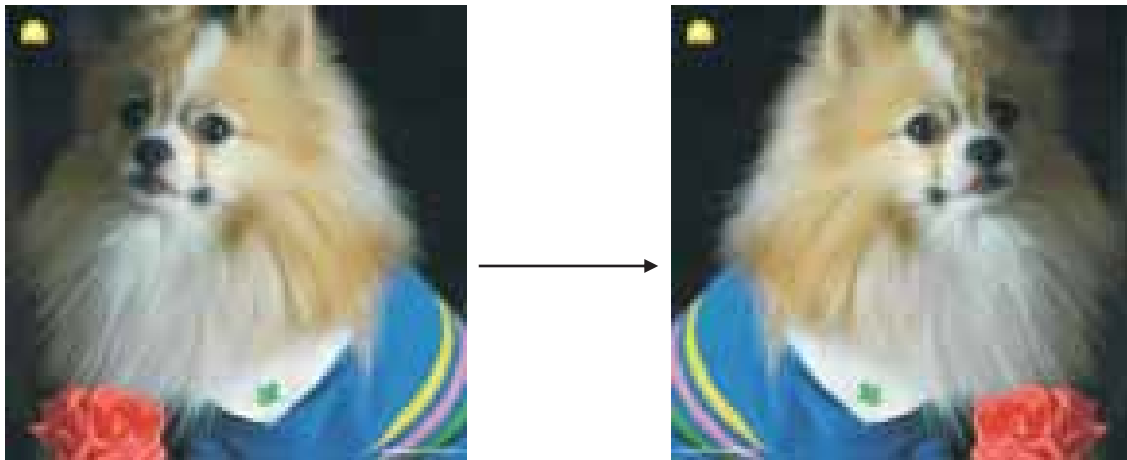

2. NEXT button: flip image

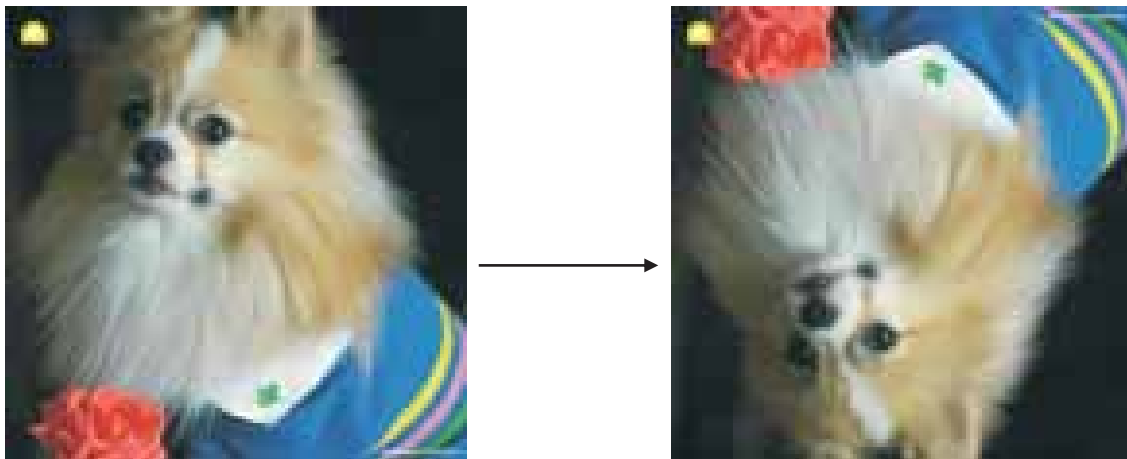

The live view will be adjusted accordingly. (This step is to correct any disorientation). Mirror and Flip buttons only be functioned in the live view mode.

## 1.2 Capture mode

In capture mode, there are three film types for scanning photos:

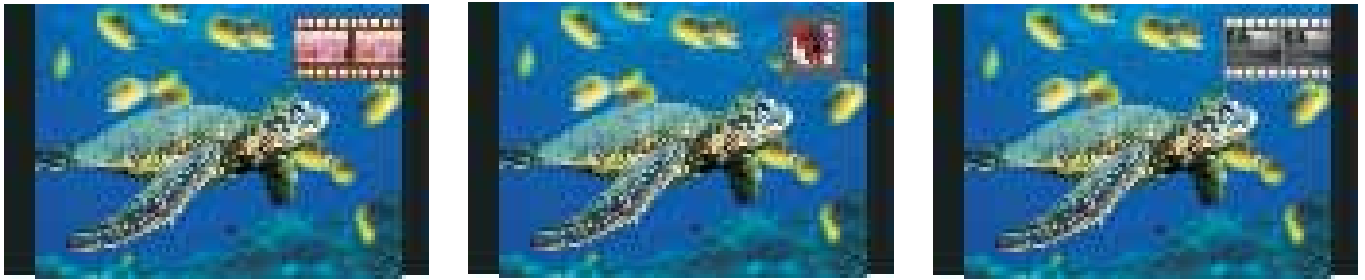

No.	Options	Functions
1	Negative Film	Scanning negative color film
2	Slides	Scanning positive color film
3	B/W	Scanning black and white film

Press the OK button to switch the film types to scan. Press the SCAN button, the current image will be captured and saved to internal memory or SD/MMC card, then return to live view again.

To adjust the exposure value manually from -2 to 2, press and hold the OK button for 3 seconds. Press PREVIOUS/NEXT to select the exposure value, and then press OK button to confirm.

**Note:** EV 2 means brighter exposure value and EV -2 means darker exposure.





## 2: Playback

Press the HOME button to access the main menu, then press NEXT button to choose the Playback function, and press OK button to confirm. The photos will be playback in slide show mode.

### 2.1 Playback: Slide show → Single picture → Edit mode

You can interrupt (Pause) slide show mode to stand-alone playback mode (single picture playback) by pressing the OK button. Use the PREVIOUS/NEXT button to manually scroll the pictures.

To edit the picture stored in internal memory or SD/MMC card, press OK button again to bring out the edit mode for modification.

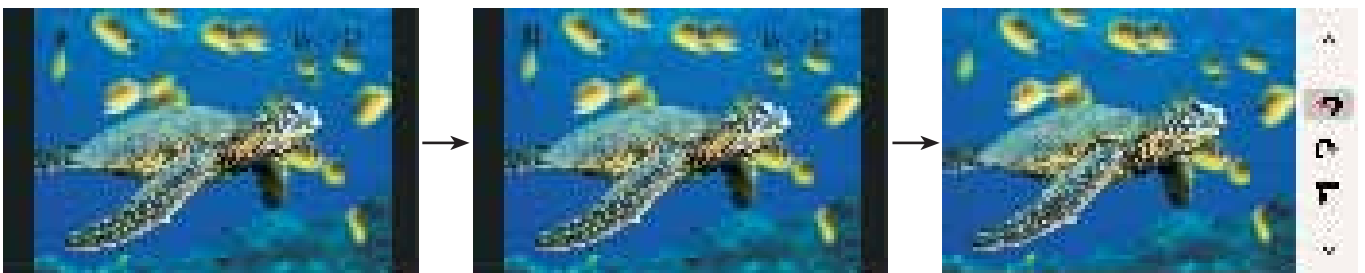

#### Note:

- If there is no SD/MMC card inserted or no image in internal memory, it will display 20 Pre- installed images which cannot be edited.
- If there is no file when enter playback mode, a No File symbol will show on screen.

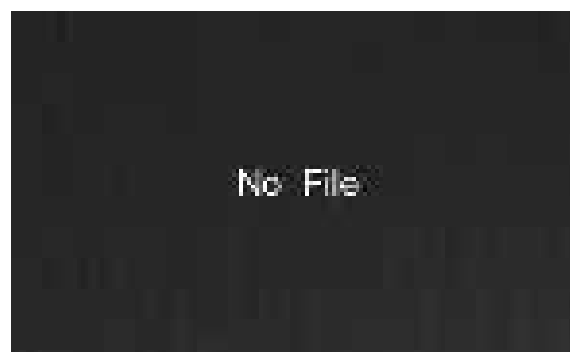

## 2.2 Playback: Rotation

In “Edit mode”, press PREVIOUS/NEXT button to select clockwise or counter clockwise icon to rotate image 90 degree respectively and press the OK button to save image.

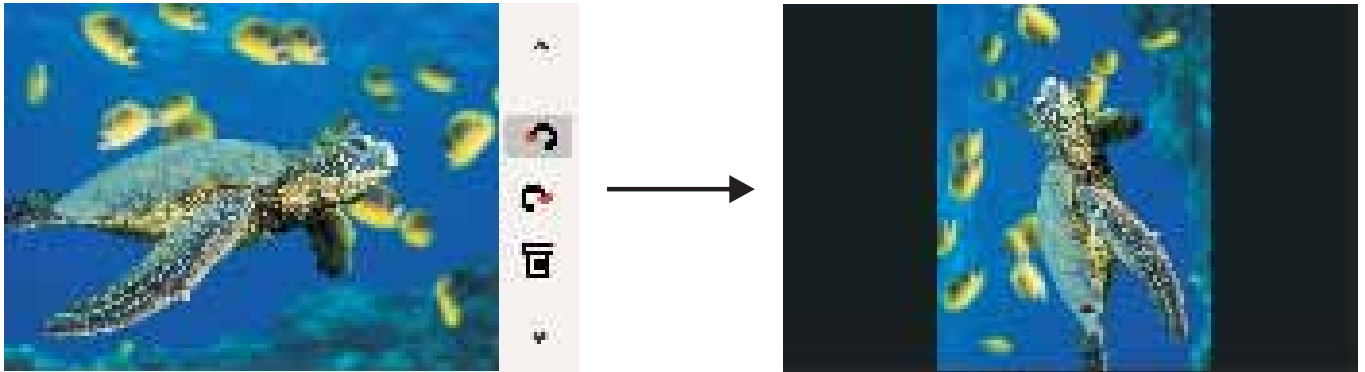

## 2.3 Playback: Delete

Select DELETE icon and press OK button to confirm. The current picture will be deleted and next picture will be shown. Press HOME button to exit edit mode.



## 3: USB Connect

When the device is connected with USB cable to PC, please press OK button to enter into main menu, then press PREVIOUS/NEXT button to select USB mode, press OK button to confirm, the film scanner will become a mass storage device and you can view or edit images on PC.

### 3.1 USB mode/Status

Once select USB mode, the film scanner will become a mass storage device and will show on the screen, it will appear as a removable disk on the PC. Open the folder to view or edit images on the PC.



Press the HOME button to return to main menu.

### 4: Setup

There are six options in setup mode:



No.	Options	Function
1	Resolution	Adjusts the resolution of the captured image.
2	Language	Language selection
3	Format	Reformats the product
4	FW Upgrade	Software upgrade
5	Default	Restore to original setting
6	Version Info	Product software information

## 4.1 Resolution

Press OK button to enter into Resolution mode, and then press PREVIOUS/NEXT button to select Resolution, then press OK button to confirm.

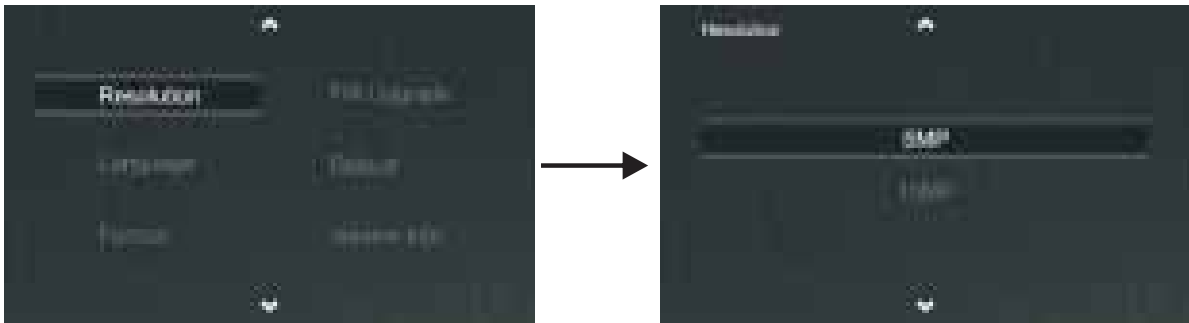

Two kind of resolution you can select:

- ① 5 Megapixels resolution
- ② 10 Megapixels resolution

Press PREVIOUS/NEXT button to select resolution options, and then press OK button to confirm your choice.

## 4.2 Language

Press PREVIOUS/NEXT button to select Language mode, and then press ENTER button to confirm, press PREVIOUS/NEXT button to select language, press ENTER button to confirm.

It supports 8 kinds of languages: English, French, German, Italian, Spanish, Traditional Chinese, Simplified Chinese and Japanese.

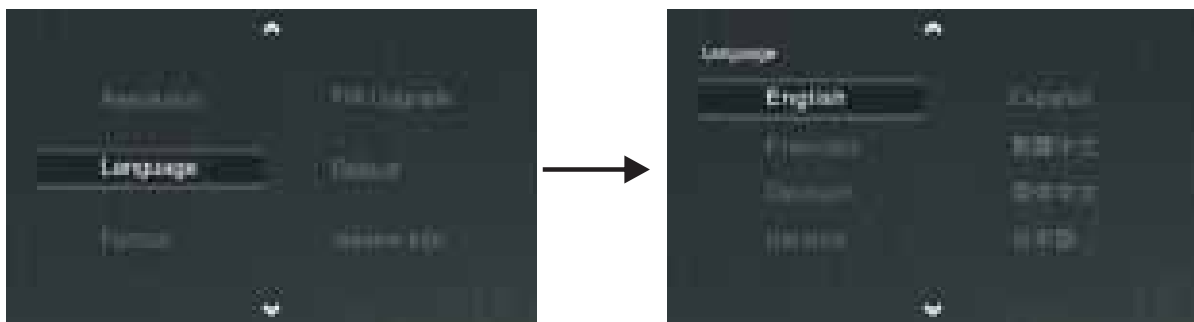

### 4.3 Format

Format function is to format all photos and images inside the built-in memory and SD/MMC card inserted.

Press PREVIOUS/NEXT button to select format mode, and then press OK button to confirm, press PREVIOUS/NEXT button to select Yes/No, press OK button to confirm.

**Notice:** This operation will format your SD/MMC card! All data will be erased!



### 4.4 FW Upgrade

New firmware will be provided to enhance the function of your film scanner if needed.

Please copy firmware into the memory card in advance, select “FW Upgrade” and then select “Yes” to confirm. FW upgrading window will be shown on the LCD screen.



**Note:** The process will last for 2 minutes and system will restart automatically.

#### 4.5 Default

Press PREVIOUS/NEXT button to select default mode, and then press OK button to confirm, press PREVIOUS/NEXT button to select Yes/No, press OK button to confirm.

This option will revert back to factory settings.

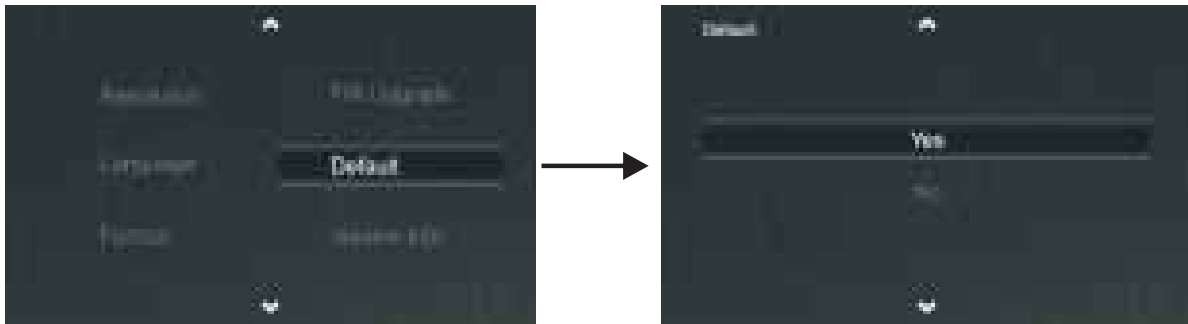

#### 4.6 Version Info

Press PREVIOUS/NEXT button to select Version Info mode, and then press OK button to confirm.

This option will show version information similar as following.



## 7. Connecting to a TV

You can browse images on a TV.

1. Turn on the film scanner and TV
2. Connect the film scanner to TV with the TV cable
3. Press the PREVIOUS/NEXT button to TV mode.
4. All functions can be actualized freely on TV

## 8. Troubleshooting

**Question:** There is unwanted stripe appearance at the edge of the image.

**Answer:** If it is slight stripe, move the slide holder gently to and fro in the device until the stripe is no longer visible in the preview window.

If the stripe is still exist, please contact with our retailer.

**Question:** The device cannot connect to the computer.

**Solution:** Please check if the cable has already connected to the USB port of the computer. Or connect the cable to another USB port. It is recommended that connect it to the motherboard directly, not to the front panel.

**Question:** The image you captured is reversed.

**Solution:** Please check the setup options, and switch to the film type that you want.



## 9. Cleaning & Maintenance

Clean the film scanner periodically after use. The film scanner should be cleaned using a compressed air canister to remove the dust from the internal chamber.

1. Insert the end of straw from the compressed air into the door flap on the right side so that it opens.

2. Gently blow out any dust on the inside of the device.

**Note:** The compressed air canister is not included with the device but it can be purchased from an office supply or electronics retailer. For further cleaning you can use an ordinary cotton swab and a bottle of lens cleaning fluid.

3. Wet the end of the cotton swab with Lens Cleaning Fluid and insert into the right side of the device so the door flap opens. Then clean the entire surface of the glass on the inside of the device with the cotton swab.

**Note:** Cotton swabs and cleaning fluid are not included with the device but can be purchased from an office supply, photo supply or electronics retailer.

When not in use please disconnect the film scanner from the computer and store in a clean, dry and dust-free place.

## 10. Technische Daten

◆Lens	F/4, f=3.93
◆Sensor	5.1 mega pixels CMOS sensor
◆Focus Range	51.5mm
◆LCD	7" TFT
◆External memory	SD/MMC card
◆Exposure	Auto
◆Color balance	Auto
◆Scan high resolution	10M pixels interpolation resolution
◆Data conversion	12 bits per color channel
◆Scan Method	Single pass
◆Light source	Backlight (3 white LED)
◆Power	Powered from USB /5V adapter with USB cable
◆Interface	USB 2.0
◆Dimensions	216.5mm(L) x132.5mm(W) x51mm(H)
◆Weight	400G
◆Languages	English, French, German, Italian, Spanish, Traditional Chinese, Simplified Chinese and Japanese.

MADE IN CHINA