

English

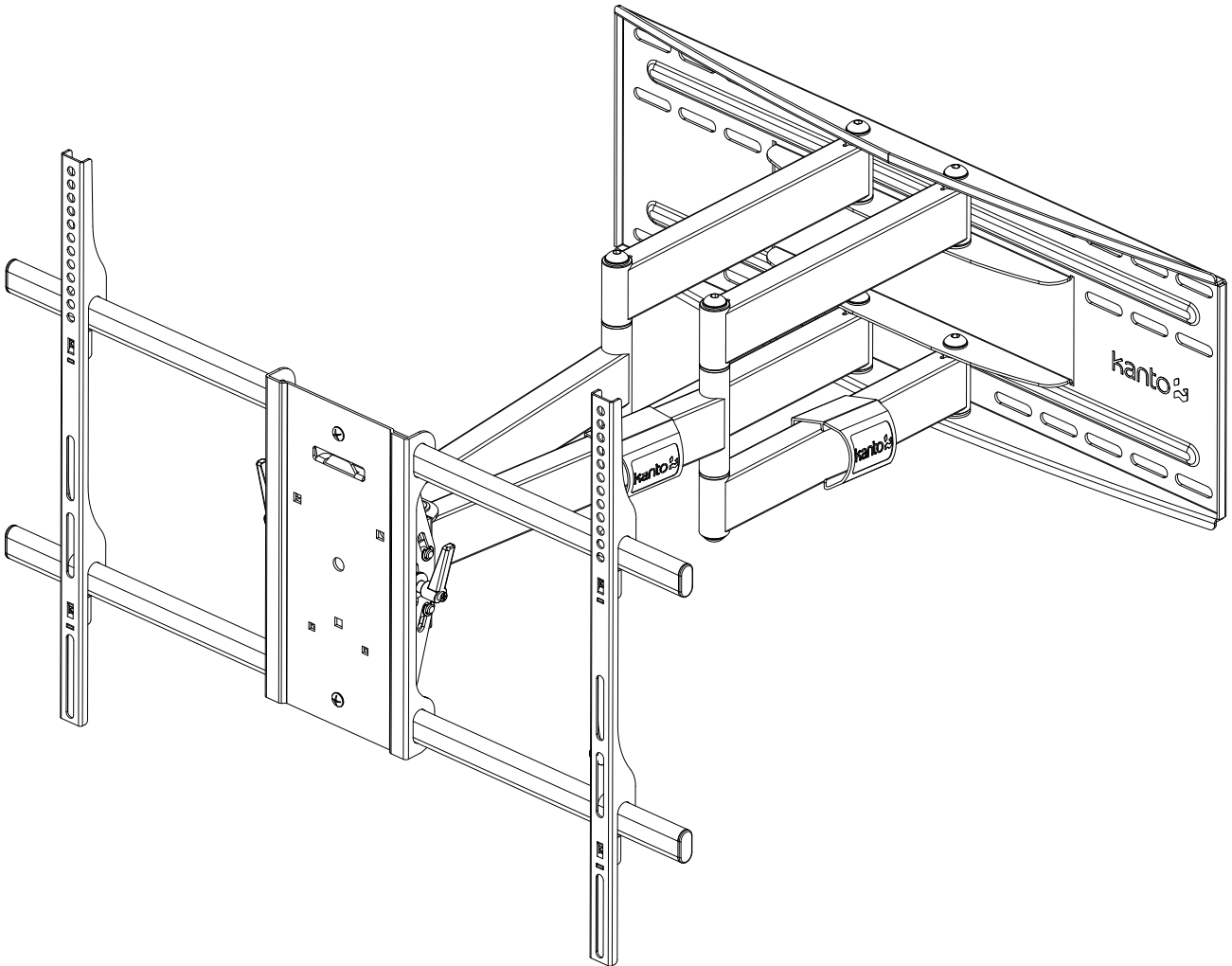

User Manual
FMX3 TV Mount



FULL MOTION FLAT PANEL TV MOUNT

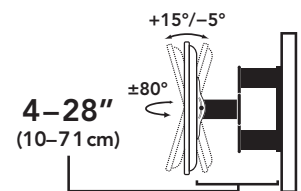
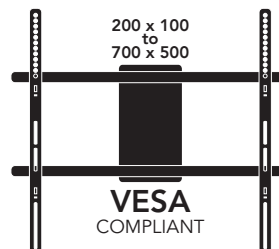
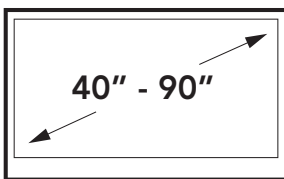

Supporting your digital lifestyle™

Table of Contents

Table of Contents / Introduction	2	Setup - Steps 3 to 4	6
Supplied Parts & Hardware	3	Setup - Steps 5 to 6	7
Setup - Step 1	4	Other Kanto Products	8
Setup - Step 2	5	Warranty	8

Introduction

Thank you for choosing a Kanto full motion wall mount. The FMX3 is designed to mount flat panel televisions weighing up to 150 lbs (68 kg), extend an amazing 28" from your wall, pan left and right up to 80° (depending on TV size), and tilt your TV +15° / -5°. You can also adjust the horizontal level ±5°.

Read these instructions fully before installation of this mount. If you do not understand these directions, or have any doubts about the safety of the installation, please consult a qualified installation contractor to install this mount. Make sure there are no defective or missing parts. Do not use defective parts. If there is hardware missing, or if you are uncertain whether the part is defective call Kanto directly at 1-888-848-2643 or support@kantoliving.com. Kanto cannot be liable for property damage or injury caused by incorrect mounting, incorrect assembly, lifting or incorrect use of this product.

This product should not be mounted on steel stud walls or cinder block walls. Consult a qualified installation contractor if you are unsure about the type of wall you may have.

See installation video online at:
www.kantoav.com/pages/video-fmx3



CAUTION

The maximum loading weight is 150 lbs (68 kg). This wall mount is intended for use only with the maximum weights indicated. Use with products heavier than the maximum weights indicated may result in instability causing possible injury. Recommended TV Size: 40 inch to 90 inch.



CAUTION

The wall you plan to affix the Kanto mount to must be able to support more than 5 times the weight of the television and the wall mount combined. Do not use this product for any purpose other than to mount a flat panel TV on a vertical surface as outlined in this manual. Improper installation may cause damage to your TV or serious injury. This product should not be mounted to steel stud walls, cinder block or old concrete walls. Consult a qualified installation contractor if you are unsure about the type of wall you may have.

Supplied Parts and Hardware

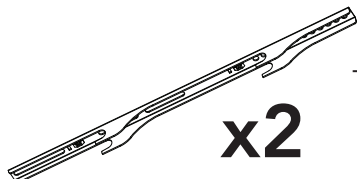

TV Bracket Arm

x2

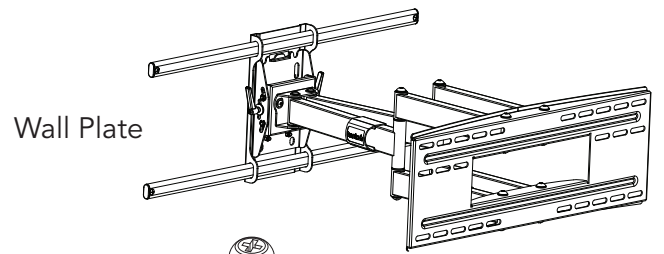

Wall Plate



x4

A: M4 x 15mm Bolt

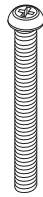

x4

B: M4 x 30mm Bolt

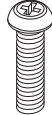

x4

C: M5 x 15mm Bolt

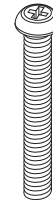

x4

D: M5 x 30mm Bolt

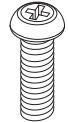

x4

E: M6 x 15mm Bolt

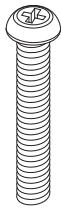

x4

F: M6 x 30mm Bolt

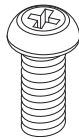

x4

G: M8 x 15mm Bolt

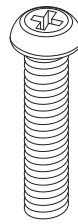

x4

H: M8 x 30mm Bolt

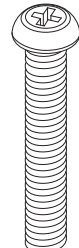

x4

I: M8 x 40mm Bolt

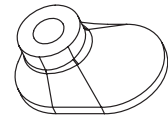

x4

J: Spacer



x4

K: Spacer



x4

L: M4 Star Washer



x4

M: M5 Star Washer



x4

N: M6 Star Washer



x4

O: M8 Star Washer



x4

P: Washer M4/M5

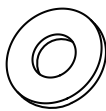

x4

Q: Washer M6/M8

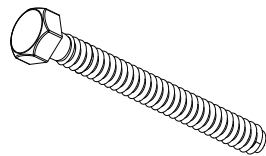

x6

R: Lag Bolt

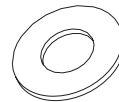

x6

S: Lag Bolt Washer

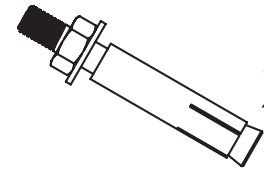

x6

T: Concrete Anchor

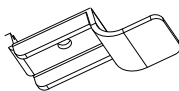

x4

U: Lock Clips



x4

V: M4x8mm Lock Clip Screws

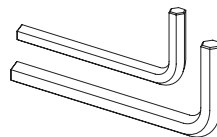

W: 5mm Allen Key

X: 6mm Allen Key



x2

Y: Cable Management Clip

Required Tools



Socket set



Phillips Screwdriver



Hammer (for concrete installs)



Pencil



Stud Finder

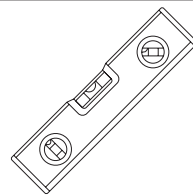

Level

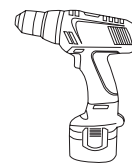

Drill



9/16" Masonry Bit



1/4" Wood Bit

Step 1: Attach Bracket Arms to TV

There are a wide variety of TVs available that require an assortment of bolt sizes. We provide a selection of mounting bolts to fit most TVs. If you have any concerns about this mounting hardware or installation call us direct at 1-888-848-2643 or email at support@kantoliving.com.

Step 2.1 Determine the correct size of bolt.

Kanto provides 4 bolt diameters (Metric sizes M4, M5, M6 and M8) in various lengths.

Part items: **A, B, C, D, E, F, G, H** or **I**.

Select the correct diameter bolt and hand screw into the back of the TV to determine the correct length. Use the longest available bolt without reaching the bottom of the TV threads. If your TV has a curved back or deep recesses, you can use the spacers (**J** or **K**).

Step 2.2 Select appropriate washers.

Each bolt size has a companion lock washer (**L** through **O**) and uses a washer (**P** or **Q**). The washer (**P**) is used for M4 and M5, and washer (**Q**) is used for M6 and M8.

Step 2.3 Attach Bracket Arms

Insert the Bolts through the Star Washer (**L** through **O**), Washer (**P** or **Q**), TV Bracket, and Spacers (**J** or **K** if necessary), then thread into the mounting holes (see Diagram A).

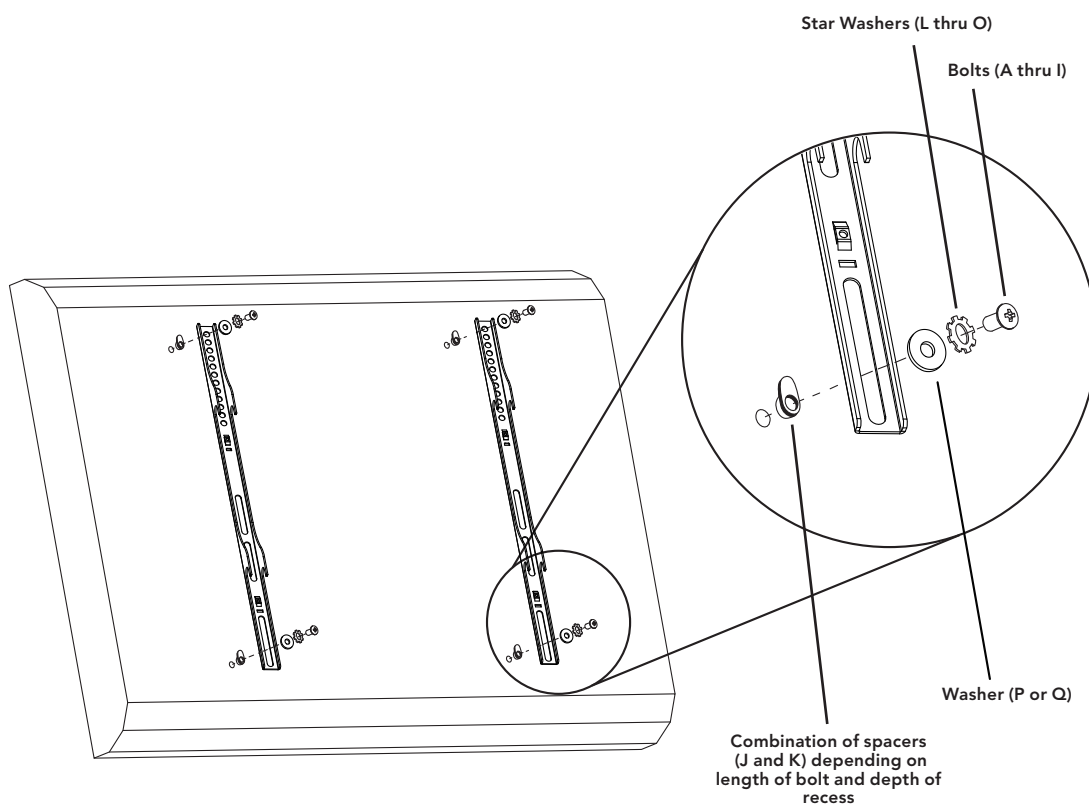

Diagram A



WARNING

Never over-tighten a screw into the back of your flat panel TV. Do not lay the TV face down on its glass front. Use a wall or a TV stand.

Step 2: Mount Wall Plate

Before you start drilling, attach the Wall Plate Template to your wall. It will make finding level, marking and drilling pilot holes, and catching much of your dust easier. Remove it before you attach the wall plate!

Wood Stud Wall

The Wall Plate must be mounted to two wood studs. Use a stud sensor to locate the two studs, clearly marking the outer edges of the studs. Use a long level to make sure these holes are horizontally level. Attach the Wall Plate Template to the wall at the desired height so that the stud centers are visible through mounting slots, and drill the top Wall Plate pilot holes (Row 1, Diagram B). Mark the location of Row 2 and Row 3 of Wall Plate pilot holes for each stud, and drill the pilot holes. Once you have 6 pilot holes, remove the Wall Plate Template.

Attach the Wall Plate using 6 Lag Bolts (R) and Lag Bolt Washers (S) (see Diagram B). Make sure the Wall Plate is flat against the wall surface. Do not over-tighten Lag Bolts (R).

Brick or Concrete Wall

Attach the Wall Plate Template to the wall at the desired height, using a long level to ensure that the template is level. Mark six hole locations on the wall for the concrete anchors (we suggest offsetting the holes as shown in Diagram C where possible). Drill the six holes perpendicular to the wall using a masonry bit (see Diagram C). Do not drill into mortar joints. Insert a Concrete Anchor (T) into each of these holes until the washer is flush with the wall surface. Remove the nut, lock washer and washer, then add back the washer and nut. Tighten the nut on the Concrete Anchor (T) until the anchor is fully secure. Do not over-tighten. Remove the nut and washer so that just the bolt thread is showing. Remove the Wall Plate Template.

Place the Wall Plate over the six protruding bolts, then mount using the washer, lock washer and nuts removed earlier. Make sure the Wall Plate is flat against the wall surface. Do not over tighten Concrete Anchor nuts.

Wood

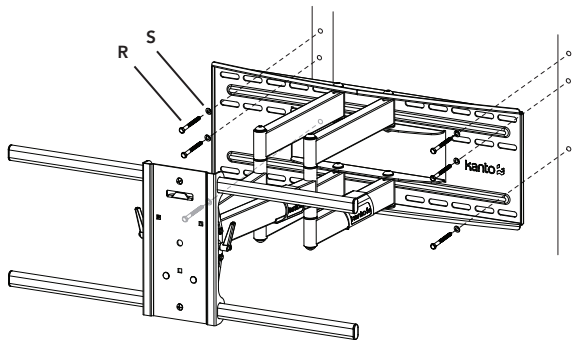
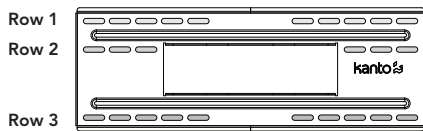
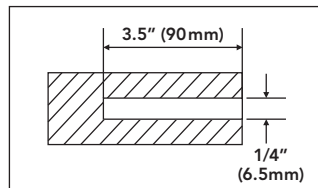

Diagram B



Concrete

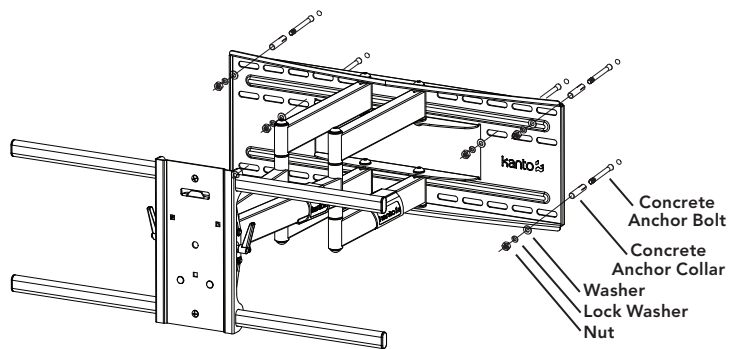
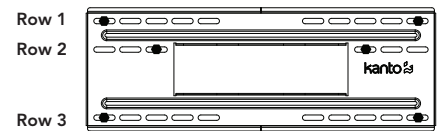
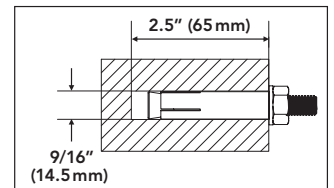

Diagram C



CAUTION

Make sure the supporting surface will support the load limits outlined in the Caution at bottom of page two. Tighten Lag Bolts until the Wall Plate is snug flat against the wall. Do not over tighten Lag Bolts (R). Each Lag Bolt must be located in the center of a wood stud.



CAUTION

Make sure the concrete or brick wall is at least 3.5" thick. Make sure the anchor is seated completely flush with the concrete surface even if there is another layer of material, such as drywall. If drywall is over 5/8" thick custom lag bolts must be used. Concrete must be a minimum of 2000 psi in density.

Step 3: Attach TV to "H" Assembly

Pull the "H" Assembly away from the wall and use two people to lift the TV onto the "H" Assembly.

Generally, you will center the TV on the "H" Assembly, but you may offset the TV from center by sliding it to the left or right of the "H" Assembly as desired.

Secure TV to "H" Assembly using 4 lock clips (U) and screws (V), as shown in Diagram D.

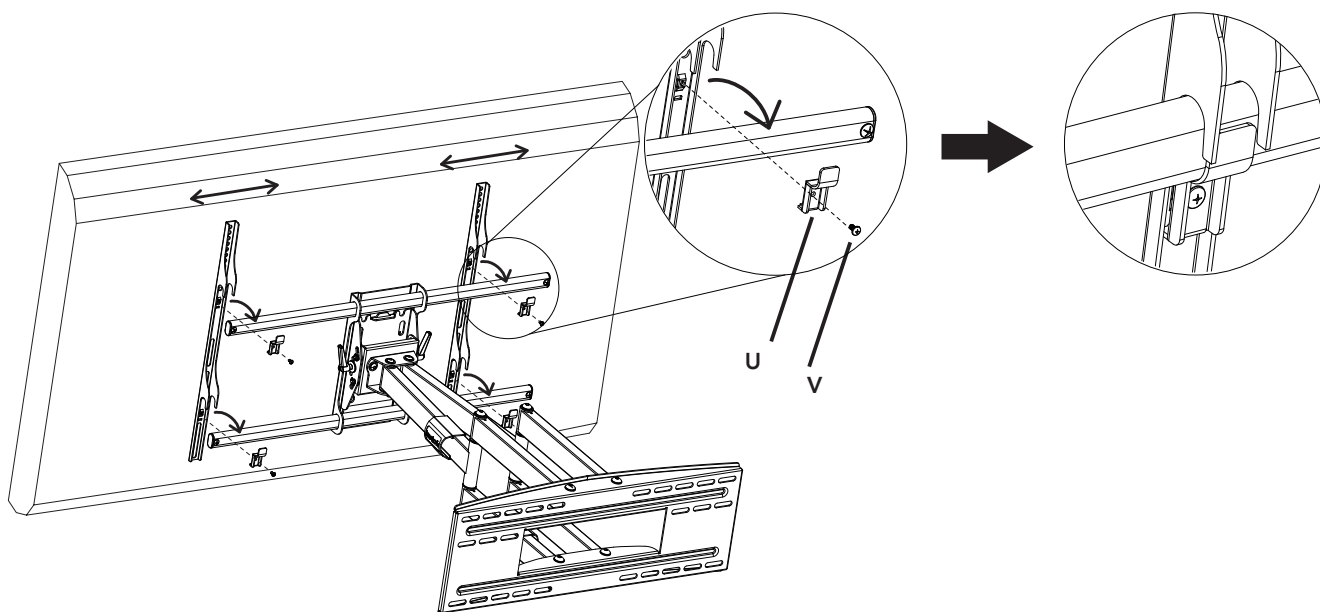

Diagram D

**CAUTION**

Read this section carefully prior to install.

Step 4: Level the TV

You can make minor ($\pm 5^\circ$) adjustments to the horizontal level of the TV after installation. There are two leveling screws on the Tilt Head Plate as shown in Diagram E. Loosen these slightly and use a level to adjust the horizontal level of the TV. Re-tighten with 5mm Allen Key (**W**).

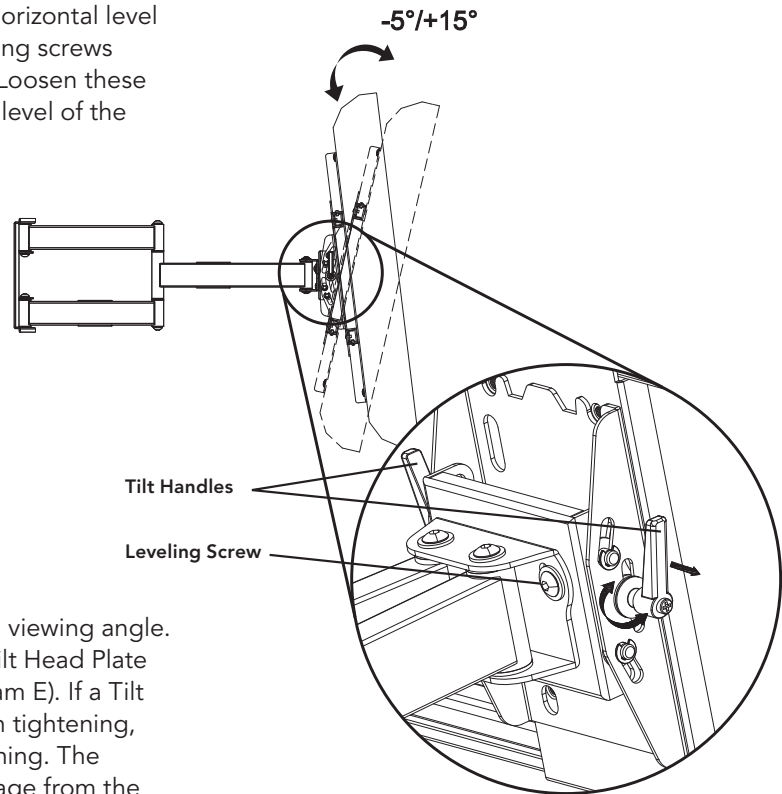

Diagram E

Step 5: Tilt the TV

The FMX3 will tilt $+15^\circ/-5^\circ$ to provide the ideal viewing angle. Loosen the Tilt Handles on both sides of the Tilt Head Plate and tilt the TV to the desired angle (see Diagram E). If a Tilt Handle interferes with the back of the TV when tightening, adjust its position by pulling out and repositioning. The Tilt Handles are spring-loaded and will disengage from the assembly in order to allow their repositioning. Tighten the Tilt Handles when the TV is at the desired angle, then point the Tilt Handles up or down by pulling out and re-positioning.

Step 6: Cable Management

Attach the Cable Management Clips (**Y**) to the top or bottom of the wishbone extension arms as desired, as shown in Diagram F. Choose the arms you will use to route your cables. The clips open easily to insert cables and attach to your chosen arms.

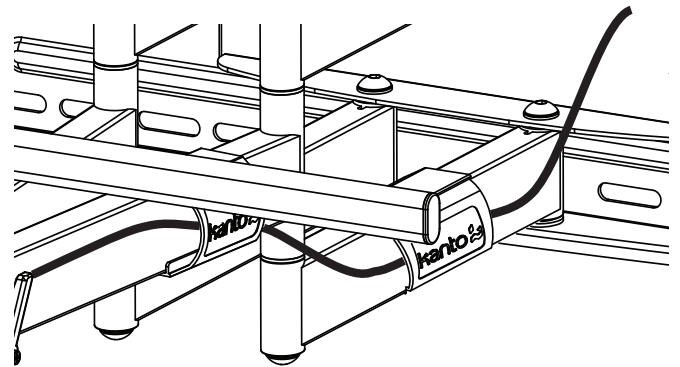

Diagram F

**WARNING**

Use two people to lift and position the TV onto the Tilt Head Plate.



Check out more great products from Kanto!

Kanto Speakers

- Check out our full line of bookshelf and desktop speaker systems
- Available in a stunning array of colors
- Visit kantospeakers.com for more!

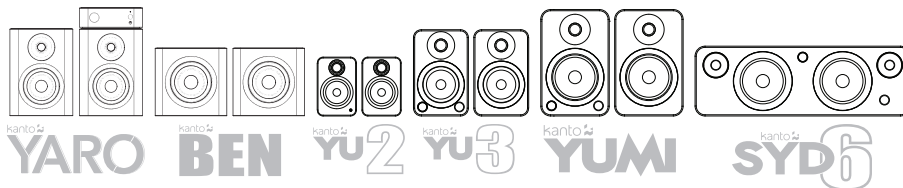

- Full line of Video and Audio Cables
- Attractive white cables and heads
- HDMI, Optical, Mini-jack, RCA, USB
- Switchers, Hubs, Adapters
- Visit kantoliving.com/cable for more!



To learn more about all our products, visit www.kantoliving.com



Warranty

Limited Warranty To Original Purchaser

Kanto Distribution Inc. (Kanto) warrants the equipment it manufactures to be free from defects in material and workmanship for the following limited warranty period of:

24 months parts and labour

If equipment fails because of such defects and Kanto or an authorized dealer is notified within 24 months from the date of shipment with proof of original invoice, Kanto will, at its option, repair or replace the equipment, provided that the equipment has not been subjected to mechanical, electrical, or other abuse or modifications. Equipment that fails under conditions other than those covered will be repaired at the current price of parts and labor in effect at the repair. Such repairs are warranted for 90 days from the day of reshipment to the original purchaser. This warranty is in lieu of all other warranties expressed or implied, including without limitation, any implied warranty or merchantability or fitness for any particular purpose, all of which are expressly disclaimed.

The information in the owner's manual has been carefully checked and is believed to be accurate. However, Kanto assumes no responsibility for any inaccuracies that may be contained in the manual. In no event will Kanto, be liable for direct, indirect, special, incidental, or consequential damages resulting from any defect or omission in this manual, even if advised of the possibility of such damages.

