

RV-32C
Wired Video Doorbell Intercom with 7.0" TFT Monitor
User Manual



Outdoor camera :



Indoor unit :

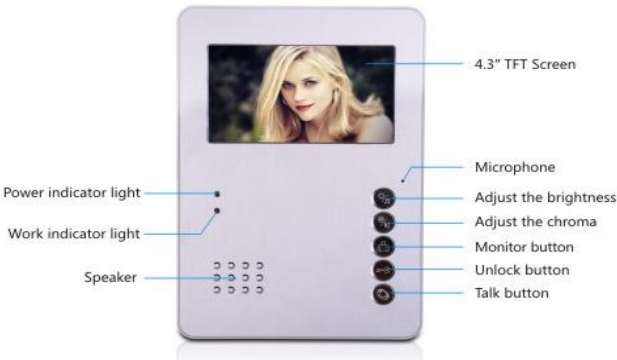

Camera installation :

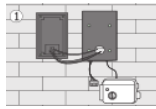

1. Electric lock connect at the right end socket , the left end socket used connect indoor

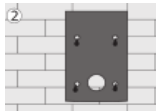

2. Hang using four screws on the wall

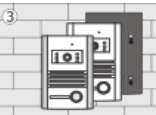

3. Put the outdoor unit on the pendant

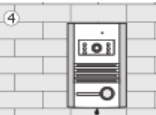

4. Fixed on the bottom 1 screw

Basic Operation

- 1) How to turn to sleep model ?

When outdoor unit call the indoor unit, press "talk button" two times into the sleep model, or after 15 seconds automatic into sleep mode

When indoor unit in video model press "monitor button" into sleep model, or after 3 minutes automatic into sleep mode

- 2) How to enter into intercom model ?

In sleep model, when press "call button" of outdoor unit, the chime of indoor unit sounds 15 seconds; after press "monitor button" on the indoor unit; then press "intercom button" can intercom with outdoor unit (intercom time can keep 90 seconds)

When talk , you can press "unlock button" to open the door, press "talk" or "monitor" button to exit

- 3) How to monitor ?

If the outdoor unit didn't call, users need through the indoor unit monitoring outdoor situations;

then press "monitor button" ,can see outdoor situations (monitor time can keep 90 seconds), press "monitor button" again to exit

- 4) How to unlock ?

Only when in intercom model, it can unlock. Press "unlock button"

- 5) The bell selection and volume adjustment and exit. To ensure the power supply is normal.

① When indoor unit at any mode, can press "adjust the brightness" button / "adjust the video brightness and music" to select from 16pcs melody, press "talk button" to exit

② When indoor unit at any mode, can press "adjust the chroma button" / "adjust the videochroma and volume" to adjust the volume, press "talk button" to exit volume choice

Monitor installation:

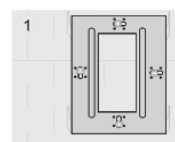

1. Fixed the 4 screw, install the wall mounting of monitor on the wall

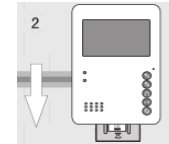

2. Install the monitor on the wall mounting

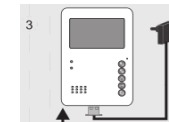

3. Connect the DC adapter to the monitor

Cable Specifications

- A: cable of the maximum length for the indoor unit to outdoor unit
B: cable of the maximum length for the indoor unit to indoor unit
C: cable of the maximum length for the lock to outdoor unit

	0.2mm	0.5mm	1.0mm
A	30m	50m	100m
B	30m	50m	100m
C	2m	3m	5m

	Color	Cable function
1	Yellow	Video
2	Black	GND
3	Green	Audio
4	Red/Brown	Power
5	Blue	Signal

	Color	Cable function
1	Yellow/Grey	Video
2	Black	GND
3	Green	Audio
4	Red	Power

	Color	Cable function
1	Red	Lock +
2	Black	Lock -