



# Russell Hobbs



Problems? – Ring the helpline

# 0845 658 9700

(local rate number)

instructions

**£10,000 prize draw**  
**PLUS Free Rewards Gallery**  
Register online now to  
collect your reward  
See back for  
details

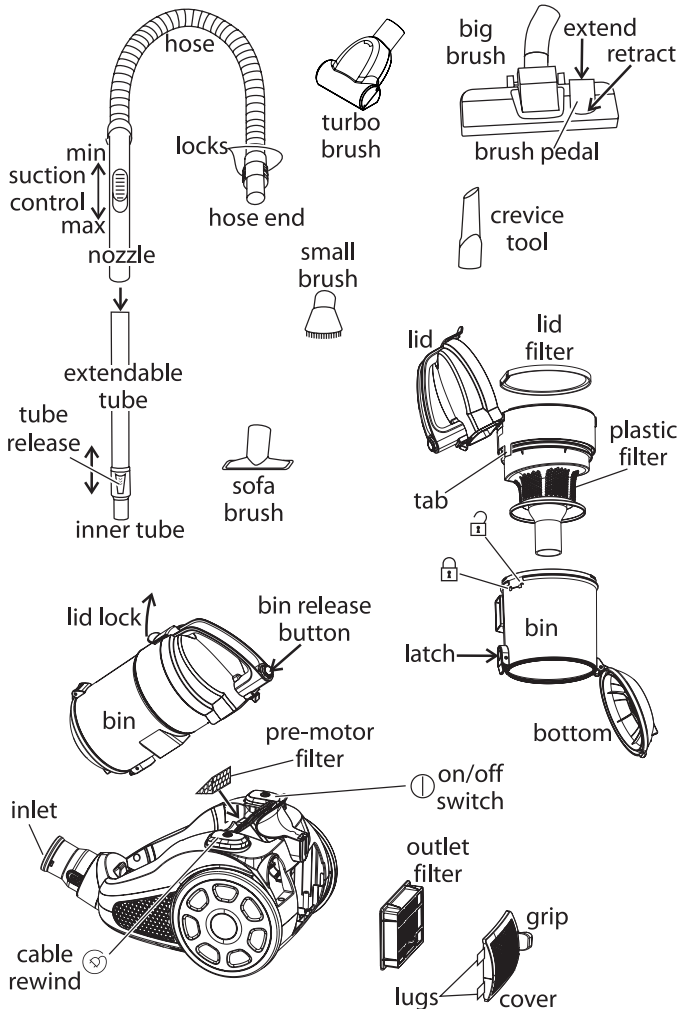

Read the instructions, keep them safe, pass them on if you pass the appliance on. Remove all packaging before use.

## **IMPORTANT SAFEGUARDS**

Follow basic safety precautions, including:

- 1 The cleaner should only be used by or under the supervision of a responsible adult. It's not a toy – don't let children play with it.
- 2 Don't put the cleaner in liquid; don't use it anywhere damp or wet.
- 3 Don't use the cleaner near a gas, oil, or open fire. The flame may be sucked towards the cleaner, causing a fire hazard.
- 4 Keep hair, clothing, fingers, toes, and pets away from the end doing the sucking, and from the brush.
- 5 Stuff you mustn't pick up:
  - a) liquids – you'll short the motor
  - b) stuff that may ignite, like matches, bits of fire-lighter
  - c) anything burning or smouldering (cigarette ends, ashes, embers) – wait till they're extinguished and cold
  - d) spillage from toner cartridges – the fine particles may pass through the filter, and short circuit the motor
  - e) cement or plaster dust – they'll combine with moisture in the air, clog the filter, scour the bin, and may burn out the motor
  - f) anything sharp – you may puncture the filter
  - g) anything biological – you'll eventually have to clean it off the filter, and viral particles may pass through the filter, reach the air outlet, and enter your air supply
- 6 If you use the cleaner outdoors (e.g. cleaning the car), connect it to the electricity supply via a residual current device (RCD), with a rated residual operating current not exceeding 30mA.
- 7 Don't leave the cleaner unattended when plugged in.
- 8 Unplug the cleaner and rewind the cable when not in use.
- 9 Keep an eye on the cable, so it doesn't catch on anything, or trip anyone up. Don't run the cleaner over the cable, you'll damage it.
- 10 If you're using the cleaner on stairs, sit it where it can't fall, and keep it below you, so if it does fall, it won't land on you.
- 11 Don't use the cleaner if the bin is full – switch off, unplug, empty.



- 12 Don't use the cleaner for any purpose other than those described in these instructions.
- 13 Don't use accessories or attachments unless we provide them.
- 14 Don't leave the cleaner in sunlight, UV can damage plastics.
- 15 Don't use the cleaner if it's damaged or malfunctions.
- 16 If the cable or plug is damaged, return the cleaner to avoid hazard.

## household use only

---

### COUNT THE BITS

---

You should have an extendable tube, a turbo brush, a big brush, a crevice tool, a small brush, a sofa brush, and a hose – check all the packaging before you dispose of it.

---

### FITTING THE HOSE

---

- 1 Align the hose end with the inlet in the cleaner.
  - 2 Push the hose end into the inlet. It'll click as it locks into position.
- 

### CABLE

---

- 3 Pull as much cable as you need from the back of the cleaner.
  - 4 The yellow band round the cable tells you there's a metre left.
  - 5 The red band tells you "Stop pulling, you've run out of cable!".
  - 6 Watch the cable so it doesn't catch on anything, or trip anyone.
- 

### CARRYING AND MOVING THE CLEANER

---

- 7 Lift the cleaner only by the handle.
- 8 Don't sit it upright – it'll fall over.
- 9 You may move the cleaner around by pulling gently (that's gently), on the hose.



### CHOOSE THE TOOL FOR THE JOB

---

- 10 The tools will fit on the nozzle, or the end of the inner tube.

**big brush** used with the extendable tube, for floors and carpets:

Press the rear of the pedal to extend the bristles for floors with little or no pile. Press the front to retract the bristles for rugs, carpets, and anything with pile.

- turbo brush** used with the extendable tube, for floors and carpets, it has a rotating, suction-powered brush, for deep cleaning.
- crevice tool** as the name implies, down the sides of upholstery, and awkward spaces nothing else can reach.
- small brush** to remove dust from blinds and curtains, and to brush/clean awkward corners.
- sofa brush** to remove pet hair, lint, and dust from upholstery, and other small, flat areas – don't use it on hanging curtains, as it doesn't have the bristles necessary to let air flow freely, use the small brush instead.
- 11 Fit the extendable tube to the nozzle for floors, carpets, or hard to reach places:
- push the tube release towards the narrow end of the tube, and keep it pressed
  - pull out as much of the inner tube as you need
  - if you've finished using it, push it back
  - return the tube release to the locked position
- 12 Fit the wide end of the extendable tube to the nozzle.
- 13 Choose a tool, and fit it to the end of the inner tube.

---

## SUCTION CONTROL

---

- 14 Move the suction control towards the nozzle for maximum suction, away from the nozzle, to reduce suction.

---

## POWER UP

---

**caution** If you've accidentally pressed the on/off switch , the cleaner may start up when you plug it in.

- 15 Plug the cable into a power socket (switch the socket on).
- 16 Press and release the on/off switch , to turn the cleaner on.

---

## CLEANING



---

- 17 Move the tool over the surface, cleaning a small area at a time.
- 18 When you move to a new area, overlap the previous area.

---

## FINISHED?

---

- 19 Press and release the on/off switch , to turn the cleaner off.
- 20 Unplug the cleaner (switch the socket off first).
- 21 Press the  button, and hold it in – the cable will rewind.
- 22 Keep clear of the cable. If it catches on anything, stop pressing, and it'll stop rewinding.
- 23 We've tried not to make it too powerful, to avoid wrecking your home, so you may need to push the plug end in manually.

---

## REMOVING AND EMPTYING THE BIN

---

- 24 It's best to empty the bin after each use.
- 25 Switch off, unplug, and leave it for a minute, to let the dust settle.
- 26 Press the locks on the hose end, and pull the hose from the inlet.
- 27 Hold the handle, press the bin release button, then lift the bin up and out of the cleaner.
- 28 Lower the bin into your dustbin so the bottom of the bin is below the rim, to prevent the dust dispersing into your environment.
- 29 Press the latch on the side of the bin, to open the bottom.
- 30 Give the bin a couple of taps, to shake all the dirt loose.

---

## CHECK THE FILTERS





---

- 31 Spread out some newspaper, and wear rubber gloves.
- \* Filters must be completely dry before replacing in the cleaner.

---

## PLASTIC FILTER

---

- 32 Lift the bottom and close the bin.
- 33 Grip the handle in one hand, grip the bottom of the bin with the other hand.
- 34 Turn the handle till the tab moves from the closed padlock  to the open one .
- 35 Lift the plastic filter out of the bin.
- 36 Clean the outside of the plastic filter with a stiff brush – an old toothbrush is ideal.
- 37 Replace the plastic filter in the bin, and move the tab from  to , to lock it in place.

---

## LID FILTER

---

- 38 Pull the lid lock up, to open the lid.
- 39 Lift off the lid filter.
- 40 Wash it in warm soapy water, rinse, then air dry.
- 41 When it's completely dry, replace it, and close the lid.

---

## PRE-MOTOR FILTER

---

- 42 Lift the pre-motor filter out of the cleaner.
- 43 Soak it in warm soapy water for a few minutes, rinse under a running tap, then let it air dry.
- 44 When it's completely dry, replace it in the cleaner.
- 45 Lower the bottom of the bin into the cleaner, then push the handle forward and down, to lock the bin into the cleaner.

---

## OUTLET FILTER

---

- 46 Press the grip towards the cover, and lift the cover off the cleaner.
- 47 Lift the outlet filter out of the cleaner.
- 48 Tap it gently over the dustbin, to dislodge any dirt.
- 49 If it's really dirty, soak it in warm soapy water for a few minutes, rinse under a running tap, then let it air dry.
- 50 When it's completely dry, replace it in the cleaner.
- 51 Fit the lugs on the cover into the cleaner, then press the grip home, to lock the cover in place.
- 52 Replace the hose end in the inlet.

---

## CLEANING THE CLEANER

---

- 53 Switch the cleaner off and unplug it.
- 54 Wipe external surfaces of the cleaner with a damp cloth.
- 55 Wipe the tools and tubes with a damp cloth.
- 56 Wipe the inside of the bin and its bottom with a damp cloth.
- 57 Don't put any part of the cleaner in a dishwasher.

---

## TIMING

---

- 58 Clean the cleaner frequently. Basically, the better you look after it, the longer it'll last. Keep an eye on it as you use it, and examine the filters when you empty the bin. If anything needs cleaning, do it there and then, don't put it off, in case you forget.

---

## **BLOCKAGES**

---

59 No matter how careful you are, sooner or later you'll block the cleaner.

---

## **DON'T PANIC!**

---

If the cleaner starts to get noisy and you start to lose suction, don't worry, it's not the end of the world, you've probably just blocked it.

- 1 Switch the cleaner off and unplug it.
- 2 Spread a newspaper on the floor, you're going to make a mess.
- 3 If you're using one of the tools, remove and check it first.
- 4 Pull the hose out and check it.
- 5 Use something blunt, like the blunt end of a ball-point pen to dislodge any blockage.
- 6 Remove the bin, and check the filters.
- 7 If you haven't cleared the blockage by now, try again.
- 8 Still not clear? – Ring the helpline.







---

## **WIRING INSTRUCTIONS UK plugs only**

---

The cleaner doesn't need an earth. It has a 13A BS1362 fuse in a 13A BS1363 plug. To replace the plug, fit the blue wire to N, and the brown wire to L. Fit the cord grip. If in doubt, call an electrician. Don't use a non-rewireable/moulded plug unless the fuse cover is in place. If you remove the plug, dispose of it.

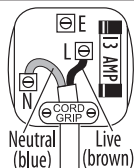

---

## **ENVIRONMENTAL PROTECTION**

---

To avoid environmental and health problems due to hazardous substances in electrical and electronic goods, appliances marked with this symbol mustn't be disposed of with unsorted municipal waste, but recovered, reused, or recycled.



---

## **HELPLINE – 0845 658 9700**

---

If you need help, ring the helpline (it's a local rate number). Please have the **Model No.** to hand, as we won't be able to help you without it. It's on the rating plate (usually underneath the product). The product isn't user-serviceable. If it's not working, read the instructions, check the plug fuse and main fuse/circuit breaker. If it's still not working, consult your retailer.

If that doesn't solve the problem – ring Customer Service – they may be able to offer technical advice.

If they advise you to return the product to us, pack it carefully, include a note with your name, address, day phone number, and what's wrong. If under guarantee, say where and when purchased, and include proof of purchase (till receipt). Send it to:

**Customer Service, Spectrum Brands (UK) Limited, Fir Street, Failsworth, Manchester M35 0HS**

email: [service@russellhobbs.com](mailto:service@russellhobbs.com)

telephone: 0845 658 9700 (local rate number)

---

## **GUARANTEE**

---

Defects affecting product functionality appearing within two years of first retail purchase will be corrected by replacement or repair provided the product is used and maintained in accordance with the instructions. Your statutory rights are not affected. Documentation, packaging, and product specifications may change without notice.

---

## **EXTENDED 6 YEAR GUARANTEE**

---

In order to extend your guarantee to 6 years, register at:

[www.russellhobbs.co.uk/6reg](http://www.russellhobbs.co.uk/6reg)

Registration must be completed within 28 days of purchase.

---

## **ONLINE**

---

[www.russellhobbs.co.uk](http://www.russellhobbs.co.uk) for more products

---

## **REGISTRATION AND PRIZE DRAW**

---

Collect your free reward, and a chance to win £10,000.

Visit [www.productregister.co.uk/rhobbs](http://www.productregister.co.uk/rhobbs)

---