

Fork Truck Attachments

OWNER'S MANUAL

LIFT MASTER BOOMS

MODEL LM-OBT, LM-1T-6, LM-EBT, LM-EBT-6

Contents

Safety Precautions	1
Receiving Instructions	1
Installation Instructions	1
Warranty	1
Operating Instructions	2

Certificate of Assurance	2
Parts Breakdown LM-OBT	3
Parts Breakdown LM-1T-6	4
Parts Breakdown LM-EBT	5
Parts Breakdown LM-EBT-6	5

SAFETY PRECAUTIONS

Read owner's manual completely before operating unit!

- Secure Lift Master Boom to fork truck carriage with safety chain.
- Never stand underneath lift device when in use.
- Be sure fork mast is tilted back toward driver.

RECEIVING INSTRUCTIONS

Every unit is thoroughly tested and inspected prior to shipment. However, it is possible that the unit may incur damage during transit. If damage is noticed when unloading, make a note of it on the **BILL OF LADING**. Remove all packing and strapping material, then inspect the unit again for damage. **IF DAMAGE IS EVIDENT, FILE A CLAIM WITH THE CARRIER IMMEDIATELY!** Finally, check the design specifications to ensure they match those as requested (i.e. model type, capacity, etc...)

INSTALLATION INSTRUCTIONS

STEP 1 - Insert forks through fork pockets of Boom so that the back side of boom is in contact with fork carriage of fork truck.

STEP 2 - Attach safety chain to fork truck carriage.

STEP 3 - Tilt fork carriage and mast back toward the driver so that boom does not slide off forks.

STEP 4 - Make desired adjustments to boom length by sliding the inner extension tube in or out of main tube, and locking it down with infinite locking screw.

WARRANTY

This product is warranted for one year from date of purchase to be free of manufacturing defects in material and workmanship.

This warranty does not cover normal wear of parts or damage resulting from any of the following: negligent use or misuse of the product, use or application contrary to installation instructions, or disassembly, repair or alteration by any person prior to authorization from a factory representative.

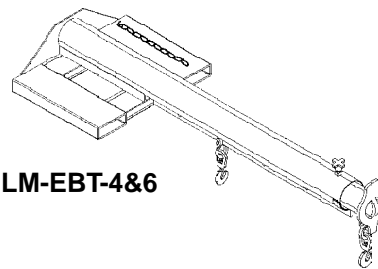

LM-EBT-4&6

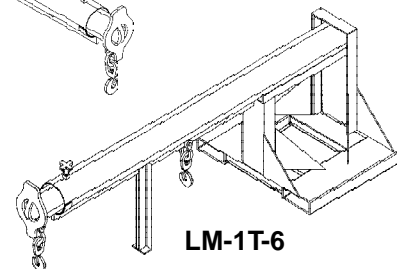

LM-1T-6

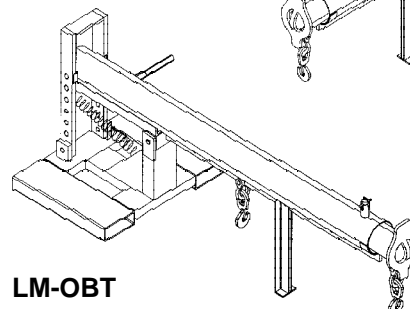

LM-OBT

LIFT MASTER BOOMS

ENGLISH

ESPAÑOL

FRANÇAIS

BEFORE OPERATION

- 1.) Ensure that forks of forklift are completely through boom fork pockets, and that the boom is against the fork uprights near the carriage of the forklift.
- 2.) Secure boom to forklift by wrapping chain around the carriage of the forklift. Pull the chain as tight as possible and lock chain to carriage utilizing the locking hook on either end of the chain.
- 3.) To adjust height using the orbital function: lower boom to the ground with the forklift tines engaged and safety chain secured to mast. While stabilizing the boom pivot handle, remove pivot locking pin and position boom to desired height. (Note: this operation can be performed by one person, but it is strongly recommended to have two persons position the boom.)
- 4.) Extend the telescopic pipe to the desired distance and secure with locking pin. Ensure the pin is locking the telescopic pipe is in place and it cannot move horizontally.
- 5.) Review boom capacity to ensure the boom can lift the desired load at the desired distance safely.
- 6.) Review forklift owners manual for forklift capacity at the load center of gravity distance and raised height to ensure the forklift can lift the desired load safely.

NEVER OVERLOAD THE FORKLIFT!

- 8.) Do not use the boom if it has been damaged.
- 9.) Tilt mast back toward driver. **NEVER** tilt mast top forward as boom may tend to slip off forks.

OPERATION

- 1.) Wrap lifting chain, nylon strap, around the load you desire to move. Secure load to boom utilizing one or both front and rear hooks of the hook bar.
- 2.) Lift the load slowly. If the forklift begins to rise, the load is too heavy for the forklift. Unattached the bundle and move the center of the load closer to the forklift. This may require pushing the telescoping pipe back into the larger pipe and locking into position. Make sure all personnel are clear before attempting to lift load. If bundle does not raise evenly, re-center the lifting chains so the load remains parallel with the surface.
- 3.) Raise the load to transporting height, keeping load as close to the ground as possible.
- 4.) Transport the load to the desired location. Move slowly and avoid all bumps and inclines/declines. Ensure all personnel are clear of the area. If at any time the forklift begins to rise, **STOP**, and adjust the center of the load as described in paragraph number 2.
- 5.) Raise/Lower the load into the desired position. Lower load slowly into place.
- 6.) Un-attach load lifting chains from boom. Push telescoping boom back into larger pipe and secure with locking pin.

Certificate of Assurance

This certificate is your assurance that our Lift Master Series Fork Truck Booms and attachments are manufactured in accordance with our interpretations of applicable national OSHA (29CFR 1910.178) fork truck standards. Please realize that some portions of these standards are the responsibility of the end user to fulfill, i.e., 29 CFR 1910.178 (a)(4) *Modifications and additions which affect capacity and safe operation (of the fork truck) shall not be performed by the customer or user without manufacturers prior written approval. Capacity, operation, and maintenance instruction plates, tags or decals shall be changed accordingly.* It is the responsibility of the user to adapt to state or local laws. The end user is responsible to use the equipment safely in a manner which it is designed for and within the rated capacity of the unit. Please contact the factory for further assistance. Thank you for your interest in our product.

Vestil Manufacturing Company
2999 North Wayne St., Angola, IN 46703
Ph: 260-665-9521 Fax: 260-665-1339
Website: www.vestil.com

ENGLISH

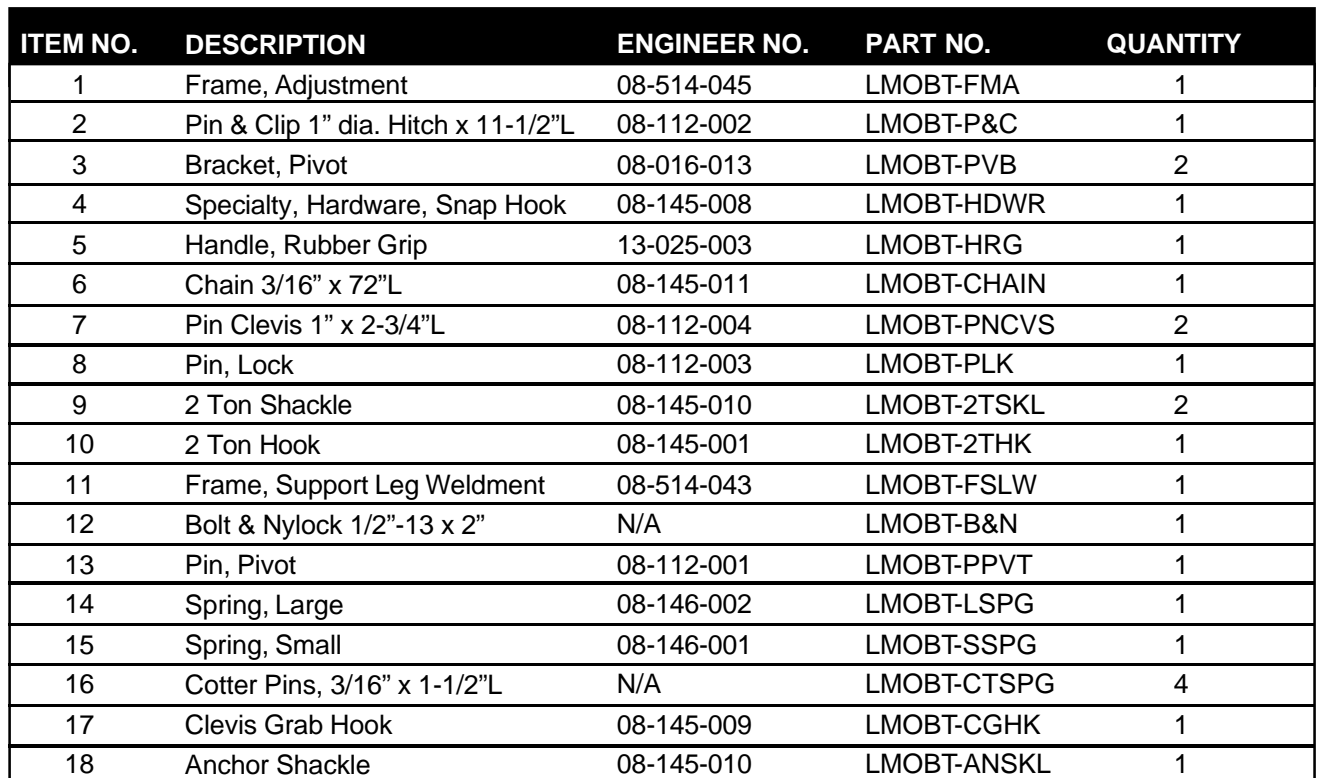

3

PARTS IDENTIFICATION **LIFT MASTER BOOM LM-1T6 & LM-1T**

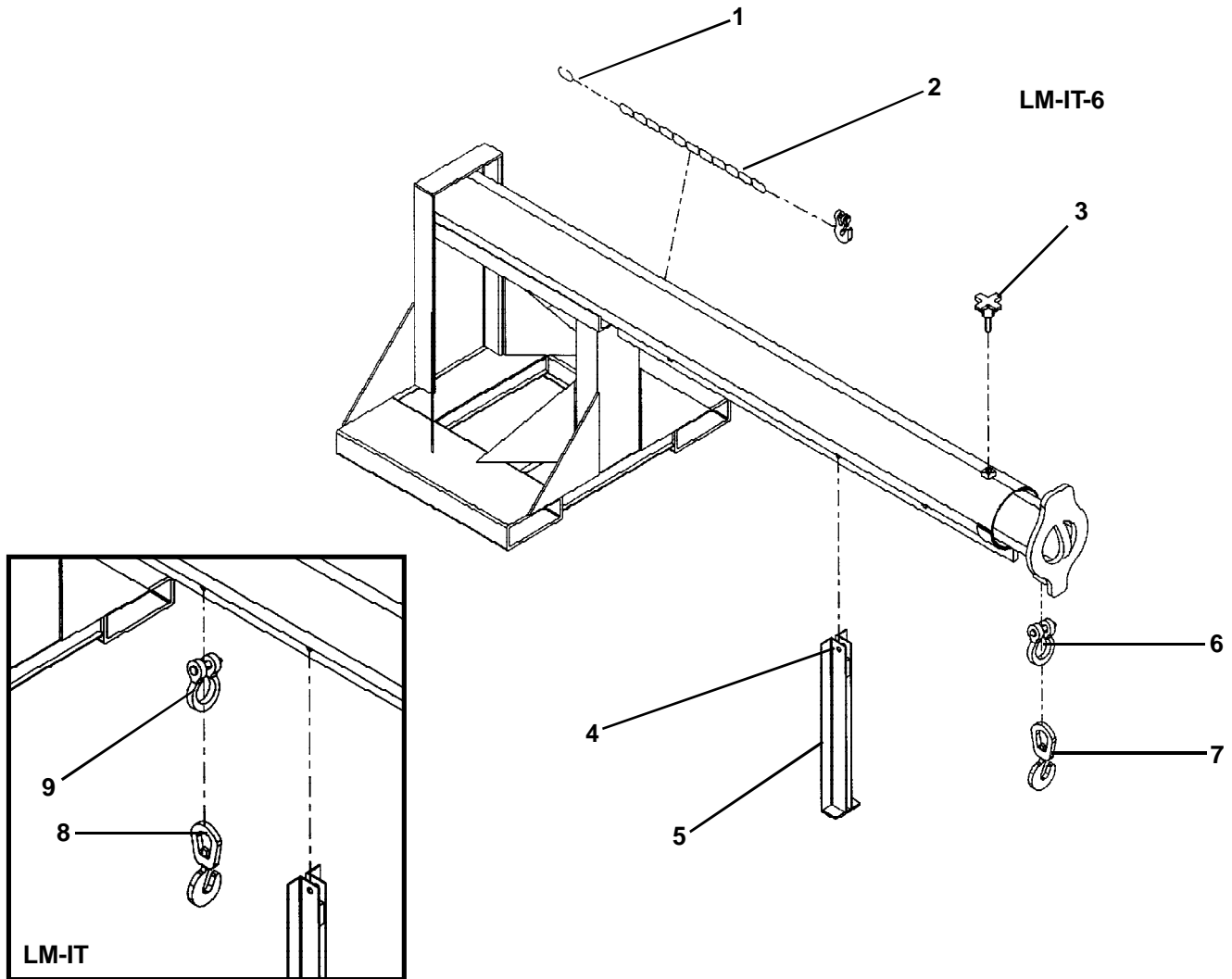

Model LM-IT-6

ITEM NO.	DESCRIPTION	ENGINEER NO.	PART NO.	QUANTITY
1	Snap Hook	08-145-007	LM1T6-SH	1
2	3/16" Chain 36"L	08-145-008	LM1T6-CHN	1
3	Knob	08-025-004	LM1T6-KNB	1
4	Bolt & Nut	N/A	LM1T6-BN	1
5	Frame Support Leg (Weldment)	08-514-042	LM1T6-FSL	1
6	3 Ton Shackle	08-145-004	LM1T6-3TSKL	1
7	3 Ton Hook	08-112-002	LM1T6-3THK	1

N/A- NOT AVAILABLE

Model LM-IT

ITEM NO.	DESCRIPTION	ENGINEER NO.	PART NO.	QUANTITY
8	Clevis Grab Hook (LM-1T only)	08-145-009	LMIT-CGHK	1
9	Anchor Shackle (LM-1T only)	08-145-010	LMIT-ANSKL	1

N/A- NOT AVAILABLE

PARTS IDENTIFICATION **LIFT MASTER BOOM LM-EBT & LM-EBT-6**

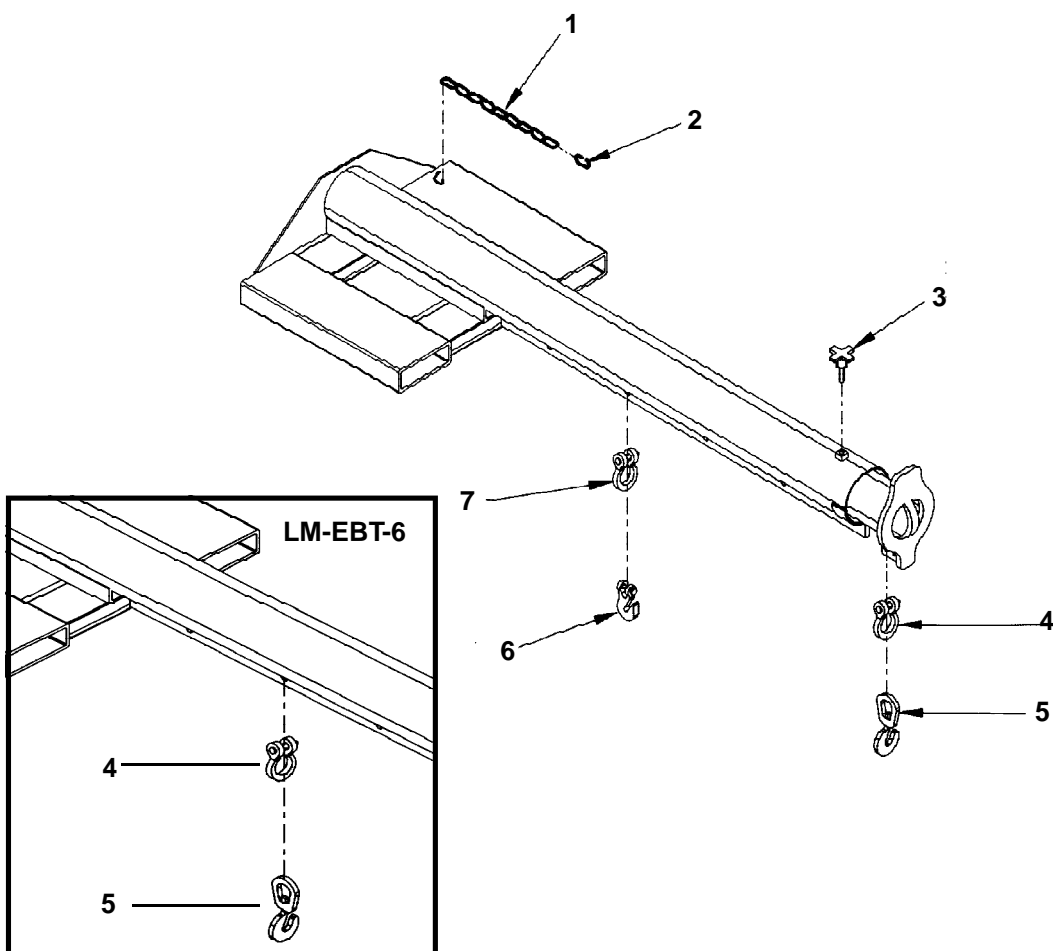

ENGLISH

Model LM-EBT

ITEM NO.	DESCRIPTION	ENGINEER NO.	PART NO.	QUANTITY
1	3/16" Chain x 36"L	08-145-007	LMEBT4-CHN	1
2	Snap Hook	08-145-008	LMEBT4-SNHK	1
3	Knob	08-025-004	LMEBT4-KNB	1
4	Anchor Shackle	08-145-003	LMEBT4-ANSKL-1	1
5	2 Ton Swivel Hook	08-145-001	LMEBT4-2TSWHK	1
6	Clevis Grab Hook	08-145-009	LMEBT4-CGHK	1
7	Anchor Shackle	08-145-010	LMEBT4-ANSKL-2	1

Model LM-EBT-6

ITEM NO.	DESCRIPTION	ENGINEER NO.	PART NO.	QUANTITY
1	3/16" Chain x 36" L	08-145-007	LMEBT6-CHN	1
2	Snap Hook	08-145-008	LMEBT6-SNHK	1
3	Knob	08-025-004	LMEBT6-KNB	1
4	Anchor Shackle	08-145-004	LMEBT6-ANSKL	2
5	3 Ton Swivel Hook	08-145-002	LMEBT6-3TSWHK	2