

INVERTER

Panasonic®

Operating Instructions Refrigerator

For Household Use

Model No: NR-BW415V, NR-BW465V
NR-BW415X, NR-BW465X



NR-BW415V



NR-BW415X



NR-BW465V



NR-BW465X

Contents

• Safety precautions	2
• Required action	4
• Installation	5
• Parts identification	6
• Food storage in the freezer compartment	7
• Temperature control (Model: NR-BW465V, NR-BW415V)	7
• Temperature control (Model: NR-BW465X, NR-BW415X)	8
• Quick freezing	9
• ECO NAVI operation	9
• How to clean the refrigerator	10
• Troubleshooting	11
• Specifications	12

Thank you for purchasing the Panasonic product.

- Please read these instructions carefully and follow safety precautions page 2-3 before using this product.
- Please make sure the date and name of store of purchase are stamped in warranty card and keep it with this operating instructions.

RBD/PGF/GULF

AK-156490
T0112-0
Printed in Thailand

Safety precautions

Please be sure to follow these instructions.



WARNING

This sign means
[It may lead a serious injury or death.]



CAUTION

This sign means
[It may result in injury or property damage.]



These signs mean prohibited action.



This sign means required action.



R600a

iso-butane

Otherwise it may cause
a fire, injury, explosion,
electrical shock.



WARNING

In case of emergency...



R600a
iso-butane

- Do not use electrical appliances such as a deodorizer in the refrigerator. (If the refrigerant leaks, then it may catch fire due to sparks on the contacts.)
- Do not store explosive substances such as aerosol cans with a flammable propellant and chemicals or scientific specimens in this appliance.
- Maintenance work only be carried out at workshop by well-trained maintenance worker.
- Servicing personal in Queensland are hereby advised that Queensland installation/servicing requirements must be followed, including the need for a Gas Work Authorisation (hydrocarbon refrigerants), if the gas system of this appliance is opened or charged.
- This appliance contains a small quantity of R600a refrigerant which is environmentally friendly, but flammable. It does not damage the ozone layer, nor does it increase the greenhouse effect.
- During transportation and installation, ensure that the tubing of the refrigerant circuit is not damaged.
- Leaking refrigerant can ignite and may damage the eyes.
- In the event any damage does occur, avoid exposure to open fires and any device which creates a spark. Disconnect the appliance from the mains power.
- Thoroughly ventilate the room in which the appliance is located for several minutes.

In case of emergency...



R600a
iso-butane

- Notify (insert authorised service agent details) for necessary action and advice.
 - The room for installing the appliance must be at least 1 cubic metre per 8 grams of refrigerant. The refrigerant quantity contained in this appliance is noted on the Rating Plate of the appliance.
-
- **Stop** using the refrigerator immediately if there is an abnormality or failure. (Otherwise it may cause smoke, a fire or electrical shock.)
Abnormality and failure examples.
 - Power cord or plug is abnormally hot.
 - Power cord is deeply cut or deformed.
 - There is burning smell.
 - You can feel tingling electricity.
 - A flammable refrigerant is used. If you have damaged the cooling circuit (piping), open the windows to ventilate the kitchen and contact your dealer. (Otherwise it may cause an electrical shock, ignition or explosion.)
-
- Do not disassemble, repair or modify the refrigerator by yourself. If you want to repair the refrigerator, please consult your dealer or authorized service center.
 - Do not use mechanical device or other means to accelerate the defrosting process, other than those recommended by the manufacturer.

Safety precautions

Please be sure to follow these instructions.

Otherwise it may cause a fire, injury, explosion, electrical shock.



WARNING

When recycling the product...



- Before taking the refrigerator to be recycled, please remove all the door opening seal to prevent locking a child in it.
- The warning labels mentioned above should be kept throughout the life of the refrigerator.
The user manual should be handed over to any person who would use or handle the refrigerator whenever the refrigerator would be transferred to another location and delivered to a recycling plant.
- Regarding to local laws, Cyclo-Pentane is used for insulation of this refrigerator and flammable gas is used for refrigerant. When you throw away this unit, please discard it by proper method and do not dispose it by burning.

For power plug and cord...



- Do not plug or unplug with wet hands.
- Do not let the cord or plug be damaged. If the supply cord is damaged, must be replaced by service center.



- Disconnect power plug when cleaning.
- Plug into a wall outlet of the rated voltage on its own with the rated current and insert plug fully.
- Reserve one plug for the refrigerator only. Avoid connecting many appliances to the same plug and unroll through the length of cord.
- Remove dust periodically from the power plug.
- If you detect a gas leak, do not touch the power plug and ventilate the kitchen.
- If you detect burning smell, disconnect the power plug and ventilate the kitchen.

Otherwise it may cause burn injury, accidents.



CAUTION

When using...



- Do not damage the cooling circuit (piping on the back.) The flammable refrigerant may catch fire and lead to an explosion.
- Do not touch compressor or pipe, this area is high temperature.
- Do not let any children hang the refrigerator's door, it may overturn to the kid.
Children should be supervised to ensure that they do not play with the refrigerator.
- Do not place any water container on the top of the refrigerator.
- Do not fill the gaps around the refrigerator. (If the refrigerant leaks, then it may catch fire.)



- This appliance is not intended to use by persons (including children) with reduced physical, sensory or mental capabilities or lack of experience and knowledge, unless they have been supervised by responsible person for their safety.

When opening/closing the doors...



- While opening the refrigerator, be careful not to pinch other one's hand holding the door.
- Mind the gap between the doors. They may nip your hand while closing the door.

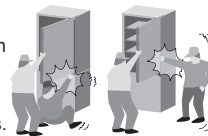

When storing food...



- Do not add a high impact on glass trays. (Otherwise those glass trays may break and you may be injured.)
- Do not freeze glass bottles. (If the liquid in a glass bottle is frozen, then the bottle may break and the liquid may leak out.)



When moving the refrigerator...



- Hold the refrigerator tightly when transporting.
- Apply protective covering, etc. to floors with a fragile surface.



Required action

When opening/closing the doors...

- **Do not** refrigerate items which are bigger than tray or shelf, as the door will not close completely causing leakage of cool air.
- **Do not** open refrigerator frequently or leave it open for long time in order to prevent water dripping inside and waste energy.
- Frequently check the door opening seal, it must be closed to the refrigerator's body completely.

When cleaning...

- **Do not** clean the refrigerator with chemical substance or liquid. It will cause damage and have corrosion on the surface.
- Clean the pan water evap located over the compressor at the back of the refrigerator every three months to prevent the odour generated from humidity.



When using...

- When the plug is disconnected, leave it for 10 minutes before plugging again. If not, the compressor may not work.
- **Do not** put anything on top of the refrigerator. Otherwise, it may fall due to vibration.
- Adjust the temperature according to the actual operating condition for energy saving.
- If you will not be at home for several days and there are nothing refrigerated in the refrigerator, the plug should be disconnected for energy saving.



When storing food...

- **Do not** place warm/hot foodstuff in the refrigerator. Store warm food and drinks after they have cooled.
- **Do not** overload the refrigerator. Gap must be provided between foodstuffs to maintain the cooling effect.
- Store fruits and vegetables in vegetable case, where trapped moisture helps preserve food quality for longer time periods.
- Drinking water, beverage bottles should be sealed to prevent the odour.
- Foodstuff such as vegetable, fruits and fresh food should be wrapped or pack in box before freezing and refrigerating.
- Put the food such as meat or fish in the freezer if you want to store for an extended period.
- If you will put high moisture content into refrigerator, should be sealed and wrapped to prevent dew and frost.
- It is suitable for storage food and so on which would like to storage another food separately.

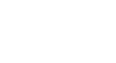

Utility box

Installation

The distance from the wall is installed

- The top of the refrigerator and the ceiling at least 30 cm.
- The wall and the back of the refrigerator at least 10 cm.
- The side of the refrigerator and the wall at least 5 cm.

Area around installed

- **Do not** locate the refrigerator in a humid place as rust may form and may cause electric leakage.
- **Do not** locate the refrigerator exposing to direct sunlight as the heat and sunlight will increase the temperature.
- **Do not** locate the refrigerator near heat source such as cooking stove or oven.
- **Do not** block the openings on the circumstances of the refrigerator.
- The refrigerator must be located in the place where there is good air circulation.
- In case of placing the refrigerator on an uneven surface, adjust the adjustable bolt to make the refrigerator stands stably.

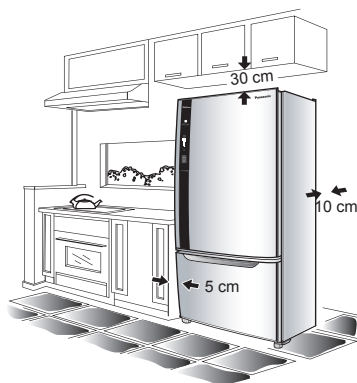

Moving or shifting

- When moving or shifting the refrigerator, remove ice twister, top freezer case, pan water evap etc. and check to be sure that there is no water in the refrigerator, adjust the adjustable bolt of refrigerator, then move the refrigerator and install in the location, adjust adjustable bolt for locking.

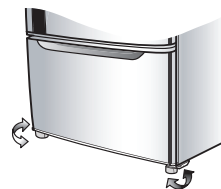

Power cord setting

- To bring power cord for use, pan water evap from left should be lifted up. Then bring the power cord out and then insert pan water evap into the block by pressing at both the sides.

LED lamp and Grounding

- The refrigerator LED lamp, specially designed for this refrigerator, does not function on individual replacing. If you need replacement, please contact Panasonic Service Center.
- If there is no grounding wiring plug in refrigerator, it should be connected with grounding connection or prevent electrical hazard from electric leakage.

For safety, the ground connection should be done

(For a refrigerator with plug (2-pin plug) without any ground wire)

The ground connection will allow prevention of danger resulted from electricity leakage.

The ground connection can be performed in 2 ways as follows:

1. In the case that the grounding receptacle having been prepared for the socket (plug socket), connect the ground wire to the screw used for ground connection at the bottom rear of the refrigerator (regarding the screw used for ground connection, please notice the ⚡ symbol) as shown in the illustration ①.
2. In the case that the socket (plug socket) having not been provided with any grounding receptacle, connect the ground wire to the screw at the bottom of the refrigerator, (as regards the screw used for ground connection, please notice the ⚡ symbol). And then connect the other end to the ground rod as shown in the illustration ②.

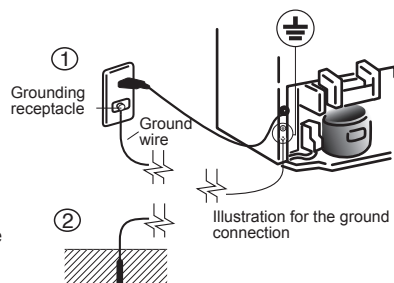

Prohibited spots for ground connection

- Gas pipes and water supply pipes (dangers from electric shock or explosion).
- The ground wires of telephone cords and lightning rods (dangers from lightning).

Parts identification

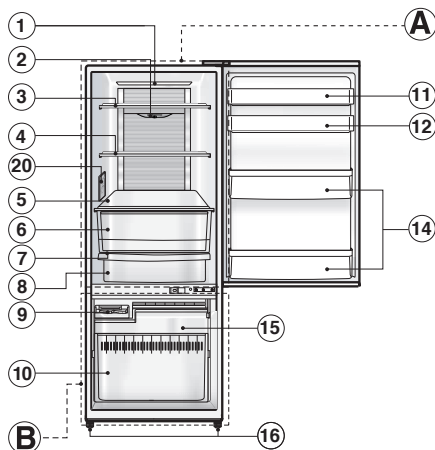

NR-BW465V, NR-BW415V

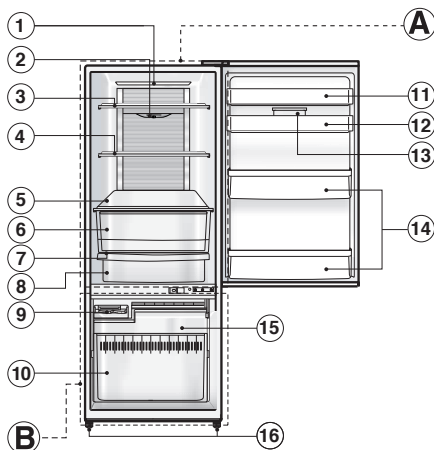

NR-BW465X, NR-BW415X

A REFRIGERATOR COMPARTMENT

B FREEZER COMPARTMENT

① LED Lamp

② Refrigerator temperature control

③ Small tempered glass tray

④ Large tempered glass tray

⑤ Tempered glass tray crisper

⑥ Vegetable case

⑦ Tray chilled top

⑧ Chilled case

⑨ Ice twister

⑩ Bottom freezer case

⑪ Egg shelf
(model NR-BW465V, NR-BW465X)

⑫ Egg shelf with egg tray

⑬ Utility box
(model NR-BW415X, NR-BW465X)

⑭ Bottle shelf

⑮ Top freezer case

⑯ Adjustable bolt

⑰ Freezer control and Quick freezing mode
(model NR-BW415X, NR-BW465X)

⑱ Pan water evap

⑲ Compressor

⑳ Freezer room temperature control (model NR-BW415V, NR-BW465V)

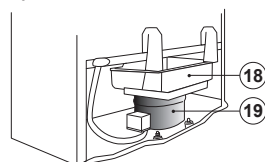

Product view from behind.

Freezer control and Quick freezing mode

For only model.

- NR-BW415X
- NR-BW465X

FREEZER CONTROL
button

QUICK FREEZING
button

This portion is shown at front of the product.

Freezing control

For only model.

- NR-BW415V
- NR-BW465V

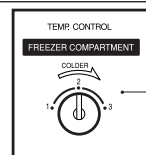

SPECIAL FEATURE

1) NON-FLON

This unit uses totally NON-FLON MATERIALS both for refrigerant (iso-butane (R600a)) and for insulation (Cyclo-Pentane). So, this refrigerator does not damage the earth's ozone layer and has almost no effect on global warming.

2) INVERTER

In accordance with temperature change inside the compartment, the motor runs at different speed. When the temperature is stable, the motor runs at a lower speed (energy saving & lower noise). When powerful cooling is required, the motor runs at a higher speed.

Food storage in the freezer compartment

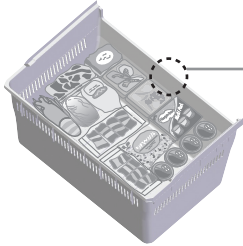

Bottom Freezer Case

Maximum Storage

If the stored food exceeds edge of container, the freezer door can not close completely and the compartment may become frosted.

How to make ice cubes

1. Pull out the ice twister.
2. Fill water in the ice twister until the water level line, then place it back.
3. To remove ice cubes
 - 1) Be sure to put in a top freezer case inside.
 - 2) Twist the ice twister clockwise.
(The ice cubes will drop into the ice freezer case.)

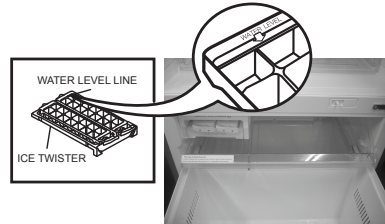

Remark

- If an ice twister is twisted while top freezer case pulled out, ice and water will fall inside or floor. Please be sure to put in a top freezer case to receive the falling ice.

Temperature control (Model: NR-BW465V, NR-BW415V)

Refrigerator compartment temperature control

<p>REFRIGERATOR CONTROL MIN ··· MED ··· MAX</p> <p>The temperature can be adjusted for MIN, MED and MAX levels. Indicating number and cool level.</p>	"MIN" Higher by approx. 5°C ~ 10°C
	"MED" Approx. 2°C ~ 7°C
	"MAX" Lower by approx. -1°C ~ 4°C
<p>TEMP. CONTROL FREEZER COMPARTMENT</p> <p>COLDER</p> <p>1 2 3</p> <p>The temperature can be adjusted for 1-3 levels. Indicating number and cool level.</p>	Number "1" Higher by approx. -13°C ~ -18°C
	Number "2" Approx. -17°C ~ -22°C
	Number "3" Lower by approx. -19°C ~ -24°C

Remark

While operating the refrigerator for the first time, after connecting the plug, adjust the temperature to "MED" position of each control and leave it for 24 hours for the effective cooling operation. After that, adjust the temperature as you prefer. If you want to save the energy, do not adjust the temperature lower than the actual operating condition.

Temperature control (Model: NR-BW465X, NR-BW415X)

This refrigerator is specially designed for appropriate use, which can adjust the temperature level to detailed 9 levels with the following details.

How to operate the “9 levels” mode

1. Set LED display to “MIN” with the “FREEZER CONTROL” button.
2. Press the “FREEZER CONTROL” button (for 10 seconds) until the LED display return to show at “MIN” position.
3. Set “9 levels” mode following below table mentioned by pressing the “FREEZER CONTROL” button.

Cooling Level	Minimum Maximum								
	1	2	3	4	5	6	7	8	9
FREEZER CONTROL LED DISPLAY									

Lighting

Blinking

Not lighting

LED Display table

To reset the setting “9 levels” mode

Repeat step 1 and 2, then the refrigerator return to normal operation mode.

Remark:

Temperature control varies depends on the changing of environment and food storage quantity.

Refrigerator compartment temperature control

<p>The temperature can be adjusted for MIN, MED and MAX levels. Indicating number and cool level.</p>	“MIN” Higher by approx. 5°C ~ 10°C
	“MED” Approx. 2°C ~ 7°C
	“MAX” Lower by approx. -1°C ~ 4°C

Freezer compartment temperature control



<p>The temperature can be adjusted for MIN - MAX levels. Indicating operate and cool level.</p>		“MAX” Lower by approx. -19°C ~ -24°C
		“MED” Approx. -17°C ~ -22°C
		“MIN” Higher by approx. -13°C ~ -18°C

Quick freezing

Model : NR-BW415X, NR-BW465X

How to operate the “QUICK FREEZING” mode



- Press the button “QUICK FREEZING” (Blue light LED  turns on) blue light LED (150 min “QUICK FREEZING” mode.)
- The system will stop operating automatically when it runs for 150 min and return to normal mode (Blue light LED  turn off)

Remarks :

- If you want to stop the operation, press the button “QUICK FREEZING”.
- Blue light LED  flashing means that the defrosting system is now working “QUICK FREEZING” mode will start right after the defrosting operation is finished.
- Freezer temp. control does not operate during “QUICK FREEZING” mode. (The compressor rotation is at the maximum level for “QUICK FREEZING” mode)

ECO NAVI operation

Model : NR-BW415X, NR-BW465X

Detect opening and closing of door and brightness around refrigerator, and automatically controls operation to save energy¹.

ECO NAVI lamp is on during ECO NAVI operation

- This refrigerator learn the lifestyle patterns of your family from opening and the time periods of infrequent use to perform ECO NAVI operation.

Remark :

- The refrigerator learns your lifestyle pattern from the previous 3 weeks, and uses what it has learned from the 4th week onwards. Therefore, the ECO NAVI lamp “ON/OFF” pattern may change from the 4th week onwards.
- The refrigerator performs ECO NAVI operation when it becomes dark² around the refrigerator, such as when you are asleep.
- The brightness of the lamp is lowered approximately 5 minutes after the lamp turns on.

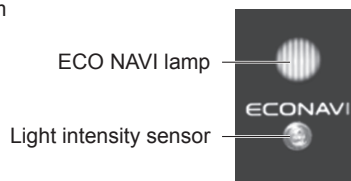

Setting for enabling ECO NAVI operation

- ECO NAVI operation is enabled automatically only when the temperature control of the freezer compartment are set to “MED”.
(However, ECO NAVI does not operate while quick freezing is operating.)
- It is not possible to forcefully start ECO NAVI operation.

Remark :

¹ Effectiveness differs depending on the ambient temperature, ambient brightness, number of times and when doors are opened and closed, and state in which food is stored.

² Darkness is detected by the light intensity sensor at approximately 3 lx to 10 lx or less

How to clean the refrigerator

1 Interior cleaning

Wipe off the stain with warm water. When stains can not be removed easily, wipe them with warm water and soap by using a soft cloth. Then wipe the soap off using damp soft cloth.

2 Exterior cleaning

Cleaning by using soft cloth with warm water and soap. Then wipe off the soap.

3 Gasket door PC

- Clean by wiping softly. This area, petroleum gel was applied to reduce the friction of the refrigerator body. Be careful not to wipe off them.
- The door opening seal is replaceable when reaching end of life. While cleaning, push it back to the groove if it comes off.

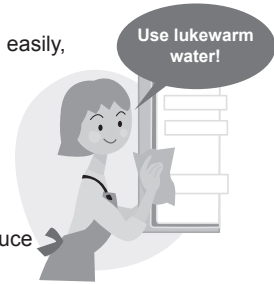

Note: Do not use the following items. (Otherwise, the surface will be scratched.)

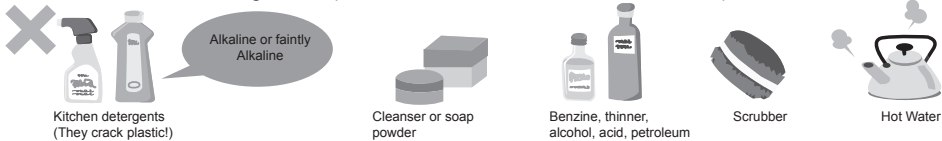

Removing trays for cleaning.

• Removing

1. Unhook the protrusion at the back by lift it upward and pull the tray forward until removing.

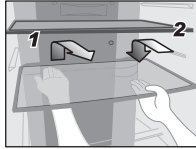

• Attaching

2. Push the tray until it reached the end lock.

Remark

- When removing tray above vegetable case, please pull out the vegetable case first and then follow to removing the tray as above details.
- In case of attaching the tray and it does not lock, make sure that you did not attach it the wrong tray.

Removing the vegetable case and chilled case for cleaning.

• Removing

1. Pull the case until it reached the end of stopper.
2. Raise up the front of case a bit and then completely take out.

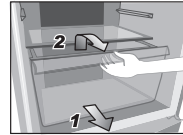

• Attaching

1. Push the case on both supporters.
2. Raise it up, then push until it reached the end.

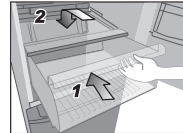

Removing egg shelf, bottle shelf for cleaning.

• Removing

1. Lift it upward, alternating between the right and left side.

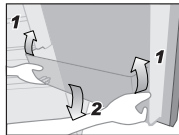

• Attaching

2. Placing it on both supporters, and then press until it reached the end of supporters.

Removing the top and bottom freezer case for cleaning.

1. Pull the freezer drawer toward yourself, raise up a bit the front of freezer drawer and pull the freezer drawer until stopper.
2. Pull the top freezer case toward yourself, raise up a bit and then move it upward to remove.
3. Lift both sides of bottom freezer case and move it upward to remove.

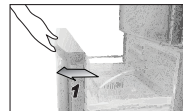

Troubleshooting

The refrigerator does not operate.

- Check that the plug and its socket are in good condition.
- Check if there is any problem on main fuse and electrical system of the house.
- Check by unplug and wait for 5 minutes before plugging it back in.

The refrigerator does not cool enough.

- Check to be sure that the temperature control button or lever is at the proper position.
- Check to see if the refrigerator is overloaded with stuff or there is any hot foodstuff refrigerated inside.
- Is the refrigerator exposed directly to sunlight or heat source?
- Is the refrigerator door completely closed?
- Is the refrigerator door opened frequently?

Vapor generated inside and outside the cabinet / surface of door.

- Condensation may appear on the surface of cabinet when humidity is high, e.g. during rainy season or the air circulation is not good.
- If there is condensation inside, check if the door is completely closed. Is the refrigerator frequently opened or left open for a long time? Is there any hot foodstuff refrigerated inside?

The refrigerator generates noise.

- Check if the refrigerator is located on a stable floor or is installed properly.
- Check if there is any object in contact with the refrigerator.

Food becomes frozen

- Do you put the food near cold air duct?
- Do you adjust the temperature control at "MAX"? Adjust to "MIN".
- Do you put food in chilled case?

The ECO NAVI lamp does not light properly.

ECO NAVI does not operate.
(the ECO NAVI lamp does not light)

- Is the quick freezing operating?
- Are the temperature setting of freezer compartment set to something other than "MED" ?
- Did you open the doors frequently, or store very hot food?
- The learning function may automatically disable ECO NAVI operation during times of frequent use.

ECO NAVI operation is rarely performed.

- Is there a power failure?
If a power failure occurs, the leaning function data collected up until that will be lost. ECO NAVI operation will rarely be performed until the learning function has collected the data again.

ECO NAVI operation is stopped part way though.

- If for example, defrosting (auto) is turned on during ECO NAVI operation, the normal cooling operation will need to be performed afterwards so ECO NAVI operation may be stopped.
- The learning function may be sometimes restart the normal cooling operation.

ECO NAVI operation is performed too often
(the ECO NAVI lamp rarely turns off).

- Is the light intensity sensor hidden?
- Is there dirt scratches on the control panel (light intensity section)?
- ECO NAVI operation may be performed while the refrigerator is being used depending on the conditions of use, but the cooling performance is maintained.



