

Orbital Bottle Washing Machine

(Specification & User's manual) (BAL-3001)



FILLER CO., LTD.

TEL:(02)2593-1616 2591-6873

FAX:(02)2586-4587

<http://www.filler.com.tw>

E-mail:filler@filler.com.tw

Directory

A. Specification / Technical Capability	01
B. Diagrammatic Structure	02
C. Diagrammatic Dimensions	03
D. List of Accessories	04
E. Control Panel Introduction	05
F. Warnings &Emergency Measures	06
G. Assembling procedures.....	07
H. Disassembling procedures.....	09
I. Operation Procedures	10
J. Washing terms instruction	11
K. Warranty & Proof of Purchase.....	12
L. Maintenance & Replacement Record Sheet	14

Filler

Orbital Bottle Washing Machine BAL-3001

A. Specification / Technical Capability



Dimension of Main Machine: L x W x H
140cm x 52cm x 120cm (4'7" x 1'8.5" x 3'11")
Net Weight of Main Machine: 85 kg (188 lbs)
Power Supply: 110V, 50/60Hz
Equipment Needed: Air compressor with 1 horsepower
or above

Technical Capabilities:

- Washing speed: Up to 1800 bottles per hour (average 30 bottles per minute).
- Applicable bottle-size height 2.5cm ~ to 22cm, diameter (either side) 1cm ~ 9cm.
- 4 rinse head spray nozzles adapted, effective washing and drying are done via multidirectional water flow followed by high pressure air to immediately blow dry bottles.
- Motor speed adjustable, rapid washing works in straight track while oval orbiting gives high purity to bottles of different shapes.
- Special designed mold allows for fast and easy changing.
- Utilize top grade stainless steel and alloy for all major parts.

***Note 1: Machine works with air compressor. It is more cost effective to directly purchase from general hardware stores.**

***Note 2: Using water rinse, recycled bottles (second time used bottle) are not suitable for this machine**

***Note 3: There are 16 bottles per working track:**

B. Diagrammatic Structure

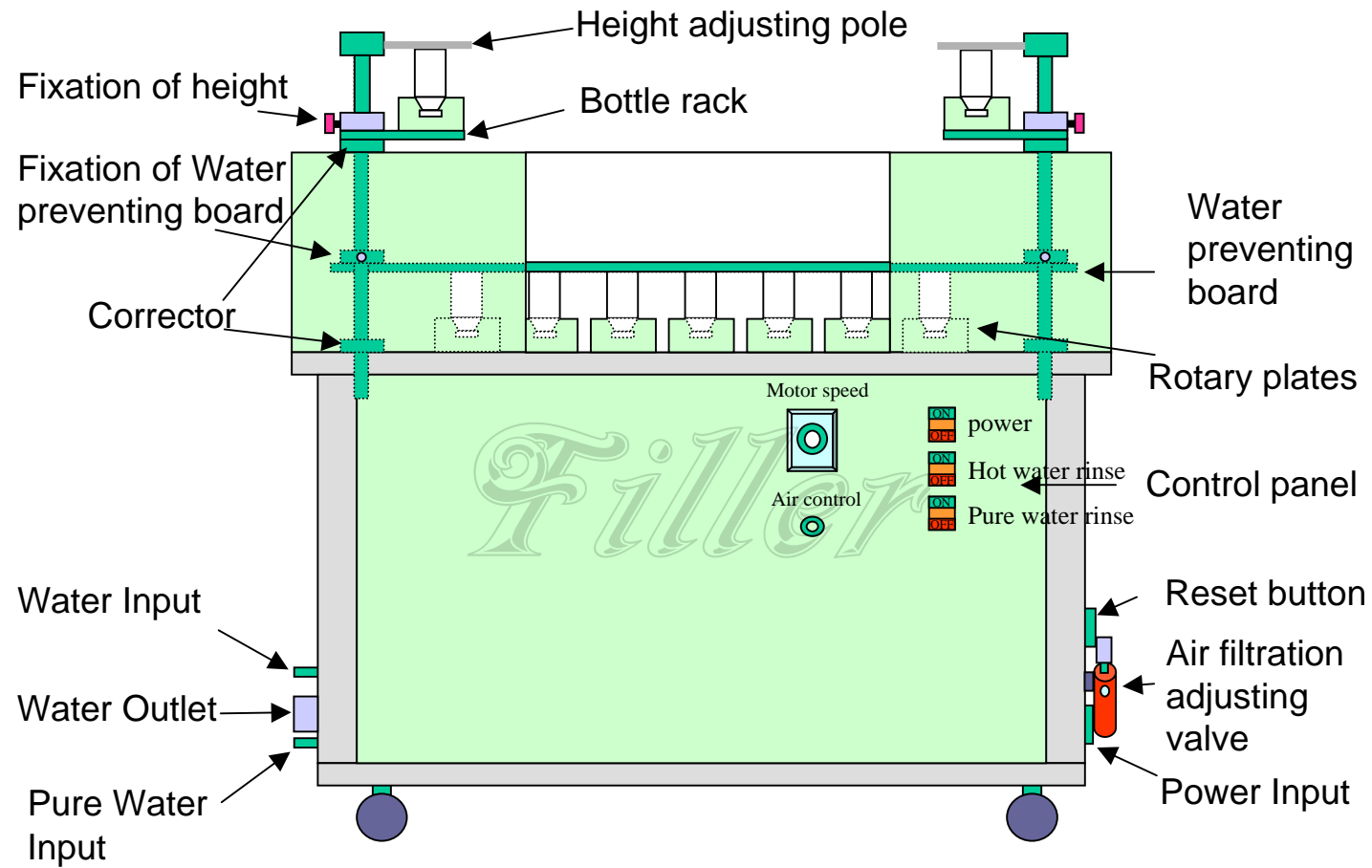

C. Diagrammatic Dimensions

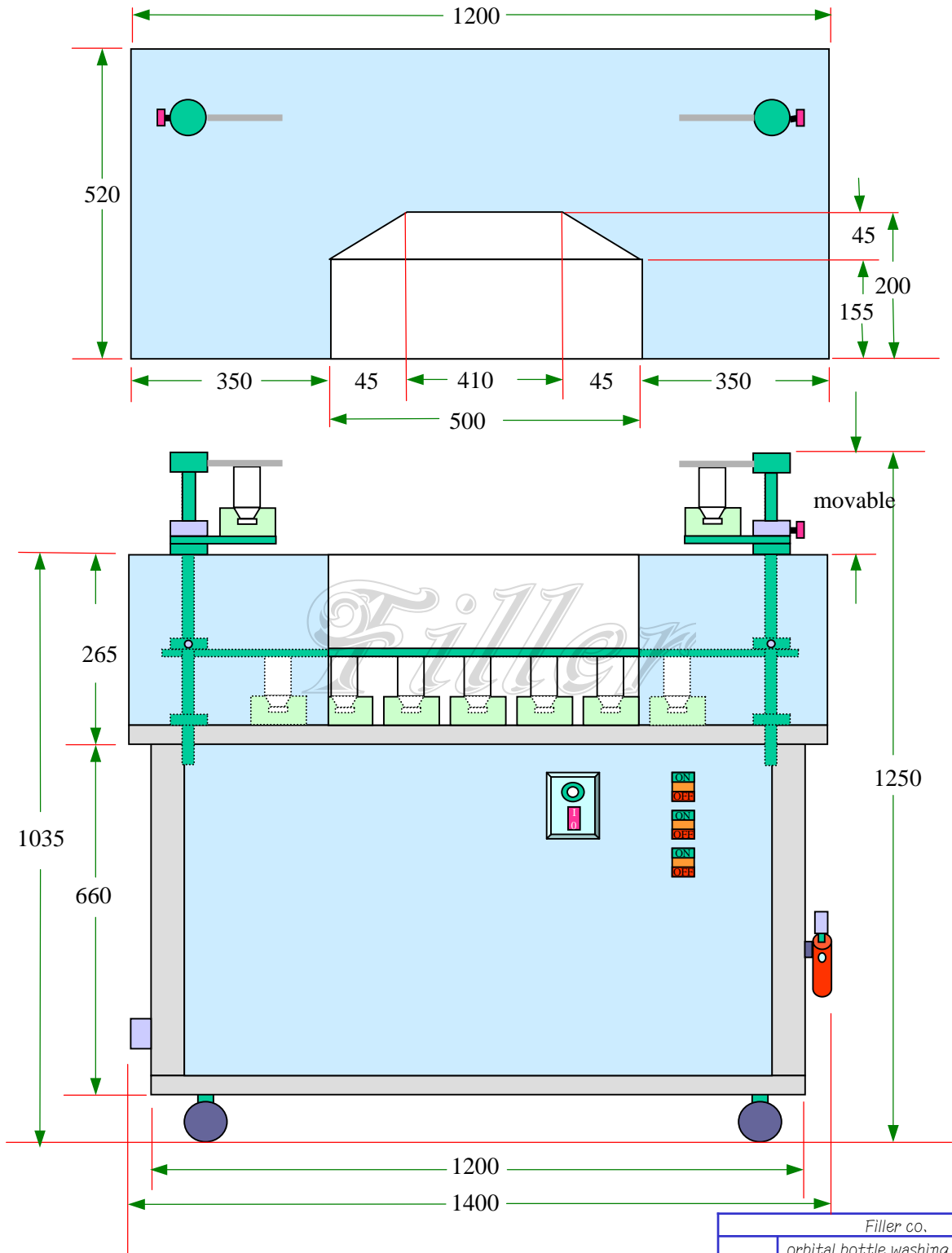

Filler co.			
item	orbital bottle washing machine BAL-3001		
Map no	02	Scale	1 : 1
Q'ty	1	Measurement	mm
date	97.09.23	material	Aluminum alloy & stainless steel

D. List of Accessories

item	illustration	article	code	Quantity	description	remarks
1		Mold	BW-24	16 pieces		
2		Mold Seat	BW-13	2 pieces		
3		Fixing bolt	BW-25	16 pieces		
4		User's manual	FM-B3001	1 set		

E. Control Panel Introduction

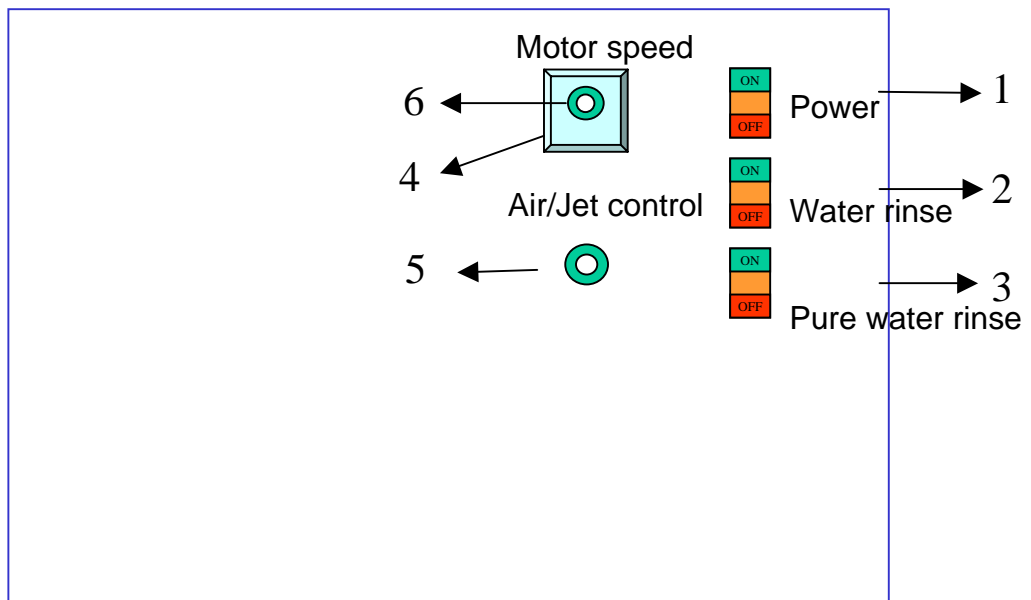

Filler

- 1. Power on / off**
- 2. Power on / off of water pump**
- 3. Power on / off of pure water pump**
- 4. Motor speed controller**
- 5. Air/Jet control button**
- 6. Motor speed adjusting button**

F. Warnings & Emergency Measures

1. This machine should be operated by air compressor and electricity, please check if the voltage is appropriate before use. Also check if the air compressor is connected with the machine. In order to keep the action in good and normal situation, the motor will shut off automatically when the air pressure is below 3Kgcm. While the air pressure is back to normal standard (3.5Kgcm), the motor will rerun.
2. Please install the washing mold carefully as the motor power is on, and make sure the mold is assembled well in right place to avoid seize-up.
3. Disassembling the main body of machine is strictly prohibited. Action of such automatically results in warranty to be totally voided.
4. Connect the ground wire along with the plug properly before use. Never attempt to dismantle the ground wire.
5. Avoid any careless operation at all time.
6. Turn off the Power while it's not in use for a long time.

Emergency measures -

Press reset button or unplug the power immediately in case of any abnormal output continually performed by the machine.

Contact us right away for further assistance. Never attempt to dismantle the machine.

G. Assembling Procedure

1. Selecting one mold which fits the bottle, it needs totally 16 pieces of mold and 16 pieces of fixing bolt.

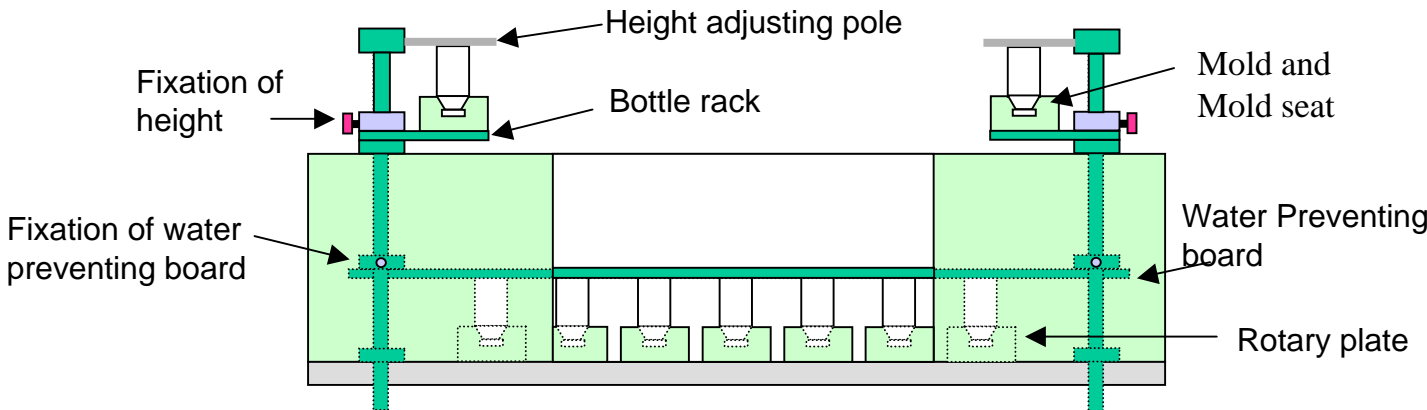

2. Put a set of mold (including the seat) together with bottle on the bottle rack (1 set for each side), adjust the height adjusting pole to fit the bottles, then put down the fixation of height and lock.

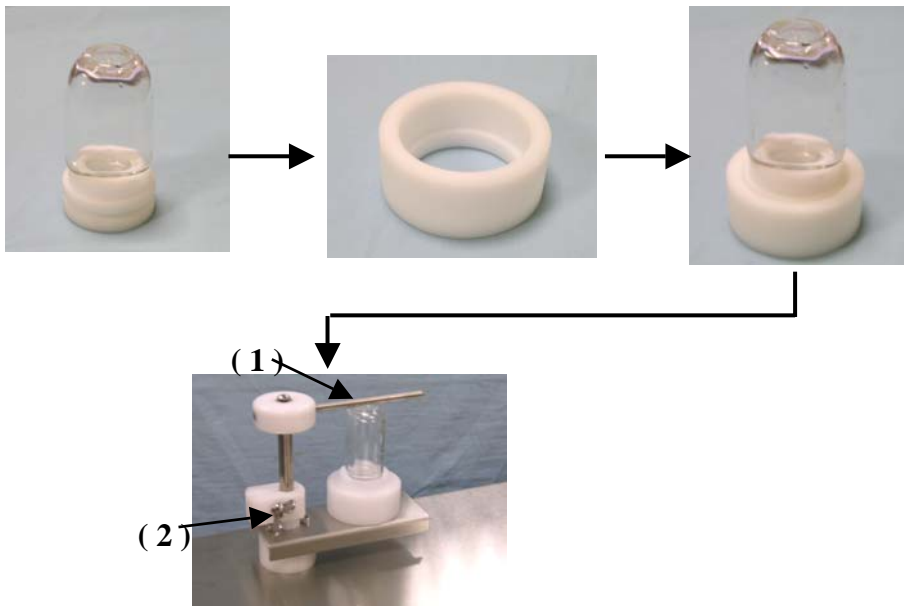

3. Turn on the power, motor will run automatically. Then adjust the motor speed to zero(0).

please note: when the speed is zero, the power of motor is still on. Please do the following procedure carefully.

4. Install 3~4 molds at first, then install the others following the rotary plates by adjusting the motor speed until 16 molds are finished.

please note: when install the mold the motor speed should be on zero(0).

Following is the instruction of one set mold assembly:

a) Put the mold on the rotary plate.

b) Insert the fixing bolt to the hole and turn 90 degrees in order to fix the mold on the rotary plate.

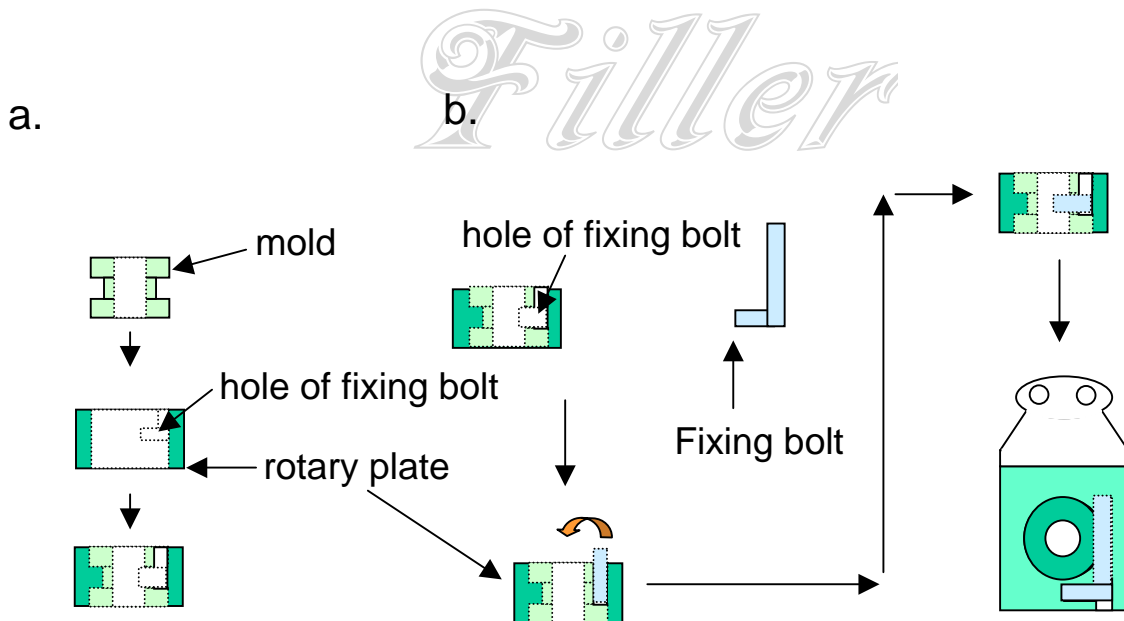

5. Repeat the steps to finish the assembly of 16 molds.

H. Disassembling Procedures

Please note: disassemble only in power-off condition of water pump and pure water pump.

1. Disassembling procedure is the reverse of assembling procedure.
2. Please do it carefully as the motor power is on when disassembling mold.

Filler

I. Operation Procedures

**Remember to always turn “off” the Motor when you’re away from the machine*

1. At first, check up the connections of air compressor, water input, pure water input, and water outlet if connect well with the machine.
2. Turn on the power.
3. Check if all molds are properly assembled.
4. Turn on the power of water pump.
5. Turn on the power of pure water pump.
6. Adjust the motor to the proper speed.
7. Put the bottles upside down into the molds.
8. Washing process is started, take out the bottles after they rotate from inner side of water preventing board.
9. Repeat step 7 & 8 to continue the washing work.
10. The washing procedure is: Put bottles -> water rinse -> pure water rinse -> dry -> outer bottle rinse -> take out bottles.

J. Washing terms instruction

1. Molds: select the molds which fit the bottles.
2. Speed Adjustment: adjusting the motor speed.
3. Air Pressure: the air pressure should be higher than 3Kgcm or the motor will shut off automatically. While the air pressure is back to normal standard (3.5Kgcm), the motor will rerun.

**Please slide the switch of air filtration governor to start the function, and adjust the twist button to control the air pressure, the biggest volume is set on 5Kgcm.*

4. Air/Jet Control: Adjust the button to control the jet volume according to the bottle size.
5. Reset Button: Please press the reset button while the error happens during the operation.

Filler

※ Please contact us for further information in detail.

K. One (1) Year Limited Warranty - Worldwide

Filler Co. warrants their standard products against defects in their operation and non-consumable materials under normal use for a period of ONE (1) YEAR from the date of purchase by the original purchaser ("Warranty Period"). When a non-consumable hardware defect arises within the Warranty Period, a claim written in detail is to be received by Filler Co. within 30 days of the date the defect was discovered. At its option, Filler Co. will either (1) repair the hardware defect at no charge, using new or refurbished replacement parts, or (2) exchange the product with a product that is new or which has been manufactured from new or serviceable used parts and is at least functionally equivalent to the original product. This Limited Warranty does not apply to the damage caused by failure to either (1) follow instruction relating to the product's use, or (2) handle, fill, transmit, wash, clamp, and/or manufacture the materials that are feasible and agreed upon through product testing beforehand and under general industrial acceptance.

Except as provided in this Warranty and to the extent permitted by law, Filler Co. shall not be liable for any direct, special, incidental, or consequential damages of any kind, including, but not limited to any expenses for removal or reinstallation resulting from a defect; loss of use; loss of revenue; loss of actual or anticipated profits (including loss of profits on contracts); loss of the use of money; loss of anticipated savings; loss of business; loss of opportunity; loss of goodwill; loss of reputation; loss of damage to or corruption of material; or any indirect or consequential loss or damage howsoever caused including the replacement of equipment and property, any costs of recovering, programming, or reproducing any material stored, filled, transmitted, handled, washed, clamped or used with Filler Co.'s products.

* Proof of Purchase *

Owner's Name				
Address				
Article				
Purchase Date				
Dealer		Signature		
Model				
TEL				
FAX				
Manufacturer	Filler Co.,LDT.	Signature		
Model				
TEL			886-2-2593-1616	886-2-2591-6873
FAX			886-2-2586-4587	

In practical terms:

- 1) ***We warrant this machine with quality of performing steady operation in normal use (based on existing industrial standard) according to its design, for one year counting from the date of purchase. .***
- 2) ***Parts that are considered consumables are not covered under this warranty.***
- 3) ***Parts & labor will be charged additional if the breakdown of machine is due to following:***
 - ***Unauthorized disassembling of the machine.***
 - ***Unauthorized operation based on instructions NOT included in User's Manual.***
 - ***Inappropriate power supply voltage applied.***
 - ***Damage from rats, insects, poor working condition, and natural disasters.***
 - ***Accident caused by failure in following instructions on assembling, disassembling, and cleaning procedures. (for example, sinking/soaking machine into water)***

(2) Replacement Record Sheet

Initiation Date	Replacement Date	Material / Item	Remarks

Filler