

Quick Start **Guide**

NTC-30 Series - Outdoor WiFi Router



Let's get this show on the road

You must be excited to get started with your Outdoor WiFi Router. If all goes to plan, you'll be up and running in no time.

This guide will help you get started as quickly and easily as possible. It'll help you get connected and show you all kinds of ways to get the most from your Outdoor WiFi Router. You'll be able to get your remote home or office connected wirelessly to the internet in no time.

CONTENTS

Let's make sure you have everything	3
Let's get started	4
Power options	6
Picking the best spot for installation	7
Connecting via Ethernet	8
Configure the router	12
Connecting wirelessly	16
Wall mounting your Outdoor WiFi Router	17
Pole mounting your outdoor WiFi Router	19
Get to know your Outdoor WiFi Router better	21

Let's make sure you have everything

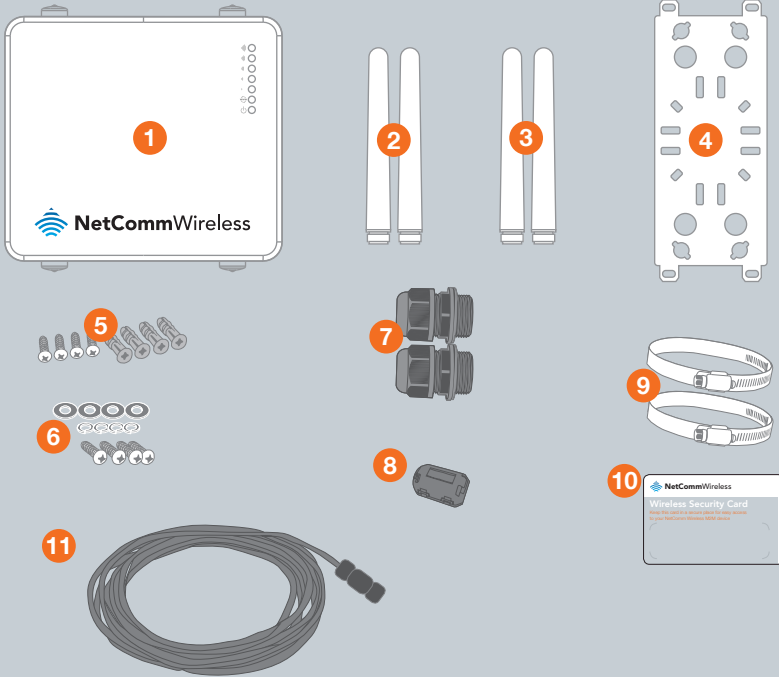

ITEM	INTERFACE	QTY
1	Outdoor WiFi Router	1
2	WiFi Antennas	2
3	3G Antennas	2
4	Mounting Bracket	1
5	Set of wall mounting screws	4
6	Set of mounting screws	4
7	Cable Glands	2
8	Ferrite Core	1
9	Hose clamps for pole mounting	2
10	Wireless Security Card	1
11	Power DC cable 10m (open ended)	1

Let's get started

SIM Card installation

1. Remove the protective cap labelled SIM/Reset with a flathead screwdriver.

NOTE: If you don't have a flathead screwdriver or you're having problems, a small coin will do the trick.

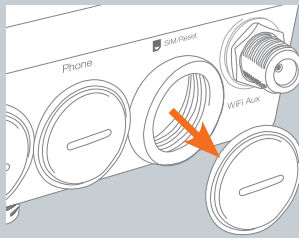

2. Place an activated SIM card into SIM card reader with the metallic part of the SIM card facing up.

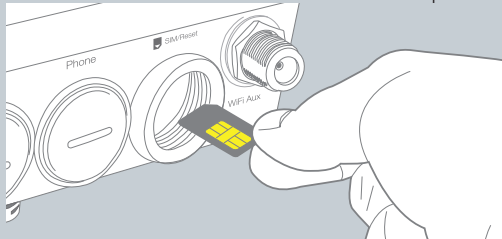

3. Push the SIM card in until the spring latches the SIM card in place. You should hear a click. If you need to remove the SIM card push inward again and the SIM will pop out.
4. Place the protective cap back on securely to ensure it is protected from water and dust (ensure IP-67 rating).

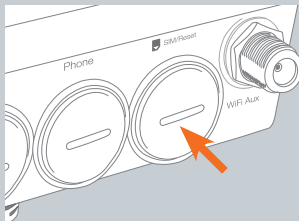

Installing the antenna

1. Remove the black protective caps from the WiFi and 3G connectors.

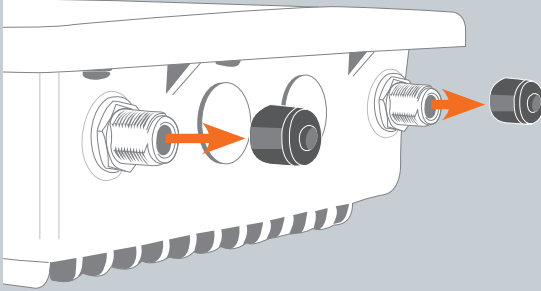

2. Each of the antennas are labelled 3G and WiFi for easy installation. Connect the corresponding antenna to the antenna connectors by holding onto the metal part of the antenna and rotating it clockwise.

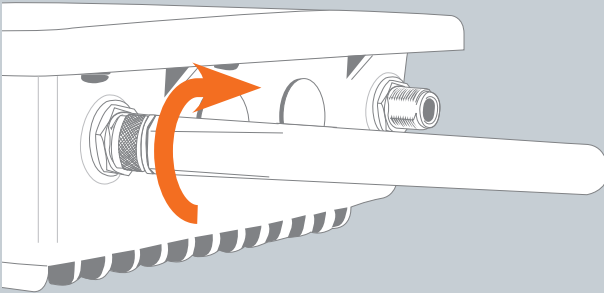

NOTE: There will be a small gap when you tighten the antenna, when you meet sufficient resistance the antenna is connected. Take care not to overtighten the antenna or use the plastic part of the antenna to tighten as this could damage the antenna.

Power options

The outdoor WiFi Router can be powered via DC power supply or Power over Ethernet (PoE).

DC power option

Your router is provided with a waterproof DC jack allowing it to be powered by a 9~28V DC power supply.

1. On the bottom interface panel of the router, locate the DC power port and unscrew the protective cap to expose the connection pins.

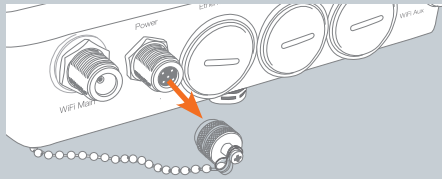

2. Connect the DC power jack as shown below to the DC power port of the router and turn the metal securing ring clockwise while pushing the connector in to secure the DC jack in position.

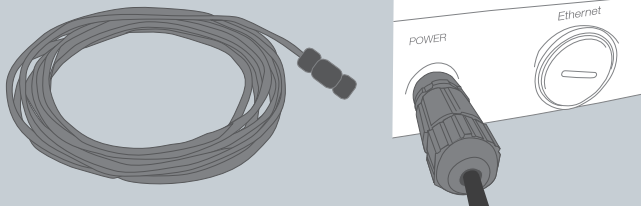

3. At the other end of the cable, wire the red (positive +) and black (grounding) wires to your 9~28V DC power supply source.

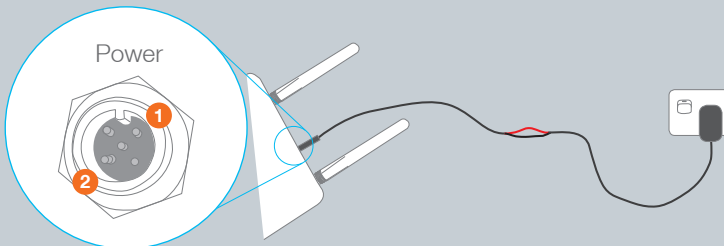

PIN	SIGNAL	DESCRIPTION
1	V+	Voltage+
2	GND	Ground

Picking the best spot for installation

1. At this point your Outdoor WiFi Router is ready to be installed on the outside of your property, however before doing so, you will need to find the best location.
2. To get the strongest signal your Outdoor WiFi Router should ideally be placed towards your nearest 3G tower.

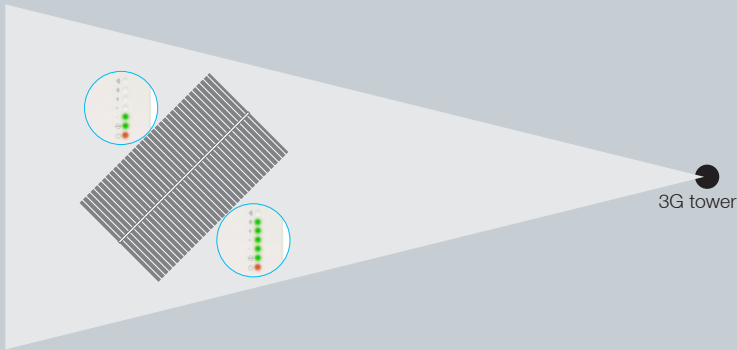

3. If you are unsure where your nearest 3G tower is, you can simply unplug and reconnect your Outdoor WiFi Router at different spots on property to see where you get the strongest signal.



4. Find the area of your property where the most indicators light up, this is where you have the best signal strength and should install your Outdoor WiFi Router.

Installing your Outdoor WiFi Router outside

Your Outdoor WiFi Router can be mounted directly onto a wall or pole. For wall mounting instructions see page 17, for pole mounting instructions see page 19.

Connecting via Ethernet

Before connecting the Ethernet cable (not supplied) you must first connect the Ferrite Core and cable gland.

Connecting the Cable Gland

1. Take a cable gland, unscrew the thread lock sealing nut, and remove the inner seal as shown below.

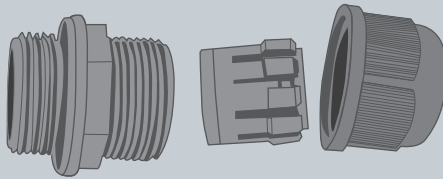

2. Thread the Ethernet cable through the thread lock sealing nut. Open the claw and the seal to place the cable through it and then pass cable through the body of the cable gland. Align the gland segments in the orientation as shown below. Plug the seal through the body and tighten the nut.

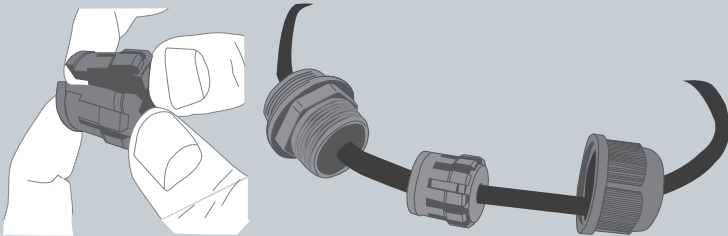

3. Tighten the cable gland to ensure the seal is adequate. Use a shifter or spanner to ensure IP67 rating.

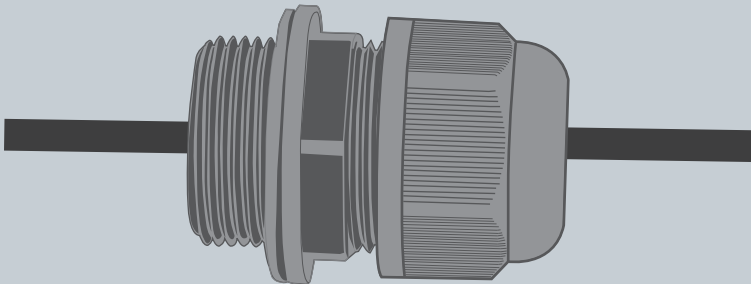

Connecting the Ferrite Core

1. After connecting the Cable Gland you now have to connect the Ferrite Core.

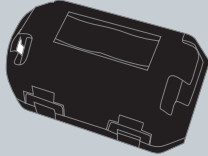

2. Locate the end of the Ethernet cable with the cable gland and make a loop in the cable, approximately 8 cm in diameter.

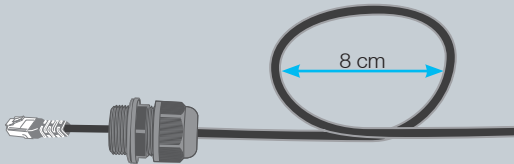

3. Open the Ferrite Core and place the part of the cable that overlaps into the centre.

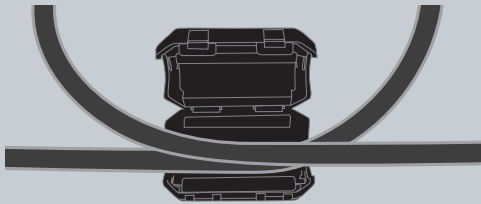

4. Close the Ferrite Core and ensure that the clips click together to hold the Ferrite Core closed.

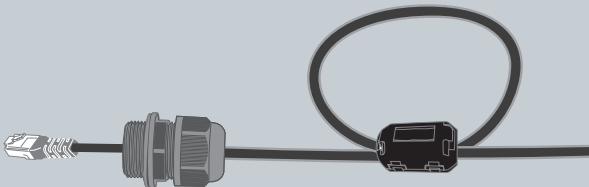

Connecting the Ethernet Cable

1. Remove the protective cap labelled Ethernet with a flathead screwdriver or small coin.

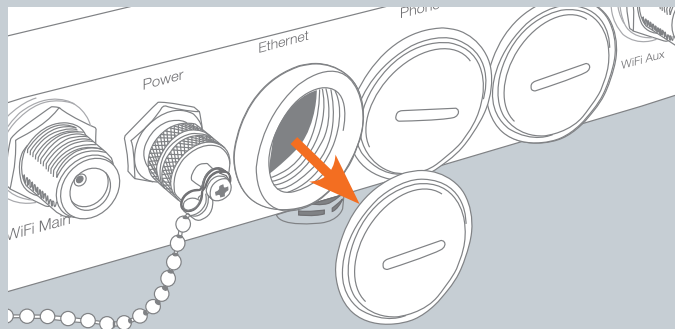

2. Connect the Ethernet cable to the Outdoor WiFi Router Ethernet port. The end with the black cable gland is the end for use with the Outdoor WiFi Router.

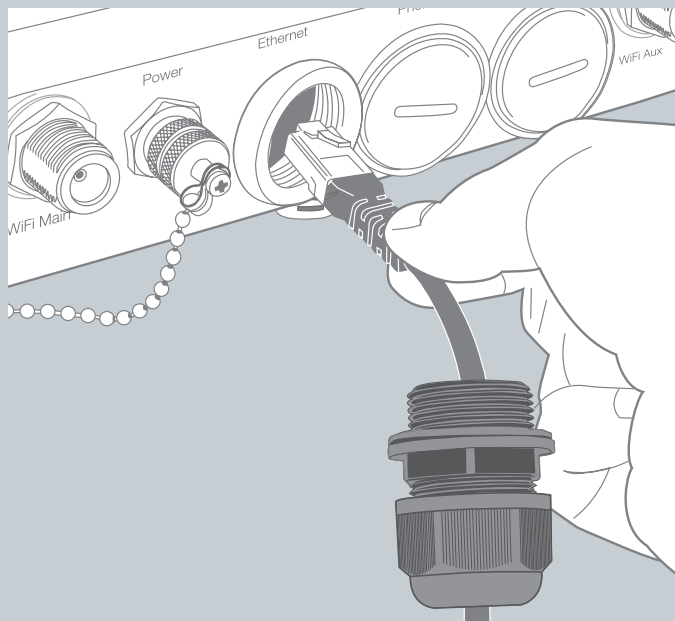

- Slide the cable gland towards the Ethernet port. You may need to loosen the bottom part of the cable gland so you can move it.

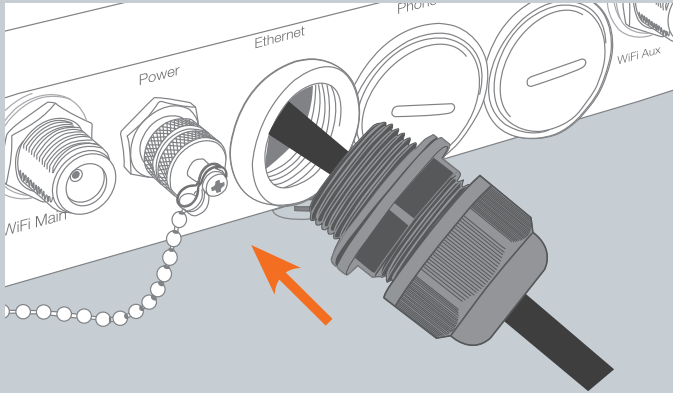

- Tighten the water-proof thread lock sealing nut to ensure the seal is adequate.

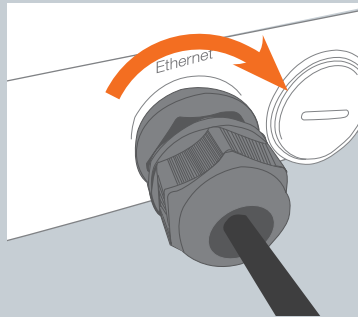

NOTE: If you loosened the bottom part of the cable gland you must retighten to ensure your Outdoor Gateway is waterproof. Use a shifter or spanner to ensure the water-proof Ethernet plug is sufficiently secure.

Connecting the phone cable



The steps for connecting your phone cable are the same as the above steps for your Ethernet cable, please ensure you use a cable gland as directed to ensure your device is waterproof

Configure the Router

Step 1: Access the Outdoor WiFi Router's homepage

Your outdoor router's homepage can be accessed by using the web address via default IP address **http://192.168.1.1** or alternatively via URL **http://my.router**.

This URL opens the management console, where you can

-  View the status of your router.
-  Make changes to the routers configurations.

There are two system management accounts for maintaining the system:

Admin manager account		Root manager account	
Username	admin	Username	root
Password	admin	Password	admin

The admin manager account allows user to manage all settings of the router except functions such as Firmware Upgrade, Device Configuration Backup and Restore, Mobile Broadband Settings and Reset to Factory Default Settings, which are privileged only to the root manager account.

To access the homepage:

- 1.** Open your web browser and enter the IP address **http://192.168.1.1** or **http://my.router**.
- 2.** Click **Login** and type the **username/password** for the Admin manager account or **Root** manager account.
- 3.** Then click on **Submit**.

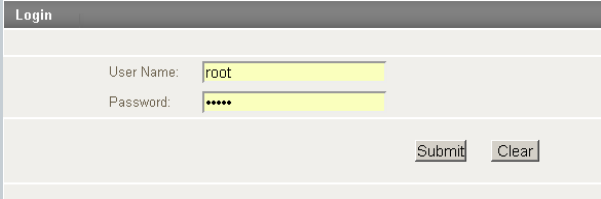

NOTE: First time users should use Root Manager account to configure Mobile Broadband settings.

Step 2: Unlock the SIM

If the SIM card is locked you will need to unlock it with the appropriate PIN code.

You can find out if the SIM is locked by viewing the **SIM Status** at the bottom of the **Status** page.

Connection Status	
Connection Up Time	00:00:00
Provider	Limited Service
IMEI	XXXXXXXXXXXXXXXXXX
Frequency	WCDMA850
Signal Strength (dBm)	-67 dBm (High) 
SIM Status	SIM PIN Locked

If the SIM Status is **SIM PIN Required** or **SIM Locked** then follow the following steps to unlock the SIM card:

1. From the menu, select **Internet Settings** -> **Mobile Broadband** -> **SIM Security**.

This will open up the page displaying SIM Security Settings as shown below:

SIM Security Settings	
SIM Status	SIM locked
Number of Retries Remaining	3
PIN	<input type="text"/>
Confirm PIN	<input type="text"/>
Remember PIN: Disabled	<input type="radio"/> Enable <input checked="" type="radio"/> Disable
PIN Protection: Enabled	
<input type="button" value="Save"/>	

2. Enter the PIN code in the **PIN** field and then enter it again in the **Confirm PIN**.

It is highly recommended that you select **Remember PIN** so that you will not have to enter the PIN code each time the SIM is inserted. Alternatively you can also disable SIM PIN protection by selecting **Disable PIN** from the **PIN Protection** drop down menu.

3. Click **Save**.
4. Wait for a few seconds and verify that the SIM Status reads **SIM OK**.

Step 3: Connect to the Internet

Your router should automatically connect to the Internet if the SIM status reads **SIM OK**. If it does not, follow the steps listed below to setup the Mobile Broadband connection.

By default, the router is set to automatically configure the mobile broadband connection. It tries to detect the correct APN and connection details in order to connect to your mobile broadband service.

If the auto-configuration is unsuccessful, you will need to enter the connection details as follows:

1. From the menu, select **Internet Settings** -> **Mobile Broadband** -> **Connection**.

Mobile Broadband Profile Settings	
Profile Name	<input type="text" value="Profile1"/> <input type="checkbox"/> Automatically configure my mobile broadband
Profile Name	<input type="text" value="Profile1"/>
APN Name	<input type="text"/>
Mobile Broadband Connection	<input checked="" type="radio"/> Enable <input type="radio"/> Disable
Username	<input type="text"/>
Password	<input type="text"/>
Authentication Type	<input checked="" type="radio"/> CHAP <input type="radio"/> PAP
Reconnect Delay	<input type="text" value="30"/> (30-65535) secs
Reconnect Retries	<input type="text" value="0"/> (1-65535, 0=Unlimited)
Metric	<input type="text" value="20"/> (1-65535)
MTU	<input type="text" value="1460"/> (1-1500)
NAT Masquerading	<input checked="" type="radio"/> Enable <input type="radio"/> Disable

2. Unselect the **Automatically configure my mobile broadband** box and click **Save**.
3. Select a **profile name** from the pull down menu to save the profile settings. You can configure and save the mobile broadband settings the router will use to connect to a particular network.
4. Enter the connection details (**APN Name**) provided by your mobile broadband service provider. You may need to enter **Username** and **Password** provided by your mobile broadband service provider.
5. Ensure the Mobile Broadband Connection radio button is on **Enable**.
6. Click **Save**.

Verify Connection Status

Click on the **Status** link to return to the status page.

The **Mobile Broadband Status** should be Up. The IP Address field shows the current IP address that the network has allocated for the router.

Status > Internet Settings > Services > System

All Status | LAN | PPPoE | PPTP | IPsec

// System Information

System Up Time	00:48:11
Router Version	Hardware: 1.4 Software: V1.10.18.0
Router Serial Number	163611130410013
Phone Module	Model: MC8704 Hardware: 1.0 Firmware: T3_0_2_2AP
MAC Address	00:60:64:A3:5D:2C

// Ethernet Port Status

LAN: ✔	Up / 100.0 Mbps / FDX
---	-----------------------

// Mobile Broadband (MBB) [Show data usage](#)

Profile Name	Interface	Status	APN	IP Address
Profile1	wwan0	Up	XXXXXXXXXX	XXX.XXX.XXX.XXX

// Connection Status

Connection Up Time	00:42:15
Provider	XXXXXXXXXX
Coverage	UMTS
IMEI	XXXXXXXXXXXXXXXXXX
Frequency	WCDMA850
Signal Strength (dBm)	-68 dBm (High)
SIM Status	SIM OK

Advanced Status

Connecting Wirelessly



1. Using your wireless device e.g. notebook, tablet or smart phone, scan for your Outdoor Wireless network as displayed on your wireless security card.
2. Enter your password (or Wireless Security Key) displayed on your security card .
3. Wait approximately 30 seconds for the connection to be established.

Restore Factory Defaults

Restoring the device's factory default settings will erase any configuration changes you have made.

1. Disconnect the power source from the router.
2. Press and hold the physical reset button. While holding the reset button down, connect the power source and keep holding the reset button down for 20 seconds and then release it.
3. Once you have reset your router to its default settings you will be able to access the device's web interface using IP address <http://192.168.1.1>.

Alternative method using the device's web interface is described in the user manual.

Wall Mounting Your Outdoor WiFi Router

Locate your mounting bracket, mounting bracket screws, wall mount screws, and grey wall plugs.

1. Before you start make sure all cables have been disconnected from your Outdoor WiFi Router and that your antennas have been attached and your SIM card is inserted.
2. Align the mounting bracket horizontally to the desired position on the wall.
3. Make sure you have at least 60 cm clear space around the centre of the mounting bracket

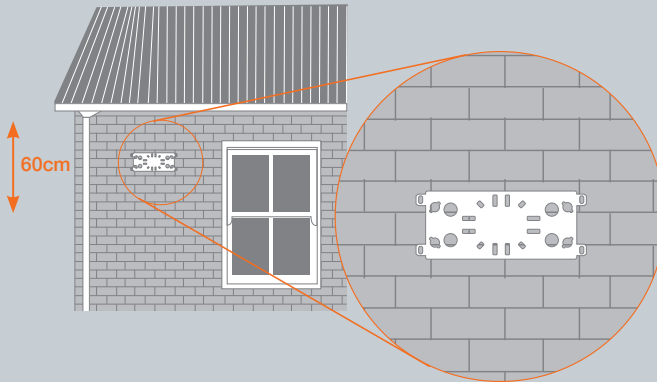

4. Use a pencil or piece of chalk to mark the holes on the wall
5. Remove the mounting bracket from the wall
6. Using your drill and a 6 mm drill bit to drill the holes in the wall where you marked previously.

NOTE: Before drilling into your walls ensure you are not drilling into an area with electrical wiring, a circuit or wire tracer can help you find these. If you are unsure consult a professional installer.

7. Insert the 4 grey wall plugs into the wall.

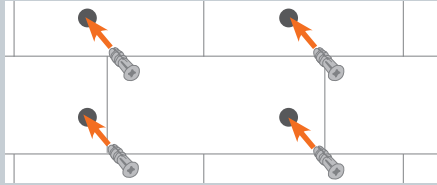

8. Mount the mounting bracket horizontally to the back of the Outdoor WiFi Router with the mounting bracket screws.

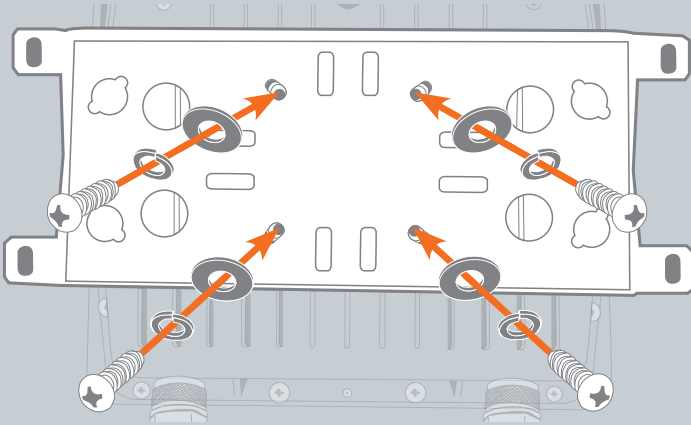

9. Secure the mounting bracket to the wall by inserting the wall mount screws into the grey wall plugs

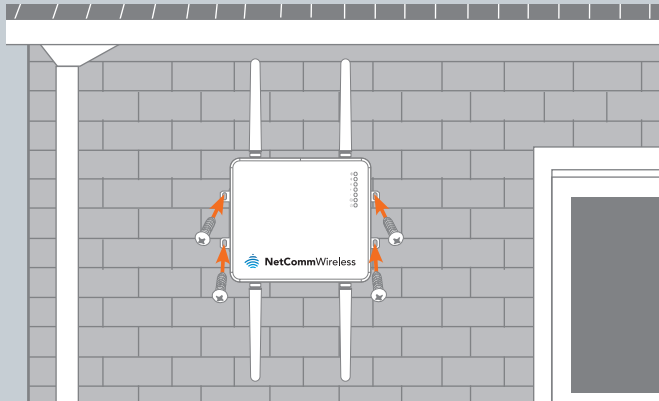

10. You can now reconnect the cables to your Outdoor WiFi Router.

Pole Mounting Your Outdoor WiFi Router

Make sure you have your included mounting bracket, mounting bracket screws and hose clamps.

1. Before you start make sure all cables have been disconnected from your Outdoor WiFi Router and that your antenna have been attached and your SIM card is inserted.
2. Mount the mounting bracket vertically to the back of the Outdoor WiFi Router with the mounting bracket screws.

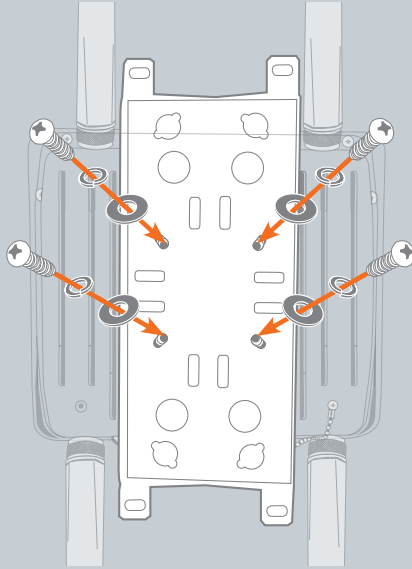

3. Open the hose clamps by turning the locking mechanism counter-clockwise.

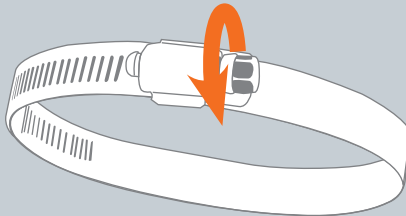

NOTE: You can loosen it by hand or use a flathead screwdriver.

4. Straighten out the end of the metal straps and slide them through the rectangular holes in the mounting bracket.

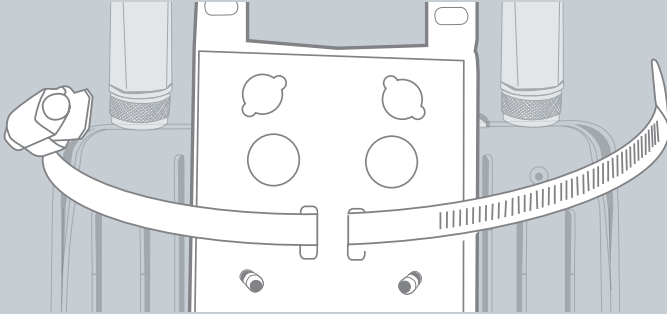

5. Wrap the metal strap around the pole.
6. Use a flathead screwdriver to tighten the locking mechanism by turning it clockwise.

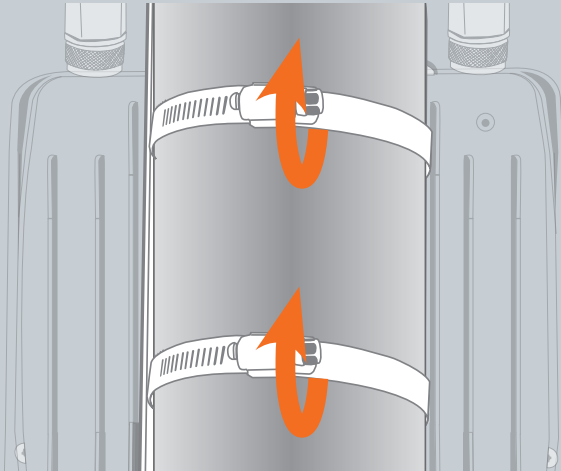

7. You can now reconnect the cables to your Outdoor WiFi Router

Get to know your Outdoor WiFi Router better

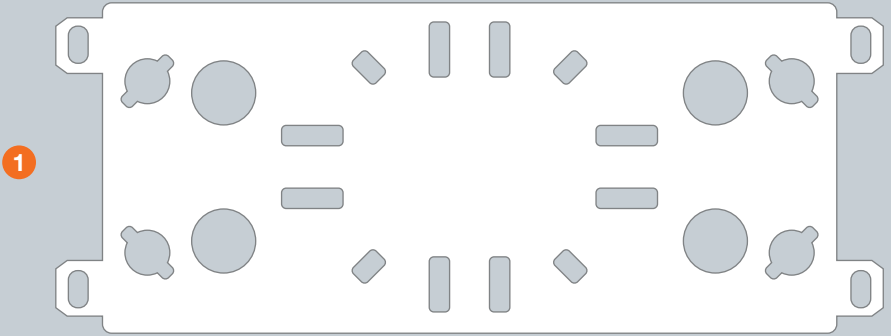

OUTDOOR WIFI ROUTER		
1	Height	240 mm
2	Length	255 mm
3	Depth	80 mm
4	Weight	1750 g (without mounting bracket and antennas)

2

MOUNTING BRACKET		
1	Height	290 mm
2	Length	110 mm
	Depth	12 mm
	Weight	410 g

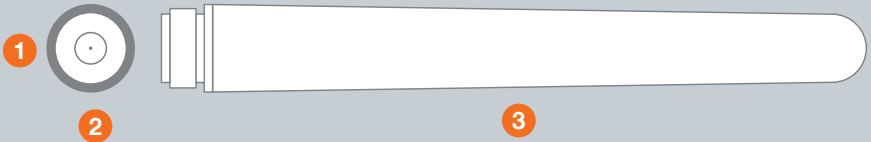

3G AND WiFi		
1	Height	20 mm
2	Length	20 mm
3	Depth	180 mm
	Weight	60 g

What it all means

The Outdoor WiFi Router has 7 LEDs to display the current system and connection status.



LED INDICATOR	ICON	COLOUR	DEFINITION
High Signal		Green	High 3G signal strength available (-47 dBm to -77 dBm).
Medium to High Signal		Green	Medium to High 3G signal strength available (-78 dBm to -85 dBm).
Medium Signal		Green	Medium 3G signal strength available (-86 dBm to -92 dBm).
Low to Medium Signal		Green	Low to Medium 3G signal strength available (-91 dBm to -101 dBm).
Low Signal		Green	Low 3G signal strength available (-102 dBm to -109 dBm).
Internet		Green	The router is currently connected to the Internet.
Power		Orange	The unit is powered on.

The 5 signal LEDs also indicate if the device is MEP locked, SIM is not inserted, and if the SIM is PIN or PUK locked by flashing in certain patterns.

LED PATTERN	
SIM Not Inserted	All signal LEDs flash ON and OFF every 2 seconds
MEP Lock	The signal LEDs flash in a pattern with one, three and 5 LEDs flashing in a sequence.
PIN Lock	The signal LEDs flash in a sequential order starting with the Low signal LED to the High signal LED.
PUK Lock	The signal LEDs flash in a sequential order starting with the High signal LED to the Low signal LED.

Product Warranty

NetComm Wireless products have a standard 12 months warranty from date of purchase.

Technical Support

For firmware updates or if you have any technical difficulties with your product, please refer to the support section of our website.

support.netcommwireless.com



NetCommWireless

NETCOMM WIRELESS LIMITED ABN 85 002 490 486

Head Office, 18-20 Orion Road
Lane Cove, Sydney, NSW 2066, Australia

p: +61 2 8205 3888 f: +61 2 9424 2010

e: m2msales@netcommwireless.com

www.netcommwireless.com