

# USER'S MANUAL

HIR7BLK

UNIVERSAL HEADREST WITH PRE-INSTALLED 7" (178mm) WIDESCREEN  
TFT VIDEO MONITOR

**BOSS**<sup>®</sup>  
AUDIO SYSTEMS

BOSS Audio Systems  
3451 Lunar Court • Oxnard, CA 93030  
[www.bosssaudio.com](http://www.bosssaudio.com) | 800.999.1236  
tech support: [www.bosssaudio.com/support](http://www.bosssaudio.com/support)



0114

# USER'S MANUAL

HIR7BLK

UNIVERSAL HEADREST WITH PRE-INSTALLED  
7" (178mm) WIDESCREEN TFT  
VIDEO MONITOR



**BOSS**<sup>®</sup>  
AUDIO SYSTEMS

## PRODUCT STRUCTURE

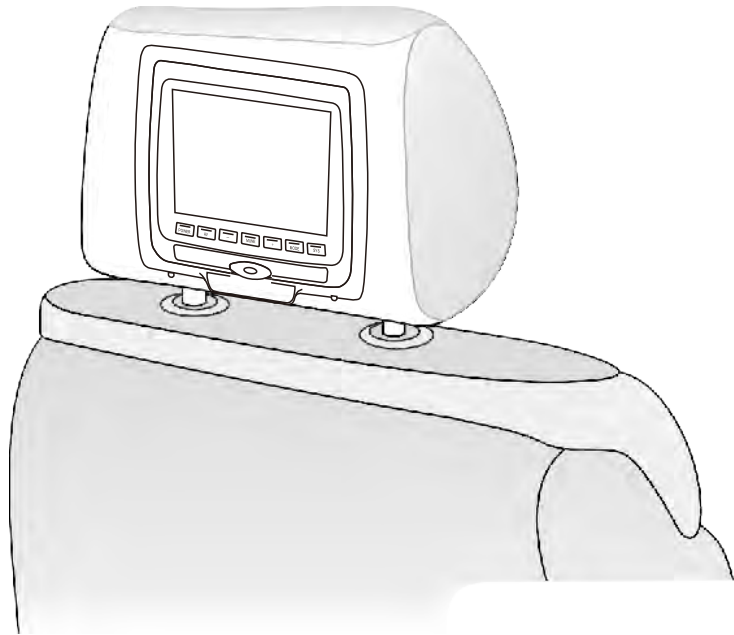

Thank you for purchasing Boss Audio Systems products! To ensure long-term trouble-free service of the product, please read this manual carefully before using the monitor.

Installation of this product must be performed by a professional installer.

We strongly recommend connecting this product and testing it before installing it in the vehicle. Improper installation will void warranty.



### WARNING

- ▶ READ THIS MANUAL BEFORE USING THIS PRODUCT.
- ▶ THIS PRODUCT IS COMPOSED OF PRECISION COMPONENTS AND SHALL NOT BE DISASSEMBLED.
- ▶ BROKEN WARRANTY SEAL WILL VOID THE WARRANTY
- ▶ PROTECT THE PRODUCT FROM MOISTURE AND SHOCK

## Features

- \* Available in black, gray, and beige
- \* Adjustable mounting poles to fit any seat
- \* Poles adjustable from 4 inches apart to 8 inches apart
- \* 7" wide TFT LED Monitor
- \* 1 Set wired AV input
  
- \* Faceplate mini-stereo jack output for wired headphones
- \* Color System: NTSC/PAL selectable
- \* Built in dual channel IR Transmitter
- \* Frequency: 2.3 MHz (Left), 2.8 MHz (Right)
- \* Dual Function remote control: RC-701N
- \* Operating temperature: 32°F to 140°F
- \* Storage temperature: -4°F to 176°F
- \* Environmental Humidity: <90%

## HOW TO USE THE PILLOW MONITOR

### HOW TO USE THE ADAPTER TUBES

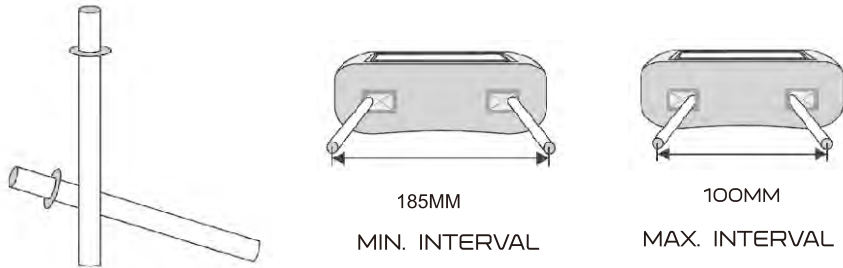

Since the spacing of the mounting holes can vary on different vehicles we supply two adapter poles {12mm diameter}, Use these adapter poles when the headrest mounting holes in your seat are too large for the posts of the headrest monitor.

### REMOTE FUNCTION

1. POWER SWITCH
2. VIDEO SELECT
3. MENU
4. NEXT
5. PREVIOUS
6. MODE SELECT

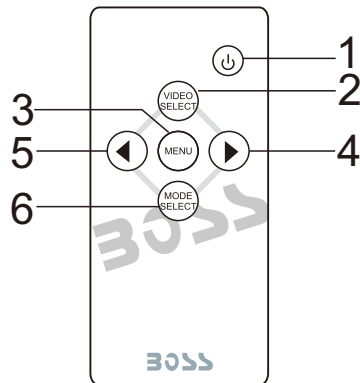

REMARK: MUTE IS NOT AVAILABLE FOR THIS MODEL.  
CONTENTS AND SPECIFICATIONS ARE SUBJECT TO CHANGE WITHOUT PRIOR NOTICE.

To adjust the headrest posts simply pull apart or push together to adjust for the seat. If the larger diameter posts are needed make sure to install them before running any wires.

### Structure

MANUAL KNOB ADJUSTMENT

1. POWER
2. SOURCE
3. -
4. MENU
5. +
6. MODE
7. SYSTEM

### WIRING DIAGRAM

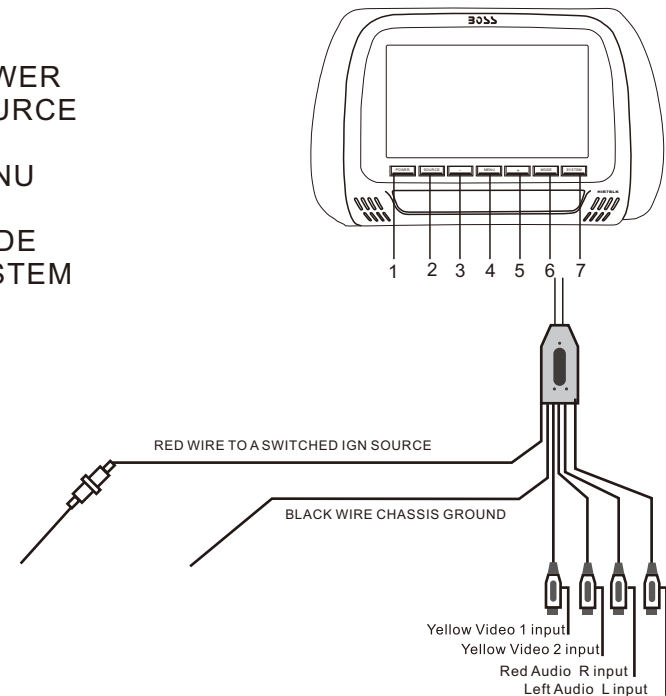

### ACCESSORY

- |                   |      |                   |      |
|-------------------|------|-------------------|------|
| 1. AV INPUT LINE  | 1PCS | 2. ASSEMBLY STICK | 1PCS |
| 3. REMOTE CONTROL | 1PCS | 4. USERS MANUAL   | 1PCS |