



# Nokia Mediamaster Free-to-View

## Owner's Manual



Digital terrestrial Free-to-View is a non-subscription service through an existing TV and aerial.

Total Channel availability is subject to coverage.

\*You may be required to upgrade your television aerial to enable full service reception.

**NOKIA**  
CONNECTING PEOPLE



## Important Information

### Wiring the plug (UK and Eire only)

The mains lead on this product is already fitted with a non-rewireable (moulded) plug incorporating a fuse, the value of which is indicated on the pin face of the plug. Should the fuse need to be replaced, an ASTA or BSI approved BS 1362 fuse must be used of the same rating.

If the fuse cover is detachable always refit the cover after replacing the fuse. NEVER use the plug with the fuse cover omitted.

If the fitted plug is not suitable for your socket outlets it should be cut off, after having first removed the fuse, and an appropriate plug fitted in its place. If this new plug contains a fuse its value should be the same as that removed from the non-rewireable plug.

The severed plug must be destroyed immediately to avoid possible shock hazard.

If you need to replace the mains plug then follow the instruction given below:

The wires in the mains lead are coloured in accordance with the following code: BLUE - Neutral (N); BROWN - Live (L).

As these colours may not correspond with the coloured markings identifying the terminals in your plug, proceed as follows:

The wire coloured BLUE must be connected to the terminal marked with the letter N or coloured BLUE or BLACK.

The wire coloured BROWN must be connected to the terminal marked with the letter L or coloured BROWN or RED.

On no account should either of these wires be connected to the terminal marked E or coloured GREEN or GREEN and YELLOW.

Before replacing the plug cover, make certain that the cord grip is clamped over the sheath of the lead; not simply over the two wires.

If in doubt, consult a qualified electrician.

### Contact information:

**Customer Services - 01793 556 046**

**Warranty - Freephone 0800 0850 836**

**NHC.sales@nokia.com**

**www.nokia.com**

**Note: Contact information for ITV Digital refers to subscription services only**

**\*For details on your local TV aerial installer contact cai: Tel: 020 8902 8998,  
www.cai.org.uk**

Nokia Home Communications operates a policy of continuous development. Therefore we reserve the right to make changes and improvements to any of the products described in this manual without any prior notice.

Nokia is a registered trademark of Nokia Corporation.

Copyright © 2002. Nokia Home Communications.  
All rights reserved.



# MEDIAMASTER 9850 T



## Contents

<b>Welcome to digital terrestrial television</b>	<b>4</b>	<b>Setting the timer and video recording</b>	<b>19</b>
<b>General operation of your ITV Digital Mediamaster</b>	<b>4</b>	General information	19
<b>For your safety</b>	<b>4</b>	Setting the timer	19
<b>Remote</b>	<b>5</b>	Deleting a timer	20
<b>Product overview</b>		Timer alarm	20
Rear panel	6	Setting your video	21
Front panel	6	<b>Using digital teletext</b>	<b>21</b>
<b>Installation</b>	<b>7</b>	Using a digital text TV channel	21
About the SCART sockets	7	Using text services in a digital TV channel	21
Preparing the remote	7	<b>Checking your digital updates</b>	<b>22</b>
Inserting your ITV Digital Smartcard	7	Postbox	22
Connecting the Mediamaster	8	Smartcard data	22
Connecting the Mediamaster to a TV	8	<b>Setting the viewing preferences</b>	<b>23</b>
Connecting to a TV and a video	8	Preferred language	23
Connecting to a satellite receiver and a video	9	Subtitles	23
Connecting to a Hi Fi system	9	TV volume	23
Connecting to the telephone wall socket	9	Info display time	23
Tuning procedure when RF connections are used	10	Timer alarm	23
<b>Getting started</b>	<b>11</b>	Time and date	24
General information	11	<b>Settings for your TV and video</b>	<b>24</b>
Switching on for the first time	11	TV screen	24
<b>Displaying a channel</b>	<b>12</b>	TV sound	25
Beginning your subscription	12	TV standard	25
Selecting channels	12	Video sound	25
Switching between digital and analogue channels	12	Video standard	25
<b>Using the channel list</b>	<b>13</b>	Output channel	25
Renumbering the channels	13	<b>Modem settings</b>	<b>26</b>
<b>The on-screen tv guide</b>	<b>14</b>	<b>ITV Digital technical information</b>	<b>26</b>
<b>Setting up your favourite channels</b>	<b>15</b>	Signal strength	27
<b>Using parental lock</b>	<b>16</b>	Manufacturer data	27
Setting your parental code for the first time	16	Auto update	27
To change your parental code	16	<b>Searching for channels</b>	<b>28</b>
Selecting channels to be locked	17	Adding new channels	28
<b>Watching your locked channels</b>	<b>18</b>	Replacing the whole channel list	28
To unlock individual channels	18	<b>Trouble shooting guide</b>	<b>29</b>
To unlock all channels	18	<b>Front panel display</b>	<b>31</b>
		<b>Technical specifications</b>	<b>32</b>
		<b>Menu screen structure</b>	<b>33</b>

Please be aware that from time to time the Mediamaster may be automatically updated 'over the air' and new software can change the functionality of the Mediamaster.

The EMC Directive 89/336/EEC is applied to this product.

## Welcome to digital terrestrial television



The simplest way to get digital television is here. No dish. No cable. Simply an aerial. It is, without doubt, the most exciting development in television history since the first-ever broadcast in 1936.

In the last 60 years, there have been up to five normal channels on analogue television. Digital terrestrial television changes that.

ITV Digital is the next step in television. Simply plug in your ITV Digital box for a feast of mouth watering television. ITV Digital lets you pick and choose the Primary channels you want to watch.

Subscription channels from ITV Digital, together with free-to-view channels from the BBC\* and ITV, cover everything from sports and movies to news and current affairs, all with improved picture and sound... and widescreen too. No need for dishes. No need for cables. All you need is ITV Digital.

\* BBC services are provided free as part of the licence fee.

## General operation of your ITV Digital Mediamaster

Throughout this manual you will notice that the everyday operation of your ITV Digital Mediamaster is based on a series of user friendly on-screen displays and menus. These displays will help you get the most from your ITV Digital Mediamaster, guiding you through initial installation, channel selection, timer settings and many other functions.

Functions can be carried out using either the buttons on the front of your Mediamaster or on the remote. However we suggest that you will find it easier to use your remote in most instances. If at any time when using the menus you want to return to the normal TV picture, press either the EXIT or MENU button.

Included with your ITV Digital Mediamaster is the ITV Digital 'starter pack'. It contains the leaflet '**How to switch on in one easy go**'. This has simple instructions on how to connect and start up the ITV Digital Mediamaster. Your Smartcard from ITV Digital is also included with this leaflet.

Should you experience any difficulties with the operation of your ITV Digital Mediamaster, please consult the relevant section of this book, including the trouble shooting guide, or if you need more help call: **ITV Digital Customer Services 0808 100 0101**.

## For your safety

- **Allow clear space around the Mediamaster for sufficient ventilation.**
- **Do not cover the Mediamaster or place it on a unit that emits heat.**
- Use a soft cloth and a mild solution of washing-up liquid to clean the casing.
- Never allow liquids, spray or other materials to come into contact with the inside of the Mediamaster.
- Do not connect or modify cables when the Mediamaster is plugged in.
- Do not remove the cover.
- Do not allow the unit to be exposed to hot, cold or humid conditions.
- Nokia is proud to offer a high quality product. To keep this level of quality, service should be carried out only at a Nokia authorised service centre.
- Please note that the only way to isolate the Mediamaster completely from the 230 V mains supply is to unplug the mains lead!

## Remote



Throughout this manual, you will find that all daily functions can be carried out using the remote. This section explains the function of each button.

**⏻** To turn the Mediamaster into / out of standby mode.

**TV DTV** To switch between digital terrestrial TV, analogue TV, digital satellite TV signal and VCR, when your systems are connected by SCART leads.

**🔊** To turn the sound off/on (mute) from your Mediamaster without having to use your TV remote.

**- +** To adjust the volume of digital programmes, without having to use your TV remote.

**0 - 9** To change channel and to select individual menu options.

**INFO** To display the on-screen TV guide, with information about current and next programmes.

**TEXT** To use for digital text information services.

**EXIT** To return from a menu to normal TV picture.

**MENU** To display or exit from the main menu.

**GUIDE** To access future interactive and pay-per-view services.

**P+ P-** To change channels by stepping up and down.

**▼ ▲** To move the highlighted box up and down in menus, or scrolling through channels when using the on screen tv guide.

**◀ ▶** To make changes to settings once you have selected a particular menu option.

**🏠 🏠** At the moment, these have no function.

**SELECT** To confirm choices and selection of a highlighted item. To display the channel list.

**RED** The coloured buttons are used in a number of areas  
**GREEN** including teletext services, when using the menus or  
**YELLOW** the on-screen tv guide.  
**BLUE**

Some functions can be operated with the front panel buttons of the Mediamaster. The buttons are identified in the same way as those on your remote.

For inserting the batteries in the remote, see page 7.



## Rear panel

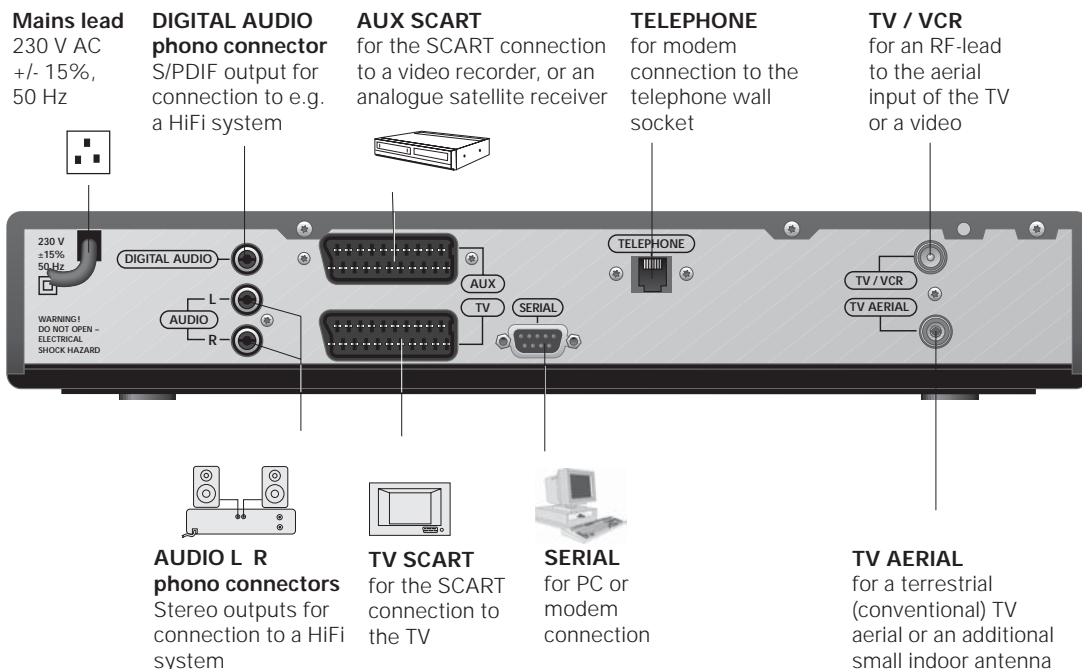

## Front panel

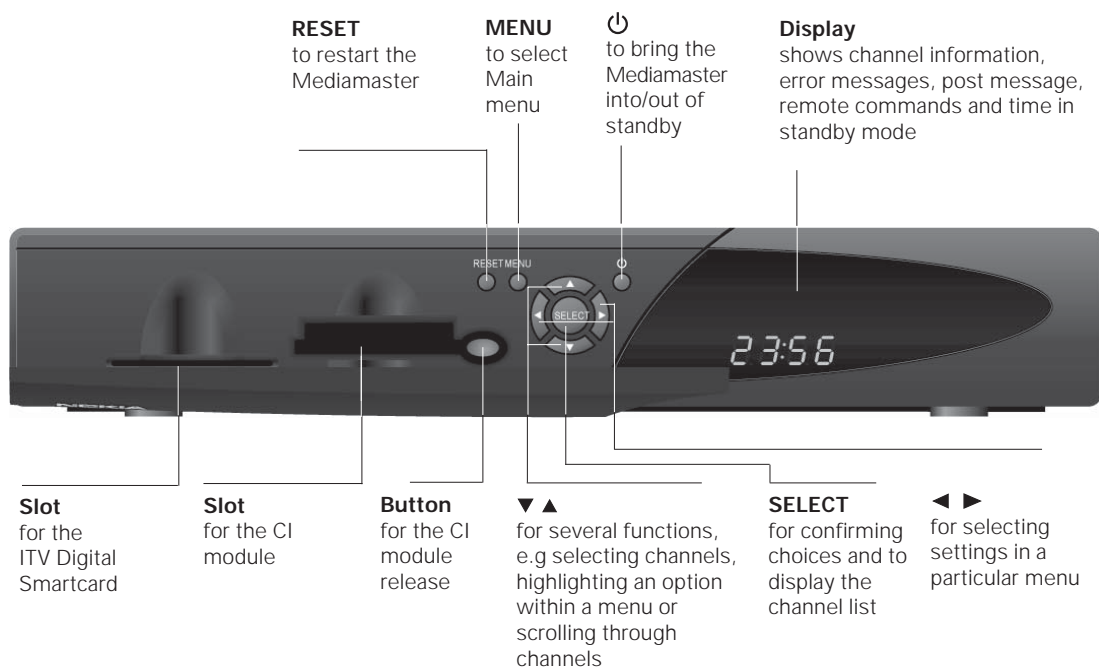

## Installation



The box for your ITV Digital Mediamaster should contain the following items:

- the ITV Digital Mediamaster
- a remote with 2 AAA batteries
- aerial/RF lead (double screened 1,5 metres)
- SCART lead (fully featured 1,0 metre)
- telephone modem cable (10 metres with a T-splitter)
- a user's manual
- ITV Digital starter pack



### About the SCART sockets

- The rear panel of the Mediamaster is equipped with 2 **SCART** sockets (see diagram). **When you connect other products to any of these sockets, always use fully featured SCART leads** (as supplied). There are "less well specified" SCART leads on the market, however picture quality could be reduced.
- SCART leads are also necessary to get stereo sound from a stereo TV and video.



SCART socket

### Preparing the remote

- Remove the cover on the battery compartment at the bottom of the remote.
- Insert the 2 x AAA (1,5 V) batteries, as shown in the diagram, taking care to observe the + and - markings indicated inside.
- Replace the cover.

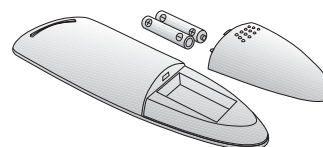

### Inserting your ITV Digital Smartcard

- Insert your smartcard fully into the slot, behind the lid in the front panel of the Mediamaster so that the **gold chip** and the **arrow faces downwards and inwards** (see diagram opposite).

After inserting the card, leave it in the slot permanently. Do not remove it again, unless ITV Digital asks you to do so.



**Note!** The gold chip and the arrow must be on the underside of the Smartcard

## Connecting the Mediamaster



There are many different types of TV/video and other equipment that you can connect to the Mediamaster.

In this manual you will see some of the most common ways to connect your equipment.

If you use RF leads you have to tune your TV and video manually to the Mediamaster (see page 10).

If you have problems with your connections and need help, contact **ITV Digital Customer Services 0808 100 0101**.

### Connecting the Mediamaster to a TV

- Connect the SCART lead (supplied) between the main SCART socket on the TV and the TV SCART socket on the Media master.
- Connect the RF lead (supplied) between the TV/VCR output on the Mediamaster and the TV aerial input on your TV.
- Connect the ordinary TV aerial directly to the TV AERIAL input socket on the Mediamaster (or use an indoor aerial).

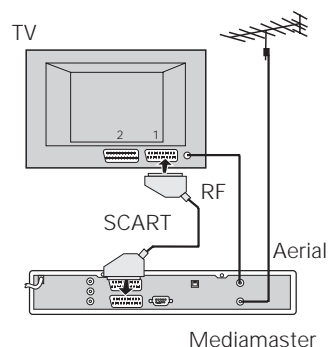

### Connecting to a TV and a video

Refer to your video's manual for full instructions.

- Connect one SCART lead between the main SCART socket on the TV and the TV SCART socket on the Mediamaster.
- Connect another SCART lead between the video and the AUX SCART socket on the Mediamaster.
- Connect an RF lead from the TV/VCR output on the Mediamaster to the TV aerial input on the video.
- Connect an RF lead from the RF output on the video to the TV AERIAL input socket on the TV. (This connection will already be in place. If so, you need not change it).
- Connect the ordinary TV aerial directly to the TV AERIAL input socket on the Mediamaster. (This will previously have been in the back of your video).

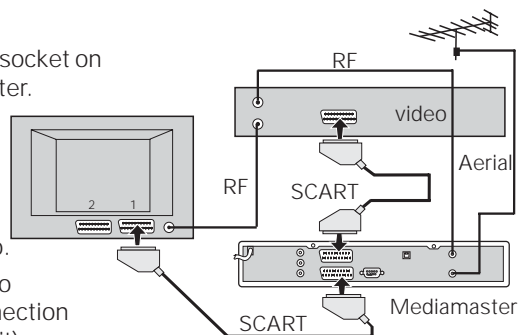

#### If your TV has a SCART socket, but your video does not

- Follow connection details from above, but without the 2nd SCART lead. Your video will then need to be manually tuned to your Mediamaster

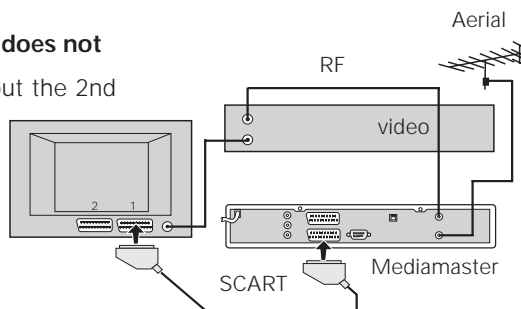

## Connecting to a satellite receiver and a video



- Connect a SCART lead between the main SCART socket on the TV and the TV SCART socket on the Mediamaster.
- Connect a SCART lead between the TV SCART socket on the satellite receiver and the AUX SCART socket on the Mediamaster.
- Connect a SCART lead between the video and the 2nd SCART socket on the TV (if available).
- Connect an RF lead from the RF output on the video to the TV aerial input on the TV.
- Connect an RF lead from the RF output on the satellite receiver to the RF input socket on the video.
- Connect an RF lead from the TV/VCR output on the Mediamaster to the RF input socket on the satellite receiver.
- Connect the ordinary TV aerial to the TV AERIAL input socket on the Mediamaster.
- Connect the coaxial cable between the LNB and the LNB socket on the satellite (analogue/digital) receiver.

*Both the video and the analogue satellite receiver must be tuned with different UHF channels (not occupied between 21 to 69).*

**The analogue satellite receiver must be switched to OFF (standby) when you want to watch digital terrestrial channels from the Mediamaster.**

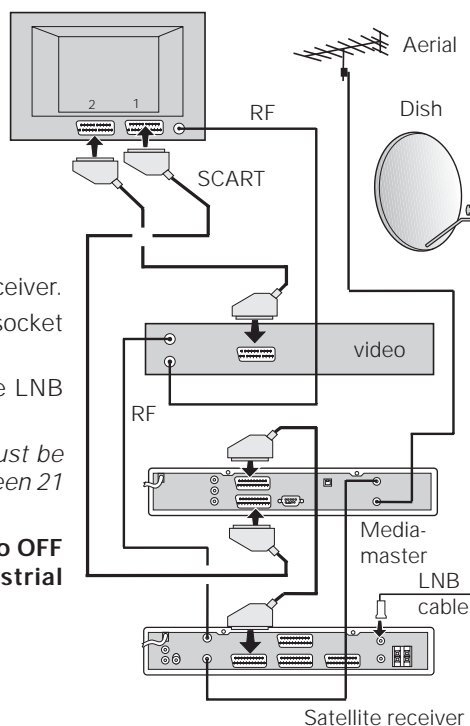

## Connecting to a HiFi system

- Connect an RCA/Cinch stereo cable from the AUDIO L R sockets on the Mediamaster to the LINE, AUX, SPARE or EXTRA input sockets on your HiFi system.
- If available you can connect an RCA/Cinch single cable from the DIGITAL AUDIO socket on the Mediamaster to your HiFi system or Dolby Pro Logic system.

**Note:** To avoid interference you **must** use a screened video cable.

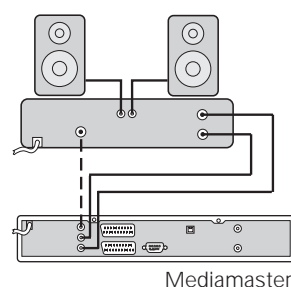

## Connecting to the telephone wall socket

In the future you will be offered interactive and pay-per-view services from ITV Digital. You may then need to connect the Mediamaster to the telephone line.

- To connect the telephone modem cable (supplied) simply plug the cable from the Mediamaster TELEPHONE socket to the telephone socket. Until you need to connect this, please keep the cable in a safe place.

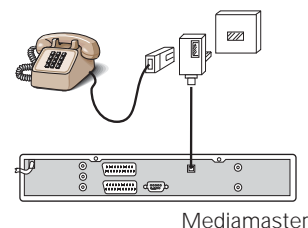

## Tuning procedure when RF connections are used



If you have connected your Mediamaster using SCART leads, you do not have to manually tune your Mediamaster to your TV or video. The steps below explain what to do if you have been unable to use SCART in your connection.

To tune your TV for RF connections you might also need your TV manual as well as this manual.

- Plug in your TV, Mediamaster (and video).
- Switch on the TV.
- Press  to switch the Mediamaster on.

### Tuning your TV to the ITV Digital Mediamaster

- Select a programme number on the TV that is not currently used for a terrestrial TV channel.
- Follow the instructions in your TV user manual to tune the TV channel selector to channel 21 (this is the Mediamaster's factory preset RF channel). If you are already using this channel e.g. for a terrestrial TV channel, select another non occupied UHF channel between 21 to 69 on the TV.

For example, if you then select UHF channel 50 on your TV, you must change your Mediamaster to the same channel. To do this, refer to page 25 and change option 6 within the 'tv and video settings' menu.

- When you have correctly changed the UHF channel number you will see the 'welcome' message on the TV screen
- Follow the instructions in your TV manual to store this as your digital terrestrial channel. You will have to select it when you want to watch digital terrestrial channels.
- Once the welcome message is visible press the **SELECT** button on the Mediamaster remote to start the Installation procedure.
- If the *welcome message* is missing or there is interference on other channels you will have to change the UHF channel number. Press MENU on the front panel or on the remote. You will see the main menu. Select *viewing preferences*, then *tv and video settings* and *UHF channel number*. See page 25.



*If you have a video connected it must be tuned with different UHF channel (between 21 to 69) than the Mediamaster.*

## Getting started



### General information

Once you have connected your Mediamaster to your equipment properly, you are ready to begin searching for new channels.

(One of the easiest methods of connection is explained in the 'How to switch on in one easy go' leaflet also included with your Mediamaster. We recommend that if possible, you use this guide to install your Mediamaster).

Pressing the **SELECT** button will confirm a selection within a menu.

Pressing **EXIT** will remove the menu from the screen or the **RED** 'back' button to move a step back at a time.

Use the **▲** and **▼** buttons to move up and down and **◀** or **▶** buttons to move left or right within a highlighted box. If you need to use the coloured buttons or some other buttons it will be displayed on each menu.

### Switching on for the first time

- Plug in your TV, Mediamaster and video. **Switch on the TV first.** Press **⏻** to switch the Mediamaster on.

The front panel display will flash a few times (- :- - :-). When it stops flashing you are ready to go on.

- Now you will see the 'welcome' message on the screen.

#### If the welcome message does not appear ...

If you don't see the *welcome* message it could be because your Mediamaster has been switched on before. Press **MENU** to display the 'main menu'. If the welcome screen or main menu aren't visible you may need to press the **TV/DTV** button several times if the system is connected by SCART leads. Alternatively, use the appropriate button on your TV remote to select the AV channel (EXT or AV).

- Press **SELECT** on the remote to select the 'main menu'. Press **▼** to highlight 'getting started'. Press **SELECT** to start the channel search.

You may see a menu including options to 'add channels' or 'store channels'. Choose option 4 'store channels' and press **SELECT**.

Your Mediamaster will now automatically search for your new digital channels. This could take several minutes. You will see a bar on the menu telling you how the search is progressing.

As the search ends, you will briefly see a message that indicates the Mediamaster is storing the channels. You will then see a list of the channels that have been found and stored.

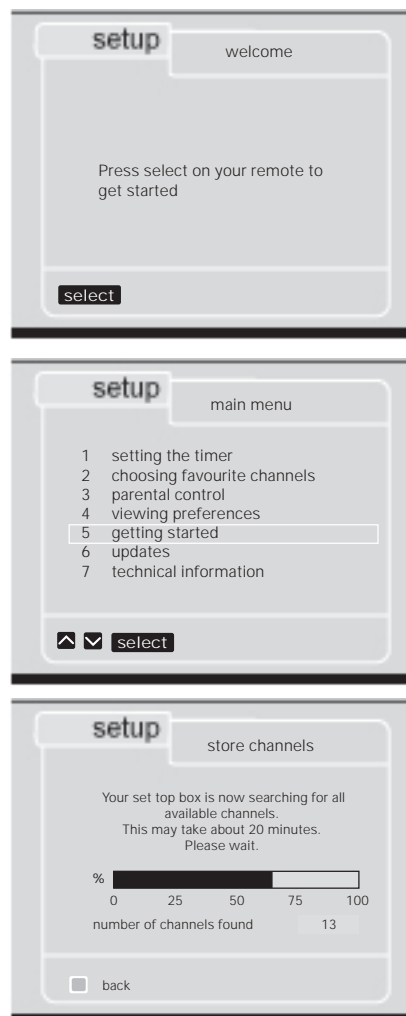

## Displaying a channel



After the Mediamaster has found and stored the channels, it automatically displays the *channel list* menu.

Press **EXIT** or **SELECT** to begin watching a channel. To select another channel, use the number buttons on the remote or the **▲** and **▼** buttons to scroll down the list of available channels.

The Mediamaster always displays the first channel on the menu. This is a free channel. It means you can see it even if you haven't started your subscription yet.



## Beginning your subscription

- If you haven't yet done so, take your Smartcard out of its sleeve in the 'How to switch on in one easy go' leaflet. Note the Smartcard number and put it into the slot behind the flap of your Mediamaster (see page 7).
- Call the ITV Digital activation team on **0870 600 1616**.  
They will ask you for some information to confirm your account and will then activate your Smartcard.

## Selecting channels

When you change channels, a channel-banner appears briefly at the top of the screen. The channel number, name and any favourite or locked channel symbol is displayed. You can adjust the length of time that the banner will display on the menu or take it away (see page 23).

The channel number is also displayed on the front panel.

In either case, the Mediamaster will wait approximately one second before changing channels after the selection has been made.

- To change channels press **P+** or **P-** or the number buttons

**IMPORTANT** – using the number buttons will enable you to select ALL channels, regardless of whether they have been selected as your favourite channels. However, the **P+** or **P-** or **▲** and **▼** buttons will select favourite channels only, if the favourites mode is activated.



## Switching between digital and analogue channels

To switch between watching digital channels via your Mediamaster and standard analogue channels on your TV or your video, use the TV/DTV button. The button will only function if you have connected your digital box using the scart lead supplied.

- Press **TV/DTV** to switch between digital terrestrial TV, analogue TV, digital satellite TV and video, when your systems are connected by SCART leads. (The satellite receiver must be put into standby when you are watching terrestrial digital TV).
- Alternatively press the appropriate button on your TV remote to select the AV channel (EXT or AV).

## Using the channel list



The channel list is an alternative way of viewing what channels are available on your ITV Digital Mediamaster. The list will display ALL channels over the programme you are currently watching and will also indicate which channels have been selected as your favourites or have been locked.

- Press **SELECT** to display the channel list whilst viewing any channel.
- The display will show a total of 6 channels at a time, consecutive to the channel you are currently watching, along with symbols that identify whether channels are your favourites or are locked. The channel you are currently viewing will be highlighted on this list.
- Press **▲** or **▼** to move through the channel list. When you reach the bottom of one menu, continue to press the **▼** to scroll to the next screen. Alternatively, pressing the **◀** or **▶** button will scroll a full page at a time.
- Press **SELECT** to view the channel you want to watch or press **EXIT** to remove the channel list from your screen without changing channels.



## Renumbering the channels

This feature enables you to choose the order in which your channels are stored following initial installation.

You are only able to swap channels around, two at a time, preventing you from being able to delete a channel by accident.

- Press **MENU** to select the *main menu*.
- Select *getting started* by pressing **5** (or highlighting it and press **SELECT**.)
- Within the *getting started* menu select *change channel numbers* by pressing **2** (or highlighting it and press **SELECT**).
- The screen will display a complete list of channels currently available. This screen will also indicate whether they have been selected as your favourite or locked channels.
- To move a channel to an alternative location, firstly highlight the channel using the **▲** or **▼** and press **SELECT** to choose that channel as indicated at the bottom of the screen.
- Now select the new channel location using the **▲** or **▼** buttons to highlight the channel number where you want to move the channel to.
- Press **SELECT** again to swap the channels you have highlighted.
- Repeat these steps to move further channels.
- Press **EXIT** to return to a normal TV picture.



To reveal further sections of the list

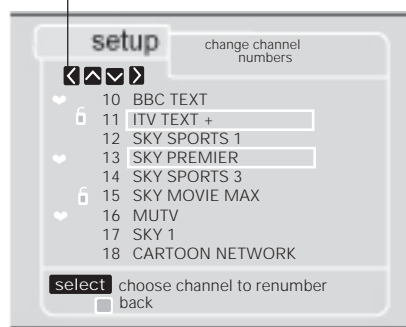

## The on-screen tv guide



When you are watching a digital channel you can display an on-screen tv guide to see information about current and next programmes.

- Press **INFO** to activate the on-screen tv guide.
- The banner at the top of the screen will always display the current channel number and name, the name of the current programme and the time.

- The banner at the bottom of the screen will initially show the same information and additionally, the name and start time of the current and next programme.

It also indicates whether it is broadcast in mono or stereo and also the type of programme (such as film, drama or comedy).

- Press **▲ ▼** or the number buttons to see programme information for other channels at the bottom of the screen without changing the channel you are currently watching.

**Note:** If the favourite channels function is active, pressing the **▲** or **▼** buttons when using the on-screen tv guide will display only your favourite channels and the current channel.

Alongside the programme names, you can view additional information about both the current and the next programme.

- Press the **BLUE** button to see information about the current programme.
- Press the **YELLOW** button to see information about the next programme.
- Press **▲** or **▼** if not all of the further information is displayed.
- Press the coloured buttons again to remove the information.
- Press **SELECT** to change to that channel, when the programme you want to watch is displayed at the bottom of the screen.
- Press **INFO** again or **EXIT** to return to normal TV viewing without changing a channel.

**Note:** The channel cannot be changed however if you are viewing information for the **NEXT** programme.

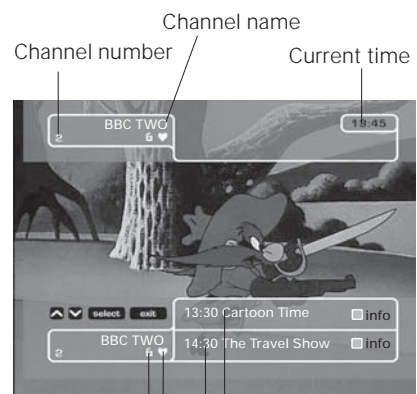

Symbols:  
a locked or  
unlocked  
channel  
a favourite  
channel

Current programme  
and its start time  
Next programme  
and its start time

Programme  
type, its sound  
and if subtitles  
are available

Start and end  
times for the  
programme



To remove the  
further informa-  
tion

Detailed description  
of the programme

## Setting up your favourite channels



This function enables you to select channels as your 'favourite channels' which are then easier and faster to access.

When using the **P+** and **P-** buttons to change channels, and the favourite mode is on, only your favourite channels will be available for selection. Similarly, with the favourites mode on and when using the on-screen tv guide, the **▲** or **▼** buttons will only select your favourites.

You can view a list of your chosen favourite channels by selecting the channel list, or the favourite channels screen.

- Press **MENU** to select the *main menu*.
- Select *choosing favourite channels* by pressing **2** (or highlighting it and press **SELECT**.)
- Press **▲** or **▼** to highlight the favourite channel, then press **SELECT**. A heart symbol will appear alongside the channel name to indicate it has been selected.
- Repeat these steps until you have marked all the other channels you wish to add to the favourite list.
- To remove a favourite channel from your list press **▲** or **▼** to highlight the channel you want to remove then press **SELECT**. The heart symbol will disappear.
- Press the **GREEN** button to activate the favourite mode. The favourite mode status is displayed on the top right of the menu as 'favourites are on' or 'favourites are off'.
- Press the **RED** button to return to the previous screen, or press **EXIT** to return to normal TV viewing.

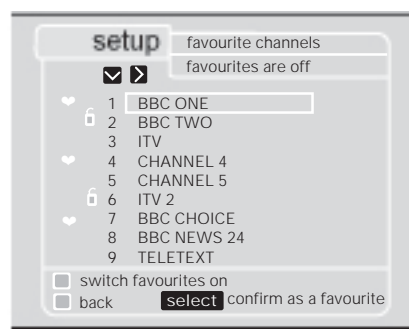

## Using parental lock



This feature will enable you to limit access to any particular channel.

When this option is selected for the first time, you will be asked to enter your code before certain other functions can be performed.

Only people who know the code can then unlock a channel.

### Setting your parental code for the first time

- Press **MENU** to select the *main menu*.
- Select *parental lock* by pressing **3** (or highlighting it and press **SELECT**.)
- Select *enter new parental code* by pressing **1** (or highlighting it and press **SELECT**.) The menu to the right will now be displayed.
- Select a 4-digit code (not 0000), using the number buttons.

As you enter the code, it will be displayed on the screen. If you enter an incorrect number, use the ◀ button to move back one space and make an amendment.

- Please keep a note of your parental code in a safe place for future reference.
- Press **SELECT** to confirm and store the code.

If for any reason the code is not accepted, the entry will be cleared and you will be prompted to enter another code.

- Press the **RED** button to return to the previous *parental lock* menu or press **EXIT** to return to normal TV viewing.

If you forget your parental code, contact ITV Digital Customer Services.

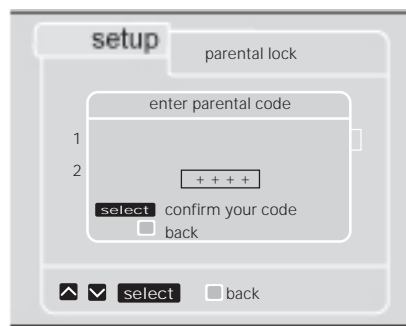
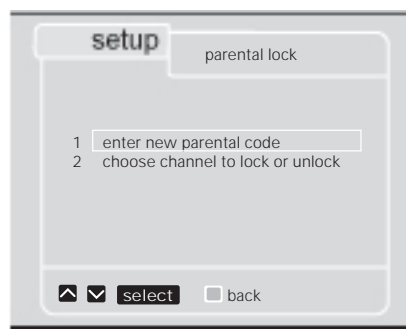

### To change your parental code

Once a code has been entered, you can change the parental code at any time. In order to do this, you will need to enter the current code before a new code can be entered.

- Press **MENU** to select the *main menu*.
- Select *parental lock* by pressing **3** (or highlighting it and press **SELECT**.)
- Select *change parental code* by pressing **1** (or highlighting it and press **SELECT**.)
- Enter your current code and then press **SELECT**. Asterisks will be displayed as the code is entered. If necessary, use the ◀ button to correct any mistakes.

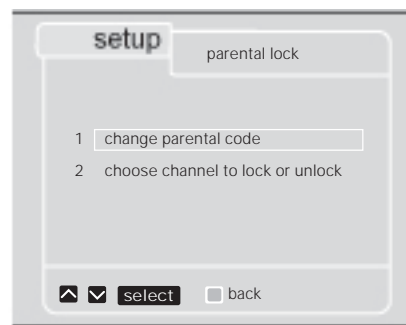



If this code is correct, you will be asked to enter a new code.

- Enter your new 4-digit code (not 0000) and then press **SELECT** to confirm.

An on-screen message asks you to remember your new code.

If you entered a wrong code at any stage, an on-screen display will inform you what to do.

- Press the **RED** button to return to the previous *parental lock* menu or press **EXIT** to return to normal TV viewing.

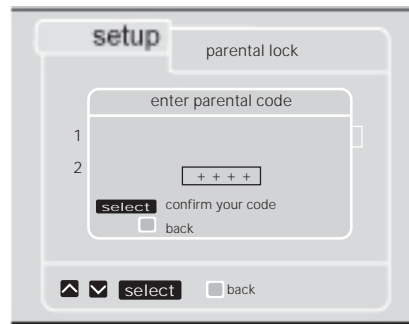

## Selecting channels to be locked

- Press **MENU** to select the *main menu*.
- Select *parental lock* by pressing **3** (or highlighting it and press **SELECT**.)
- Enter your parental code and then press **SELECT**.
- Select *choose channels to lock or unlock* by pressing **2** (or highlighting it and press **SELECT**.) The screen to the right will now be displayed.
- Press **▲** or **▼** to highlight the channel you want to lock. Press **SELECT**. A padlock symbol will appear alongside the selected channel to confirm your choice.
- Repeat this step until you have identified all the channels you want to lock.
- Press the **GREEN** button to lock (closed padlock) or to unlock (opened padlock) channels. 'locks are closed' or 'locks are open' will appear at the top of the screen.
- Press the **RED** button to return to the previous *parental lock* menu or press **EXIT** to return to normal TV viewing.
- If you wish to unlock a channel permanently, repeat the above steps, highlighting the channel that you want to lock and press **SELECT**. The padlock symbol will disappear.

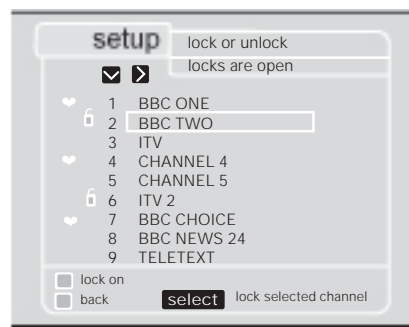

**Note:** You should briefly put your Mediamaster into standby to ensure that locked channels are stored in the memory.

## Watching your locked channels



Once you have locked all the required channels, there are 2 ways to regain access and watch these channels. You can either unlock individual channels as you select them, or return to the 'choose channels to lock or unlock' menu and temporarily unlock them all.

### To unlock individual channels

- When you select a channel that has been locked you will not be able to see or hear the locked channel until your code has been entered. Press **SELECT** to display the screen opposite.
- Then enter your parental code. Asterisks will be displayed in the 4 digit field.
- Press **SELECT** to confirm the code.
- If necessary, press ◀ to move back and make an amendment if you enter wrong code.  
The locked channel will appear on the TV screen.
- If you enter an incorrect number, a message will inform you. Press **SELECT** and try again.

**Note:** If after unlocking a channel this way, you change to another channel, you will have to repeat the above steps to view the locked channel again.



### To unlock all channels

If you temporarily want to unlock all your locked channels, the easiest way to do this is from the 'lock or unlock' menu.

- Press **MENU**, then select option **3**, *parental lock* and option **2**, *choose channels to lock or unlock*.
- Enter your parental code when prompted.
- Press the **GREEN** button to unlock (opened padlocks). 'locks are open' appear below the menu title.

You will now have access to all your locked channels without having to enter your parental code for each channel.

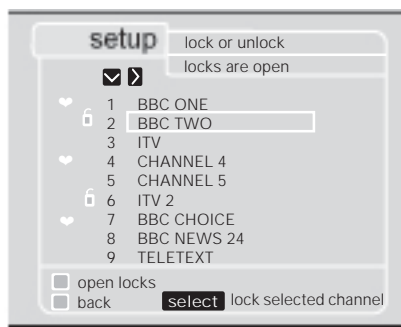

**Note:** Don't forget to lock your channels again after unlocking them all in this manner (use the same procedure as described above).

## Setting the timer and video recording



### General information

The 'timer settings' function enables you to program your Mediamaster to switch on and off at selected times, for up to 8 different time slots. Your video can then be set to record digital programmes.

- Pressing the **RED** button will return you to the previous part of the procedure, or
- Pressing **EXIT** will discard any changes that have been made and return your Mediamaster to normal operation.
- **Please note that it is NOT possible to record from one digital channel and watch an alternative digital channel at the same time.**
- If you wish to watch TV while you record a digital terrestrial channel, you can watch the channel you are recording or an analogue channel or vice versa.
- Make sure that the time and date are correctly set (see page 24).
- If you enter a setting that overlaps another setting, a screen will be displayed to warn you of the conflict.
- If you set more than one timer, the list of timers will rearrange automatically and the earliest 'timer' becomes 1.
- You can set the timer (without setting your video) to remind you when 'favourite' programme will start.

### Setting the timer

- Press **MENU** to select the *main menu*.
- Select *setting the timer* by pressing **1** (or highlighting it and press **SELECT**.)
- The screen will now show a list of 8 timer slots, each one indicating that it is either available for programming, or that it has a programme already stored in it.
- Select a free row by pressing the appropriate number or highlighting it and press **SELECT**. The screen opposite is displayed.
- Use the number buttons to key in the settings for the different items (the date, channel number, start and end times).
- Press **▼** button to confirm the entry and move to each item.
- You must use four digits for the date. Only the day and month should be entered, the receiver will automatically know the year, e.g. for the 8<sup>th</sup> February 1999, enter 0802.
- If you do not know the channel number press the **GREEN** button to display the channel list on the screen. Press **▲** or **▼** to highlight the channel you require and press **SELECT**. The channel number will then be added to the *set the timer* menu.
- You must use the 24-hour clock for the time (e.g. 8.25 pm, enter 2025).
- If you enter something incorrectly, a message will be displayed. Use **◀** to make a correction.

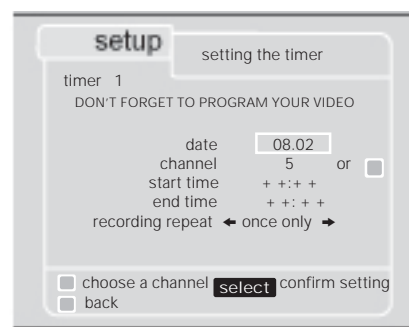

- When you highlight 'recording repeat' use ◀ or ▶ to select how frequently you want the recording to be made. The screen display will give you options of 'once only', 'daily' or 'weekly'. Select the option you want. The last two alternatives are useful when recording a series of programmes.
- Press **SELECT** to save the settings when all the details have been set. If the channel is locked, enter your parental code and confirm with **SELECT**. The programme details will then be displayed on the *setting the timer* menu.
- Repeat these steps for other timer settings.
- Press **EXIT** to return to TV viewing.
- Press  to set the receiver in standby to activate the timer settings.

**Note:** Five minutes before the start time the Mediamaster will switch onto the preprogrammed channel. "rEC" is shown on the front panel display. The timer will switch back into standby five minutes after the end time.

## Deleting a timer

- Press **MENU** and select **1** for the *setting the timer* menu.
- Press ▲ or ▼ to highlight the timer event you want to delete.
- Press the **BLUE** button. Followed by number button **1** to delete the timer.

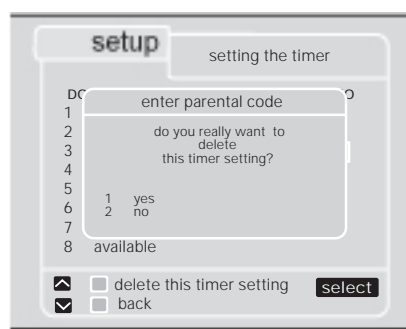

## Timer alarm

- If you have finished watching programmes on your Mediamaster, you should leave it in standby mode in order for the timer settings to be activated.
- If however you wish to continue watching other digital channels after setting a timer, you can do so by changing channels in the normal way.
- If you are watching another digital channel when the timer is due to start, the timer alarm will sound a short 'beep' and "rEd" will be shown on the front panel display.
- Press the **Red** button. The screen opposite is displayed. You now have two choices:
  - Press **SELECT** if you want to change to the channel set in the timer. Your video will then record the correct channel.
  - Press the **Red** button if you want to stay on the channel you are watching. In this case the video will record the channel you are watching and not the channel you set in the timer.



## Setting your video



These steps above will now activate your Mediamaster. But if you want to record, you must also set up your video at the appropriate times.

As previously mentioned it is not possible to record one digital channel whilst watching another.

You can however record a digital channel via your Mediamaster and watch an analogue channel on your TV, or vice versa.

## Using digital teletext

In addition to normal teletext services available on analogue terrestrial channels, your Mediamaster has access to dedicated digital teletext channels. The digital services include high quality text and graphics as well as advanced navigational options. You can use the digital text information services even if you don't have a Teletext TV.

### Using a digital text TV channel

- Select the digital text channel. Check the channel list or the TV guide for the channel number.
- Individual teletext pages can be selected by using the number, ▲ ▼ or coloured buttons and the **SELECT** button.
- When you have finished viewing the digital text channel, select an alternative channel in the normal manner.

### Using text services in a digital TV channel

Teletext services may also be available on other digital channels. The operation and appearance of these services is similar to what you may be used to on your TV.

Sometimes the text services can be indicated by a symbol or other functions on the screen, superimposed on the channel you are watching.

- Press **TEXT** to display text services.
- Use the number buttons on your remote to select the different pages. Use the colour buttons for the functions shown on the screen.
- Press **TEXT** again to return to a normal TV viewing.

## Checking your digital updates



Your Mediamaster has the ability to display messages that have been sent to you by a broadcaster, perhaps about a special offer or your current subscription package.

You will be advised when a message is waiting to be read by the code '**POSE**' appearing in the display on the front of your Mediamaster.

### Postbox

- Press **MENU** to select the *main menu*.
- Select *ITV Digital updates* by pressing **6**.
- Select *check your postbox* by pressing **2**.
- Your current messages will then be displayed. The most recent message appears at the top of the screen, with previous messages following.
- Press **▲ ▼** if you wish to check other messages. Each time you re-enter the postbox, the latest message will always appear first.

**NOTE:** Messages cannot be manually deleted, but the oldest messages are automatically removed as new messages are received.

- Press the **RED** button to return to the previous menu or press **EXIT** to return to normal TV viewing.

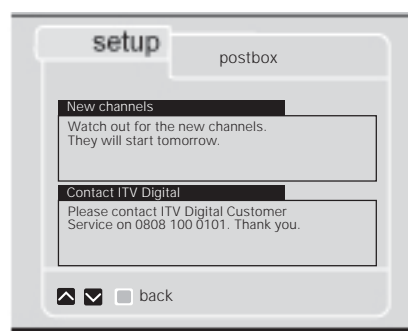

### Smartcard data

In this menu you can check information about your smartcard.

- Press **MENU** to select the *main menu*.
- Select *ITV Digital updates* by pressing **6**.
- Select *smartcard data* by pressing **1**.
- Press the **RED** button to return to the previous menu or press **EXIT** to return to normal TV viewing.

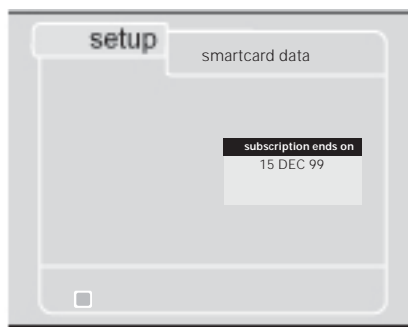

## Setting the viewing preferences



The Mediamaster has three menus to set your viewing preferences. Each have been factory-set for the most commonly used settings.

- Press **MENU** to select the *main menu*.
- Select *viewing preferences* by pressing **4**.
- Select *ITV Digital box settings* by pressing **1**.
- Press **▲** or **▼** to select the required setting numbered 1 to 6.
- Press **◀** or **▶** to make the required adjustment.
- Press the **RED** button to return to the previous menu or press **EXIT** to return to normal TV viewing.

### Preferred language

When your Mediamaster is first switched on, the default setting will be English. Other options are Welsh and Gaelic. If the language selected is not available, the box will use English as a default.

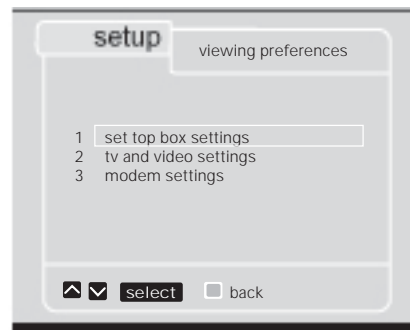

### Subtitles

Similarly, this option will allow you to choose the language that subtitles are displayed in. Options are English, Welsh, Gaelic and none. If any of the languages are selected, subtitles will always be displayed when they are available.

Options also include the same language but for the hard of hearing, these are identified by a symbol after the language and include description of activity within the programme, such as laughter or applause.

If the 'none' option is selected, subtitles will not be displayed, even if they are available.

You will know if subtitles are available for a programme either by checking the on-screen tv guide, or if you are made aware of this by a broadcaster.

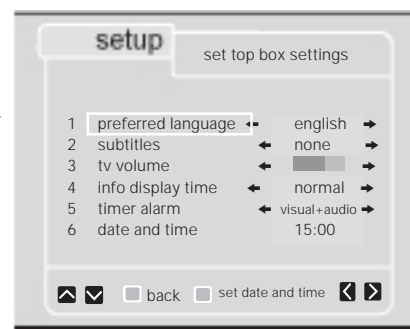

### TV volume

This option sets the maximum sound output level from your Mediamaster to your TV. This is factory set to a medium level, but you may notice that when switching between channels on your digital box and channels on your normal TV, that the volume differs. Use the **◀** or **▶** to adjust the level required.

### Info display time

With this option you can set the length of time that on-screen information is displayed. This only applies to screens that you do not make adjustments to such as channel change. The options available are off, normal or long.

**Note:** If this option is set to off, certain menus, including the channel list, will no longer appear on-screen at all.

### Timer alarm

This option enables you to select either 'visual' or 'visual+audio' for the timer alarm. The alarm is factory set to visual+audio, and as such will give a warning when a programme is about to start for which the timer has been set.

Your box will display the code '**rEd**' on the display and will 'beep'. More information about the timer function is included on pages 19 and 20 in this booklet.

### Time and date

Your Mediamaster will automatically set the current time and date by taking information from broadcasters. However, should you wish to adjust these settings, you can do so manually using this menu.

Use the numeric buttons to enter the correct details.

- You must use six digits for the date. e.g. for the 8<sup>th</sup> February 1999, enter 080299.
- You must use the 24-hour clock for the time (e.g. 8.25 pm, enter 2025).
- Press ◀ or ▶ to set 'summer' or 'winter' time.
- Press **SELECT** to confirm the settings.

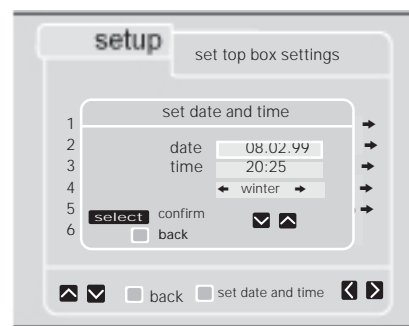

## Settings for your TV and video

The settings that appear when you install your Mediamaster have been set by the factory, and in most cases need not be changed. With the viewing preferences menu on the screen:

- Select *tv and video settings* by pressing **2**.

### TV screen

This option enables you to tell your Mediamaster whether you have a 4:3 (normal) or 16:9 (widescreen) TV.

- If you select 16:9 in this option, the box will automatically display any widescreen programmes in the correct format.
- If you choose 4:3, a further option will be highlighted below that enables you to select how you would like a widescreen programme to be shown on your standard 4:3 TV.

**Note:** Normal (4:3) is only available if it is selected in item 1 of this menu

If you have a 4:3 TV, you need to choose whether widescreen programmes are shown in a 'letterbox' format ie. with black bars at the top and bottom of the TV screen, or whether the programme is 'expanded' to fill the height of the screen, but as a result parts of the picture at the side are lost. You should choose options 'letterbox' and 'full screen' respectively.



'letterbox format'

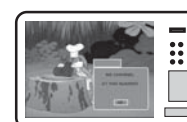

'full screen format'

### TV sound

This gives you the option of selecting either 'mono' or 'stereo' sound. As a default, stereo has been selected. You need only change this selection if you are connecting to a mono TV.

### TV standard

If you have connected your Mediamaster and your TV by a scart lead, you should try adjusting this option to ensure the best possible picture. The default is to a setting called 'composite', however you may see a picture improvement if you select the alternative '**rgb**' option and have a RGB TV.

Change the option as previously described. If you do not notice any difference in the picture quality, please ensure the setting remains on 'composite' and exit the menu.

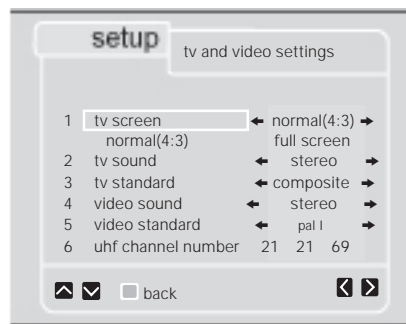

### Video sound

This gives you the option of selecting either 'mono' or 'stereo' sound for your video. As a default, stereo has been selected. You need only change this selection if you are connecting to a mono video. Please note that in order to record and playback in stereo, you need to use a scart lead between your Mediamaster and TV.

### Video standard

If you are connecting your Mediamaster to a video, this option enables you to select either pal I or S-VHS, depending on the type of video you have. As a default, it will have been set to 'pal I'.

(Please refer to your video's instruction book if you have a query about what standard it is.)

### uhf channel number

This relates to the output frequency from your Mediamaster to your TV.

If you have not connected your Mediamaster using a SCART lead, and you have been unable to tune a channel on your TV or video to watch pictures from your Mediamaster, you may need to adjust this setting. It may also require slight adjustment if you can see a picture but there is also some interference.

If you are in any doubt about adjusting this setting, please contact **ITV Digital Customer Services 0808 100 0101**.

## Modem settings



You may need to change the settings within this menu when you connect the Mediamaster to the telephone line.

- Select *modem settings* by pressing **3**.

### Modem

This gives you the option to select whether you are using the 'internal' modem or have added an 'external' modem connected to the SERIAL port.

### Dialling

This gives you the option to select tone dialling. Most domestic telephones use tone dialling.

### Connection

You will only need to change this to 'pabx' if your Mediamaster is connected to a telephone line that requires you to dial a prefix (number) for an outside line.

### Prefix

This option is only available if you have select 'pabx' in the connection option. Prefix can be: 0,1 - 9,\*,#.

### Wait for dial tone

This option is only available if you have selected 'pabx' in the connection option. Then set what your system requires.

### STD code

This allows you to tell the Mediamaster whether it will be required to dial an STD code. Usually set to no.

### Prefix

If you have set STD code to 'yes', this allows you to enter the code.

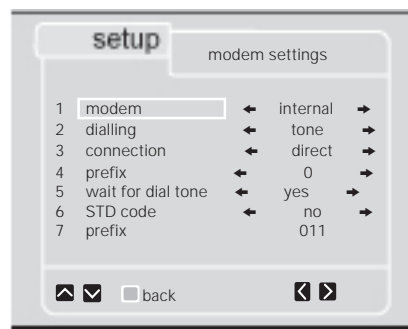

## Technical information

The options contained within the technical information menu enable you to check the status of your Mediamaster. This is not something you should need to do, apart from in the unlikely event of a problem occurring with your box. In this instance, it will help the ITV Digital customer care people to understand the problem and resolve it as quickly as possible.

- Press **MENU** to select the *main menu*.
- Select *technical information* by pressing **7**.

## Signal strength



- Select *signal strength* by pressing **1**.

This option allows you to check the strength of the signal you are receiving through your aerial and the UHF channel number. The colour of the on-screen display will change depending on the signal strength. The bar is empty if the signal is missing.

- Press the **GREEN** button, enter the channel number and press the **RED** button to check the signal strength.

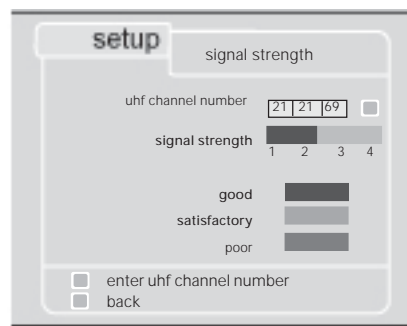

## Technical information

- Select *ITV Digital data* by pressing **2**.

This option shows various information about your ITV Digital Mediamaster, such as its manufacturer and the versions of hardware and software that it contains.

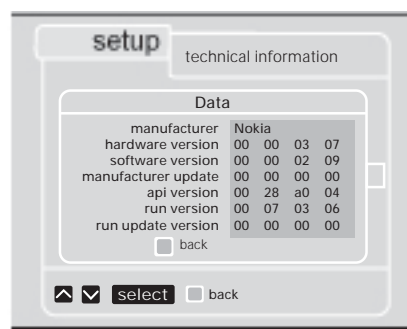

## Auto update

The Mediamaster has the capability to be updated over the air. This may update certain menu functions and add new features. The basic functions will generally be the same. You can also use the '*auto update*' menu to download new data when your ITV Digital Customer Services asks you or when you get a message to do so.

- Select *auto update* by pressing **3**.
- Press **SELECT** to start the update.

While the update is going on you may see the following messages on the front panel display:

*auto Update:* the Mediamaster is searching for an update of the software and will then restart itself

*update Error:* indicates that no update is available and that your Mediamaster already has the latest software

*retrying Update:* indicates that there are problems with the update but your Mediamaster is repeating the update process.

*Out of order:* this indicates that your Mediamaster has been unsuccessful in updating its software, and it may be necessary to contact ITV Digital Customer Services.

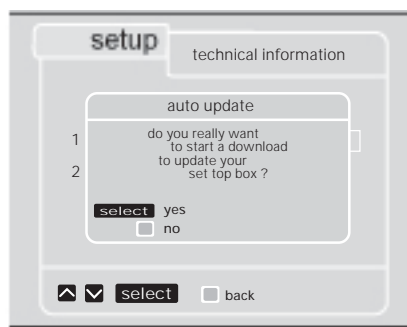

## Searching for channels



This function is normally only used when first installing your Mediamaster, as described earlier in this instruction book. You should follow these instructions when you wish to re-install your Mediamaster at an alternative location, or search for new channels that may have subsequently been launched by the broadcasters.

### Adding new channels

This function should be used when you want to search for any new channels that may have been launched since you originally installed your Mediamaster.

- Press **MENU**, then **5** (*getting started*), then **3** (*add channels*)

Your Mediamaster will now automatically search for any new digital channels. This could take several minutes. You will see a bar on the menu telling you how the search is progressing.

As the search ends, you will briefly see a message that indicates the Mediamaster is storing the channels.

Once the box has found any new channels, the on-screen display will disappear and the new channels will be added into the channel list.

You can check what channels have been added by looking at the channel list, also selected from the getting started menu. If no new channels have been launched, your Mediamaster will display a message saying 'no channels found'.

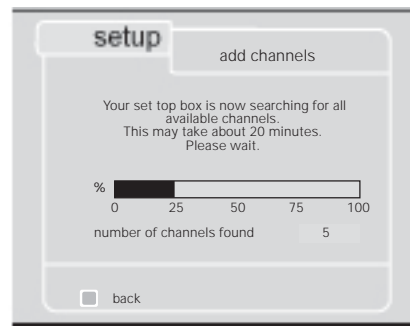

### Replacing the whole channel list

Should you want to carry out a new search for all channels, the store channels option should be selected. In this instance, the current channels stored in your Mediamaster will be replaced by those channels found in the new search.

- Press **MENU**, then **5** (*getting started*) then **4** (*store channels*)

**Note:** As your Mediamaster will have been previously tuned at this stage, the screen will display a warning that existing channel information will be lost when this process is complete.

- Press **SELECT** if you wish to continue, alternatively press the **RED** button to return to the main menu and no changes will be made.

Your Mediamaster will now automatically search for your digital channels. This could take several minutes. You will see a bar on the menu telling you how the search is progressing.

As the search ends, you will briefly see a message that indicates the Mediamaster is storing the channels. You will then see a list of the channels that have been found and stored.

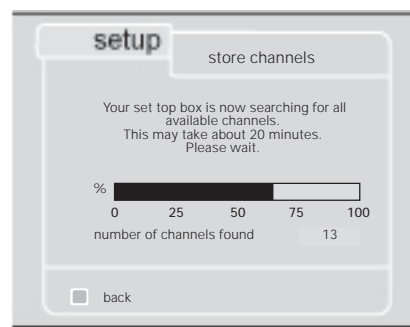

## Trouble shooting guide



Problem	Possible causes	What to do
The display on the front panel does not light up/is not lit.	Mains cable is not connected.	Check that the mains cable is plugged into the power socket.
No sound or picture, but the front panel shows the time or -:- -	The Mediamaster is in standby.	Press the standby button or any number button to bring the Mediamaster out of standby.
Bad picture/blocking error.	Signal too weak.	Check if the aerial works for analogue reception.
The front panel shows a channel number, but you can't see anything from digital TV.	The Mediamaster is not set in digital TV mode.	If your system is connected by SCART leads, press TV/DTV. If this not does work, set the TV to its appropriate AV input. If your system is connected only by RF leads, set your TV to that channel you have tuned for digital terrestrial TV.
	The SCART connection has been made wrong or your TV has not selected the correct AV/EXT channel.	Check SCART connections, making sure leads are firmly pushed into the sockets. Try manually selecting the AV/EXT channel on your TV.
When the Mediamaster tries to find and store channels during the first installation, you see the message 'no channels found' or some channels are missing from the channel list.	The aerial is not properly connected to the Mediamaster.	Check the aerial connector and the aerial installation.
	The aerial is not pointing in the right direction. The aerial is not suitable for digital channels. The indoor aerial is not enough. There are no digital transmission.	Check if you can see the analogue channels. Check that the aerial is pointing in the right direction. Check that the digital transmission are available in the area.
The P+ and P- buttons do not work. ▲ ▼ buttons do not work in the on-screen TV guide.	The Mediamaster is in favourites mode and you have not set any favourites channels.	Set up some favourites or take the Mediamaster out of favourites mode.
Pressing TV/DTV does not switch between a digital channel and an analogue channel.	The system is not connected by SCART leads. The system is SCART connected but the TV is tuned to its channel for digital terrestrial TV.	The TV/DTV button will only work for SCART connected systems.
A small red circle or square appears on the screen, or your picture is 'freezing'.	The digital signal is weak or missing. The aerial may not be suitable. There could be a transmission problem.	Contact ITV Digital Customer Services. They may ask you to check the signal strength menu. This is normally only a temporary situation and should correct itself. If it persists, contact ITV Digital Customer Services.
	Your connecting cables have become loose or disconnected.	Check all connections and make sure they are firmly pushed into sockets.

### What to do if you can't solve the problem

If you have tried all of the actions suggested above, without solving the problem, please contact  
**ITV Digital Customer Services 0808 100 0101**

## Trouble shooting guide



Problem	Possible causes	What to do
The settings you have done in the menus have not been changed.	The Mediamaster was unplugged without first going to standby.	Some menus are only saved permanently when you first put the Mediamaster in standby. Put the Mediamaster in standby after you have changed something in the menus.
You see a on-screen message 'no channel on this number'.	You have entered in a channel number which currently has no channel associated with it.	Select another channel number.
You can't find all the channels you think should be available.	The signal to your aerial may be weak.	Try retuning your Mediamaster, following the relevant steps in this manual. If you are still missing channels, your aerial may need adjusting. Contact ITV Digital Customer Services. They will check this for you.
	Your aerial may need adjusting or your local transmitter may not be working.	
You can see interference on your normal TV channels or your video.	Your Mediamaster is interfering with the frequency of your other equipment.	You need to change the UHF output of the Mediamaster.
The on-screen displays are not as sharp as I expected.	If you have connected using SCART and you have an RGB compatible TV, one of the tv settings should be wrong.	Refer to the relevant section in this manual and alter the TV standard to RGB.
There is no picture on certain channels but the channel name is displayed.	Your ITV Digital subscription does not currently include these channels.	To add channels to your subscription, contact ITV Digital Customer Services.
The order of my channels has changed.	They have been re-arranged as described in this manual.	Refer to the relevant section in this manual to change the order again.
The picture on some channels seems to have been stretched or squashed.	The broadcast is probably in widescreen and the Mediamaster settings may not be correct.	Check the Mediamaster settings. If you have a widescreen TV, you may also need to check the settings on your TV.
I set the timer but it didn't record what I wanted.	The video was set incorrectly.	Make sure that your video is set for the same time as your Mediamaster. If you set the timer and have finished watching TV, make sure you put your Mediamaster into standby, otherwise it will not activate. If you set the timer and continued watching, you must change to the timer channel when the alarm activates.
	Your Mediamaster was not left in standby.	
	You were watching another digital channel and ignored the timer alarm.	
When I have more than 1 programme in the timer, I sometimes miss the beginning of the second programme.	The timer automatically adds 5 minutes to the start and end times set in the timer. If the 2 <sup>nd</sup> programme starts immediately after the first, this can delay the start of the second recording.	Only set the timer for the exact time of the programme. Allow for the 5 minutes run in and out times when setting more than one event.

## Trouble shooting guide









Problem	Possible causes	What to do
The remote is not working.	Battery exhausted. Remote is incorrectly aimed. The Mediamaster is in standby.  An incorrect code has been entered into the remote.	Change the batteries. Aim the remote at Mediamaster. Check that nothing blocks the front panel. Check if (:) is flashing on the front panel display when you press a button. If not replace the batteries. Refer to the relevant section of this book to make sure that the right codes are being used for your other equipment.
You see the on-screen message 'insert smartcard'.	The Mediamaster can't recognise your smartcard.	Check that you are using the proper smartcard. Check that the smartcard has been correctly inserted. If the problem persists, you may have a problem with the card. Contact ITV Digital Customer Services.
You have forgotten your parental code.		Contact ITV Digital Customer Services. They will help you set it up again.

### What to do if you can't solve the problem

If you have tried all of the actions suggested above, without solving the problem, please contact  
**ITV Digital Customer Services 0808 100 0101**

## Front panel display

	Pressing a button on the remote		There is an unread post message in the postbox
	The Mediamaster is in standby		The timer alarm (flashing)
	Channel number		The Mediamaster is in record mode
	RF channel		

## Technical specifications



### Transmission Standards

DVB, MPEG 2

### RF input (OFDM)/Modulator output

#### Loop through output

Input/output connector IEC female / IEC male  
 RF input frequency 470 to 862 MHz  
 RF input power level 35 to 80 dB  $\mu$ V  
 RF impedance 75  $\Omega$   
 Frequency range Loop through 47 to 862MHz  
 Frequency range Re-modulator 470 to 862 MHz  
 Output channel UHF CH 21-69  
 Preset channel 21  
 Output signal PAL I

### TV SCART

Video output 1 V<sub>pp</sub> ( $\pm 1$  dB) / 75  $\Omega$   
 Audio output 0,5 V<sub>rms</sub> / R<sub>L</sub> > 10 k $\Omega$   
 RGB output Internal RGB  
 RGB bandwidth 5,8 MHz  $\pm 3$  dB  
 Fast blanking output Internal RGB  
 Status output 0/6/12 V / R<sub>L</sub> 10 k $\Omega$

### AUX SCART

Video output 1 V<sub>pp</sub> ( $\pm 1$  dB) / 75  $\Omega$   
 Video input 1 V<sub>pp</sub> / 75  $\Omega$   
 Audio output 0,5 V<sub>rms</sub> / R<sub>L</sub> > 10 k $\Omega$   
 Audio input 0,5 V<sub>rms</sub> / R<sub>L</sub> > 10 k $\Omega$   
 Status input 0/6/12 V / R<sub>L</sub> > 10 k $\Omega$

### DIGITAL AUDIO (S/PDIF)

Connector 1 x RCA

### AUDIO R L

Connector 2 x RCA (R+L)  
 Output 0,5 V<sub>rms</sub>  $\pm 0,5$  dB / R<sub>L</sub> 10 k $\Omega$

### SERIAL (RS 232) Low speed serial data

Connector 9-pin D-sub  
 Signals Full duplex data, max. 115,2 kbit/s  
 Pin 1 DCD (Data carrier detect) not connected  
 2 RXD (Receive data)  
 3 TXD (Transmit data)  
 4 DTR (Data terminal ready) Set to high  
 5 GND (Signal ground)  
 6 DSR (Data set ready) not connected  
 7 RTS (Ready to send)  
 8 CTS (Clear to send)  
 9 RI (Ring indicator) not connected

### MODEM Return channel, Telephone line

Connector Modular jack 6-pin  
 Protocol V22 bis, 2400 baud

### Conditional access system:

Embedded Mediaguard and PCMCIA interface for the Common Interface CA-module (DVB Standard)

### Smartcard Interface:

Interface for one card according to ISO 7816  
 Support embedded descrambler (Mediaguard)

### Front panel

Display 4x7 segment alphanumeric LED display,  
 Buttons:  $\phi$ ,  $\nabla$ ,  $\blacktriangle$ ,  $\blacktriangleleft$ ,  $\blacktriangleright$  SELECT, RESET, MENU

### General data

Article code The model code, variant and serial number, are located on a label on the underside of the housing.

Supply voltage 230 V AC  $\pm 15\%$ , 50-60 Hz  
 Power consumption max 24 W  
 Power consumption in standby 5 W  
 Operating temperature +5° C to +45° C  
 Storage temperature - 40° C to +65° C  
 Humidity 25 to 75 % rel humidity  
 Operating distance for remote max 10 meters  
 Dimensions (w x d x h) 380 x 240 x 65 mm  
 Weight 1,9 kg approx

### SCART-sockets

#### TV

1 Audio out right ch.	Audio out right ch.
2 -	Audio in right ch.
3 Audio out left ch.	Audio out left ch.
4 Audio ground	Audio ground
5 RGB blue ground	RGB blue ground
6 -	Audio in left ch.
7 RGB blue signal out	RGB blue signal in
8 Switch voltage out	Switch voltage in
9 RGB green ground	RGB green ground
10 Connect to pin 10 in AUX scart	
11 RGB green signal out	RGB green signal in
12 -	-
13 RGB red ground	RGB red ground
14 Fast blank. ground	Fast blank. ground
15 RGB red signal out	RGB red signal in
16 Fast blanking out	Fast blanking in
17 Video out ground	Video out ground
18 -	Video in ground
19 Video out	Video out
20 -	Video in
21 Ground (casing)	Ground (casing)

#### AUX



The EMC Directive 89/336/EEC is applied to this product.

# Menu screen structure



## First time installation

First power on

**setup welcome**

Press select on your remote to get started

Press SELECT

**setup main menu**

- 1 setting the timer
- 2 choosing favourite channels
- 3 parental lock
- 4 viewing preferences
- 5 getting started
- 6 updates
- 7 technical information

## Main Menu

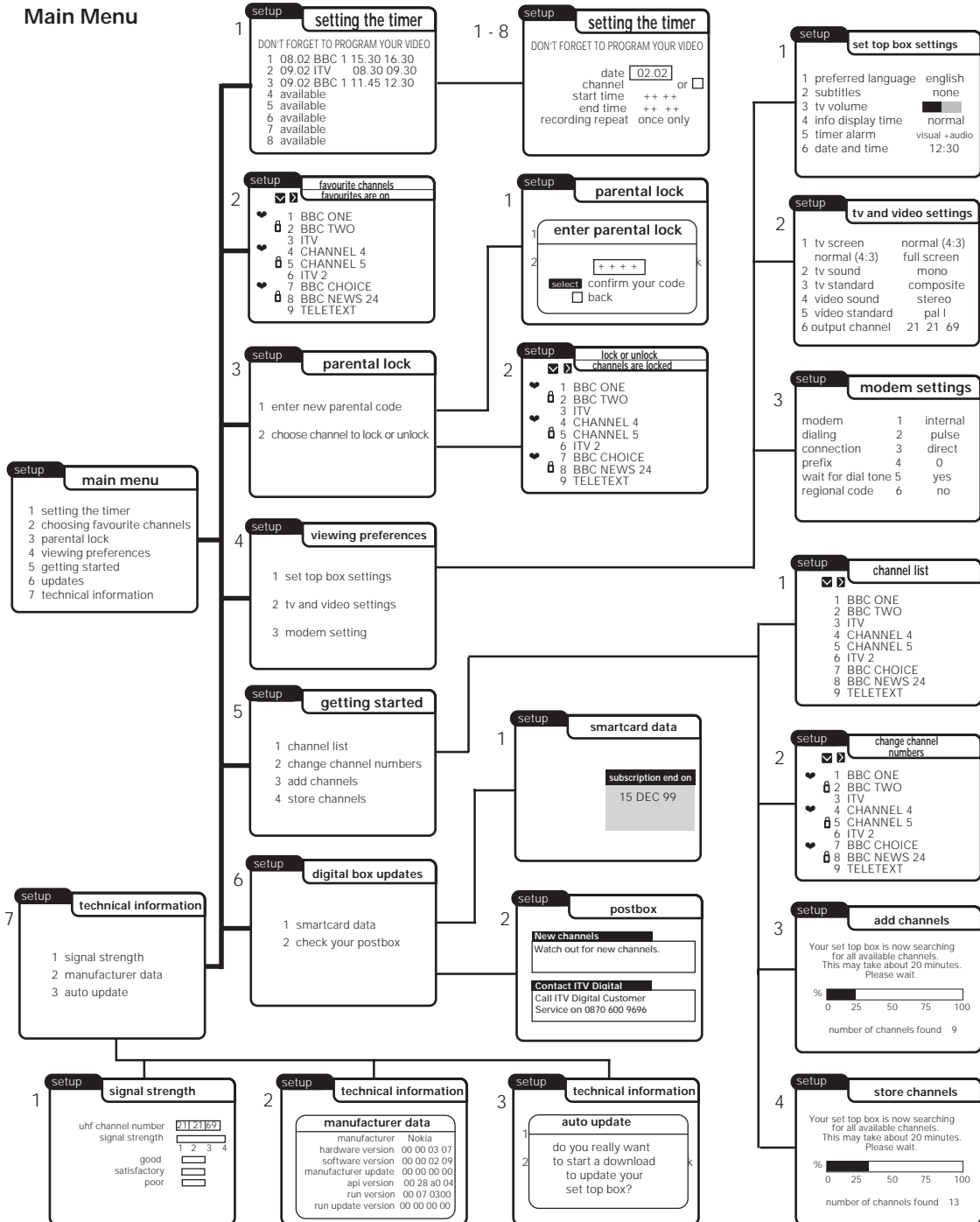

Hereby, Nokia declares that this digital receiver 9850 T is in conformity with the essential requirements and other relevant provisions of Directive 1999/5/EC. This Terminal Equipment is intended for connection to the analogue Public Switched Telephone Networks (PSTNs), in which network addressing, if provided, is by means of Dual Tone Multiple-Frequency (DTMF) signalling.

<b>NOKIA</b>		
<b>Declaration of Conformity</b>		
Manufacturer:	Nokia Corporation through its unit Nokia Home Communications	
Address:	Keilalahdentie 4, FIN-02150 Espoo, Finland	
	Declares that the product	
Product:	Multimedia Terminal 9850T	
	is in conformity with the following Directives and Standards	
Directives:	73/23/EEC 89/336/EEC 92/31/EEC 93/68/EEC 1999/5/EC	
Standards:	EN 55020: 1994, + A11+A12+A13+A14 EN 55013: 1990, + A12+A13+A14 EN 55022: 1998 (class B) EN 50082-1:1997  EN 60065: 1993 + A11 EN 41003: 1998	
Linköping, 14 <sup>th</sup> March, 2002		
<b>Nokia Home Communications</b>		
		
Ismo Viinikainen Head of Product Creation, MT		
Postal Address	Phone	Fax
Nokia Home Communications P.O. Box 226, FIN-00045 NOKIA GROUP	+358 7180 180 71	+358 7180 646 712

This equipment has been approved pursuant to Council Decision 98/482/EC [CTR 21] for pan-European single terminal connection to the Public Switched telephone Network (PSTN). However, due to differences between the individual PSTNs provided in different countries, the approval does not, of itself, give an unconditional assurance of successful operation on every PSTN termination point. In the event of problems, you should contact your equipment supplier in the first instance.

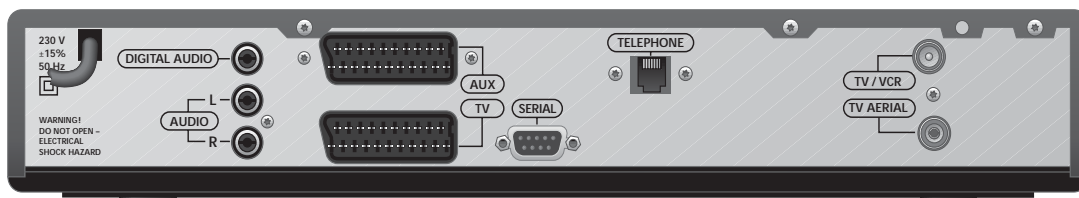

**NOKIA**  
CONNECTING PEOPLE

66 76928-22

Nokia is a registered trademark of Nokia Corporation  
[www.nokia.com](http://www.nokia.com)



© 0214