

CONTENTS

| | |
|--------------------------|--------|
| 1.Usage |1 |
| 2.Feature |1 |
| 3.Accessories |1 |
| 4.System installation |2 |
| 5.Operation instruction |5 |
| 6.Additional accessories |6 |
| 7.Technical data |7 |
| 8. Diagram |8 |

Intelligent Auto Dialed Alarm System

(dial automatically the number saved by householder)



USER MANUAL

Intelligent Auto Dialed Alarm System
(dial automatically the number saved by householder)
RL-0503CD
USER MANUAL

1.Usage

Ideal for house, company, warehouse etc. where anti-theft is needed. The system will alarm sharply when someone intrudes illegally in arms status, meanwhile 6 groups of telephone numbers stored in the main unit will be dialed automatically.

2.Feature

- Compared with other products, this system is easier to operate.
- Magnetic code controller is equipped to arm the system easily. When alarm is activated, the host can enter correct password within the limited time to disarm the system.
- Settings and stored data will not be lost after power failure.
- Up to 38 sensors can be added to this system.
- Simple installation and usage.

3.Accessories

- 1)One main unit
- 2)Two wireless siren with light(indoor & outdoor)
- 3)One infrared sensor(with bracket)
- 4)Two magnet sensors (enclosed 3×LR44 alkaline batteries per sensor)
- 5)One magnetic code controller
- 6)One adapter (9V 300 m A)
- 7)One telephone line

4.System installation

A.Main unit:

- 1.Connect one terminal of telephone line to the main unit and the other terminal to the telephone.
- 2.Put DC terminal of enclosed adapter into DC jack of the main unit and connect AC plug to AC power supply.
- 3.Load 4× AAA size alkaline batteries or NI-Mh batteries at the back of the main unit for spare power supply.
- 4.It is best to put the main unit in a hidden place to avoid the intruder's damage.
- 5.When the left switch on the main unit is turn to "OFF", the main unit's power is shut off; when the switch is turn to "ON", the indicator light of the main unit is on with an remind sound, which means the main unit power is on now.

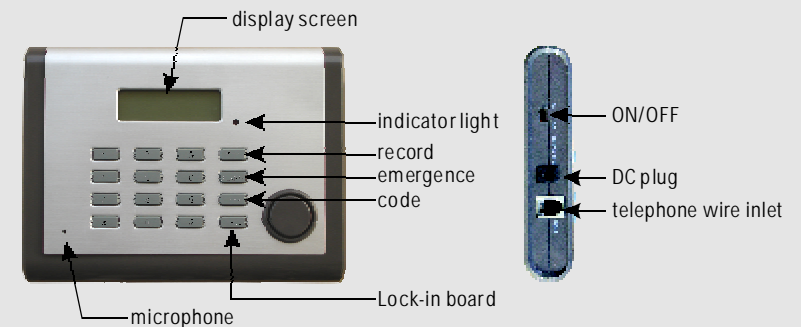

B.Wireless siren with light

1.)indoor

Load 3xLR6 alkaline batteries and put it in an obvious place inside the house.



2)outdoor

Loose the screws, load 4x LR6 alkaline batteries and put it in an Obvious Place outside the house.

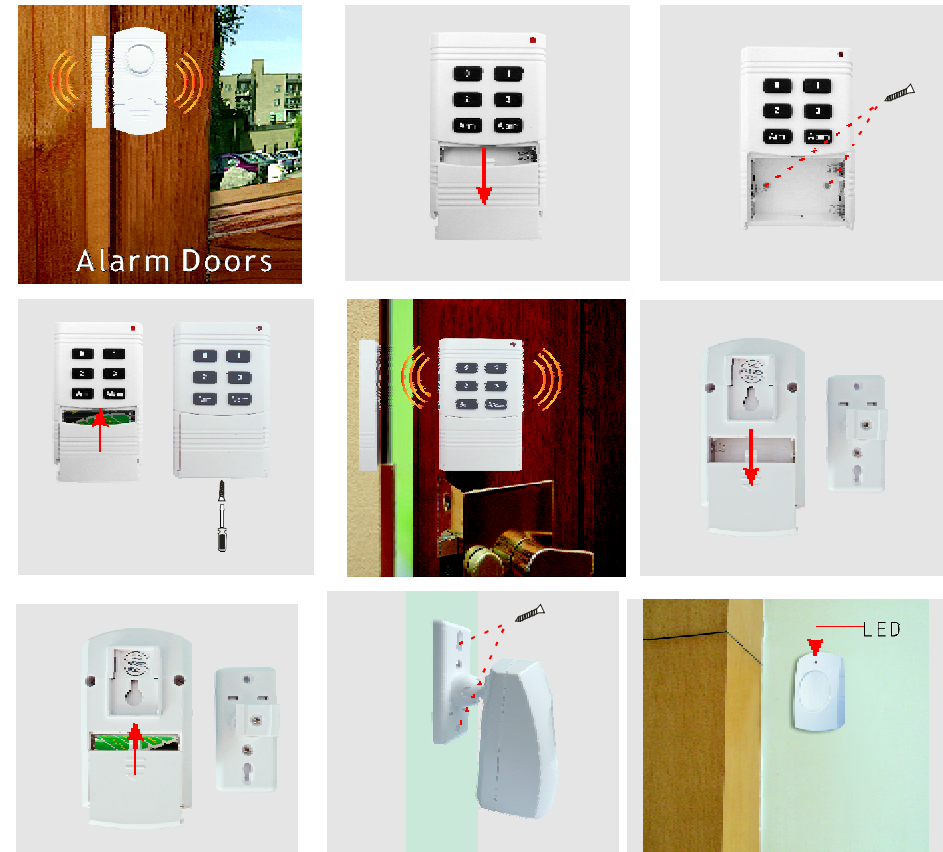
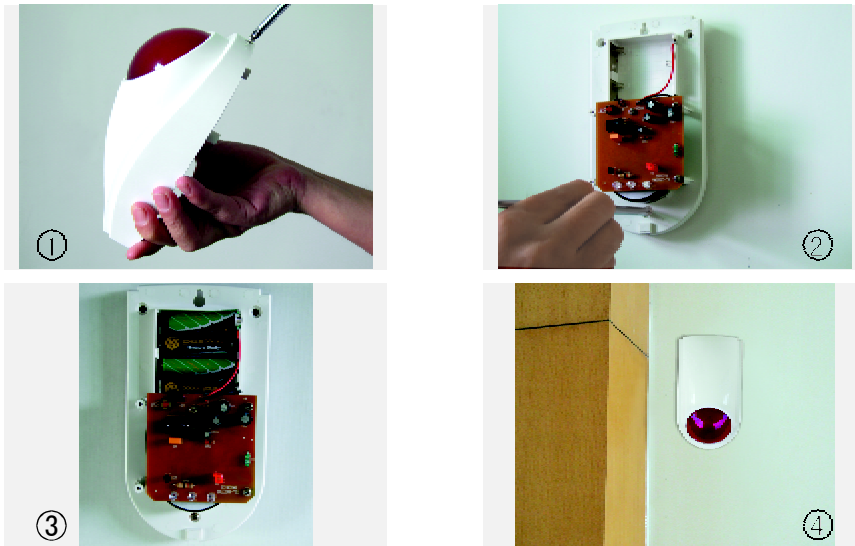

C.Magnet sensor:

It consists of magnetic bar and sensor. Stick the magnetic bar and sensor on the door/window and door frame/window frame with double-side adhesive tape. Align the magnetic bar and sensor and pay attention that the distance between them is not more than 10mm.

D.Infrared sensor

Load 3 pieces of AAA alkaline batteries. Put the adjustable bracket in a needed place and hang the infrared sensor on it. Pay attention to avoid the direct sunshine; do not face the glass window; do not face the heat & cold air vent or heat & cold resource; do not face something that swing easily. The best height for installation is 1.0m to 1.5m. Adjust the angle for best performance.

E. Magnetic code controller

It consists of magnetic bar and controller sensor. Load 3 pieces of AAA alkaline batteries, stick the magnetic bar on the door frame with double-side adhesive tape and fix the controller sensor on the door with screws. Align the magnetic bar and sensor and pay attention that the distance between them should be within 10mm.

Press ARM button, the system will be armed 30 seconds later. If someone intrudes illegally from the door with the magnetic code controller, it will be activated instantly. The system will be disarmed if someone enters the code in 30 seconds.

Arm button: 1. Press ARM once to arm the system after 30 seconds

2. Press ARM continuously, it will enter code amendment mode 3 seconds later.

Press four-digit new code then press ARM again to exit.

Alarm button: To activate the system for emergency

Number keys: To set the code

Initial password is 0123.

F.Operation

Switch on the main unit, load batteries for all accessories. Operation begins when NO-SAVE is shown in the main unit.

1)Record

Press button REC and REC will be shown in the screen. Release the hand when indicating sound is heard to begin the record. The longest time for record is 10 seconds. Record is stopped when indicating sound is heard. The record will be heard from the alarm telephone when system is activated.

2) Set alarm telephone numbers

Press * to set alarm telephone numbers and they are shown in the screen. Press # and the numbers will disappear from the screen, which means the numbers have been stored in the system. For instance, if 13501234567 is an alarm number, press *13501234567#, and then this number is stored in the system. When one number is set, a serial number will be shown in the main unit. There are 6 groups of numbers maximally. These six numbers will be dialed automatically when system is activated as per the serial number from 1 to 6.

3) Cancel the alarm number

Press * and #, then indicating sound will be heard to identify that the set six alarm numbers have been cancelled.

4)Lock & unlock the keypad

Press button LOCK to lock the keypad; press button LOCK two times to unlock the keypad.

5.Operation instruction

- a. Arm: press ARM on magnetic code controller, one indicating sound from the main unit and wireless siren will be heard separately and SAVE will be shown in the screen. The system will be armed 30 seconds later. The alarm numbers will be dialed automatically when someone intrudes illegally from the window or door with magnet sensor or infrared sensor or enters the working range of infrared sensor if system is armed. Record will be heard. Wireless siren will alarm for 25 seconds with flashing light. Switch the magnet sensor RF + ALARM, it will also alarm 2 seconds after alarm from Wireless siren will light to frighten away the thief.
- b. Emergency: press ALARM of magnetic code controller to arm the system for emergency. The set six numbers will be dialed automatically as per serial number from 1 to 6. Wireless siren will alarm with flashing light.

c. Answer the telephone: hang up the telephone or mobile and then other alarm numbers will be dialed continuously after one finishes answering the telephone and mobile and hearing the record. If there is no need to dial the other alarm numbers, press #.

d. Monitor the site: press * to monitor the site. The longest time is two minutes. Press # to stop the dial and monitor.

e. Disarm the system: Enter password to disarm the main unit and wireless siren, meanwhile indicating sound from them will be heard separately.

f. Replace the battery

Lower power supply indicating lights of Wireless siren and infrared sensor will work if power is not enough. Please kindly replace the batteries when LED light of infrared sensor is yellow and LED light of wireless siren flashes every five seconds.

6. Additional accessories:

Load the batteries for needed accessories. Press CODE buttons of the main unit and wireless siren, one indicating sound from them will be heard. If magnet sensor is added, switch it RF, move magnetic bar and sensor close then separate them more than 10mm; if infrared sensor is added, face it to the human until indicating light turns on; If magnetic code controller is added, press ALARM. During each operation, one indicating sound from the main unit and wireless siren will be heard separately. Two indicating sounds from them will be heard 40 seconds after operation is finished, which means that the added accessories is in working status right now.

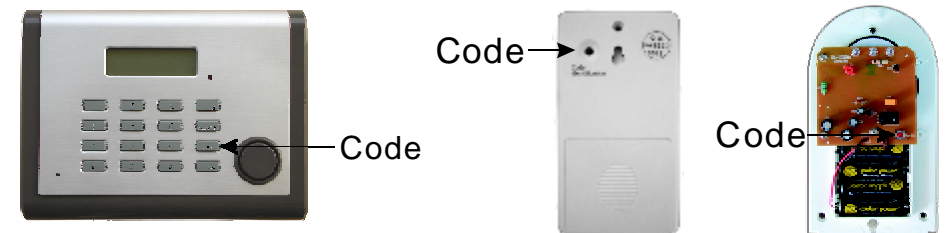

7. Technical data

Main unit:

- Input voltage: DC6V-9V
- Working current: < 12 m A
- Receive frequency: 433.5MHZ-434MHZ

Infrared sensor

- Input volts: DC4.5V (AAAx3)
- Standby current: < 0.1mA
- Transmission current: < 8mA
- Transmission frequency: 433.5MHZ-434MHZ
- Transmission distance: > 50m (open area)
- Inductive distance: > 5m (open area)
- Low voltage indication: < 3.1V ± 0.1V

Magnet sensor

- Input volts: DC4.5V (LR44x3)
- Standby current: < 10 uA
- Transmission current: < 8mA
- Transmission frequency: 433.5MHZ-434MHZ
- Transmission distance: > 50m (open area)

Magnetic code controller

- Input volts: DC4.5V (AAAx3)
- Standby current: < 10uA
- Transmission current: < 5mA
- Transmission frequency: 433.5MHZ-434MHZ
- Transmission distance: > 50m (open area)

Wireless siren with light(indoor)

- Power volts: DC4.5V (LR6x3)
- Standby current: < 600uA
- Alarm current: < 170mA
- Alarm volume: > 95 dB(within 0.5m)
- Receive frequency: 433.5MHZ-434MHZ
- Low voltage indication: < 3.1V ± 0.1V

Wireless siren with light(outdoor)

- Power volts: DC6V (LR6x4)
- Standby current: < 650uA
- Alarm current: < 200mA
- Alarm volume: > 105 dB(within 0.5m)
- Receive frequency: 433.5MHZ-434MHZ
- Low voltage indication: < 3.6V ± 0.1V

8. Diagram

