



Tel: +7 495 7907870
Mo6: +7 965 4429948
Skype: Discoverytelecom
Mail: info@discoverytelecom.ru
www.discoverytelecom.ru

EWK2 EWK2A

WIRELESS KEYFOB

User Manual v1.1

Compatible with:

- ESIM264 v7.14.00 and up + EWT1 v16.18 and up.
- ESIM364 v02.04.10 and up.
- EPIR2 v01.01.08 and up.

Main Features:

- Alarm system arming & disarming;
- Panic button;
- PGM output control;
- Visual and audio indication of command status.

For more details, please refer to ELDES alarm system user and installation manuals.

EWK2/EWK2A is a wireless device intended to remotely arm and disarm ELDES alarm system, cause system alarm (Panic Button) or to control any electric appliance connected to the alarm system's PGM output. In order to start using wireless keyfob EWK2/EWK2A, it has to be bound to ELDES wireless alarm system using *ELDES Configuration Tool* software or sending a corresponding SMS text message. EWK2 keyfob features four configurable buttons intended to operate according to individual needs, while EWK2A keyfob model features one configurable button. After the button is pressed, EWK2/EWK2A internal buzzer's sound signal and red LED indicator confirms a transferred command to ELDES alarm system via wireless connection. The status of the sent command can be checked by attempting to receive the feedback signal from the alarm system. This can be performed by pressing down the same button again and holding it for 3 seconds. 3 short sound signals and LED indicator flashes indicate a successfully carried out command, while 1 long beep and LED indicator flash stands for failed command and feedback signal failure. By default, one pair of buttons is already configured to arm and disarm the alarm system.

It is possible to connect up to 5 EWK2/EWK2A devices to ELDES alarm system at a time. The maximum wireless connection range is 150 meters (in open areas).

1. CONTENTS OF PACK

1. EWK2/EWK2A.....qty. 1
2. CR2032 3V lithium battery.....qty. 1
3. User manual.....qty. 1

2. TECHNICAL SPECIFICATIONS

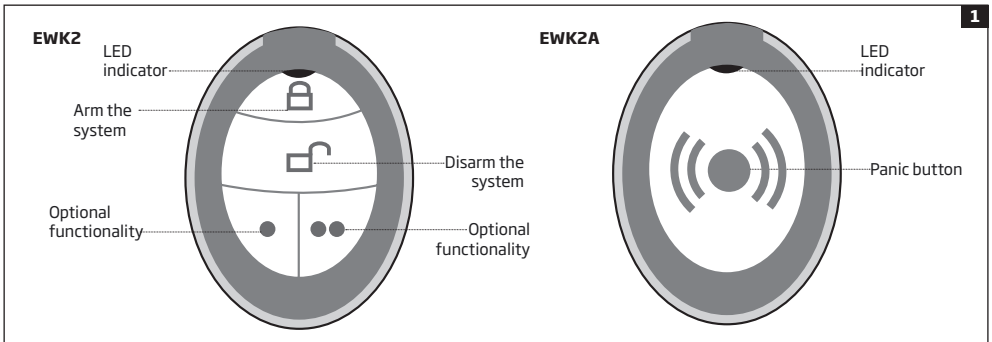

NOTE: Fig. No. 1 reflects the default EWK2/EWK2A button configuration. All EWK2 keyfob buttons are/EWK2A keyfob button is configurable according to individual needs.

2.1. Electrical & Mechanical Characteristics

Battery type	CR2032 Lithium
Battery voltage; capacity	3V; 240 mAh
Quantity of batteries	1
Battery operation time	~18 months*
Wireless transmitter-receiver frequency	868 Mhz
Range of operating temperatures	-20...+55°C
Humidity	0-90% RH @ 0... +40 °C (non-condensing)
Dimensions	53 x 37 x 10 mm
Wireless communication range	Up to 30 meters in premises; up to 150 meters in open areas
Compatible with alarm systems	ELDES Wireless

* This operation time can be achieved by pressing the keyfob button up to 4 times per day. The operation time depends on different conditions and may vary.

3. INSTALLATION

1. Remove the screw located on the back side of EWK2/EWK2A enclosure.

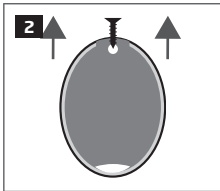

2. Once the enclosure is opened, remove the PCB from the EWK2/EWK2A enclosure and flip the PCB so that the back side would be facing up.

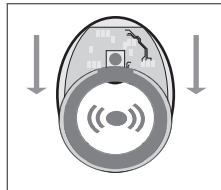
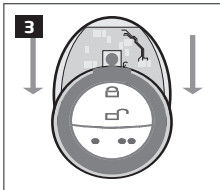

3. Insert the CR2032 type battery provided in the EWK2/EWK2A pack. Before inserting the battery, ensure that it is positioned plus-marked side up.

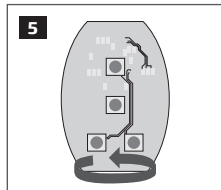
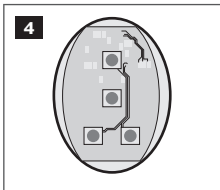

- Insert the CR2032 type battery provided in the EWK2/EWK2A package. Before inserting the battery, ensure that it is positioned plus-marked side up.

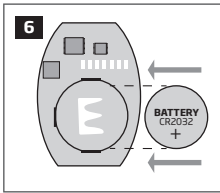

- Insert the PCB back to the enclosure and close it.
- Bind the device to the alarm system using *ELDES Configuration Tool* software. **Open Wireless Device Management** section and enter a 8-digit wireless device ID located on the EWK2/EWK2A enclosure and press **Add** button (see Fig. No. 7). The device can also be bind by sending a corresponding command via SMS message. For more details, please, refer to the software's HELP section and ELDES alarm system installation manual.

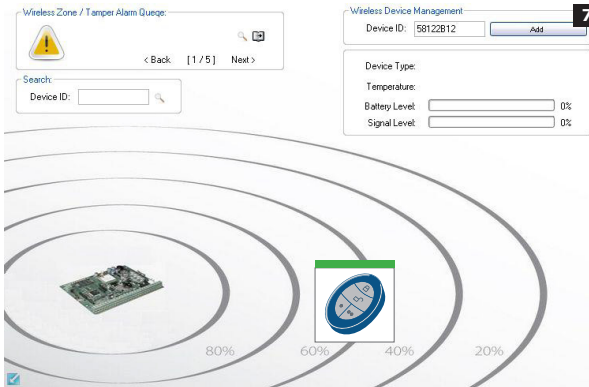

- Press any EWK2 button/press the EWK2A button several times until the device is successfully bound. Upon the successful binding process EWK2/EWK2A icon, **Battery Level** and **Signal Level** values will appear in *ELDES Configuration Tool* software's **Wireless Device Management** section.
- EWK2/EWK2A is ready for use.

NOTE: If you are unable to bind the wireless device, please, restore the parameters of the wireless device to default and try again. See chapter **6. Restoring Default Parameters** for more details.

4. PANIC BUTTON

By default, EWK2A keyfob supports a Panic Button feature allowing to cause an alarm at any time when the keyfob button is pressed. EWK2 keyfob may support a Panic Button feature. This feature that can be configured using *ELDES Configuration Tool* software by creating a virtual zone of Panic/Silent or 24-Hour type and assigning it to Virtual Alarm option. The Panic Button feature can be set up on any button of EWK2.

5. BATTERY REPLACEMENT

- Open EWK2/EWK2A enclosure.
- Remove the old battery from the battery slot.
- Position the new battery according to the appropriate battery slot positive terminal indicated.
- Insert the battery into the battery slot.
- Battery replaced.

See **3. INSTALLATION** for more details.

ATTENTION: Only CR2032 3V battery can be used. Install only new, high quality and unexpired batteries.

ATTENTION: The battery must be removed if the device is not in use.



ATTENTION: In order to avoid fire or explosion hazards, the system must be used only with approved battery. Special care must be taken when connecting positive and negative battery terminals. Dispose old batteries only into special collection sites. Do not charge, disassemble, heat or incinerate old batteries.

NOTE: The system sends an SMS message to a preset User 1 as soon as the battery level runs below 5%.

NOTE: The battery status can be monitored in real-time using *ELDES Configuration Tool* software.

6. RESTORING DEFAULT PARAMETERS

EWK2

1. Press and hold  and  buttons simultaneously.
2. Hold the buttons pressed until LED indicator and the buzzer provide several short flashes and beeps simultaneously.
3. Release the buttons.
4. Parameters restored to default.

EWK2A

1. Press and hold the lower side of the button. 
2. Hold the button pressed until LED indicator and the buzzer provide several short flashes and beeps simultaneously.
3. Release the button.
4. Parameters restored to default.

7. ADDITIONAL INFORMATION

Limited Liability

The buyer must agree that the system will reduce the risk of fire, theft, burglary or other dangers but does not guarantee against such events. "ELDES UAB" will not take any responsibility regarding personal or property or revenue loss while using the system. "ELDES UAB" liability according to local laws does not exceed value of the purchased system. "ELDES UAB" is not affiliated with any of the cellular providers therefore is not responsible for the quality of cellular service.

Manufacturer Warranty

The system carries a 24-month warranty by the manufacturer "ELDES UAB". Warranty period starts from the day the system has been purchased by the end user. The warranty is valid only if the system has been used as intended, following all guidelines listed in the manual and within specified operating conditions. Receipt must be kept as a proof of purchase date. The warranty is voided if the system has been exposed to mechanical impact, chemicals, high humidity, fluids, corrosive and hazardous environment or other force majeure factors.

SAFETY INSTRUCTIONS

Please read and follow these safety guidelines in order to maintain safety of operators and people around:

- DO NOT use the system where it can be interfere with other devices and cause any potential danger.
- DO NOT use the system with medical devices.
- DO NOT use the system in hazardous environment.
- DO NOT expose the system to high humidity, chemical environment or mechanical impacts.
- DO NOT attempt to personally repair the system.



The WEEE (Waste Electrical and Electronic Equipment) symbol on this product (see left) means it must not be disposed of in household waste. To prevent possible harm to human health and/or the environment, you must dispose of this product in an approved and environmentally safe recycling facility. For further information contact your system supplier, or your local waste authority.