

IRM-S01BN LED STROBE LIGHT USER MANUAL

1 GENERAL INTRODUCTION

With 15 pieces LED, internal good control circuit and exterior power supply, IRM-S01BN Strobe Light can send out the alarm signal through LED flash. This product is widely used in correspondence room, IT data center and other indoor location for alarm prompt.

appearance and connect

Refer to Chart 1

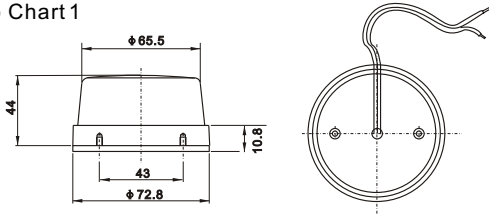

Chart 1

2 TECHNICAL PARAMETER

Refer to table 1

Table 1 main parameters

Parameter	Instruction
Operating voltage	24VDC
Flash current	≤80mA
Flashes	120 times/ min
Flash frequency	120 times/ min (±10%)
Operating temperature	-10℃ ~ +50℃
Life time	≥1000 hours (standard power work continuously)
Strobe color	Red

3 INSTALLATION

3.1 CHECKING

1. After goods are forwarded to client, the seal of carton should be well, and the carton should not have any rupture or wet phenomena.
2. Open the strobe packaging, check the appearance of strobe light, there should be no house scrapes, scratches and any other defects. If strobe is damaged please inform the manufacturer immediately.
3. Check and confirm if the product and the accessories are full and correct or not.

3.2 MECHANICALLY INSTALLATION

Three installation methods optional, refer to Chart 2 for accessories and installation methods.

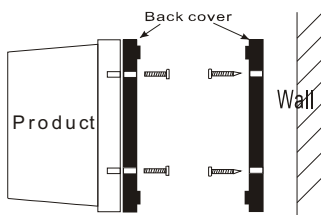

Chart 2

Mode one: Sponge adhesive; rip off the protective paper on both side of the glue paper. Affixed one side of it to products, and another side to the position where you need to install.

Mode two: Rotary buckle installation; Open the button cover (refer to Chart 2), fix the back cover on the wall, then clodse the rotary buckle

Mode three: magnet adsorption; fix the bracket with magnet inlaid (refer to Chart 3) on the product by screws, and then adsorb it on any iron surface.

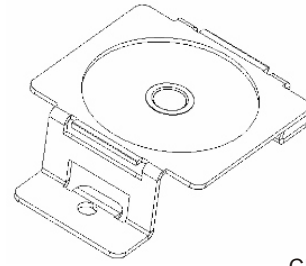

Chart 3 bracket

4 CONNECTION

Output and power connection

Output and power connections are RJ45, refer to Chart 1 for position, refer to Table 2 for definition.

Table 2 RJ45 Connection definition

Terminal Number	Definition
1	NULL
2	24V/connect with PIN5
3	NULL
4	GND/Beacon-
5	COM/connect with PIN 2
6	NO/Beacon+
7	NULL
8	NULL

Connection mode: Connected with relay output terminal of superstratum device by reticle.

APPENDIX ONE CONSIGNMENT LIST

- Strobe Light one piece;
- Product fitting one set;
- User manual one piece

Components	Hazardous Substances or Elements Identified Table					
	Plumbum	Mercury	Cadmium	Hexavalent chromium	Polybrominated biphenyls	Polybrominated diphenyl ether
	Pb	Hg	Cd	Cr ⁶⁺	PBB	PBDE
Finished products	○	○	○	○	○	○

○: Content of this hazardous substance is under the required level of SJ/11363-2006 standard.

×: Content of this hazardous substance is beyond the required level of SJ/11363-2006 standard.

Emerson Network Power Co., Ltd. has been committed to design and manufacture of environmental products, we will continue to research products to reduce and eliminate toxic substances. Limited by the current technology level, it is hard to achieve a reliable substitute or find a mature solution.

Explaining about the EPUP (Environmental Protection Use Period): EPUP of this product (already identified on product), with normal use condition and compliance with the safety note of this product, The term from the date in produced to the deadline that toxic and hazardous substances element of this product will not seriously impact the environmental, personal and property.

Apply to IRM-S01BN LED strobe light

EMERSON NETWORK POWER CO., LTD.

Add: No.1 Kefa, Road, Science & Industry Park, Nanshan District
P.C.: 518057

Website: www.emersonnetworkpower.com.cn

Customer Service Hotline: 4008876510

E-mail: service@emersonnetwork.com.cn

Copyright reserved, content subject may be changed without notice.