

INSTRUCTION MANUAL



Single Station Smoke Detector (wireless)
Wireless Optical-Smoke Fire Detector

DEGA FWL Home



ISO 9001:2008
Quality Management Systems
Système de Qualité
www.sgs.com

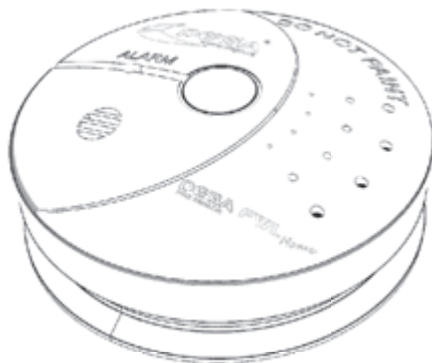

Content

Page 2 / For your protection

Page 2 / Technical data and information

Page 3 / Description of the product

Page 3 / Installation, assembly and disassembly of the detector

The recommended procedure for a typical one-storey dwelling

The recommended procedure for a typical multi-storey dwelling

Where to install a smoke detector

Where not to install a smoke detector

Assembly of the detector

Disassembly of the detector

Connecting the battery

Replacing the battery

Page 5 / Testing the detector

Page 5 / Maintenance

Page 5 / What to do in the case of fire

Page 6 / Troubleshooting

Page 6 / General warranty terms and conditions



Reproduction of this manual, or any part thereof, in any form, without the prior written permission of DEGA CZ s.r.o. is prohibited.

DEGA CZ s.r.o. reserves the right to alter the specifications of the hardware and software described in this manual at any time and without prior notice.

DEGA CZ s.r.o. bears no liability for any damage resulting from the use of this device!

FOR YOUR PROTECTION



Watch out for static electricity

Prior to installing or handling the product, ensure that you do not have an accumulated static charge. Touch a grounded metal object to trigger the discharge of any accumulated electric charge. Otherwise the product could suffer damage.



In the event of any failure of the equipment unplug it immediately

If you notice an unusual odour or smoke emanating from the product, unplug it from the mains and from all peripherals. Continued operation could result in injury or property damage. After disconnecting the product deliver it to an authorised service centre or the manufacturer for inspection.



Do not use the product in the vicinity of flammable gases or in areas where there is a potential occurrence of these gases.

Do not use electronic equipment in the vicinity of flammable gases; this could potentially cause a fire or an explosion. The product is not designed for use in industrial or commercial spaces nor in „Ex“ hazardous areas.



Do not disassemble the product and ensure against its contact with water

Contact with internal components of the product may cause an electric shock. In the case of any failure refer the servicing of the product exclusively to a certified service centre. Contact with water can create a short circuit in the product and consequent damage to property or personal injury.



The smoke detector responds only to visible smoke

Smoke detectors start emitting warning signals only in the event of the detection of smoke or other particles generated during the combustion process. Detectors do not respond to heat, flames or gas. The possibility of a fire is announced by an acoustic signal. Fires often progress very swiftly, however. In such cases, the smoke may not reach the detector rapidly enough to ensure the safe escape of the people in the building.



Use in one household only

This smoke detector is designed for use in one household only. In larger buildings, each housing unit should be equipped with its own detector(s). Smoke detectors should not be installed in non-residential areas; they are not a viable substitute for a comprehensive monitoring system.



Install a detector in each room

Install a detector in every room and on every floor of the building. There are many reasons why smoke may not reach the sensitive area of the detector. For example, if the fire starts in a remote part of the building, on another floor, in the chimney, along a wall, on the roof or in a room behind closed doors, it may be that the smoke will not reach the area sensitive to the detector rapidly enough for the detector to provide notice of impending danger to all the members of the household. The detector is only able to identify fire directly in the space or in the room in which it is located.

TECHNICAL DATA AND INFORMATION

Supply voltage:	a 6LR61/9V battery
Supply voltage in the standby mode:	< 40 µA
Supply voltage in the alarm mode:	< 30 mA
Type of sensor:	photoelectric (responsive to visible smouldering smoke)
Expected operational life of the sensor in a clean environment:	max.5 years
Radio frequency:	433,92 MHz
Range:	50m in an open area
Internal speaker acoustic performance:	85 dB at 1m
Operating temperature range:	max.-10°C to +50°C
Relative humidity of the ambient air:	15 - 90%

Certified in accordance with CSN EN 14604 based on the specifications of Decree No. 23/2008 of the Ministry of Interior, On the technical conditions for fire protection of buildings.

DESCRIPTION OF THE PRODUCT

- 1 - Air holes for the access of smoke to the sensor of the detector
- 2 - A „TEST“ button
- 3 - A red indicator - „ALARM“ (LED, alarm)
- 4 - Piezo-buzzer

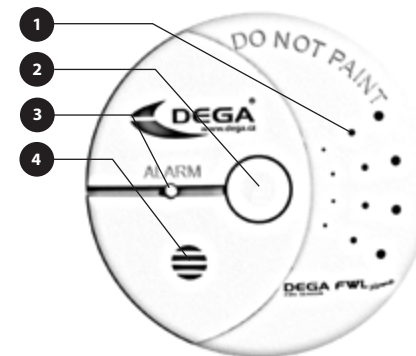

Attention: The „TEST“ button reliably tests all the functions of the smoke detector. Do not try to test the detector in any other manner. Carry out checking, using the „TEST“ button, once a week, and always also after a longer absence.

INSTALLATION, ASSEMBLY AND DISASSEMBLY

THE RECOMMENDED PROCEDURE FOR A TYPICAL ONE-STOREY DWELLING

Attach the smoke detector to the ceiling or to a wall in each bedroom and in the hallway outside each bedroom. If the hallway is longer than 9.1 m, place a detector at each end of the hallway. If you have a cellar, install a detector on the ceiling of the basement space directly below the staircase

THE RECOMMENDED PROCEDURE FOR A TYPICAL MULTI-STOREY DWELLING

Attach a smoke detector to the ceiling or to a wall in each bedroom and also in the hallway outside each bedroom. If the hallway is longer than 9.1 m, place a detector at each end of the hallway. Install additional detectors above the top end of the staircase between the first and second floors.

WHERE TO INSTALL A SMOKE DETECTOR

1. Place a detector in each bedroom and also in the hallway outside each bedroom.
2. Place a detector on each staircase and on each floor.
3. Once the smoke, heat and flames reach the ceiling, they begin to spread horizontally. Install the detector in the centre of the ceiling.
4. If you do not place the detector in the centre of the ceiling, ensure that it is at least 10 cm from any corner (see Figure 1).
5. A detector installed on the wall must be located at least 10 cm below the ceiling (see Figure 1).
6. If a room, hall or corridor is longer than 9.1 m, additional detectors need to be placed there.
7. In the case of a sloping wall or ceiling, place the detector at a distance of 50 cm below the top of the wall or the ceiling (see Figure 2).

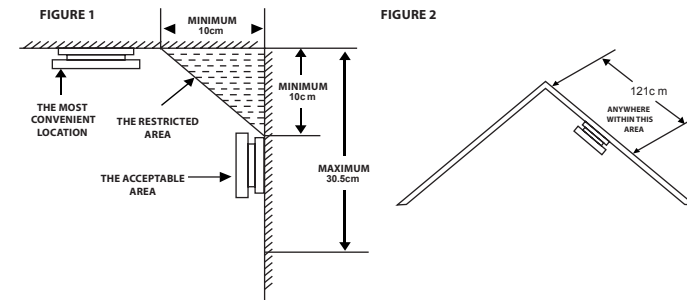

WHERE NOT TO INSTALL A SMOKE DETECTOR

1. Do not place detectors close to rooms or facilities where combustion normally takes place (e.g. kitchens, boilers, water heaters). In these areas, utilise special detectors with an alarm silencing function.
2. The installation of a detector in a very humid environment, e.g. in a bathroom, or close to a washing machine or a dishwasher, is unsuitable. Place the detector at a distance of at least 3.5 m from any source of humidity.
3. Do not place the detector close to ventilation holes or openings designed for the supply of hot or cold air, but always at least 1 m away from such locations. The airflow might dilute the concentration of smoke and the alarm would then not be activated.
4. Do not place the detector in rooms in which the temperature could drop below 4.5 °C or, vice versa, where it could exceed 37.5 °C – this could provoke a false alarm.
5. Do not install the detector in any excessively dusty, dirty or insect-infested areas, where particles released into the air could impair the functioning of the detector.

Attention: If you place the detector close to a shower or a cooker, because of the extent of the content of water vapour the inducing of a false alarm can occur.

Recommendation: In each area/room, for safety reasons, install a minimum of two detectors (if damage to one detector occurs at least one backup detector will remain functional).

ASSEMBLY OF THE DETECTOR

1. Twist the detector body counter-clockwise and remove the mounting plate from the back of the detector.
2. Hold the plate against the area to which you wish to attach the detector. Use a pencil to mark the positions for both the holes for the mounting plate on the surface.
3. Drill holes into the points marked and hammer in anchors. Screw the screws with sealing rings halfway into the anchors, then attach the mounting plate of the detector to them. Tighten the screws (see Figure 3).
4. Insert the batteries into the battery compartment and close the cover. Align the detector body with the mounting plate and rotate the detector body clockwise until it clicks (see Figure 5).
5. Test the detector by pressing the „TEST“ button.

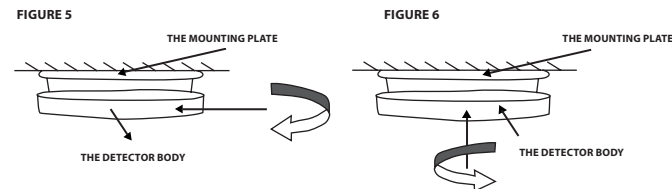
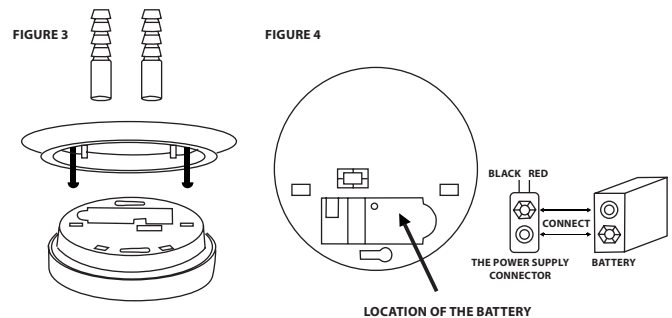

DISASSEMBLY OF THE DETECTOR

1. Twist the detector body counter-clockwise and remove it from the mounting plate (see Figure 6).
2. Unscrew the two screws that attach the mounting plate to the wall.

CONNECTING THE BATTERY

Connect the 6LR61/9V alkaline battery as shown in Figure 4

REPLACING THE BATTERY

1. Turn the detector body counter-clockwise and remove it from the mounting plate.
2. Following the instructions in the „Connecting the battery“ section attach the power supply cable (Figure 4).
3. Insert the battery into the battery compartment, attach the detector body to the mounting plate and rotate the detector body clockwise.
4. Test the detector by pressing the „TEST“ button.

TESTING THE DETECTOR

1. Test all the smoke detectors and ensure they are properly installed and functioning well.
2. Check the functionality of the detector by pressing the „TEST“ button for at least 5 seconds. Under no circumstance use an open flame for this purpose. You could accidentally set fire to, or damage, the detector or your home.
3. Test the smoke detectors once a week and also always following returning from a vacation or after several days absence from your home.
4. When conducting the test stand at an arm's length distance from the detector.
5. Firmly press the „TEST“ button for 3-5 seconds. The detector being tested emits a short beep. When you release the button the alarm is silenced. The second detector then also beeps and its light flashes. (Depending on the distance between the detectors the delay will be between 3 and 15 seconds). The alarm can continue beeping for up to 30 seconds.

IF THE ALARM SOUNDS AND YOU ARE NOT CONCURRENTLY CONDUCTING A TEST, THIS REPRESENTS A REAL ALARM THAT REQUIRES YOUR IMMEDIATE ATTENTION AND ACTION!

MAINTENANCE

1. **Once a week** - test the functionality of the sensor by pressing the „TEST“ button for 5 seconds
2. **At least once a month** - wipe any fine dust or dirt from the surface of the detector using a soft cloth.
3. **At least once a year** - replace the 9V battery.

In the event of any major contamination disconnect the detector from the battery and clean the surface of the detector with a damp cloth. Do not utilise any liquid cleaners.

Do not use the device for longer than the lifetime of the sensor!

WHAT TO DO IN THE CASE OF FIRE

These instructions will help you in the case of fire. Act in accordance with safety principles to minimise the risk of fire.

1. Please act calmly and judiciously.
2. Leave the building as rapidly as possible. Before opening any door, touch it and check it for heat. If requisite, use an alternative escape route. Crawl alongside the wall and do not stop, do not bring anything with you.
3. Gather in the pre-agreed location outside the building.
4. Call the fire brigade when you are outside the building.
5. Never return into a burning building. Wait until the arrival of fire brigade.

TROUBLESHOOTING

Never turn off the alarm by disconnecting the power, you would thereby be endangering your own safety. Open a window and/or stir-up the air in the vicinity of the detector to reduce the amounts of smoke and of dust.

Problems	The proposed procedure
When testing an alarm the sound signal is not audible. ATTENTION: The „TEST“ button must be held down for at least 5 seconds	Remove the detector body from the mounting plate and ensure that the supply power cable is firmly connected.
The smoke detector beeps at one-minute intervals.	Replace the battery.
Sometimes a false alarm is triggered, e.g. while cooking, showering, etc.	Clean the detector. Employ the services of an electrician and move the smoke detector to another location.
The acoustic signalling is different than it was previously. The detector beeps, then stops beeping for a while.	The smoke detector is functioning properly. This alarm uses an internationally recognised means of signalling evacuation. The signalling method is as follows: the detector first gives three short beeps followed by a two-second pause and then the three beeps are repeated. Clean the detector.

GENERAL WARRANTY TERMS AND CONDITIONS

When the instructions for installation, operation and maintenance are followed the manufacturer guarantees a warranty period of 24 months from the date of receipt of the product. When claiming a product defect it is necessary to submit a proof of purchase that contains the following information: name and surname of the purchaser, name and business name of the seller and his/her identification number; if the seller is a legal entity its name, identification number, registered office; if a natural person – the first name, surname, address and the warranty card, if the buyer received one from the seller. The validity of the warranty shall not be affected by non-compliance with the obligations related to the issuance of the warranty card.

1. Claims concerning the product (for a warranty repair only complete devices are accepted) may be filed during the warranty period only with the seller from which it was purchased; subsequently the seller is required to forward the product to an authorised service centre or to the manufacturer.
2. This warranty is not applicable to:
 - damage caused by fire, water, static electricity, power surges in the electric supply or in the public network, accident, improper use of the product, wear and tear
 - contamination of the product and its subsequent cleaning,
 - damage caused by any adjustment, modification or improper manner of use inconsistent with the instruction manual, the technical standards or the applicable safety regulations in the Czech Republic,
 - damage to the product during transportation caused by improper handling or handling of the product in a manner contrary to the advice provided in the instruction manual,
 - DEGA products **that have been used in association with other than original DEGA products, including consumables and accessories,**
 - **the setting (calibration) of detectors**
 - wear and tear or damage to the sensors in detectors, including the need for their replacement
 - wearing parts and consumables (e.g. the wrench for removal of sensors, gaskets, etc.) that are detrimental to normal wear and tear during operation, together with wear and tear of the product and its components caused by their normal use.
3. Claims regarding a product defect that can be dealt with reasonably quickly and without additional consequences will be resolved by remedying the defect (repair) or by replacement of the product part, because in such a case it is a contradiction of the standard norms that the entire product shall be replaced (§ 616, paragraph 4 of the Commercial Code). A buyer who exercises the right of warranty repair is not entitled to the return of the parts that have been replaced.
5. For the complete version of the general business conditions and of the claims procedure go to www.dega.cz

Manufacturer: DEGA CZ s.r.o., K Žižkovu 640/9, 190 00 Prague 9, Czech Republic
 Tax ID: CZ 279 029 43, Company ID: 279 02 943
 Telephone (cz) : +420 774 447 660-5, Fax: +420 227 203 512
 E-mail: info@dega.cz, Web: www.dega.cz