

# Other Access Control Products

## standalone products

Also available is a range of fully functional standalone door controls for less complex door management. This attractive design, with modern aesthetics, will complement and building.

- 1 and 2 Door Digital Keypads
- Proximity Switch
- Biometric Switch

### Features:

- (35 - 1000) users
- Access control
- Door monitoring
- Manager user
- fire and intruder alarm interface
- Backlighting
- Tamper resistant
- 5 amp relays
- Indoor or outdoor use
- Robust polycarbonate housing with stainless steel keys
- Mounts onto a standard electrical back box



## Contents

Initial Setup

2

Installation Diagrams

4

Wiring Diagrams

6

Enrolling Door Controls

12



Wi-Pin  
Wi-Prox  
Wi-Pin & Prox

Simple Secure Access

[www.argusaccess.com](http://www.argusaccess.com)

Installation & User Manual V2.041



## Technical Specs

Power Supply	12V DC
Current consumption	70mA
Current consumption with load (max)	100mA
Relay Contact Rating	5 Amps / 240V ac
Operating Temperature	-20 °C to +60 °C
Moisture Resistance	IP 67
Dimensions - Flush Mount	W. 87mm D. 21mm H. 119mm
- Surface Mount	W. 87mm D. 35mm H. 119mm
Number of Users	20000

## Initial Installation

The Door Control should be Factory Defaulted after installation. This will restore all default settings to the Door Control and will unenrol it from any existing Controller.

The Door Control will then start to scan and enrol on a controller.

Refer to the section 'Enrolling Door Controls' for instructions on how to configure the Windows Software.

## Restoring Factory Settings - Wi-Pin&Prox, Wi-Pin

Code	Description
55	Restore Factory Default Settings

Example:



Note: The Door Control can not be defaulted while enrolled onto the network controller. The Door Control must first be disabled using the windows software.

If the Door Control is enrolled onto the Network Controller then the Default Engineer code will be set by the windows Software.

If Engineer Code is lost, Ensure the Door Control is disabled using the windows software, then remove the Security Caps (see page 5) and hold down the X key during power-up and enter the default Engineer Code '6666' immediately. This will restore the factory settings.



## Restoring Factory Settings - Wi-Prox

Step	Description
1	Present Programming Card 2 Times
2	Present Any Card Once

Note: Add a programming card to the Wi-Prox Door Control. The Door Control must be disabled first if it has been enrolled onto a Network Controller. Follow the below method to add a programming card to the Door Control.

## Adding a Programming Card

Step	Description
1	Remove security caps and power down unit.
2	Power up unit and Present Any Card 2 times immediately. This card is now the Programming Card for the unit. Refit security caps

## Factory Default PIN codes

The following PIN codes are the Factory Default Settings:

- The Default Engineer code is '6666'
- User PIN '1111'

Note: The User PIN '1111' is deactivated when the Door Control is enrolled onto the Network Controller.



When Surface Mounting the Door Control a Surface Mount Collar is required.  
- Fix Surface Mount Collar to wall, ensure arrow is pointing upwards

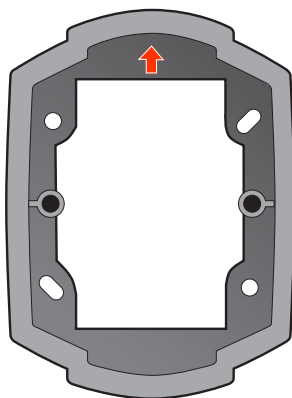

### Surface Mounting

After fixing Surface Mount Collar to wall (as above) and wiring is complete as per wiring diagrams on pages 6-11, the Door Control may then be screwed to Surface Mount Collar using security screws provided. Both Security Caps are then clipped onto the Door Control.

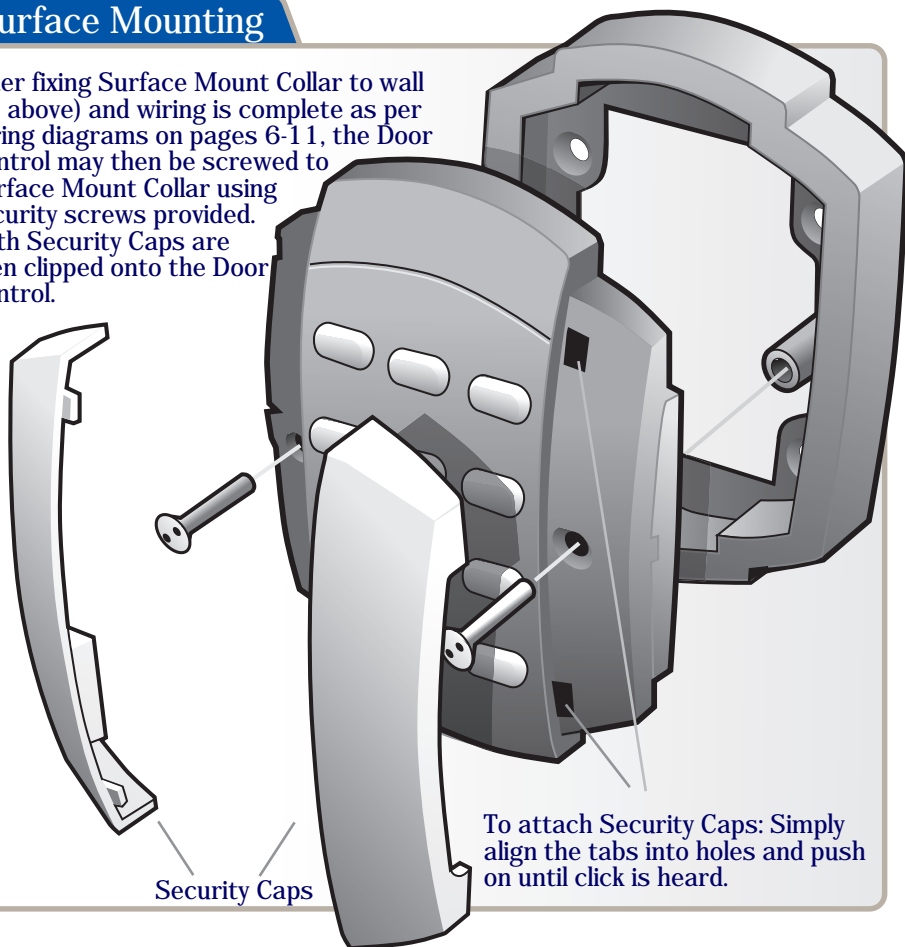

To attach Security Caps: Simply align the tabs into holes and push on until click is heard.

Security Caps



### Flush Mounting

Door Control is mounted to electrical pattress box using security screws provided. Both Security Caps are then clipped onto Door Control.

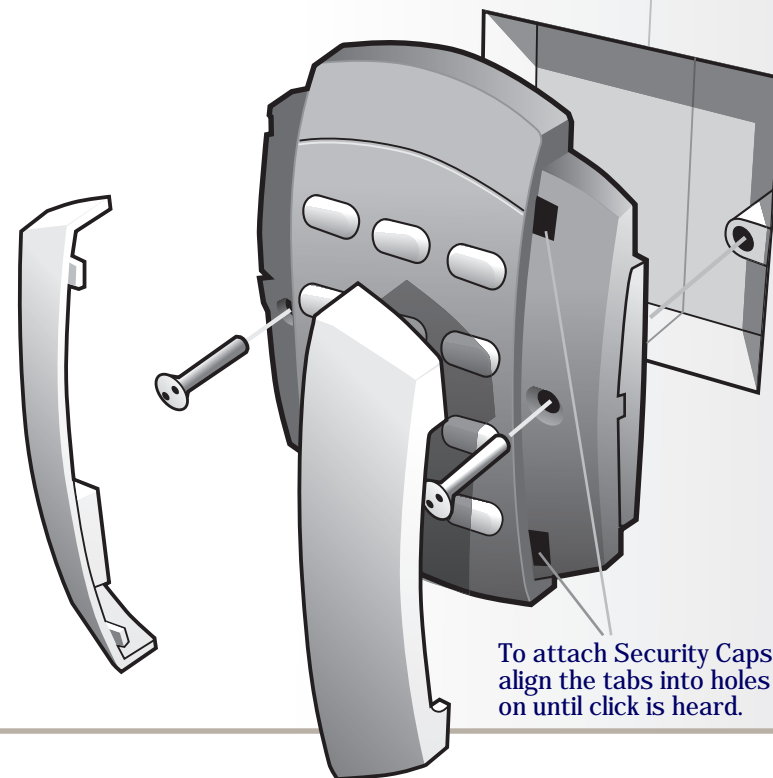

To attach Security Caps: Simply align the tabs into holes and push on until click is heard.

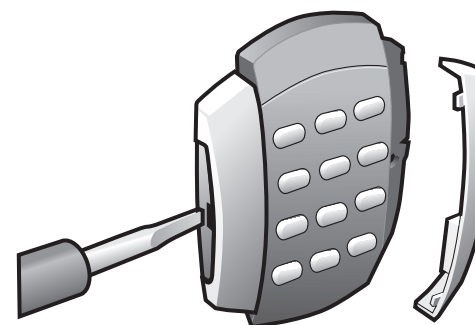

To release Security Caps push a screwdriver into slots on the side and pull forward.



## Wiring Diagrams with External Reader Function

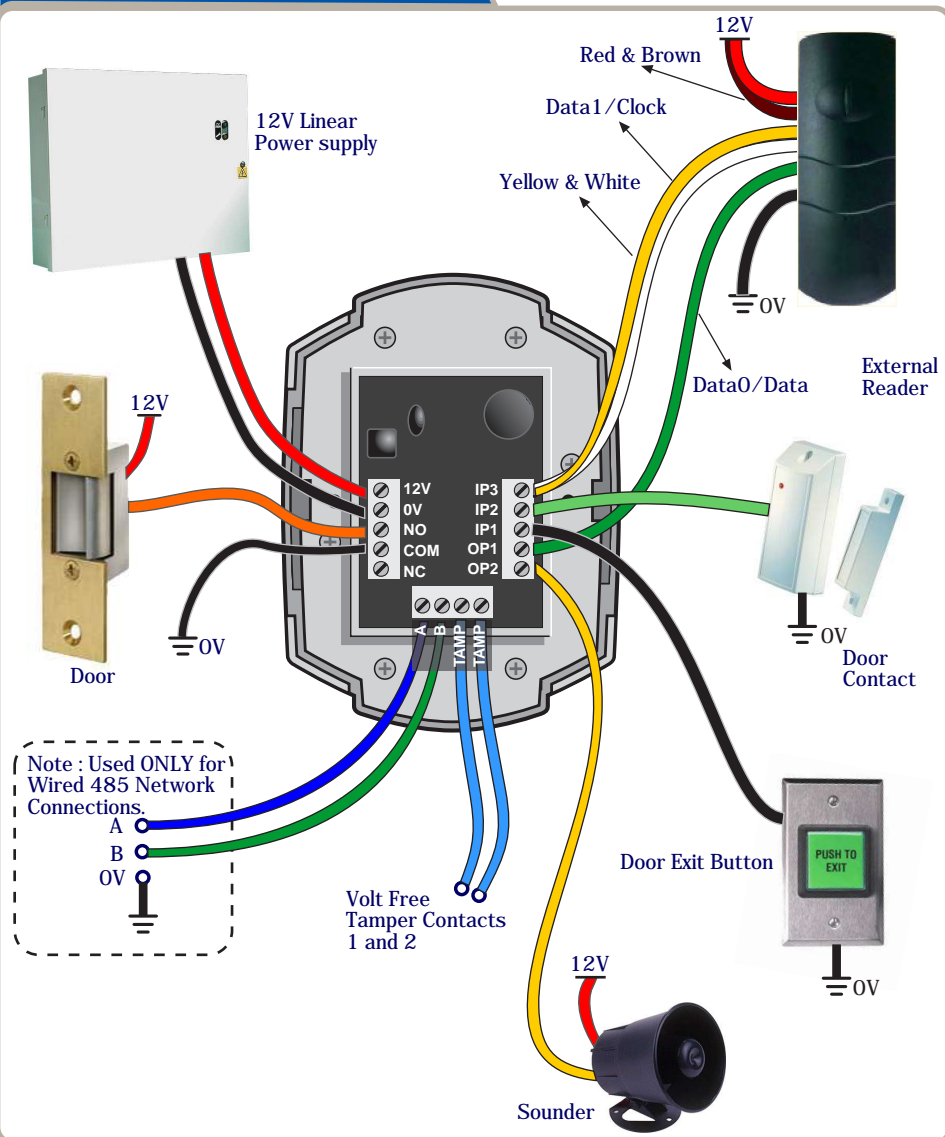

## Wiring Diagrams with External IP3 Function

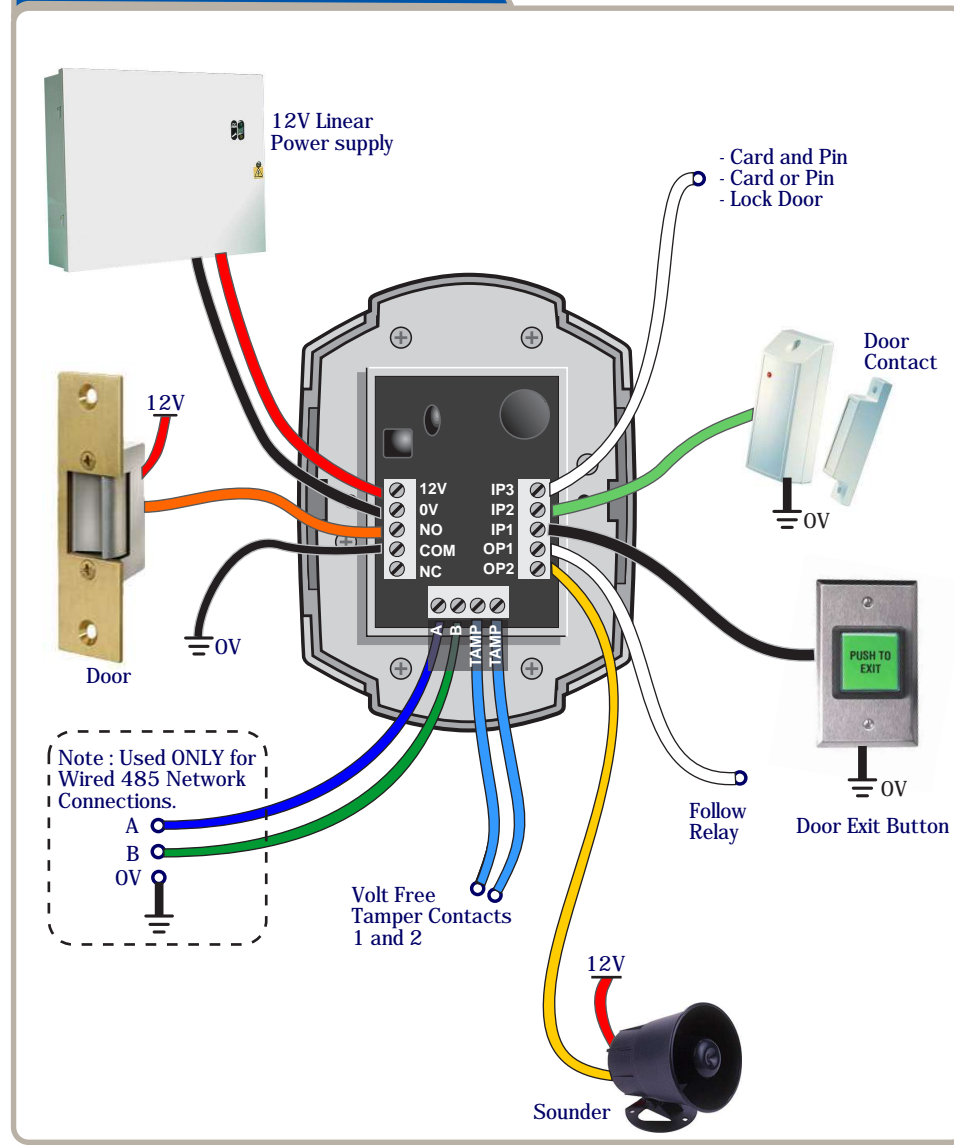



## Wiring Diagrams with Alarm Panel Connections

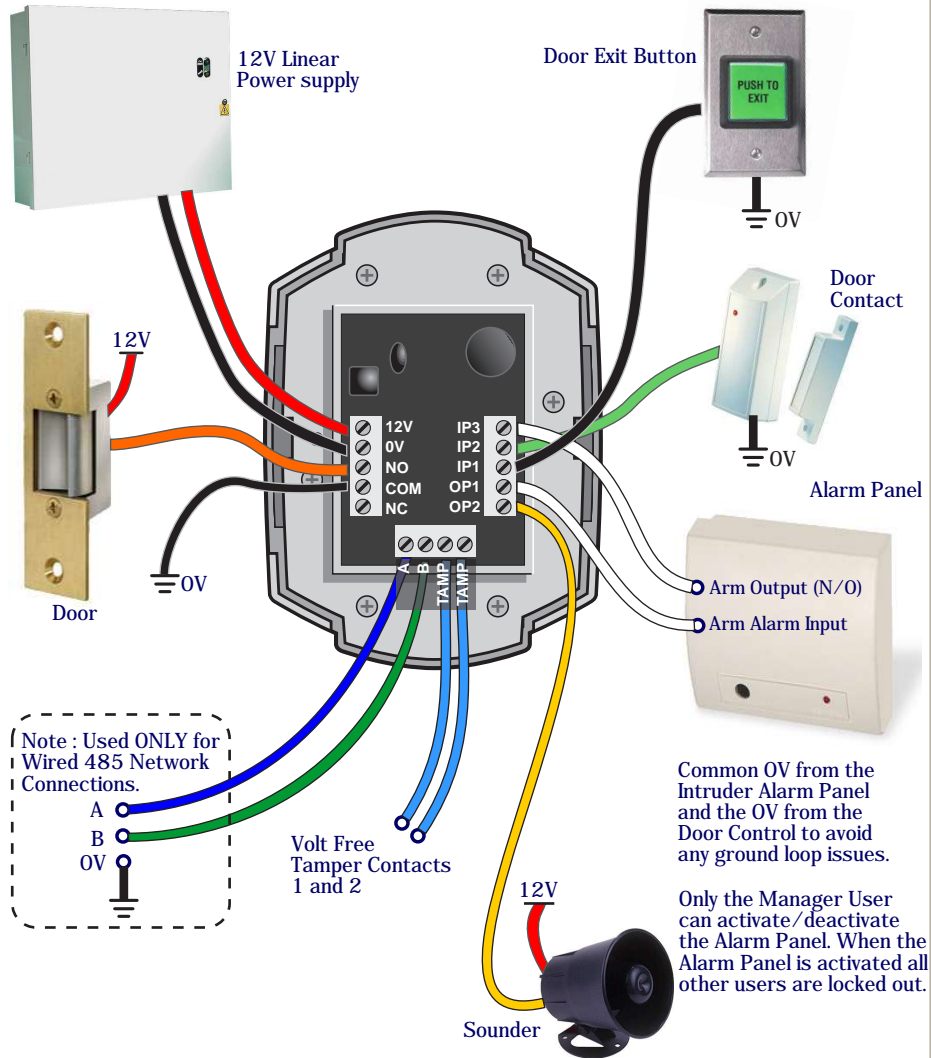

## Wiring Diagrams with Interlock connections

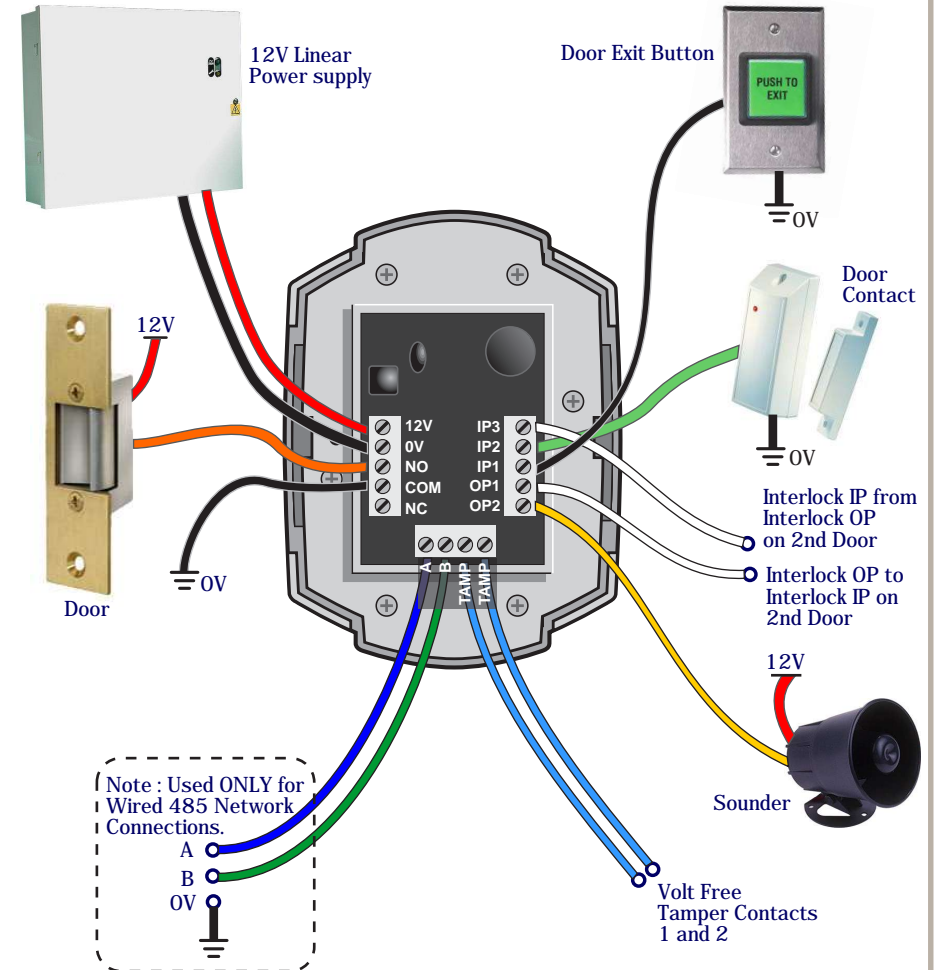





## Wiring Diagrams with Fire Alarm Override

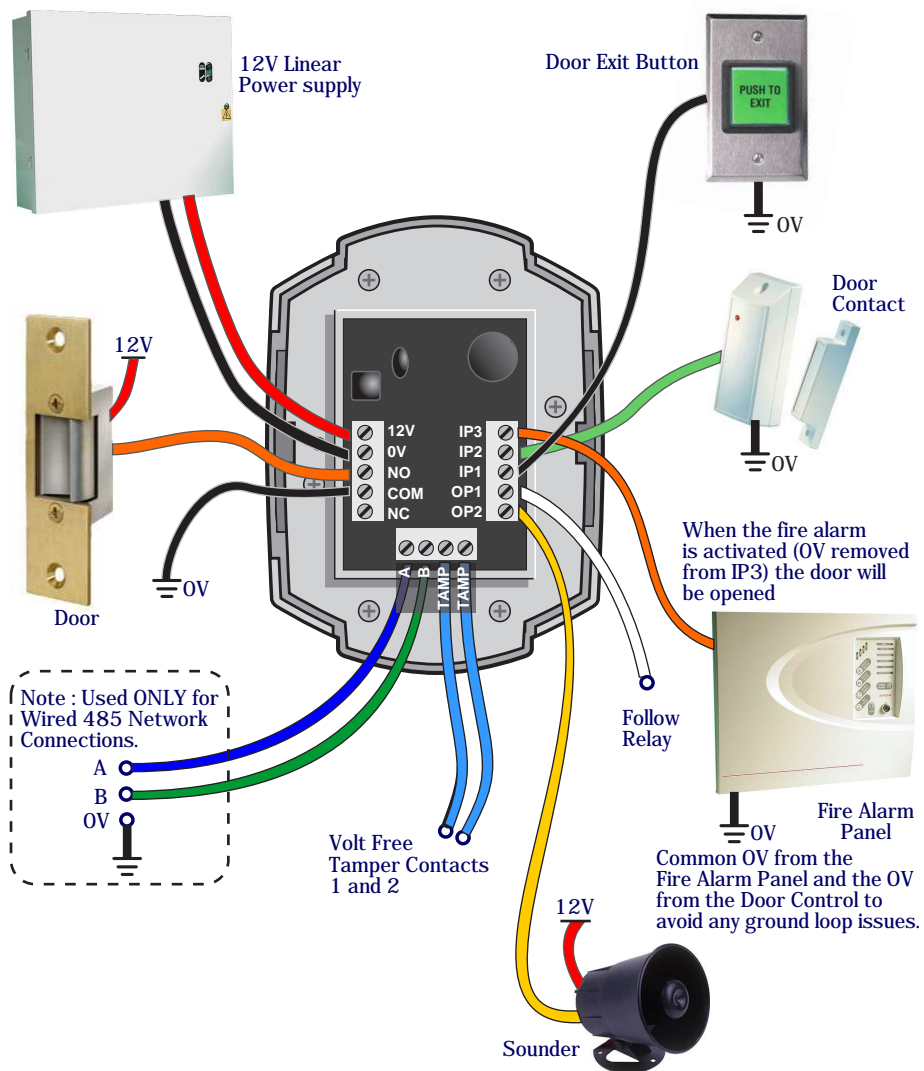

## Wiring Diagrams with Interlock connections

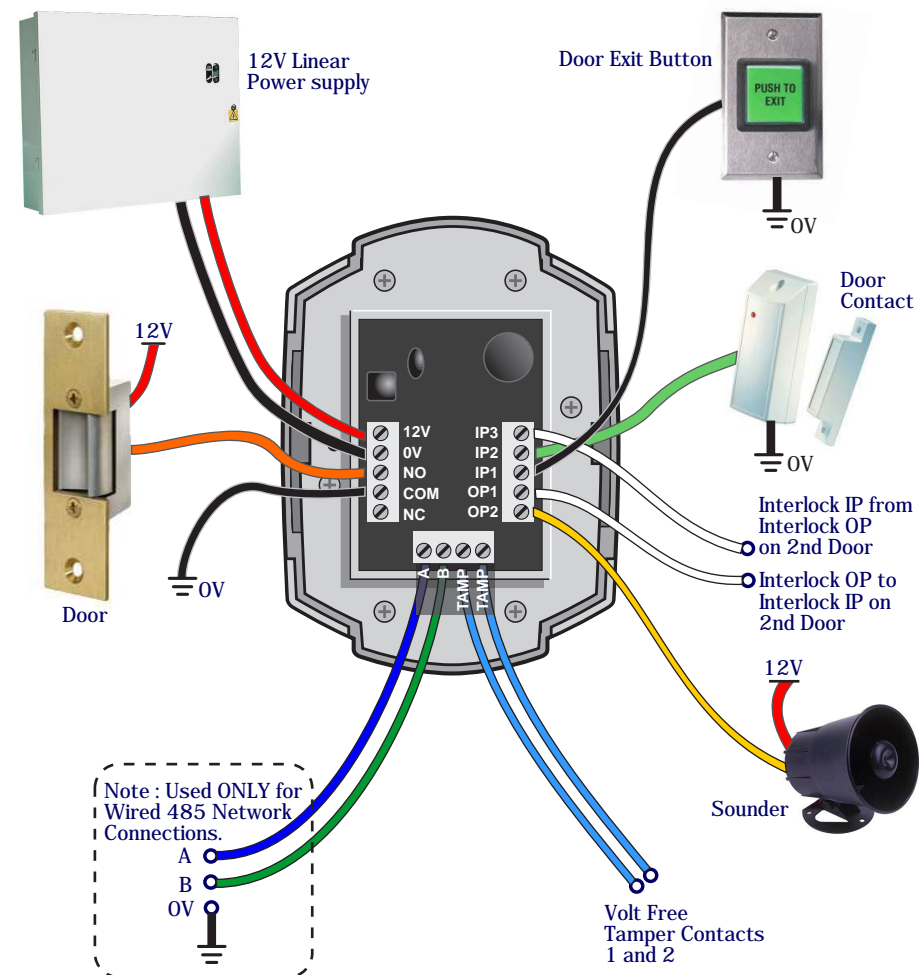



## Adding Door Controls

Step	Description
1	Click the Doors Icon on the left hand toolbar on the PC application
2	Click 'Add New Door'
3	The Door is added to the Controller.
4	Configure the required Door settings : Door Timers, Alarm Options, Door Options, Timed Actions, Inputs & Outputs.
5	Click 'Save' to transmit the changes to the Controller.

Note: Placing the mouse cursor over a door feature will display a description of the feature.



## Assigning a Door Address on Wireless Network

Step	Description
1	On the Controller screen: Click 'Allow Doors to Join this Controller'
	All Door Controls that don't have an address start to beep out the next available address. The Keys will also illuminate to indicate the address. e.g Keys 1 & 5 will be ON for address number 15.
2	Hit any key on the 'beeping' Door Control to assign this address. Present a Card on the 'beeping' Proximity unit to assign this address.
	When a Door Control is assigned an address, all unassigned Door Controls will start to beep the next available address.
3	When all doors are assigned: Click 'Secure Network'

Note: While assigning door addresses, leave the Controller Screen open or the network will be Secured automatically, stopping doors from joining the network.

## Assigning a Door Address on a Wired 485 Network

Step	Description
1	Right Click on the Controller Icon & select 'Manually Assign Addresses'
	Follow Step 2 above to complete the process.

