



Disney

# SING IT

Disney  
**HIGH SCHOOL MUSICAL 3**  
SENIOR YEAR

EVERYONE  
**E**  
CONTENT RATED BY  
ESRB



## **⚠️ WARNING: PHOTOSENSITIVITY/EPILEPSY/SEIZURES**

A very small percentage of individuals may experience epileptic seizures or blackouts when exposed to certain light patterns or flashing lights. Exposure to certain patterns or backgrounds on a television screen or when playing video games may trigger epileptic seizures or blackouts in these individuals. These conditions may trigger previously undetected epileptic symptoms or seizures in persons who have no history of prior seizures or epilepsy. If you, or anyone in your family, has an epileptic condition or has had seizures of any kind, consult your physician before playing. IMMEDIATELY DISCONTINUE use and consult your physician before resuming gameplay if you or your child experience any of the following health problems or symptoms:

- dizziness
- eye or muscle twitches
- disorientation
- any involuntary movement or convulsion.
- altered vision
- loss of awareness
- seizures

RESUME GAMEPLAY ONLY ON APPROVAL OF YOUR PHYSICIAN.

### **Use and handling of video games to reduce the likelihood of a seizure**

- Use in a well-lit area and keep as far away as possible from the television screen.
- Avoid large screen televisions. Use the smallest television screen available.
- Avoid prolonged use of the PLAYSTATION®3 system. Take a 15-minute break during each hour of play.
- Avoid playing when you are tired or need sleep.

Stop using the system immediately if you experience any of the following symptoms: lightheadedness, nausea, or a sensation similar to motion sickness; discomfort or pain in the eyes, ears, hands, arms, or any other part of the body. If the condition persists, consult a doctor.

### **NOTICE:**

Use caution when using the SIXAXIS™ wireless controller motion sensor function. When using the SIXAXIS™ wireless controller motion sensor function, be cautious of the following points. If the controller hits a person or object, this may cause accidental injury or damage. Before using, check that there is plenty of space around you. When using the controller, grip it firmly to make sure it cannot slip out of your hand. If using a controller that is connected to the PS3™ system with a USB cable, make sure there is enough space for the cable so that the cable will not hit a person or object. Also, take care to avoid pulling the cable out of the PS3™ system while using the controller.

### **WARNING TO OWNERS OF PROJECTION TELEVISIONS:**

Do not connect your PLAYSTATION®3 system to a projection TV without first consulting the user manual for your projection TV, unless it is of the LCD type. Otherwise, it may permanently damage your TV screen.

### **HANDLING YOUR PLAYSTATION®3 FORMAT DISC:**

• Do not bend it, crush it or submerge it in liquids. • Do not leave it in direct sunlight or near a radiator or other source of heat. • Be sure to take an occasional rest break during extended play. • Keep this disc clean. Always hold the disc by the edges and keep it in its protective case when not in use. Clean the disc with a lint-free, soft, dry cloth, wiping in straight lines from center to outer edge. Never use solvents or abrasive cleaners.



## **TABLE OF CONTENTS**

<b>CONTROLS</b> .....	<b>4</b>
<b>DISNEY SING IT BASICS</b> .....	<b>5</b>
<b>QUICK PLAY</b> .....	<b>6</b>
<b>SINGLE PLAYER</b> .....	<b>6</b>
<b>MULTIPLAYER</b> .....	<b>8</b>
<b>PERSONALIZE</b> .....	<b>9</b>
<b>TIPS</b> .....	<b>9</b>
<b>CUSTOMER SUPPORT</b> .....	<b>12</b>
<b>LIMITED WARRANTY</b> .....	<b>13</b>

## PLAYSTATION®3 system front

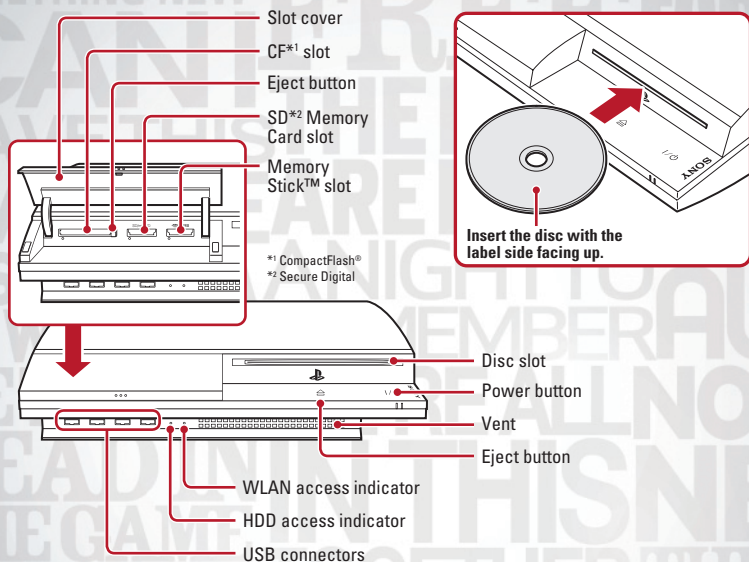

**Note:** Some models of the PLAYSTATION®3 system do not include media slots. For specific features included, refer to the instructions for use of your model of the PLAYSTATION®3 system.

**Starting a game:** Before use, carefully read the instructions supplied with the PLAYSTATION®3 computer entertainment system. The documentation contains information on setting up and using your system as well as important safety information.

Check that the MAIN POWER switch (located on the system rear) is turned on. Insert the DISNEY SING IT: HIGH SCHOOL MUSICAL 3: SENIOR YEAR disc with the label facing up into the disc slot. Select the icon for the software title under [Game] in the PLAYSTATION®3 system's home menu, and then press the  $\otimes$  button. Refer to this manual for information on using the software.

**Quitting a game:** During gameplay, press and hold down the PS button on the wireless controller for at least 2 seconds. Then select "Quit Game" from the screen that is displayed.

**Hint** To remove a disc, touch the eject button after quitting the game.

## Using the SIXAXIS™ wireless controller (for PLAYSTATION®3)

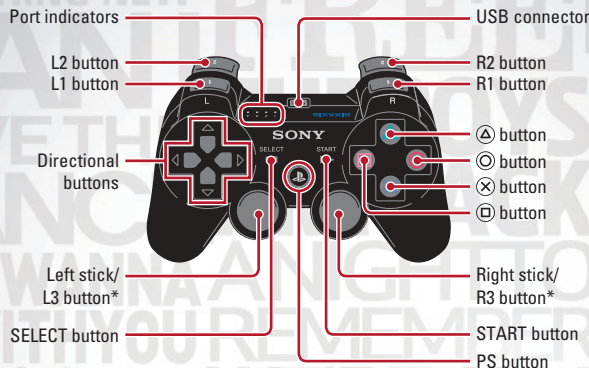

\* The L3 and R3 buttons function when the sticks are pressed.

**Note:** To use the controller, you must first register or "pair" the controller with the PLAYSTATION®3 system and assign a number to the controller. For details, refer to the instructions supplied with the system.

### Saved data for PLAYSTATION®3 format software

Saved data for PLAYSTATION®3 format software is saved on the system's hard disk. The data is displayed under "Saved Game Utility" in the Game menu.

**Notice:** *Disney Sing It: High School Musical 3: Senior Year* can be used with either the SingStar® microphone or the Logitech USB microphone. If both are used, only the SingStar® microphone will be recognized.

Use the directional pad or left stick to move through menus, **X button** to accept a selection, and **△ button** to move back or return to previous screens.

The diagram to the right shows the default settings for the controller.

## Basic Controls

**←→** or **↑↓** **directional buttons** – Navigate menus

**X button** – Accept / Advance to next screen

**△ button** – Back / Return to previous screen

**START button** – Start game

## Microphone

Your microphone must be plugged in at all times while playing the game. Microphone input is indicated with an icon on the Song Selection and Options menus. Some multiplayer options become available when two microphones are connected. Choose Mic Volume from the Options menu to adjust volume levels for each microphone.

Connecting your microphone to the PLAYSTATION®3 is a snap:

1. Make sure the power is switched OFF.
2. Attach your microphone's USB connector to one of the USB connections on the back of your PLAYSTATION®3.
3. Turn the power ON.
4. Load *Disney Sing It: High School Musical 3: Senior Year*.
5. Sing!



## Song Selection

Once you decide which kind of game you want to play, choose any song to start the show!

- Scroll through the music videos to see and hear a preview.
- Decide if you want to sing part of the song or the whole song and choose your difficulty level.
- In multiplayer modes, each singer chooses his or her own difficulty level and everyone can sing together.

## Pitch Detection Bar

Follow along as the pitch bar and lyrics cross the screen to guide your tune. Keep the pitch indicator on the bars for the best performance! When there are two singers, player one is always at the bottom and pitch bars and lyrics are color-coded green for Player 1 and purple for Player 2.

## Options

From the Options menu you can load or save your profile, adjust your microphone settings, view credits, and adjust camera settings.

## Multipliers

Hit all the notes on one screen to earn double points. Sing three screens flawlessly to earn triple points and five screens for quadruple points! Missing a note will end your winning streak and you'll lose your multipliers.

## QUICK PLAY



Time to sing! Select Quick Play at the main menu to go straight to singing.

- Choose Solo to start a solo performance, Versus to sing against a friend or Duet to sing cooperatively.
- Pick a song and difficulty level and click the button on the screen to start belting it out.

## SINGLE PLAYER



In Single Player mode you can take singing lessons in *Sing It Pro* or test your skills in *You're on Your Own!* Be the star of your own live concert in *Gig Mode!*

## Sing It Pro

Singing lessons are fun with your own personal voice coach. In *Sing It Pro* you can perfect your singing voice while practicing pitch, accuracy and breathing techniques.



- First, listen to a portion of a song and sing it accurately to move on to the next song in the lesson. Get them both right and move on to the next lesson.
- Then, use the skills you've learned to earn excellent scores in real challenges.
- Go back to *Sing It Pro* anytime to master songs or brush up on your skills.

## You're on Your Own!

Are you up to the challenge? Choose a song you know well enough to sing without lyrics, score or pitch marks to guide you. Your score will be displayed at the end of the song.

## Gig Mode

Put on a live concert!

- Create and arrange your own personal set list of up to five songs to perform. Rock it out!
- At the end of your gig your final score is averaged from all the songs you've played.

Gig Mode can also be selected from multiplayer options.

## MULTIPLAYER



It's fun to play *Disney Sing It: High School Musical 3: Senior Year* with your friends. Sing together in Duet mode, battle against each other in a Versus tournament, play together in Team Play or perform a concert in Gig Mode.

- When there are two singers, player one is always at the bottom and pitch bars and lyrics are color-coded green for Player 1 and purple for Player 2.
- Players choose their own individual difficulty level so everyone can play together.
- Some multiplayer options become available when two microphones are connected.

### Duet / Versus

Sing any of the songs together in Duet mode to create beautiful harmonies. Play against a friend in a Versus competition.

### Team Play

Work together as a team singing Duets or competing in Versus tournaments.

- Choose a team name from the list and start singing.
- You can sing alone or as part of a duet. Up to eight players can join party mode.
- Save team profiles to keep track of wins and scores and the team's *Most Valuable Player*.

### Gig Mode

Time to put on a show! You and a friend can perform a concert together by singing a duet of up to five songs consecutively.

- Choose which songs you want to sing together or leave it to fate and choose *Random*.
- The player with the highest average score for all songs performed is *The Star of the Show*.

## PERSONALIZE

From here you can choose your background theme and check out high scores.

### Choose Theme

Customize the look of your game the way you prefer by choosing from three High School Musical themes.

## TIPS

Use *Quick Play* to get straight to singing! Create a Solo or Duet performance or enter into Versus mode with a friend.

Become a better singer or master a tough song in Single Player mode by taking personal singing lessons at *Sing It Pro* or by relaxing your vocal chords in *Warm Up* sessions.

After mastering a difficult song during your lessons at *Sing It Pro*, put your skills to the test in *You're on Your Own!*

Put on a live solo concert or perform a duet with a friend in *Gig Mode!* Design your own set list to sing up to five songs back-to-back!