

COVEREIGN 2400W Shredder

2948610
(Model: FD2402)

Instruction Manual



After Sales Support

UK/Ireland
Web

0345 640 0800
www.argosspares.co.uk



Important - Please read these instructions fully before starting assembly

These instructions contain important information that will help you get the best from your mower, ensuring it is assembled correctly and safely.

If you need help or have damaged or missing parts, call the Customer Helpline on 0345 640 0800.

Contents

Intended Purpose.....	3
Safety Information.....	4
Symbols Used in the Instructions.....	4
Symbols on the Shredder.....	4
General Safety.....	6
General description	12
In the Box	13
Parts.....	13
Box Contents	14
Assembly	15
Operating.....	16
Start- Up.....	16
ON/OFF Operation.....	16
Emptying the Collection Bag	16
Overload Protection.....	16
Restart Prevention	16
Usage.....	17
General Working Instructions.....	17
Clearing a Blockage.....	18
Reversing, Sharpening or Replacing the Blade.....	18
Maintenance.....	19
Maintenance and Cleaning	19
General Cleaning and Servicing.....	19
Troubleshooting	20
General Troubleshooting	20
Technical Data.....	20
Technical Data Table.....	20
Disposal.....	21
Disposal and Recycling.....	21
Getting Help	21

Intended Purpose

The shredder is intended for shredding fibrous and wood-related materials such as hedge and tree cuttings, branches, bark and pine cones.

Any use not expressly permitted in this manual may damage the shredder and pose a serious danger to the user.



Do not put stones, glass, metal, bones, plastics or fabrics into the shredder.

The operator or user is responsible for accidents and injury or damage to third parties.



The manufacturer will not be held responsible for any damage caused by improper operation or use outside of intended usage..

Safety Information

Important - Please read these instructions fully before starting assembly

-  This shredder may cause serious injuries if improperly used.
-  Before using the shredder, read the user manual carefully and familiarise yourself with all of the controls. In cases of uncertainty, ask an expert for advice. Keep the manual in a safe place and pass it on to any subsequent owner to ensure that the information contained therein is available at all times.

Symbols used in the instructions

-  Hazard symbols with information on prevention of personal injury and property damage.
-  Precaution symbol (other symbol may be used instead of exclamation mark) with information on prevention of harm / damage.
-  Notice symbol with information on how to handle the device properly.

Symbols on the shredder

-  Warning!
-  Read the manual.
-  Wear ear and eye protection.
-  Wear hand protection.



Safety Information

Important - Please read these instructions fully before starting assembly

Symbols on the shredder (continued)



Do not expose the unit to rain.



Caution! Switch off the motor and disconnect from the mains before adjustment or cleaning work, or if the cable is caught or has been damaged.



Warning! Risk of injury by rotating blade!



Danger-Rotating blades. Keep hands and feet out of openings while machine is running.



Warning! Danger from thrown objects.



Keep your distance from the feeder and ejection area, and keep others away from the danger area.



Caution!

Moving blade



Warning! Electric shock hazard.



Always unplug the shredder before working on it.



Guaranteed noise power level



Safety Information

Important - Please read these instructions fully before starting assembly

Symbols on the shredder (continued)



Do not dispose of electrical equipment in the domestic waste.



The equipment is intended only for use in premises in which the current bearing capacity of the network is ≥ 100 A per phase and which are supplied by a distribution grid with a nominal voltage of 230/240V.



Safety class II

IP24 Protection against contact with the fingers and solid foreign bodies with $\varnothing > 12$ mm as well as protection against splashed water from all directions.



The product complies with the applicable European directives and an evaluation method of conformity for these directives was done.

General Safety



IMPORTANT! Read carefully before use and keep for future reference

- The device must not be used by people (including children) with limited physical, sensory or mental faculties or who lack the necessary experience and/or knowledge - unless they are supervised by a person responsible for safety or are being instructed to operate the shredder by such a person.
- Keep children and pets at a safe distance away from the device. Children must be supervised in order to ensure that they do not play with the equipment.



Safety Information

Important - Please read these instructions fully before starting assembly

General Safety (continued)

- Never allow children or other persons unfamiliar with the user manual to use the shredder. Local regulations or bylaws may determine the minimum age for using the shredder.



Observe noise control and local regulations.



CAUTION! When using power tools, observe the following basic safety measures for the prevention of electric shocks and the risk of injury and fire:

Preparation

Training Become familiar with the instruction manual before attempting to operate this equipment.

- Never use the shredder with other persons or animals nearby.
- Wear hearing and eye protection at all times when using the shredder.
- Wear appropriate protective clothing such as protective gloves, firm footwear and long trousers. Do not wear loosely fitting clothes or clothes with dangling cords or belts.
- Only use the shredder in the open (that is, away from walls or other rigid structures) on a firm, level surface.
- Do not use the machine on a paved, gravelled area, which could be damaged by ejected material.
- Before you start up the shredder, check that all of the nuts, bolts and other fastenings are tight. Covers and shields must be fastened properly and in good working order. Replace any damaged or illegible stickers.



Safety Information

Important - Please read these instructions fully before starting assembly

General Safety (continued)

- Only use replacement parts and accessories supplied and recommended by the manufacturer. Using third-party parts will immediately invalidate the guarantee.
- Do not leave the shredder working unattended and keep it in a dry place out of children's reach.
- While being used in the open, connect the shredder to a residual current (RC) circuit breaker with a trip current of not more than 30 mA.
- When servicing the cutting means be aware that, even though the power source will not start due to the interlock feature of the guard, the cutting means can still be moved by a manual starting mechanism.
- Shut-off the power unit before attaching or removing the bag.
- Keep all guards and deflectors in place and in good working condition.

Working with the device

- Make sure that the funnel feeder is empty before you start the shredder.
- Keep your head, hair and body away from the intake opening.
- Do not reach into the funnel feeder during operation. The shredder will continue to run for a short period after you switch it off.
- Always make sure you are standing in a firm, balanced position. Do not lean forwards, and never lean over the shredder when inserting materials.



Safety Information

Important - Please read these instructions fully before starting assembly

General Safety (continued)

- Make sure that the material inserted into the shredder does not contain hard objects made of metal, stone, glass or similar.
- Do not use the shredder in the rain and in bad weather. Work in daylight or under good lighting conditions.
- Do not operate the shredder when you are tired or distracted, or under the influence of alcohol or medication. Always take a break when you need one and be sensible about how you work.
- Switch the shredder off and pull the plug under the following circumstances:
 - when you are not using the device,
 - transporting it or leaving it unattended;
 - before releasing a jammed blade.
 - when you are checking the device, cleaning it or removing blockages;
 - when you are carrying out cleaning or maintenance work or replacing accessories;
 - Before moving or lifting the shredderIf foreign objects should enter the shredder, if the shredder is making unfamiliar noises or vibrations (check the shredder for damage before starting it up again)
- Do not allow shredded material to accumulate near the ejection area. This may otherwise hinder proper ejection and force the material back up through the feeder.
- Do not transport or tip the shredder with the motor running.



Safety Information

Important - Please read these instructions fully before starting assembly

General Safety (continued)

- Keep hands, other body parts and clothing out of the filling chamber and ejection channel and away from other moving parts.
- In the event of blockages in the machine intake or ejection, switch off the motor and disconnect the machine from the mains before removing leftover material in the intake opening or ejection channel. Ensure that the motor is free of rubbish and other accumulations in order to safeguard the motor from damage or possible fire.
- Remember that the cutting tool is also activated when the starting mechanism is started on a motor operated machine.



CAUTION! The following states how damage to the trimmer and possible injury to people can be avoided:

- Handle the unit with care. Clean the ventilation slits regularly; keep to the maintenance instructions.
- Do not overload your device. Work only within the indicated range of performance. Do not employ any low power machines for heavy work. Do not use your device for purposes for which it has not been designed.
- Only switch the shredder off once the funnel feeder is completely empty since the shredder may otherwise clog up and not be able to start afterwards.
- Do not attempt to repair the shredder yourself unless you are qualified to do so. Any work not specified in this manual may only be carried out by a qualified service centre.



Safety Information

Important - Please read these instructions fully before starting assembly

General Safety (continued)

Electrical safety



CAUTION! The following states how to avoid accidents and injuries due to electric shock:

- Damaged cables, coupling and plugs or connecting leads not corresponding to specifications, must not be employed. Remove the plug immediately from the plug socket in case of damage to the mains cable.

Do not touch the mains power supply cable under any circumstances until you have pulled the plug out of the mains socket.

- If the power cable for this equipment is damaged, it must be replaced by the manufacturer, a customer service agent of the same or a similarly qualified person in order to prevent hazards.
- Do not use the appliance if the on/off switch does not work properly. Always have a damaged switch repaired by our a qualified technician.
- Only use extension cables that have been approved for outdoor use and are resistant to splash water. The core diameter for extension cables measuring up to 25 m must be at least 1.5 mm², and 2.5 mm² for cables longer than 25m. Always roll the whole cable off the reel before use. Check the cable for damage.
- Do not unplug the shredder pulling on the cable, only pull the plug itself. Keep the cable away from heat, oil and sharp edges.



Safety Information

Important - Please read these instructions fully before starting assembly

General Description

Functional description

The shredder has a powerful electric motor with overload protection. Cutting is performed by a system of fast rotating.

Refer to the following descriptions for a functional description of the various components and controls.

In the Box

Parts

- | | | | |
|-------------|------------------|---------------------|------------------|
| 1 Hopper | 4 Collection bag | 7 Mains lead | 10 On/Off switch |
| 2 Pusher | 5 Wheel | 8 Reset button | 11 Handle |
| 3 Bag mount | 6 Chassis | 9 Housing interlock | |

1

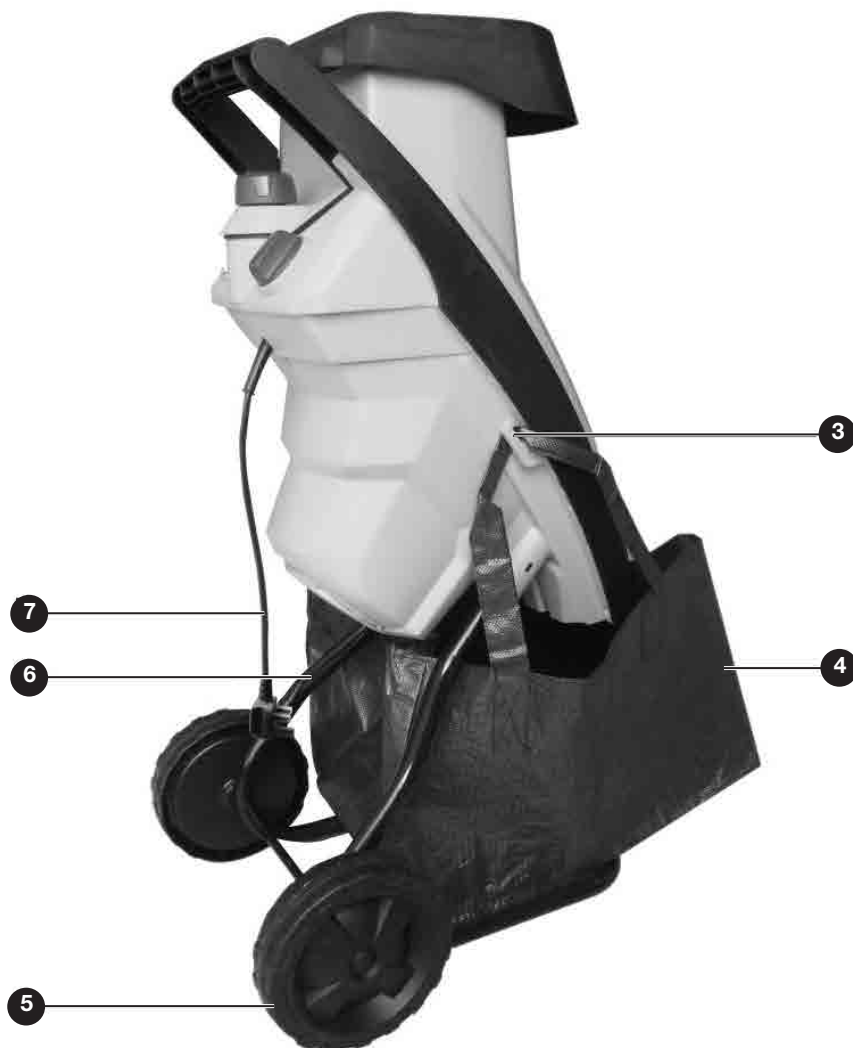
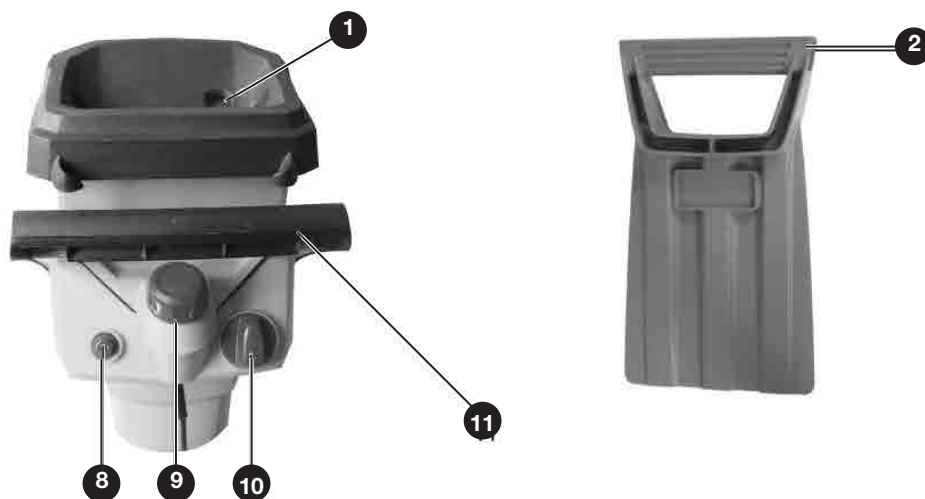

In the Box

Box Contents

- Operating and safety instructions
- Shredder
- Chassis
- Collection bag
- Two wheels, wheel covers, and mounting materials.
- Allen wrench
- Pusher

Assembly

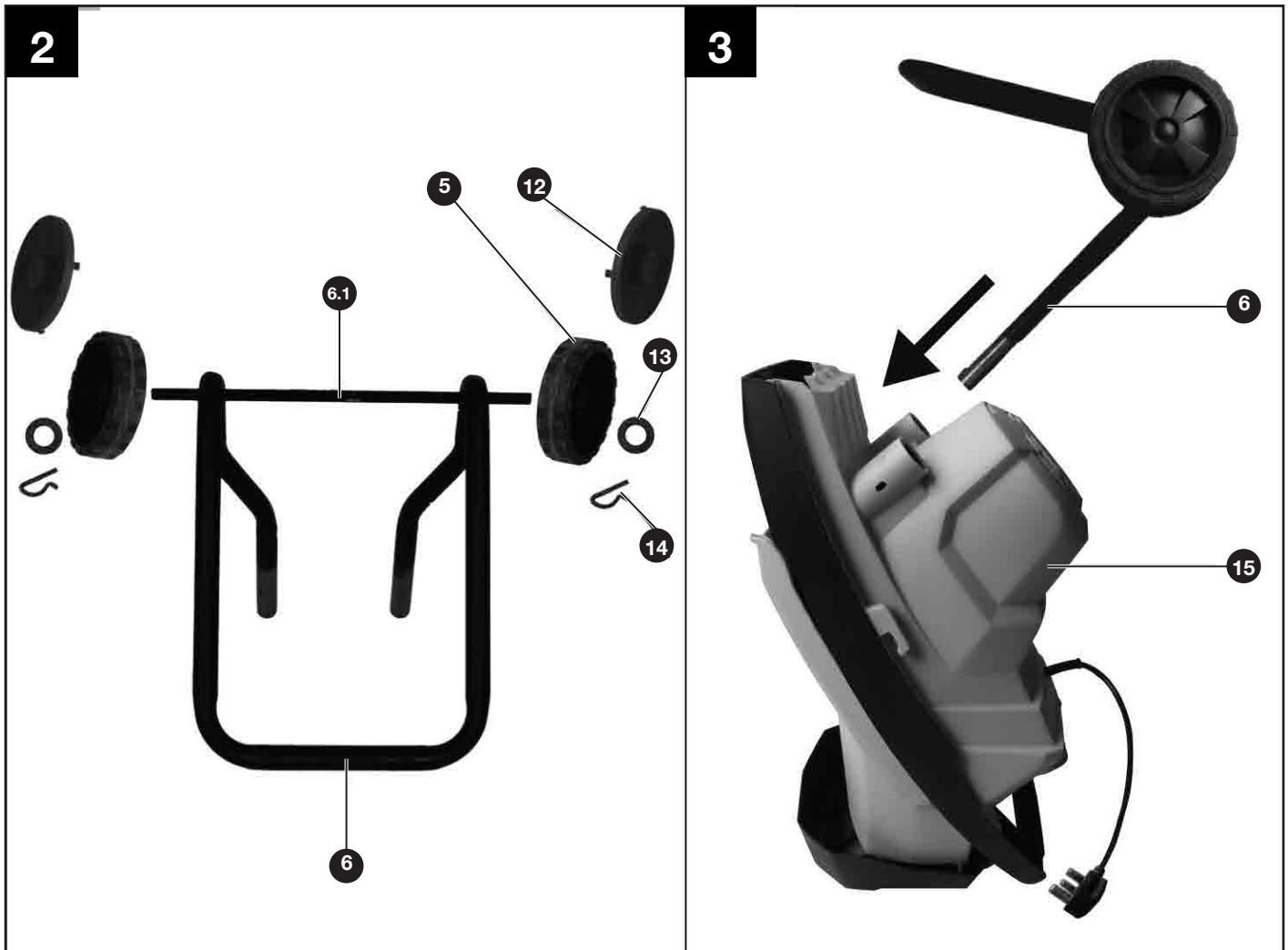

- Slide the axle **6.1** into the chassis **6**.
- Mount the two wheels **5** onto the chassis **6**.
- Slide the two wheels **5** onto the chassis axle **6**. Slip the washers **13** onto the axle and push the split pins **14** through the appropriate holes in the axle.
- Clip the wheel covers **12** onto the wheels.
- Rest the shredder **15** on the hopper **1** (upside down). Push the wheel chassis **6** into the 2 holes in the plastic housing of shredder. Secure with the 2 screws provided.

Operation

Start- up



Check that the mains voltage matches the rating on the name plate.

Hook the collection bag **4** into the bag mounts **3**.

ON/OFF Operation

If your shredder is fitted with a long mains cable, plug it directly into the mains supply, using an RCD device if necessary.

Connect the extension cable.

Make sure that the funnel feeder is empty.

- Set the On/Off switch **10** to “ON” to turn on the unit. Feed the material to be shredded into the opening of the hopper. The material is drawn in and shredded.
- Set the On/Off switch **10** back to “OFF” to turn off the unit. The shredder will continue to run for a few seconds after switching off.

Emptying the Collection Bag



Avoid filling the collection bag too much. Mind that the bag will fill unevenly under the discharge duct!

- Turn off the unit.
- Remove and empty the collection bag **4**.

Overload Protection

In the event of overload, e.g. due to branches that are too thick, the equipment automatically switches off.

To restart the unit, wait a few minutes for the motor to cool down, press the Reset button **8**, then turn on the unit.

Restart Prevention

The unit will not automatically restart when the power returns after a power cut. To restart the unit, turn the on/off switch to “off” then back to “on”.

Usage

General Working Instructions



Keep your body at a safe enough distance from the shredder as long branches may be spun round while being drawn into the shredder.



Wear ear and eye protection.



Wear hand protection.

- When feeding branches into the unit, keep holding them firmly until they are automatically drawn in.
- Adapt to the speed of the shredder and avoid overloading the unit.
- To avoid the unit clogging up, mix freshly cut branches or leafy material with drier materials such as twigs
- To prevent the blades from becoming blunt quickly, remove mud and stones from the roots before shredding.
- Do not shred but directly compost all soft and wet material such as kitchen waste.
- Keep a couple of dry branches to use them for cleaning the unit at the end.
- Do not turn off the unit until all the material has passed the blades. Remaining material may otherwise block the blade when you restart the unit.

Usage

Clearing a Blockage

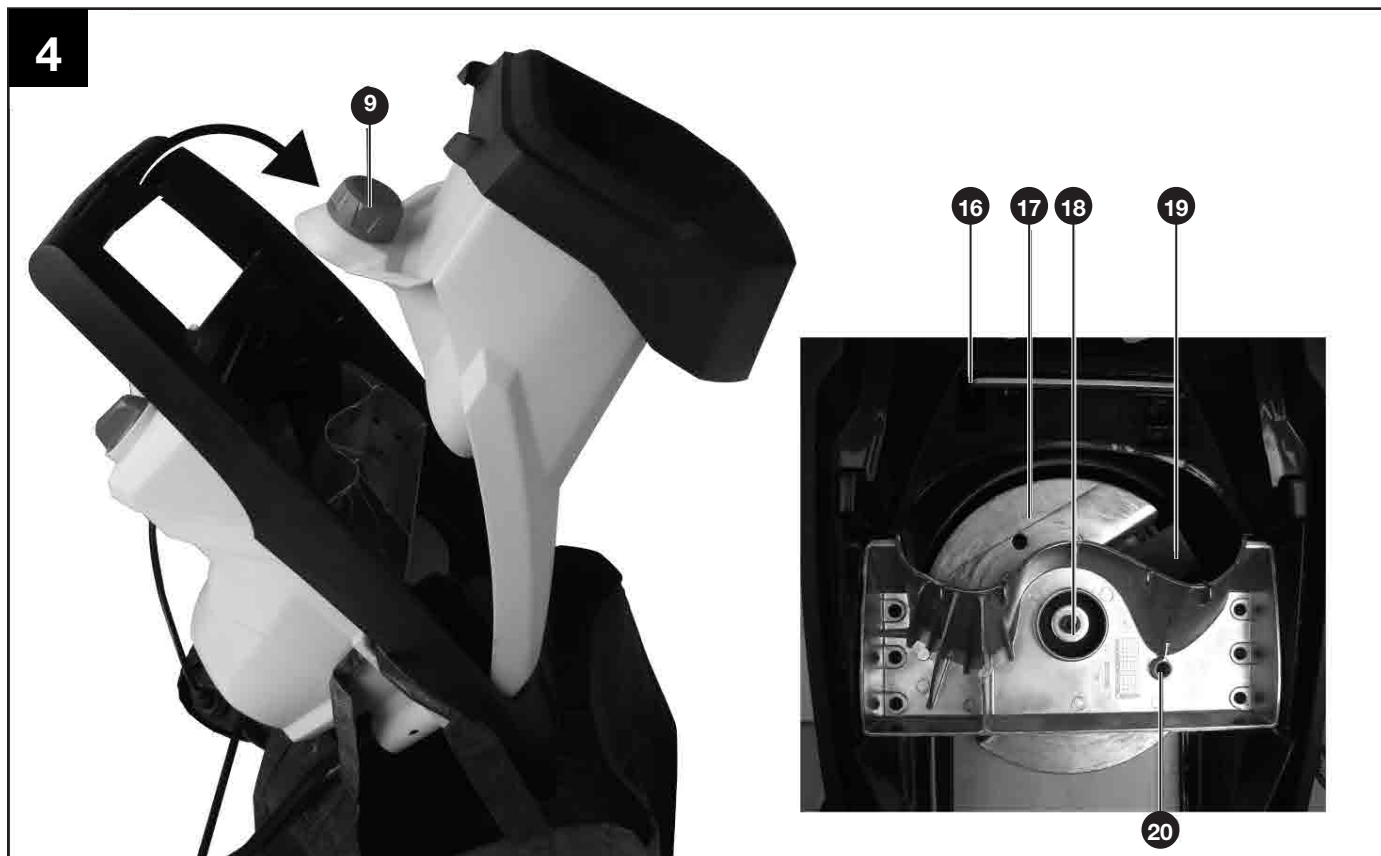

Clearing a blockage



Before starting to service or clean the unit, turn off the unit, disconnect the power plug, and wait until the blade comes to a standstill.

- Check that the power plug is removed from the mains supply.
- Unscrew the housing interlock **9**.
- Tip forward the front part of the shredder housing. You can remove it completely and put it aside.
- You now have full access to the blades **19**.
- Remove the blockage.

Reversing, sharpening or replacing the blade



Before starting to service or clean the unit, turn off the unit, disconnect the power plug, and wait until the blade comes to a standstill. Take care.

- Check that the power plug is removed from the mains supply.
- Unscrew the housing interlock **9**.
- Tip forward the front part of the shredder housing. You can remove it completely and put it aside.
- You now have full access to the blade **19**.

Usage

Reversing, Sharpening, Replacing the Blade

- Use a screwdriver to block the blade plate **17**. Slot the screwdriver into the access hole **20** and carefully turn the blade plate **17** until one of the two blocking apertures appears. Now block the blade plate **17** by slotting the screwdriver right through it.
- Use the allen key **16**, that you will find in the recess in the housing of the shredder after you have removed the hopper housing, to loosen the allen bolt **18** in the centre of the blade plate **17**. Remove the blade **19** from its seat.
- The blade can be reversed, otherwise sharpen or replace any blunt or damaged blade as necessary.
- Refit the blade onto the blade plate ensuring it is seated in its correct position. Refit the washer and allen bolt and tighten securely.
- Refit the the hopper housing onto the shredder housing securely. The bottom of the hopper housing should be hooked into the main housing for a correct fit. Ensure the interlock retainer is tightened. The machine may not start if the housing has not been correctly fitted.

Maintenance

Maintenance and Cleaning



Leave all work not described in this manual to an authorised customer service centre. Only use original parts.



Wear hand protection when working on the blade.



Before starting to service or clean the unit, turn off the unit, pull the power plug, and wait until the blade stands still. Risk of injury from electric shock, fire and rotating blades.

General Cleaning and Servicing



Do not spray water onto the shredder. Electric shock hazard.

- Always keep the shredder, wheels and air vents clean. Use a brush or cloth to clean it, avoid cleaners and solvents.
- Always check that the shredder and especially the guards are not worn down or damaged but firmly attached before use.
- Check that the nuts, bolts and screws are tight.
- Check the covers and guards for damage and improper attachment. If necessary, change the components.
- Keep the shredder in a dry place out of children's reach. Do not cover the shredder in nylon bags, as moisture may develop.

Troubleshooting

General Troubleshooting

The following table provides solutions to common problems encountered with the shredder.

Fault	Possible Cause	Solution
Motor will not start	No mains power supply	Check the socket, cable, lead and plug for damage, and if necessary, have any damage repaired by qualified repair personnel.
	Overload protection tripped	Wait until the motor has cooled down, then press the Reset button and restart the unit
	Lid of housing not closed properly	Tightly screw in the housing interlock
Garden waste is not drawn in	Shredding material is too soft	Use the pusher or add dry twigs/branches
	Unit blocked	See section "Clearing a Blockage"
	Shredding material in discharge duct	Remove shredding material from discharge duct
Unit won't shred properly	Blades are blunt	Check and turn, sharpen or replace blades as necessary (see section "Sharpening, reversing, replacing the blades")

Technical Data

Technical Data Table

Specification	Value
Nominal power intake	2400W S6 40% 100s
Nominal voltage	220-240 V ~50 Hz
Safety class	II
Degree of protection	IP24
Idling speed	3940min ⁻¹
Branch thickness	max. 40 mm
Volume of collection bag	ca. 50 l
Weight	12 kg
Noise pressure level (LpA)	84 dB(A) KpA=3 dB
Noise performance level (guaranteed)	107 dB(A)

Technical Data

Technical Data Table (continued)

* The max. branch thickness that can be shredded is dependent on the type of wood and the quality of the material being cut.

For hard wood (e.g. oak/beech branches), the max. branch thickness that can be shredded is less than for soft wood (e.g. pine/spruce wood). For dry or knotted wood, the cutting thickness may also be less.

The equipment is intended only for use in premises in which the current bearing capacity of the network is ≥ 100 A per phase and which are supplied by a distribution grid with a nominal voltage of 230/240V. You may need to check with your electricity provider if in any doubt.

If in doubt, check with your local electricity provider to verify that your mains socket has enough continuous current carrying capacity for this unit.

Noise and vibration values were determined according to the standards and stipulations mentioned in the declaration of conformity.

Technical or visual modifications may be carried out during our continuous product improvement programmes. All dimensions, references and information of this instruction manual are therefore subject to change without prior notice. Legal claims, which are made on the basis of the instruction manual, cannot thus be considered as valid.

Disposal

Disposal and Recycling



Do not dispose with household waste.

Recycle products and components according to local legal requirements.

Getting Help

After sales helpline number: 0345 640 0800

Spare parts purchases: www.argosspares.co.uk