

# EXTERNAL COIN DEVICE

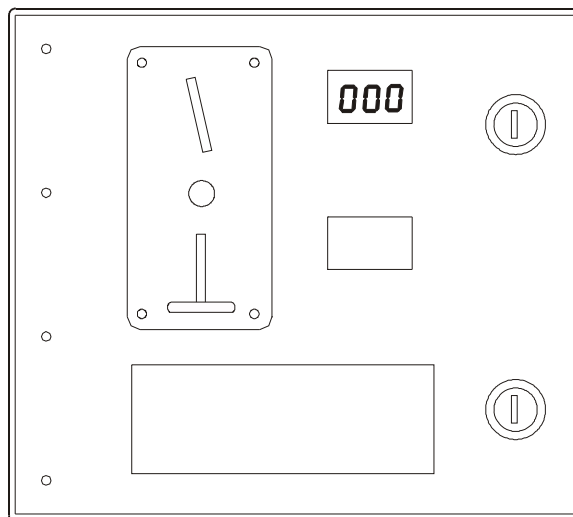

505637

**ORIGINAL INSTALLATION AND PROGRAMMING MANUAL**

**505636 E**  
**Publication date: 17 Feb 2014**



# 1. TABLE OF CONTENTS

|  |           |
|--|-----------|
| <b>1. TABLE OF CONTENTS</b> .....  | <b>3</b>  |
| <b>2. WARNINGS AND SYMBOLS</b> .....                                       | <b>4</b>  |
| 2.1. WARNINGS.....   | 4         |
| 2.2. EXTERNAL COIN DEVICE LABELS.....                                      | 4         |
| <b>3. USE OF THE EXTERNAL COIN DEVICE</b> .....                            | <b>5</b>  |
| 3.1. COIN COUNTER (INTENDED FOR WASHING MACHINE) ECD 1.....                | 5         |
| 3.2. TIMER (INTENDED FOR DRYER) ECD 2 .....                                | 5         |
| <b>4. INSTALLATION</b> .....   | <b>6</b>  |
| <b>5. ADJUSTMENTS</b> .....  | <b>7</b>  |
| 5.1. CONNECTION OF COIN SWITCHES.....                                      | 7         |
| 5.2. COIN COUNTER (WASHING MACHINE) .....                                  | 8         |
| 5.3. TIMER (DRYER).....  | 8         |
| 5.4. CONNECTION OF 6,5 kg WASHER TO EXTERNAL COIN DEVICE .....             | 9         |
| 5.6. CONNECTION OF 6/7 kg WASHER TO EXTERNAL COIN DEVICE .....             | 10        |
| 5.7. CONNECTION OF 9 kg DRYER TO EXTERNAL COIN DEVICE.....                 | 10        |
| 5.8. CONNECTION OF 6,5 kg DRYER TO EXTERNAL COIN DEVICE .....              | 10        |
| <b>6. TROUBLE SHOOTING AIDS</b> .....                                      | <b>12</b> |
| 6.1. COINS CAN'T BE INSERTED .....   | 12        |
| 6.2. LINKED APPLICANCE GETS NOT STARTED .....                              | 12        |
| 6.3. DISPLAY DOESN'T LIGHT UP OR NOT FULLY.....                            | 12        |
| <b>7. SPARE PARTS LIST</b> .....   | <b>13</b> |
| <b>8. PUTTING “OUT OF SERVICE”</b> .....                                   | <b>17</b> |
| 8.2. MACHINE DISPOSAL .....  | 17        |
| 8.2.1 POSSIBILITY OF THE MACHINE DISPOSAL BY THE SPECIALIZED COMPANY ..... | 17        |
| 8.2.2 POSSIBILITY OF THE MACHINE LIQUIDATION BY OWN POTENTIAL.....         | 17        |

## 2. WARNINGS AND SYMBOLS

### 2.1. WARNINGS

This English version is the original version of this manual. Without this version, the instructions are incomplete. Before installation, operation and maintenance of the machine read carefully the complete instructions, i.e. this "Installation and programming manual", "Installation, maintenance and user's manual", "Programming manual" and "Spare parts manual".

The Programming manual and Spare parts manual are not delivered with a machine by default.

You shall ask the supplier / manufacturer to obtain Programming manual and Spare parts manual.

Follow the instruction written in manuals and keep the manuals in a proper place by the machine for later use.

If any problems or failures occur which you do not understand, immediately contact your service man, dealer or manufacturer.

**⚠ CAUTION - IMPORTANT NOTE !!!**  
**READ THIS MANUAL CAREFULLY BEFORE USING THIS APPLIANCE. UNQUALIFIED INTERVENTION TO THIS APPLIANCE AND THE MACHINE MAY CAUSE SERIOUS BODILY INJURY AS WELL AS DAMAGE TO THE PARTS.**

**⚠ DANGER !!!**  
**ALWAYS DISCONNECT THE ELECTRICAL POWER SUPPLY BY TAKING OUT OF MAIN PLUG FROM THE WALL SOCKET AND DISCONNECT WITH THE DISCONNECTING DEVICE THE LINKED APPLIANCE BEFORE SERVICING !**  
**THIS IS YOUR PERSONAL SAFETY !**

**⚠ DANGER !!!**  
**TO ENSURE EVERYBODY'S SAFETY, OPERATIONS THAT REQUIRE THE APPLIANCE TO BE OPENED MUST BE CARRIED OUT BY QUALIFIED PERSONS WHO TAKE ALL THE NECESSARY MEASURES.**  
**AT THE END OF THESE OPERATIONS, THE APPLIANCE MUST BE RESTORED TO ITS ORIGINAL STATE.**

**⚠ DANGER !!!**  
**TO ENSURE EVERYBODY'S SAFETY, BEFORE CONNECTING THE POWER SUPPLY OF THE EXTERNAL COIN DEVICE OR/AND THE LINKED APPLIANCE LOCK ALWAYS THE DOOR OF THE EXTERNAL COIN DEVICE AND VERIFY IF THE LINKED APPLIANCE IS RESTORED TO ITS ORIGINAL STATE.**

### 2.2. EXTERNAL COIN DEVICE LABELS



Danger, read and follow written instructions.



Caution, dangerous electrical tension, electric devices

505 638

### **3. USE OF THE EXTERNAL COIN DEVICE**

- The external coin device must be ordered as timer device or as coin counter device.
- A single or double coin drop can be applied according to clients' order.
- Regularly remove the coins from the external coin device. Always disconnect the external coin device from the power supply!
- DO NOT OIL THE COIN DROP MECHANISM !

#### **3.1. COIN COUNTER (INTENDED FOR WASHING MACHINE) ECD 1**

The price to start the machine is shown on the LED display. When inserting a coin, the value of this coin is reduced from the value shown on the LED display.

When enough coins are inserted, the value reaches 0. The coin counter will give an electrical "ready to start" contact to the linked appliance.

The linked appliance will start after pushing the start button on the linked appliance control. The coin counter will reset automatically after some time or after disconnection of the power supply.

#### **3.2. TIMER (INTENDED FOR DRYER) ECD 2**

When inserting coins, the timer will give an electrical "ready to start" contact to the linked appliance and the available time is shown on the display. The linked appliance will start after pushing the start button on the linked appliance control. Time on the display is decreasing. Meanwhile new coins can be inserted and extra time will be added. When time becomes zero, the linked appliance stops.

# 4. INSTALLATION

1. Fix the external coin device securely in vertical position by four bolts on a dry place without possibility of getting wet.
2. By changes, connect the coin switches to the electronic board (fig.4., COIN VALUE 1,2, ..., +5 Volts) (See chapter 5.1.).
3. Set the DIP switch "PRICE SETTING" for coin counter and timer and "TIME SETTING" for timer. (See chapters 5.2,5.3.).
4. The relay contact is a potential free contact with rating 250V ac 2(1)A.  
Connect the "RELAY NO" terminal and "RELAY COM" terminal to the machine circuit for activating a "Start" or "Ready to start" command.
5. Use the 250V ac already wired plug to connect the external coin device to the main supply of 208 - 240V ac.  
The wall socket must be fused with max 16A and leakage current breaker of 30 mA.

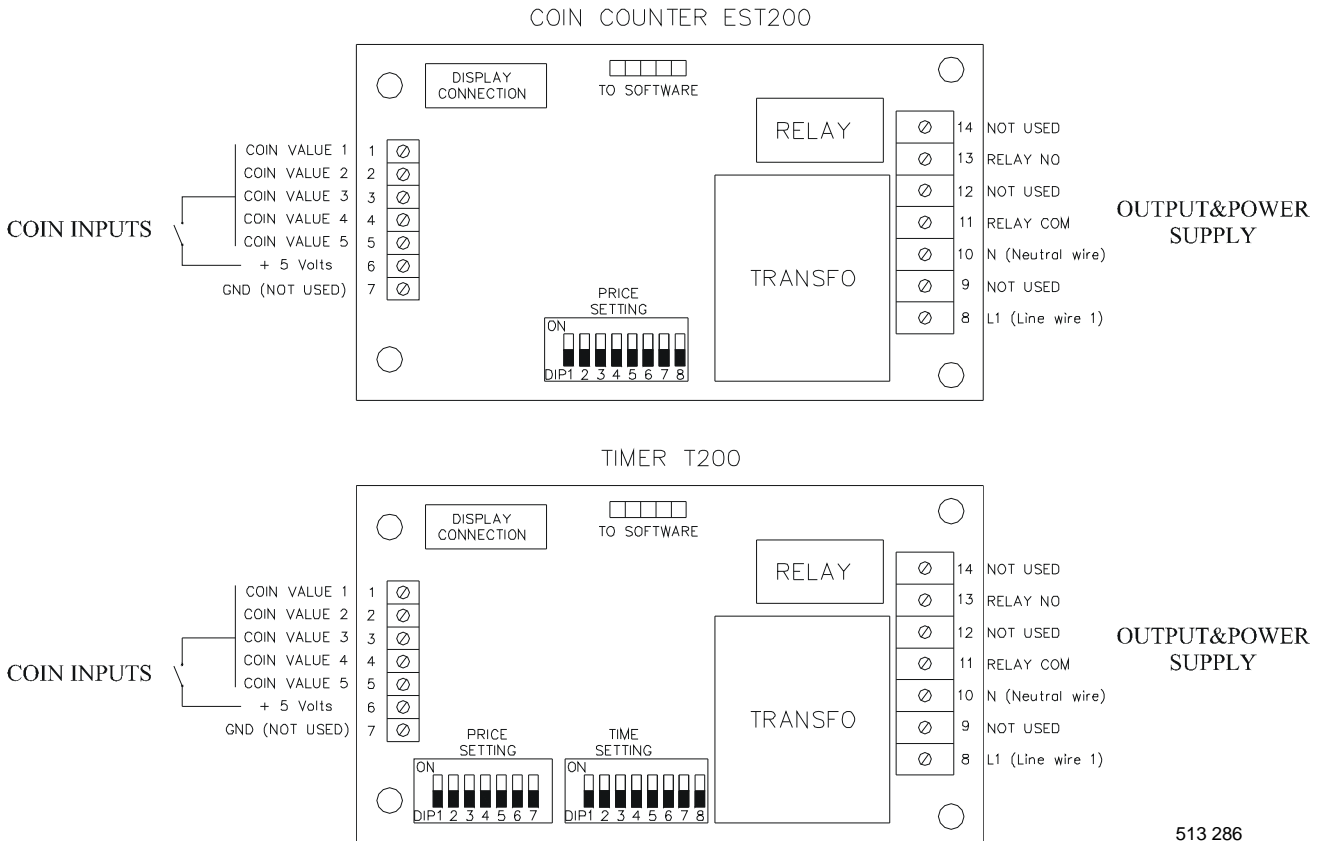

Fig.4. Coin counter EST200 and Timer T200

## 5. ADJUSTMENTS

### **⚠ DANGER!**

**ALWAYS TAKE CARE THAT ELECTRICAL CABLES ARE PROTECTED AGAINST DAMAGING. ALWAYS TAKE CARE THAT ELECTRICAL CABLES CAN NOT CAUSE BODILY INJURY AS WELL AS DAMAGE TO THE PARTS AND APPLIANCES. WHEN THE CABLES NEEDS TO BE SHORTED, PROLONGED OR CHANGED, IT MUST BE DONE BY QUALIFIED SKILLED PERSON ACCORDING THE VALID LOCAL STANDARDS!**

### 5.1. CONNECTION OF COIN SWITCHES

The coin counter EST200 and timer T200 is a electronic board for one price with five inputs and one output. There are five coin inputs available and have *standard* the following coin values (see also fig.4.):

| COIN VALUE | Value of switch (Units) |
|------------|-------------------------|
| 1          | 010                     |
| 2          | 020                     |
| 3          | 025                     |
| 4          | 050                     |
| 5          | 100                     |

#### **COIN DROPS: 0,5 EURO AND 1 EURO**

The decimal is placed as follow : "4.00", what means 100 units for 1 Euro.

The same logic shows "0,50" Euro is 50 units and "1,00" Euro is 100 units.

The coin switches has to be connected to coin value 4 (50 Units) and coin value 5 (100 Units).

#### **COIN DROPS : 0,20 EURO AND 0,50 EURO**

The decimal point is placed as follow : "4.00". So "0.20" Euro is 20 units and "0.50" Euro is 50 units.

Connect the coin switches to coin value 2 (20) and coin value 4 (50).

It is also possible to show a decimal point on of the LED display. There is foreseen a jumper on the display board to have the decimal point on 3 possible positions :

- If the jumper is placed in the middle of the pin connector, no decimal point is shown. (Example "999")
- The jumper placed on the left of the pin connector, there will be shown a decimal point next to the left digit. (Example "9.99")
- The jumper placed on the right of the pin connector, there will be shown a decimal point next to the middle digit . (Example "99.9")



Fig.5.1.

## 5.2. COIN COUNTER (WASHING MACHINE)

Each DIP switch of the "PRICE SETTING" switch (See fig.4.) has a certain value, as mentioned in the following table:

| Number of switch | Value number |
|------------------|--------------|
| 1                | 1            |
| 2                | 2            |
| 3                | 4            |
| 4                | 8            |
| 5                | 16           |
| 6                | 32           |
| 7                | 64           |
| 8                | 128          |

A value is selected by switching the switch to the "ON" position.

**The price is the product of the "PRICE SETTING" (1-255) and a predetermined value 5!**

The price lays between 5 and 1275 (1x5 to 255x5). Herein is 1 and 255 price settings value, 5 is standard value).

### □ EXAMPLE

#### PRICE FOR ONE WASH: 4 EURO

We keep in mind that we have three digits on the display, and we will display the amount 4 Euro like "4.00". So we count for one unit on the display = "0.01" Euro.

For the decimal point we have to place the jumper on the left side of the pin connector to shown a decimal point next to the left digit. (software independent).

The price is determined by the DIP switch "PRICE SETTING" multiplied by a value 5.

We calculate the PRICE SETTING we have to set :

$$400 \text{ units (4 Euro) } / 5 = 80$$

We have to set the DIP switch "PRICE SETTING" on 80 :

$$0 * 1(\text{DIP 1}) + 0 * 2(\text{DIP 2}) + 0 * 4(\text{DIP 3}) + 0 * 8(\text{DIP 4}) + 1 * 16(\text{DIP 5}) + 0 * 32(\text{DIP 6}) + 1 * 64(\text{DIP 7}) + 0 * 128(\text{DIP 8}) = 80$$

As we can see the DIP switches 5 and 7 of the "PRICE SETTING" must be placed on "1" or "ON".

The other DIP switches must be placed on "0" or "OFF".

#### PRICE FOR ONE WASH: 5 EURO

Predetermined programmable value = 5

Price setting is 5.00 or  $500/5 = 100$

The number 100 can be composed as follows:

$$0 * 1(\text{DIP 1}) + 0 * 2(\text{DIP 2}) + 1 * 4(\text{DIP 3}) + 0 * 8(\text{DIP 4}) + 0 * 16(\text{DIP 5}) + 1 * 32(\text{DIP 6}) + 1 * 64(\text{DIP 7}) + 0 * 128(\text{DIP 8}) = 100$$

Place the following DIP switches of the "PRICE SETTING" on "1" or "ON" : DIP 3, DIP 6, DIP 7.

The other DIP switches are placed on OFF position.

## 5.3. TIMER (DRYER)

Each DIP switch of the "PRICE SETTING" (See fig.4.) has a certain value, as mentioned in 5.2 coin counter.

When this price is paid the dryer will start and this for a predetermined time set with DIP switch "TIME SETTING" as mentioned in the following table:

| Number of switch | Value number |
|------------------|--------------|
| 1                | 1            |
| 2                | 2            |
| 3                | 4            |
| 4                | 8            |
| 5                | 16           |
| 6                | 32           |
| 7                | 64           |
| 8                | 128          |



You can now form any number for the time in minutes by making a combination of the values mentioned here above (1-255). A value is selected by switching the switch of the "TIME SETTING" to the "ON" position. Standard you can set a time between the 1 min and 255 minutes for the above set price. Extra payment is possible at any time.

## □ EXAMPLE

### TIME SET 4 MINUTES FOR A PRICE OF 1 EURO

1. Set the price on 1 Euro (see 5.2 Coin counter).
2. Set the time on 4 min.

The time to set on the "TIME SETTING" switch (see fig.4.) is : 4

$$0*1(\text{DIP } 1)+0*2(\text{DIP } 2)+1*4(\text{DIP } 3)+0*8(\text{DIP } 4)+0*16(\text{DIP } 5)+0*32(\text{DIP } 6)+0*64(\text{DIP } 7)+0*128(\text{DIP } 8) = 4.$$

For 4 minutes you have to pay 1 Euro and extra payment is possible, for 1 Euro you get 4 min more time on the display.

For a 0,5 Euro extra payment you will get 2 minutes extra time.

## 5.4. CONNECTION OF 6,5kg WASHER AND 6,5kg DRYER WITH HEAT PUMP TO EXTERNAL COIN DEVICE

- To connect the washer to the external coin device, use the already connected (2+1) cable coming from the external coin device.
- Open the top cover of the washer and place the cable through the foreseen opening on the rear plate in the middle. If no hole with swivel is present, mount one that's fit for the cable.
- In the rear top side you will find a rectangle 6 pole connector (male and female). Remove the female with the wire bridge that is sitting in position 1 and 4. Remove the wire bridge.
- If not present put on male faston's on the wires of the cable coming from the External coin device that match with the female faston' in the male connector and place them in position 1 and 4 of the female connector.
- Place the earth in position 6.
- Fix the female on the male connector and secure all new items.
- Place everything in the original position before connecting to the power supply.
- The time relay is preset from production to MODE C and TIME 5 minutes.

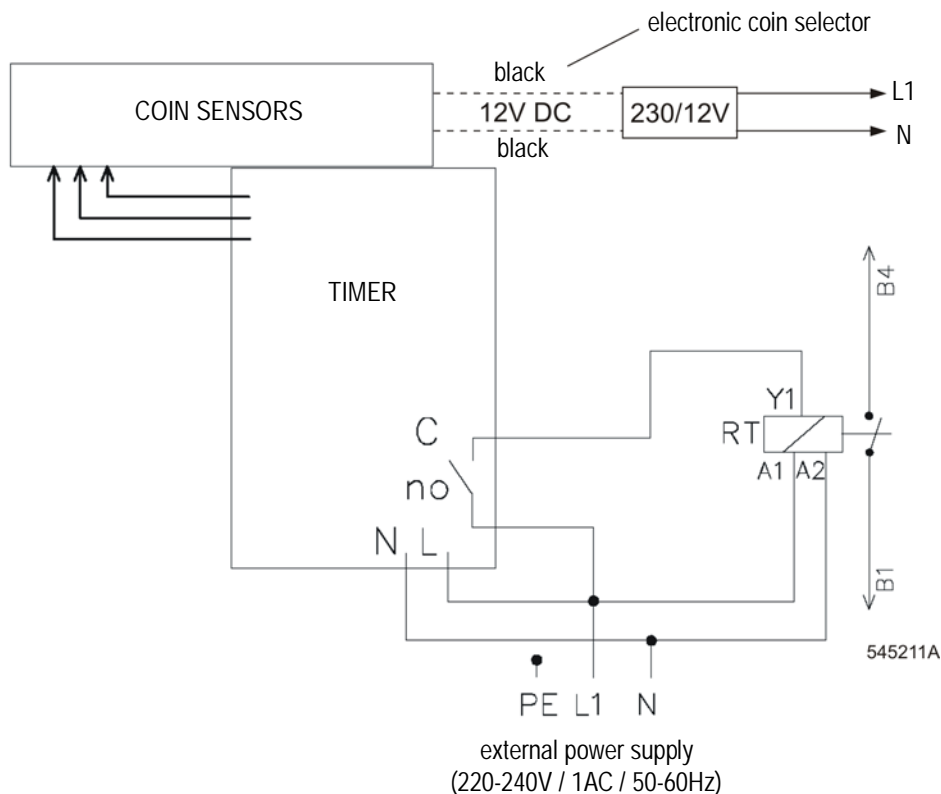

## 5.5. CONNECTION OF 6/7 kg WASHER TO EXTERNAL COIN DEVICE

- To connect this washer to the external coin device you need to order model ECD 1.
- To connect the washer to the external coin device, use the already connected (2+1) cable coming from the external coin device.
- Open the top cover of the washer and place the cable through the foreseen opening on the rear plate. If no hole with swivel is present, mount one that's fit for the cable.
- If not present put on female faston's on the wires of the cable coming from the External coin device that match with the male faston located on the program switch located on the rear of the machine. Connect one wire of the cable to the red and one to the green.  
Never put any voltage to these two (red and green) wires.  
Connect the earth wire to a earth point of the machine.  
More detailed connection information can be found on the electrical wiring diagram of the machine.
- Secure all new items.
- Place everything in the original position before connecting to the power supply.

## 5.6. CONNECTION OF 9 kg DRYER TO EXTERNAL COIN DEVICE

- To connect this dryer to the external coin device you need to order model ECD 2.
- To connect the dryer to the external coin device, use the already connected (3+1) cable coming from the external coin device.
- Open the top cover of the dryer and place the cable through the foreseen opening on the rear plate. If no hole with swivel is present, mount one that's fit for the cable.
- Connect the earth wire to a earth point of the machine.
- RT is an Timer relay. This relay is active for a certain time longer than the RL, this is necessary for the cooldown function and is standard set on 5 minutes.
- Place everything in the original position before connecting to the power supply.

## 5.7. CONNECTION OF 6,5kg DRYER TO EXTERNAL COIN DEVICE, NOT APPLICABLE FOR 6,5kg DRYER WITH HEAT PUMP

- To connect this dryer to the external coin device you need to order model ECD 2.
- To connect the dryer to the external coin device, use the already connected (4+1) cable coming from the external coin device.
- Open the top cover of the dryer and place the cable through the foreseen opening on the rear plate. If no hole with swivel is present, mount one that's fit for the cable.
- There is a relay with wires on the right rear side. Disconnect the black wire and two orange wires from the RB terminal of the relay.
- Connect the disconnected black wire to the wires of the external coin device - AC wires (blue + gray).
- Connect Wire B (black) to the RB terminal - relay coil.
- Connect Wire D to the pair of the orange wires - electrical circuit of the motor.
- Provide all the connections with suitable insulated connecting components.
- Connect the earth wire to a earth point of the machine.
- RT is an Timer relay. This relay is active for a certain time longer than the RL, this is necessary for the cooldown function and is standard set on 5 minutes.
- Place everything in the original position before connecting to the power supply.

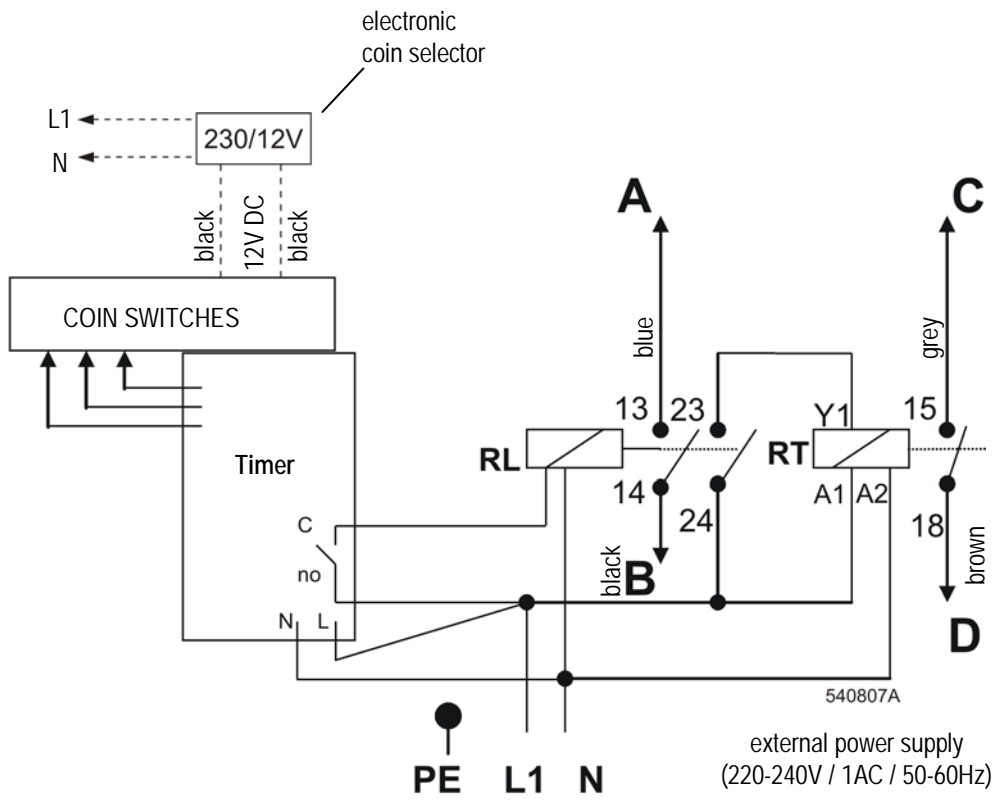

Fig.5.7. Schematic diagram 6,5 kg dryer connection

## **6. TROUBLE SHOOTING AIDS**

Before servicing always disconnect the power from supply source!

Do not forget to lock the external coin device door after servicing or empty the coin box!

### **6.1. COINS CAN'T BE INSERTED**

#### **COIN DROP SLOT IS PLUGED**

- clean slots of coin meter on dry way.
- remove foreign objects from coin mechanism.

#### **COIN DROP SWITCH IS DEFECT**

- exchange damaged parts to identical purchased parts from your dealer/manufacturer.

#### **COIN BOX IS FULL**

- Empty the coin box in the external coin device.

### **6.2. LINKED APPLIANCE GETS NOT STARTED**

#### **NOT SUFFICIENT NUMBER OF COIN FOR START SIGNAL**

- put right number of coins in the external coin device.

#### **COIN DROP SWITCH IS DEFECT**

- exchange damaged parts to identical purchased parts from your dealer/manufacturer.

#### **COIN COUNTER OR TIMER IS DEFECT**

- exchange damaged parts to identical purchased parts from your dealer/manufacturer.

#### **DEFECT OR BAD CONNECTION**

- check wire connection according “Connection diagram” delivered with appliance.

### **6.3. DISPLAY DOESN'T LIGHT UP OR NOT FULLY**

#### **THE POWER OF THE EXTERNAL COIN DEVICE IS INTERRUPTED**

- carefully check source supply and supply cable of the external coin device.

#### **COIN COUNTER OR TIMER IS DEFECT**

- exchange damaged parts to identical purchased parts from your dealer/manufacturer.

#### **DISPLAY IS DEFECT**

- exchange damaged parts to identical purchased parts from your dealer/manufacturer.

#### **DEFECT OR BAD CONNECTION**

- check flat cable between coin drop counter or timer and display and his connection.

# 7. SPARE PARTS LIST

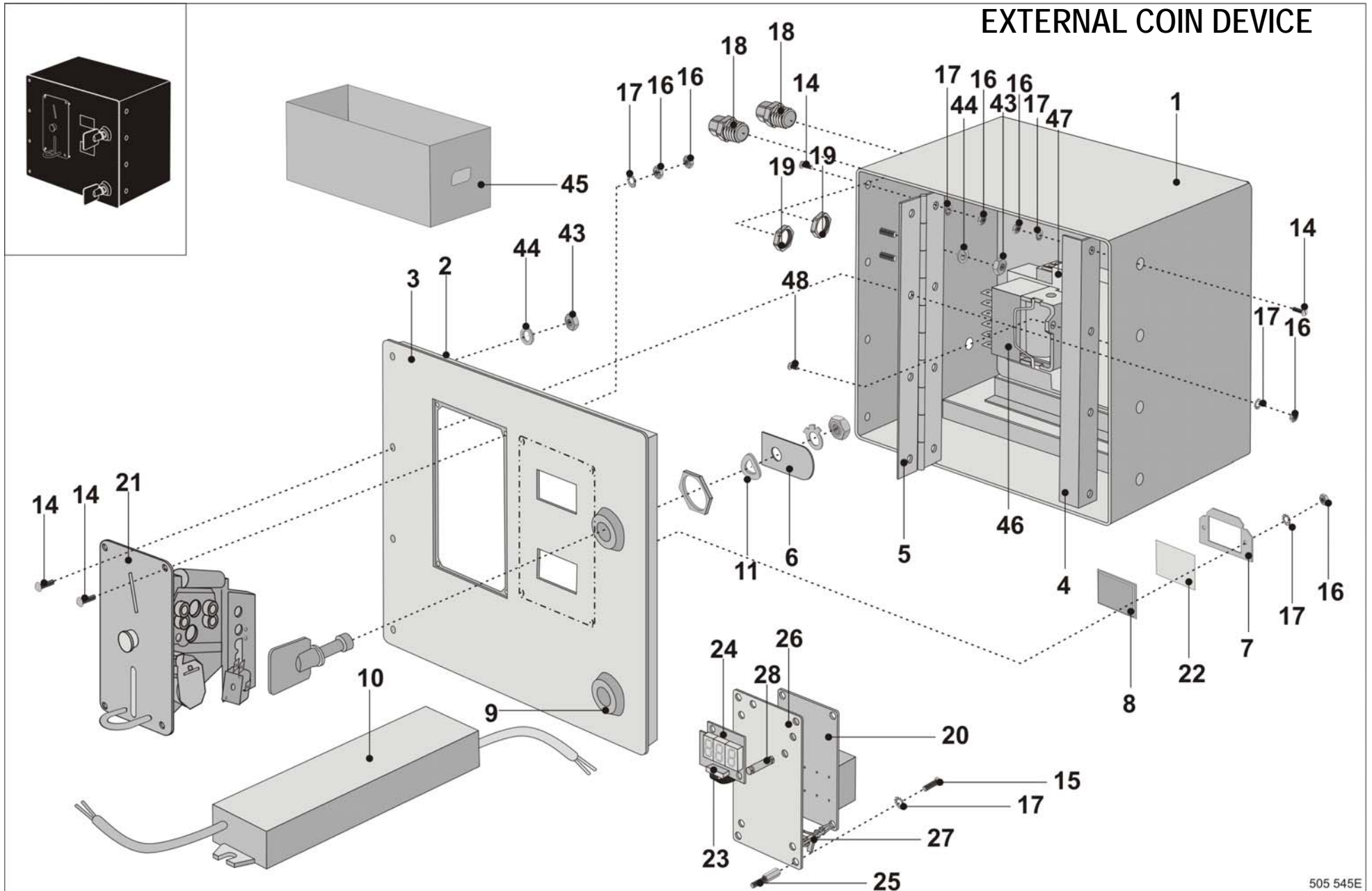

505 545E

**External coin device: drawing nr. 505545E**

|    |              |   |   |   |   |
|----|--------------|---|---|---|---|
| 1  | 500184       | Coin box  | Boite   | Münzgerätkasten                                 | Caja del monedero                                     |
| 2  | 535170       | Cover of coinmeter  | Couvercle   | Deckel Münzgerätschach-tel                      | Tapa de la caja del automata de monedas               |
| 3  | 535172       | Coinbox plate   | Plaque de monnayeur                                 | Schild Münzgerät                                | Rótulo del automata de monedas                        |
| 4  | 100518       | L plate   | Corniere  | Winkelstück                                     | Escuadra  |
| 5  | PRI610000041 | Hinge   | Paumelle  | Türband   | Bisagra   |
| 6  | 100520       | Door latch  | Encliquetage de la serrure                          | Türschloßklinke                                 | Pestillo de la cerradura                              |
| 7  | F01113500514 | Holder  | Support   | Halter  | Sujetador   |
| 8  | PRI543072072 | Plexi transparent   | Altuglas transparent                                | Durchsichtiges Plexi                            | Plexiglás transparente                                |
| 8  | PRI543073072 | Plexi red   | Altuglas rouge                                      | Rotes Plexi                                     | Plexiglás rojo  |
| 9  | PRI610001028 | Coinbox lock  | Serrure du monnayeur                                | Schloß Münzgerät                                | Cerradura del automata de monedas                     |
| 9  |              | Big nut, part of No. 9                                    | Grande écrou de la serrure, partie de la position 9 | Türschloßmutter groß, Positionsbestandteil 9    | Tuerca grande de la cerradura, parte de la posición 9 |
| 9  |              | Securing washer, part of No. 9                            | Rondelle de sécurité, partie de la position 9       | Sicherungsscheibe, Positionsbestandteil 9       | Arandela de seguridad, parte de la posición 9         |
| 9  |              | Nut M7, part of No. 9                                     | Ecrou M7, partie de la position 9                   | Mutter M7, Positionsbestandteil 9               | Tuerca, parte de la posición 9                        |
| 10 | 549083       | Power supply 12V, applicable for electronic coin selector |   |   |   |
| 11 | PRI231000038 | Supple bent washer  | Rondelle élastique coudé                            | Unterlegscheibe federnd durchgebogen            | Arandela elástica encorvada                           |
| 14 | PRI212000008 | Bolt M3x10  | Vis M 3 x 10  | Schraube M 3 x 10                               | Tornillo M3x10  |
| 15 | 309084000306 | Bolt M3x6   | Vis M 3 x 6   | Schraube M 3 x 6                                | Tornillo M3x6   |
| 16 | 310934000003 | Nut M3  | Ecrou M3  | Mutter M3                                       | Tuerca M3   |
| 17 | 311679800003 | Washer M3   | Rondelle M3   | Unterlegscheibe M3                              | Arandela M3   |
| 18 | PRI350000045 | Swivel  | Traversé du cable                                   | Kabeldurchführung                               | Paso de cable   |
| 19 | PRI350001045 | Nut   | Ecrou   | Mutter  | Tuerca  |
| 20 | 102043       | Timer board, applicable for washing machines              | Carte du programmeur                                | Programmatorplatte, gültig für Waschmaschinen   | Lámina del programador                                |
| 20 | 102044       | Timer board, applicable for drying machines               | Carte du programmeur                                | Programmatorplatte, gültig für Trockenmaschinen | Lámina del programador                                |
| 21 | 516914       | Coin meter "Unibel Tech", applicable for high spin        |   |   |   |
| 21 | 516913       | industrial washing machines 10kg / 25lb                   |   |   |   |
| 21 |              | Coin meter "Unibel Tech", applicable for high spin        |   |   |   |
| 21 |              | industrial washing machines 7kg / 18lb                    |   |   |   |
| 21 | 102371       | Coin meter for 5DKK + 10DKK                               |   |   |   |
| 21 | 516639       | Coin meter for 2DKK                                       |   |   |   |
| 21 | 100895       | Coin meter for 5DKK                                       |   |   |   |
| 21 | 100896       | Coin meter for 20DKK                                      |   |   |   |
| 21 | 101797       | Coin meter for 1DKK + 5DKK                                |   |   |   |
| 21 | 101450       | Coin meter for 2DKK + 5DKK                                |   |   |   |
| 21 | 516632       | Coin meter for 2DKK + 10DKK                               |   |   |   |
| 21 | 102407       | Coin meter for 0,2EUR                                     |   |   |   |
| 21 | 102452       | Coin meter for 1EUR + 0,2 EUR                             |   |   |   |
| 21 | 102546       | Coin meter for "SUN WASH" jeton                           |   |   |   |
| 21 | 100866       | Coin meter for "5K" jeton                                 |   |   |   |
| 21 | 100867       | Coin meter for "7K" jeton                                 |   |   |   |
| 21 | 100868       | Coin meter for "10K" jeton                                |   |   |   |
| 21 | 100869       | Coin meter for "12K" jeton                                |   |   |   |
| 21 | 100870       | Coin meter for "15K" jeton                                |   |   |   |
| 21 | 100871       | Coin meter for "D" jeton                                  |   |   |   |
| 21 | 100887       | Coin meter for 1E + 20PC                                  |   |   |   |
| 21 | 100888       | Coin meter for 1E + 50PC                                  |   |   |   |
| 21 | 516994       | Coin meter for 20 pence                                   |   |   |   |
| 21 | 100891       | Coin meter for 100YEN                                     |   |   |   |
| 21 | 100892       | Coin meter for 500YEN + 100YEN                            |   |   |   |
| 21 | 516921       | Coin meter "Unibel Tech" 5K                               |   |   |   |
| 21 | 101437       | Coin meter for 0,25USD                                    |   |   |   |
| 21 | 100893       | Coin meter for 1AUD                                       |   |   |   |
| 21 | 100642       | Coin meter for 1AUD + 20C                                 |   |   |   |

**External coin device: drawing nr. 505545D**

|    |        |   |  |  |  |
|----|--------|---|--|--|--|
| 21 | 516875 | Coin meter for 1AUD + 2AUD                                    |  |  |  |
| 21 | 516950 | Coin meter for 1CHF   |  |  |  |
| 21 | 100900 | Coin meter for 5ILS + 1ILS                                    |  |  |  |
| 21 | 101499 | Coin meter for 5NOK   |  |  |  |
| 21 | 101155 | Coin meter for 10NOK  |  |  |  |
| 21 | 516967 | Coin meter for 5 NOK +10NOK                                   |  |  |  |
| 21 | 101612 | Coin meter for 10NOK + 20NOK                                  |  |  |  |
| 21 | 516969 | Coin meter for 1 TopMos jeton + 1BGN                          |  |  |  |
| 21 | 516807 | Coin meter for F10.3-W2000-19,2                               |  |  |  |
| 21 | 516977 | Coin meter for 1 "Vendo" jeton                                |  |  |  |
| 21 | 100902 | Coin meter for 1EUR   |  |  |  |
| 21 | 101536 | Coin meter for 0,50EUR + 1EUR                                 |  |  |  |
| 21 | 101632 | Coin meter for 0,20EUR + 0,50EUR                              |  |  |  |
| 21 | 516737 | Coin meter for 1EUR + 2EUR                                    |  |  |  |
| 21 | 529114 | Coin meter for 2EUR + 0,50EUR                                 |  |  |  |
| 21 | 516980 | Coin meter for 2EUR   |  |  |  |
| 21 | 516984 | Coin meter for 0,05EUR  |  |  |  |
| 21 | 101535 | Coin meter for 0,50EUR  |  |  |  |
| 21 | 101228 | Coin meter for 1 MYR  |  |  |  |
| 21 | 553007 | Coin meter for 0,5 MYR  |  |  |  |
| 21 | 516991 | Coin meter for 1 jeton Token                                  |  |  |  |
| 21 | 516992 | Electronic coin meter EMP 500.12 v4, Moroccan currency        |  |  |  |
| 21 | 516782 | Electronic coin meter   |  |  |  |
| 21 | 516999 | Coin meter for jetons 7K + D                                  |  |  |  |
| 21 | 529106 | Coin meter for 1 "Wascator" jeton                             |  |  |  |
| 21 | 529108 | Coin meter for 1 "Unibel" jeton                               |  |  |  |
| 21 | 101293 | Coin meter "Jeton Blanco"                                     |  |  |  |
| 21 | 529109 | Coin meter for 10K "IPSO" jeton                               |  |  |  |
| 21 | 529115 | Coin meter for 50HUF + 100HUF                                 |  |  |  |
| 21 | 552952 | Coin meter for 200HUF   |  |  |  |
| 21 | 102084 | Coin meter for 10NT + 50NT                                    |  |  |  |
| 21 | 102473 | Coin meter for 10TWD  |  |  |  |
| 21 | 100898 | Coin meter for 500WON   |  |  |  |
| 21 | 552951 | Coin meter for 1SGD   |  |  |  |
| 21 | 556109 | Coin meter for 1SGD, (new Singapore dollar)                   |  |  |  |
| 21 | 552998 | Coin meter for 1TRY   |  |  |  |
| 21 | 529119 | Coin meter for 1 jeton, without coining, jeton diameter 20 mm |  |  |  |
| 21 | 529124 | Coin meter for 1 "Volund" jeton, jeton diameter 22,5 mm       |  |  |  |
| 21 | 534187 | Coin meter for 1 "Wascator" jeton                             |  |  |  |
| 21 | 529113 | Coin meter for 1 "Miele" jeton                                |  |  |  |
| 21 | 529110 | Coin meter for 1 jeton without coining, jeton diameter 26 mm  |  |  |  |
| 21 | 534289 | Coin meter for three-groove jeton, jeton diameter 27mm        |  |  |  |
| 21 | 534297 | Coin meter for three-groove jeton, jeton diameter 25mm        |  |  |  |
| 21 | 537775 | Coin meter for jeton "D" and 2EUR                             |  |  |  |
| 21 | 537776 | Coin meter for jeton "7K" and 2EUR                            |  |  |  |
| 21 | 537778 | Coin meter for jeton "Milano Italy"                           |  |  |  |
| 21 | 556113 | Coin meter for "Flash wash" jeton                             |  |  |  |
| 21 | 537779 | Coin meter for 5PLN + 1 PLN                                   |  |  |  |
| 21 | 556114 | Coin meter for 2PLN   |  |  |  |
| 21 | 537787 | Coin meter for two-groove jeton, jeton diameter 27mm          |  |  |  |
| 21 | 537788 | Coin meter for "A.S.A.R.D." jeton, jeton diameter 25,8mm      |  |  |  |
| 21 | 552901 | Coin meter for "Eagle" jeton, jeton diameter 25,98mm          |  |  |  |

**External coin device: drawing nr. 505545D**

|    |              |   |                      |                      |                               |
|----|--------------|---|----------------------|----------------------|-------------------------------|
| 21 | 516804       | Coin meter for "7K Equipos Par Lavar" jeton   |                      |                      |                               |
| 21 | 516638       | Coin meter for "Lucky Winner" jeton   |                      |                      |                               |
| 21 | 553008       | Coin meter for "Butzi wash" jeton   |                      |                      |                               |
| 21 | 537825       | Coin meter for 20CZK  |                      |                      |                               |
| 21 | 516636       | Coin meter for 10CZK + 20CZK  |                      |                      |                               |
| 21 | 101586       | Coin meter for 1NZD + 2NZD  |                      |                      |                               |
| 21 | 537828       | Coin meter for jeton "Electrolux ASARD", jeton diameter 22,3mm  |                      |                      |                               |
| 21 | 537859       | Coin meter for jeton "Laundromatic Belgium", jeton diameter 22,3mm  |                      |                      |                               |
| 21 | 537829       | Coin meter for two-groove jeton "Carsen", jeton diameter 22mm   |                      |                      |                               |
| 21 | 537913       | Coin meter for jeton "Asard Wascator", jeton diameter 19,9mm  |                      |                      |                               |
| 22 | -            | Coin label, according to the coin meter   |                      |                      |                               |
| 23 | 102073       | Display flat cable  |                      | Flachkabel           |                               |
| 24 | 102072       | Display   |                      | LED-Anzeige          |                               |
| 25 | 102127       | Spacer M3x12x7  |                      | Distanzstück M3x12x7 |                               |
| 26 | 102087       | Display washer  |                      | Scheibe Anzeige      |                               |
| 27 | 102190       | Support post Ø3,9   |                      | Distanzstück Ø3.9    |                               |
| 28 | PRI326002004 | Distance post Ø4,9  |                      | Distanzstück Ø4.9    |                               |
| 43 | 310934240004 | Nut M4  | Ecrou M4             | Mutter M4            | Tuerca M4                     |
| 44 | 311679824004 | Washer M4   | Rondelle M4          | Unterlegscheibe M4   | Arandela M4                   |
| 45 | 321848140028 | Coin box  | Armoire du monnayeur | Münzgeratkasten      | Caja del autómatas de monedas |
| 46 | PRI346011007 | Start relay   |                      | Start-Relais         |                               |
| 47 | PRI345015045 | Time relay  |                      | Zeitrelais           |                               |
| 48 | 309084000410 | Bolt M4x10  | Vis M4x10            | Schraube M4x10       | Tornillo M4x0                 |
| -  | 521520       | External coin meter complete - electric part for washing machines excluding 6,5 kg (stepper), (not shown) |                      |                      |                               |
| -  | 545212       | External coin meter complete - electric part for washing machines 6,5 kg (stepper), (not shown)           |                      |                      |                               |
| -  | 521521       | External coin meter complete - electric part for drying machines (timer) (not shown)                      |                      |                      |                               |
| -  | 534755       | External coin meter complete - mechanical part, (not shown)   |                      |                      |                               |
| -  | PRI347001010 | Jeton 5K, (not shown)   |                      |                      |                               |
| -  | PRI347001011 | Jeton 7K, (not shown)   |                      |                      |                               |
| -  | PRI347003015 | Jeton 10K, (not shown)  |                      |                      |                               |
| -  | PRI347001015 | Jeton 12K, (not shown)  |                      |                      |                               |
| -  | PRI347002015 | Jeton 15K, (not shown)  |                      |                      |                               |
|    |              |   |                      |                      |                               |
|    |              |   |                      |                      |                               |
|    |              |   |                      |                      |                               |



## 8. PUTTING “OUT OF SERVICE“



 **DANGER!**  
**ALWAYS DISCONNECT THE ELECTRICAL POWER SUPPLY BY TAKING OUT OF MAIN PLUG FROM THE WALL SOCKET AND DISCONNECT WITH THE DISCONNECTING DEVICE THE LINKED APPLIANCE BEFORE PUTTING OUT OF SERVICE !**  
**THIS IS YOUR PERSONAL SAFETY !**

1. Disconnect power and remove power supply cable.
2. Disconnect the linked appliance.

### 8.2. MACHINE DISPOSAL

#### 8.2.1 POSSIBILITY OF THE MACHINE DISPOSAL BY THE SPECIALIZED COMPANY

Information concerning the WEEE-directive (Waste Electrical and Electronic Equipment, for European Union member states only):

- For the production of the machine that you have purchased, natural resources are being reclaimed and used.  
The machine can contain substances which are dangerous for health and environment.
- When you dispose of your machine, to avoid spreading of these substances in our environment and to reduce the pressure on our natural resources, we encourage you to use the collection, reuse and recycle system of your region or country. These systems reuse or recycle most of the components.
- The symbol “crossed out bin on wheels (  )“ invites you to make use of these systems.
- If you wish more information concerning the systems for collection, reuse or recycling of disposed machines, you can take contact with the competent administration of your region or country (waste management).
- You can also take contact with us for more information concerning the environmental performances of our products.
- Please, consider that the WEEE directive is generally only valid for household machines. In some countries professional machines are added, in others not. Therefore the symbol (  ) may not be present.
- Info for dealers: Due to the diversity of the national legislations, manufacturer can not take all the measures to be in accordance with all national legislations of each member state. We expect that each dealer who imports our appliances into a member state (and puts it on the market) takes the necessary steps to be in rule with the national legislation (as the directive requires).

#### 8.2.2 POSSIBILITY OF THE MACHINE LIQUIDATION BY OWN POTENTIAL

It is necessary to sort out the parts for metal, non-metal, glass, plastics etc, and bring them to recycle places. The sorted out materials has to be classified in waste groups. Offer the sorted waste to the company which is competent for further treatment.

# IMPORTANT !

**TYPE:**

**COIN VALUES:**

- coin slot No.1:
- coin slot No.2:

**INSTALLATION DATE:**

**INSTALLATION  
CARRIED OUT BY:**

**SERIAL NUMBER:**

**ELECTRICAL DETAILS:**

**220-240 VOLT 1 PHASE 50/60HZ**

**NOTE:**

ANY CONTACTS WITH YOUR DEALER REGARDING MACHINE SAFETY, OR SPARE PARTS, MUST INCLUDE THE ABOVE IDENTIFICATION.

MAKE CERTAIN TO KEEP THIS MANUAL IN A SECURE PLACE FOR FUTURE REFERENCE.

**DEALER:**

|  |
|--|
|  |
|--|