

# TASK FORCE™

## 1450PSI ELECTRIC PRESSURE WASHER

ITEM: 248901

MODEL NO.: AP-PW1450-ZE01

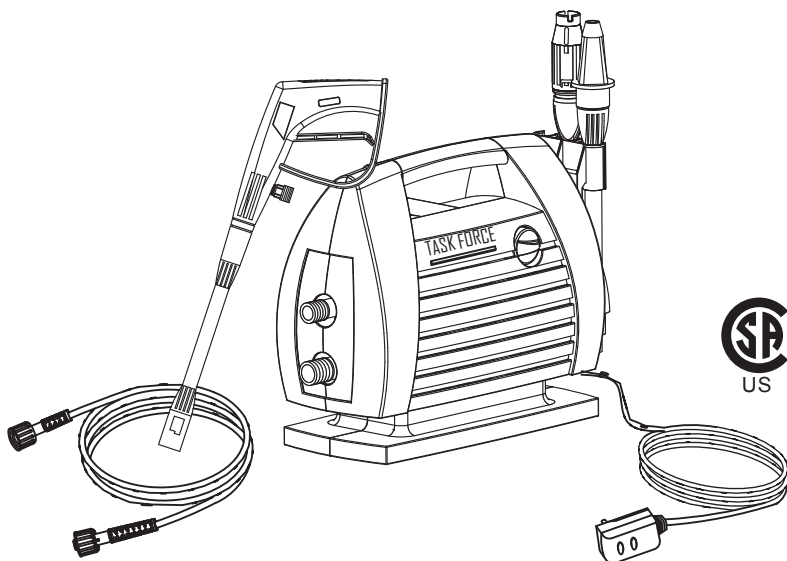

### ⚠ CAUTION ! ⚠

BEFORE OPERATING THIS UNIT, PLEASE READ THIS MANUAL THOROUGHLY AND RETAIN IT FOR FUTURE REFERENCE.

IF YOU MUST STORE YOUR PRESSURE WASHER IN A PLACE WHERE TEMPERATURE IS BELOW 41°F (5°C), YOU MUST APPLY WINTERIZING PROCEDURE TO PROTECT IT. FAILURE TO WINTERIZE THE UNIT MAY PERMANENTLY DAMAGE PUMP AND VOID THE WARRANTY. SEE PAGE 10 FOR WINTERIZING PROCEDURE.

### QUESTIONS, PROBLEMS, MISSING PARTS?

Before returning to your retailer, visit our website or call our customer service at

**[www.activeproducts.com](http://www.activeproducts.com) / 1-866-990-9918**

PURCHASE DATE: \_\_\_\_\_ SERIAL#: \_\_\_\_\_

PLEASE KEEP THE ORIGINAL BOX, PACKAGING AND RECEIPT.  
WARRANTY REGISTRATION BY INTERNET, [WWW.ACTIVEPRODUCTS.COM](http://WWW.ACTIVEPRODUCTS.COM).

TABLE OF CONTENTS

Technical specifications . . . . . i

Precautions . . . . . 1

Safety Features and Electrical Power Information . . . . . 2

Replacement Parts and Diagram . . . . . 3

Assembly and Operating Instructions . . . . . 4

Using the Accessories . . . . . 7

Working with Detergent . . . . . 8

Shut Down and Clean-up . . . . . 9

Taking a Break . . . . . 9

Winterizing and Long-term Storage . . . . . 10

Maintaining Your Pressure Washer . . . . . 11

Troubleshooting . . . . . 12

Warranty . . . . . 14

TECHNICAL SPECIFICATIONS

Specifications

Max. pressure:	1450PSI
Water flow rate:	1.3GPM
Power source requirement:	120V, 60HZ
Electrical cord:	35' WITH GFCI
High-pressure hose:	20'
Rated current:	11A
Water supply:	COLD TAP WATER

## IMPORTANT PRECAUTIONS - READ FIRST!

### ⚠ Safety Warnings ⚠

When using this product, basic precautions should always be followed:

- Read all the instructions before using the product.
- High-pressure jets can be dangerous if subject to misuse. The jet must not be directed at persons or animals.
- Water spray must never be directed towards any electric wiring, devices or directly towards the pressure washer machine itself or fatal electric shock may occur.
- To reduce the risk of injury, do not operate the machine near children.
- Learn how to stop the machine and release pressure quickly. Be thoroughly familiar with the controls.
- Stay alert—watch what you are doing.
- Wear safety goggles.
- For use with cold water supply only. Do not draw other liquids.
- Do not use acids, solvents, or any other flammable material in this product. These products can cause physical injuries to the operator and irreversible damage to the machine.
- To reduce the risk of electrocution, keep all connections dry and off the ground. Do not touch plug with wet hands.
- The pressure washer should not be used in areas where gas vapours may be present. An electric spark could cause an explosion or fire.
- To minimize the amount of water getting into the pressure washer, the unit should be placed as far as possible from the cleaning site during operation.
- Avoid accidental starts. Shut power “OFF” before connecting or disconnecting cord to electrical outlets.
- Do not operate the product when fatigued or under the influence of alcohol or drugs.
- Do not stand on unstable surfaces. Stand with both feet balanced at all times.
- Prior to starting the pressure washer in cold weather, be sure ice has not formed in any part of the equipment.
- Never carry your pressure washer by the cord. Do not pull on the cord to disconnect from the outlet.
- To allow free air circulation, the pressure washer should not be covered during operation.

- The Trigger Gun Safety Lock prevents the trigger from accidentally being engaged. This safety feature does not lock trigger in the “ON” position.
- California Proposition 65: This product or its power cord contains lead, a chemical known to the State of California to cause cancer, birth defects or other reproductive harm. Wash hands after use.

### ⚠ Warnings ⚠

- Do not use with flammable liquids and toxic chemicals.
- Injection Hazard: Equipment can cause serious injury if the spray penetrates the skin.
- Do not point the gun at anyone or any part of the body. In case of penetration seek medical aid immediately.
- This system is capable of producing 1450PSI. To avoid rupture and injury, do not operate this pump with components rated less than 1450PSI working pressure (including but not limited to spray guns, hose and hose connections).
- Before servicing, cleaning or removal of any parts, shut “OFF” power and relieve pressure.
- Do not spray electrical apparatus and wiring. If connection is made to a portable water system, the system shall be protected against backflow.

## SAFETY FEATURES AND ELECTRICAL POWER INFORMATION

The pressure washer is equipped with a stop device that will sense when the trigger on the gun is released. It will open the power circuit to the motor and cause the pressure washer motor to stop. Motor will resume again when trigger is pulled.

### ⚠ Warning ⚠

The pressure washer is also equipped with a main power "ON/OFF" switch located on the unit. It should always be moved to the "OFF" position when the pressure washer is not being used to prevent possible injury or damage.

### Ground Fault Circuit Interrupter:

This pressure washer has a ground-fault circuit-interrupter (GFCI) built into the plug of the power supply cord. This device provides additional protection from the risk of shock. Should replacement of the plug or cord become necessary, use only identical replacement parts that include GFCI protection.

### Extension Cords

If possible, do not use extension cords with this product. However, if you must use one, observe all the warnings and instructions listed below:

### ⚠ Warning ⚠

Extension cords are not recommended unless they are plugged into a ground fault circuit-interrupter found in circuit boxes or protected receptacles.

### Use a sufficient gauge:

Maximum cable length: 50' = 14 AWG

- Use only extension cords that are intended for outdoor use. These extension cords are identified by a marking "Acceptable for use with outdoor appliances; store indoors while not in use."
- Use only extension cords having an electrical rating not less than the rating of the product.
- Do not use damaged extension cords. Examine extension cord before using and replace if damaged. Do not abuse extension cord and do not yank on any cord to disconnect.
- Keep cord away from heat and sharp edges.
- Always disconnect the extension cord from the receptacle before disconnecting the product from the extension cord.
- To reduce the risk of electrocution, keep all connections dry and off the ground. Do not touch plug with wet hands.

## REPLACEMENT PARTS AND DIAGRAM

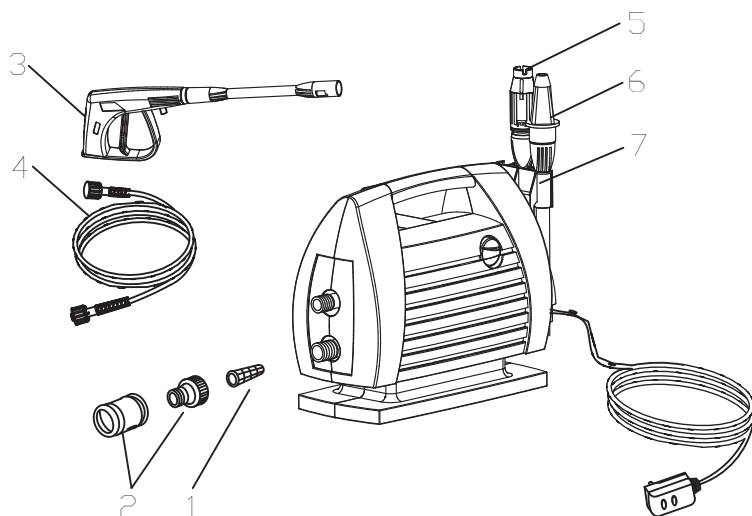

### CORNER ITEMS:

- 8 USER MANUAL
- 9 NEEDLE

### Parts List

Item no.	Quantity	Part Name	Parts No.
1	1	Water filter	ZE01-000-0003
2	1	Quick-connect coupling & inlet adaptor	ZE01-050-0000
3	1	Gun assembly	ZE01-090-0001
4	1	High-pressure hose	ZE01-090-0002
5	1	Adjustable wand	ZE01-090-0003
6	1	Turbo wand	ZE01-090-0004
7	1	Gun/wand holder	ZE01-000-0001
8	1	User manual	ZE01-900-0002
9	1	Needle	ZE01-900-0001

## ASSEMBLY AND OPERATING INSTRUCTIONS

Assembly Time: 2 minutes / Tools Required: None

### Surface Preparation

Before starting any cleaning task, it is important to inspect the area for objects which could create a hazard. Remove from the workarea which could be tripped over, such as toys or outdoor furniture. Ensure that all doors and windows are closed tight.

#### ⚠ Caution ⚠

- Never use the pressure washer to draw in water contaminated with solvents (e.g. paint thinners, gasoline, oil, etc.).
- Dirt in the feed water will damage the unit. To avoid this risk, we recommend checking the water filter (located inside the water inlet; to clean it out see Maintenance section on page 11).
- Always prevent debris from being drawn into the unit by using a clean water source and an accessory water filter if required.

### Water Supply (Cold Water Only)

- Do not draw non-water liquids through the unit. For use with cold water supply only.
- Water hose must be at least a 1/2" in diameter.
- Flow rate of water supply must not fall below 2 GPM (gallons per minute).
- Flow rate can be determined by running the water for one minute into an empty 5-gallon container.
- The water supply temperature must not exceed 104°F (40°C).

#### ⚠ Caution ⚠

To prolong the life of the unit, it is recommended to rest the unit 5 minutes after every 30 minutes of use.

Fig. 1

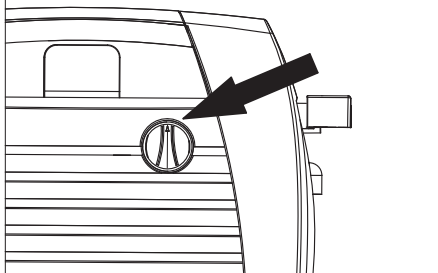

#### Step 1

Make sure that the ON/OFF switch is in the "OFF" position.

Fig. 2

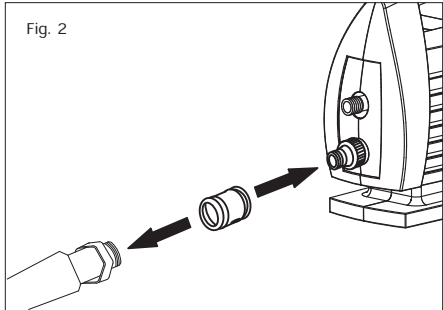

#### Step 2

Separate the adaptor and quick-connect coupling. Attach inlet adaptor to the machine's inlet and attach the quick-connect coupling onto the garden hose.

Fig. 3

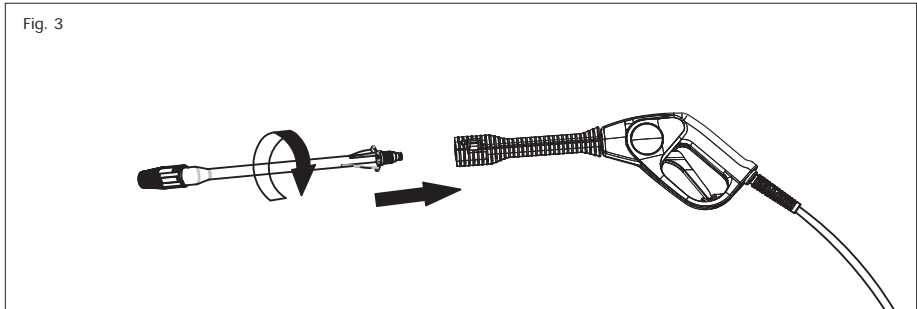

#### Step 3

Insert the wand into spray gun, and twist 1/4 turn until rectangular tab appears.

Fig. 4

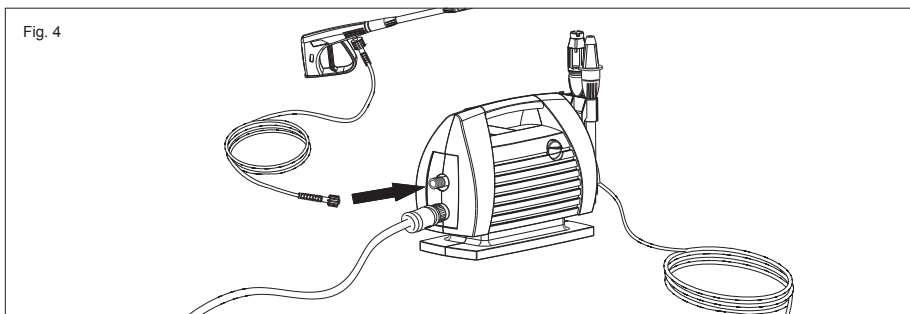

**Step 4**

Attach the high-pressure hose to the water outlet. Twist tightly to avoid leakage.

Fig. 5

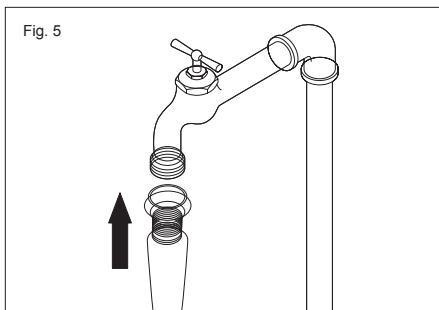

**Step 5**

Attach garden hose to water supply and turn water on.

Fig. 6

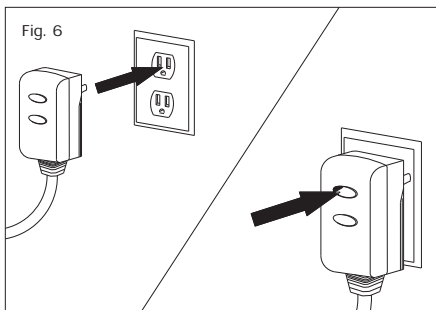

**Step 6**

Plug the unit into an outlet. Press "TEST", then press "RESET" to assure proper connection to power.

Fig.7

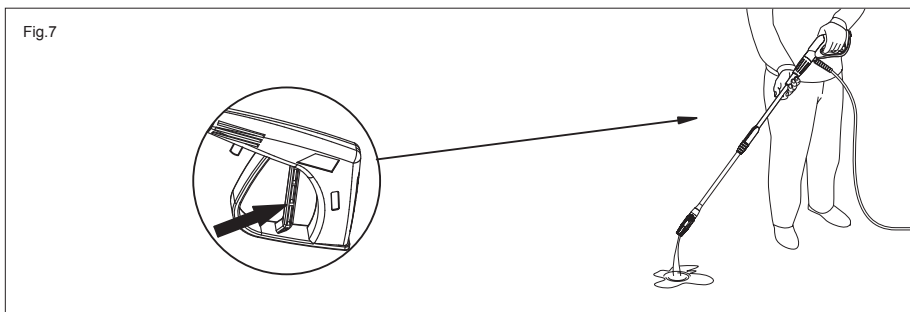

**Step 7**

Before turning the unit ON, depress the trigger to bleed any trapped air out of the pump and hose.

Fig.8

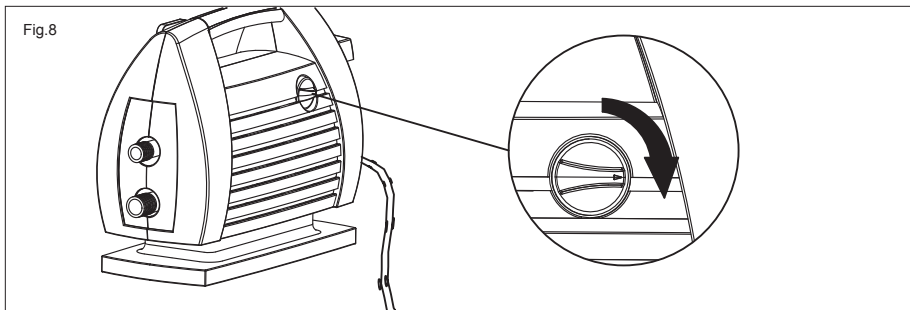

**Step 8**

Start the pressure washer by turning ON/OFF switch to ON.



## USING THE ACCESSORIES

Fig. 9

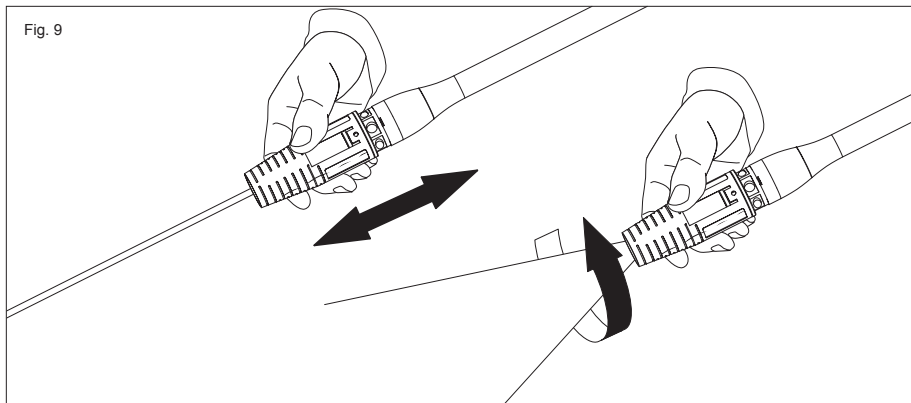

### Adjusting The Spray

The adjustable spray nozzle can be adjusted from fan to jet. The spray is adjusted from jet to fan spray by turning the nozzle as shown in Fig. 9.

#### ⚠ Caution ⚠

Jet spray adjustment is very aggressive. Do not adjust while spraying. We recommend that for most cleaning applications a 20° spray angle should be used to avoid damage to the surface being sprayed.

#### ⚠ Caution ⚠

To prolong the life of the unit, it is recommended to rest the unit 5 minutes after every 30 minutes of use.

## WORKING WITH DETERGENTS

### Using the detergent

To enhance the efficiency of the pressure washer, sometimes it is necessary to use detergents to help loosen tough dirt and grime.

#### ⚠ Caution ⚠

This machine has been designed for use with pressure washer detergents only. The use of other detergents or chemicals may affect the operation of the machine and will void the warranty.

**Note:** To apply detergent, the adjustable nozzle must be in the low-pressure position.

### Detergent Application

#### Step 1

Pull the detergent suction tube out and insert it into a detergent container.

Fig.10

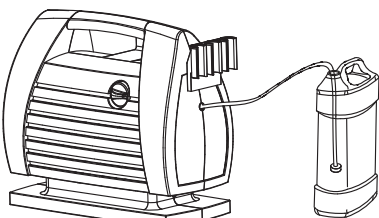

#### Step 2

Adjust the nozzle to low-pressure setting to apply the detergent.

#### Step 3

Depress the gun trigger and the detergent will be automatically injected and mixed with water.

#### Step 4

Apply detergent to work area. Do not allow detergent to dry on surface.

#### Step 5

Release the gun trigger and adjust nozzle to high pressure setting. Depress the gun trigger and rinse the surface in a sweeping motion.

### Important notice

When you have finished using detergent, always follow the "Cleanup Instructions". Failure to clean properly will cause the injection system to become clogged and inoperable.

#### ⚠ Warning ⚠

- Never use bleach, chlorine products and other corrosive chemicals.
- Never use liquids containing solvents (i.e., paint thinners, gasoline, oils).
- Never use ammonia products.
- Never use acid-based products.

These products can cause physical injuries to the operator and irreversible damage to the machine and/or damage the surface being cleaned.

### Cleanup Instructions

#### Step 1

Insert the detergent suction tube into a container of fresh water.

#### Step 2

Set the nozzle to the low-pressure setting.

#### Step 3

Pull and hold the gun trigger for 20~30 seconds. Allow fresh water to rinse through the detergent injection system.

## SHUTTING DOWN AND CLEANING UP

### Step 1

Turn the switch to "OFF" (O) position and unplug cord from outlet.

### Step 2

Turn off the water supply.

### Step 3

Press trigger to release water pressure for 20~30 seconds.

### Step 4

Disconnect the garden hose from the water inlet on the unit.

### Step 5

Disconnect the the high-pressure hose from the high-pressure outlet and engage the gun safety lock.

### ⚠ Warning ⚠

Turn off water supply and squeeze trigger to depressurize the unit. Failure to do so could result in personal injury due to discharge of high-pressure water.

## TAKING A BREAK

**If taking a break of five minutes or more:**

### Step 1

Engage gun safety lock.

### Step 2

Turn pressure washer to "OFF" (O) position.

### Step 3

Unplug the power cord from the outlet.

## WINTERIZING AND LONG-TERM STORAGE

### Optimum Winterizing Procedure

Material required: Pump saver

Winterizing your pressure washer will help protect and prolong its life. It is strongly recommended you follow the below steps using a pump saver. This will keep the internal parts lubricated, protected from rust, and prevents the pump from freezing.

1. Connect the pump saver hose onto the adaptor and quick-connect coupling.
2. Depress button on top of antifreeze container.
3. Continue until fluid exits the pump outlet.
4. Remove the hose from pump inlet.

Pump saver is available at your local hardware stores.

### Alternative Procedure

If you cannot perform the Optimum Winterizing procedure, you can still protect your pressure washer from winter-damage:

1. Disconnect all water connections.
2. Turn on the machine for a few seconds. Press trigger to bleed any remaining water in the pump. Turn off immediately.
3. Remove the gun and hose from the pressure washer. Drain any excess water. Roll hose carefully and do not allow hose to be kinked.
4. Store the machine and accessories in a room that does not reach freezing temperatures. Do not store near furnace or other

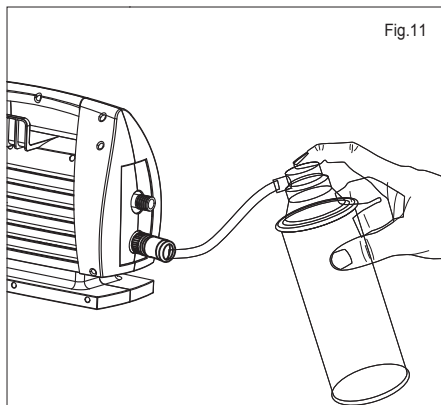

## USER MAINTENANCE

### Connections

Connections on pressure washer hoses, gun and spray wand should be cleaned regularly and lubricated with non-water soluble grease.

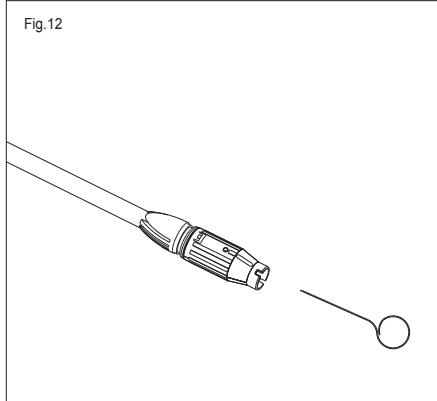

### Adjustable Nozzle

When the nozzle is clogged, it will cause the pump to build pressure and may cause the unit to surge. You can clean the nozzle by carefully inserting a thin, sharp instrument (i.e. paperclip) into the tip to rid it of deposits.

For the adjustable nozzle, you can also lubricate the nozzle collar (high-pressure/low-pressure) by using non-water soluble grease regularly.

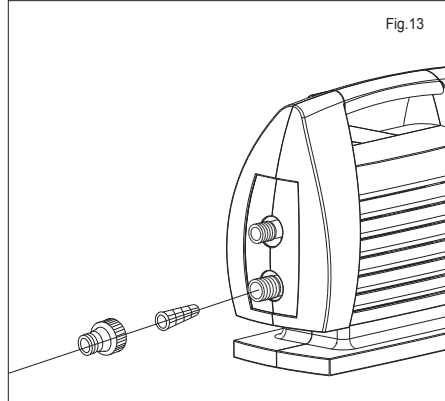

### Water Filter Screen

The pressure washer is equipped with a water inlet filter that prevents debris going into the pump. If the filter is not kept clean, the flow of water to the pressure washer will be restricted and the pump may be damaged.

1. To clean inner water screen, remove quick connector and remove the filter screen from the pump inlet.
2. Rinse screen until it is free of debris and blockage.
3. Replace screen and quick-connector immediately.

### Air Vents

The air vents located on the front and back of the pressure washer must be kept clean and free of any obstructions to ensure proper air-cooling of the motor during operation.

## TROUBLESHOOTING

Symptom	Cause	Solution
Motor will not start.	GFCI needs to be reset.	Press RESET button on the GFCI.
	On/Off switch is in the "OFF" (O) position.	Turn switch to the "ON" (I) position.
	Power cord is not plugged in.	Plug in power cord.
	Extension cord is too long. Extension cord is not proper gauge. Extension cord is damaged.	Replace extension cord with a 50' 14 gauge cord.
	Electrical outlet does not supply adequate power.	Try a different outlet.
Unit does not reach high pressure.	Diameter of garden hose is too small.	Replace with a inch or 5/8" garden hose.
	Water supply is restricted.	Check garden hose for kinks, leaks and blockage.
	Not enough inlet water supply.	Open water source full force.
	Water inlet filter is clogged.	Remove filter and rinse out in warm water.
	Pump is sucking air.	Check that hoses and fittings are air tight. Turn "OFF" machine and purge pump by squeezing trigger gun until a steady flow of water emerges through the nozzle.
Output pressure varies high and low.	Not enough inlet water supply.	Turn water on full force. Check garden hose for kinks, leaks or blockage.
	Pump is sucking air.	Check that hoses and fittings are air tight. Turn "OFF" machine and purge pump by squeezing trigger gun until a steady flow of water emerges through the nozzle.
	Water inlet filter is clogged.	Remove filter and rinse out in warm water.
	Discharge nozzle is obstructed.	Blow out or remove debris with a fine needle.
No detergent.	Detergent container is empty.	Add more detergent.
	Detergent bottle or suction tube not properly connected.	Check connections.
	Detergent is too thick.	Dilute detergent.
	Filter on detergent suction tube is clogged.	Run warm water through filter to remove debris.
	Damaged or clogged detergent suction tube.	Remove obstruction or replace detergent suction tube.
	Nozzle is in high-pressure position.	Turn nozzle tip to low-pressure position.
	Discharge nozzle is obstructed.	Blow out or remove debris with a fine needle.

**TROUBLESHOOTING – continued**

Symptom	Cause	Solution
Garden hose connection leaks.	Loose fittings.	Tighten fittings.
	Missing/worn rubber washer.	Insert new washer.
Spray wand, or extension, or nozzle leaks.	Spray nozzle not properly attached.	Insert the spray nozzle into the trigger gun. Carefully press in against the spring tension and twist into the locked position.
	Broken o-ring or plastic insert.	Call Customer Service.
Pump is noisy.	Pump is sucking air.	Check that hoses and fittings are air tight. Turn off machine and purge pump by squeezing trigger gun until a steady flow of water emerges through the nozzle.
Water leaks from pump (up to 10 drops per minute is permissible).	Loose fittings.	Check that all fittings are tight.
	Water seals are damaged or worn.	Call Customer Service.
Oil Drip.	Oil seals are damaged or worn.	Call Customer Service.
Motor buzzes but fails to run.	Supply voltage below minimum.	Verify that only the pressure washer is running on this circuit.
	System has residual pressure.	Turn unit "OFF", squeeze trigger on spray wand to release pressure, then turn unit "ON".
	Voltage loss due to extension cord.	Do not use extension cord with this unit—plug directly into power outlet.
	Pressure washer not used for long periods.	Call Customer Service.

IF YOU ENCOUNTER ANY ADDITIONAL DIFFICULTIES NOT LISTED, VISIT OUR WEBSITE AT [WWW.ACTIVEPRODUCTS.COM](http://WWW.ACTIVEPRODUCTS.COM) OR CALL CUSTOMER SERVICE AT 1-866-990-9918 FOR ASSISTANCE.

## WARRANTY

### LIMITED 1 YEAR WARRANTY

This pressure washer is warranted to be free of defects in materials and workmanship under normal residential use for one (1) year.

Specific warranty applies to:

- Electric motor and pump are warranted for one (1) year.
- Standard accessories and attachments including the gun, wand/hose and coupler are warranted for a ninety (90) day period.

The warranty period is calculated from the date of purchase by the end user and covers the cost for replacement parts/equipment. In order to verify a warranty situation a copy of the original receipt or gift receipt must accompany the warranty claim, along with the manufacturer's serial number from the product. Any warranty claim, work, or replacements given are to fulfill the terms of the original warranty period only.

The manufacturer's obligation under this warranty shall strictly be limited, at manufacturer's option, to replace any pressure washer or parts thereof, which in the opinion of the manufacturer, shows defect in workmanship or material. All decisions of Active Products with regard to this limited warranty shall be final. NO RETURNS or REFUNDS will be allowed by the retailer or manufacturer.

To make a warranty claim or inquiry, you must call 1-866-990-9918. You must have the product serial number and receipt information ready.

If defects should appear within one year of purchase, you may return the unit with your receipt as proof of purchase to the place of purchase for an exchange of either a new or refurbished unit, at manufacturer's discretion. There will be no REFUNDS provided.

The warranty does NOT cover:

- Merchandise sold as reconditioned, used, demonstration or floor models.
- Any commercial, industrial or rental usage of this product. Any such usage will void the implied warranty.
- Any product that has been damaged by freezing, dropping, misuse, neglect, accident, abuse, improper handling, normal wear and tear, or non-compliance with the owner's manual
- Any product that has been damaged by a contaminated water supply, water sediment or chemicals/detergents that are not approved by or recommended by Active Products.
- Any product that has been damaged by acts of nature such as fires, floods, earthquakes, lightning strikes, etc.
- Damage caused by repairs made by the end user or any service center not authorized by Active Products. Any such tampering will void the implied warranty.
- Any cost for shipping by the customer or authorized service center of the allegedly defective product.
- Any cost for shipping of replacement parts or accessories. Such shipping costs will be borne in full by the end user.
- Any non-standard or bonus accessory/attachement included with the original product.

The manufacturer shall in no event be liable for injuries to persons or property, or for incidental, contingent, special or consequential damages arising from the use of this product. This warranty does not apply to damage due directly or indirectly to misuse, abuse, negligence or accidents; repairs or alterations; or lack of maintenance. The manufacturer shall not be liable for any misrepresentations by stores, store employees, or any parties, that make claims on this product.

This warranty is non-transferable and only applies to products that were sold in and reside in the United States. This warranty gives you specific legal rights. You may have other rights, which vary by state.

If you have any questions or comments, visit our web site at [www.activeproducts.com](http://www.activeproducts.com) or call our toll free customer service line at 1-866-990-9918.